

HISTORIC PROPERTIES INVENTORY FORM

HISTORIC PRESERVATION UNIT  
DEPARTMENT OF CULTURE & HISTORY  
THE CULTURAL CENTER  
CHARLESTON, WEST VIRGINIA 25305

(Staff Use Only)

File No:  
Theme(s):  
Neg No(s):  
USGS Quad:  
UTM Ref:

DISTRICT SITE BUILDING STRUCTURE OBJECT

- 1 NAME(S) historic/common: Pendleton County Poor Farm *South Branch WVA*
- 2 LOCATION street/road: U.S. Rte. 220  
city/town: Upper Tract  
(incorporated/unincorporated)
- 3 USE/FUNCTION present: Private Residence  
original: Poor Farm
- 4 OWNER/ADDRESS present: Mr. & Mrs. Michael Munley Upper Tract  
original: Pendleton County Franklin
- 5 PHOTO/SKETCH OF:

(public/private restricted)  
(public/private)  
(phone no.)

7. PLAN (include approx. dimensions):

See Attached

6. LOCALE/ENVIRONMENT (map)

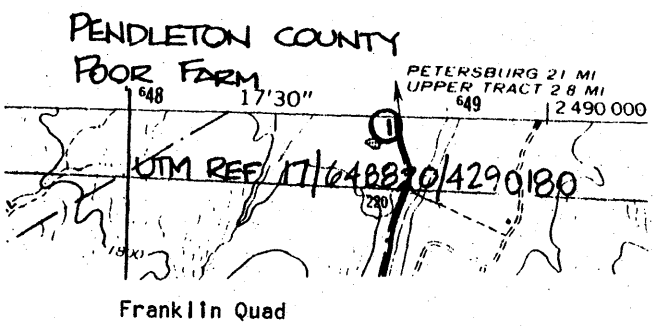

8. (A.) ACREAGE (approx):

Approximately 1 acre

(B.) VERBAL BOUNDARY DESCRIPTION:

The nominated area is enclosed within a 200' x 200' square, having as its eastern boundary the west edge of US Route 220, to include the house and its immediate environment.

COUNTY: Pendleton  
Survey Region:  
Planning District:

PROPERTY NAME: Pendleton County Poor Farm

9. DESCRIPTION (clarify as appropriate):

a. Exterior Fabric  
 stone \_\_\_\_\_  
 brick \_\_\_\_\_  
 concrete \_\_\_\_\_  
 stucco \_\_\_\_\_  
 weatherboard X \_\_\_\_\_  
 clapboard \_\_\_\_\_  
 board & batten \_\_\_\_\_  
 shingle \_\_\_\_\_  
 other \_\_\_\_\_

b. Structural System  
 masonry \_\_\_\_\_  
 frame X \_\_\_\_\_  
 log \_\_\_\_\_  
 metal \_\_\_\_\_  
 other \_\_\_\_\_  
 foundation concrete  
covered or poured  
concrete

c. Roofing Material  
 wood \_\_\_\_\_  
 metal (standing seam)  
 slate \_\_\_\_\_  
 tile \_\_\_\_\_  
 asphalt \_\_\_\_\_  
 composition \_\_\_\_\_  
 other \_\_\_\_\_

d. Associated Structures (use/type):  
 outbuildings none  
 \_\_\_\_\_  
 dependencies attached superintendant's  
house, connected to poor house by a  
porch.  
 other \_\_\_\_\_  
 \_\_\_\_\_  
 \_\_\_\_\_

e. Integrity (include dates):  
original site/relocated \_\_\_\_\_  
 \_\_\_\_\_  
 alterations \_\_\_\_\_  
 \_\_\_\_\_  
 additions \_\_\_\_\_  
 \_\_\_\_\_  
 \_\_\_\_\_

f. Condition:  
 excellent X \_\_\_\_\_  
 good \_\_\_\_\_  
 fair \_\_\_\_\_  
 deteriorated \_\_\_\_\_  
 abandoned \_\_\_\_\_

g. Threats:

10. SIGNIFICANCE (use attachment sheet if necessary)

a. Architect/Builder/Engineer:  
 \_\_\_\_\_  
 \_\_\_\_\_  
 b. Style/Period: Ca. 1900  
 \_\_\_\_\_  
 c. Date(s): \_\_\_\_\_  
 \_\_\_\_\_

The 281 acre farm upon which this large house stands was acquired by Pendleton County in 1882 and 1886. The present house appears to date from ca. 1900. It is a long, seven bay frame structure with a hipped roof. It is significant historically for its association with the conduct of county government and for social/humanitarian concerns as administered through the local governmental agencies.

11. BIBLIOGRAPHY:

Adapted from survey documentation compiled by Nan Stevens, Region VIII Planning and Development Council, Petersburg, WV. 1983.

12. FORM PREPARED BY Paula S. Reed DATE September 1984

a. Address 207 S. Potomac Street, Hagerstown, MD 21740  
 b. Organization Preservation Associates, Inc.  
 c. Phone no. (301) 791-7880

MAY 29 1985

ATTACHMENT TO HISTORIC PROPERTIES INVENTORY FORM

HISTORIC PRESERVATION UNIT  
DEPARTMENT OF CULTURE & HISTORY  
THE CULTURAL CENTER  
CHARLESTON, WEST VIRGINIA 25305

1. Name(s) Historic/Common: Pendleton County Poor Farm

(#10. Significance, continued)

Architecturally, this multi-unit dwelling is derived from the American foursquare style, a popular form in the early 20th century in the South Branch Valley and throughout the United States. Except for the large size of the house, the architecture of the building is of secondary importance. Its primary significance, derives from its humanitarian contribution to the social history of Pendleton County. Illustrated by this large dwelling is a turn-of-the-century period social program developed by the county to provide shelter for indigents in exchange for their work on the farm. The farm was intended to be self sufficient, and as far as can be determined, operated in that manner until its operation ceased later in the 20th century.

4. Mr. Mike Munley  
Route 220  
Upper Tract, WV 26866

PARISH FARM/M & M RANCH

Plan:

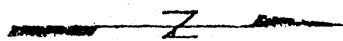
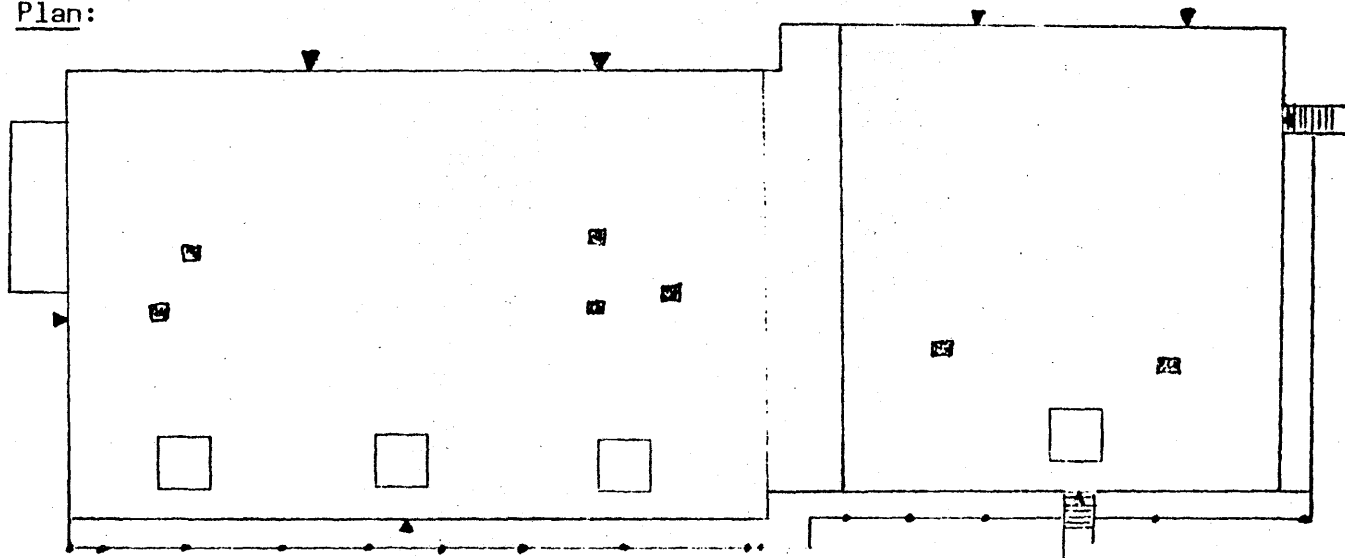

Locale/Environment:

