

OMB NO. 1024-0018
EXP. 12/31/84

United States Department of the Interior
National Park Service

National Register of Historic Places
Inventory—Nomination Form

See instructions in *How to Complete National Register Forms*
Type all entries—complete applicable sections

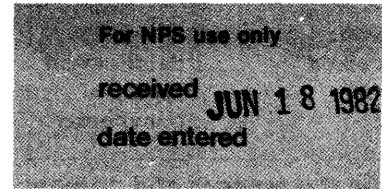

1. Name

historic Christ Episcopal Church

and/or common same

2. Location

street & number 206 South Locust n/a not for publication

city, town Bastrop n/a vicinity of congressional district

state LA code 22 county Morehouse Parish code 067

3. Classification

Category	Ownership	Status	Present Use
<input type="checkbox"/> district	<input type="checkbox"/> public	<input checked="" type="checkbox"/> occupied	<input type="checkbox"/> agriculture
<input checked="" type="checkbox"/> building(s)	<input checked="" type="checkbox"/> private	<input type="checkbox"/> unoccupied	<input type="checkbox"/> commercial
<input type="checkbox"/> structure	<input type="checkbox"/> both	<input type="checkbox"/> work in progress	<input type="checkbox"/> educational
<input type="checkbox"/> site	Public Acquisition	Accessible	<input type="checkbox"/> entertainment
<input type="checkbox"/> object	n/a in process	<input checked="" type="checkbox"/> yes: restricted	<input type="checkbox"/> government
	n/a being considered	<input type="checkbox"/> yes: unrestricted	<input type="checkbox"/> industrial
		<input type="checkbox"/> no	<input type="checkbox"/> military
			<input type="checkbox"/> museum
			<input type="checkbox"/> park
			<input checked="" type="checkbox"/> private residence
			<input type="checkbox"/> religious
			<input type="checkbox"/> scientific
			<input type="checkbox"/> transportation
			<input type="checkbox"/> other:

4. Owner of Property

name Christ Episcopal Church

street & number 206 S. Locust

city, town Bastrop n/a vicinity of state LA 71220

5. Location of Legal Description

courthouse, registry of deeds, etc. Morehouse Parish Courthouse

street & number Clerk of Court's Office (no specific mailing address) Courthouse located on square bounded by Madison, Washington, Franklin, and Jefferson Sts. (no specific street address). 71220
city, town Bastrop state LA

6. Representation in Existing Surveys

title LA Historic Sites Survey has this property been determined eligible? yes no

date 1982 federal state county local

depository for survey records LA State Historic Preservation Office

city, town Baton Rouge state LA

7. Description

Condition

excellent
 good
 fair

deteriorated
 ruins
 unexposed

Check one

unaltered
 altered

Check one

original site
 moved date n/a

Describe the present and original (if known) physical appearance

The Christ Episcopal Church is a late nineteenth century Victorian Gothic frame church located in a residential area of Bastrop. Apart from an adjacent parish hall connected by a breezeway and the replacement of the original windows with stained glass memorials, the building is virtually in its original condition.

The building has a cruciform plan with four corner entrances. The main entrance is set in a square corner tower with a pyramid roof. Each of the four arms of the cruciform plan church terminates in an angular gable. Ancillary corner entrances are set in shed roof extensions to the building mass. Most of the exterior corners of the building are articulated with pairs of false buttresses set at right angles to each other. All of the fenestration is tall and narrow in proportion with triangular tops which are cut to resemble pointed arches. The entire exterior is sheathed in narrow gauge clapboards.

The interior features an auditorium style church plan. The interior space derives its elaborate spatial character from the intersection of the building's two pitched roofs and from the four corner alcoves which contain the corner entrances. Each of these alcoves is set beneath a pair of straight sided pointed arches similar to the window tops. The complex and angular character of the interior is enhanced by the use of dark walnut stained narrow gauge wainscoting nailed at different angles. Other interior features include a rood screen, four panel doors, a pipe organ, and stained glass windows. Apparently the original windows were composed of diamond shaped glass panes. However, they were replaced through the years by stained glass memorials. The original size and shape was not changed.

The only major change since the church was constructed has been the addition of a c.1950 parish hall which is connected to the rear of the church by a covered walkway. This has had little effect upon the appearance of the church.

Minor changes include the addition of a single metal awning and the reworking of the entrance door area at the point where the walkway joins the church (Photo 1). Again, these changes have had a negligible effect upon the building's outward and inward appearance.

8. Significance

Period	Areas of Significance—Check and justify below			
<input type="checkbox"/> prehistoric	<input type="checkbox"/> archeology-prehistoric	<input type="checkbox"/> community planning	<input type="checkbox"/> landscape architecture	<input type="checkbox"/> religion
<input type="checkbox"/> 1400–1499	<input type="checkbox"/> archeology-historic	<input type="checkbox"/> conservation	<input type="checkbox"/> law	<input type="checkbox"/> science
<input type="checkbox"/> 1500–1599	<input type="checkbox"/> agriculture	<input type="checkbox"/> economics	<input type="checkbox"/> literature	<input type="checkbox"/> sculpture
<input type="checkbox"/> 1600–1699	<input checked="" type="checkbox"/> architecture	<input type="checkbox"/> education	<input type="checkbox"/> military	<input type="checkbox"/> social/ humanitarian
<input type="checkbox"/> 1700–1799	<input type="checkbox"/> art	<input type="checkbox"/> engineering	<input type="checkbox"/> music	<input type="checkbox"/> theater
<input checked="" type="checkbox"/> 1800–1899	<input type="checkbox"/> commerce	<input type="checkbox"/> exploration/settlement	<input type="checkbox"/> philosophy	<input type="checkbox"/> transportation
<input type="checkbox"/> 1900–	<input type="checkbox"/> communications	<input type="checkbox"/> industry	<input type="checkbox"/> politics/government	<input type="checkbox"/> other (specify)
		<input type="checkbox"/> invention		

Specific dates 1897 **Builder/Architect** unknown

Statement of Significance (In one paragraph) Criterion C

The Christ Episcopal Church is locally significant in the area of architecture as an architectural landmark in the town of Bastrop. Although Bastrop is an old community and the seat of Morehouse Parish, it has only a modest collection of pre-1930 structures, both in terms of numbers and in terms of architectural distinctiveness.* The architectural heritage of Bastrop consists largely of plain turn-of-the-century cottages, bungalows, and innocuous 1920's commercial buildings. There are three major exceptions to this: (1) the Snyder Museum, a 1920's eclectic house; (2) the 1915 Beaux Arts courthouse, and (3) the Christ Episcopal Church (1897). Of these three, the church is the oldest and the only one which represents the Victorian taste. This can be seen in its highly angular Gothic wood frame design. As far as the State Historic Preservation Office knows, it is the finest example of Victorian architecture remaining in Bastrop.

*Bastrop was incorporated in 1852 and has been the Morehouse Parish seat since the parish was created in 1844.

9. Major Bibliographical References

History of Christ Episcopal Church Provided by Mrs. Bert Smith, Church Secretary.
Copy in National Register File, Louisiana State Historic Preservation Office.

10. Geographical Data

Acreege of nominated property approx. 3 acre

Quadrangle name Bastrop, La.

Quadrangle scale 1=62500

UMT References

A

1	5	6	10	11	4	10	10	3	16	2	16	8	17	15
Zone			Easting				Northing							

B

Zone			Easting				Northing							

C

Zone			Easting				Northing							

D

Zone			Easting				Northing							

E

Zone			Easting				Northing							

F

Zone			Easting				Northing							

G

Zone			Easting				Northing							

H

Zone			Easting				Northing							

Verbal boundary description and justification

Please refer to sketch map.

List all states and counties for properties overlapping state or county boundaries

state	code	county	code
n/a			

state	code	county	code
-------	------	--------	------

11. Form Prepared By

name/title Mrs. Bert Smith, Secretary

organization Christ Episcopal Church date April 1982

street & number 206 S. Locust St. telephone 318-281-5276

city or town Bastrop state LA 71220

12. State Historic Preservation Officer Certification

The evaluated significance of this property within the state is:

national state local

As the designated State Historic Preservation Officer for the National Historic Preservation Act of 1966 (Public Law 89-665), I hereby nominate this property for inclusion in the National Register and certify that it has been evaluated according to the criteria and procedures set forth by the National Park Service.

State Historic Preservation Officer signature

Robert B. DeBlieux

title State Historic Preservation Officer date June 8, 1982

For NPS use only

I hereby certify that this property is included in the National Register.



Keeper of the National Register

date 7/20/82

Attest:
Chief of Registration

date

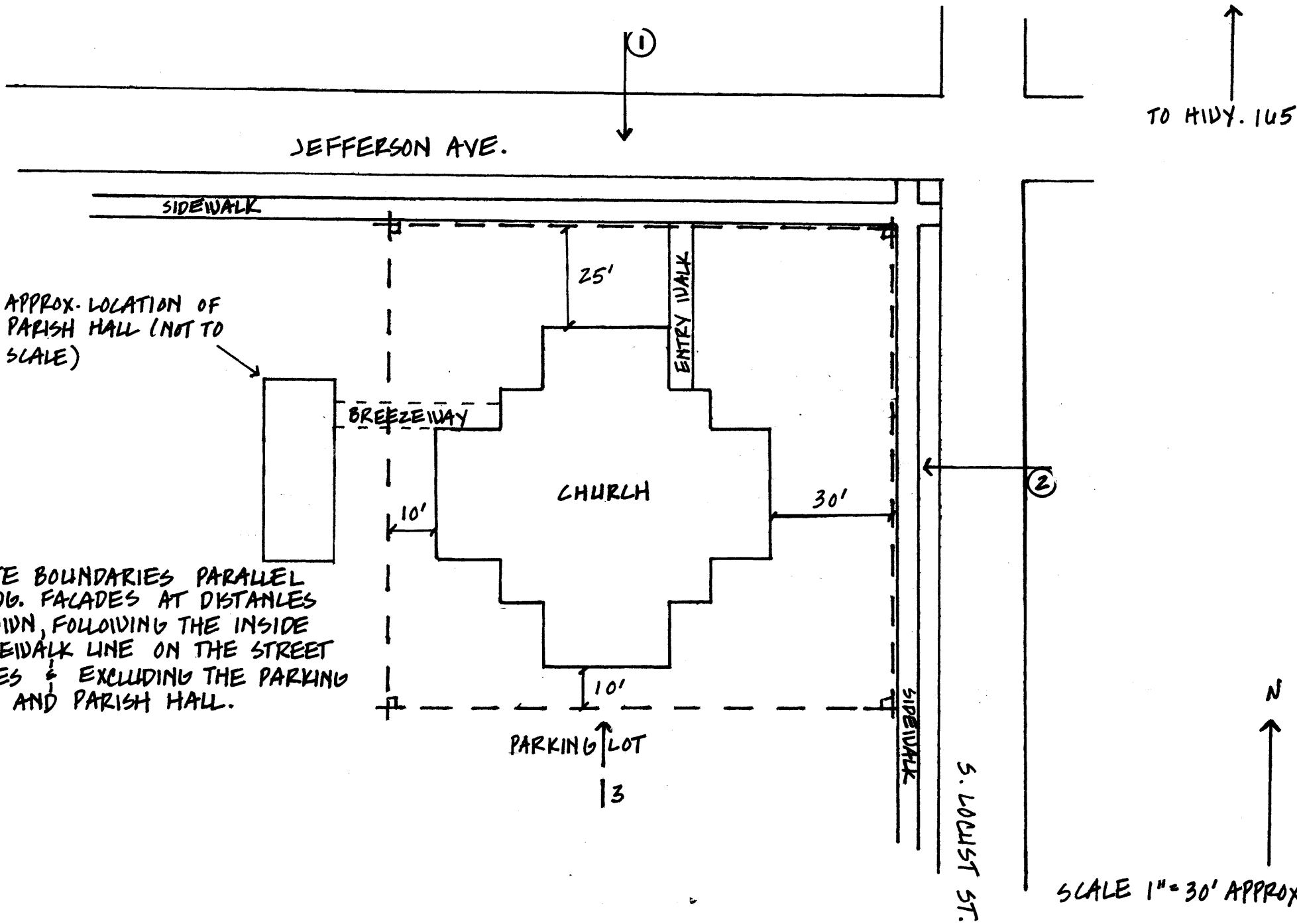
CHRIST EPISCOPAL CHURCH
BASTROP, LOUISIANA



APPROX. LOCATION OF
PARISH HALL (NOT TO
SCALE)

SITE BOUNDARIES PARALLEL
BLDG. FACADES AT DISTANCES
SHOWN, FOLLOWING THE INSIDE
SIDEWALK LINE ON THE STREET
SIDES & EXCLUDING THE PARKING
LOT & PARISH HALL.