

# KENTUCKY HISTORIC RESOURCES INVENTORY

WS-190

Site No. \_\_\_\_\_

1. Historic Name(s) **Round stone smoke house**

Original Owner \_\_\_\_\_

2. Present Name \_\_\_\_\_

3. Location **south side U.S. 150, 1.7 miles east of Nelson County line, near Fredericktown**

4. Owner's Name **Raymond Humes**

5. Owner's Address **Route #2, Springfield, Kentucky 40069**

6. Open to Public Yes  No  X

7. Ownership Private  X Local  State  Federal

8. Site Plan with North Arrow  
*attached*

9. Architect/Builder \_\_\_\_\_

10. Date *mid 19th C.*  A.  B.

11. Style *mid 19th Vernacular*  A.  B.

12. Original Use **Smoke House**  C.

13. Present Use **Smoke House**

14. Condition **Good**  B.

15. Stories, No. of \_\_\_\_\_

16. Description  
**Round stone smoke house; masonry of untooled stones in broken courses; pointed roof; batten door. Rafters and joinery not inspected; vents of concrete block (added?). Located in yard of vernacular frame house sheathed in aluminum. Other buildings were not inspected (pouring rain).**

*House is leaning out of plumb, T. plumb.*

(Continue on Back)

17. Single Pile \_\_\_\_\_  NA.  X Double Pile \_\_\_\_\_

18. Floor Plan **N/A**

19. Structural Fabric **Stone** A.  B.

20. Decorative Fabric **Stone** A.  B.

21. Roof Form & Material **Pointed, conical**

22. Foundation Material **Stone**

23. Outbuildings **N/A**

24. Alterations  Additions   
 Moved  Wall Treatment

25. History \_\_\_\_\_

26. Significance  
**Only known round stone smoke house in Kentucky outside the German settlement in Northern Kentucky.**

27. Source of Information  
**Observation**

28. ADD/County **Washington**

29. U.S.G.S. Quadrant (15'/75') **Maud**    G.I.S. Mod. \_\_\_\_\_

30. UTM Reference  
**16** **648410** **4180205**  
Zone Easting Northing

31. Coordinate Accuracy

32. Prehistoric Site \_\_\_\_\_ Object \_\_\_\_\_  
Historic Site \_\_\_\_\_ Structure \_\_\_\_\_  
(Building) \_\_\_\_\_ Other \_\_\_\_\_

33. National Register District Name: *Early Stone Buildings*

34. Significance of Evaluation

35. Status \_\_\_\_\_ Date \_\_\_\_\_

National Landmark	<input type="checkbox"/>
National Register	<input type="checkbox"/>
Landmark Certificate	<input type="checkbox"/>
Kentucky Survey	<input type="checkbox"/>
Local Landmark	<input type="checkbox"/>
HABS/HAER	<input type="checkbox"/>

36. Historic Theme  
Primary **Architecture**  C.   
Secondary \_\_\_\_\_  
Other \_\_\_\_\_

37. Endangered Yes  X No

38. ATTACH PHOTO

Roll No. *Stone 13*

Picture No. *27*

Direction *down auto*

39. Prepared by: **Carolyn M. Wooley**

40. Organization **Kentucky Heritage Council**

41. Date **December 1983**

42. Revision Dates \_\_\_\_\_ 43. Staff Review \_\_\_\_\_

**KENTUCKY HISTORIC RESOURCE INVENTORY SUPPLEMENT  
BOUNDARY AND LOCATION INFORMATION**

Historic Property Name round stone smoke house Site # W-190

Multiple Resource/Thematic Nomination Title \_\_\_\_\_

U.T.M. Coordinates - List multiple UTMs if property is ten or more acres.

A. 6 648410 4180205 D. \_\_\_\_\_

B. \_\_\_\_\_ E. \_\_\_\_\_

C. \_\_\_\_\_ F. \_\_\_\_\_

Verbal Boundary Description \_\_\_\_\_ Acreage ca 1/2 acre

Beginning at A where the fence meets the road NE of the house, thence with fence SW to B at the garage, thence to C, N. to D at the road, and E with road to the beginning, containing the frame house and stone smoke house.

Sketch of Site Plan (Showing outbuildings, structures, landscape features and the site boundary as described above.)

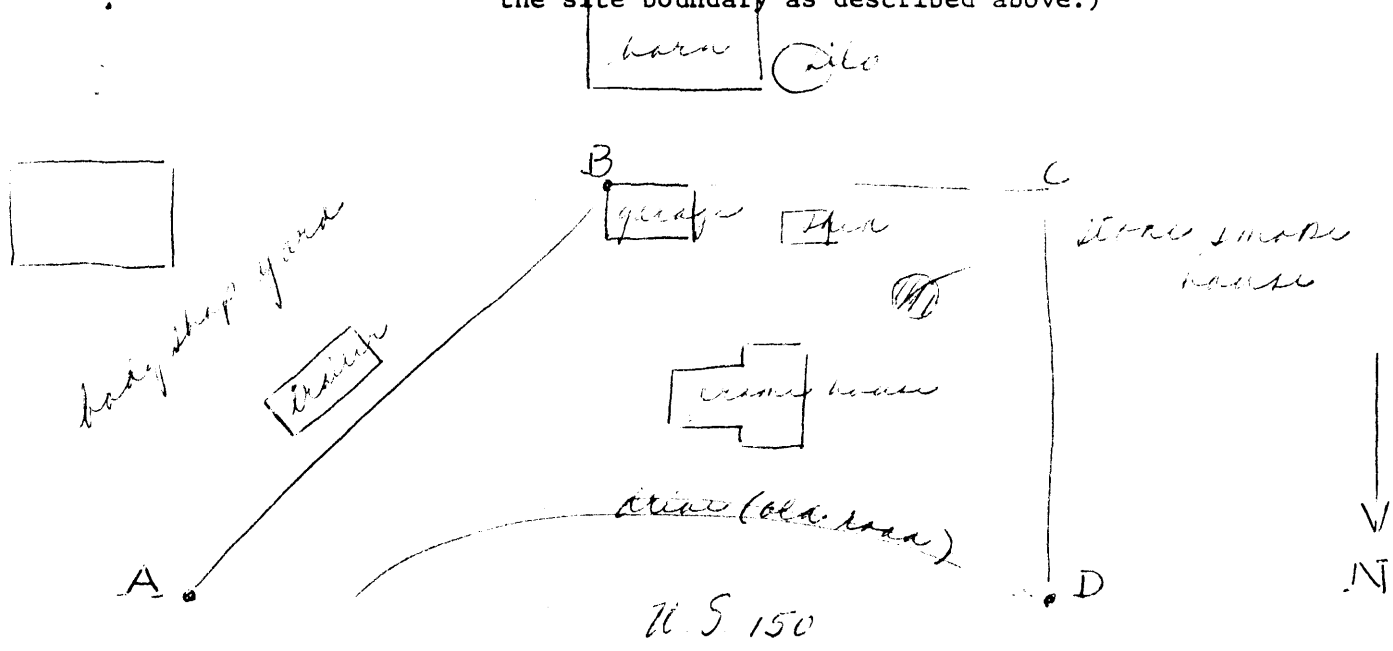

Official Courthouse Property Reference: