

UNITED STATES DEPARTMENT OF THE INTERIOR
NATIONAL PARK SERVICE

FOR NPS USE ONLY
RECEIVED **OCT 16 1979**
DATE ENTERED **MAR 26 1980**

**NATIONAL REGISTER OF HISTORIC PLACES
INVENTORY -- NOMINATION FORM**

SEE INSTRUCTIONS IN *HOW TO COMPLETE NATIONAL REGISTER FORMS*
TYPE ALL ENTRIES -- COMPLETE APPLICABLE SECTIONS

1 NAME

HISTORIC Colorado Southern Railroad Depot

AND/OR COMMON Old Missouri Pacific Railroad Depot

2 LOCATION

STREET & NUMBER Corner of North Avenue G and East Front Street

CITY, TOWN Crowley VICINITY OF 7th - John Breaux
STATE Louisiana CODE 022 COUNTY Acadia CODE 001

3 CLASSIFICATION

CATEGORY	OWNERSHIP	STATUS	PRESENT USE
<input type="checkbox"/> DISTRICT	<input type="checkbox"/> PUBLIC	<input type="checkbox"/> OCCUPIED	<input type="checkbox"/> AGRICULTURE
<input checked="" type="checkbox"/> BUILDING(S)	<input checked="" type="checkbox"/> PRIVATE	<input checked="" type="checkbox"/> UNOCCUPIED	<input type="checkbox"/> MUSEUM
<input type="checkbox"/> STRUCTURE	<input type="checkbox"/> BOTH	<input type="checkbox"/> WORK IN PROGRESS	<input type="checkbox"/> COMMERCIAL
<input type="checkbox"/> SITE	PUBLIC ACQUISITION	ACCESSIBLE	<input type="checkbox"/> EDUCATIONAL
<input type="checkbox"/> OBJECT	<input type="checkbox"/> IN PROCESS	<input checked="" type="checkbox"/> YES: RESTRICTED	<input type="checkbox"/> ENTERTAINMENT
	<input type="checkbox"/> BEING CONSIDERED	<input type="checkbox"/> YES: UNRESTRICTED	<input type="checkbox"/> GOVERNMENT
		<input type="checkbox"/> NO	<input type="checkbox"/> INDUSTRIAL
			<input type="checkbox"/> MILITARY
			<input checked="" type="checkbox"/> OTHER: none

4 OWNER OF PROPERTY

NAME Louisiana Church Interiors, Inc.

STREET & NUMBER P. O. Box 1084

CITY, TOWN Crowley VICINITY OF Louisiana STATE 70526

5 LOCATION OF LEGAL DESCRIPTION

COURTHOUSE, REGISTRY OF DEEDS, ETC. Acadia Parish Courthouse

STREET & NUMBER

CITY, TOWN Crowley STATE Louisiana

6 REPRESENTATION IN EXISTING SURVEYS

TITLE Louisiana Historic Sites Survey

DATE 1979 FEDERAL STATE COUNTY LOCAL

DEPOSITORY FOR SURVEY RECORDS State Historic Preservation Office
CITY, TOWN Baton Rouge STATE Louisiana

7 DESCRIPTION

CONDITION		CHECK ONE	CHECK ONE
<input type="checkbox"/> EXCELLENT	<input type="checkbox"/> DETERIORATED	<input type="checkbox"/> UNALTERED	<input checked="" type="checkbox"/> ORIGINAL SITE
<input type="checkbox"/> GOOD	<input type="checkbox"/> RUINS	<input checked="" type="checkbox"/> ALTERED	<input type="checkbox"/> MOVED DATE _____
<input checked="" type="checkbox"/> FAIR	<input type="checkbox"/> UNEXPOSED		

DESCRIBE THE PRESENT AND ORIGINAL (IF KNOWN) PHYSICAL APPEARANCE

The Colorado Southern Railroad Depot is set next to the rail line near the center of downtown Crowley.

The plan consists of two large square waiting rooms with a ticket booth and pair of restrooms set between them. The waiting rooms are treated with criss-cross beam ceilings which give the effect of coffering, and large arches over the ticket windows.

The brick bearing wall building is covered with stucco which is worked in various ways to achieve architectural effects. For example, over the arched doors and windows, the stucco is worked so as to give the appearance of rusticated voussoirs. The exterior has a somewhat massive and spreading character with features taken mainly from the California Mission Revival. These features include the use of pale stucco and red roofing material and the use of crudely scrolled embrasures and corner pilasters in the tower. The most impressive mission features are the depot's four baroque gables with their inscribed sunburst windows. At one time the tower was surmounted by a pyramid roofed campanile composed of arches with scroll volutes at the corners. Though it has been removed, this feature is slated to be replaced in kind as part of an ongoing restoration of the depot. When this work is complete, the depot will be used as a commercial showroom.

8 SIGNIFICANCE

PERIOD	AREAS OF SIGNIFICANCE -- CHECK AND JUSTIFY BELOW			
<input type="checkbox"/> PREHISTORIC	<input type="checkbox"/> ARCHEOLOGY-PREHISTORIC	<input type="checkbox"/> COMMUNITY PLANNING	<input type="checkbox"/> LANDSCAPE ARCHITECTURE	<input type="checkbox"/> RELIGION
<input type="checkbox"/> 1400-1499	<input type="checkbox"/> ARCHEOLOGY-HISTORIC	<input type="checkbox"/> CONSERVATION	<input type="checkbox"/> LAW	<input type="checkbox"/> SCIENCE
<input type="checkbox"/> 1500-1599	<input type="checkbox"/> AGRICULTURE	<input type="checkbox"/> ECONOMICS	<input type="checkbox"/> LITERATURE	<input type="checkbox"/> SCULPTURE
<input type="checkbox"/> 1600-1699	<input checked="" type="checkbox"/> ARCHITECTURE	<input type="checkbox"/> EDUCATION	<input type="checkbox"/> MILITARY	<input type="checkbox"/> SOCIAL/HUMANITARIAN
<input type="checkbox"/> 1700-1799	<input type="checkbox"/> ART	<input type="checkbox"/> ENGINEERING	<input type="checkbox"/> MUSIC	<input type="checkbox"/> THEATER
<input type="checkbox"/> 1800-1899	<input type="checkbox"/> COMMERCE	<input type="checkbox"/> EXPLORATION/SETTLEMENT	<input type="checkbox"/> PHILOSOPHY	<input checked="" type="checkbox"/> TRANSPORTATION
<input checked="" type="checkbox"/> 1900-	<input type="checkbox"/> COMMUNICATIONS	<input type="checkbox"/> INDUSTRY	<input type="checkbox"/> POLITICS/GOVERNMENT	<input type="checkbox"/> OTHER (SPECIFY)
		<input type="checkbox"/> INVENTION		

SPECIFIC DATES 1907

BUILDER/ARCHITECT C. H. Page, Architect

STATEMENT OF SIGNIFICANCE

The Colorado Southern Railroad Depot is significant in the areas of architecture and transportation. The depot is architecturally significant as a good representative example of a Mission Revival railroad station. It represents an early 20th century fashion for building depots in the Mission Revival style, which was prevalent among railroad companies oriented towards the southwest.

In addition, the California Mission style did not see a significant flowering in Louisiana until the 1920's. Because the Colorado Southern depot was built in 1907, it stands as an extremely early example of the style for the state and, indeed, for the region.

The depot's significance in the area of transportation rests upon its status as the town's foremost reflection of the railroad, which was an important mode of transportation in the area throughout most of the twentieth century. The depot was built in 1907, the same year as the completion of the Eunice to Crowley railroad as part of the Colorado Southern, New Orleans and Pacific line. Later in 1907, the line became part of the Frisco Railroad.

The building was designed by C. H. Page, an architect from Austin, Texas. The contractor was W. C. Whitney of Beaumont, and the cost of construction was about \$15,000.

The railroad was important for both passenger and freight service. "During heavy rice years, you would have two-engine trains with sometimes 200 cars filled with rice waiting to leave," recalled Dorsey Peckham, longtime railroad employee. In the 1930's, the building ceased to be used as a passenger depot, and it was leased to American Legion Post No. 15 for \$1 per year until 1945. For a number of years it served as the local American Legion Home. In 1978, the depot was purchased by the present owners, who plan to restore it and use it as a showroom.

9 MAJOR BIBLIOGRAPHICAL REFERENCES

Fontenot, Maria, "Depot History - Here Since 1907," Crowley Post-Signal (8 Oct. 1978).
 "Will Build Crowley Depot," Crowley Daily Signal (23 Jan. 1908).

10 GEOGRAPHICAL DATA

ACREAGE OF NOMINATED PROPERTY approx. .7 acres

QUADRANGLE NAME _____

QUADRANGLE SCALE _____

UTM REFERENCES

A 15 559100 3341600

B

C

D

E

F

G

H

ZONE EASTING NORTHING

ZONE EASTING NORTHING

VERBAL BOUNDARY DESCRIPTION

LIST ALL STATES AND COUNTIES FOR PROPERTIES OVERLAPPING STATE OR COUNTY BOUNDARIES

STATE	CODE	COUNTY	CODE

STATE	CODE	COUNTY	CODE

11 FORM PREPARED BY

NAME / TITLE Stan J. Gall

ORGANIZATION _____

DATE _____

STREET & NUMBER Louisiana Church Interiors, Inc.

TELEPHONE _____

P. O. Box 1084

317 723-1526

CITY OR TOWN _____

STATE _____

Crowley

Louisiana 70526

12 STATE HISTORIC PRESERVATION OFFICER CERTIFICATION

THE EVALUATED SIGNIFICANCE OF THIS PROPERTY WITHIN THE STATE IS:

NATIONAL

STATE

LOCAL X

As the designated State Historic Preservation Officer for the National Historic Preservation Act of 1966 (Public Law 89-665), I hereby nominate this property for inclusion in the National Register and certify that it has been evaluated according to the criteria and procedures set forth by the National Park Service.

STATE HISTORIC PRESERVATION OFFICER SIGNATURE

E. Bernard Lanie

TITLE

State Historic Preservation Officer

DATE

10/5/79

FOR NPS USE ONLY

I HEREBY CERTIFY THAT THIS PROPERTY IS INCLUDED IN THE NATIONAL REGISTER

DATE

3/26/80

KEEPER OF THE NATIONAL REGISTER

ATTEST:

Beth Garvino
CHIEF OF REGISTRATION

DATE

3/26/80

covered 36.6
88

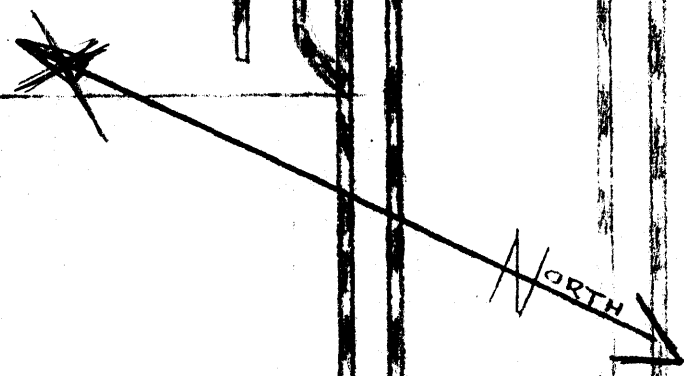

AVENUE G.

FIRST STREET.

FRONT STREET.

PHOTO ①

PHOTO ②

PHOTO ③

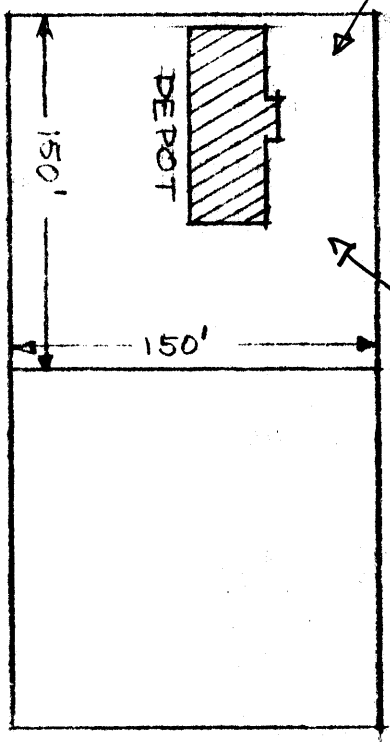

PARKERSON AVENUE

663 YP COLORADO SOUTHERN RR DEPOT
CROWLEY, LOUISIANA