

1314

United States Department of the Interior
National Park Service

National Register of Historic Places
Registration Form

OCT 10 1995

INTERAGENCY RESOURCES DIVISION
NATIONAL PARK SERVICE

This form is for use in nominating or requesting determinations for individual properties and districts. See instructions in How to Complete the National Register of Historic Places Registration Form (National Register Bulletin 16A). Complete each item by marking "x" in the appropriate box or by entering the information requested. If an item does not apply to the property being documented, enter "N/A" for "not applicable." For functions, architectural classification, materials, and areas of significance, enter only categories and subcategories from the instructions. Place additional entries and narrative items on continuation sheets (NPS Form 10-900a). Use a typewriter, word processor, or computer, to complete all items.

1. Name of Property

historic name Loucks Grove Church

other names/site number Wahtawah Christian Church

2. Location

street & number 7 mi. N. of jct. SR 25 and SR 92, 3 mi. E.,
1 1/2 mi. N. on unnamed county road N/A not for publication

city or town Greenfield vicinity

state Iowa code IA county Adair code 001 zip code 50849

3. State/Federal Agency Certification

As the designated authority under the National Historic Preservation Act, as amended, I hereby certify that this nomination request for determination of eligibility meets the documentation standards for registering properties in the National Register of Historic Places and meets the procedural and professional requirements set forth in 36 CFR Part 60. In my opinion, the property meets does not meet the National Register criteria. I recommend that this property be considered significant nationally statewide locally. (See continuation sheet for additional comments.)

Patricia Shenkine 10-3-95
Signature of certifying official/Title Date

State Historical Society of Iowa
State of Federal agency and bureau

In my opinion, the property meets does not meet the National Register criteria. (See continuation sheet for additional comments.)

Signature of certifying official/Title Date

State or Federal agency and bureau

4. National Park Service Certification

I hereby certify that the property is:

- entered in the National Register.
 - See continuation sheet.
- determined eligible for the National Register
 - See continuation sheet.
- determined not eligible for the National Register.
- removed from the National Register.
- other, (explain:)

Edson H. Boal
Signature of the Keeper

11-22-95
Date of Action

Entered in the
National Register

Loucks Grove Church

Name of Property

Adair County, Iowa

County and State

5. Classification

Ownership of Property (Check as many boxes as apply)

- private, public-local, public-State, public-Federal

Category of Property (Check only one box)

- building(s), district, site, structure, object

Number of Resources within Property (Do not include previously listed resources in the count.)

Table with columns: Contributing, Noncontributing, buildings, sites, structures, objects, Total. Values: 1, 1, 0, 0, 0, 0, 1, 1.

Name of related multiple property listing (Enter "N/A" if property is not part of a multiple property listing.)

N/A

Number of contributing resources previously listed in the National Register

0

6. Function or Use

Historic Functions

(Enter categories from instructions)

RELIGION: religious facility

Current Functions

(Enter categories from instructions)

RELIGION: religious facility

WORK IN PROGRESS

7. Description

Architectural Classification

(Enter categories from instructions)

LATE VICTORIAN: Gothic

Materials

(Enter categories from instructions)

foundation STONE: limestone

walls WOOD: weatherboard

roof WOOD: shingles

other BRICK

Narrative Description

(Describe the historic and current condition of the property on one or more continuation sheets.)

8. Statement of Significance

Applicable National Register Criteria

(Mark "x" in one or more boxes for the criteria qualifying the property for National Register listing.)

- A Property is associated with events that have made a significant contribution to the broad patterns of our history.
- B Property is associated with the lives of persons significant in our past.
- C Property embodies the distinctive characteristics of a type, period, or method of construction or represents the work of a master, or possesses high artistic values, or represents a significant and distinguishable entity whose components lack individual distinction.
- D Property has yielded, or is likely to yield, information important in prehistory or history.

Criteria Considerations

(Mark "x" in all the boxes that apply.)

Property is:

- A owned by a religious institution or used for religious purposes.
- B removed from its original location.
- C a birthplace or grave.
- D a cemetery.
- E a reconstructed building, object, or structure.
- F a commemorative property.
- G less than 50 years of age or achieved significance within the past 50 years.

Areas of Significance

(Enter categories from instructions)

ARCHITECTURE

Period of Significance

1895

Significant Dates

1895

Significant Person

(Complete if Criterion B is marked above)

N/A

Cultural Affiliation

Architect/Builder

UNKNOWN

Narrative Statement of Significance

(Explain the significance of the property on one or more continuation sheets.)

9. Major Bibliographical References

Bibliography

(Cite the books, articles, and other sources used in preparing this form on one or more continuation sheets.)

Previous documentation on file (NPS):

- preliminary determination of individual listing (36 CFR 67) has been requested
- previously listed in the National Register
- previously determined eligible by the National Register
- designated a National Historic Landmark
- recorded by Historic American Buildings Survey # _____
- recorded by Historic American Engineering Record # _____

Primary location of additional data:

- State Historic Preservation Office
- Other State agency
- Federal agency
- Local government
- University
- Other

Name of repository:

Loucks Grove Church
Name of Property

Adair County, Iowa
County and State

10. Geographical Data

Acreeage of Property One acre

UTM References

(Place additional UTM references on a continuation sheet.)

1

1	1	5
---	---	---

3	8	3	4	8	0
---	---	---	---	---	---

4	5	8	6	6	0
---	---	---	---	---	---

2

--	--	--	--	--	--

--	--	--	--	--	--

--	--	--	--	--	--

3

--	--	--	--	--	--

--	--	--	--	--	--

--	--	--	--	--	--

4

--	--	--	--	--	--

--	--	--	--	--	--

--	--	--	--	--	--

See continuation sheet

Verbal Boundary Description

(Describe the boundaries of the property on a continuation sheet.)

Boundary Justification

(Explain why the boundaries were selected on a continuation sheet.)

11. Form Prepared By

name/title Letha Maynes

organization Loucks Grove Preservation Society date March 9, 1995

street & number 418 South First Street telephone (515) 743-6222

city or town Greenfield state Iowa zip code 50849

Additional Documentation

Submit the following items with the completed form:

Continuation Sheets

Maps

A USGS map (7.5 or 15 minute series) indicating the property's location.

A Sketch map for historic districts and properties having large acreage or numerous resources.

Photographs

Representative black and white photographs of the property.

Additional items

(Check with the SHPO or FPO for any additional items)

Property Owner

(Complete this item at the request of SHPO or FPO.)

name Loucks Grove Preservation Society

street & number 418 South First Street telephone (515) 743-6222

city or town Greenfield state Iowa zip code 50849

Paperwork Reduction Act Statement: This information is being collected for applications to the National Register of Historic Places to nominate properties for listing or determine eligibility for listing, to list properties, and to amend existing listings. Response to this request is required to obtain a benefit in accordance with the National Historic Preservation Act, as amended (16 U.S.C. 470 et seq.).

Estimated Burden Statement: Public reporting burden for this form is estimated to average 18.1 hours per response including time for reviewing instructions, gathering and maintaining data, and completing and reviewing the form. Direct comments regarding this burden estimate or any aspect of this form to the Chief, Administrative Services Division, National Park Service, P.O. Box 37127, Washington, DC 20013-7127; and the Office of Management and Budget, Paperwork Reductions Projects (1024-0018), Washington, DC 20503.

United States Department of the Interior
National Park Service

**National Register of Historic Places
Continuation Sheet**

Section number 7 Page 1

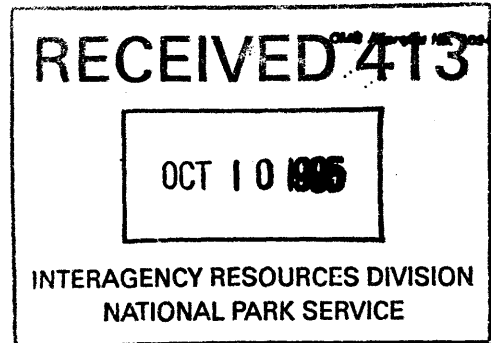

Loucks Grove Church
Adair County, Iowa

Materials

roof ASPHALT

United States Department of the Interior
National Park Service

National Register of Historic Places Continuation Sheet

Section number 7 Page 2

Loucks Grove Church
Adair County, Iowa

DESCRIPTION

Loucks Grove Church is located about eleven and one-half miles northeast of Greenfield, Adair County, Iowa. It faces the west toward the sloping hill of Loucks Grove Cemetery which lies one-quarter mile away. The church can easily be seen from the rocky county road which is 43 feet from the front entrance. The one acre tract on which the church is located still has trees on three sides. Although land cultivation has edged to church property boundaries, a trace of timber remains.

The rectangular structure measures 42 feet 4 inches long by 32 feet 3 inches wide and 31 feet 4½ inches high and sits on a native limestone foundation. The stones are laid together to provide a support which is 22 inches wide and 33 inches tall at the highest point. The cornerstone at the southeast corner bears the date 1895 and a name which is no longer legible. The only entrance is through a vestibule on the west side. The vestibule is 16 feet 3 inches long by 6 feet 6 inches wide and 31 feet 4½ inches high. The 24 foot steep roof of the main structure and the vestibule fall from the 31 foot 4½ inch high peak to the 16 foot sidewalls. Over the original wooden shingles, two layers of composition shingles have been applied. Currently a re-roofing project is underway to remove all the shingles. New wooden shingles are being laid, entirely by hand, to the specifications of the original shingles. The exterior walls are sided with 4 inch lap siding which has been painted white. A re-painting project is now in progress. There are three Gothic style windows on both the north and south sides of the church. Over the double doors in the vestibule is an ogee arch window with ten panes. It is presently being repaired.

The interior of the church is reached through the vestibule which opens to single doors on both the north and south sides of the sanctuary. The ceiling and upper part of the interior walls of the church and vestibule are covered with the original lath and horsehair plaster. Over the plaster is a thin layer of painted finishing plaster. The 16 foot ceiling of the one-room church is rounded to meet the sidewalls and is also

United States Department of the Interior
National Park ServiceNational Register of Historic Places
Continuation SheetSection number 7 Page 3Loucks Grove Church
Adair County, Iowa

DESCRIPTION (continued)

rounded at the corners. Three Gothic style windows are spaced evenly in the south wall as well as three of the same in the north wall. The measurements of the windows are $40\frac{1}{2}$ inches wide by 111 inches long. The pointed arch of each window accounts for 31 inches of the total 111 inch length. Yellow pine is the material used for the door and window frames. Bullseye corner blocks decorate the frames at the upper corners of the doors. The wood surrounding the doors and windows has been stained and varnished. The hardware on all doors is decorated with an intricate design. The lower portions of the walls are lined with 5 inch wide wainscoting which has been stained and varnished. The height of the wainscoting in the vestibule is 59 inches and drops to $45\frac{1}{4}$ inches in the main part of the building. An exception to the $45\frac{1}{4}$ inch height is when it rises to 52 inches directly behind the altar area.

The floors of the choir and altar area are 3 inch wide, dark, unidentified wood; the vestibule floor is $3\frac{1}{4}$ inch unidentified wood. They are all original. The floor in the main part of the sanctuary is made of $3\frac{1}{4}$ inch wide yellow pine. There was a fire in the church in 1960 that damaged the floor of the main part of the sanctuary; the area was replaced at that time. The vestibule floor has been painted, but the rest of the floors of the church are varnished.

In the northeast part of the church is the altar and choir section. The total area is 21 feet 6 inches long by 8 feet 6 inches wide. The choir area accounts for 10 feet 6 inches of the length on the north side. It is reached from the main floor by a $7\frac{1}{2}$ inch riser. The other 11 feet is the altar area which is in the middle of the east wall. The altar area is reached by a $7\frac{1}{2}$ inch riser from the choir section or by two $7\frac{1}{2}$ inch risers from the main part of the church. The remaining 9 feet 10 inches in the overall area is on the south end. There are no interior walls other than the one which divides the sanctuary and the vestibule.

United States Department of the Interior
National Park ServiceNational Register of Historic Places
Continuation SheetSection number 7 Page 4Loucks Grove Church
Adair County, Iowa

DESCRIPTION (continued)

The pews (which are believed to be original) are made of pine and have been stained and varnished. There are 12 center pews which measure 8 feet 10 inches long. The 20 remaining pews are 7 feet 7 inches long and are attached to the side walls. The sidewall pews have only one end; the sides that are attached to the walls have no ends. Both sets of pews have cutout shields attached to each end on the outside. The width of all the pews is 1 foot 4 inches and have a rolled area at the top of the backrest. The armrests on the ends of the pews gently curve downward.

The building is currently in structurally good shape. The foundation needs minor mortar work. The roof is now being replaced. There is moderate water damage to the ceiling in the southeast corner but will not require extensive repair. Raccoon hunters knocked out four holes in the plastered walls, but those too will not require extensive repair.

The only outbuilding on the Loucks Grove Church property is a wooden frame three-hole out house. It is located approximately 20 feet from the northeast corner of the church. The date of construction is not known.

A hitching rail once stood at the east side of the churchyard. It was removed long ago, but plans to replace it are being considered.

Paint, varnish, a ceiling fan and various minor repairs have been made through the years. Electricity was installed August 25, 1957; a propane fueled space heater was added in January, 1961; and the vestibule ceiling has been lowered. There have been no structural changes and the church remains very much as it was on the day of completion in 1895.

United States Department of the Interior
National Park ServiceNational Register of Historic Places
Continuation SheetSection number 8 Page 5Loucks Grove Church
Adair County, Iowa

STATEMENT OF SIGNIFICANCE

Loucks Grove Church is a locally significant example of a Gothic style influenced rural community frame church. It is significant for its being representative of a once common class of rural religious buildings. It is further significant within its county as the sole surviving and unchanged example of its building type.

The churches of 1895 that bore the influence of Gothic style architecture did so in varying ways and degrees. Some had gingerbread detailing under the eaves, gables, and over the front entrance, or patterns cut in the siding. Others decorated the inside doorways with carved designs in the upper door facing. Many of the churches chose a window with an ogee arch which was placed above the front entrance; often the windows were multi-paned. Some rounded the angle where the sidewalls and ceiling met, while others chose door hardware that boasted intricate designs. One or more of the preceding features were some of the usual Gothic influences; however, the most common and obvious feature was pointed arch windows. Loucks Grove incorporated carved door facings, an ogee arch ten pane window, rounded ceiling, decorative hardware, and six windows with pointed arches.

At the close of the year 1895, twenty-nine churches had been erected in Adair County, a rural county in southwest Iowa, during the preceding twenty-four years. Of those twenty-nine, nineteen were of Gothic influence. Today there are only seven of that era and style that have survived. They are: Adair Methodist (town of Adair), Highland Methodist (Prussia Township), Congregational at Hebron (Grand River Township), Greenfield Presbyterian (town of Greenfield), Bridgewater Christian (town of Bridgewater), Zion (Union Township), and Loucks Grove (Jefferson Township). Loucks Grove is the only one that has remained structurally unaltered and its physical integrity intact. The other six have been either moved or considerably altered or both. The additions of wings, entryways, and

United States Department of the Interior
National Park Service

National Register of Historic Places
Continuation Sheet

Section number 8 Page 6

Loucks Grove Church
Adair County, Iowa

STATEMENT OF SIGNIFICANCE (continued)

basements were common alterations.

Early church records of Loucks Grove were destroyed by vandals in the late 1960s, and the only source of information for early years is the newspaper accounts in the Stuart Locomotive. In the September 27, 1895 edition an article appeared that told of interested farmers hauling lumber for the Wahtawah Church (later called Loucks Grove). The building material, both exterior and interior, was most likely ordered through a Stuart, Iowa lumberyard from a universal millwork catalog. That was an ordinary method of obtaining building material during the late 19th century. The foundation is definitely native limestone and was probably quarried from Howe, Iowa which is approximately three miles southeast of the church.

It is not entirely clear if the congregation built the church or if some professional labor was hired. The Stuart Locomotive reported in the January 17, 1896 edition that "the new Wahtawah Church is completed and the carpenters gone home." However, the January 31, 1896 issue of the same newspaper reported "nearly all the labor was donated by the friends." Men of the congregation could probably have constructed the building, but skilled labor was certainly needed in some capacity. For example, a trained backplasterer was surely involved with the interior walls and rounded ceiling corners. The walls and corners are still solid (except for roof leakage damage) after one hundred years.

The architect or builder of the church is not known. The cornerstone of the building bears the date 1895 as well as an illegible name above it. Perhaps it is the name of the architect or builder.

Loucks Grove was free of the \$1000.00 construction cost on the day of dedication, January 26, 1896.

Loucks Grove was a Christian Church from 1895 to 1957, and an

United States Department of the Interior
National Park ServiceNational Register of Historic Places
Continuation SheetSection number 8, 9 Page 7Loucks Grove Church
Adair County, Iowa

STATEMENT OF SIGNIFICANCE (continued)

Independent Church from 1957 to the present. It has been intermittently active during the years and is currently active on a yearly basis only.

Loucks Grove Church stands as the lone example of an unchanged Gothic influenced rural religious building of the late 19th century in Adair County, Iowa. Such buildings represented about two-thirds of the county's churches in 1895. It is a simple, white, frame building that has withstood the test of time and has undergone no structural changes in one hundred years. With the exception of electricity and a propane space heater, it is today as it was then in 1895. The vestibule with its decorative hardware on the doors and an ogee arch window, and the sanctuary with its pointed arch windows and rounded ceiling that exhibit the Gothic influence still show the original design and construction. It is the only church in Adair County with such a distinction.

BIBLIOGRAPHY

Adair County Historical Society. History of Adair County, Iowa. 1976. 75-77, 95, 97, 98, 155, 202-204, 205-208, 252-255, 318-320, 433, 434, 451, 452, 454, 473, 474, 504, 505, 557, 558, 623-625, 650-653.

Kilburn, Lucian M., ed. History of Adair County Iowa and Its People. Chicago: The Pioneer Publishing Company, 1915. 78, 84-87, 89-91.

Stuart Locomotive (newspaper). Stuart, Iowa. September 27, 1895. p. 6, col. 1.

Stuart Locomotive (newspaper). Stuart, Iowa. January 17, 1896. p. 6, col. 3.

United States Department of the Interior
National Park Service

National Register of Historic Places
Continuation Sheet

Section number 9, 10 Page 8

Loucks Grove Church
Adair County, Iowa

BIBLIOGRAPHY (continued)

Stuart Locomotive (newspaper). Stuart, Iowa. January 31, 1896.
p. 6, col. 1.

VERBAL BOUNDARY DESCRIPTION

A tract of land described as follows: Commencing at the Southwest corner of the Southwest Quarter of the Northwest Quarter (SW $\frac{1}{4}$ NW $\frac{1}{4}$) of Section Thirty-five (35), Township Seventy-seven (77) North, Range Thirty-one (31) West of the 5th P.M., thence North fourteen (14) rods, thence East Eleven (11) rods and Eight (8) feet, thence South Fourteen (14) rods, thence West Eleven (11) rods and Eight (8) feet to the place of beginning, containing one acre, more or less, Adair County, Iowa.

VERBAL BOUNDARY JUSTIFICATION

The nominated property includes a one acre parcel on which Loucks Grove Church is located. This land is bounded by a county road to the west. Partition fences separate the church grounds from adjoining property to the north, east and south.

United States Department of the Interior
National Park Service

National Register of Historic Places
Continuation Sheet

Section number _____ Page 9

Loucks Grove Church
Adair County, Iowa

SKETCH MAP



#1 is the only contributing resource.



#2 is the only non-contributing resource. It is a three-hole out house located approximately twenty feet from northeast corner of church. Date of construction is not known.

County rock road is not numbered. See accompanying plat map for location.

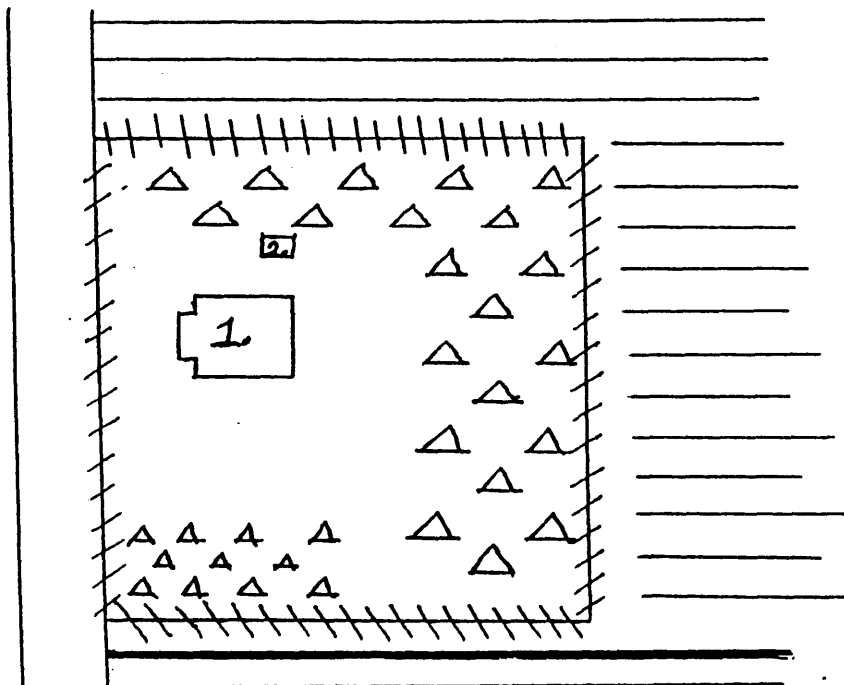
Approximate scale is 1 inch = 80 feet.

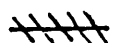

LEGEND:

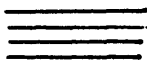
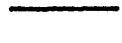
- | | | | |
|---|---------------------|---|----------------|
|  | Property Boundaries |  | Drive to field |
| #1. | Loucks Grove Church |  | Trees |
| #2. | Out House |  | Field |
|  | County Rock Road | | |

United States Department of the Interior
National Park Service

National Register of Historic Places
Continuation Sheet

Section number _____ Page 11

Loucks Grove Church
Adair County, Iowa

PHOTOGRAPHS (2 sets enclosed in separate envelopes)

The following information is common to all photographs submitted:

Loucks Grove Church
Adair County, Iowa
Letha Maynes
January 18, 1995
Letha Maynes, Greenfield, Iowa

View of Loucks Grove Church from the roadway, facing south.
#1

View of Loucks Grove Church and surrounding timber, facing
northeast.
#2

View of Loucks Grove Church from the west. (Window above
entrance is currently being repaired. It has ten panes of
glass).
#4

Interior photograph of Gothic style windows on the north wall
of the church.
#9

Interior of church facing west. The two doors open to the
vestibule.
#10

Interior of church facing east. Note rounded ceiling in the
left corner.
#14

United States Department of the Interior
National Park Service

National Register of Historic Places Continuation Sheet

Section number _____ Page 12

Loucks Grove Church
Adair County, Iowa

PHOTOGRAPHS (continued)

The outside toilet located just north of the church.
#18

United States Department of the Interior
National Park Service

National Register of Historic Places
Continuation Sheet

Section number _____ Page 13

Loucks Grove Church
Adair County, Iowa

FLOOR PLAN

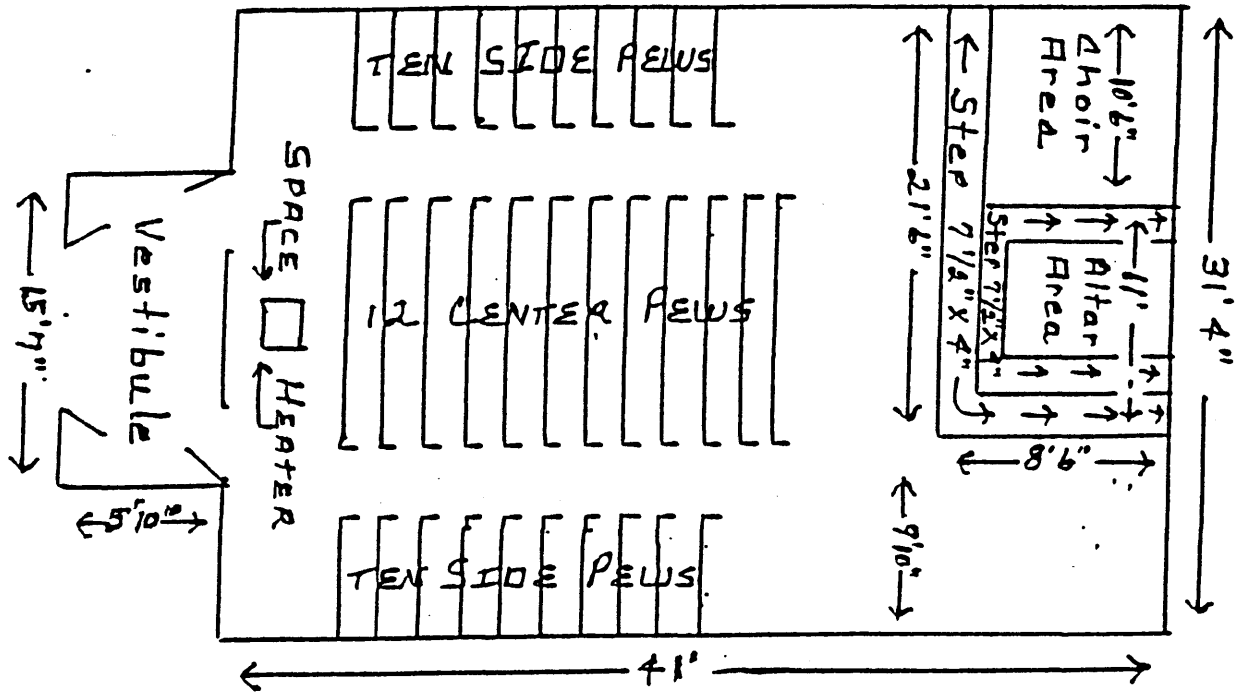

Interior measurements. Not drawn to scale.