

**NATIONAL REGISTER OF HISTORIC PLACES
INVENTORY - NOMINATION FORM**

(Type all entries - complete applicable sections)

STATE: Nebraska	
COUNTY: Gage	
FOR NPS USE ONLY	
ENTRY NUMBER	DATE
MAR 14 1973	MAR 14 1973

1. NAME

COMMON:
Paddock (Algernon S.) House

AND/OR HISTORIC:

2. LOCATION

STREET AND NUMBER:
1401 N. 10th Street

CITY OR TOWN:
Beatrice

STATE: **Nebraska** CODE: **31** COUNTY: **Gage** CODE: **067**

3. CLASSIFICATION

CATEGORY (Check One)	OWNERSHIP	STATUS	ACCESSIBLE TO THE PUBLIC
<input type="checkbox"/> District <input checked="" type="checkbox"/> Building <input type="checkbox"/> Site <input type="checkbox"/> Structure <input type="checkbox"/> Object	<input type="checkbox"/> Public <input checked="" type="checkbox"/> Private <input type="checkbox"/> Both	<input checked="" type="checkbox"/> Occupied <input type="checkbox"/> Unoccupied <input type="checkbox"/> Preservation work in progress	Yes: <input checked="" type="checkbox"/> Restricted <input type="checkbox"/> Unrestricted <input type="checkbox"/> No
PRESENT USE (Check One or More as Appropriate)			
<input type="checkbox"/> Agricultural <input type="checkbox"/> Commercial <input type="checkbox"/> Educational <input type="checkbox"/> Entertainment	<input type="checkbox"/> Government <input type="checkbox"/> Industrial <input type="checkbox"/> Military <input type="checkbox"/> Museum	<input type="checkbox"/> Park <input checked="" type="checkbox"/> Private Residence <input type="checkbox"/> Religious <input type="checkbox"/> Scientific	<input type="checkbox"/> Transportation <input type="checkbox"/> Other (Specify) _____ _____ _____

4. OWNER OF PROPERTY

OWNER'S NAME:
Earl F. Burger

STREET AND NUMBER:
1401 N. 10th Street

CITY OR TOWN: **Beatrice** STATE: **Nebraska** CODE: **31**

5. LOCATION OF LEGAL DESCRIPTION

COURTHOUSE, REGISTRY OF DEEDS, ETC.:
Register of Deeds, Gage County Court House

STREET AND NUMBER:

CITY OR TOWN: **Beatrice** STATE: **Nebraska** CODE: **31**

6. REPRESENTATION IN EXISTING SURVEYS

TITLE OF SURVEY:
Historic Preservation in Nebraska

DATE OF SURVEY: **1971** Federal State County Local

DEPOSITORY FOR SURVEY RECORDS:
Nebraska State Historical Society

STREET AND NUMBER:
1500 "R" Street

CITY OR TOWN: **Lincoln** STATE: **Nebraska** CODE: **31**

SEE INSTRUCTIONS

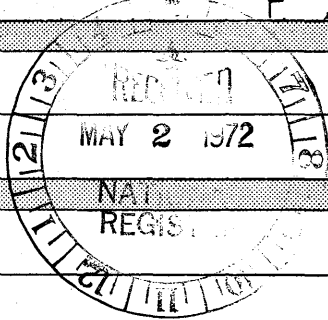

STATE: Nebraska
COUNTY: Gage
ENTRY NUMBER: MAR 14 1973
DATE: MAR 14 1973
FOR NPS USE ONLY

7. DESCRIPTION

CONDITION	(Check One)					
	<input type="checkbox"/> Excellent	<input checked="" type="checkbox"/> Good	<input type="checkbox"/> Fair	<input type="checkbox"/> Deteriorated	<input type="checkbox"/> Ruins	<input type="checkbox"/> Unexposed
	(Check One)			(Check One)		
	<input type="checkbox"/> Altered	<input checked="" type="checkbox"/> Unaltered		<input type="checkbox"/> Moved	<input checked="" type="checkbox"/> Original Site	

DESCRIBE THE PRESENT AND ORIGINAL (if known) PHYSICAL APPEARANCE

The Paddock House, built ca. 1870 is constructed of native limestone. It is free from any attempt at ornamentation except for the projecting keystone and stone window-sills. The house, like many of the more permanent residential structures of this period, 1880's, is best characterized as vernacular architecture.

The roof is gabled with a very simple treatment of the eaves-line. The upper story projects into the roof area making the house one and a half stories.

The house is composed of two volumes. A large volume sets to the south and a smaller set-back portion sets to the north. The larger south portion has been plastered and painted at some date after its original construction. The plaster has cracked in many places which accentuates the areas where the masonry has not withstood the stresses produced by time and uneven foundation settlement. The walls of the smaller set-back section have no visible cracks and appear to be relatively unweathered. A small frame, porch-like structure now connects to the rear of the small section.

Governor Paddock built the house in 1870 but did not move into it until 1873, when he took permanent residence in Beatrice. In ca. 1873 a brick addition was constructed which connected to the south of the side of the house. This addition was L shaped and contained a kitchen and a large dining area. Through the years Beatrice grew to the north and in 1927 when 10th street extended through the Paddock addition of Beatrice, the brick addition had to be torn down because it projected too close to the street. The house now stands in its original form.

When the house was originally built it was situated to the rear of its grounds, serving as a farm house. The entrance was oriented toward the west with an access drive from 9th street. After the town had expanded out to the house and it became a part of the residential district, the entrance changed orientation to 10th street which is the east side of the house.

The house has remained unaltered except for the south brick addition which was torn down in 1927. It has survived relatively well and until 1968 it was occupied as a family residence. It is still known throughout the Beatrice area as the Paddock House and reflects an early period in residential development.

SEE INSTRUCTIONS

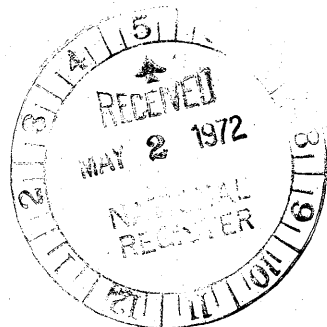

SIGNIFICANCE

PERIOD (Check One or More as Appropriate)

- Pre-Columbian | 16th Century | 18th Century | 20th Century
 15th Century | 17th Century | 19th Century

SPECIFIC DATE(S) (If Applicable and Known)

AREAS OF SIGNIFICANCE (Check One or More as Appropriate)

- | | | | |
|--|---|---|--|
| <input type="checkbox"/> Aboriginal | <input type="checkbox"/> Education | <input checked="" type="checkbox"/> Political | <input type="checkbox"/> Urban Planning |
| <input type="checkbox"/> Prehistoric | <input type="checkbox"/> Engineering | <input type="checkbox"/> Religion/Philosophy | <input type="checkbox"/> Other (Specify) |
| <input type="checkbox"/> Historic | <input type="checkbox"/> Industry | <input type="checkbox"/> Science | |
| <input type="checkbox"/> Agriculture | <input type="checkbox"/> Invention | <input type="checkbox"/> Sculpture | |
| <input checked="" type="checkbox"/> Architecture | <input type="checkbox"/> Landscape Architecture | <input type="checkbox"/> Social/Humanitarian | |
| <input type="checkbox"/> Art | <input type="checkbox"/> Literature | <input type="checkbox"/> Theater | |
| <input type="checkbox"/> Commerce | <input type="checkbox"/> Military | <input type="checkbox"/> Transportation | |
| <input type="checkbox"/> Communications | <input type="checkbox"/> Music | | |
| <input type="checkbox"/> Conservation | | | |

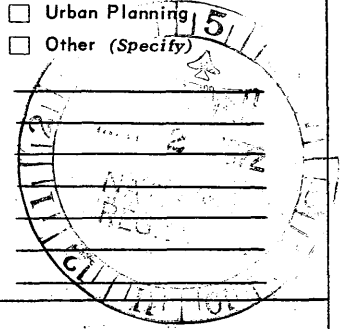

STATEMENT OF SIGNIFICANCE

Algernon Sidney Paddock was born at Glens Falls, New York, November 9, 1830. He died at Beatrice, Nebraska, October 17, 1897. His father, Ira A. Paddock, was a well-known and prominent lawyer of Glen Falls, New York. Algernon S. Paddock attended Union College, latter a university at Schenectady, New York. He was forced to leave the college, upon entering his senior year because of financial affairs. After leaving college Paddock taught school and in his spare time read law. He was admitted to the New York bar and in May, 1857, came to Omaha.

Paddock came to Nebraska at a most opportune time. Nebraska had not yet gained statehood and was in the process of formulating it's political and governmental factions. Paddock was a participant in the organization of the Republican party in Nebraska. He was a delegate to the 1860 Chicago Convention that nominated Lincoln for President. Paddock was nominated Secretary of Nebraska Territory and entering the position on April 1, 1861. While attending his duties as Secretary of the Territory he took an active part in organizing the First Nebraska regiment; bonded the territorial debt, and obtained orders for organizing two companies of cavalry which latter became the Second Nebraska Cavalry. Upon the admission of Nebraska to the Union, March 1, 1867, Mr. Paddock returned from the office of Secretary. *retired (?)*

In 1873 Paddock moved from Omaha to the residence of this nomination, in Beatrice, which was his home for the remainder of his life. In 1875 he was elected United States Senator for Nebraska for a term of six years. In 1882 he was appointed to the very important "Utah Commission" by his friend President Arthur and served the commission until October 1, 1886, when he resigned. Paddock served another term as U.S. Senator for Nebraska from 1887 to 1893.

As a citizen of Beatrice, Senator Paddock was also a driving force in the communities development. He platted and laid out the Fairview and Paddock additions to Beatrice and also through private developments exhibited his interest in the prosperity of the city.

The Paddock House is located in the Paddock addition of Beatrice. Judging from property evaluations and the cornerstone of the house, which is inscribed 1870, the house had already been built when Senator Paddock moved to Beatrice in 1873. A tax evaluation jump from \$1200 in 1872, to

SEE INSTRUCTIONS

9. MAJOR BIBLIOGRAPHICAL REFERENCES

Manuscript Records - Nebraska State Historical Society
 Files - Nebraska State Historical Society

10. GEOGRAPHICAL DATA

LATITUDE AND LONGITUDE COORDINATES DEFINING A RECTANGLE LOCATING THE PROPERTY			OR	LATITUDE AND LONGITUDE COORDINATES DEFINING THE CENTER POINT OF A PROPERTY OF LESS THAN TEN ACRES		
CORNER	LATITUDE	LONGITUDE		LATITUDE	LONGITUDE	
	Degrees Minutes Seconds	Degrees Minutes Seconds		Degrees Minutes Seconds	Degrees Minutes Seconds	
NW	° ' "	° ' "		96° 44' 28"	40° 16' 49"	
NE	° ' "	° ' "				
SE	° ' "	° ' "				
SW	° ' "	° ' "				

NO
LITM
CD

APPROXIMATE ACREAGE OF NOMINATED PROPERTY: one standard lot

LIST ALL STATES AND COUNTIES FOR PROPERTIES OVERLAPPING STATE OR COUNTY BOUNDARIES

STATE:	CODE	COUNTY	CODE

SEE INSTRUCTIONS

11. FORM PREPARED BY

NAME AND TITLE: Persijs Kolberg, Curator of Historic Sites

ORGANIZATION: Nebraska State Historical Society DATE: _____

STREET AND NUMBER: 1500 "R" Street

CITY OR TOWN: Lincoln STATE: Nebraska CODE: 31

12. STATE LIAISON OFFICER CERTIFICATION

As the designated State Liaison Officer for the National Historic Preservation Act of 1966 (Public Law 89-665), I hereby nominate this property for inclusion in the National Register and certify that it has been evaluated according to the criteria and procedures set forth by the National Park Service. The recommended level of significance of this nomination is:

National State Local

Name Marian D. Knecht

Title Director, Nebraska State Historical Society

Date _____

NATIONAL REGISTER VERIFICATION

I hereby certify that this property is included in the National Register.

Robert M. Utley
 Chief, Office of Archeology and Historic Preservation

Date 3/14/73

ATTEST: W. M. [Signature]
 Keeper of The National Register

Date 3-7-73

NATIONAL REGISTER OF HISTORIC PLACES
INVENTORY - NOMINATION FORM

STATE Nebraska	
COUNTY Gage	
FOR NPS USE ONLY	
ENTRY NUMBER	DATE MAR 14 1973

#8. Significance

(Continuation Sheet)

(Number all entries)

\$2300 in 1874, is substantial verification of the south brick addition being made upon Paddock's arrival.

The Paddock House is a very good example of a Nebraska vernacular architecture. While viewed by Senator Paddock's contemporaries, at the time of its construction, as a very handsome and even elegant residence, it remained unpretentious, portraying the quiet dignity of the early successful statesman and businessman of Nebraska.



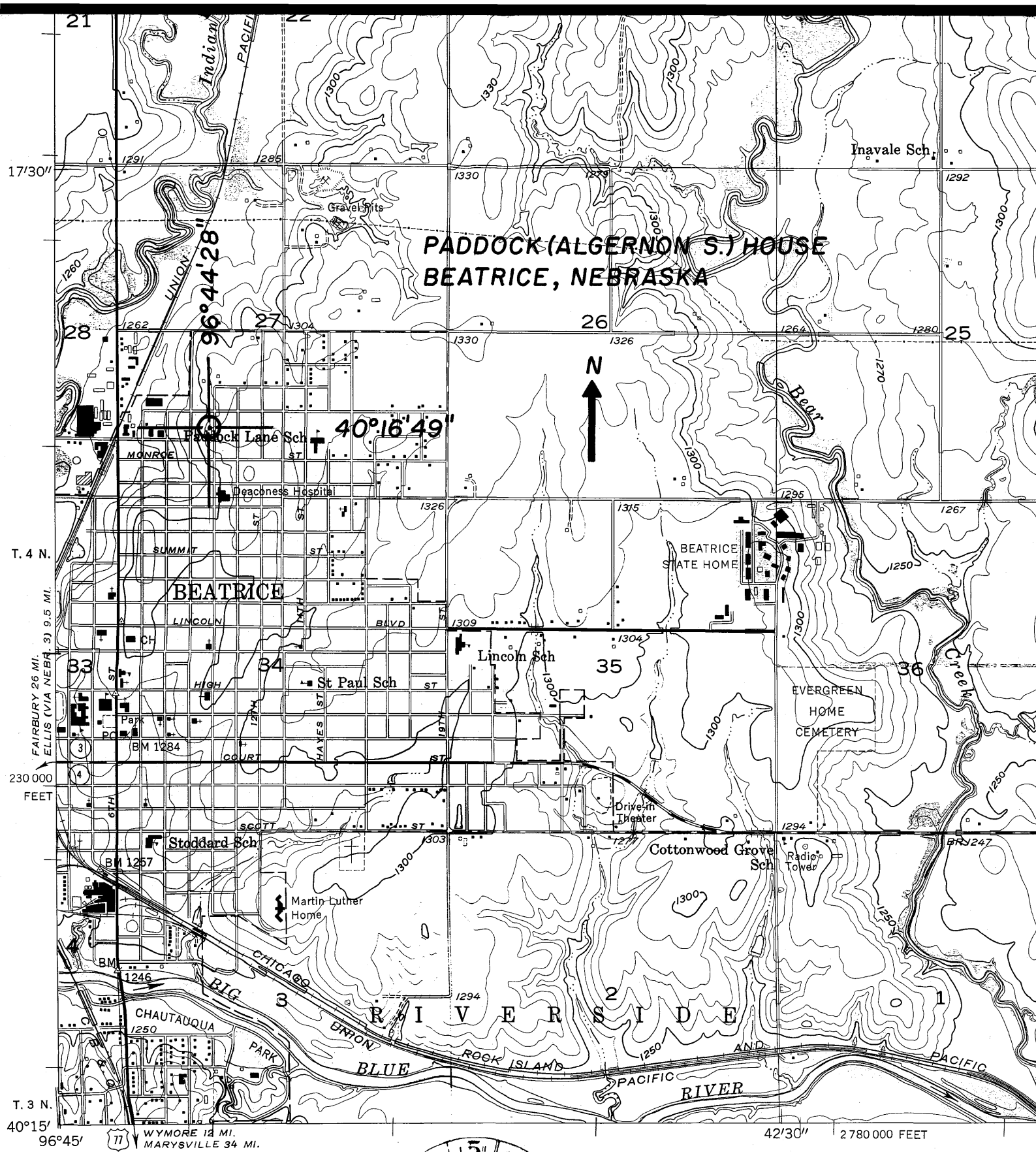

Mapped, edited, and published by the Geological Survey as part of the Department of the Interior program for the development of the Missouri River Basin

Control by USGS and USC&GS

Topography from aerial photographs by photogrammetric methods
Aerial photographs taken 1951. Field check 1957

Polyconic projection. 1927 North American datum
10,000-foot grid based on Nebraska coordinate system, south zone
1000-meter Universal Transverse Mercator grid ticks, zone 14, shown in blue

Red tint indicates area in which only landmark buildings are shown

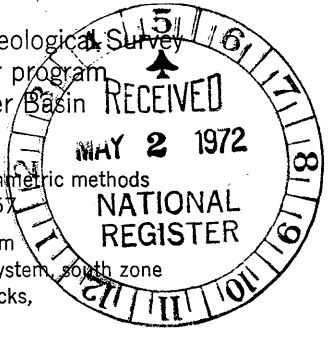

APPROXIMATE MEAN DECLINATION, 1957

TRUE NORTH
MAGNETIC NORTH

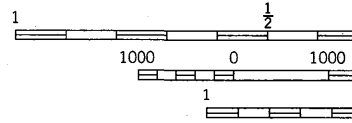

THIS MAP COMPILED BY U. S. GEOLOGICAL SURVEY
FOR SALE BY U. S. GEOLOGICAL SURVEY

Form 10-301
(July 1969)

UNITED STATES DEPARTMENT OF THE INTERIOR
NATIONAL PARK SERVICE

**NATIONAL REGISTER OF HISTORIC PLACES
PROPERTY MAP FORM**

(Type all entries - attach to or enclose with map)

STATE Nebraska	
COUNTY Gage	
FOR NPS USE ONLY	
ENTRY NUMBER	DATE
	MAR 14 1973

SEE INSTRUCTIONS

1. NAME			
COMMON:		Paddock (Algernon S.) House	
AND/OR HISTORIC:			
2. LOCATION			
STREET AND NUMBER:			
1401 N. 10th Street			
CITY OR TOWN:			
Beatrice			
STATE:	CODE	COUNTY:	CODE
Nebraska	31	Gage	067
3. MAP REFERENCE			
SOURCE:			
U.S.G.S., 7½', Beatrice East Quadrangle			
SCALE:			
1:24,000			
DATE:			
1957			
4. REQUIREMENTS			
TO BE INCLUDED ON ALL MAPS			
1. Property boundaries where required.			
2. North arrow.			
3. Latitude and longitude reference.			

