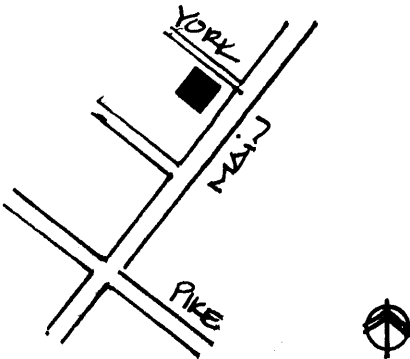
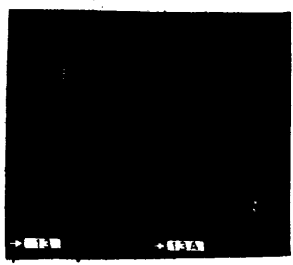

KENTUCKY HISTORIC RESOURCES INVENTORY

Site No. PIP 9

1. Historic Name(s) <input checked="" type="checkbox"/> <b>York House</b> Original Owner <b>Col. John Dils</b>		22. ADD/County <b>BIG SANDY / PIKE</b> <span style="border: 1px solid black; padding: 2px;">098</span>	
2. Present Name <b>York House</b>		23. U.S.G.S. Quadrant (15'/75') <b>Pikeville</b> <span style="border: 1px solid black; padding: 2px;"> </span>	
3. Location <input checked="" type="checkbox"/> <b>Main St. Pikeville, Ky. 41501</b>		24. UTM Reference <span style="border: 1px solid black; padding: 2px;">17</span> <span style="border: 1px solid black; padding: 2px;">365950</span> <span style="border: 1px solid black; padding: 2px;">4149200</span> Zone Easting Northing	
4. Owner's Name <b>Joan Johnson</b>		25. Coordinate Accuracy <span style="border: 1px solid black; padding: 2px;"> </span>	
5. Owner's Address <b>Box 2014 Pikeville, Ky. 41501</b>		26. Prehistoric Site <input type="checkbox"/> Object Historic Site <input type="checkbox"/> Structure <input checked="" type="checkbox"/> Building <input type="checkbox"/> Other	
6. Open to Public Yes <input type="checkbox"/> No <input checked="" type="checkbox"/>	7. Visible from road Yes <input checked="" type="checkbox"/> No <input type="checkbox"/>	8. Ownership <input checked="" type="checkbox"/> Private <input type="checkbox"/> Local <input type="checkbox"/> State <input type="checkbox"/> Federal	
9. Local Contact/Organization <b>PRESERVATION COUNCIL OF PIKE COUNTY, INC.</b>		27. National Register District Name: <b>Multiple Resources of Pikeville</b> <span style="border: 1px solid black; padding: 2px;"> </span>	
10. Site Plan with North Arrow 		28. Significance Evaluation <span style="border: 1px solid black; padding: 2px;"> </span>	
		29. Status <input type="checkbox"/> National Landmark <input type="checkbox"/> National Register <input type="checkbox"/> Landmark Certificate <input type="checkbox"/> Kentucky Survey <input type="checkbox"/> Local Landmark <input type="checkbox"/> HABS/HAER	
		30. Historic Theme Primary <u>Architecture</u> <span style="border: 1px solid black; padding: 2px;">C</span> Secondary <u>Law</u> <span style="border: 1px solid black; padding: 2px;">R</span> Other <u>Appalachian History</u> <span style="border: 1px solid black; padding: 2px;">I I</span>	
18. Description <b>Two story frame house w/ polygonal bay; round arched windows; overhanging eaves w/ brackets; vertical corner boards; one story porch</b>		31. Endangered <input type="checkbox"/>	
(Continue on Back)		32. Preservation Project Status Actual Cost in \$1,000s	
		33. ATTACH PHOTO 	
19. History <b>This house was standing in 1864 when Col. and Mrs. John Dils deeded this house to their daughter Mrs. J.M. (Augusta) York. The Yorks lived here for many years including the years after they built Creekmore. Judge</b>		Roll No. <u>B</u> Picture No. <u>11, 12, 13</u> Direction	
20. Significance <b>Earliest unaltered residence in Pikeville.</b>		34. Prepared by: <b>HELEN POWELL</b>	
21. Source of Information <b>Kathy Burke 1974 Sandborn 1910</b>		35. Organization <b>CARMAN AND POWELL, INC.</b>	
		36. Date <u>3/83</u>	
		37. Revision Dates 38. Staff Review	

Hsi  
History Cont.

York was a prominent man in the community. He served as Judge from 1900-1904. Col. Dils was the commander of the 39th Kentucky Mounted CalInfantry during the Civil War.

KENTUCKY HISTORIC RESOURCE INVENTORY SUPPLEMENT  
BOUNDARY AND LOCATION INFORMATION

Historic Property Name York House Site # PiP 9

Multiple Resource/Thematic Nomination Title Multiple Resources of Pikeville

U.T.M. Coordinates - List multiple UTMs if property is ten or more acres.

A. 17 365950 4149200 D. \_\_\_\_\_

B. \_\_\_\_\_ E. \_\_\_\_\_

C. \_\_\_\_\_ F. \_\_\_\_\_

Verbal Boundary Description \_\_\_\_\_ Acreage .14

From the east corner of the intersection of York Alley and Main Street; then south along the right of way of Main 70 feet to a point; then east 95 feet to a point; then north 65 feet to a point in the right of way of York Alley; then west 95 feet along the right of way of York Alley to the point of beginning and containing the house, stone wall, and cast iron gate.

Sketch of Site Plan (Showing outbuildings, structures, landscape features and the site boundary as described above.)

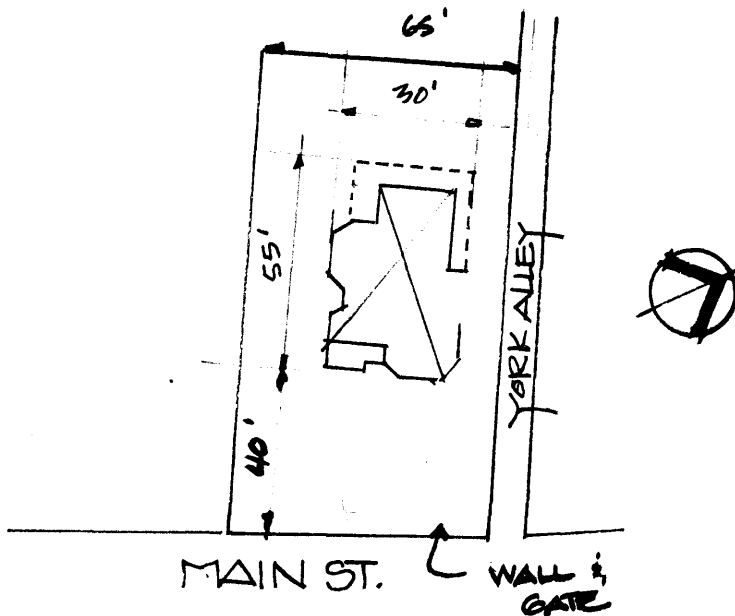

Official Courthouse Property Reference: