

KENTUCKY HISTORIC RESOURCES INVENTORY

Site No. Ob 124

Ruddell

1. Historic Name(s) <i>Miller's house at Ruddell Mills</i>		22. ADD/County <i>Bluegrass / Bourbon</i>	
Original Owner <i>Lease Ruddell and family (Ruddell)</i>		23. U.S.G.S. Quadrant (15'/75') <i>Millersburg</i>	
2. Present Name <i>Ruddell Mills Stone house</i>		24. UTM Reference <i>16 741480 4243140</i>	
3. Location <i>W side of 1940 on N bank of Hayslon Creek</i>		Zone Easting Northing	
4. Owner's Name <i>Leonard Snapp</i>		25. Coordinate Accuracy	
5. Owner's Address <i>Ruddell Mills, Paris, Ky. 40361</i>		26. Prehistoric Site Object Historic Site Structure Building <input checked="" type="checkbox"/> Other	
6. Open to Public Yes <input type="checkbox"/> No <input checked="" type="checkbox"/>	7. Visible from road Yes <input checked="" type="checkbox"/> No <input type="checkbox"/>	8. Ownership Private <input checked="" type="checkbox"/> Local <input type="checkbox"/> State <input type="checkbox"/> Federal <input type="checkbox"/>	
9. Local Contact/Organization		27. National Register District Name:	
10. Site Plan with North Arrow <i>See attached boundary form</i>		28. Significance Evaluation	
11. Architect		29. Status National Landmark <input type="checkbox"/> Date National Register <input type="checkbox"/> Landmark Certificate <input type="checkbox"/> Kentucky Survey <input type="checkbox"/> Local Landmark <input type="checkbox"/> HABS/HAER <input type="checkbox"/>	
12. Builder		30. Historic Theme Primary <i>Architecture</i> <input checked="" type="checkbox"/> C Secondary <i>Settlement</i> <input checked="" type="checkbox"/> K Other <i>mills, distilling</i> <input checked="" type="checkbox"/> N	
13. Date <i>late 18th C.</i> A. <input checked="" type="checkbox"/> B. <input type="checkbox"/>		31. Endangered Yes <input type="checkbox"/> No <input checked="" type="checkbox"/>	
14. Style A. <i>Federal</i> <input checked="" type="checkbox"/> B. <input type="checkbox"/>		32. Preservation Project Status	
15. Original Use <i>residence</i> <input checked="" type="checkbox"/> A. <input type="checkbox"/> B. <input type="checkbox"/>		Actual Cost in \$1,000s	
16. Present use <i>residence</i>		33. ATTACH PHOTO <i>in attached envelope</i>	
17. Condition <i>excellent</i> <input checked="" type="checkbox"/> A. <input type="checkbox"/> B. <input type="checkbox"/>		Roll No. _____ Picture No. _____ Direction _____	
18. Description <i>1 1/2 story 3 bay central hall dry stone house; very good masonry, 9 stone vousssoirs, exterior chimneys each end; windows have pegged frames, oval trim; attic windows flank chimney, 1 window 5 end 1st floor also; cellar entrance</i> (Continue on Back) (over)		34. Prepared by: <i>C.M. Wooley</i>	
19. History <i>Present owner bought from Raymond Yoakell who heired from Bill Mitchellree. In 1877 owned by J. Howard and J. Howard Distillery. Was built by family of pioneer settler (over)</i>		35. Organization	
20. Significance <i>Uncommon 1 story central hall stone house in setting depicting life in an early milling community.</i>		36. Date <i>1982</i>	
21. Source of Information <i>18. inspection 19. Leonard Snapp and De Beers Atlas; Edna Salbath Whitley and Waller Langston</i>		37. Revision Dates 38. Staff Review	

18. cont.:

on S end; log joists in cellar;  
no brasses on cellar windows,  
horizontal diamond bars w mullion;  
cornice returned on front. House has  
ash floors, chair rail (including both  
sides of center hall), paneled jambs,  
one shelf mantel and 1 fine mantel  
w reeded pilasters; winding stair arises  
from rear of center hall w space taken  
from S room; upstairs has small center  
hall w door to each bedroom; 6 panel  
doors.

photo 5

On N end of house is an early  
1 room frame wing w gable roof; to  
the rear is a gabled ell w shed roofed  
porches on each side (one enclosed).  
House painted white. Original stone  
walk in front yard.

House is situated on side of hill  
descending to Hinton Creek, which joins  
Stoner Creek at rear of property and forms  
S fork Licking River. Good rock retaining  
wall built N of house to level house  
site. At rear doorway is grindstone of  
Bill Mitcheltree, blacksmith former  
owner of house. Some of the Ruddle's Mills  
mills & distilleries were located on the creek  
bank S of the house. Property contains  
numerous old dependencies - shop, sheds,  
meat house, chicken house, out houses,  
barns, and later frame house up the hill.

(photos 6, 7)

19. cont.:

Issac Ruddell on land of James Ruddell.

Originally was office for the saw and grist mill operator. Mill dam built 1788.

Became home of Abram Ruddle, who with his brother Stephen had been captured by Indians in 1780 at Ruddle's Fort, adopted by Indians, and married Indian wives. Abram served in War of 1812 after his return to Ky, later moved out west perhaps due to the resentment of the neighbors because of the "considerable number of blanket and feathered relatives of his wife who visited and camped here."

VERBAL BOUNDARY DESCRIPTION & JUSTIFICATION

Beginning at A where hwy 1940 crosses Hickston, thence W with creek bank to near property line at B, thence with line N to C and E to D at the road, thence along road S to the beginning, containing the stone house, shop, chicken house, meat house, barn, and frame house as well as other

SKETCH MAP OF SITE SHOWING BOUNDARIES AND KEY BUILDINGS AND FEATURES WITH NORTH ARROW.

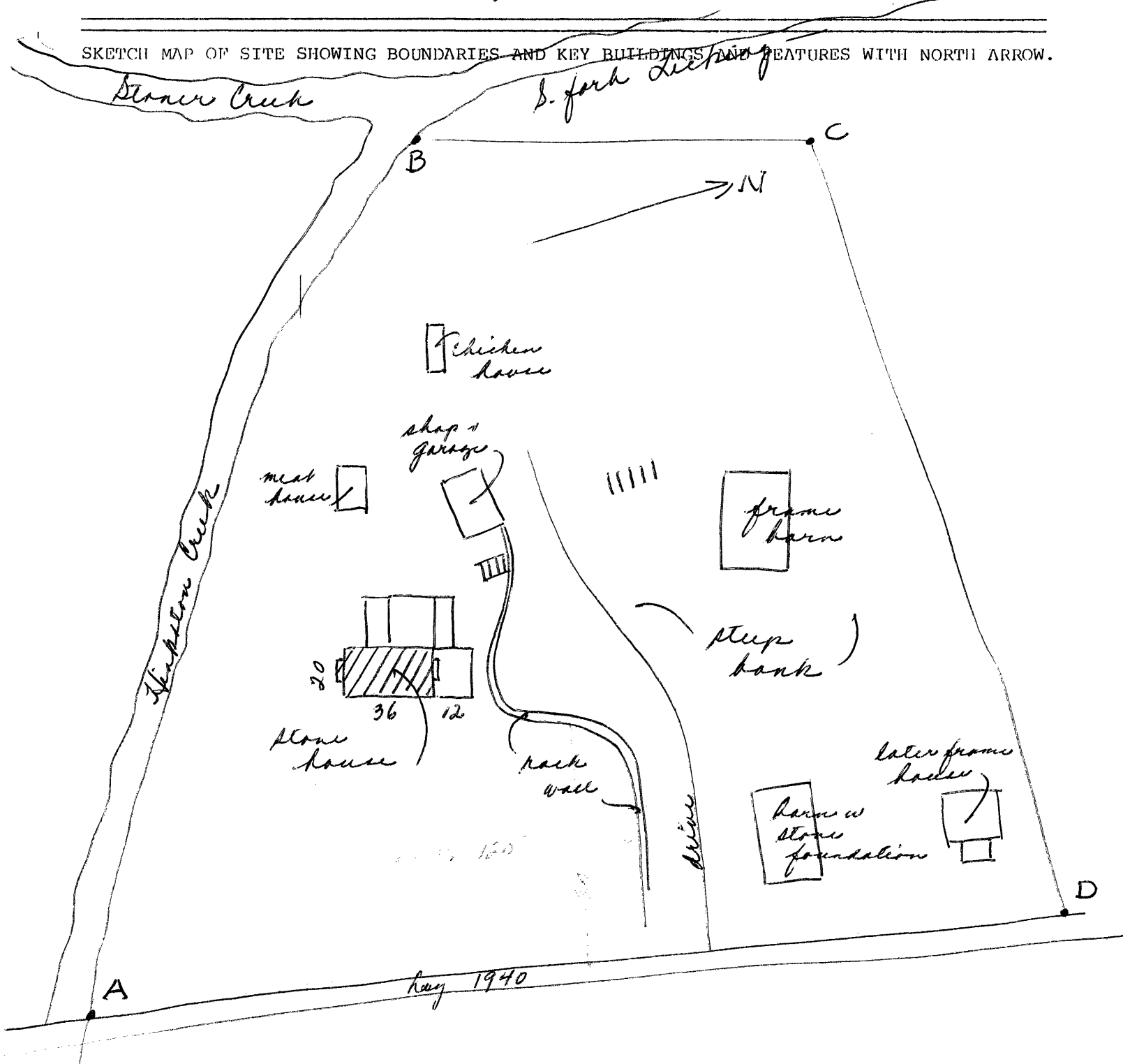

unchartered dependencies - an area of 4 acres

Yards very accurate to land survey  
to be done by - 1/3 acre also included

KENTUCKY HISTORIC RESOURCES INVENTORY

Site No. Ob 124

Ruddell

1. Historic Name(s) <i>Miller's house at Ruddell Mills</i>		22. ADD/County <i>Bluegrass / Bourbon</i>	
Original Owner <i>Lease Ruddell and family (Ruddell)</i>		23. U.S.G.S. Quadrant (15'/75') <i>Millersburg</i>	
2. Present Name <i>Ruddell Mills Stone house</i>		24. UTM Reference <i>16 741480 4243140</i>	
3. Location <i>W side of 1940 on N bank of Hayslon Creek</i>		Zone Easting Northing	
4. Owner's Name <i>Leonard Snapp</i>		25. Coordinate Accuracy	
5. Owner's Address <i>Ruddell Mills, Paris, Ky. 40361</i>		26. Prehistoric Site Object Historic Site Structure Building <input checked="" type="checkbox"/> Other	
6. Open to Public Yes <input type="checkbox"/> No <input checked="" type="checkbox"/>	7. Visible from road Yes <input checked="" type="checkbox"/> No <input type="checkbox"/>	8. Ownership Private <input checked="" type="checkbox"/> Local <input type="checkbox"/> State <input type="checkbox"/> Federal <input type="checkbox"/>	
9. Local Contact/Organization		27. National Register District Name:	
10. Site Plan with North Arrow <i>See attached boundary form</i>		28. Significance Evaluation	
11. Architect		29. Status National Landmark <input type="checkbox"/> Date National Register <input type="checkbox"/> Landmark Certificate <input type="checkbox"/> Kentucky Survey <input type="checkbox"/> Local Landmark <input type="checkbox"/> HABS/HAER <input type="checkbox"/>	
12. Builder		30. Historic Theme Primary <i>Architecture</i> <input checked="" type="checkbox"/> C Secondary <i>Settlement</i> <input checked="" type="checkbox"/> K Other <i>mills, distilling</i> <input checked="" type="checkbox"/> N	
13. Date <i>late 18th C.</i> A. <input checked="" type="checkbox"/> B. <input type="checkbox"/>		31. Endangered Yes <input type="checkbox"/> No <input checked="" type="checkbox"/>	
14. Style A. <i>Federal</i> <input checked="" type="checkbox"/> B. <input type="checkbox"/>		32. Preservation Project Status Actual Cost in \$1,000s	
15. Original Use <i>residence</i> <input checked="" type="checkbox"/> A. <input type="checkbox"/> B. <input type="checkbox"/>		33. ATTACH PHOTO <i>in attached envelope</i>	
16. Present use <i>residence</i>		Roll No. _____ Picture No. _____ Direction _____	
17. Condition <i>excellent</i> <input checked="" type="checkbox"/> A. <input type="checkbox"/> B. <input type="checkbox"/>		34. Prepared by: <i>C.M. Wooley</i>	
18. Description <i>1 1/2 story 3 bay central hall dry stone house; very good masonry, 9 stone vousssoirs, exterior chimneys each end; windows have pegged frames, oval trim; attic windows flank chimney, 1 window 5 end 1st floor also; cellar entrance</i> (Continue on Back) (over)		35. Organization	
No. Stories <i>1 1/2</i> <input checked="" type="checkbox"/> A. <input type="checkbox"/> B. <input type="checkbox"/>		36. Date <i>1982</i>	
Single Pile <input checked="" type="checkbox"/> NA <input type="checkbox"/>		37. Revision Dates	
Double Pile _____		38. Staff Review	
Floor Plan <i>central hall</i> <input checked="" type="checkbox"/> A. <input type="checkbox"/> B. <input type="checkbox"/>			
Structural Fabric <i>stone</i> A. <input checked="" type="checkbox"/> B. <input type="checkbox"/>			
Decorative Fabric <i>vousssoirs</i> A. <input checked="" type="checkbox"/> B. <input type="checkbox"/>			
Roof Form <i>gable</i>			
19. History <i>Present owner bought from Raymond Yoast who heired from Bill Mitchell. In 1877 owned by J. Howard and J. Howard Distillery. Was built by family of pioneer settler (over)</i>			
20. Significance <i>Uncommon 1 story central hall stone house in setting depicting life in an early milling community.</i>			
21. Source of Information <i>18. inspection 19. Leonard Snapp and De Beers Atlas; Edna Salbath Whitley and Waller Langston</i>			

18. cont.:

on S end; log joists in cellar;  
no brasses on cellar windows,  
horizontal diamond bars w mullion;  
cornice returned on front. House has  
ash floors, chair rail (including both  
sides of center hall), paneled jambs,  
one shelf mantel and 1 fine mantel  
w reeded pilasters; winding stair arises  
from rear of center hall w space taken  
from S room; upstairs has small center  
hall w door to each bedroom; 6 panel  
doors.

photo 5

On N end of house is an early  
1 room frame wing w gable roof; to  
the rear is a gabled ell w shed roofed  
porches on each side (one enclosed).  
House painted white. Original stone  
walk in front yard.

House is situated on side of hill  
descending to Hinton Creek, which joins  
Stoner Creek at rear of property and forms  
S fork Licking River. Good rock retaining  
wall built N of house to level house  
site. At rear doorway is grindstone of  
Bill Mitcheltee, blacksmith former  
owner of house. Some of the Ruddle's Mills  
mills & distilleries were located on the creek  
bank S of the house. Property contains  
numerous old dependencies - shop, sheds,  
meat house, chicken house, out houses,  
barns, and later frame house up the hill.

(photos 6, 7)

19. cont.:

Issac Ruddell on land of James Ruddell.

Originally was office for the saw and grist mill operator. Mill dam built 1788.

Became home of Abram Ruddle, who with his brother Stephen had been captured by Indians in 1780 at Ruddle's Fort, adopted by Indians, and married Indian wives. Abram served in War of 1812 after his return to Ky, later moved out west perhaps due to the resentment of the neighbors because of the "considerable number of blanket and feathered relatives of his wife who visited and camped here."



VERBAL BOUNDARY DESCRIPTION & JUSTIFICATION

Beginning at A where hwy 1940 crosses Hinkston, thence W with creek bank to near property line at B, thence with line N to C and E to D at the road, thence along road S to the beginning, containing the stone house, shop, chicken house, meat house, barn, and frame house as well as other

SKETCH MAP OF SITE SHOWING BOUNDARIES AND KEY BUILDINGS AND FEATURES WITH NORTH ARROW.

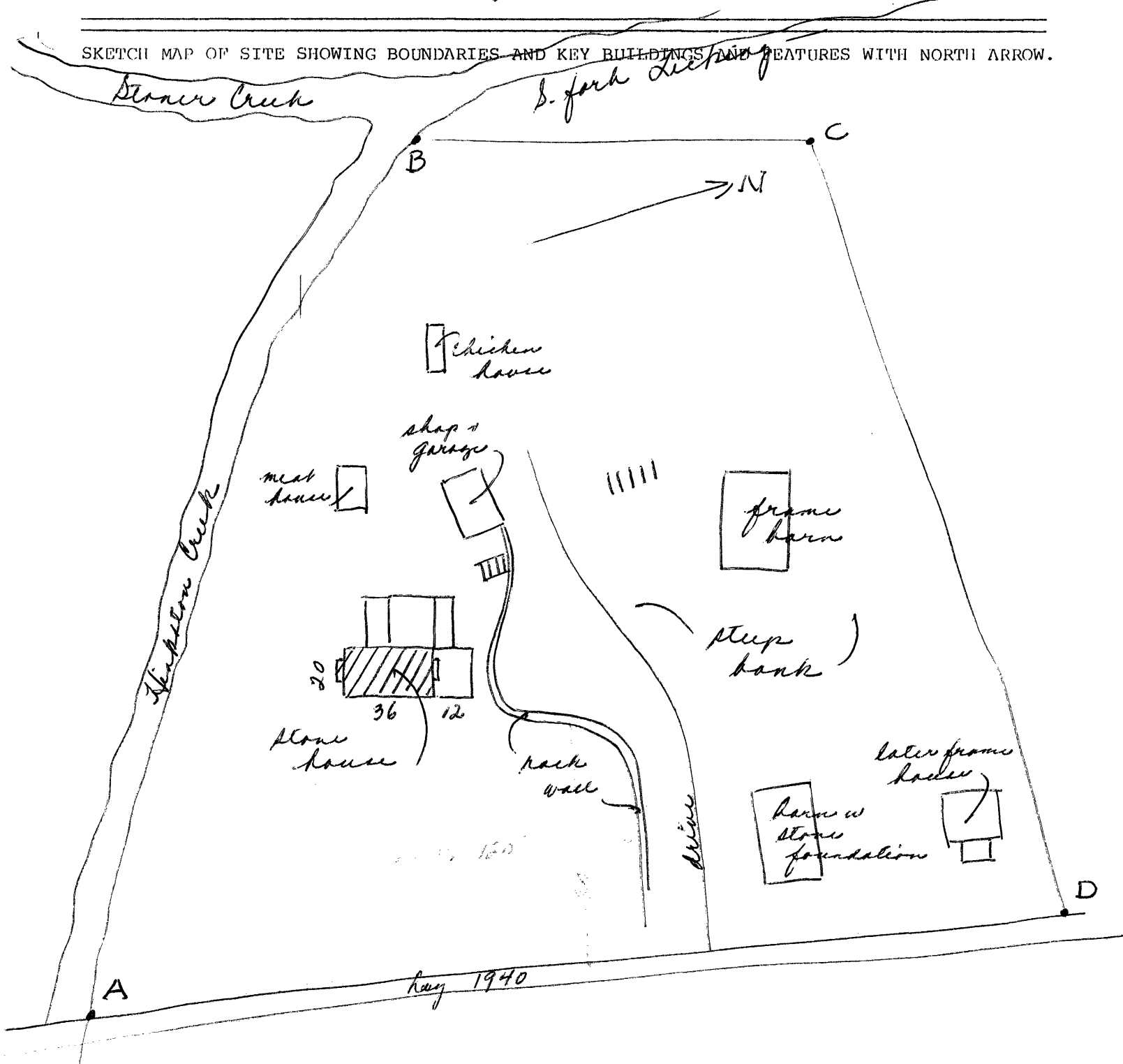

unchartered dependencies - an area of 4 acres

Yards very accurate to land survey  
to be done by - 1/3 acre also included