

United States Department of the Interior  
National Park Service

RECEIVED 413

1272

National Register of Historic Places  
Registration Form

OCT - 5 1995

This form is for use in nominating or requesting determinations for individual properties and districts. See instructions in How to Complete the National Register of Historic Places Registration Form (National Register Bulletin 16A). Complete each item by marking "x" in the appropriate box or by entering the information requested. If an item does not apply to the property being documented, enter "N/A" for "not applicable." For functions, architectural classification, materials, and areas of significance, enter only categories and subcategories from NATIONAL PARK SERVICE entries and narrative items on continuation sheets (NPS Form 10-900a). Use a typewriter, word processor, or computer to complete all items.

1. Name of Property

historic name CEDARS OF LEBANON STATE PARK HISTORIC DISTRICT

other names/site number N/A

2. Location

street & number Cedar Forest Road, Cedars of Lebanon State Park N/A not for publication

city or town Lebanon  vicinity

state Tennessee code TN county Wilson code 189 zip code 37087

3. State/Federal Agency Certification

As the designated authority under the National Historic Preservation Act, as amended, I hereby certify that this  nomination  request for determination of eligibility meets the documentation standards for registering properties in the National Register of Historic Places and meets the procedural and professional requirements set forth in 36 CFR Part 60. In my opinion, the property  meets  does not meet the National Register criteria. I recommend that this property be considered significant  nationally  statewide  locally. ( See continuation sheet for additional comments.)

Herbert L. Hays 10/2/95  
Signature of certifying official/Title Date

Deputy State Historic Preservation Officer, Tennessee Historical Commission  
State of Federal agency and bureau

In my opinion, the property  meets  does not meet the National Register criteria. ( See continuation sheet for additional comments.)

\_\_\_\_\_  
Signature of certifying official/Title Date

\_\_\_\_\_  
State or Federal agency and bureau

4. National Park Service Certification

I hereby certify that the property is:

- entered in the National Register.  See continuation sheet.
- determined eligible for the National Register  See continuation sheet.
- determined not eligible for the National Register.
- removed from the National Register.
- other, (explain): \_\_\_\_\_

Edson M. Beall  
Signature of the Keeper

Date of Action

11.7.95

Name of Property

County and State

**5. Classification**

**Ownership of Property**

(Check as many boxes as apply)

- private
- public-local
- public-State
- public-Federal

**Category of Property**

(Check only one box)

- building(s)
- district
- site
- structure
- object

**Number of Resources within Property**

(Do not include previously listed resources in the count.)

Contributing	Noncontributing	
4	1	buildings
1	0	sites
1	2	structures
0	0	objects
6	3	Total

**Name of related multiple property listing**

(Enter "N/A" if property is not part of a multiple property listing.)

State Parks in Tennessee Built by the  
CCC and WPA, 1934-1942

**Number of contributing resources previously listed  
in the National Register**

0

**6. Function or Use**

**Historic Functions**

(Enter categories from instructions)

RECREATION AND CULTURE: Auditorium  
GOVERNMENT: Park office

**Current Functions**

(Enter categories from instructions)

RECREATION AND CULTURE: Auditorium

**7. Description**

**Architectural Classification**

(Enter categories from instructions)

OTHER: Rustic architecture of the National  
Park Service

**Materials**

(Enter categories from instructions)

foundation STONE

walls LIMESTONE

roof ASPHALT SHINGLES

other WOOD; METAL

**Narrative Description**

(Describe the historic and current condition of the property on one or more continuation sheets.)

See continuation sheets.

**8. Statement of Significance**

**Applicable National Register Criteria**

(Mark "x" in one or more boxes for the criteria qualifying the property for National Register listing.)

- A** Property is associated with events that have made a significant contribution to the broad patterns of our history.
- B** Property is associated with the lives of persons significant in our past.
- C** Property embodies the distinctive characteristics of a type, period, or method of construction or represents the work of a master, or possesses high artistic values, or represents a significant and distinguishable entity whose components lack individual distinction.
- D** Property has yielded, or is likely to yield, information important in prehistory or history.

**Criteria Considerations**

(Mark "x" in all the boxes that apply.)

Property is: N/A

- A** owned by a religious institution or used for religious purposes.
- B** removed from its original location.
- C** a birthplace or grave.
- D** a cemetery.
- E** a reconstructed building, object, or structure.
- F** a commemorative property.
- G** less than 50 years of age or achieved significance within the past 50 years.

**Areas of Significance**

(Enter categories from instructions)

Government/Politics

Recreation/Culture

Social History

\_\_\_\_\_

\_\_\_\_\_

\_\_\_\_\_

**Period of Significance**

1937-1944

\_\_\_\_\_

\_\_\_\_\_

**Significant Dates**

1937

\_\_\_\_\_

\_\_\_\_\_

**Significant Person**

(Complete if Criterion B is marked above)

N/A

**Cultural Affiliation**

N/A

\_\_\_\_\_

\_\_\_\_\_

**Architect/Builder**

Works Progress Administration

National Park Service

**Narrative Statement of Significance**

(Explain the significance of the property on one or more continuation sheets.)

**9. Major Bibliographical References**

**Bibliography**

(Cite the books, articles, and other sources used in preparing this form on one or more continuation sheets.)

**Previous documentation on file (NPS):** N/A

- preliminary determination of individual listing (36 CFR 67) has been requested
- previously listed in the National Register
- previously determined eligible by the National Register
- designated a National Historic Landmark
- recorded by Historic American Buildings Survey # \_\_\_\_\_
- recorded by Historic American Engineering Record # \_\_\_\_\_

**Primary location of additional data:**

- State Historic Preservation Office
- Other State agency
- Federal agency
- Local government
- University
- Other

Name of repository:

\_\_\_\_\_

Name of Property

County and State

**10. Geographical Data**Acreage of Property approximately 3 acres

VINE, TN, 314 SE

**UTM References**

(Place additional UTM references on a continuation sheet.)

1	1 6	5 6 1 8 2 0	3 9 9 3 4 6 0
	Zone	Easting	Northing
2			

3			
	Zone	Easting	Northing
4			

 See continuation sheet**Verbal Boundary Description**

(Describe the boundaries of the property on a continuation sheet.)

**Boundary Justification**

(Explain why the boundaries were selected on a continuation sheet.)

**11. Form Prepared By**name/title Ginger Ramsey and Carroll Van Westorganization MTSU Center for Historic Preservation date July 27, 1995street & number PO Box 80, MTSU telephone 615-898-2947city or town Murfreesboro state TN zip code 37132**Additional Documentation**

Submit the following items with the completed form:

**Continuation Sheets****Maps**A **USGS map** (7.5 or 15 minute series) indicating the property's location.A **Sketch map** for historic districts and properties having large acreage or numerous resources.**Photographs**Representative **black and white photographs** of the property.**Additional items**

(Check with the SHPO or FPO for any additional items)

**Property Owner**

(Complete this item at the request of SHPO or FPO.)

name Commissioner, Tennessee Department of Environment and Conservationstreet & number 401 Church Street telephone 615-532-0446city or town Nashville state TN zip code 37243

**Paperwork Reduction Act Statement:** This information is being collected for applications to the National Register of Historic Places to nominate properties for listing or determine eligibility for listing, to list properties, and to amend existing listings. Response to this request is required to obtain a benefit in accordance with the National Historic Preservation Act, as amended (16 U.S.C. 470 et seq.).

**Estimated Burden Statement:** Public reporting burden for this form is estimated to average 18.1 hours per response including time for reviewing instructions, gathering and maintaining data, and completing and reviewing the form. Direct comments regarding this burden estimate or any aspect of this form to the Chief, Administrative Services Division, National Park Service, P.O. Box 37127, Washington, DC 20013-7127; and the Office of Management and Budget, Paperwork Reductions Projects (1024-0018), Washington, DC 20503.

National Register of Historic Places  
Continuation Sheet

RECEIVED 413

OCT - 5 1995

Section number 7 Page 1

INTERAGENCY RESOURCES DIVISION

NATIONAL PARK SERVICE

Cedars of Lebanon State Park Historic District, Wilson County, TN

VII. Description

The Cedars of Lebanon State Park Historic District, at Cedars of Lebanon State Park in Wilson County, Tennessee, is centered around the park's most scenic natural landmark--Jackson Cave--and the adjacent Cedar Forest Lodge. The park's built environment of roads, trails, structures, and buildings largely dates to the era of its initial construction by the Civilian Conservation Corps and the Works Progress Administration during the late 1930s. The district includes the Cedar Forest Lodge, a stone storage building, a system of trails leading to Jackson Cave, and two Rustic-style overlooks, all built by the Works Progress Administration in 1937, as well as a stone water fountain, added by the State of Tennessee in 1944. The integrity of the nominated area, which is shaped like a rectangle and contains approximately three acres, is intact and conveys well the aspects of New Deal landscapes associated with the public parks developed in the 1930s.

The Cedar Forest Lodge lies in the northern half of the district. It is built of rough-cut locally quarried limestone in an interpretation of the Rustic Style, a stylistic interpretation promoted by the National Park Service as appropriate for park buildings. It has a cross-shaped floor plan and a cross-gabled roof covered by asphalt shingles. The pediment of each gable is constructed of stained rough-hewn cedar logs. Stone entry steps lead to all exterior doors that are made of stained board-and-batten cedar, with "X"-shaped cedar trim on the bottom panels and one small cedar-framed window centered on the top panels. All of the windows have limestone sills while above each door and window are plain cedar lintels. All of the doors are cedar batten doors. All exterior doors and windows are 1980s replacements, which approximate the originals, except for the three sets of original doors at the primary center gable entrance. Also reflecting an interpretation of Rustic Style, these replacement doors are compatible with the architecture of the building.

The north facade is dominated by a projecting gable with double doors centered between two single doors. The eastern corner of the gable has a stone block at the foundation; the block states "Cedar Forest Lodge 1937." The pediment of the gable has a small centered cedar-framed metal vent.

United States Department of the Interior  
National Park Service

# National Register of Historic Places Continuation Sheet

Section number 7 Page 2

Cedars of Lebanon State Park Historic District, Wilson County, TN

To the west of the projecting gable is a cedar door, which is located between two eight light casement windows. Above the door is a transom window.

To the east of the projecting gable are three closely-aligned cedar doors, which are separated only by thin sections of limestone. East of the doors are two eight-over-one double-hung sash windows.

The east elevation is a gable end with two paired eight light casement windows that are separated by one door. There is another door to the north of the windows. The gable has a paired three light casement window centered on the second floor.

The south elevation includes a projecting gable with a centered small cedar-framed metal vent on its pediment. Below is a large triple casement window. The center window has eighteen lights and the windows on either side have twelve lights. On the east wall of the projecting gable is a centered door. On the west wall of the projecting gable is a paired eight light casement window. To the east of the projecting gable are two doors on either side of the stone chimney that has a metal rain guard. To the west of these doors are two paired eight light casement windows. To the west of the projecting gable is a door with transom. On either side of the door is a eight light casement window with a cedar sill.

The west elevation has a projecting gable, with a small centered cedar-framed metal vent in its pediment. A large triple casement window with a cedar sill extends most of the width of the section. Each window has sixteen lights.

The interior reflects the same Rustic Style as found in the exterior. Significant extant architectural features include rough limestone walls, cedar mortise and tenon construction, exposed cedar rafters and beams secured with metal bracing, a double layer of cedar strips that form the ceiling, and a cedar wainscoting. The floor in most rooms is a wood parquet installed over oak flooring in the early 1970s.

The central hall/auditorium dominates the interior space. On the west wall is a large limestone fireplace, which has a cedar

United States Department of the Interior  
National Park ServiceNational Register of Historic Places  
Continuation SheetSection number 7 Page 3

Cedars of Lebanon State Park Historic District, Wilson County, TN

mantel with segmental arch opening with voussoirs. Above the mantel is a historic mill stone moved from a local farm at the time of the building's construction. Cedar pilasters additionally frame the walls of the central hall, dividing the limestone walls and cedar wainscoting at regular intervals. The two doors on either side of the central hall fireplace are original to the construction of the building.

Separating the central hall from the recreational room to the east is a cedar screen of three squared-arched doorways trimmed with cedar strips in a diagonal pattern. The center doorway is twice as large as the others. The east recreational room has a smaller limestone fireplace on its south wall. Two doors are located on the cedar-panelled east wall. The door to the west leads to a small panelled hall that accesses two cedar-panelled bathrooms, which were updated to handicapped access standards in the circa 1985. The door to the right leads to a six-by-six wood-panelled room that was once a refreshment room. Behind this room is a painted and wood-panelled room, with carpet, that was once used as an office.

On the west side of the central hall/auditorium is the former screened porch. This room was enclosed with casement windows in circa 1950. In 1986, linoleum tile was placed over the original oak flooring and a large laminate counter was added on the south side of the room in order to turn the space into a refreshment center, a function the room still serves today.

The Cedar Forest Lodge (C) retains sufficient integrity for nomination under Criterion A and to be a contributing building in the district, but the changes, although sensitively done, make it unlikely to be eligible for architecture under Criterion C. Other buildings in state parks, such as the Pickett State Rustic Park Historic District (NR 7/8/86) and Standing Stone Rustic State Park Historic District (NR 7/8/86) have better examples of buildings eligible for architecture under Criterion C.

The setting of the Cedar Forest Lodge is significant. The location of the lodge was chosen because of the proximity of Jackson Cave, the park's most outstanding scenic attraction. The cave lies to the immediate south of the lodge and the lodge itself rests on a rock cliff that overlooks the cave area. There is a stone fence (NC), separating the grounds of the lodge from

United States Department of the Interior  
National Park ServiceNational Register of Historic Places  
Continuation SheetSection number 7 Page 4

## Cedars of Lebanon State Park Historic District, Wilson Co., TN

the cliff over the cave. This fence, altered to supplement concrete pavement added in circa 1960, is non-contributing, due to date of construction. Around the cave depression, the Work Progress Administration constructed two scenic overlooks. The overlooks are built of limestone, with shed cedar roofs supported by cedar logs, and are designed in the Rustic Style. The east overlook (C), built in circa 1937, lies to the south and east of the lodge. The west overlook (C), also built in circa 1937, lies to the south and west of the lodge. To connect the overlooks to the lodge, federal workers constructed trails and a bridge that crosses the cave depression at the place where the creek exits the depression and winds its way south. The connecting trails, built in circa 1937, comprise a contributing element to the nomination (C). The bridge, however, was replaced over time, with the current structure dating to circa 1985 (NC, due to date of construction).

North of the lodge are two additional contributing elements. A limestone, pyramid-shaped water fountain dates to circa 1944 (C). It is located just north of the main entrance of the building. About fifty yards to the northwest of the lodge entrance, across the park road separating the lodge from a picnic area, is an asphalt shingle gable roof limestone storage building, with a limestone foundation, and a replacement security door that dates to circa 1980. This stone building, also in the Rustic Style, dates to circa 1937 (C). Directly east, about 25 yards, of the limestone building, within the nominated boundaries, is an open, asphalt shingle gable-roof log picnic pavillion. It dates to circa 1960 (NC, due to date of construction).



United States Department of the Interior  
National Park Service

**National Register of Historic Places  
Continuation Sheet**

Section number 8 Page 5

---

Cedars of Lebanon State Park Historic District, Wilson County, TN

VIII. Statement of Significance

The Cedars of Lebanon State Park Historic District at Cedars of Lebanon State Park, in Wilson County, Tennessee, is eligible for the National Register of Historic Places under Criterion A for its association with the federal government's relief and recovery programs during the New Deal, especially the Works Progress Administration. It is nominated under the registration requirements set forth in the Multiple Property Documentation for State Parks in Tennessee Built by the CCC and WPA, 1934-1942.

In January 1921, Stephen Mather, the first Director of the National Park Service, arranged the first meeting of the National Conference of State Parks. This meeting in Iowa launched a movement that developed new public parks in every state and commonwealth in the United States. The mission of the National Conference of State Parks was to urge federal, state, and local officials to provide public parks, forests, and preserves that would be accessible to all Americans. In 1925, the Tennessee General Assembly officially recognized the park movement by establishing the State Park and Forestry Commission, which had the power to acquire properties for use as state parks and forests. Later, in reaction to the federal park initiatives of the 1930s, the State of Tennessee in 1937 created the Department of Conservation, with divisions for forestry, geology, and state parks.

The eventual creation of Cedars of Lebanon State Park is closely associated with federal efforts at conservation, park development, and public works programs during the New Deal of President Franklin D. Roosevelt, from 1933 to 1938. Roosevelt's recovery and reform plans included programs to put unemployed Americans to work as well as programs to revitalize national resources and restore abused natural landscapes. In 1936, Congress approved the Park, Parkway, and Recreational Study Act of 1936, in which the National Park Service and other federal agencies would collaborate with state agencies in producing comprehensive surveys of recreational resources. In Tennessee, the National Park Service worked with the Tennessee Valley Authority, the U.S. Forest Service, the Resettlement Administration, the Works Progress Administration, the Civilian Conservation Corps (CCC), and other federal programs.

United States Department of the Interior  
National Park ServiceNational Register of Historic Places  
Continuation SheetSection number 8 Page 6

Cedars of Lebanon State Park Historic District, Wilson County, TN

The "Lebanon Cedar Forest Project" in Wilson County, Tennessee, was developed as a "Land-Use Area" in cooperation with the Resettlement Administration and the U.S. Department of Agriculture. Land-Use Areas were established on sub-marginal agricultural lands for redevelopment, reforestation, and erosion control. The Wilson County site was chosen due to its sub-marginal soil. The large cedar forest that existed at the time of settlement had been heavily cut through the nineteenth and early twentieth centuries, especially to provide timber and wood for a pencil mill on Cainsville Road. Because of this deforestation, and over-grazing of young timber growth by livestock, the gladelike (too rocky for cultivation) nature of the soil, and subsequent heavy erosion, the land had little agricultural or timber value and was a major contributor to the poverty of the surrounding rural population.

In 1933, the U.S. Department of Agriculture provided Tennessee with funds to assist in adapting sub-marginal lands for better uses. Due to the nature of the environmental destruction in Wilson County (an estimated zone of 50,000 acres), a project for Wilson County was the first to be proposed in Tennessee. The first completed project, however, took place in what is now Pickett State Park (NR 7/08/86).

The "Lebanon Cedar Forest Project" began in 1933, with the purchase of land from approximately 94 families. After the land acquisition, the project was submitted to Washington for approval, which it received on September 25, 1935. Like other such federal projects, the Cedar Forest Project had the goals of relocating farmers from sub-marginal lands to better producing lands; establishing a wildlife refuge; creating a recreational center for approximately 200,000 people within a fifty mile radius; and to serve as a conservation demonstration for neighboring farm families. The project also specified that eight thousand acres of gladelike soil would be transformed into a cedar forest.

The federal government supervised the construction of the project and provided plans for the park and park structures from standardized plans already developed by the National Park Service. The primary design goal was to build structures that enhanced, rather than detracted from, the natural scenic beauty

United States Department of the Interior  
National Park Service

## National Register of Historic Places Continuation Sheet

Section number 8 Page 7

---

Cedars of Lebanon State Park Historic District, Wilson County, TN of the park. Jackson Cave, consequently, became a focal point and here would be located the Cedar Forest Lodge.

The project's buildings were constructed of locally quarried limestone and cedar trees from the park. The work was carried out by locally hired WPA labor. The only other extant, or identified, WPA project in Wilson County is the Gymnasium (1936) at Cumberland University, a building that in 1992-93 was converted from a gym into a music hall and classrooms. The WPA in 1939 also completed the Lebanon air field, which began as a Civil Works Administration project in December 1933.

The original headquarters for the project was at the Copeland Building in Lebanon. Office personnel and construction labor were local residents and involved one hundred individuals at the peak of activity for the project. As the project expanded, offices moved to a house on University Avenue, also in Lebanon.

On September 25, 1937, the official opening of "Lebanon Cedar Forest" took place with the laying of the cornerstone of the Cedar Forest Lodge. The park headquarters moved to the lodge until it was ready for public use. The building has not changed in its location or size since that time, but the original screened porch was enclosed with large casement windows in circa 1950. The casement windows, like the original screened porch, provide much natural light to the west room of the lodge. Since the room's conversion, it has been used as a smaller recreational room and/or refreshment stand for park visitors for most of the subsequent years. The lodge originally served and continues to serve as a recreational and community center for tourists and Wilson County residents, providing a large enclosed area for dances, meetings, and lectures in the central hall/auditorium.

On March 23, 1939, the U.S. Department of Agriculture leased the "Lebanon Cedar Forest Project" to the Tennessee Department of Conservation. The state renamed it the "Cedars of Lebanon State Park," but the park was not formally transferred from the U.S. Department of Agriculture to the State of Tennessee until 1955. During World War II, attendance at Cedars of Lebanon State Park reached its peak, as the park served as a camp and recreational area for the Second U.S. Army soldiers stationed in the region on army maneuvers. From 1942-44, the Cedar Forest Lodge, Jackson

United States Department of the Interior  
National Park Service

**National Register of Historic Places  
Continuation Sheet**

Section number 8 Page 8

---

Cedars of Lebanon State Park Historic District, Wilson County, TN

Cave, and the scenic overlooks became the primary focal point of activity and recreation for the soldiers on their off-duty time. Due to the activity of the U.S. Army here in 1943 and 1944, the historical significance of this park's historic district extends to 1944, although the original multiple property cover sheet for State Parks in Tennessee Built by the CCC and WPA goes only to 1942.

The setting of these sites, buildings, and trails of the Cedars of Lebanon State Park Historic District remains largely extant today, representing the best example in Wilson County, Tennessee, of the combined efforts of federal and state agencies to create a conservation landscape in the midst of the Great Depression.

United States Department of the Interior  
National Park Service

National Register of Historic Places  
Continuation Sheet

Section number 9 Page 9

---

Cedars of Lebanon State Park Historic District, Wilson County, TN

IX. Bibliography

Coggins, Allen R. "The Early History of Tennessee's State Parks, 1919-1956." Tennessee Historical Quarterly 43(Fall 1984): 295-315.

Coleman, Bevley R. A History of State Parks in Tennessee. Nashville: Tennessee Department of Conservation, 1968.

Evans, W.B., U.S. Department of Agriculture, to Walter R. Johnson, Tennessee Division of State Parks, February 17, 1940, Park Records, Cedar of Lebanon State Park, Wilson County, TN.

Jones, James B. and Claudette Stager. "State Parks in Tennessee Built by the CCC and WPA, 1934-1942." National Register of Historic Places Multiple Property Nomination, Tennessee Historical Commission, Nashville, Tennessee, 1986.

Merritt, Dixon, ed. Wilson County: Its Land and Its Life. Lebanon, TN: Lebanon Democrat, 1961.

Suddarth, Sandy. "History of Lebanon Cedar Forest Project." Park Records, Cedar of Lebanon State Park, Wilson County, TN.

Suddarth, Sandy. Interview with Ginger Ramsey, October 1994 and April 1995.

Young, Max J. "An Interim Investigation of Cedars of Lebanon State Park and Forest." Tennessee Department of Conservation, Division of Forestry, June 1973.

United States Department of the Interior  
National Park Service

**National Register of Historic Places  
Continuation Sheet**

Section number 10 Page 10

---

Cedars of Lebanon State Park Historic District, Wilson County, TN

X. Geographical Data

Verbal Boundary Description

The Cedars of Lebanon State Park Historic District is centered around the Cedar Forest Lodge and Jackson Cave. Its associated outbuildings and structures are within boundaries of fifty yards to the north of Cedar Forest Road, twenty yards to the east and west of the Cedar Forest Lodge, and approximately two hundred yards to the south of the Cedar Forest Lodge, following both the east and west trails that lead to the bridge, which crosses the drainage depression area of Jackson Cave. The bridge defines the southern boundary of the district while the historic storage building stands at the northwest corner and the picnic pavillion is at the northeast corner of the boundaries.

Boundary Justification

The nominated boundaries contain an intact area, centered around the Cedar Forest Lodge and Jackson Cave, that best presents the historic character of Cedars of Lebanon State Park, Wilson County, Tennessee, and have been marked on the attached park map

United States Department of the Interior  
National Park Service

**National Register of Historic Places  
Continuation Sheet**

Section number PHOTOS Page 11

---

Cedars of Lebanon State Park Historic District, Wilson County, TN

PHOTOGRAPHS

Cedars of Lebanon State Park Historic District  
Wilson Co., TN

Photos by: Carroll Van West  
          MTSU Center for Historic Preservation  
Date:      March 22, 1995 and June 20, 1995  
Negatives: Tennessee Historical Commission  
          2941 Lebanon Road  
          Nashville, TN 37243

North facade, facing southwest  
1 of 24

North facade, facing south  
2 of 24

North facade, entrance detail, facing south  
3 of 24

West elevation, facing east  
4 of 24

South elevation, facing northeast  
5 of 24

South elevation, facing north  
6 of 24

East elevation, facing west  
7 of 24

Replacement doors and original lanterns, north facade, facing  
southwest  
8 of 24

Cornerstone, north facade, facing south  
9 of 24

Central hall/auditorium, facing north  
10 of 24

United States Department of the Interior  
National Park Service

**National Register of Historic Places  
Continuation Sheet**

Section number PHOTOS Page 12

---

Cedars of Lebanon State Park Historic District, Wilson County, TN

Central hall/auditorium, facing south  
11 of 24

Arched doorway into eastern room, facing east  
12 of 24

Fireplace/mantle, central hall/auditorium, facing west  
13 of 24

Roof trusses, central hall/auditorium, facing south  
14 of 24

Eastern room, facing south  
15 of 24

Refreshment stand room, facing northeast  
16 of 24

Water fountain, lodge entrance, facing south  
17 of 24

East overlook, facing northwest  
18 of 24

West overlook, facing northwest  
19 of 24

Storage building, facing northwest  
20 of 24

Picnic shelter, facing north  
21 of 24

Jackson Cave, facing north  
22 of 24

East trail, facing east  
23 of 24

Bridge, southern boundary, facing south  
24 of 24



PLAYGROUND

ASSEMBLY HALL

REST R

RECREATION LODGE

BASEBALL

Cedar Forest Rd

M

REA

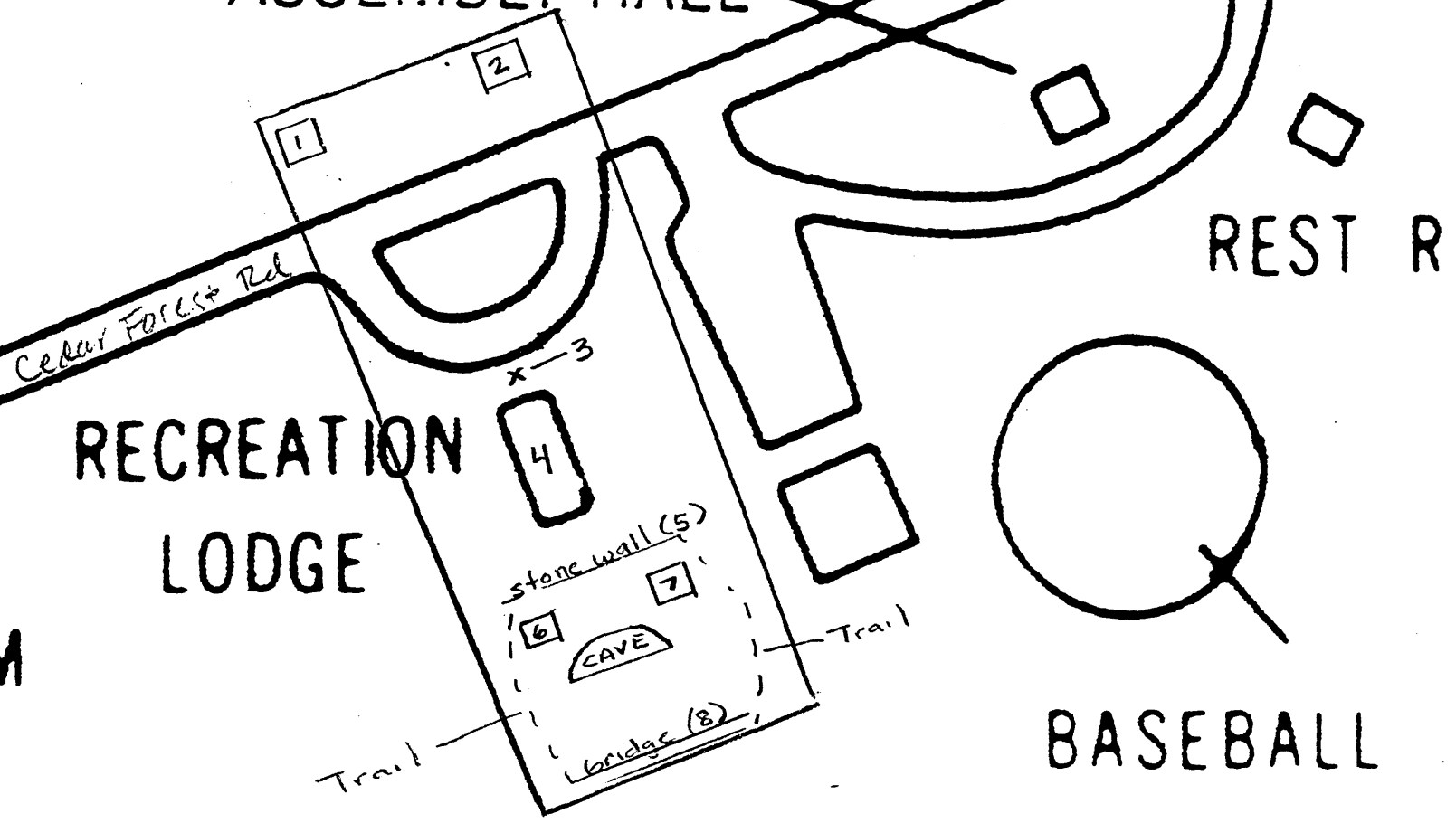

Cedars of Lebanon State Park Historic District  
Property Distribution/ boundaries: NTS

Legend:

- 1) c. 1937 storage building (C)
- 2) c. 1960 picnic pavillion (NC)
- 3) 1944 water fountain (C)
- 4) Cedar Forest Lodge, 1937 (C)
- 5) Stone wall, c. 1960 (NC)
- 6 & 7) overlooks, c. 1937 (C)
- 8) bridge, c. 1985 (NC)

NOT TO SCALE  
APPROX. BOUNDARIES -  
SEE BOUNDARY  
DESCRIPTION

