

RECEIVED

301

NATIONAL REGISTER OF HISTORIC PLACES REGISTRATION FORM

This form is for use in nominating or requesting determinations of eligibility for individual properties or districts. See instructions in "Guidelines for Completing National Register Forms" (National Register Bulletin 16). Complete each item by marking "X" in the appropriate box or by entering the requested information. If an item does not apply to the property being documented, enter "N/A" for "not applicable." For additional space use continuation sheets (Form 10-900a). Type all entries.

1. Name of Property

historic name Eastanollee Auditorium
other names/site number n/a

2. Location

street & number Northeast corner of Eastanollee School Road and Red Hollow Road.
city, town Eastanollee (n/a) **vicinity of**
county Stephens **code** GA 257
state Georgia **code** GA **zip code** 30577

(n/a) not for publication

3. Classification

Ownership of Property:

- private
- public-local
- public-state
- public-federal

Category of Property:

- building(s)
- district
- site
- structure
- object

Number of Resources within Property:

Contributing

Noncontributing

buildings	1	0
sites	0	0
structures	0	0
objects	0	0
total	1	0

Contributing resources previously listed in the National Register: n/a

Name of previous listing: n/a

Name of related multiple property listing: n/a

4. State/Federal Agency Certification

As the designated authority under the National Historic Preservation Act of 1966, as amended, I hereby certify that this nomination meets the documentation standards for registering properties in the National Register of Historic Places and meets the procedural and professional requirements set forth in 36 CFR Part 60. In my opinion, the property meets the National Register criteria. () See continuation sheet.

Russell C. Cloves

2-21-00

Signature of certifying official

Date

W. Ray Luce
Deputy State Historic Preservation Officer

In my opinion, the property () meets () does not meet the National Register criteria. () See continuation sheet.

Signature of commenting or other official

Date

State or Federal agency or bureau

5. National Park Service Certification

I, hereby, certify that this property is:

entered in the National Register

Edson H. Boall 3/31/00

() determined eligible for the National Register

() determined not eligible for the National Register

() removed from the National Register

() other, explain:

() see continuation sheet

[Signature]

Keeper of the National Register

Date

6. Function or Use

Historic Functions:

SOCIAL/meeting hall
EDUCATION/education-related
RECREATION AND CULTURE/auditorium

Current Functions:

EDUCATION/education-related
RECREATION AND CULTURE/auditorium

7. Description

Architectural Classification:

LATE 19TH AND 20TH CENTURY REVIVALS/Colonial Revival

Materials:

foundation	brick
walls	brick
roof	asphalt
other	n/a

Description of present and historic physical appearance:

The Eastanollee Auditorium is located within the larger campus of buildings associated with the Eastanollee School complex. The school complex encompasses the historic Eastanollee Auditorium, nonhistoric Eastanollee Middle School, nonhistoric Eastanollee Elementary School, and other educational-related buildings. The school complex is located near the center of the small community of Eastanollee in rural Stephens County.

The Eastanollee Auditorium was constructed in 1923 and is the oldest remaining building within the larger school campus. The T-shaped auditorium is a gable-front, wood-framed, brick-veneered building. The front of the building features a one-story, gable-front section and the rear of the building features a two-story, hipped roof section. The building features slightly overhanging boxed eaves, decorative shingles in the front gable, and cornice returns (see photos 1 and 2). The symmetrical front facade of the building features a triangular pedimented portico supported by paired Doric columns, a centrally located main entrance with wood double doors and transom, and long narrow windows (currently covered with louvered shutters) located on either side of the main entrance (see photo 3). The remaining windows on the gable-front section of the building consist of single and paired nine-over-nine double-hung windows .

The rear section of the building with the hipped roof is two-stories in height. The first floor, considered to be the basement, is built into an earthen bank and features single six-over-six double-hung windows (see photos 4 and 5). The rear facade features a wood triangular pediment located

United States Department of the Interior
National Park Service

National Register of Historic Places Continuation Sheet

Section 7--Description

over a centrally located entrance, decorative wood double doors, and a row of single six-over-six, double-hung windows (see photos 5 and 6). The second story of the hipped-roof section features single and double nine-over-nine double-hung windows (see photos 4 and 5).

The main entrance of the auditorium opens directly into the main auditorium space with the stage located at the far end (east) of the building (see photo 8). The interior space is open with a center aisle located between two sections of metal seats (350 seats) and a gym floor is located on the stage. The large open interior space is supported by exposed ceiling beams with support braces (see photo 9). The interior walls, wainscoting, and ceiling are clad with beaded board, and the auditorium and stage floors are wood. The stage floor was originally designed as a basketball court with basketball backboards located at each end of the court and a historic clock/scoreboard (see photo 10).

Historically, the original high school (no longer standing) was located just to the west of the auditorium, and large mature trees surrounded the auditorium. Both buildings faced a courtyard used for recreational and administrative purposes (see Attachment 1). Currently, a modern school has replaced the historic school and the courtyard is paved but still functions as a recreational location (see photo 1). Large mature trees as well as a small grassy yard continue to surround the auditorium (see photos 1 and 2).

8. Statement of Significance

Certifying official has considered the significance of this property in relation to other properties:

nationally statewide locally

Applicable National Register Criteria:

A B C D

Criteria Considerations (Exceptions): N/A

A B C D E F G

Areas of Significance (enter categories from instructions):

ENTERTAINMENT/RECREATION
ARCHITECTURE

Period of Significance:

1923 to 1950

Significant Dates:

1923 Construction of the Eastanollee Auditorium
1923 to 1950 Eastanollee Auditorium served as the school auditorium and the only public meeting place for the Eastanollee community.

Significant Person(s):

n/a

Cultural Affiliation:

n/a

Architect(s)/Builder(s):

Unknown.

United States Department of the Interior
National Park Service

National Register of Historic Places Continuation Sheet

Section 8--Statement of Significance

Narrative statement of significance (areas of significance)

The Eastanollee Auditorium was once a component of an early 20th-century school complex centered around the Stephens County High School (no longer standing). The school complex has lost historic buildings and modern educational-related buildings have been constructed to replace the older buildings from the early 20th century. The auditorium is the oldest building remaining on the school campus that represents the early 20th century history of the Stephens County High School complex. The Eastanollee Auditorium is significant in the areas of Entertainment/recreation and architecture at the local level of significance.

The Eastanollee Auditorium is significant in the area of Entertainment/recreation for its use as a gymnasium, theater, and social hall by the original Stephens County High School, modern replacement high school, middle school, and Eastanollee community. The original Stephens County High School was constructed in 1915 and located adjacent to the Eastanollee Auditorium (see Attachment 1). Before the construction of the auditorium in 1923, the second floor of the school was used as an auditorium/gymnasium. As more students attended the school, the community financially supported the construction of the Eastanollee Auditorium and the second floor of the high school was converted to classrooms.

The auditorium served as the social center of the Eastanollee community providing meeting space for local groups and organizations. The auditorium was largest building in the community for the local citizens to come together for entertainment, social services, and political meetings. The auditorium stage also served as a gymnasium floor for school-related sporting events.

The Eastanollee Auditorium is significant in the area of architecture as a good example of a Colonial Revival-style auditorium constructed during the early 20th century. The Colonial Revival style was very popular in Georgia from the 1890s through the 1940s and beyond. The Colonial Revival style was commonly used for a variety of community landmark building, such as schools, banks, auditoriums, and libraries found in both large and small towns in Georgia. The auditorium has retained many of its significant character-defining features such as the pedimented front portico supported by paired Doric columns, wide cornice band, cornice returns, boxed eaves, and single and paired none-over-nine double-hung windows (see photos 1, 2, 4 and 5). The auditorium also maintains many of its original interior features such as its large open space with a center hallway located between two sections of seats; stage with gymnasium floor; wood ceilings, walls, and floors; and wainscoting (see photos 8, 9, and 10).

The majority of auditoriums associated with school complexes in Georgia, such as the Rock Gym in Elbert County, listed to the National Register of Historic Places on December 31, 1998, were constructed during the Works Projects Administration period (1933-1943) in Georgia. The

United States Department of the Interior
National Park Service

National Register of Historic Places Continuation Sheet

Section 8--Statement of Significance

Eastanollee Auditorium is an excellent example of a community sponsored effort to construct an auditorium to serve both the Eastanollee school system as well as the community at large.

National Register Criteria

The Eastanollee Auditorium is eligible under National Register Criterion A for its association to the significant theme of entertainment/recreation and under National Register Criterion C as a good example of a Colonial Revival style building.

Criteria Considerations (if applicable)

n/a

Period of significance (justification)

The period of significance for the Eastanollee Auditorium begins in 1923, the year the auditorium was constructed, and ends in 1950, the end of the historic period. The period of significance extends to 1950 since the auditorium was the only building that served the Eastanollee community for community- and school-related events from its construction throughout the historic period.

Contributing/Noncontributing Resources (explanation, if necessary)

The one contributing historic resource is the Eastanollee Auditorium.

Developmental history/historic context (if appropriate)

****Note: The following history was prepared by Jorene Martin, "Eastanollee Auditorium," Historic District Information Form, May 4, 1996. On file at the Historic Preservation Division, Georgia Department of Natural Resources, Atlanta, Georgia.**

Education in Eastanolle began in a way that was similar to so many rural communities with informal classes held in private homes. The first official school in Eastanollee was not organized until after the Civil War (1861-1865). Classes were taught in the Mt. Carmel Methodist Church which served as both house of worship and day school. This was a common arrangement for the time, born out of the realization that the first schoolhouse in the community was only temporary and would be replaced when the community's resources and population were not so sparse.

United States Department of the Interior
National Park Service

National Register of Historic Places Continuation Sheet

Section 9--Major Bibliographic References

A new school structure was constructed in 1880 near the site of the present school campus along the old Red Hollow Road, a wagon road that ran directly through Eastanollee, connecting north Georgia to markets in Savannah. This school was known as the Post Oak school or Seven Oaks school because it was set in a cluster of post oaks. This two-room, clapboard school served as evidence of Eastanollee's development as a civilized settlement. It fulfilled the needs of the community for over thirty years, until 1915, when it was decided that a new updated school was necessary.

Following the flu epidemic of 1914-1915, Dr. and Mrs. Jeff Davis, two proponents of reformed education, donated ten acres of land on which a brick school building was to be placed. The entire community reached out to the help with the construction of the new schoolhouse. No single building more vividly represents the communal effort of Eastanollee's residents who donated time, labor and materials to provide an institution of learning for their children. Bricks baked in local kilns were used in the construction of the new school by resident craftsmen. In the summer of 1916, the cornerstone was laid and in December 1917, the first classes were held in the new building. The two-story brick school contained four classrooms on the first floor and an open area upstairs for assemblies. After just a few years, the space in the new schoolhouse proved inadequate. In 1923, the district sold bonds and with the money raised built the present auditorium and converted the second floor of the school into classrooms.

The auditorium served as the social center of the community, providing meeting space for local groups and organizations, including 4-H, Future Farmers of America, and sewing/quilting clubs. It was the only location for the local citizens to come together for entertainment, social services, political meetings, and school-related events like commencements. Well-known performers, such as Hank Williams, Sr., performed in the auditorium.

The Eastanollee school campus is still used by the Stephens County School District, although the original school was demolished and replaced in the 1950s. The auditorium remains as the oldest school building still in use on the campus. The stage/gymnasium floor receives almost daily use by students in the Crossroads and Pre-Kindergarten programs. The building has remained an important community building to Eastanollee.

The Eastanolle Auditorium was awarded a Georgia Heritage 2000 Grant in 1998 to repair structural problems with the roof of the building (see photo 5).

9. Major Bibliographic References

Martin, Jorene. "Eastanollee Auditorium," Historic Property Information Form, June 27, 1996.
On file at the Historic Preservation Division of the Georgia Department of Natural Resources,
Atlanta, Georgia, with supplemental information.

Martin, Anne. Personal interview by Jorene Martin. May 4, 1996.

Previous documentation on file (NPS): (x) N/A

- preliminary determination of individual listing (36 CFR 67) has been requested
- preliminary determination of individual listing (36 CFR 67) has been issued
date issued:
- previously listed in the National Register
- previously determined eligible by the National Register
- designated a National Historic Landmark
- recorded by Historic American Buildings Survey #
- recorded by Historic American Engineering Record #

Primary location of additional data:

- State historic preservation office
- Other State Agency
- Federal agency
- Local government
- University
- Other, Specify Repository:

Georgia Historic Resources Survey Number (if assigned): ST-6

10. Geographical Data

Acreage of Property Less than one acre.

UTM References

A) Zone 17 Easting 293040 Northing 3824020

Verbal Boundary Description

The National Register boundary for the Eastanollee Auditorium is indicated by a heavy black line on the attached aerial photo based on a Stephens County Tax Assessors Map at the scale of 1" = 200'.

Boundary Justification

The National Register boundary encompasses the Eastanollee Auditorium, historic recreational space adjacent to the auditorium, and remaining historic vegetation associated with the auditorium.

11. Form Prepared By

State Historic Preservation Office

name/title Amy Pallante/National Register Specialist
organization Historic Preservation Division, Georgia Department of Natural Resources
street & number 500 The Healey Building, 57 Forsyth Street
city or town Atlanta **state** Georgia **zip code** 30303
telephone (404) 656-2840 **date** February 2000

Consulting Services/Technical Assistance (if applicable) () not applicable

name/title Jorene Martin/Preservation Planner
organization Georgia Mountain Regional Development Center
street and number P.O. Box 1720
city or town Gainesville **state** Georgia **zip code** 30503
telephone 770-536-3431

() **consultant**
(x) **regional development center preservation planner**
() **other:**

(HPD form version 02-24-97)

United States Department of the Interior
National Park Service

National Register of Historic Places Continuation Sheet

Photographs

Name of Property: Eastanollee Auditorium
City or Vicinity: Eastanolle
County: Stephens
State: Georgia
Photographer: James R. Lockhart
Negative Filed: Georgia Department of Natural Resources
Date Photographed: December 1997

Description of Photograph(s):

- 1 of 10 Oblique view of the Eastanollee Auditorium; photographer facing east.
- 2 of 10 Oblique view of the auditorium; photographer facing north.
- 3 of 10 Detail view of the front facade; photographer facing northeast.
- 4 of 10 Oblique view of the auditorium; photographer facing south.
- 5 of 10 Oblique view of the auditorium; photographer facing west .
- 6 of 10 Detail view of the rear entrance; photographer facing southwest.
- 7 of 10 Detail view of the side elevation; photographer facing northwest.
- 8 of 10 Interior view towards the stage; photographer facing northeast.
- 9 of 10 Detail interior view of the auditorium seats and wall; photographer facing northwest.
- 10 of 10 Detail view of the stage; photographer facing north.

**Attachment 1
Eastanallee Auditorium
Eastanallee, Stephens Co., GA.
c.1920 Historic Photograph**

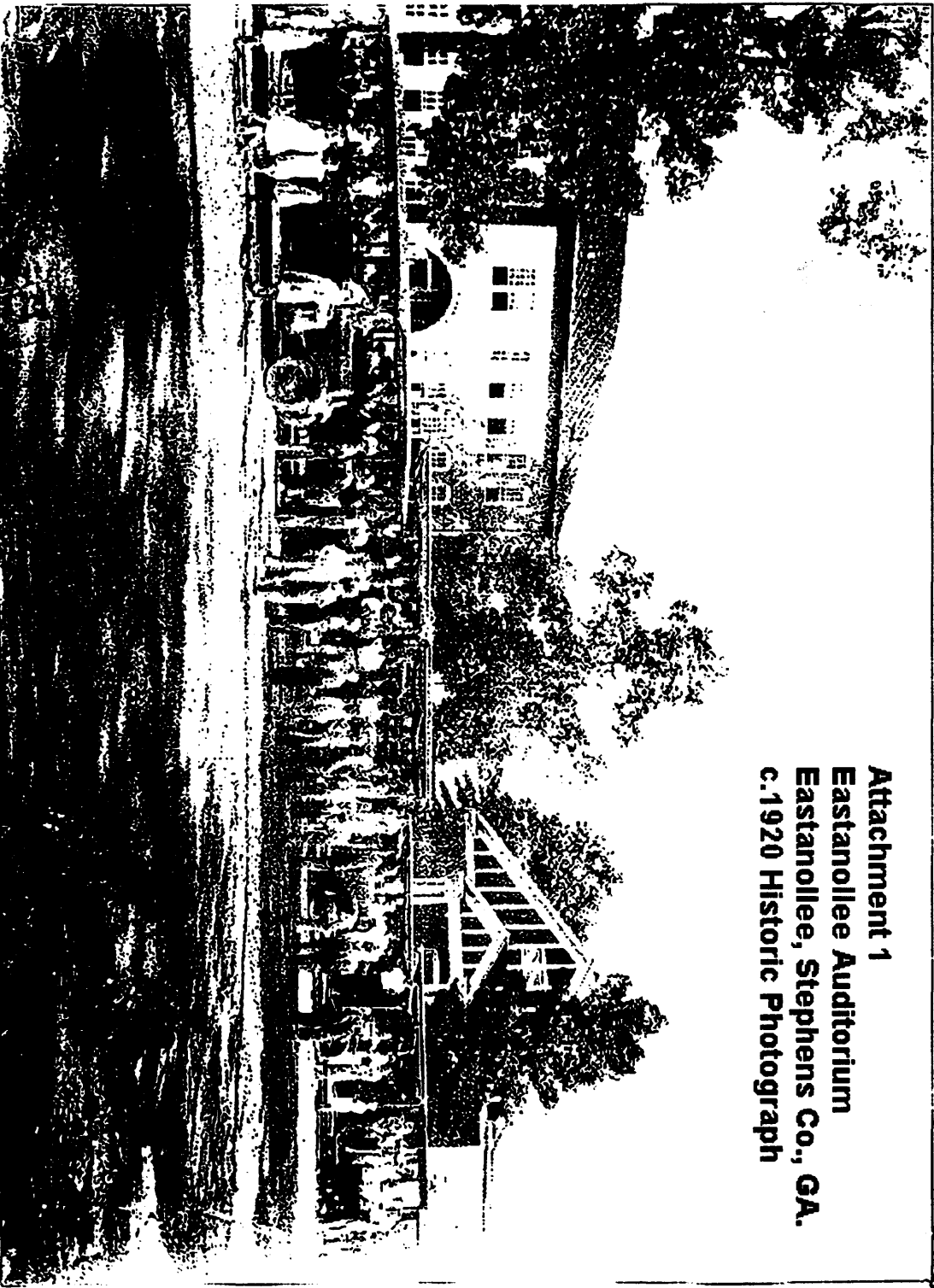

Children boarding county school buses at Eastanallee in 1920's. School began in August and operated on a reduced schedule in the autumn to allow children to pick cotton. In the background is the academic building; far right is the auditorium.

NATIONAL REGISTER MAP/SITE MAP AND PHOTO KEY

Eastanollee Auditorium
Eastanollee, Stephens County, Georgia
Not to scale.

○ = photo number and direction

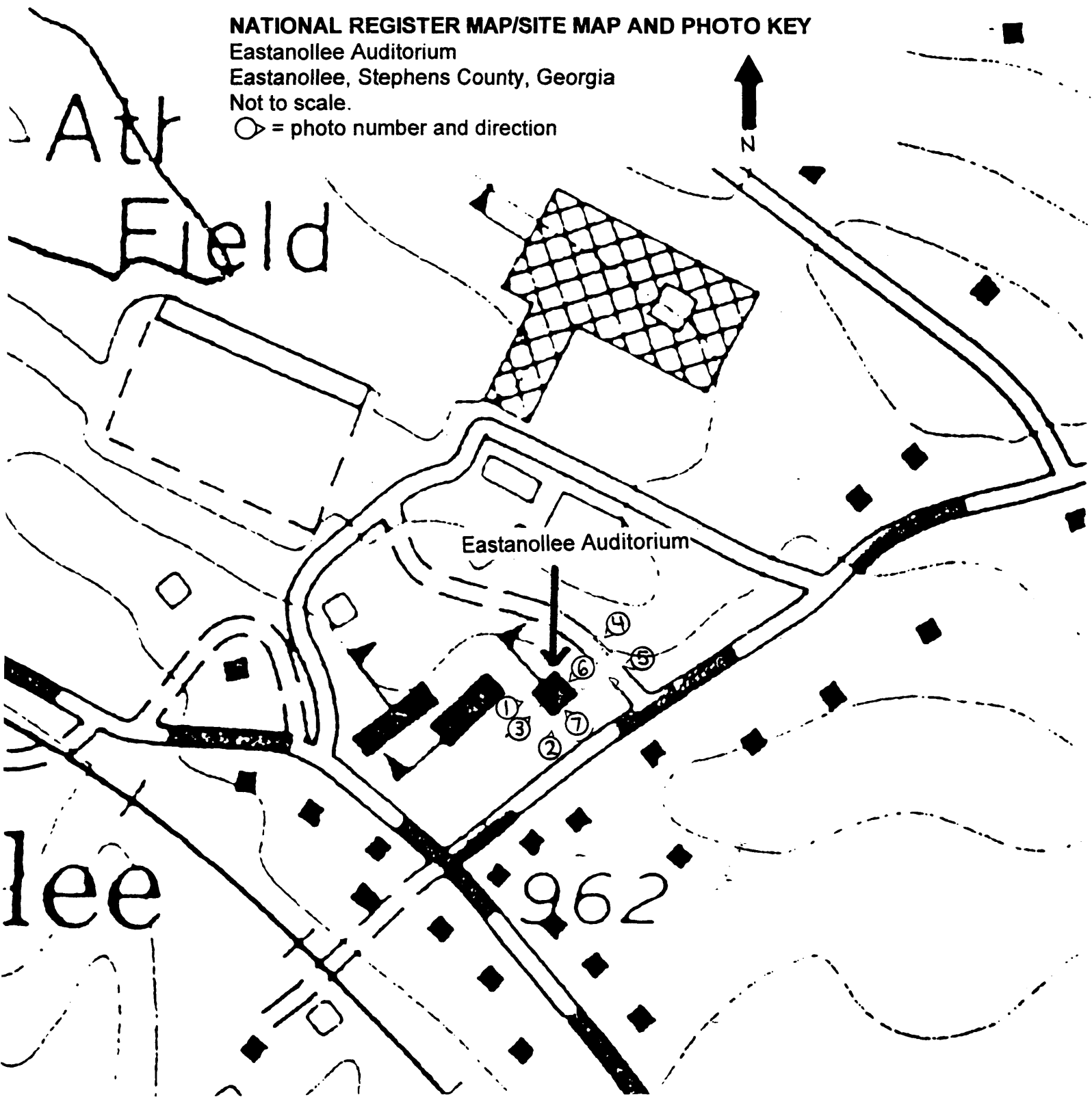

Eastanollee Auditorium

962

Att
Field

lee

NATIONAL REGISTER MAP/SITE MAP AND PHOTO KEY

Eastanollee Auditorium
Eastanollee, Stephens County, Georgia
Not to scale.

⊙ = photo number and direction

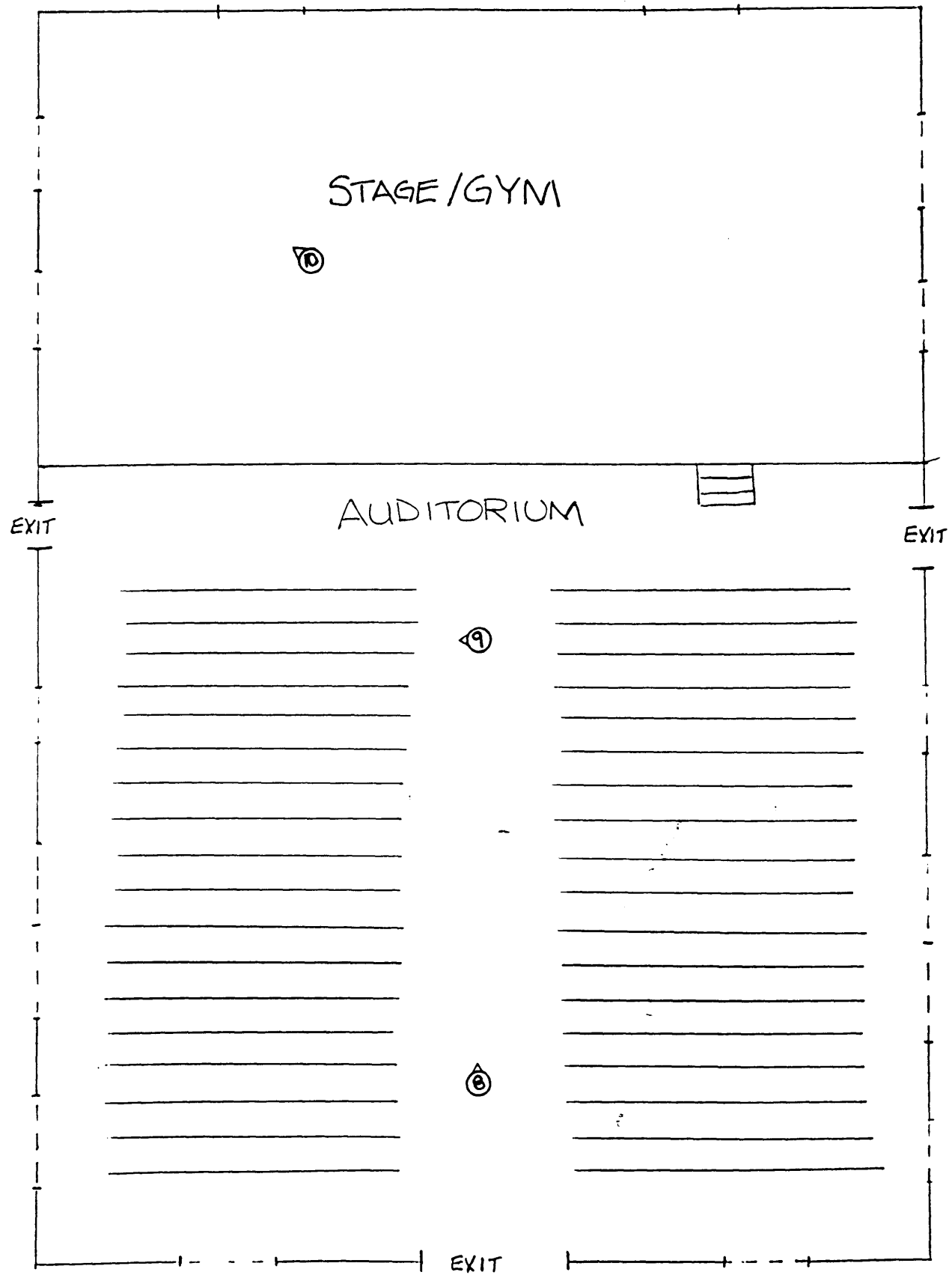

*DRAWING NOT TO SCALE

NATIONAL REGISTER MAP
Eastanollee Auditorium
Eastanollee, Stephens Co., GA.
Source: Stephens County Tax
Assessors Office



Scale: 1" = 200'

— = National Register boundary

