

RECEIVED

598
RECEIVED OMB No. 10024-0018

United States Department of the Interior
National Park Service

JUN 1993

FEB 12 1993

National Register of Historic Places Registration Form

Ala. Historical Commission

This form is for use in nominating or requesting determinations for individual properties and districts. See instructions in *How to Complete the National Register of Historic Places Registration Form* (National Register Bulletin 16A). Complete each item by marking "x" in the appropriate box or by entering the information requested. If an item does not apply to the property being documented, enter "N/A" for "not applicable." For functions, architectural classification, materials, and areas of significance, enter only categories and subcategories from the instructions. Place additional entries and narrative items on continuation sheets (NPS Form 10-900a). Use a typewriter, word processor, or computer, to complete all items.

1. Name of Property

historic name Altwood

other names/site number Cedar Crest Farms

2. Location

street & number west of Marengo County Road 51 N/A not for publication

city or town Faunsdale vicinity

state Alabama code AL county Marengo code 091 zip code 36738

3. State/Federal Agency Certification

As the designated authority under the National Historic Preservation Act, as amended, I hereby certify that this nomination request for determination of eligibility meets the documentation standards for registering properties in the National Register of Historic Places and meets the procedural and professional requirements set forth in 36 CFR Part 60. In my opinion, the property meets does not meet the National Register criteria. I recommend that this property be considered significant nationally statewide locally. (See continuation sheet for additional comments.)

[Signature]
Signature of certifying official/Title

5-25-93
Date

Alabama Historical Commission (State Historic Preservation Office)
State of Federal agency and bureau

In my opinion, the property meets does not meet the National Register criteria. (See continuation sheet for additional comments.)

Signature of certifying official/Title

Date

State or Federal agency and bureau

4. National Park Service Certification

I hereby certify that the property is:

- entered in the National Register. See continuation sheet.
- determined eligible for the National Register See continuation sheet.
- determined not eligible for the National Register.
- removed from the National Register.
- other. (explain:)

Signature of the Keeper

Date of Action

Patrick Anders

7/13/93

Altwood
Name of Property

Marengo County, Alabama
County and State

5. Classification

Ownership of Property
(Check as many boxes as apply)

- private
- public-local
- public-State
- public-Federal

Category of Property
(Check only one box)

- building(s)
- district
- site
- structure
- object

Number of Resources within Property
(Do not include previously listed resources in the count.)

Contributing	Noncontributing	
1		_____ buildings
		_____ sites
		_____ structures
		_____ objects
1		_____ Total

Name of related multiple property listing
(Enter "N/A" if property is not part of a multiple property listing.)
Plantation houses of the Alabama Canebrake
and associated outbuildings (1818-1942)

**Number of contributing resources previously listed
in the National Register**
0

6. Function or Use

Historic Functions
(Enter categories from instructions)

Domestic/single dwelling

Current Functions
(Enter categories from instructions)

Domestic/single dwelling

7. Description

Architectural Classification
(Enter categories from instructions)

Other: Tidewater cottage

Materials
(Enter categories from instructions)

foundation Brick
walls Log

roof Asbestos
other

Narrative Description

(Describe the historic and current condition of the property on one or more continuation sheets.)

8. Statement of Significance

Applicable National Register Criteria

(Mark "x" in one or more boxes for the criteria qualifying the property for National Register listing.)

- A Property is associated with events that have made a significant contribution to the broad patterns of our history.
- B Property is associated with the lives of persons significant in our past.
- C Property embodies the distinctive characteristics of a type, period, or method of construction or represents the work of a master, or possesses high artistic values, or represents a significant and distinguishable entity whose components lack individual distinction.
- D Property has yielded, or is likely to yield, information important in prehistory or history.

Criteria Considerations
(Mark "x" in all the boxes that apply.)

Property is:

- A owned by a religious institution or used for religious purposes.
- B removed from its original location.
- C a birthplace or grave.
- D a cemetery.
- E a reconstructed building, object, or structure.
- F a commemorative property.
- G less than 50 years of age or achieved significance within the past 50 years.

Narrative Statement of Significance
(Explain the significance of the property on one or more continuation sheets.)

9. Major Bibliographical References

Bibliography

(Cite the books, articles, and other sources used in preparing this form on one or more continuation sheets.)

Previous documentation on file (NPS): N/A

- preliminary determination of individual listing (36 CFR 67) has been requested
- previously listed in the National Register
- previously determined eligible by the National Register
- designated a National Historic Landmark
- recorded by Historic American Buildings Survey
- recorded by Historic American Engineering Record # _____

Areas of Significance

(Enter categories from instructions)

Architecture

Period of Significance

c. 1836

Significant Dates

c. 1836

Significant Person

(Complete if Criterion B is marked above)

N/A

Cultural Affiliation

N/A

Architect/Builder

N/A

Primary location of additional data:

- State Historic Preservation Office
- Other State agency
- Federal agency
- Local government
- University
- Other

Name of repository:

United States Department of the Interior
National Park ServiceNational Register of Historic Places
Continuation SheetSection number 7 Page 1Altwood
Marengo County, Alabama

Resting at the end of a long drive, Altwood is a rare and significant example of a vernacular interpretation of the Tidewater cottage. Constructed circa 1836 by Richard Henry and Anna Carter (Harrison) Adams, Altwood was acquired in 1987 by Dr. and Mrs. Jim Rankin through the auspices of the Alabama Historical Commission's Endangered Landmarks Program. In order to ensure its survival the house was moved approximately four miles to its present site in 1988 and is presently undergoing an extensive renovation. The structure was re-located in a rural setting, similar to its original site, on the edge of extensive farmlands and pasture. Too, the structure retains its original orientation, facing due south.

Altwood, in regard to construction, was at one time, a log dogtrot structure. Soon after initial construction, however, probably in a matter of weeks, the exterior was covered in weatherboarding and the dogtrot was enclosed to create a central hallway. At Altwood, the intent was never to create a dogtrot house but merely to utilize the construction methods for the framing of the house. The structure rests on brick piers. The one and a half story cottage features a side gable roof with three dormer windows and end chimneys (reconstructed). The roof material is standing seam metal. The facade (south) contains five bays with a centrally placed, double leaf entrance. The paneled doors are enframed by a full transom and sidelights. The windows contain 6/9 double hung sash windows (replacements). The original porch has been removed but a porch following the lines of the original, is being reproduced. On each side elevation, the chimneys are flanked by upper story windows. A rear addition, following the lines and dimensions of the rear porch, was constructed in 1988 soon after the structure's removal to its present site. The sympathetic addition features a shed style roof.

The interior of Altwood contains a central hallway with small corner stair. The staircase features paneled wainscoting. The hallway is 18' x 19' and the ceilings are approximately 9' in height. A rear double leaf entrance with a simple transom is located at the rear of the hallway. All of the rooms of the original section of Altwood are plastered. The flanking rooms are each 21' x 19' and feature delicate Federal style mantles. The south walls each feature two windows while the rear (north) wall feature a central single leaf entrance flanked on either side windows. The paneled doors, reflecting nice examples of early craftsmanship, are all original to the house. The upper or half story contains a central hallway, two large rooms, and a small closet room (original to the house) in the hallway. The rear addition contains a large kitchen/living area, a modern bathroom and utility area.

Although Altwood has been moved, it still retains much of its integrity of design, materials, craftsmanship, and feeling. Altwood is a significant example of the Tidewater cottage, a building form which is rare and one of the most threatened historic resources in the state of Alabama.

United States Department of the Interior
National Park ServiceNational Register of Historic Places
Continuation SheetSection number 8 Page 2 Altwood, Marengo County, Alabama**Statement of Significance****Criterion C: Architecture**

Altwood is a significant example of a local interpretation of a Tidewater Cottage. Constructed in 1836 as a log dogtrot structure, the dwelling was later modified into a dwelling reminiscent of the Tidewater cottages found along the eastern seaboard. This Tidewater cottage is reflective of the origins of its builder, Richard Henry and Anna Carter (Harrison) Adams who moved into the Alabama Canebrake from Charles City County, Virginia. The erection of a cottage of this type clearly reflects the transportation of certain architectural forms from the cultural hearths of the Atlantic seaboard to the frontier of Alabama. Altwood takes on increased significance due to the fact that most Tidewater cottages were constructed in the Tennessee valley; it is one of the few cottages of this type to be found in the Black Belt prairie and the only one still extant in the Canebrake region. The Tidewater-type cottage is one of Alabama's most threatened architectural resources.

Historical Summary

In the early 1830s, the Canebrake was the destination for a number of pioneers from the Charles City County, Virginia area including Richard Henry and Anna Carter (Harrison) Adams. In 1836, the couple purchased a plantation near the present day crossroad community of Faunsdale and erected a log dogtrot dwelling. The dwelling was later modified into the Tidewater-type cottage, Altwood. Adams was a leading planter and entrepreneur; he served on the board of directors for the Alabama and Mississippi Rivers Railroad. According to the 1860 Census, his plantation consisted of 860 acres and was worked by 88 slaves; his personal property and real estate were worth a combined total of \$320,400. The Altwood property descended through the family until the 1980s when Louise Minge Cameron donated the plantation house to the Alabama Historical Commission's Endangered Landmarks Program. In 1987, Dr. and Mrs. Jim Rankin acquired the property, relocated the structure to ensure its survival, and began an extensive but sympathetic restoration.¹

Criteria Considerations: B

Altwood derives its primary significance from its architecture. As one of Alabama's few remaining examples of the Tidewater-type cottage, Altwood is a significant building illustrating the transportation of particular house forms from the eastern seaboard to the Alabama frontier and the perpetuation and popularity of this type as a building form. Altwood is significant as a finished log structure that has retained a high degree of integrity including design, materials, craftsmanship, and feeling. Due to abandonment and neglect at its original location, the house had to be moved to ensure its survival. The integrity of the building was not compromised and its new location is very similar to its original: a rural setting with a north-south orientation.

¹John Witherspoon Dubose, "Chronicles of the Canebrake," Alabama Historical Quarterly, Winter Issue 1947, pp. 595-596. Sixth Federal Census of the United States, Marengo County. Robert S. Gamble, "Endangered Aristocrats," Alabama Heritage, Winter, 1992, p. 22-30.

United States Department of the Interior
National Park Service

National Register of Historic Places Continuation Sheet

Section number 10 Page 3

Altwood
Marengo County, Alabama

Verbal Boundary Description

Those three acres lying in the eastern half of the southern half of the western half of the southwest quarter of Section 22, Township 17 north, Range 4 east, being that land conveyed by deed from John Rankin of Cedar Crest Farms to Dr. Jim and Amy Rankin in 1988. For exact boundaries, please see tax map.

Boundary Justification

The boundary was drawn to include the present site of Altwood.

United States Department of the Interior
National Park Service

**National Register of Historic Places
Continuation Sheet**

Section number _____ Photographs _____ Page 4

Altwood
Marengo County, Alabama

Photographs

For Photographs 1-11, the information in sections 1-5 is the same:

1. Altwood
 2. Faunsdale vicinity, Marengo County, Alabama
 3. Jeff Mansell, photographer
 4. Negatives on file, Alabama Historical Commission
 5. August 8, 1991
 6. Front facade, camera facing north
 7. Photograph #1
-
6. Front facade, camera facing north
 7. Photograph #2
-
6. Front facade and southeast corner, camera facing northwest
 7. Photograph #3
-
6. Front facade and southwest corner, camera facing northeast
 7. Photograph #4
-
6. Rear elevation, northwest corner, camera facing southeast
 7. Photograph #5
-
6. Window, front facade
 7. Photograph #6
-
6. Interior, detail of fireplace mantle in left (east) room
 7. Photograph #7
-
6. Interior, hallway facing north, detail of rear entrance and staircase
 7. Photograph #8
-
6. Interior, hallway facing northeast, detail of staircase
 7. Photograph #9
-
6. Interior, detail of door in right (east) room
 7. Photograph #10
-
6. Interior, detail of upper story, left (west) room
 7. Photograph #11

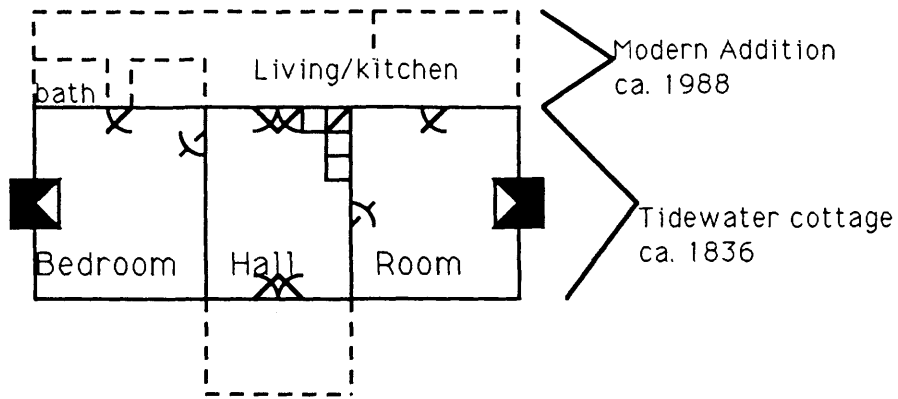

First Floor plan - not to scale

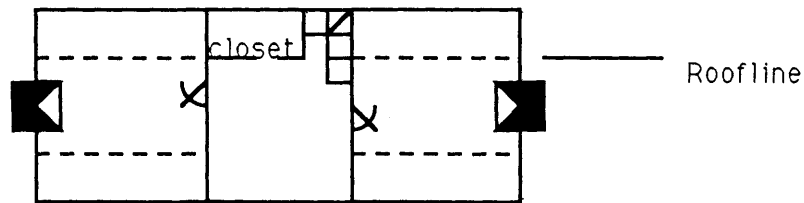

Second floor plan

Altwood
Plan

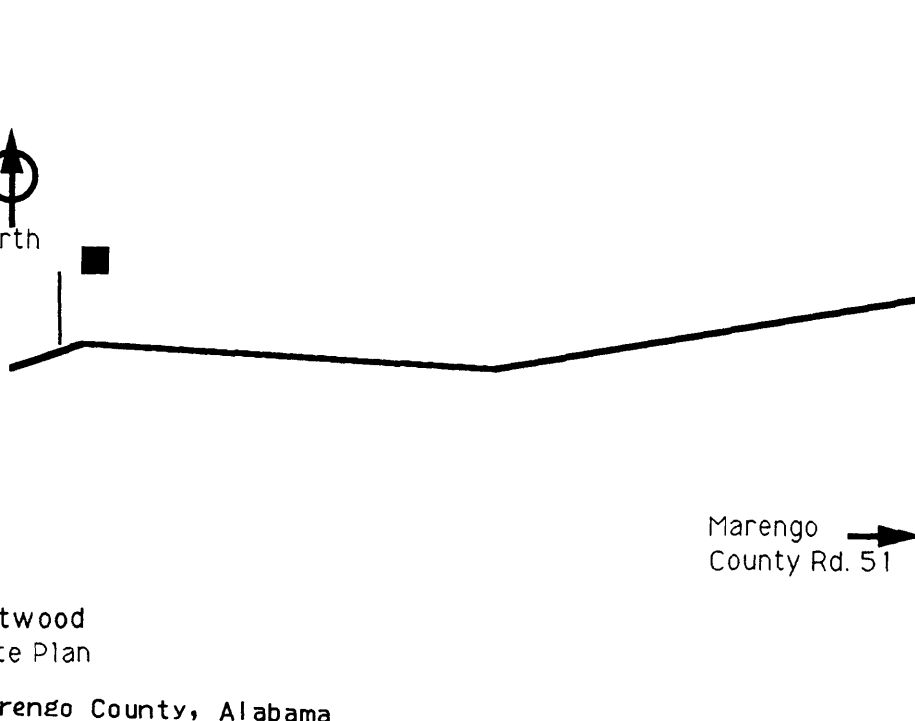

Altwood
Site Plan

Marengo County, Alabama

T 17 N - R 4 E 1/4 = 1 mile² Altwood MARENGO COUNTY, ALABAMA T 17 N - R 5 E

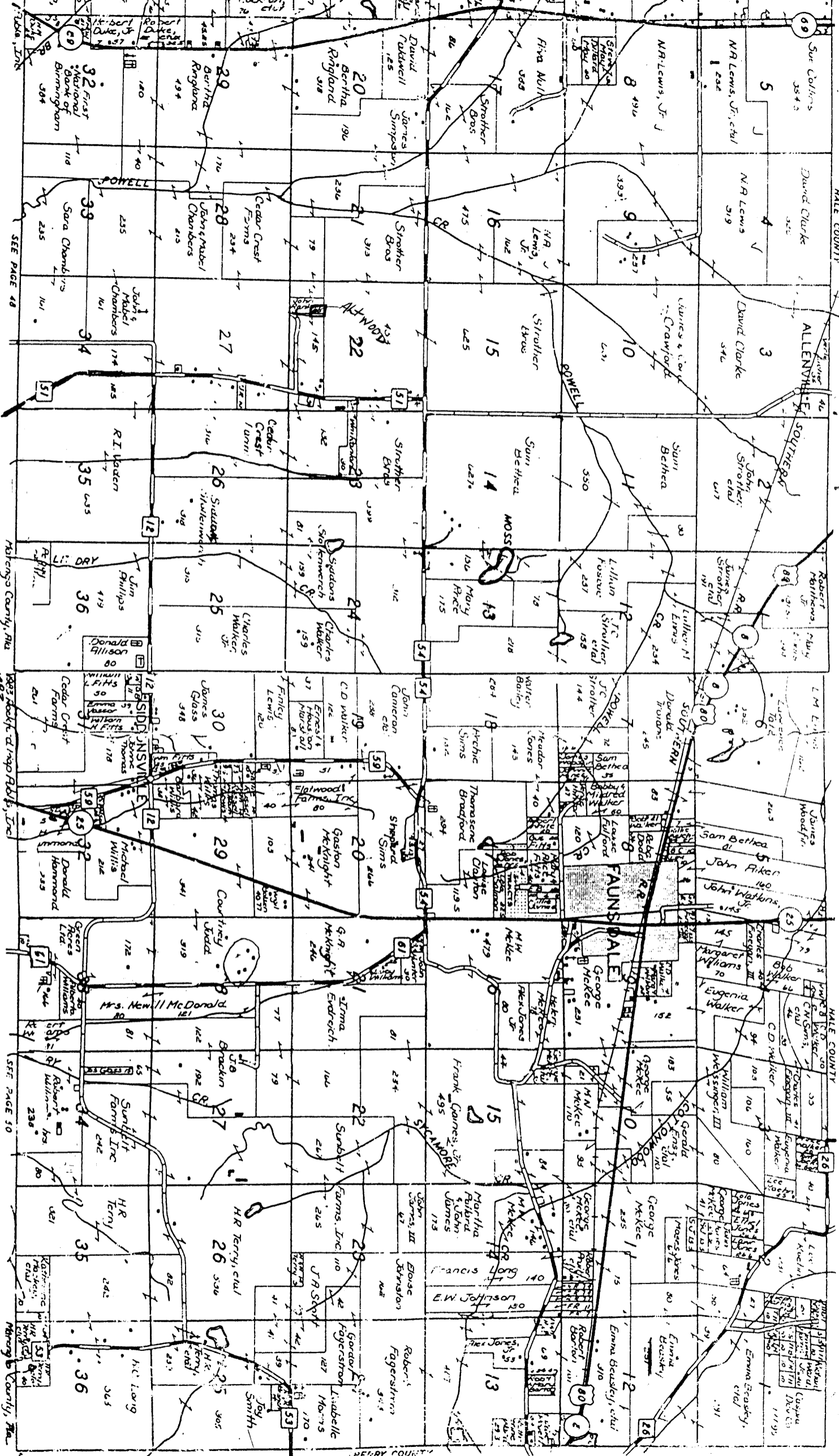

SEE PAGE 48 SEE PAGE 49 SEE PAGE 50