

642

RECEIVED  
APR 27 1992  
NATIONAL REGISTER

United States Department of the Interior  
National Park Service

National Register of Historic Places  
Registration Form

This form is for use in nominating or requesting determinations of eligibility for individual properties or districts. See instructions in Guidelines for Completing National Register Forms (National Register Bulletin 16). Complete each item by marking "x" in the appropriate box or by entering the requested information. If an item does not apply to the property being documented, enter "N/A" for "not applicable." For functions, styles, materials, and areas of significance, enter only the categories and subcategories listed in the instructions. For additional space use continuation sheets (Form 10-900a). Type all entries.

1. Name of Property

historic name Jay Cooke State Park CCC/WPA/Rustic Style Service Yard  
other names/site number Jay Cooke State Park

2. Location

street & number off Minnesota Highway 210  not for publication N/A  
city, town Twin Lakes Township Carlton  vicinity  
state Minnesota code MN county Carlton code 017 zip code 56718

3. Classification

Ownership of Property	Category of Property	Number of Resources within Property	
<input type="checkbox"/> private	<input type="checkbox"/> building(s)	Contributing	Noncontributing
<input type="checkbox"/> public-local	<input checked="" type="checkbox"/> district	2	1 buildings
<input checked="" type="checkbox"/> public-State	<input type="checkbox"/> site		sites
<input type="checkbox"/> public-Federal	<input type="checkbox"/> structure		structures
	<input type="checkbox"/> object		objects
		2	1 Total

Name of related multiple property listing:  
Minnesota State Park CCC/WPA/Rustic Style  
Historic Resources

Number of contributing resources previously listed in the National Register 0

4. State/Federal Agency Certification

As the designated authority under the National Historic Preservation Act of 1966, as amended, I hereby certify that this  nomination  request for determination of eligibility meets the documentation standards for registering properties in the National Register of Historic Places and meets the procedural and professional requirements set forth in 36 CFR Part 60. In my opinion, the property  meets  does not meet the National Register criteria.  See continuation sheet.

Signature of certifying official: Ian R. Stewart, Deputy State Historic Preservation Officer

Date: 4/20/92

State or Federal agency and bureau Minnesota Historical Society

In my opinion, the property  meets  does not meet the National Register criteria.  See continuation sheet.

Signature of commenting or other official

Date

State or Federal agency and bureau

5. National Park Service Certification

I, hereby, certify that this property is:

- entered in the National Register.  See continuation sheet.
- determined eligible for the National Register.  See continuation sheet.
- determined not eligible for the National Register.
- removed from the National Register.
- other, (explain:)

Beth Poland

6/11/92

Signature of the Keeper

Date of Action

**6. Function or Use**

Historic Functions (enter categories from instructions)

RECREATION/Outdoor Recreation

LANDSCAPE/State Park

Current Functions (enter categories from instructions)

RECREATION/Outdoor Recreation

LANDSCAPE/State Park

**7. Description**

Architectural Classification

(enter categories from instructions)

Materials (enter categories from instructions)

foundation Stone

walls Stone

Frame

roof Asphalt

other

Other: NPS Rustic Architecture

Describe present and historic physical appearance.

See Continuation Sheets

United States Department of the Interior  
National Park ServiceNational Register of Historic Places  
Continuation SheetSection number 7 Page 1Jay Cooke State Park CCC/WPA/Rustic Style Service Yard  
Twin Lakes Township, Carlton County, MinnesotaDESCRIPTION

The Jay Cooke State Park CCC/WPA/Rustic Style Service Yard is a four acre area including two contributing buildings. One non-contributing building is also included. The Service Yard is located off Minnesota Highway 210 just to the east of both the Jay Cook State Park Historic District and Picnic Grounds. The park includes both sides of the St. Louis River which is a highly turbulent stream running through a very picturesque rock gorge. The gorge consists of basalt rock which is generally inclined 45 degrees from the horizontal and pitched toward the south. Additional rock formations are scattered throughout the park. Architects for the park buildings were from the National Park Service.

Department of Natural Resources building identification numbers are located after the name of each building.

1. Building: Custodian's Cabin 2-63 Builder: CCC  
Architect: O. Newstrom Date: 1934

The basic dimensions of the Custodian's Cabin are 32' x 24' but an 8'6" x 13'6" porch projects from the west facade creating an L-shaped building. The residence rests on a concrete foundation and is sheathed with 6" x 2" pine log siding installed in shiplap sheets. The gable roof is supported by brackets. All window openings are double hung. The interior consists of a living room, kitchen, two bedrooms, and a bath.

2. Building: Pump House 2-60 Builder: CCC  
Architect: National Park Service Date: 1935

The Pump House is a 12' x 13'6" structure built of dark native stone resting on a concrete foundation. The entrance door is constructed with 2 ply planks and strap iron hinges. A massive stone lintel is placed above the doorway. Two 4-light casement windows are found on the south facade and one is located on the west facade. The gable roof features projecting lookouts.

United States Department of the Interior  
National Park Service

National Register of Historic Places  
Continuation Sheet

Section number 7 Page 2 Jay Cooke State Park CCC/WPA/Rustic Style Service Yard  
Twin Lakes, Carlton County, Minnesota

---

3. Building: Garage 2-62 Builder: Unknown  
Architect: DNR Date: 1980s

The Garage is a rectangular frame structure capped by a gable roof. This building replaced the original garage which was a 26' x 22' structure sheathed with pine log siding. The present garage is non-contributing.

**8. Statement of Significance**

Certifying official has considered the significance of this property in relation to other properties:

nationally     statewide     locally

Applicable National Register Criteria     A     B     C     D

Criteria Considerations (Exceptions)     A     B     C     D     E     F     G

Areas of Significance (enter categories from instructions)

Architecture  
Landscape Architecture  
Government  
Recreation

Period of Significance

1934-35  
\_\_\_\_\_  
\_\_\_\_\_

Significant Dates

1934  
\_\_\_\_\_  
\_\_\_\_\_

Cultural Affiliation

N/A  
\_\_\_\_\_  
\_\_\_\_\_

Significant Person

N/A

Architect/Builder

National Park Service  
Civilian Conservation Corps  
Works Progress Administration

State significance of property, and justify criteria, criteria considerations, and areas and periods of significance noted above.

See Continuation Sheets

See continuation sheet

United States Department of the Interior  
National Park ServiceNational Register of Historic Places  
Continuation SheetSection number 8Page 1Jay Cooke State Park CCC/WPA/Rustic Style Service Yard  
Twin Lakes, Carlton County, MinnesotaSTATEMENT OF SIGNIFICANCE

The Jay Cooke State Park CCC/WPA/Rustic Style Service Yard is historically significant for its association with the social, political, and economic impact of the Great Depression and the subsequent development of the various Federal Relief Programs which were responsible for its construction. The Service Yard is also historically significant for its association with the development of Jay Cooke State Park, a major recreational facility which received intensive use from residents of the surrounding communities and the City of Duluth.

The Custodian's Cabin and the Pump House are architecturally significant as outstanding examples of Rustic Style construction based on National Park Service design philosophy. Even though the Pump House is located in the Service Yard out of public view, it is constructed with dark native gabbro which blends with the rocky gorge of the adjacent St. Louis River. The Custodian's Cabin is one of several buildings in the state park system constructed with log siding, which simulates full-log construction. Service Yards were often included in the parks which were established or expanded during the Depression Era in order to provide space for storage, maintenance, and a residence for the park superintendent. The National Park Service insisted that in exchange for federal assistance, the states had to guarantee that the parks would be maintained and properly administered. The landscape design for the Service Yard is architecturally significant as a part of an overall scheme which successfully organized the various areas of the park which had been previously scattered along the entire 7 mile park drive.

Jay Cooke State Park was established in 1915 when the St. Louis Power Company donated 2,350 acres of land for that purpose. Large scale development began in 1933 when C.C.C. Camp SP-2 occupied the park on June 22, 1933. This camp constructed the Swinging Bridge, the Service Yard, and began development of the Oldenburg Point Picnic Grounds. They were also involved in eliminating soil erosion and in landscaping the Skyline Parkway so that the road would blend with the natural setting. However, due to declining C.C.C. enrollment on a nationwide basis, this camp was one of three in Minnesota which were terminated unexpectedly in October 1935. At that point, the picnic shelter at Oldenburg Point was only about half finished. However, the Lake Shore C.C.C. Camp SP-18 located north of Duluth provided the manpower to finish a number of incomplete projects.

United States Department of the Interior  
National Park Service

## National Register of Historic Places Continuation Sheet

Section number 8 Page 2 Jay Cooke State Park CCC/WPA/Rustic Style Service Yard  
Twin Lakes, Carlton County, Minnesota

---

A second C.C.C. Camp SP-21 Company 1171 was established in the park in May 1939. This camp continued development at the park and rebuilt the Swinging Bridge and constructed the River Inn. This camp was terminated on March 25, 1942 just before the C.C.C. came to an end. The WPA was also active in the park on a limited basis and was mainly involved with road work.

**9. Major Bibliographical References**

Department of Conservation. Report of the Division of State Parks for October-November, 1935.  
Department of Natural Resources. Working Drawings and Specifications for the Buildings and Structures at Jay Cooke State Park. Bureau of Engineering. St. Paul, Minnesota.  
Fritzen, John. "The History of Fond du Lac and Jay Cooke State Park." St. Louis County Historical Society, 1962.  
Schwartz, George M. "The Geology of Jay Cooke State Park." The Conservation Volunteer. State of Minnesota. Minnesota State Park, Parkway and Recreational Area Study. 1938.

See continuation sheet

Previous documentation on file (NPS):

- preliminary determination of individual listing (36 CFR 67) has been requested
- previously listed in the National Register
- previously determined eligible by the National Register
- designated a National Historic Landmark
- recorded by Historic American Buildings Survey # \_\_\_\_\_
- recorded by Historic American Engineering Record # \_\_\_\_\_

Primary location of additional data:

- State historic preservation office
- Other State agency
- Federal agency
- Local government
- University
- Other

Specify repository: \_\_\_\_\_

**10. Geographical Data**

Acreage of property 4 Acres

UTM References

A 

1	5
---	---

5	4	9	9	5	0
---	---	---	---	---	---

5	1	6	7	5	0	0
---	---	---	---	---	---	---

  
Zone Easting Northing

B 

--	--

--	--	--	--	--	--

--	--	--	--	--	--	--

  
Zone Easting Northing

C 

--	--

--	--	--	--	--	--

--	--	--	--	--	--	--

D 

--	--

--	--	--	--	--	--

--	--	--	--	--	--	--

See continuation sheet

Verbal Boundary Description

The boundary for the Jay Cooke State Park CCC/WPA/Rustic Style Service Yard is shown on the accompanying map entitled, "Jay Cooke State Park."

See continuation sheet

Boundary Justification

The boundary includes the two buildings that have been historically associated with the property and that maintain historic integrity. The boundary defines an area of the park developed by the Federal Relief Programs.

See continuation sheet

**11. Form Prepared By**

name/title Rolf T. Anderson  
organization N/A date March 29, 1992  
street & number 212 West 36th Street telephone 612-824-7807  
city or town Minneapolis state Minnesota zip code 55408



United States Department of the Interior  
National Park Service

OCT 23 1992

# National Register of Historic Places Continuation Sheet

Section number 2 Page 1

---

Jay Cooke State Park CCC/WPA Rustic Style Service Yard (92000642)  
Carlton County, Minnesota

The township information is wrong on the form. Please change the township name to  
Thomson Township

  
Signature of certifying official

10/16/92  
date

Ian R. Stewart  
Deputy State Historic Preservation Officer

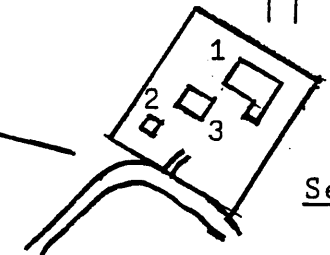
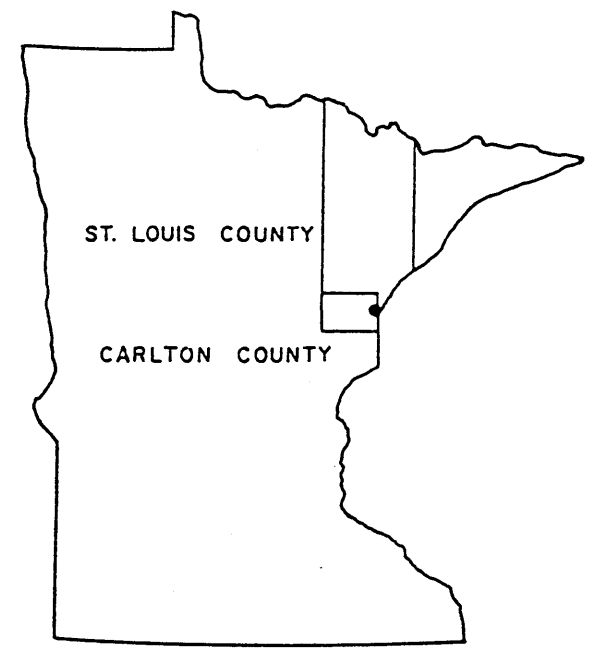
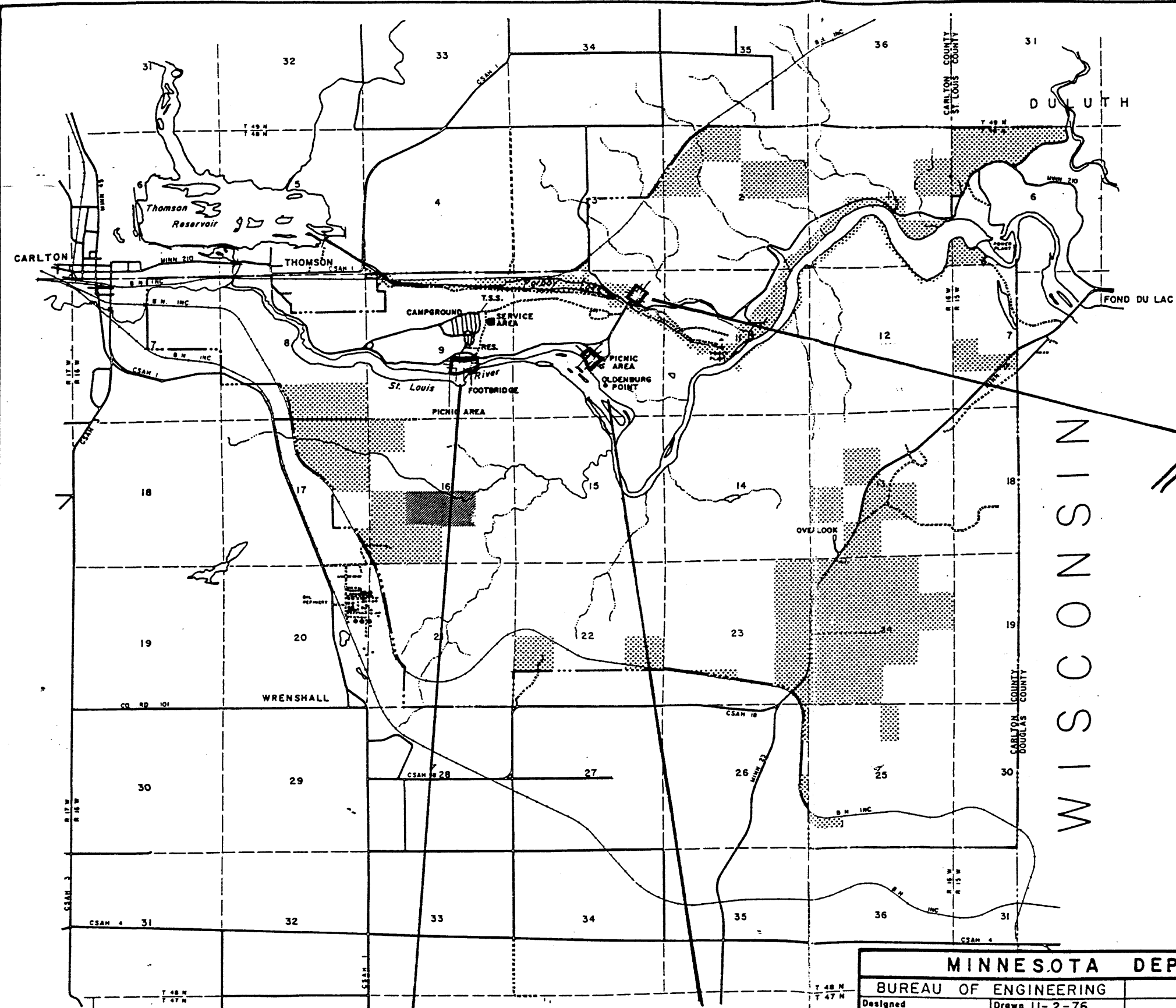

Service Yard

Historic District

- 1\* River Inn
- 2. Swinging Bridge

Picnic Grounds

- 1. Shelter
- 2. Water Tower & Latrine
- 3. Drinking Fountain

Service Yard

- 1. Custodian's Cabin
- 2. Pump House
- 3. Garage#

SCALE: 1" = 4000' \*Keyed to description  
 STATUTORY BOUNDARY 11266 AC. in nomination.

# non-contributing

Historic District

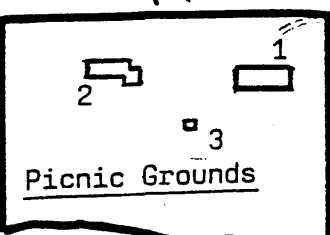
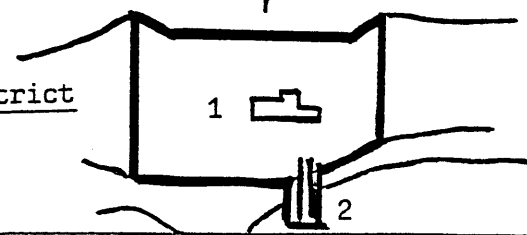

MINNESOTA DEPARTMENT OF NATURAL RESOURCES

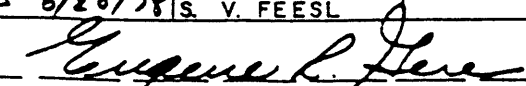
BUREAU OF ENGINEERING		DIVISION OF PARKS AND RECREATION	
Designed	Drawn 11-2-76 L. D. SWENSON	STATE PARK SITE MAP	
Survey	Checked 10-14-77 R. E. SMITH	<b>JAY COOKE STATE PARK</b> CARLTON & ST. LOUIS COUNTIES - NEAR DULUTH	
Ownership Revised	Revised 7-20-78 RES 6/20/78 S. V. FEESL		
Date	10-17-77	Sec. 326173	T. 48 N. R. 15 & 16 W. Sheet 15
 Administrator		Req. 74-7	File P.022.00.01

