

**United States Department of the Interior  
National Park Service**

**National Register of Historic Places  
Inventory—Nomination Form**

For NPS use only  
received  
date entered

Continuation sheet      DISTRICT DATA      Item number 4      Page 1

PROPERTY OWNERS - HISTORIC RESOURCES OF SOUTH HAMPTON, NEW HAMPSHIRE

✓ WOODMAN ROAD HISTORIC DISTRICT, *Woodman Rd.*

<u>SITE NO.</u>	<u>TAX MAP LOT</u>	<u>OWNER/ADDRESS</u>
55	C 3-3	Cornwell, Robert H. & Patricia Woodman Rd., RFD, So. Hampton, NH 03827
56	C 3-10A	Verge, Richard & Anne Woodman Rd., RFD, So. Hampton, NH 03827

**United States Department of the Interior  
National Park Service**

**National Register of Historic Places  
Inventory—Nomination Form**

For NPS use only  
received  
date entered

Continuation sheet

DISTRICT DATA

Item number

7

Page 1

Woodman Road District

Northeast of the Town Center District are two sites located along Woodman Road which form an architecturally unified district historically associated with South Hampton's nineteenth century agricultural development. The Woodman Road District includes two wooden, 2½ story, Greek Revival style houses which are sited on opposing sides of Woodman Road. Both structures were constructed in the mid-nineteenth century as part of agricultural complexes and retain a sufficient amount of open acreage to maintain their original character.

**United States Department of the Interior  
National Park Service**

**National Register of Historic Places  
Inventory—Nomination Form**

For NPS use only
received
date entered

Continuation sheet

DISTRICT DATA

Item number 8

Page 1

WOODMAN ROAD DISTRICT

The Woodman Road District centers on two vernacular Greek Revival farmhouses (Sites 55 + 56), constructed by the locally prominent Woodman family and remaining significant portions of their original acreage. The two houses closely resemble each other in their simplified detailing, gable-front orientation, and side hall plans. The earlier of the houses (Site 56) is significant for its association with the Free Will Baptists (who met here from 1830 to 1849), one of a multiplicity of religious sects which flourished in South Hampton in this period. The two houses, which maintain architectural and site integrity, are important for their association with the history of South Hampton in the first half of the nineteenth century.

**United States Department of the Interior  
National Park Service**

**National Register of Historic Places  
Inventory—Nomination Form**

For NPS use only  
received  
date entered

Continuation sheet      DISTRICT DATA      Item number 10      Page 1

NAME: The Woodman Road District

VERBAL BOUNDARY DESCRIPTION: The boundary of the Woodman Road District originates at a point co-terminus with the northeast corner of Site 55 (3-3) and the mid-line of Woodman Road. The boundary line then proceeds south along the mid-line of Woodman Road to a point perpendicular to the northern property line of Site 56 (3-10A). It then circles this property along the north, east and south borders to the mid-line of Woodman Road and follows the center line north to a point perpendicular with the corner of Site 55 (3-3). The district boundary then traces the property line of Site 55 (3-3) southwest, due west, northeast, and due east to the point of origin at the mid-line of Woodman Road.

BOUNDARY JUSTIFICATION: The boundaries of the Woodman Road District encompass the two Greek Revival farm complexes and the surviving acreage historically owned by the Woodman family.

Acreage: 6.46

Quadrangle name: Exeter, NH-MASS.

Quadrangle scale: 1:24000

UTM references:

	ZONE	EASTING	NORTHING
A	19	3-41-860	47-49-770
B	19	3-41-720	47-49-720
C	19	3-41-690	47-49-800
D	19	3-41-510	47-49-720
E	19	3-41-530	47-49-910
F	19	3-41-680	47-49-910
G	19	3-41-680	47-49-870
H	19	3-41-840	47-49-880

United States Department of the Interior  
National Park Service

National Register of Historic Places  
Inventory—Nomination Form

For NPS use only  
received  
date entered

Continuation sheet

DISTRICT DATA

Item number

Page

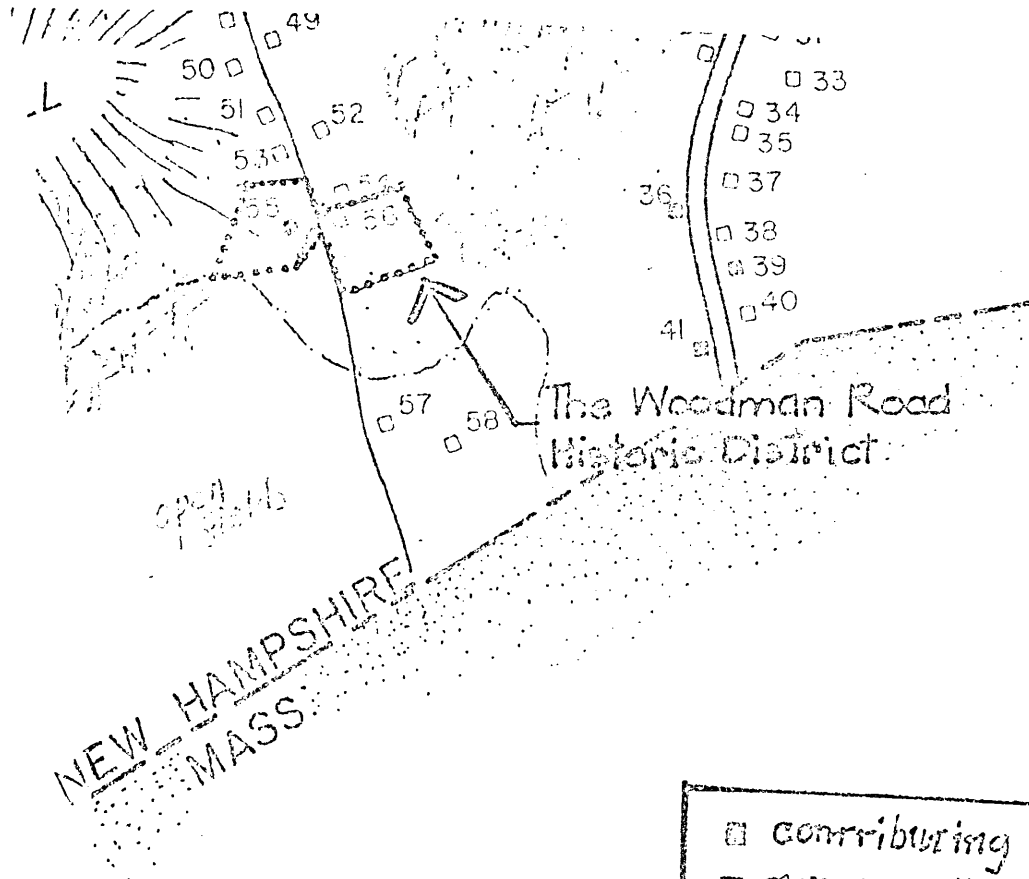

- contributing
- non-contributing
- intrusion
- EL Empty lot
- B bridge



Stratford Rockingham Regional Council

99 Water Street, Exeter, New Hampshire

Phone: (603) 778-0885

*Contributing*

TOWN: South Hampton	COUNTY: Rockingham	UTM: Z 19 / E 341605 / W 4749855
SURVEY NUMBER: 55		USGS QUAD: Exeter Quad 7.5' Series
COMMON NAME: Cornwell House		FUNCTIONAL TYPE: Farmhouse
HISTORIC NAME: Woodman House		PRESENT USE: Residential
LOCATION: West side of Woodman Road .8 miles south of Highland Road		ARCHITECT/BUILDER: Unknown
OWNER: Robert Cornwell		CONDITION: Exc. Good Fairly Poor Ruins
ADDRESS: Woodman Road South Hampton, NH.		INTEGRITY: Original Site <input checked="" type="checkbox"/> Moved <input type="checkbox"/> (When: )
MAP & PARCEL #: 3-3		Major alterations & date: Original clapboard siding has been covered with asphalt shingles Date Unknown
DATE: c. 1850		LEVEL/SIGNIFICANCE: Natl <input type="checkbox"/> State <input type="checkbox"/> Local <input checked="" type="checkbox"/>
SOURCE: Herb Bubert Scott Novak		
STYLE: Greek Revival/Italianate		

GENERAL DESCRIPTION: Structural System

- FOUNDATION: Stone  Brick  Concrete  Concrete Block
- WALL STRUCTURE: Wood Frame  Post & Beam  Balloon Frame  Other   
Load Bearing Masonry  Stone  Brick  Concrete Block  Other   
Metal  Iron  Steel  Other
- WALL COVERING: Clapboard  Wood Shingle  Board & Batten  Shiplap  Aluminum   
Novelty  Stucco  Stone  Brick  Sheet Metal  Asphalt Shingles  Vinyl   
Asphalt Sheeting  Composite Board  Other
- ROOF SHEATHING: Wood Shingle  Asphalt Shingle  Standing Seam Tin  Slate   
Pressed Metal  Sheet Metal  Rolled Asphalt  Other
- ENGINEERING STRUCTURE:
- OTHER:  
# of Stories 2 1/2 # of Bays 3x3 Approx. Dimensions 24' x 30' M.B.  
Roof Style: Gable  Hip  Gambrel  Flat  Shed  Mansard  Jerkinhead   
Monitor  Sawtooth  Other   
Appendages: Porches 1 Towers  Dormers 1 Bay Windows  Ells 2 Chimneys 2  
Wings  Cupolas  Sheds  Garage 2 Other   
Entry Location: Center  Sidehall  Other

MAP (Indicate North in circle):

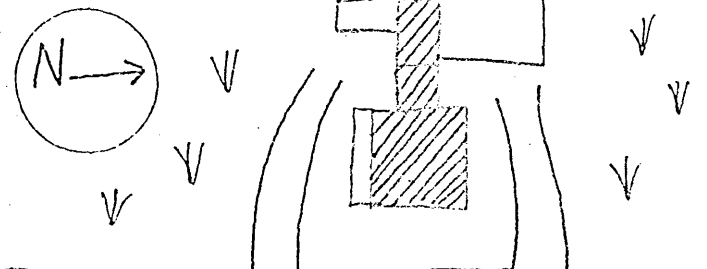

WOODMAN ROAD

56

PHOTO

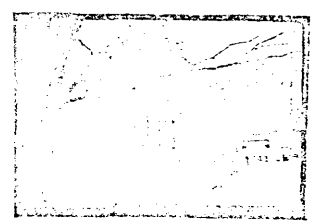

Description of View: Front (east)  
Side (north)

Photographer: Scott Novak  
Negative with: S.R.R.C.  
Negative File Number: SH-79-4-c/#18

ADDITIONAL ARCHITECTURAL AND STRUCTURAL DESCRIPTION:

Built c. 1850, this is basically a Greek Revival structure which through later alterations has obtained a trace of Italianate detail. Greek Revival elements of this house include: the gable end facing the street; a recessed sidehall entry; a four-panel door with sidelights extending its full height; and pilasters supporting a partial entablature.

The Italianate influence is demonstrated by the use of brackets under the projecting raking eaves and partial entablature.

Other features include; a boxed cornice on the raking eaves, six-over-six windows with projecting caps; shutters on the south side windows; an enclosed porch to the south, and two ells with gable roofs.

RELATED STRUCTURES AND CONTEXT:

BOUNDARY AND ACREAGE DESCRIPTION:

Four acres bounded on the north-Flett, east-Wallem, and Woodman Road, south-Wallem and west-Wallem.

REFERENCES:

STATEMENT OF SIGNIFICANCE (Evaluation & Historical Associations):

The Cornwell house is a blend of Greek Revival and Italianate elements of style. This house combines with the Boswell House to the east to form a visual anchor along this section of Woodman Road.

Surrounded by open land, it stands as a visual reminder of South Hampton's agricultural heritage.

The 1892 map indicates that the owner of the home was Mrs. A. Woodman.

SURROUNDING ENVIRONMENT: Open Land  Woodland  Scattered Bldgs  Moderately Built Up   
Densely Built Up  Residential  Commercial  Industrial  Agricultural   
Roadside Strip Development  Other

Recorded By: Herb Bubert  
Scott Novak

Date: 2/8/79

99 Water Street, Exeter, New Hampshire

Phone: (603) 778-0895

*Contributing*

TOWN: South Hampton	COUNTY: Rockingham	UTM: 7 19 /E 341670	NR 4749840
SURVEY NUMBER: 56	USGS QUAD: Exeter Quad 7.5' Series	FUNCTIONAL TYPE: Farmhouse	
COMMON NAME: Verge House	HISTORIC NAME: Woodman Farm	PRESENT USE: Residential	
LOCATION: .3 miles S of inter. Woodman & Highland, E side of Woodman Road	ARCHITECT/BUILDER: Unknown	CONDITION: Exc. Good Fair <input checked="" type="checkbox"/> Poor Ruins	
OWNER: Richard Verge	ADDRESS: Woodman Road	INTEGRITY: Original Site <input checked="" type="checkbox"/> Moved (When: )	
ADDRESS: South Hampton, NH.	MAP & PARCEL #: 3-10A	Major alterations & date: Rear wall of ell and stairs refinished 1979	
DATE: c. 1830	SOURCE: Scott Novak Herb Bubert	LEVEL/SIGNIFICANCE: Natl State Local <input checked="" type="checkbox"/>	
STYLE: Queen Revival			

GENERAL DESCRIPTION: Structural System

- FOUNDATION: Stone  Brick \_\_\_ Concrete \_\_\_ Concrete Block \_\_\_
- WALL STRUCTURE: Wood Frame \_\_\_ Post & Beam  Ballon Frame \_\_\_ Other \_\_\_  
Load Bearing Masonry \_\_\_ Stone \_\_\_ Brick \_\_\_ Concrete Block \_\_\_ Other \_\_\_  
Metal \_\_\_ Iron \_\_\_ Steel \_\_\_ Other \_\_\_
- WALL COVERING: Clapboard \_\_\_ Wood Shingle \_\_\_ Board & Batten \_\_\_ Shiplap \_\_\_ Aluminum \_\_\_  
Novelty \_\_\_ Stucco \_\_\_ Stone \_\_\_ Brick \_\_\_ Sheet Metal \_\_\_ Asphalt Shingles  Vinyl \_\_\_  
Asphalt Sheeting \_\_\_ Composite Board \_\_\_ Other \_\_\_
- ROOF SHEATHING: Wood Shingle \_\_\_ Asphalt Shingle  Standing Seam Tin \_\_\_ Slate \_\_\_  
Pressed Metal \_\_\_ Sheet Metal \_\_\_ Rolled Asphalt \_\_\_ Other \_\_\_
- ENGINEERING STRUCTURE:
- OTHER:  
# of Stories 2 1/2 # of Bays 4x3 Approx. Dimensions 24' x 30' M.B.  
Roof Style: Gable  Hip \_\_\_ Gambrel \_\_\_ Flat \_\_\_ Shed \_\_\_ Mansard \_\_\_ Jerkinhead \_\_\_  
Monitor \_\_\_ Sawtooth \_\_\_ Other \_\_\_  
Appendages: Porches 2 Towers \_\_\_ Dormers 1 Bay Windows \_\_\_ Ells 1 Chimneys 2  
Wings \_\_\_ Cupolas \_\_\_ Sheds \_\_\_ Garage \_\_\_ Other \_\_\_  
Entry Location: Center \_\_\_ Sidehall  Other \_\_\_

MAP (Indicate North in circle):

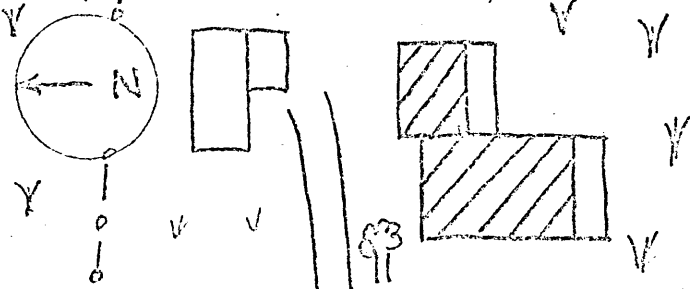

Woodman Rd.

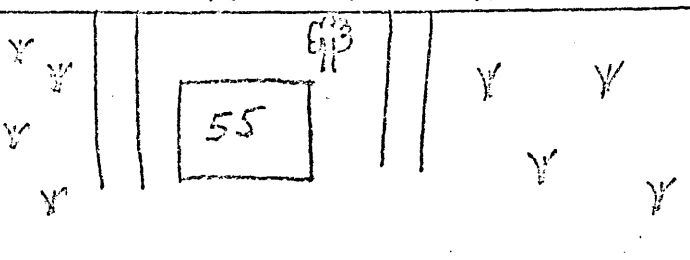

PHOTO

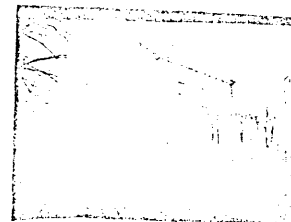

Description of View: Front (west)  
Side (north)

Photographer: Scott Novak  
Negative with: S.R.R.C.  
Negative File Number: SH-79-4-c/#19



ADDITIONAL ARCHITECTURAL AND STRUCTURAL DESCRIPTION:

Broad and heavy in appearance, with its gable end facing the street, the Verge house was built in the Greek Revival style. Its architectural integrity has been affected though, by various alterations and additions to the original structure in particular, the application of asphalt sheeting over the original clapboards. Features of this house include: a sidehall entrance with a four-panel door; sidelights set back within a screened porch; two over two windows with plain surrounds; a boxed cornice with a decorated frieze; and a triangular pediment in the gable end.

RELATED STRUCTURES AND CONTEXT:

Newly redone board & batten barn with old fieldstone foundation. Large sliding doors on barn. 2 car garage attached to barn.

BOUNDARY AND ACREAGE DESCRIPTION: 3 Acres. Bounded to the N. by Merrill, E. by Boswell, S. by Boswell and W. by Woodman Road.

REFERENCES:

STATEMENT OF SIGNIFICANCE (Evaluation & Historical Associations):

This house was once a working farm and maintains that character. It sits on 25 acres of open and once agricultural land. Greek Revival features remaining include: the pedimented gable end oriented toward the street; the sidehall entry; and the four-panel Greek Revival doors. This house was used as a meeting place by the Free Will Baptists between 1830 and 1849, during which time it was the home of Mrs. Dorothy Woodman. The Free Will Baptists disbanded in 1849.

SURROUNDING ENVIRONMENT: Open Land  Woodland  Scattered Bldgs  Moderately Built Up   
Densely Built Up  Residential  Commercial  Industrial  Agricultural   
Roadside Strip Development  Other

Recorded By: Herb Bubert  
Scott Novak

Date: 2/8/79

United States Department of the Interior  
National Park Service

National Register of Historic Places  
Inventory—Nomination Form



Continuation sheet

Item number

Page

12/1

Multiple Resource Area  
Thematic Group

dnr-11

Name South Hampton Multiple Resource Area  
State New Hampshire

Nomination/Type of Review

Date/Signature

- |     |                                  |                                     |        |                                |
|-----|----------------------------------|-------------------------------------|--------|--------------------------------|
| 1.  | Town Center Historic District    | Substantive Review                  | Keeper | <u>Ronnie Lee Boyd 4/11/83</u> |
|     |                                  |                                     | Attest | _____                          |
| 2.  | Smith's Corner Historic District | Entered in the<br>National Register | Keeper | <u>Melrose Byers 4/11/83</u>   |
|     |                                  |                                     | Attest | _____                          |
| 3.  | Woodman Road Historic District   | Substantive Review                  | Keeper | <u>Ronnie Lee Boyd 4/11/83</u> |
|     |                                  |                                     | Attest | _____                          |
| 4.  | Highland Road Historic District  | Entered in the<br>National Register | Keeper | <u>Melrose Byers 4/11/83</u>   |
|     |                                  |                                     | Attest | _____                          |
| 5.  | Jewell Town District             | Substantive Review                  | Keeper | <u>Ronnie Lee Boyd 4/11/83</u> |
|     |                                  |                                     | Attest | _____                          |
| 6.  | Currier, Capt. Jonathan, House   | Entered in the<br>National Register | Keeper | <u>Melrose Byers 4/11/83</u>   |
|     |                                  |                                     | Attest | _____                          |
| 7.  |                                  |                                     | Keeper | _____                          |
|     |                                  |                                     | Attest | _____                          |
| 8.  |                                  |                                     | Keeper | _____                          |
|     |                                  |                                     | Attest | _____                          |
| 9.  |                                  |                                     | Keeper | _____                          |
|     |                                  |                                     | Attest | _____                          |
| 10. |                                  |                                     | Keeper | _____                          |
|     |                                  |                                     | Attest | _____                          |