

United States Department of the Interior  
National Park Service



514

# National Register of Historic Places Registration Form

This form is for use in nominating or requesting determinations for individual properties and districts. See instructions in National Register Bulletin *How to Complete the National Register of Historic Places Registration Form*. If any item does not apply to the property being documented, enter "N/A" for "not applicable." For functions, architectural classification, materials, and areas of significance, enter only categories and subcategories from the instructions. Place additional certification comments, entries, and narrative items on continuation sheets if needed (NPS Form 10-900a).

## 1. Name of Property

Historic name Olathe Cemetery  
Other names/site number Olathe City Cemetery; Olathe Memorial Cemetery; KHRI #091-3745  
Name of related Multiple Property Listing New Deal-era Resources of Kansas

## 2. Location

Street & number 738 N. Chestnut Street not for publication  
City or town Olathe vicinity  
State Kansas Code KS County Johnson Code 091 Zip code 66061

## 3. State/Federal Agency Certification

As the designated authority under the National Historic Preservation Act, as amended,

I hereby certify that this  nomination \_\_\_ request for determination of eligibility meets the documentation standards for registering properties in the National Register of Historic Places and meets the procedural and professional requirements set forth in 36 CFR Part 60.

In my opinion, the property  meets \_\_\_ does not meet the National Register Criteria. I recommend that this property be considered significant at the following level(s) of significance:

national  statewide  local Applicable National Register Criteria:  A  B  C  D

*Patrick Zollner*  
Signature of certifying official/Title

Patrick Zollner, Deputy SHPO

11-21-16  
Date

Kansas State Historical Society

State or Federal agency/bureau or Tribal Government

In my opinion, the property \_\_\_ meets \_\_\_ does not meet the National Register criteria.

Signature of commenting official

Date

Title

State or Federal agency/bureau or Tribal Government

## 4. National Park Service Certification

I hereby certify that this property is:

entered in the National Register

\_\_\_ determined eligible for the National Register

\_\_\_ determined not eligible for the National Register

\_\_\_ removed from the National Register

\_\_\_ other (explain:)

*Alexis O'Keefe*  
Signature of the Keeper

1-11-17  
Date of Action

Date of Action

Olathe Cemetery  
Name of Property

Johnson County, Kansas  
County and State

**5. Classification**

**Ownership of Property**  
(Check as many boxes as apply.)

**Category of Property**  
(Check only **one** box.)

**Number of Resources within Property**  
(Do not include previously listed resources in the count.)

<input type="checkbox"/>	private
<input checked="" type="checkbox"/>	public - Local
<input type="checkbox"/>	public - State
<input type="checkbox"/>	public - Federal

<input type="checkbox"/>	building(s)
<input type="checkbox"/>	district
<input checked="" type="checkbox"/>	site
<input type="checkbox"/>	structure
<input type="checkbox"/>	object

<u>Contributing</u>	<u>Noncontributing</u>	
1	1	buildings
1	0	sites
2	0	structures
3	0	objects
<b>7</b>	<b>1</b>	<b>Total</b>

**Number of contributing resources previously listed in the National Register**

0

**6. Function or Use**

**Historic Functions**  
(Enter categories from instructions.)

**Current Functions**  
(Enter categories from instructions.)

FUNERARY: cemetery

FUNERARY: cemetery

**7. Description**

**Architectural Classification**  
(Enter categories from instructions.)

**Materials**  
(Enter categories from instructions.)

OTHER: cemetery

foundation: N/A

walls: Brick

Stone

roof: N/A

other: N/A

Olathe Cemetery

Name of Property

Johnson County, Kansas

County and State

---

## Narrative Description

### Summary

The Olathe Cemetery, now Olathe Memorial Cemetery, at 738 N. Chestnut Street is located in Olathe, the county seat of Johnson County, which is located in northeastern Kansas and a part of the Kansas City metropolitan area. The cemetery is situated north of downtown Olathe and is bounded by East Harold Street to the north, North Woodland Road to the east, a tree line and residential neighborhood to the south, and Northgate Street to the west (Figure 1). Access into the cemetery is from both Woodland Road and Chestnut Street. Established in 1865, the 26-acre site includes over 10,000 graves, several monuments and memorials, two mausoleums, and a former chapel. The cemetery grounds are intersected with historic paths and roads and surrounded by a modern metal fence. Despite some alterations, including the addition of a cremation garden at the south boundary in 2013, this cemetery retains many of its original features and remains eligible for listing in the National Register of Historic Places.

---

### Elaboration

The 26-acre Olathe Cemetery is roughly rectangular in plan. What began as a ten-acre burial ground in 1865 increased through three additions to gain its current form by ca. 1956 (Figure 2). The size increases resulted in two distinct, historic design patterns seen today (Figure 3). The original (northern) portion of the cemetery follows a more streamlined appearance with burials grouped in blocks within sections. This original portion of the cemetery is laid out in four rectangular sections of varying sizes and topped with a practically semicircular section. The first addition, constructed in 1879, consists of four rectangular sections similar to the original cemetery. Both portions feature straight pedestrian pathways that border gravestones arranged north-south in blocks. The southern portion, or second addition, was designed with semi-circular patterns, thus stones in this section are arranged in curves around the half circles. Pathways in this section also are arranged in semi-circular patterns. Numerous plantings of trees and bushes characterize the cemetery grounds. Varieties include native maple and even more rare trees such as Chinese Fringe and Dawn Redwood (Photos 2 & 23).

There are two entrances to the cemetery; one entrance is through the gate at North Chestnut Street and another entrance is located on North Woodland Road (Photos 18 & 19). The dates of the cemetery entrances are unknown, but it is likely the North Woodland Road entrance was created ca. 1880 during the first cemetery addition and the entrance at North Chestnut was added ca. 1890 during the second cemetery addition. The gateposts at the North Chestnut entrance originally were limestone. In ca. 1980, brick posts were installed and replaced the original limestone gateposts. A metal fence currently surrounds the entire property.

The city-owned cemetery contains approximately 10,592 graves. Primarily granite and marble, gravestones range from simple tablet and raised-top inscription types to pulpit and more elaborate obelisk types. There are several groups buried in the Olathe Cemetery. An area in the northeast portion of the cemetery known as Potter's Field contains graves of some of the earliest settlers in Olathe. The Baby's Circle, established in the 1950s, is located at the southern boundary (Photo 16). The Civil War Circle includes burials of soldiers who fought in the War Between States, while the World War I Circle includes World War I, World War II, Korean War, and Vietnam War veterans (Photos 10 & 14). The cemetery also features a governors section, and a section that includes late employees of Hyer Boot Company.

The Olathe Cemetery contains two war memorials, one Daughters of the American Revolution memorial, and two structures. Located in the Civil War Circle, the Grand Army of the Republic (G.A.R.) memorial, described as "fourteen feet high and costing \$1,000" was erected in 1893 by the Franklin Post No. 68, G.A.R. "in memory of our dead comrades" (Photo 14 & 15).<sup>1</sup> The second war memorial, located in the southeast portion of the cemetery, was erected in 1923. The Earl Collier Post of the American Legion and Veterans of Foreign Wars and citizens of Olathe erected the monument as a memorial to the soldiers and marines of the Spanish-American War and the World War (Photos 11 & 12).<sup>2</sup> By the 1920s, the cemetery featured two mausoleums. The Black Family Mausoleum, erected in 1912, is the oldest mausoleum in Johnson County (Photo 22).<sup>3</sup> The construction date of the Livermore Family Mausoleum, located at the southwest section of the cemetery, is unknown; however, the first Livermore family member was buried in the mausoleum in 1922 (Photo

---

<sup>1</sup> "Memorial Day in Olathe – 1933," *Olathe Mirror*, 1 June 1933. Collections of the Olathe Cemetery.

<sup>2</sup> "Earl Collier Memorial," *n.p.* 30 April 1925. Collections of the Olathe Cemetery. Available online, [http://www.olatheks.org/files/rec/Earl\\_Collier\\_Memorial1925.pdf](http://www.olatheks.org/files/rec/Earl_Collier_Memorial1925.pdf) (accessed 30 June 2016).

<sup>3</sup> Linda K. Lewis, "The Mausolea of Johnson County, Kansas," *Digital Cemetery*, 2007. Available online, <http://joco-ksgenweb.cottonhills.net/assets/files/books/joco%20mausolea.pdf> (accessed 30 June 2016).

Olathe Cemetery

Name of Property

Johnson County, Kansas

County and State

13).<sup>4</sup> In May 1934, "Memory Lane" was dedicated by the Daughters of the American Revolution (D.A.R.). This memorial lane consisted of 48 maple trees representing each of the 48 states, a granite boulder, and lilac bushes. At that time, maple trees stretched on both sides of the path from the World War Circle to the Civil War Circle. Unfortunately, the original "Memory Lane" maple trees were killed by multiple droughts and replanted three times by 1940.<sup>5</sup> In 2000, Memory Lane was re-dedicated with a new bench, new landscaping, and an illuminated flagpole. Many historic plantings of trees remain extant. Presently, the cemetery features over 250 trees with 30 of the trees included in the Olathe Garden and Civic Club's walking tree tour.<sup>6</sup>

As part of a 1937 Works Progress Administration (WPA) project, a shelter house was constructed of native limestone (Photos 4 through 6). The building originally featured a "small tool room, a built-in fire place, two modern crypt vaults for emergency use, and a large assembly room."<sup>7</sup> It is unknown if the shelter house originally featured a chapel or if the shelter house was converted into a chapel. However, by the 1980s, the shelter house was referred to as a cemetery chapel. In 1984, the chapel was renovated from storage area into the present cemetery office. Chapel renovations at that time included roof replacement, interior restoration, electrical work, and landscaping.

The most recent addition to the cemetery is the cremation garden (Photos 7 & 8). Added in 2013, the garden is situated on approximately a half acre near the Chestnut Street entrance and east of the shelter house/chapel. The cremation garden includes a columbarium/arbor ossuary, fountain burial stone, memorial boulders, pedestal memorial, memorial bench, and memorial wall.

### Integrity

The Olathe Cemetery retains integrity of location, design, setting, materials, workmanship, feeling, and association to convey its character as a twentieth-century cemetery. The cemetery retains its historic appearance with retention of its historic form and burial patterns. The roads and paths remain unchanged since the second cemetery addition was created ca. 1890. Historic entrances also are extant. Though Memory Lane was re-dedicated in 2000 with new landscaping, many historic plantings of trees within the cemetery remain extant and contribute to the historic park-like setting. Another alteration to the district that took place after the period of significance was the extension of the cemetery grounds for the cremation garden. However, the addition is located south of the original cemetery area; thus, it does not detract from the original cemetery grounds.

The City of Olathe has owned and maintained the cemetery since 1879. Currently, the Department of Parks and Recreation, City of Olathe, manages, operates, and maintains the cemetery. As a result, the vast majority of the individual markers and gravesites are intact and convey their significant age, associations, and information. Finally, contributing resources retain integrity of feeling and association as the cemetery continues to provide burials.

Individual resources include (Figure 5):

#### 091-3743. Civil War Memorial. 1893. Contributing object.

The 14 feet high Grand Army of the Republic (G.A.R.) memorial was erected by the Franklin Post No. 68, G.A.R. "in memory of our dead comrades." The gray stone monument features a statue of a Civil War soldier made of marble with a large granite base. The soldier is holding a rifle and is oriented west.

#### 091-3744. World War Memorial. 1926. Contributing object.

The Earl Collier Post of the American Legion and Veterans of Foreign Wars and citizens of Olathe erected the monument in 1926 as a memorial to the soldiers and marines of the Spanish-American War and the World War.<sup>8</sup> The full-length figure of a doughboy in bronze was cast by the American Art Bronze Company in Chicago and sculpted by John Paulding.<sup>9</sup>

<sup>4</sup> Ibid.

<sup>5</sup> "Beautify Memory Lane: Twenty-four Hard Maples Planted Under Sponsorship of the D.A.R.," n.p. 29 March 1940. Collections of the Olathe Cemetery. Available online, [http://cemetery.olatheks.org/pdf/Memory\\_Lane1940.pdf](http://cemetery.olatheks.org/pdf/Memory_Lane1940.pdf) (accessed 30 June 2016).

<sup>6</sup> The Olathe Garden and Civic Club, *Olathe Tree Tour 2: The Trees of Olathe Cemetery* (Olathe, n.p., 2016). Available online, <http://cemetery.olatheks.org/pdf/Tour-Tree.pdf>.

<sup>7</sup> "Cemetery Shelter House," n.p. 2 December 1937. Collections of the Olathe Cemetery. Available online, [http://www.olatheks.org/files/rec/Chapel\\_Construction1937.pdf](http://www.olatheks.org/files/rec/Chapel_Construction1937.pdf) (accessed 30 June 2016).

<sup>8</sup> "Earl Collier Memorial," n.p. 30 April 1925. Collections of the Olathe Cemetery. Available online, [http://www.olatheks.org/files/rec/Earl\\_Collier\\_Memorial1925.pdf](http://www.olatheks.org/files/rec/Earl_Collier_Memorial1925.pdf) (accessed 30 June 2016).

<sup>9</sup> Art Inventories Catalog, Smithsonian American Art Museum, Smithsonian Institution Research Information System (SIRIS), <http://siris.artinventories.si.edu/ipac20/ipac.jsp?session=1KL7241497B21.324&profile=ariall&uri=full=3100001~!334913~!10&ri=6&aspect=Brows>

Olathe Cemetery

Name of Property

Johnson County, Kansas

County and State

The figure stands on a square granite base. The soldier is dressed in a military uniform with helmet and boots, and holds a gun which rests on the square base.

**091-3746. Black Mausoleum. 1912. Contributing structure.**

The one-story Black Family Mausoleum is constructed of seven rows of rough granite blocks and is located in the original cemetery section. The date 1912 and inscription "Black" are centered directly above the crypt door on the south elevation.

**091-3747. Harvey Livermore Mausoleum. Ca. 1922. Contributing structure**

The Livermore Family Mausoleum was constructed with the vault partially below ground level and an earthen dome constructed above. A pyramid-shaped face features rough granite blocks, topped with a granite cross. "Livermore" is inscribed on the header block above the mausoleum door on the west elevation. Three steps descend to the door.

**091-3748. Shelter House/Chapel. 1937. Contributing building. New Deal-era Resource.**

The Shelter House/Chapel was constructed with native limestone in 1937 as part of the Works Progress Administration (WPA) project and renovated in 1984. The one-story, asymmetrical Mission-style chapel now houses the cemetery office. Oriented west, the building features an L-shaped footprint. The facade, located on the west elevation, has a parapet roof with a bell tower capped with brick trim. Two angel sculptures sit on each side of the bell tower. Two replacement doors are centered at this elevation. An opening with a replacement window also is located at the main elevation near the southwest corner of the chapel. An exterior chimney with bell tower cap is located at the gable wall of the south elevation, while a single opening with replacement door is located at the north elevation. Two original window openings are located at the east elevation; one appears resized while the other is obscured by vegetation. The roof is covered with asphalt shingles.

**091-3748a. Garage. Ca. 2000. Noncontributing building.**

The one-story detached garage is located just south of the Shelter House/Chapel. Oriented west, the garage features a side-gable roof, rectangular footprint, and metal rolling garage door. The building has a veneer stone facade and vertical plywood cladding on the remaining elevations. The roof is covered with asphalt shingles.

**091-3749a. Daughters of the American Revolution (D.A.R.) Memorial. 1934. Contributing object.**

The D.A.R. Memorial is located just northeast of the chapel. The red granite boulder features an original inscribed bronze plaque and modern plaque. The original plaque states "Memory Lane reverently dedicated to the memory of Daughters of Olathe Chapter Daughters of the American Revolution. May thirteenth 1934."

Olathe Cemetery  
Name of Property

Johnson County, Kansas  
County and State

**8. Statement of Significance**

**Applicable National Register Criteria**

(Mark "x" in one or more boxes for the criteria qualifying the property for National Register listing.)

- A Property is associated with events that have made a significant contribution to the broad patterns of our history.
- B Property is associated with the lives of persons significant in our past.
- C Property embodies the distinctive characteristics of a type, period, or method of construction or represents the work of a master, or possesses high artistic values, or represents a significant and distinguishable entity whose components lack individual distinction.
- D Property has yielded, or is likely to yield, information important in prehistory or history.

**Criteria Considerations**

(Mark "x" in all the boxes that apply.)  
Property is:

- A Owned by a religious institution or used for religious purposes.
- B removed from its original location.
- C a birthplace or grave.
- D a cemetery.
- E a reconstructed building, object, or structure.
- F a commemorative property.
- G less than 50 years old or achieving significance within the past 50 years.

**Areas of Significance**

Exploration/Settlement

**Period of Significance**

1865-1956

**Significant Dates**

1865 – first documented burial

1937 – Shelter House/Chapel constructed

**Significant Person**

(Complete only if Criterion B is marked above.)

N/A

**Cultural Affiliation**

N/A

**Architect/Builder**

Unknown

Works Progress Administration (WPA)

**Period of Significance (justification)**

The period of significance begins in 1865, the first burial, and ends in 1956, the date the original city park ground adjoining the cemetery was developed into the present Elmwood subdivision and the boundary of the cemetery was set.

**Criteria Considerations (justification)**

The cemetery meets the registration requirements for *Criteria Consideration D* as it reflects important aspects of Olathe's early history and contains graves of several persons of outstanding importance to the community.

Olathe Cemetery

Name of Property

Johnson County, Kansas

County and State

---

## Narrative Statement of Significance

### Summary

The Olathe Cemetery, now Olathe Memorial Cemetery, is one of four cemeteries located in Olathe: Family Cemetery (ca. 1855), Mt. Calvary Catholic Cemetery (1885), Oak Lawn Memorial Gardens Cemetery (1957), and Olathe Cemetery (1865).<sup>10</sup> While the small Family Cemetery with a final interment in 1898 appears to be the oldest private cemetery in Olathe, the Olathe Cemetery is the oldest public cemetery in Olathe and remains active today. The Olathe Cemetery is eligible for the National Register of Historic Places under Criterion A as it represents early exploration, settlement, and development in Olathe. The cemetery meets Criteria Consideration D as it reflects important aspects of Olathe's history and contains graves of several persons of outstanding importance. The Olathe Cemetery is the final resting place for many of Olathe's early settlers and local civic and economic leaders. Many of the cemetery grave markers are the only extant historic resource associated with these early town settlers and leaders; thus, the cemetery remains as a reflection of their contributions to the history of Johnson County. In 1937 the Works Progress Administration (WPA) improved the cemetery by adding stone entryways and a shelter house; only the shelter house remains today, but it represents a Social and Recreational property type defined in the *New Deal-era Resources of Kansas* multiple property nomination. The period of significance begins in 1865, the first burial, and ends in 1956, the date the original city park ground adjoining the cemetery was developed into the present Elmwood subdivision and the cemetery boundary was set.

---

### Elaboration

Established in 1865, Olathe resident Watts Beckwith plotted 10-acres of his private land for a city cemetery to alleviate crowding issues at Church Square, a non-extant and unplanned burial space in Olathe.<sup>11</sup> Church Square, located "only one-quarter of a mile from the business centre of town," comprised the six central lots of Block 11 and measured 163.5 feet by 272.5 feet.<sup>12</sup> According to John P. Edwards' 1886 Map of Olathe, Church Square was bound by Prairie (W. Prairie), Mulberry (W. Mulberry), Walnut (N. Walnut), and Willie (N. Willie) Streets. By 1868, Beckwith described the conditions at Church Square as a public square with "part of a fence and [a] few small broken trees" where cattle and horses ranged freely.<sup>13</sup> In lobbying for a new cemetery, Beckwith indicated that only a third of the "irregular and unauthorized" burials were located in Church Square as the remaining burials were located either in the street or on the east side of Block 12 (Kansas Avenue).<sup>14</sup> Beckwith, a gardener and florist born in New York, "laid out and opened the ground to the public" as he considered the cemetery "a public necessity," since "the authorities of Olathe, and Johnson county had neglected to make any provision for the burial of her dead."<sup>15</sup> Elvira Beckwith, sister of Watts Beckwith, was the first person to be buried in the cemetery on April 30, 1865. Elvira was the only member of the Beckwith family to be buried in the Olathe Cemetery.

According to the Map of Olathe Township of the 1874 *Atlas Map of Johnson County, Kansas*, the cemetery was depicted at the northeast corner of the northeast quarter of Watts Beckwith's land located just outside the Olathe city limits in Section 26, Township 13 South of Range 23.<sup>16</sup> Three orchards were sited just south of the cemetery (Figure 7). In 1879, the City of Olathe acquired the cemetery and five additional acres which eventually became the "First Addition of Olathe Cemetery" (Figure 8).<sup>17</sup> In June 1889, the city acquired eight additional acres "immediately south" of the cemetery which was platted by the City Engineer into "cemetery lots and block with streets and alleys" and recorded as "Plat of 2<sup>nd</sup> addition

---

<sup>10</sup> "Cemeteries." The Digital Cemetery, a JoCo History project. Accessed 29 June 2016, <http://cemetery.cottonhills.com/index.jsp>.

<sup>11</sup> Johnson County Records & Tax Administration (RTA), Plat 1 Page 22, Map of Olathe Cemetery, dated February 10, 1968, Johnson County, Kansas. Available online through subscription database, <http://www.jocogov.org/dept/records-and-tax-administration/home>.

<sup>12</sup> "Olathe Burial Grounds," *Olathe Mirror*, 3 January 1867. Available online through subscription database, [www.newspapers.com](http://www.newspapers.com) (accessed 19 September 2016).

<sup>13</sup> "Nuisances," *Olathe Mirror*, 24 September 1868. Available online through subscription database, [www.newspapers.com](http://www.newspapers.com) (accessed 19 September 2016).

<sup>14</sup> Ibid.

<sup>15</sup> "The Olathe Cemetery," n.p. ca. 1877. Collections of the Olathe Cemetery. Available online, [http://www.olatheks.org/files/rec/Watts\\_Beckwith\\_article1877.pdf](http://www.olatheks.org/files/rec/Watts_Beckwith_article1877.pdf) (accessed 30 June 2016); United States Federal Census, 1880.

<sup>16</sup> Olathe Township. Kansas City Lith'g Co. In *Atlas Map of Johnson County, Kansas*. Wyandotte, Kansas: E. F. Heisler & Co., 1874, pg42. Available online, [www.kansasmemory.org/item/223964](http://www.kansasmemory.org/item/223964) (Accessed 1 July 2016).

<sup>17</sup> John P. Edwards. *Edwards' Map of Johnson Co., Kansas*. Map. Quincy, IL: John P. Edwards, 1886. Available online, [www.kansasmemory.org/item/210670](http://www.kansasmemory.org/item/210670) (Accessed 1 July 2016); Johnson County Records & Tax Administration (RTA), Plat 2 Page 25, First Addition Olathe Cemetery, dated September 16, 1890, Johnson County, Kansas. Available online through subscription database, <http://www.jocogov.org/dept/records-and-tax-administration/home>.

Olathe Cemetery

Name of Property

Johnson County, Kansas

County and State

to Olathe Cemetery” in city records.<sup>18</sup> The *Standard Atlas of Johnson County, Kansas* in 1902 shows the cemetery containing a total of 23.4 acres and the former 20-acre orchards section now belonging to the City of Olathe (Figure 9).<sup>19</sup> This section eventually became a city park. A July 1907 *Olathe Mirror* article recounts a Fourth of July celebration in the “ground adjoining the cemetery” that was originally expected “to be used for cemetery purposes.”<sup>20</sup> The *Standard Atlas of Johnson County, Kansas* in 1922 shows the 20-acre section south of the cemetery as a park (Figure 10).<sup>21</sup>

In 1857, Dr. John T. Barton, born in Albemarle County, Virginia, founded Olathe. A town surveyor laid out the southeast quarter of Section 26 and the northeast quarter of Section 35, Township 13, Range 23 East into streets, alleys, lots, and blocks.<sup>22</sup> Olathe, the county-seat of Johnson County, was incorporated in 1857 and re-incorporated in 1858. The city is named after the Shawnee word for “beautiful.”<sup>23</sup>

According to William G. Cutler’s *History of the State of Kansas*, the first citizens of Olathe, were Jonathan Milliken, J.B. Whittier, Charles A. Osgood, C.M. Ott, J.H. Blake, John P. Campbell, S. F. Hill, Charles Mayo, Beattie Mahaffie, and Henderson Boggs.<sup>24</sup> Out of those ten settlers, six were buried in the Olathe Cemetery. Jonathan Milliken erected the first building in Olathe and was very active in encouraging immigrants to settle in the area.<sup>25</sup> He also was the first elected Assessor in Olathe Township.<sup>26</sup> Milliken was buried on July 11, 1917 located in Lot 60, N3, Block 1, Addition 2 (Photo 24).<sup>27</sup> C.M. Ott, born in Germany in 1835, erected the Olathe Roller Flour Mills and engaged in the mill business.<sup>28</sup> C.M. Ott was buried in 1907 in Lot 250, N1, Block 1, Addition 2 of the Olathe Cemetery.<sup>29</sup> J.H. Blake, born in North Carolina in 1831, was appointed County Clerk and ex-officio Recorder, then elected in 1858 to the office of Register of Deeds until 1862. After working in the mercantile business, he was elected County Treasurer in 1869, then worked as a cashier for the Peoples’ Savings Bank.<sup>30</sup> In 1910, J. H. Blake was buried in Lot 22, E2, Block 8, Addition 2 of the Olathe Cemetery.<sup>31</sup> S.F. Hill opened a dry goods and grocery store located on the west side of the town square and remained in business until his death in 1863 from consumption during the war.<sup>32</sup> S.F. Hill is buried in Block 106, W1, Lot 3, Addition 1 of the Olathe Cemetery.<sup>33</sup> J. Beattie Mahaffie, as discussed further below, came to Johnson County in 1857. Several years later, the “industrious and thriving farmer” raised more corn and wheat, and fed “more men than any other farmer in that day and age of Kansas.”<sup>34</sup> W. H. Boggs constructed the “Olathe House,” a hotel located on the west side of the town square.<sup>35</sup> W. H. Boggs was buried in July 1881 in Lot 1, W1, Block 138, Addition 1 of the Olathe Cemetery.<sup>36</sup>

<sup>18</sup> City of Olathe records, Regular Session City Counsel, 1 June 1889. Collections of the Olathe Cemetery; Johnson County Records & Tax Administration (RTA), Plat 2 Page 27, Second Addition to Olathe Cemetery, dated September 23, 1890, Johnson County, Kansas. Available online through subscription database, <http://www.jocogov.org/dept/records-and-tax-administration/home>.

<sup>19</sup> West Part of Olathe, County Seat of Johnson Co., Kansas. In *Standard Atlas of Johnson County, Kansas*. Chicago: Geo. A. Ogle & Co., 1902, pg5. Available online, [www.kansasmemory.org/item/209390](http://www.kansasmemory.org/item/209390) (Accessed 1 July 2016).

<sup>20</sup> “City Park,” *Olathe Mirror*, 11 July 1907. Collections of the Olathe Cemetery; Johnson County Records & Tax Administration (RTA), Plat 2 Page 31, The Johnson County Cemetery Park, dated June 30, 1888, Johnson County, Kansas. Available online through subscription database, <http://www.jocogov.org/dept/records-and-tax-administration/home>.

<sup>21</sup> West Part of Olathe, County Seat of Johnson Co., Kansas. In *Standard Atlas of Johnson County, Kansas*. Chicago: Geo. A. Ogle & Co., 1922, pg9. Available online, [www.kansasmemory.org/item/223951](http://www.kansasmemory.org/item/223951) (Accessed 1 July 2016).

<sup>22</sup> Ed Blair, *History of Johnson County, Kansas* (Lawrence: Standard Publishing Company, 1915), 86. Available online, <https://archive.org/details/historyofjohnson00blai>.

<sup>23</sup> “Origin of County Names,” in *Collections of the Kansas State Historical Society, 1901-1902*, Vol. VII, ed. Geo. W. Martin (Topeka: W. Y. Morgan, State Printing Office, 192), 472. Available online, <https://kshs.org/p/kansas-history/12443#khc> (accessed 1 July 2016).

<sup>24</sup> William G. Cutler, *The History of Johnson County, Kansas*, originally published by A. T. Andreas, 1883. (Higginsville, MO: Hearthstone Legacy Publications, 2009), 5.

<sup>25</sup> “The Santa Fe Trail in Johnson County,” in *Collections of the Kansas State Historical Society, 1909-1910*, Vol. XI, ed. Geo. W. Martin (Topeka: State Printing Office, 1910), 461. Available online, <https://kshs.org/p/kansas-history/12443#khc> (accessed 1 July 2016).

<sup>26</sup> Cutler, *The History of Johnson County, Kansas*, 44.

<sup>27</sup> *Olathe Cemetery*, Burial Search database, <http://cemetery.olatheks.org/burial-search/>.

<sup>28</sup> Oliver H. Gregg, History of Johnson County, *Atlas Map of Johnson County, Kansas* (Wyandotte, KS: E. F. Heisler & Co., 1874), 54.

<sup>29</sup> *Olathe Cemetery*, Burial Search database, <http://cemetery.olatheks.org/burial-search/>.

<sup>30</sup> Gregg, History of Johnson County, *Atlas Map of Johnson County, Kansas*, 59.

<sup>31</sup> *Olathe Cemetery*, Burial Search database, <http://cemetery.olatheks.org/burial-search/>.

<sup>32</sup> Gregg, History of Johnson County, *Atlas Map of Johnson County, Kansas*, 14.

<sup>33</sup> *Olathe Cemetery*, Burial Search database, <http://cemetery.olatheks.org/burial-search/>.

<sup>34</sup> Gregg, History of Johnson County, *Atlas Map of Johnson County, Kansas*, 71.

<sup>35</sup> *Ibid.*, 14.

<sup>36</sup> *Olathe Cemetery*, Burial Search database, <http://cemetery.olatheks.org/burial-search/>.



Olathe Cemetery

Name of Property

Johnson County, Kansas

County and State

In September 1859, Olathe's first board of trustees was elected and included J.T. Barton, A.J. Clemmans (Clemmons), Jonathan Milliken, L.S. Cornwell, and S.F. Hill.<sup>37</sup> A.J. Clemmans, along with Jonathan Milliken and S.F. Hill, was buried in the cemetery. A.J. Clemmans, born in Jefferson County, Ohio, in 1833, came to Olathe in 1858 and opened a blacksmith shop.<sup>38</sup> In 1868, he worked in the hardware business and became sole proprietor by 1878. In the fall of 1869, Clemmans was elected Sheriff of Johnson County and was re-elected three times. Clemmans was buried in Lot 3, Block 137, Addition 1 of the Olathe Cemetery in 1912.<sup>39</sup>

Shortly after Kansas entered the Union as a free state in 1861, Confederate troops attacked Fort Sumter "and in the twinkling of an eye almost the peaceable and, unusually quiet town, was transformed into a military camp and marching, counter marching and preparation for the deadly conflict, were the order of the day, and the peace and prosperity vanished as the dew before the morning sun."<sup>40</sup> Many of the captains and lieutenants in charge of Johnson County regiments and companies in the Kansas State Militia, such as S.F. Hill, J.E. Hayes, J.M. Hadley, William Pellet, and Pat Cosgrove, were buried in the Olathe Cemetery.<sup>41</sup> Johnson County, due to its border location, was the site of many battles between "jayhawkers" and "bushwhackers" during the Civil War's guerrilla conflict. Eight of the 24 guerrilla raids into Kansas during the Civil War took place in Johnson County.<sup>42</sup>

On September 7, 1862, William Quantrill, the notorious Confederate guerilla leader, and a band of roughly 140 men surprised residents and attacked Olathe. Guerrillas raided the city, robbed numerous businesses and homes, and even destroyed the two newspaper offices, *The Olathe Herald* and *The Olathe Mirror*.<sup>43</sup> According to William G. Cutler's *History of the State of Kansas*, guerrillas killed five Olathe men in Company H of the Twelfth Regiment Kansas Volunteer Infantry: Benjamin F. Cook, James B. Judy, John J. Judy, Isaiah Skinner, and Philip F. Wiggins. All but Benjamin F. Cook were buried in the Olathe Cemetery; Philip F. Wiggins was buried in the original cemetery location while the Judy brothers and Isaiah Skinner likely were reinterred in the Civil War Circle (Photo 25). In retaliation for the involvement of their father, Reason S. Judy, in the Battle of Lone Jack, Missouri, James B. and John J. Judy were kidnapped and robbed during Quantrill's Raid a mile and a half east of Olathe. Their bodies were found in a ravine on the farm owned by Jonathan Milliken.<sup>44</sup>

After the Civil War, Olathe became a major stop along the Santa Fe Trail. As many as 600 wagons traveled through Olathe on the way toward the west. In 1864, James Beatty Mahaffie operated his farmstead as a stagecoach stop. The Mahaffie station, known for its hospitality, was the first stop for stagecoaches travelling from Westport, Missouri on the Santa Fe Trail. In 1907, J.B. Mahaffie was buried in Lot 1, Block 119, Addition 1 of the Olathe Cemetery (Photo 26).<sup>45</sup> The Mahaffie Stagecoach Stop and Farm was listed in the National Register of Historic Places in 1977.

The Kansas Institute for the Deaf and Dumb was organized in Olathe in 1866. Colonel Josiah Emery Hayes, born in New Hampshire in July 1817, moved to Olathe in 1857 and erected numerous buildings, including the Kansas Institute for the Deaf and Dumb.<sup>46</sup> In 1861, Hayes entered the army and became Captain of Company A, Fourth Kansas Infantry. A year later, he was promoted to the Lieutenant-Colonelcy of the Twelfth Kansas Infantry.<sup>47</sup> During the Battle of Jenkin's Ferry, Colonel Hayes was "struck just below the knee, by a minie [sic] ball."<sup>48</sup> After his leg was amputated on the field, Hayes was taken to Shreveport, Louisiana, and remained a prisoner there until 1864. Under a flag of truce, Hayes' wife was permitted to travel for forty miles with a rebel soldier to stay with her husband and remained with him until he was freed. After the Civil War, Colonel Hayes was elected County Treasurer, then became head of the Johnson County Bank. In 1870, he was elected State Treasurer, and re-elected in 1872. Hayes died on March 8, 1881 from the "constant trouble with his wound," and was buried in Olathe.<sup>49</sup> His grave is located in Addition 1 of the Olathe Cemetery (Photo 27).<sup>50</sup>

<sup>37</sup> Cutler, *The History of Johnson County, Kansas*, 22.

<sup>38</sup> Ibid., 31.

<sup>39</sup> *Olathe Cemetery*, Burial Search database, <http://cemetery.olatheks.org/burial-search/>.

<sup>40</sup> Ed Blair, *History of Johnson County, Kansas* (Lawrence: Standard Publishing Company, 1915), 99-100. Available online, <https://archive.org/details/historyofjohnson00blai>.

<sup>41</sup> Ibid.

<sup>42</sup> "The Civil War in Johnson County," Johnson County Museum, accessed 1 July 2016,

<http://www.jocohistory.net/cdm/singleitem/collection/alb/id/368/rec/1>.

<sup>43</sup> Blair, *History of Johnson County, Kansas*, 118.

<sup>44</sup> Ibid., 116.

<sup>45</sup> *Olathe Cemetery*, Burial Search database, <http://cemetery.olatheks.org/burial-search/>.

<sup>46</sup> Cutler, *The History of Johnson County, Kansas*, 36-37.

<sup>47</sup> Ibid.

<sup>48</sup> Ibid.

<sup>49</sup> Ibid.

Olathe Cemetery

Name of Property

Johnson County, Kansas

County and State

In 1870, Olathe became a second class city with 2,045 residents.<sup>51</sup> The election for city officials was held in April when William Pellet, buried in the Olathe Cemetery, was elected the first mayor along with a marshall, police justice, and four councilmen.<sup>52</sup> By 1875, 72 percent of the Johnson County population worked in agriculture with 11 percent in professional and personal services, eight percent in trade and transportation, and nine percent in manufacturing and mining.<sup>53</sup> Olathe's population increased to 2,146.<sup>54</sup>

In 1878, John Pierce St. John became the first of several Olathe residents to become governor of Kansas.<sup>55</sup> St. John served in the State Senate from 1873 to 1874, then represented the Republican Party as governor from 1878 to 1882. During his tenure, his greatest accomplishment was the passage of the Prohibitory Law in 1881. He also supported the construction of a State Reform School in Topeka, Kansas, and helped create the Kansas Freedmen's Relief Association during the Great "Exodusters" movement of African-Americans to Kansas in 1879.<sup>56</sup> Governor John P. St. John died at his home in Olathe on August 31, 1916, and was buried in the Olathe Cemetery (Photo 28).

The 1880s saw the growth of the Hyer Boot Factory, Lanter Lumber Company, and the Hodges Brothers Lumber Company. Charles Henry (C.H.) Hyer, the founder of the Hyer Boot Company, and many of the Hyer Boot Factory employees were buried in the Olathe Cemetery (Photos 29 through 31). C.H. Hyer, the son of an immigrant German shoemaker, moved to Olathe in the mid-1870s and taught shoe and harness making at the Kansas School for the Deaf.<sup>57</sup> In 1875, Charles opened a small boot shop in Olathe, the first manufacturing business in the area. As demand for his boots grew, C.H. Hyer's brother, Edward, and later his three sons joined in the boot making business, and changed the name to C.H. Hyer and Sons. The Hyers created mail-order catalogs with a measurement chart that enabled customers, such as Buffalo Bill Cody, Clark Gable, Will Rogers, and Dwight Eisenhower, to order custom made boots. By 1900, the factory had 15 employees. Hyer employed mostly immigrant craftsmen from Germany, Sweden and Poland as well as hearing impaired residents from the Kansas School for the Deaf. During World War I, C.H. Hyer and Sons made boots for the officers at Fort Leavenworth and at Camp Funston. In 1964, the factory moved to a new building located at I-35 and Rawhide Drive, and the original boot shop was eventually demolished.<sup>58</sup> In 1977 the business was sold to the Ben Miller Boot Company in El Paso, Texas, and all of the original Hyer boot-making equipment was sent to the new location. It is unknown if the Olathe Cemetery burials were due to a major factory accident, but it is unlikely as the monument stone dates range from 1918-1930. John Fernquist, a factory employee buried in the Hyer group, was born in Stockholm, Sweden, and came to Olathe in 1915.<sup>59</sup> Fernquist worked in the C.H. Hyer & Sons Boot Factory until his death in 1931. Fernquist's pallbearers were Hyer shopmates, and the entire Hyer workforce attended his funeral.<sup>60</sup>

Franklin Ringold Lanter, a native of Indiana, was one of the leading lumber dealers in Johnson County. The prominent coal and lumber merchant also served as mayor and treasurer of Olathe.<sup>61</sup> In addition, Lanter was appointed postmaster of Olathe, County Treasurer, and Justice of the Peace. Franklin R. Lanter died in October 1935.<sup>62</sup> His grave is located in Addition 2 of the Olathe Cemetery.

George Hodges and his brother Frank founded Hodges Brothers Lumber Company in 1889. Although the business initially struggled, the company grew to include 14 lumberyards in Johnson and surrounding counties by 1933.<sup>63</sup> At one point,

---

<sup>50</sup> *Olathe Cemetery*, Burial Search database, <http://cemetery.olatheks.org/burial-search/>.

<sup>51</sup> Cutler, *The History of Johnson County, Kansas*, 24.

<sup>52</sup> Ibid.

<sup>53</sup> "History of Olathe," Olathe Historical Society, <http://olathehistoricalsociety.org/history> (accessed 1 July 2016).

<sup>54</sup> Ibid.

<sup>55</sup> "Olathe's 150 most notable people," *The Olathe News*, 9 December 2008. Available online, <http://www.theolathenews.com/2008/01/07/22674/olathes-150-most-notable-people.html>.

<sup>56</sup> "John Pierce St. John," National Governors Association, accessed 1 July 2016, [http://www.nga.org/cms/home/governors/past-governors-bios/page\\_kansas/col2-content/main-content-list/title\\_st-john\\_john.html](http://www.nga.org/cms/home/governors/past-governors-bios/page_kansas/col2-content/main-content-list/title_st-john_john.html).

<sup>57</sup> Kansas Historical Society, "Hyer Boot Company." In *Kansapedia*. Article published December 2004, modified June 2011. <https://www.kshs.org/kansapedia/hyer-boot-company/12093>.

<sup>58</sup> "History of Olathe," Olathe Historical Society, <http://olathehistoricalsociety.org/history> (accessed 1 July 2016).

<sup>59</sup> Find A Grave, database and images, memorial page for John Fernquist, Find A Grave Memorial No. 23242443, accessed 1 July 2016, <http://www.findagrave.com/cgi-bin/fg.cgi?page=qr&GRid=23242443>.

<sup>60</sup> Ibid.

<sup>61</sup> Blair, *History of Johnson County, Kansas*, 274-275.

<sup>62</sup> *Olathe Cemetery*, Burial Search database, <http://cemetery.olatheks.org/burial-search/>.

<sup>63</sup> Kansas State Historical Society, George Hodges House, Olathe, Johnson County, Kansas, State Register #091-4140-0007. Available online, [http://www.kshs.org/resource/national\\_register/nominationsNRDB/Johnson\\_HodgesGeorgeHouseSR.pdf](http://www.kshs.org/resource/national_register/nominationsNRDB/Johnson_HodgesGeorgeHouseSR.pdf).

Olathe Cemetery

Name of Property

Johnson County, Kansas

County and State

Hodges Brothers made \$250,000 annually in sales.<sup>64</sup> As young men, both George and Frank developed an interest in civic and political affairs. Frank Hodges was considered one of the most “capable business men of the Sunflower State” and “best buyer in the West.”<sup>65</sup> Eventually, Frank served two terms as mayor of Olathe and became known as “the mayor who took Olathe out of the mud” for constructing the first waterworks and sewer system.<sup>66</sup> Olathe streets also were completely graded under his leadership. George Hodges began his political career at age 21 as an elected member of the city council. As a councilman, George saw that Olathe had its first electric light. In 1904, George was elected State senator and re-elected to that office in 1908. In 1912, he was elected Kansas’s second Democratic governor and became known as an advocate for progressive platforms. As Ed Blair stated in his 1915 *History of Johnson County, Kansas*, “the story of Governor Hodges’ career as a public official is the story of progressive legislation in Kansas.”<sup>67</sup> During his time as governor, a corporation tax was authorized, women’s suffrage was passed, the board of administration was granted power to control all state agencies, and the Seventeenth Amendment to the U.S. Constitution was ratified to require the direct election of senators. Additionally, the number of women in Kansas government increased from one to twenty-eight during his term in office.<sup>68</sup> Eventually, the Hodges Brothers founded the *Johnson County Democratic* newspaper, now known as the *Olathe News*. Both Hodges brothers were buried in Addition 2 of the Olathe Cemetery (Photos 32 & 33).

During the early twentieth century, two mausoleums were constructed in the Olathe Cemetery. The Black Family Mausoleum, the oldest mausoleum in Johnson County, was added to the cemetery in 1912.<sup>69</sup> The Black Mausoleum is the final resting place for four generations of the Black Family. George Black, the son of James and Mary Eliza (Ainsworth) Black, was interred in 1920. In 1906, George Black assisted his uncle, Newton Ainsworth (also buried in the Olathe Cemetery) in securing the second of five monuments provided by the Daughters of the American Revolution at his farm known as Lone Elm, the historic camping grounds on the original Santa Fe Trail. George Black also was one of the organizers of the Grange organization in Johnson County.<sup>70</sup> Further, he secured the charter for the Johnson County Cooperative Association and served as the first secretary for 31 years.<sup>71</sup>

A decade after the Black Family Mausoleum was constructed, the Livermore Family Mausoleum was erected at the southwest section of the cemetery. Genoa Margaret Livermore died of apoplexy and was buried “in the family vault, in the Olathe cemetery” in June 1922.<sup>72</sup> Born in 1855 in Jackson County, Missouri, Genoa Livermore was considered one of the most prominent citizens of Olathe and Johnson County. In 1873, she married Harvey Crane Livermore and several years later they moved to Olathe. The history and organizations of Olathe were “intertwined with the life and work of Mrs. Livermore.”<sup>73</sup> She was a member of the Ladies Reading Circle, the first literary society organized in Olathe, member of the Library board, and was matron of the Eastern Star. In addition, Mrs. Livermore organized a Red Cross chapter in Johnson County shortly after the Civil War. She also became the first president of the Olathe Improvement Society, an organization that helped with civic improvements. Mr. Harvey Livermore was equally involved in the Olathe community. In 1876, Harvey Livermore was selected as business manager of the Johnson County Cooperative Association, No. 118, of the Patrons of Husbandry. The Association was “formed for the purpose of establishing and maintaining general trade in merchandise, farm products and machinery for the mutual benefit of the share-holders and customers.”<sup>74</sup> Harvey Livermore operated as the general manager for over 30 years. He is buried with his wife in the Livermore Family Mausoleum along with their two children and their children’s spouses.<sup>75</sup>

<sup>64</sup> Blair, *History of Johnson County, Kansas*, 410-412.

<sup>65</sup> Ibid.

<sup>66</sup> Ibid.

<sup>67</sup> Ibid., 411.

<sup>68</sup> George H. Hodges Papers (1899-1968), Johnson County Museum,

<http://www.jocogov.org/sites/default/files/documents/MUS/Finding%20Aid-Hodges%201988-7-58.pdf>.

<sup>69</sup> Linda K. Lewis, “The Mausolea of Johnson County, Kansas,” Digital Cemetery, 2007. Available online, <http://joco-ksgenweb.cottonhills.net/assets/files/books/joco%20mausolea.pdf> (accessed 30 June 2016).

<sup>70</sup> Blair, *History of Johnson County, Kansas*, 435.

<sup>71</sup> Ibid.

<sup>72</sup> “Death of Mrs. H. C. Livermore,” *Olathe Mirror* 15 June 1922 pg1. Available online through subscription database, [www.newspapers.com](http://www.newspapers.com) (accessed 19 September 2016).

<sup>73</sup> Ibid.

<sup>74</sup> Robert Jackson Ray, “The Co-Operative Grangers of Johnson County, Kansas: A Study and Investigation of the Practice and Workings of Cooperation Among Farmers” (Thesis: University of Kansas, 1909). Available online, <https://kuscholarworks.ku.edu/> (accessed 19 September 2016).

<sup>75</sup> Linda K. Lewis, “The Mausolea of Johnson County, Kansas,” Digital Cemetery, 2007. Available online, <http://joco-ksgenweb.cottonhills.net/assets/files/books/joco%20mausolea.pdf> (accessed 30 June 2016).

Olathe Cemetery

Name of Property

Johnson County, Kansas

County and State

During World War I, Private Earl Milton Collier, at 22 years of age, was the “first Olathe boy who has fallen and the second in Johnson county.”<sup>76</sup> Private Collier, a member of the 84<sup>th</sup> company, 6<sup>th</sup> Regiment U.S. Marines, was buried in the World War Memorial of the Olathe Cemetery (Photo 34). In 1926, the City of Olathe donated a monument along with 186 graves in memory of the soldiers and marines of the Spanish-American War and the World War.<sup>77</sup> The parents of Earl Collier donated money as a perpetual fund for the upkeep of the area in memory of their son.

During the 1930s Olathe Cemetery benefitted from at least two New Deal-era programs intended to assist unemployed citizens. In 1931 President Herbert Hoover “directed Congress to pass the Reconstruction Finance Corporation Act” to provide monetary aid to financial institutions.<sup>78</sup> Supplementing this act, Congress passed the 1932 Emergency Relief and Construction Act, which provided loans to state and local agencies. The program was finally initiated in 1933. In January of that year, *Olathe Mirror* remarked, “Many of the unemployed of Olathe have been put to work by the R.F.C. committee building a much needed 1000 feet of side walk in the Olathe cemetery. In addition, they will build 1000 feet of curbing and finish the entrance.” Harvey B. Livermore was Johnson County’s RFC chairman.<sup>79</sup> A photo from Memorial Day in 1933 confirms the stone gates were completed earlier that year (Figure 4).<sup>80</sup> Between July 1935 and July 1939 the Works Progress Administration constructed or improved over 600 buildings within the state of Kansas.<sup>81</sup> Of the 11 documented Johnson County projects, at least five were in Olathe.<sup>82</sup> Through the summer and winter of 1937, the *Olathe Mirror* reported on the progress of the cemetery’s new shelter house, stating on December 2, “A shelter house that has been under construction for several months at the Olathe Cemetery is now completed and ready for use. The house was built under the direction of Walt Huggins, cemetery supervisor.”<sup>83</sup>

On June 13, 1939, Congress passed the Naval Aviation Reserve Act, which authorized the training of 6,000 aviation reserve officers and the establishment of new naval stations.<sup>84</sup> A naval reserve air base already was in existence at Fairfax Field in Kansas City, Kansas; however, by 1941, the base was overcrowded and hazardous. As a result, the U.S. Government purchased a naval training site located southwest of Olathe in January 1942. The base began operations in July 1942, and 100 enlisted men and 72 cadets transferred from Fairfax Field. In September 1942, Don Roberds, the son of a Johnson County Judge, was the first Olathe airman to lose his life during World War II.<sup>85</sup> Fewer than six months after he received his wings at the Naval Air Corps training station in Jacksonville, Florida, Ensign Roberds was “killed instantly” when his trainer plane crashed near the Lake City airport in Jacksonville.<sup>86</sup> Roberds, age 21, was buried in Addition 2 of the Olathe Cemetery.

Shortly after the Olathe Naval Air Station became a training facility for reservists, the Korean Conflict broke out. Many Kansans served as soldiers, sailors, airmen, medical staff, military chaplains, and in other capacities during the Korean War. There were over 400 Kansas military personnel casualties during the Korean War.<sup>87</sup> Two of the 10 soldiers from Johnson County were buried in the Olathe Cemetery.<sup>88</sup> PVT James P. Enright, Jr., was killed in action on May 26 1951 and

<sup>76</sup> “First Olathe Boy Killed in France,” *Olathe Mirror*, 4 July 1918, pg 1.

<sup>77</sup> “Earl Collier Memorial,” n.p. 30 April 1925. Collections of the Olathe Cemetery. Available online, [http://www.olatheks.org/files/rec/Earl\\_Collier\\_Memorial1925.pdf](http://www.olatheks.org/files/rec/Earl_Collier_Memorial1925.pdf) (accessed 30 June 2016).

<sup>78</sup> Elizabeth Rosin, “New Deal-era Resources of Kansas” multiple property documentation form (Topeka: KSHS, 2002), E-1.

<sup>79</sup> “More R.F.C. Money to Johnson County,” *Olathe Mirror*, 8 January 1933, pg.1.

<sup>80</sup> “Memorial Day in Olathe – 1933,” *Olathe Mirror* 1 June 1933, pg. 1. Photograph digitized and available from Olathe Public Library. <http://www.jocohistory.net/cdm/singleitem/collection/opl/id/1793/rec/2> (accessed 20 September 2016).

<sup>81</sup> Rosin, “New Deal-era Resources of Kansas,” E-20.

<sup>82</sup> Kansas Historical Society Archives contains microfilm and hard copy information about WPA projects in Kansas, but this information within the archives is not comprehensive.

<sup>83</sup> “Cemetery Shelter House,” *Olathe Mirror* 2 December 1937, pg. 1.

<sup>84</sup> R. Douglas Hurt, “Naval Air Stations in Kansas During World War II,” *Kansas Historical Quarterly* (Autumn 1977):351-362. Available online, <https://www.kshs.org/p/kansas-historical-quarterly-naval-air-stations-in-kansas-during-world-war-ii/13277>.

<sup>85</sup> “Hometown Judge Keeps 175 Boys on War Fronts Informed of News,” *The Times-Picayune* (New Orleans), 31 August 1944, pg 23. Available online through subscription database, <http://www.genealogybank.com/> (accessed 30 June 2016).

<sup>86</sup> “Wings To Don Roberds,” *Kansas City Star*, 19 April 1942. Available online through subscription database, <http://www.genealogybank.com/> (accessed 30 June 2016); “Navy Flier Dies as Plane Crashes at Florida Field,” *The Times-Picayune* (New Orleans), 8 September 1942, pg 22. Available online through subscription database, <http://www.genealogybank.com/> (accessed 30 June 2016).

<sup>87</sup> “The Korean War,” Kansas 150 SLK Blog, Kansas State Library, 8 November 2010. Available online, <http://kansas150slk.blogspot.com/>

<sup>88</sup> Kansas Historical Society, Kansas Military Index, *Kansas Casualties in the Korean War, 1950-1953*, n.d. Available online, <http://www.kshs.org/p/kansas-casualties-in-the-korean-war-1950-53/15802>.

Olathe Cemetery

Name of Property

Johnson County, Kansas

County and State

was buried October 30, 1951 in Addition 1 and PFC Robert Ellis Alexander was killed in action on November 5, 1951 and was on buried on February 29, 1952 in Addition 2 of the Olathe Cemetery.

In summary, the Olathe Cemetery is the oldest public cemetery in Olathe. The site is the final resting place for many of Olathe's early settlers and local civic and economic leaders. Additionally, the cemetery retains its historic appearance with retention of its historic form and burial patterns. The Olathe Cemetery is eligible for the National Register of Historic Places under Criterion A as it represents early exploration, settlement, and development in Olathe.

Olathe Cemetery  
Name of Property

Johnson County, Kansas  
County and State

---

## 9. Major Bibliographical References

---

**Bibliography** (Cite the books, articles, and other sources used in preparing this form.)

"A Monument Dedicated at Olathe." *Atchison Blade*, 3 June 1893. Accessed 30 June 2016.  
Available online through subscription database, <http://www.genealogybank.com/>.

Art Inventories Catalog. Smithsonian American Art Museum, Smithsonian Institution Research Information System (SIRIS). <http://sirisartinventories.si.edu> Accessed 29 June 2016.

Blair, Ed. *History of Johnson County, Kansas*. Lawrence: Standard Publishing Company, 1915. Available online, <https://archive.org/details/historyofjohnson00blai>.

"Cemeteries." Catholic Cemeteries of Northeast Kansas. Accessed 29 June 2106,  
<https://cathcemks.org/mt-calvary-cemetery-olathe/>.

"Cemeteries." The Digital Cemetery, a JoCo History project. Accessed 29 June 2016,  
<http://cemetery.cottonhills.com/index.jsp>.

Collections of the Olathe Cemetery. Olathe, Kansas.

Cutler, William G. *The History of Johnson County, Kansas*, originally published by A. T. Andreas, 1883.  
Higginsville, MO: Hearthstone Legacy Publications, 2009.

Edwards, John P. *Edwards' Map of Johnson Co., Kansas*. Map. Quincy, IL: John P. Edwards,  
1886. Accessed 1 July 2016, [www.kansasmemory.org/item/210670](http://www.kansasmemory.org/item/210670).

Find A Grave. Database and images, memorial page for John Fernquist. Find A Grave Memorial No.  
23242443. Accessed 1 July 2016, <http://www.findagrave.com/cgi-bin/fg.cgi?page=gr&GRid=23242443>.

"First Olathe Boy Killed in France." *Olathe Mirror*, 4 July 1918.

George H. Hodges Papers (1899-1968). Johnson County Museum,  
<http://www.jocogov.org/sites/default/files/documents/MUS/Finding%20Aid-Hodges%201988-7-58.pdf>.

Gregg, Oliver H. History of Johnson County, *Atlas Map of Johnson County, Kansas*. Wyandotte, Kansas:  
E. F. Heisler & Co., 1874.

Historical Articles, Collections of the Olathe Cemetery. Available online,  
<http://cemetery.olatheks.org/about-us/historical-articles>.

"History of Olathe." Olathe Historical Society. Accessed 1 July 2106,  
<http://olathehistoricalsociety.org/history>.

"Hometown Judge Keeps 175 Boys on War Fronts Informed of News." *The Times-Picayune* (New Orleans), 31 August 1944. Available online through subscription database, <http://www.genealogybank.com/> (accessed 30 June 2016).

Hurt, R. Douglas. "Naval Air Stations in Kansas During World War II." *Kansas Historical Quarterly*, Autumn 1977. Available online, <https://www.kshs.org/p/kansas-historical-quarterly-naval-air-stations-in-kansas-during-world-war-ii/13277>.

"John Pierce St. John." National Governors Association. Accessed 1 July 2016,  
[http://www.nga.org/cms/home/governors/past-governors-bios/page\\_kansas/col2-content/main-content-list/title\\_st-john\\_john.html](http://www.nga.org/cms/home/governors/past-governors-bios/page_kansas/col2-content/main-content-list/title_st-john_john.html).

Johnson County Records & Tax Administration (RTA), Johnson County, Kansas, var. Available online through subscription database, <http://www.jocogov.org/dept/records-and-tax-administration/home>.

Olathe Cemetery

Name of Property

Johnson County, Kansas

County and State

- Kansas Historical Society, George Hodges House, Olathe, Johnson County, Kansas, State Register #091-4140-0007. Available online, [http://www.kshs.org/resource/national\\_register/nominationsNRDB/Johnson\\_HodgesGeorgeHouseSR.pdf](http://www.kshs.org/resource/national_register/nominationsNRDB/Johnson_HodgesGeorgeHouseSR.pdf).
- Kansas Historical Society, "Hyer Boot Company." In *Kansapedia*. Article published December 2004, modified June 2011. <https://www.kshs.org/kansapedia/hyer-boot-company/12093>.
- Kansas Historical Society, Kansas Military Index, *Kansas Casualties in the Korean War, 1950-1953*, n.d. Available online, <http://www.kshs.org/p/kansas-casualties-in-the-korean-war-1950-53/15802>.
- Lewis, Linda K. "The Mausolea of Johnson County, Kansas." Digital Cemetery, 2007. Accessed 30 June 2016, <http://joco.ksgenweb.cottonhills.net/assets/files/books/joco%20mausolea.pdf>.
- Martin, Geo. W., ed. "Origin of County Names." In *Collections of the Kansas State Historical Society, 1901-1902*, Vol. VII, Topeka, Kansas: W. Y. Morgan, State Printing Office, 1902). Accessed 1 July 2016, <https://kshs.org/p/kansas-history/12443#khc>.
- Martin, Geo. W., ed. "The Santa Fe Trail in Johnson County." In *Collections of the Kansas State Historical Society, 1909-1910*, Vol. XI, Topeka, Kansas: State Printing Office, 1910). Accessed 1 July 2016, <https://kshs.org/p/kansas-history/12443#khc>.
- "Navy Flier Dies as Plane Crashes at Florida Field." *The Times-Picayune* (New Orleans), 8 September 1942. Available online through subscription database, <http://www.genealogybank.com/> (accessed 30 June 2016).
- Olathe Cemetery. Burial Search database, <http://cemetery.olatheks.org/burial-search/>.
- "Olathe's 150 most notable people," *The Olathe News*, 9 December 2008. Available online, <http://www.theolathenews.com/2008/01/07/22674/olathes-150-most-notable-people.html>.
- Olathe Township. Kansas City Lith'g Co. In *Atlas Map of Johnson County, Kansas*. Wyandotte, Kansas: E. F. Heisler & Co., 1874. Accessed 1 July 2016, [www.kansasmemory.org/item/223964](http://www.kansasmemory.org/item/223964).
- Rosin, Elizabeth. "New Deal-era Resources of Kansas" multiple property documentation form. Topeka: KSHS, 2002.
- Sackuvich, Greg. "Cemetery chapel dedicated after restoration." *The Daily News (Olathe)*, 23 September 1984. Accessed 30 June 2016, [http://www.olatheks.org/files/rec/Chapel\\_Restoration1984.pdf](http://www.olatheks.org/files/rec/Chapel_Restoration1984.pdf).
- Smith Cemetery, Interment.net. Accessed 29 June 2016, <http://www.interment.net/data/us/ks/johnson/smith/index.htm>.
- "The Civil War in Johnson County." Johnson County Museum. Accessed 1 July 2016, <http://www.jcohistory.net/cdm/singleitem/collection/alb/id/368/rec/1>.
- The Olathe Garden and Civic Club, *Olathe Tree Tour 2: The Trees of Olathe Cemetery*. Olathe, n.p., 2016. Available online, <http://cemetery.olatheks.org/pdf/Tour-Tree.pdf>.
- The Olathe Mirror*, var. 1861-1924, available online through subscription database, <https://www.newspapers.com/> and through Kansas Historical Society Archives microfilm collection.
- United States Federal Census, 1880. Available online through subscription database, [www.ancestry.com](http://www.ancestry.com), accessed 19 September 2016.
- West Part of Olathe, County Seat of Johnson Co., Kansas. In *Standard Atlas of Johnson County, Kansas*. Chicago: Geo. A. Ogle & Co., 1902. Accessed 1 July 2016, [www.kansasmemory.org/item/209390](http://www.kansasmemory.org/item/209390).
- "Wings to Don Roberds." *Kansas City Star*, 19 April 1942. Available online through subscription database, <http://www.genealogybank.com/>

Olathe Cemetery  
Name of Property

Johnson County, Kansas  
County and State

**Previous documentation on file (NPS):**  
 preliminary determination of individual listing (36 CFR 67 has been requested)  
 previously listed in the National Register  
 previously determined eligible by the National Register  
 designated a National Historic Landmark  
 recorded by Historic American Buildings Survey # \_\_\_\_\_  
 recorded by Historic American Engineering Record # \_\_\_\_\_  
 recorded by Historic American Landscape Survey # \_\_\_\_\_

**Primary location of additional data:**  
 State Historic Preservation Office  
 Other State agency  
 Federal agency  
 Local government  
 University  
 Other  
Name of repository: Olathe Memorial Cemetery

Historic Resources Survey Number (if assigned): \_\_\_\_\_ N/A

**10. Geographical Data**

**Acreeage of Property** 26

**Provide latitude/longitude coordinates OR UTM coordinates.**

**Latitude/Longitude Coordinates**

Datum if other than WGS84: \_\_\_\_\_  
(enter coordinates to 6 decimal places)

- |                        |                       |
|------------------------|-----------------------|
| 1. Latitude: 38.897241 | Longitude: -94.818701 |
| 2. Latitude: 38.898043 | Longitude: -94.818359 |
| 3. Latitude: 38.898051 | Longitude: -94.816147 |
| 4. Latitude: 38.894132 | Longitude: -94.816134 |
| 5. Latitude: 38.894136 | Longitude: -94.817708 |
| 6. Latitude: 38.893089 | Longitude: -94.817698 |
| 7. Latitude: 38.893066 | Longitude: -94.818633 |

**Verbal Boundary Description** (describe the boundaries of the property)

The boundaries of the Olathe Cemetery are the current boundaries of the cemetery, shown on the accompanying map.

**Boundary Justification** (explain why the boundaries were selected)

The boundaries contain all the historic resources associated with the cemetery and represent the boundary of the cemetery as set by 1956.

**11. Form Prepared By**

name/title Jill Adams Enersen/Architectural Historian  
organization R. Christopher Goodwin & Associates, Inc. date September 2016  
street & number 309 Jefferson Highway, Suite A telephone 504-837-1940  
city or town New Orleans, LA 70121 state LA zip code 70121  
e-mail jenersen@rcgoodwin.com

**Property Owner:** (complete this item at the request of the SHPO or FPO)

name City of Olathe  
street & number 100 E. Sante Fe Street telephone 913-971-8600  
city or town Olathe state KS zip code 66061



Olathe Cemetery

Name of Property

Johnson County, Kansas

County and State

**Paperwork Reduction Act Statement:** This information is being collected for applications to the National Register of Historic Places to nominate properties for listing or determine eligibility for listing, to list properties, and to amend existing listings. Response to this request is required to obtain a benefit in accordance with the National Historic Preservation Act, as amended (16 U.S.C.460 et seq.).

**Estimated Burden Statement:** Public reporting burden for this form is estimated to average 100 hours per response including time for reviewing instructions, gathering and maintaining data, and completing and reviewing the form. Direct comments regarding this burden estimate or any aspect of this form to the Office of Planning and Performance Management, U.S. Dept. of the Interior, 1849 C. Street, NW, Washington, DC.

**Additional Documentation**

Submit the following items with the completed form:

**Photographs**

Submit clear and descriptive photographs. The size of each digital image must be 1600x1200 pixels (minimum), at 300 ppi (pixels per inch) or larger. Key all photographs to a sketch map or aerial map. Each photograph must be numbered and that number must correspond to the photograph number on the photo log. For simplicity, the name of the photographer, photo date, etc. may be listed once on the photograph log and doesn't need to be labeled on every photograph.

**Photograph Log**

Name of Property: Olathe Cemetery

City or Vicinity: Olathe

County: Johnson County State: KS

Photographer: Shannon R. Ryan, PhD.

Date

Photographed: 31 March 2016

Description of Photograph(s) and number, include description of view indicating direction of camera:

- Photo #1 of 34: Olathe Cemetery, Chestnut Street entrance, camera facing north.
- Photo #2 of 34: Olathe Cemetery, Chestnut Street entrance, camera facing northeast.
- Photo #3 of 34: Olathe Cemetery, Chestnut Street entrance, camera facing north.
- Photo #4 of 34: Shelter House/Chapel and garage, camera facing northeast.
- Photo #5 of 34: Shelter House/Chapel, camera facing northeast.
- Photo #6 of 34: Shelter House/Chapel, camera facing east.
- Photo #7 of 34: Cremation garden, camera facing east.
- Photo #8 of 34: Cremation garden, camera facing north.
- Photo #9 of 34: Memory Lane D.A.R. marker, camera facing east.
- Photo #10 of 34: Overview of World War Memorial, camera facing northwest.
- Photo #11 of 34: Doughboy Sculpture – World War Memorial, camera facing northeast.
- Photo #12 of 34: Doughboy Sculpture – World War Memorial, camera facing northeast.
- Photo #13 of 34: Livermore Family Mausoleum, camera facing northeast.
- Photo #14 of 34: Overview of Civil War Circle, camera facing east.
- Photo #15 of 34: Civil War Memorial, camera facing east.
- Photo #16 of 34: Overview of The Baby's Circle, camera facing northwest.
- Photo #17 of 34: Cemetery road marker, camera facing northeast.
- Photo #18 of 34: Entrance gate off of North Woodland Road, camera facing east.
- Photo #19 of 34: Entrance gate off of North Woodland Road, camera facing northwest.
- Photo #20 of 34: Overview of Potter's Field marker, camera facing northwest.
- Photo #21 of 34: Bench near first burial, Elvira Beckwith, camera facing northwest.
- Photo #22 of 34: The Black Mausoleum, south and east elevations, camera facing northwest.
- Photo #23 of 34: Planted trees along West side of Chestnut Street, camera facing northwest.
- Photo #24 of 34: Jonathan Millikan grave.
- Photo #25 of 34: James and John Judy grave, camera facing north.
- Photo #26 of 34: J.B. Mahaffie grave.

Olathe Cemetery

Name of Property

Johnson County, Kansas

County and State

- Photo #27 of 34: J. E. Hayes grave.
- Photo #28 of 34: John Pierce St. John grave.
- Photo #29 of 34: C. H. Hyer grave.
- Photo #30 of 34: Employees of C. H. Hyer & Sons marker.
- Photo #31 of 34: Cowboy boot sculpture C. H. Hyer Boot Factory, camera facing
- Photo #32 of 34: George H. Hodges grave.
- Photo #33 of 34: Frank Hodges grave.
- Photo #34 of 34: Earl Milton Collier grave.

**Figures**

Include GIS maps, figures, scanned images below.

- Figure 1. Map with boundaries.
- Figure 2. Map with Cemetery Sections.
- Figure 3. Olathe Cemetery historic site plan. Collections of the Olathe Cemetery.
- Figure 4. "Cemetery guards." JoCoHistory Collection. Available online, <http://www.jocohistory.net/cdm/singleitem/collection/opl/id/1793/rec/2>. Courtesy of Olathe Public Library.
- Figure 5. Map with Resource Locations.
- Figure 6. Map with Photo Location and Directions.
- Figure 7. Excerpt from Olathe Township. Kansas City Lith'g Co. In *Atlas Map of Johnson County, Kansas*. Wyandotte, Kansas: E. F. Heisler & Co., 1874. Historic Map Works Rare Historic Maps Collection. Courtesy of Historic Map Works.
- Figure 8. Excerpt from Edwards, John P. *Edwards' Map of Johnson Co., Kansas*. Map. Quincy, IL: John P. Edwards, 1886.
- Figure 9. Excerpt from West Part of Olathe, County Seat of Johnson Co., Kansas. In *Standard Atlas of Johnson County, Kansas*. Chicago: Geo. A. Ogle & Co., 1902, pg5.
- Figure 10. Excerpt from West Part of Olathe, County Seat of Johnson Co., Kansas. In *Standard Atlas of Johnson County, Kansas*. Chicago: Geo. A. Ogle & Co., 1922, pg9.

Figure 1

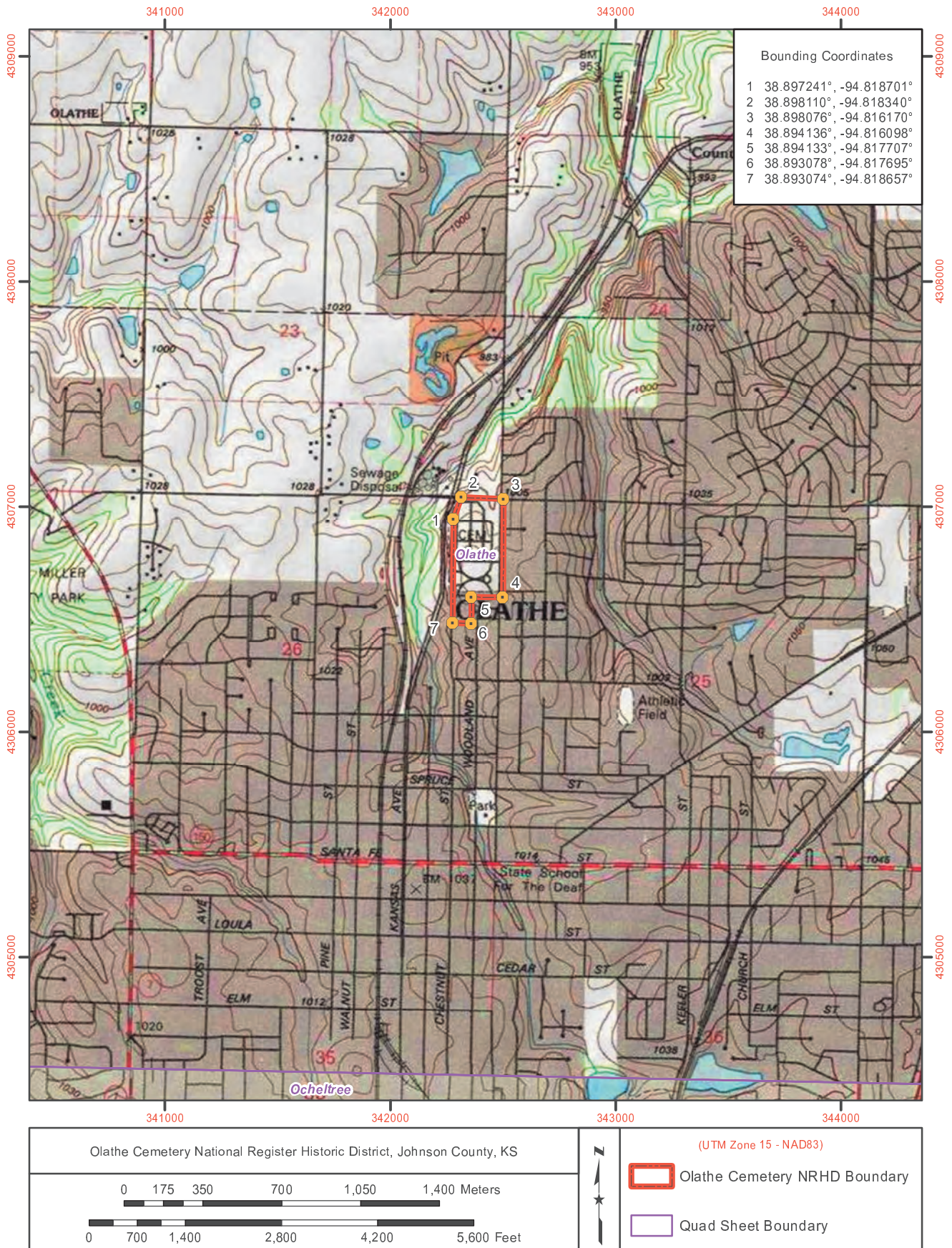

Figure 2

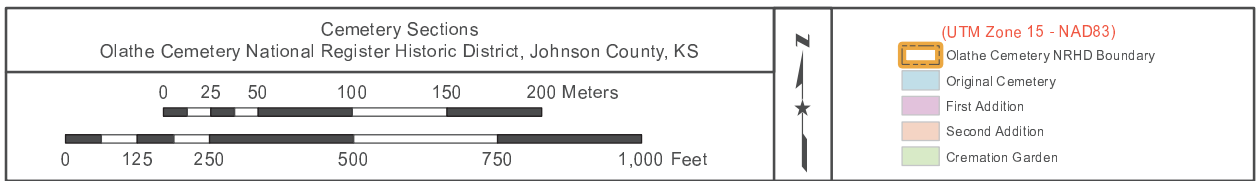

Figure 3N

Olathe Memorial City



# OLATHE MEMORIAL CEMETERY



HAROLD AVENUE

POTTER'S FIELD  
*original*

1ST BURIAL IN CEMETERY (1865)

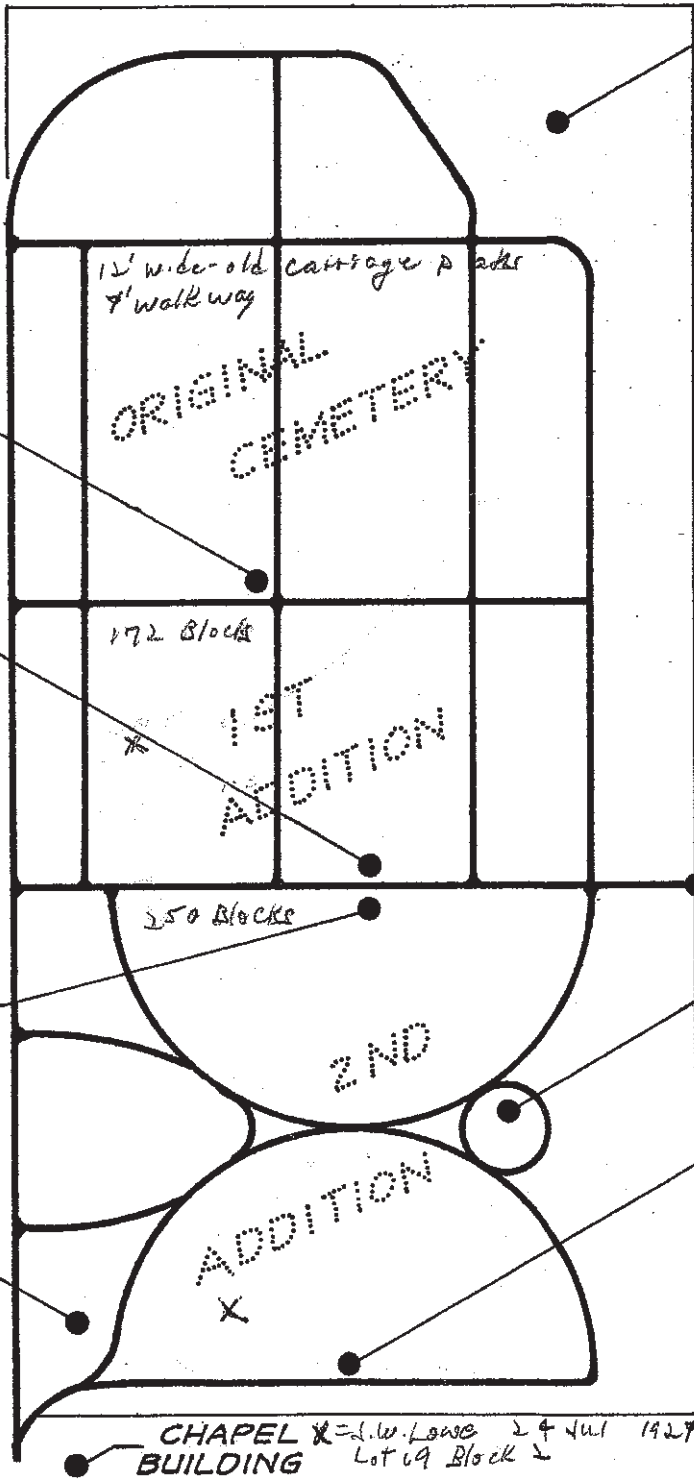

*12' wide - old carriage paths & 7' walk way*

ORIGINAL CEMETERY

JOHN PIERCE ST. JOHN (GOVERNOR) OF KANS.

*172 Blocks*

1ST ADDITION

MAIN ENTRANCE

GEORGE HODGES (GOVERNOR) OF KANS.

*250 Blocks*

2ND ADDITION

CIVIL WAR CIRCLE

WORLD WAR I CIRCLE

INFANT MEMORIAL

CHAPEL BUILDING - L.W. LANGE 24 JUL 1927 Lot 69 Block 2

*L.W. LANGE E 8th Lot 7 Block 122*

Map of Olathe Memorial City

Figure 4



Figure 5







<p>Resource Locations Olathe Cemetery National Register Historic District, Johnson County, KS</p>		<p>(UTM Zone 15 - NAD83)</p>  <p>Resource Location</p>  <p>Olathe Cemetery NRHD Boundary</p> 
<p>0 25 50 100 150 200 Meters</p>  <p>0 125 250 500 750 1,000 Feet</p> 		

Figure 6



<p>Photo Location and Directions Olathe Cemetery National Register Historic District, Johnson County, KS</p>			<p>(UTM Zone 15 - NAD83)</p> <p> Photo Location and Direction</p> <p> Olathe Cemetery NRHD Boundary</p>
<p>0 25 50 100 150 200 Meters</p> <p>0 125 250 500 750 1,000 Feet</p>			



Figure 7



Figure 8

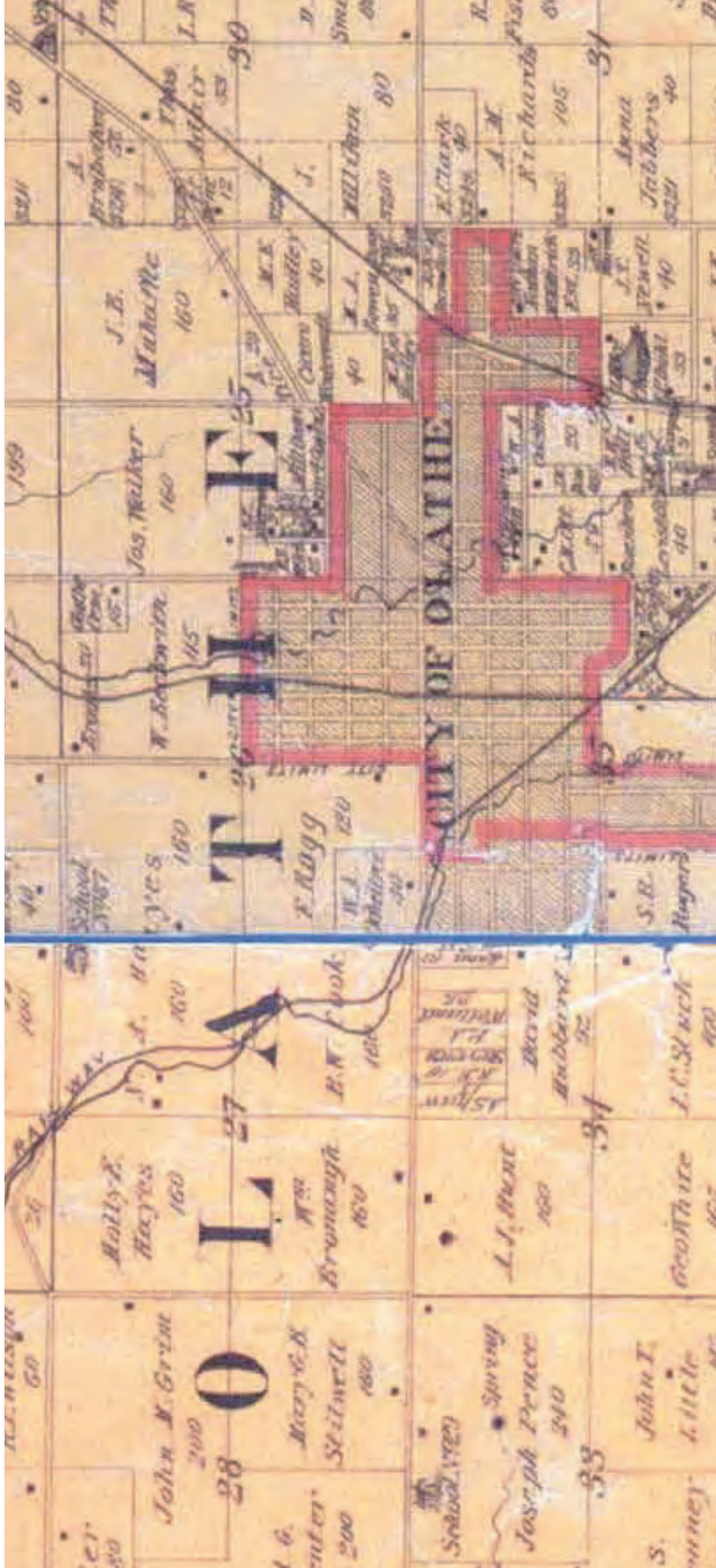
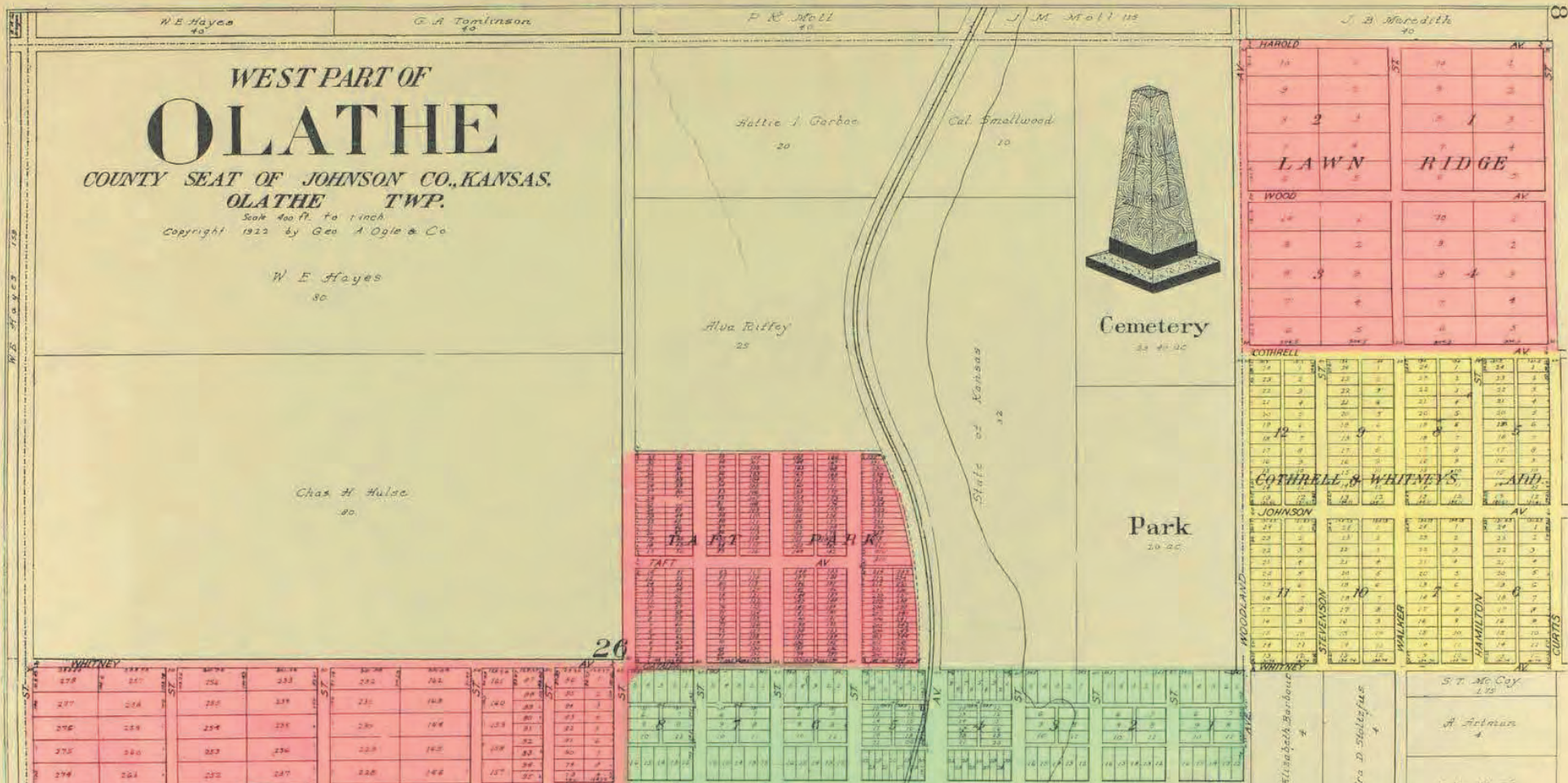



Figure 10

















Olathe  
Memorial  
Cemetery  
Est. 1865

Olathe Memorial Cemetery  
1000 S. Olathe Blvd.  
Olathe, MO 64662  
Phone: 816.841.1234  
Website: www.olathecemetery.com





OLATHE DAR OCT. 7, 2000

OLATHE CHAPTER  
D.A.R.  
MEMORIAL SERVICE ON OCT.  
MEMORY LANE  
Dedicated OCT. 7, 2000

OLATHE DAR OCT. 7, 2000







IN MEMORY  
OF  
WORLD WAR  
VETERANS





LIVERMORE





ERECTED BY  
FRANKLIN COUNTY  
IN MEMORY OF  
THE BOYS OF THE WAR



SEBASTIAN J.  
VAZULEZ  
MAY 20 1974  
FEB 28 2014

M M  
O E  
R M  
N O  
I G L A  
N O R Y  
G R Y E





PLEASE KEEP  
VEHICLES  
OFF GRASS











FIRST BURIAL





★ JONATHAN  
MILLIKAN  
1827-1917

JAMES B JUDY  
CO H  
12 KS INF  
1844  
SEP 7 1862

UNITED STATES ARMY  
DEPARTMENT OF THE ARMY  
JAMES B. JUDY  
Rec'd. 1862  
Sept. 7, 1862.  
Aged 23y.  
9m. 6d.



MAHAFFIE

JAMES BEATTY MAHAFFIE  
1817 — 1907

LUCINDA H. MAHAFFIE  
1827 — 1903

ELLA M. MAHAFFIE  
1869 — 1958

LAUGHREY



J.E. HAYES.

PHILLIPS

WALLACE

ST. JOHN  
ALBERT S. ST. JOHN  
BORN [illegible]  
DIED [illegible]  
[illegible]

FRANCIS ST. JOHN

SUSAN JANE ST. JOHN

FRANCIS ST. JOHN

FRANCIS DAVIS







C. H. HYER  
1854-1921

DARWOOD  
BORN [unclear] [unclear]  
DIED [unclear] [unclear]

ANNIE W. KIRBY  
BORN [unclear] [unclear]  
DIED [unclear] [unclear]

WILLIAM  
[unclear]

J. FERBQUIST  
1921

M. STRYVENSON  
1922 - 1924

A. YENNER  
1923 - 1926

B. OLSSON  
1928 - 1928

G. ZIMMERMAN  
1928 - 1928

B. BILSON  
1928 - 1928

R. WUTSCHKA  
1918

C. H. HYER & SONS  
EMPLOYEES

1920 - 1920  
REMOVED

C. LANDGRAN  
1929

J. WUTSCHKA  
1929 - 1929

B. POOLER  
1929 - 1919

L. HEDDLESTROM  
1933 - 1913

B. BERNARD  
1915 - 1912

B. BILSON  
1928 - 1914



GEORGE H.  
HODGES  
1888 — 1947

FRANK  
HODGES

1863 — 1962



EARL MILTON  
COLLIER

KANSAS

FVT. 6 REGT. U. S. M. C.  
2 DIV.†

JUNE 6, 1918

UNITED STATES DEPARTMENT OF THE INTERIOR  
NATIONAL PARK SERVICE

NATIONAL REGISTER OF HISTORIC PLACES  
EVALUATION/RETURN SHEET

Requested Action:

Property Name:

Multiple Name:

State & County:

Date Received: 12/2/2016      Date of Pending List: 12/27/2016      Date of 16th Day: 1/11/2017      Date of 45th Day: 1/17/2017      Date of Weekly List: 1/17/2017

Reference number:

Nominator:

Reason For Review:

Accept       Return       Reject      1/11/2017 Date

Abstract/Summary Comments:

Recommendation/ Criteria

Reviewer Alexis Abernathy      Discipline Historian

Telephone (202)354-2236      Date \_\_\_\_\_

DOCUMENTATION:    see attached comments : No    see attached SLR : No

If a nomination is returned to the nomination authority, the nomination is no longer under consideration by the National Park Service.



6425 SW 6th Avenue  
Topeka KS 66615

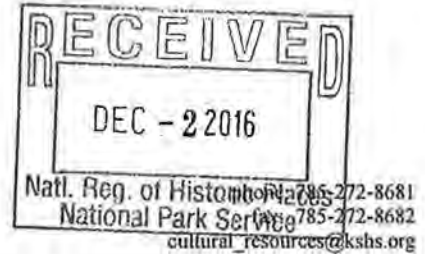

Sam Brownback, Governor  
Jennie Chinn, Executive Director

November 21, 2016

Paul Loether, National Register Chief  
National Register of Historic Places  
National Park Service  
1201 Eye Street, NW (2280)  
Washington, DC 20005

Re: National Register documents

Dear Mr. Loether:

Please find enclosed the following National Register documents:

- **Arvonia Township Hall, Lebo vicinity, Osage County, Kansas (new nomination)**
  - Physical, signed copy of the nomination's first page;
  - 1 CD (disk #1) with a PDF of the true and correct copy of the nomination;
  - 1 CD (disk #2) with photographs
- **Leonard , J.T., & Anna, House; Girard, Crawford County, Kansas (new nomination)**
  - Physical, signed copy of the nomination's first page;
  - 1 CD (disk #1) with a PDF of the true and correct copy of the nomination and .kmz file;
  - 1 CD (disk #2) with photographs
- **Eskridge City Park & Bandstand, Eskridge, Wabaunsee County, Kansas (resubmission)**
  - Physical, signed copy of the nomination's first page;
  - 1 CD (disk #1) with a PDF of the true and correct copy of the nomination, copy of city (owner) support, copy of letter from Alexis Abernathy recommending a resubmission and .kmz file;
  - 1 CD (disk #2) with photographs
- **Olathe Cemetery, Olathe, Johnson County, Kansas (new nomination)**
  - Physical, signed copy of the nomination's first page;
  - 1 CD (disk #1) with a PDF of the true and correct copy of the nomination and .kmz file;
  - 1 CD (disk #2) with photographs
- **Engle, Jacob S., House, Abilene, Dickinson County, Kansas (new nomination)**
  - Physical, signed copy of the nomination's first page;
  - 1 CD (disk #1) with a PDF of the true and correct copy of the nomination, copies of letters of support from the city of Abilene (2)
  - 1 CD (disk #2) with photographs



- **Hoffman & Lamb Buildings, Enterprise, Dickinson County, Kansas (new nomination)**
  - Physical, signed copy of the nomination's first page;
  - 1 CD (disk #1) with a PDF of the true and correct copy of the nomination;
  - 1 CD (disk #2) with photographs
  
- **Lander's Wagon & Carriage Shop, Humboldt, Allen County, Kansas (new nomination)**
  - Physical, signed copy of the nomination's first page;
  - 1 CD (disk #1) with a PDF of the true and correct copy of the nomination;
  - 1 CD (disk #2) with photographs
  
- **Grand Army of the Republic (GAR) Memorial Arch, Junction City, Geary County, Kansas (new nomination)**
  - Physical, signed copy of the nomination's first page;
  - 1 CD (disk #1) with a PDF of the true and correct copy of the nomination;
  - 1 CD (disk #2) with photographs
  
- **Reid, Lyman, House; Ottawa, Franklin County, Kansas (new nomination)**
  - Physical, signed copy of the nomination's first page;
  - 1 CD (disk #1) with a PDF of the true and correct copy of the nomination;
  - 1 CD (disk #2) with photographs
  
- **Kansas Route 66 Historic District – North Baxter Springs; Riverton & Baxter Springs vicinities, Cherokee County, Kansas (boundary expansion; additional documentation)**
  - Physical, signed copy of the nomination's first page;
  - 1 CD (disk #1) with a PDF of the true and correct copy of the nomination and .kmz file;
  - 1 CD (disk #2) with photographs
  
- **Beckett, Charles K., House, Sterling, Rice County, Kansas (removal request)**
  - Physical, signed copy of the removal request;
  - 1 CD (disk #1) with a PDF of the true and correct copy of the removal request;
  - 1 CD (disk #2) with photograph
  
- **Spring Creek School, Corbin vicinity, Sumner County, Kansas (removal request)**
  - Physical, signed copy of the removal request's first page;
  - 1 CD (disk #1) with a PDF of the true and correct copy of the removal request;
  - 1 CD (disk #2) with photographs

If you have any questions about these enclosed items, please contact me at 785-272-8681 ext. 216 or [aloughlin@kshs.org](mailto:aloughlin@kshs.org).

Sincerely,



Amanda K. Loughlin  
National Register Coordinator

Enclosures