

ARCHITECTURAL/HISTORICAL SURVEY

DAVENPORT, IOWA

The Architects Office

Wehner, Nowysz, Pottschull and Pfiffner
201 day building, Iowa city, Iowa 52240

DAVENPORT COMMUNITY DEVELOPMENT DEPARTMENT
IOWA DIVISION OF HISTORIC PRESERVATION

SITE # 82-10- 4-W2222 MAP # 2

HIST. DIST. _____

NAME Gustov C. Lerch House (H) C

ADDRESS 2222 W. Fourth Street

LEGAL DES. _____ (See cont. sheet)
SUB-DIVISION 78 BLOCK 33 PARCEL 52804 SUB-PARCEL

UTM 15 EASTING 69912410 NORTHING 45994210 ACREAGE -1 ZONE R-4D

OWNER Richard E. Blair and wife

3127 Telegraph Rd., Davenport, IA

TITLE H. 52804
(IF DIFF) _____

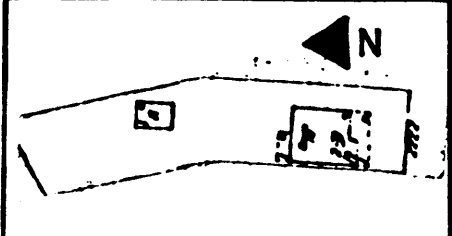

SITE SHEET

ARCHITECTURE

DESCRIPTION

2 story, cross-gable house with steep gambrel roofs and recessed
FORM porch CONST. DATE 1904-05
MATERIALS Brick, stone, wood, shingle ARCH STYLE Shingle/Colonial Revival
FENESTRATION Segmental arched, rectangular; latter w/leaded glass upper sash
DIST. FEATURES See below
ALTERATIONS Porch railing removed on sides
SITE & RELATED STR. Small lot in turn-of-the-century residential neighborhood

STATEMENT

The strong, sweeping shapes of crossed gambrels, and the variety of surface textures give this house distinction in an otherwise unremarkable turn of the century neighborhood. Set on a foundation of quarryfaced stone, the house has a first floor of tan brick, with segmental window arches and corners picked out in dark "rockfaced" brick. The second floor, fully within the sweep of the steep gambrels, is sheathed with narrow clapboard, and at the bottom has a slight "kick" to match that of the roof. The roof shingling is brought around the edges of the gable in an unusual manner to suggest cornice returns. At attic level, a pentroof across each gable end at the level of the break in the roof creates a shingled pediment, which at the front has an Adamesque oval window. Influences for this house can be found in the Colonial Revival, Shingle and Craftsman styles, but the combination and treatment is unusual and distinctive. An identical house design is located on Oak Lane in north central Davenport.

SOURCES

SIGNIFICANCE

HISTORY

DESCRIPTION

Gustov C. Lerch and his wife Mamie built this house in 1904-05. Lerch was employed as Clerk of the District Court office and later worked as bookkeeper for the A. J. Lerch Company, hardware dealers.

SOURCES

City Directories, 1902-03, 1906-07.

ARCHITECTURAL HISTORIAN: Martha Bowers | HISTORIAN: MARLYS SVENDSEN-ROESLER | SURVEY COMP 1981

EVALUATION

ARCHITECTURAL

I. ARCH. EVALUATION Excellent
II. ENVIR. STATURE Incident
III. INT. OF CONTEXT Excellent
IV. INT. OF FABRIC Excellent

LEVEL OF SIGNIFICANCE:
 NAT. STATE LOCAL N. ELIG.

HISTORICAL

I. THEME(S) OF SIGNIFICANCE:
A. PRIMARY _____
B. SECONDARY _____

II. LEVEL OF SIGNIFICANCE:
 NAT. STATE LOCAL

III. NRHP
ELIGIBLE NOT ELIGIBLE

HISTORIC DISTRICT CLASSIFICATION

FOR DIVISION OF HISTORIC PRESERVATION USE ONLY

1. DATE RECEIVED _____

2. DATE OF STAFF EVALUATION _____

A. ARCHITECTURAL B. HISTORICAL
ELIGIBLE FOR N.R.H.P.
NOT ELIGIBLE FOR N.R.H.P.

3. NRHP ACTION
A. STATE REVIEW COMM. APP. DISAPP. TABLED DATE _____
B. FEDERAL REVIEW APP. DISAPP. TABLED DATE _____

4. D.H.P. SOURCES
 COUNTY RESOURCES
 W'SHIELD SURVEY
 NRHP
 GRANT _____
 DET. OF ELIGIBILITY
 R. & C. _____
 DAVENPORT A/H SURVEY.

5. SUBJECT TRACES

6. PHOTO
1601-8

ARCHITECTURAL/HISTORICAL SURVEY

DAVENPORT, IOWA

The Architects Office

Wehner, Nowysz, Pottschull and Pfiffner

801 city building iowa city, iowa 52240

DAVENPORT COMMUNITY DEVELOPMENT DEPARTMENT
IOWA DIVISION OF HISTORIC PRESERVATION

82-10-4-W2222

LEGAL DESCRIPTION: Pt of Secs 28 and 33-78-3, com 399.7' W of
SE cor of Sec 28 - N 15.5 D W 102.57' to
S/L Tele Rd - S 58 1/4 D W 44.45' - S 15.5 D
E 80.60' to Sec/L - S 103' to 4th St - E
44.45' - N 103' to beg

CONTINUATION