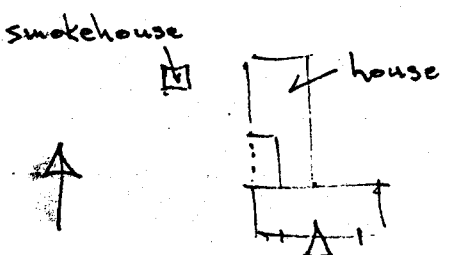

KENTUCKY HISTORIC RESOURCES INVENTORY

Js-178

1. Historic Name (s) <u>Providence / Craig Ashurst house</u> Original Owner <u>Craig Ashurst</u>		22. ADD/County <u>Bluegrass/Jessamine</u>	
Present Name <u>Waveland</u>		23. Zoning Classification <u>Magisterial District</u>	
3. Owner's Name <u>George Dale Robinson 223-1460</u>		24. U.S.G. S. Quadrant (15'/75') <u>Nicholasville</u>	
4. Owner's Address <u>Rt. 1, Nicholasville 40356</u>		25. UTM Reference Zone <u>16</u> Easting <u>715020</u> Northing <u>4203660</u>	
5. Location <u>North side Brannon Road, 2 miles west US 27</u>		26. Prehistoric Site <u>Historic Site</u> Object <u>Structure</u> <u>Buildings</u>	
6. Open to Public <u>No</u>	7. Visible from road <u>Yes</u>	8. Ownership <u>Private</u> <input checked="" type="checkbox"/>	
9. Local Contact/Organization		27. District <u>Yes</u> <input checked="" type="checkbox"/> Name:	
10. Site Plan with North Arrow 		28. Significance Evaluation <u>National Register</u>	
		29. Status <u>National Landmark</u> Date _____ <u>National Register</u> _____ <u>Landmark Certificate</u> _____ <u>Kentucky Survey</u> <input checked="" type="checkbox"/> <u>11/18/71</u> <u>Local Landmark</u> _____ <u>HABS/HAER</u> _____	
		30. Theme <u>Primary architecture</u>	
		31. Endangered <u>No</u>	
		32.	
11. Architect		ATTACH PHOTO	
12. Builder			
13. Date <u>1847*</u>			
14. Style <u>Greek Revival</u>			
15. Original Use <u>house</u>		33. Tape No. _____ Negative No. _____	
16. Present Use <u>house</u>		34. Prepared by: <u>NCP - KTG</u>	
17. Condition <u>Interior good</u> <u>Exterior excellent</u>		35. Organization <u>KHC</u>	
18. Description 2-story, 3-bay; brick Flemish bond; jack arches; original entry portico - Ionic; tripart windows; central passage plan; original 2-story ell; original recessed double gallery in ell; interior woodwork has crossetts and drip moldings; some out-of-period moldings added; gable roof brick smoke house close to house.		36. Date <u>summer 1977</u>	
19. History Ashurst's daughter married Massie Bryan, son of William Turner Bryan (Js-175); they owned farm at Providence until 1897; farm called Waveland since 1897 by Stone family.		37. Revision Dates _____ 38. Staff Review _____	
20. Significance Architecture: Providence is one of the best examples in the county of local Greek Revival; typical features include the form, portico, gallery, and interior woodwork.		21. Source of Information * Robinson Influence of Bryan Men on Central Kentucky as seen through their homes 1776-1876; 1971 survey form; Lexington Herald-Leader 2/16/58; Robinson, submitted National Register nomination form.	

KENTUCKY HISTORIC RESOURCE INVENTORY SUPPLEMENT
BOUNDARY AND LOCATION INFORMATION

Historic Property Name Craig Ashurst House/Providence Site # JK 178
Multiple Resource/Thematic Nomination Title Justonine Co.

U.T.M. Coordinates - List multiple UTM's if property is ten or more acres.

A. 16 714 400 4204680 D. 16 713970 4204820
B. 16 714220 4204270 E. 16 714350 4204850
C. 16 713760 4204610 F. _____

Verbal Boundary Description

Acreage 55 acres; part of 300 acre farm

Site included within specifically include the house
ice house, brick smoke house, chicken house, and stone
spring house. B-C is with Brennan Road, D-E is with
a branch of S. Eckhorn.

Sketch of Site Plan (Showing outbuildings, structures, landscape features and the site boundary as described above.)

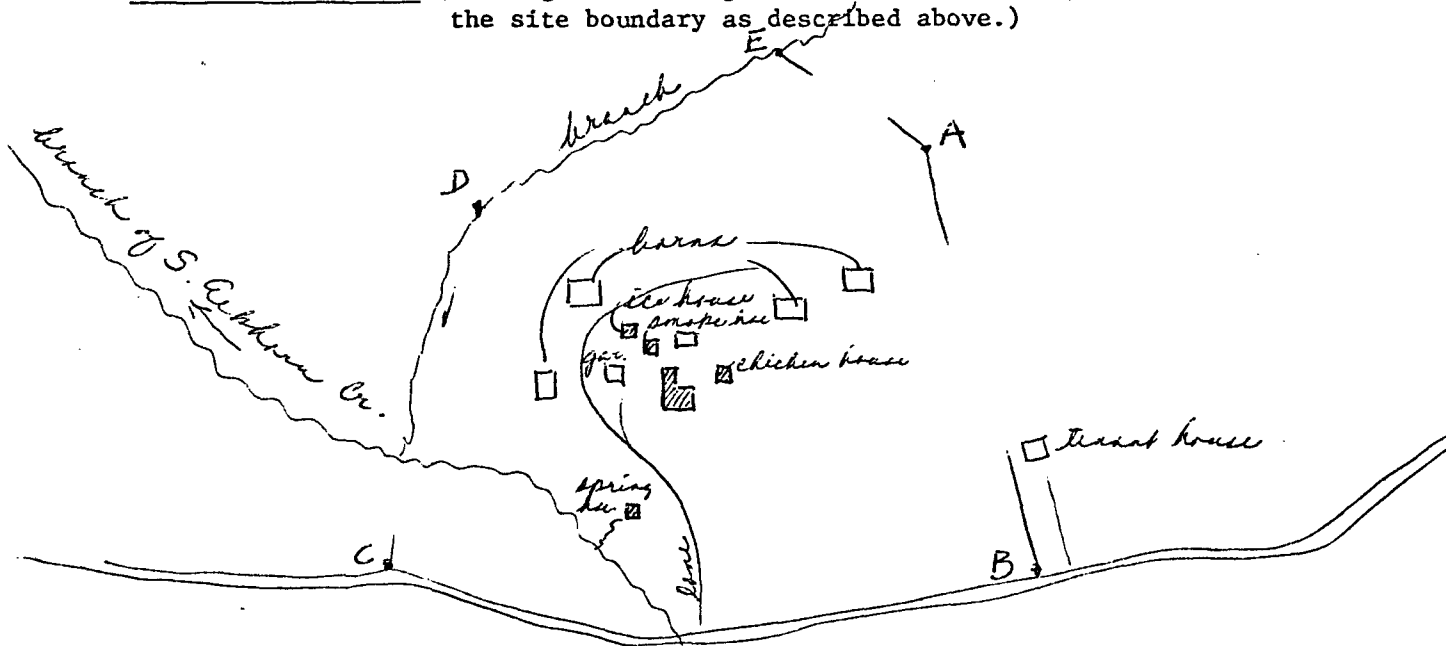

Official Courthouse Property Reference:

KENTUCKY HISTORIC RESOURCE INVENTORY SUPPLEMENT
BOUNDARY AND LOCATION INFORMATION

Historic Property Name _____ Site # JS 178

Multiple Resource/Thematic Nomination Title _____

U.T.M. Coordinates - List multiple UTMs if property is ten or more acres.

- A. 11 714 400 4204 680 D. 1 113 970 4204 820
B. 17 714 220 4204 270 E. 16 714 350 4204 850
C. 16 713 760 4204 610 F. _____

Verbal Boundary Description _____

Acres 55 acres
part of 300

Sketch of Site Plan (Showing outbuildings, structures, landscape features and the site boundary as described above.)

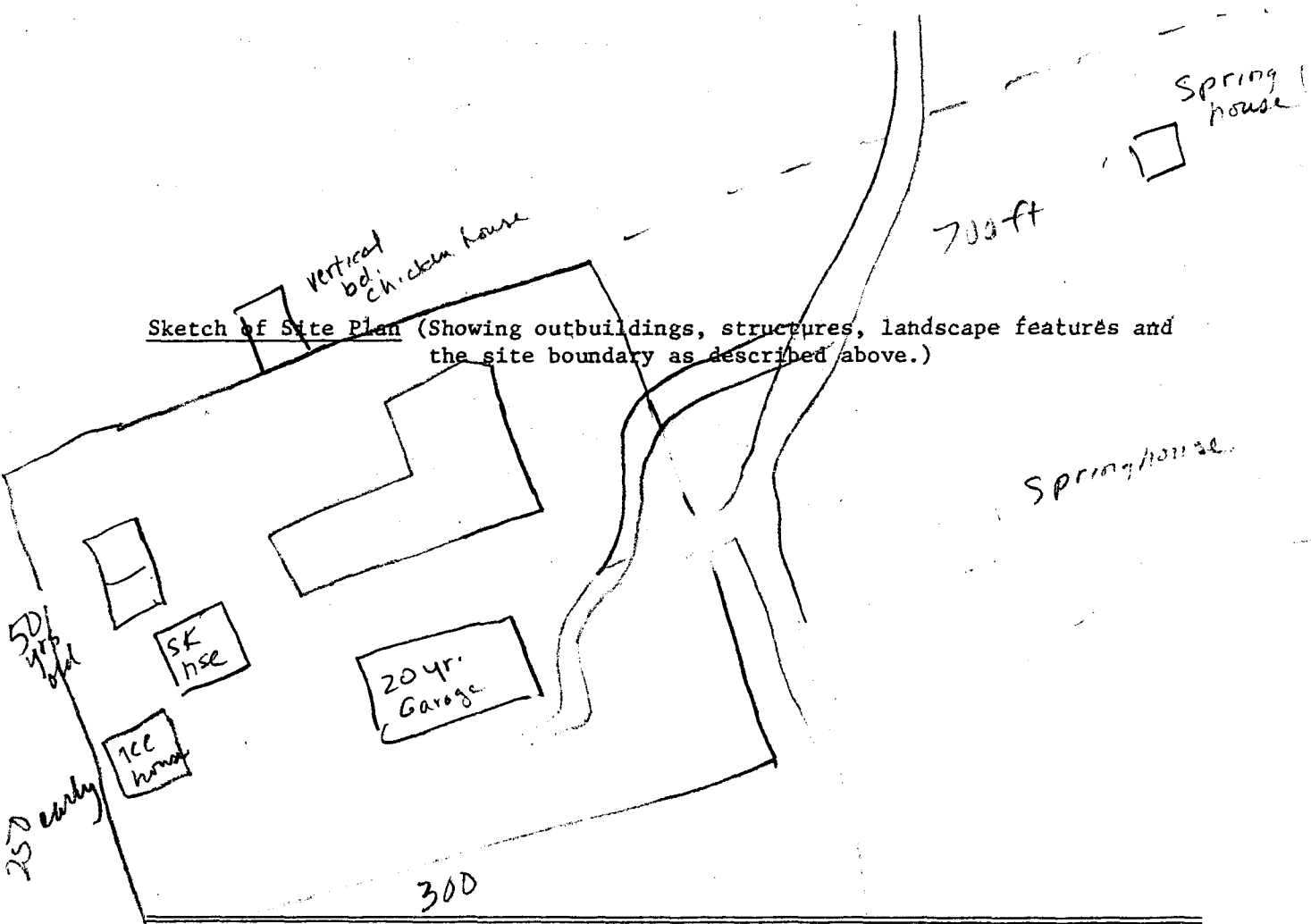

Official Courthouse Property Reference: _____