

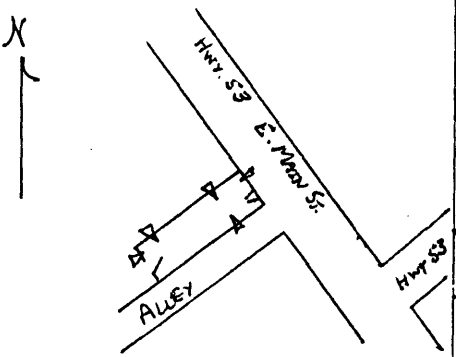

DEC 20 1982

3432

KENTUCKY HISTORIC RESOURCES INVENTORY

Site No WS-185

1. Historic Name(s) Central Bank of Willisburg and Willisburg Post Office Original Owner Central Bank of Willisburg		22. ADD/County Lincoln Trail/Wash. 115	
2. Present Name Houser Photography		23. U.S.G.S. Quadrant (15'/75') Cardwell 	
3. Location S. sd. Hwy. 53, Willisburg		24. UTM Reference 16 66,5080 4,18600,9	
4. Owner's Name Stanley Houser		25. Coordinate Accuracy 	
5. Owner's Address Rt. 1, Willisburg, Ky. 40078		26. Prehistoric Site Object Historic Site Structure <u>Building</u> Other	
6. Open to Public Yes <input checked="" type="checkbox"/> No <input type="checkbox"/>	7. Visible from road Yes <input checked="" type="checkbox"/> No <input type="checkbox"/>	8. Ownership Private <input checked="" type="checkbox"/> Local <input type="checkbox"/> State <input type="checkbox"/> Federal <input type="checkbox"/>	
9. Local Contact/Organization Owner		27. National Register District Name: N/A 	
10. Site Plan with North Arrow 	11. Architect unknown		28. Significance Evaluation NR
	12. Builder unknown		29. Status Date National Landmark <input type="checkbox"/> National Register <input type="checkbox"/> Landmark Certificate <input type="checkbox"/> Kentucky Survey <input type="checkbox"/> Local Landmark <input type="checkbox"/> HABS/HAER <input type="checkbox"/>
	13. Date c. 1906 A <input checked="" type="checkbox"/> B <input type="checkbox"/>		30. Historic Theme Primary <u>Architecture</u> Secondary <u>Commerce</u> Other
	14. Style A. Romanesque Rev <input checked="" type="checkbox"/> B. <input type="checkbox"/>		31. Endangered Yes <input type="checkbox"/> No <input checked="" type="checkbox"/>
	15. Original Use Bank 		32. Preservation Project Status N/A Actual Cost in \$ 1 000s
	16. Present use Sm. scale comm.		33. ATTACH PHOTO 
	17. Condition Good 		Roll No. <u>27</u> Picture No. <u>17A</u> Direction
	18. Description Single story brick; round arched windows w/stone voussoirs; 6/1 Eng. bond on sides w/common bond facade: facade appears to have been altered		34. Prepared by: Joe DeSpain
	(Continue on Back)		35. Organization Green Co. Hist. Soc., Inc.
	19. History The Stockholders of the Central Bank of Willisburg acquired a 1950 sq. ft. lot for \$70 from Thos. J. and Fay S. Miller in 1906. In 1936, J. M. Trent, Trustee for the Central Bank sold the lot to R. C. Pinkston. R. C. Pinkston's heirs sold to (over)		36. Date <u>11 May 1983</u>
20. Significance The only example of Romanesque Revival in Willisburg, and a building which represents turn- of-the-century commercial enterprises in rural		37. Revision Dates 38. Staff Review 	
21. Source of information See over			

HISTORY: (cont.) Mr. & Mrs. William Birch who sold to Bessie Robinson who sold to the present owner. The building has also house the Willisburg Post Office.

SOURCE OF INFORMATION: WC Deeds 39/285; 72/26; 74/621; 79/19; 79/21; 151/132

20. Washington County communities.

KENTUCKY HISTORIC RESOURCE INVENTORY SUPPLEMENT
BOUNDARY AND LOCATION INFORMATION

Central Bank of Willisburg &

Historic Property Name Willisburg Post Office Site # WS-185

Multiple Resource/Thematic Nomination Title Washington County Multiple Resource Area

U.T.M. Coordinates - List multiple UTM's if property is ten or more acres.

A. 16 665080 4185990 D. _____

B. _____ E. _____

C. _____ F. _____

Verbal Boundary Description

Acreage less than 1 acre

Lot #W5-14. The nominated acreage consists of the lot on which the building stands.

The nominated area contains one contributing building.

Sketch of Site Plan (Showing outbuildings, structures, landscape features and the site boundary as described above.)

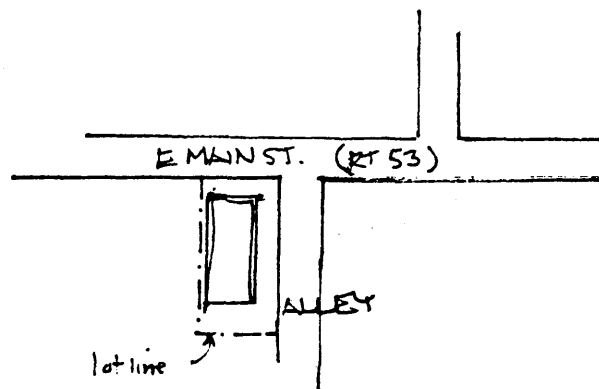

Official Courthouse Property Reference:

Washington County Courthouse , Springfield, Kentucky