

KENTUCKY HISTORIC RESOURCES INVENTORY

Site No. BC-70

1. Historic Name(s) <u>Oglesby-Conrad House</u> ✓ Original Owner _____		22. ADD County <u>Breckinridge</u> ✓ 014	
2. Present Name _____		23. U.S.G.S. Quadrant (15'/75') <u>Cloverport</u> ✓ G.I.S. Mod. [] [] [] []	
3. Location <u>Lane off U.S. 60--Outskirts of Cloverport</u>		24. UTM Reference <u>16</u> <u>530780</u> <u>4187160</u> Zone Easting Northing	
4. Owner's Name <u>Dan Burks</u>		25. Coordinate Accuracy []	
5. Owner's Address <u>Box 112, Route #2, Hardinsburg, Kentucky</u>		26. Prehistoric Site _____ Object _____ Historic Site _____ Structure _____ (Building) _____ Other _____	
6. Open to Public Yes <input checked="" type="checkbox"/> No _____	7. Visible from road Yes <input checked="" type="checkbox"/> No _____	8. Ownership [X] Private _____ [] Local _____ [] State _____ [] Federal _____ []	
9. Local Contact/Organization _____		27. National Register District Name: <u>Historic Resources of Cloverport</u> [] [] [] []	
10. Site Plan with North Arrow _____		28. Significance Evaluation <u>National Register</u> [H]	
		29. Status _____ Date _____ National Landmark _____ National Register _____ Landmark Certificate _____ Kentucky Survey _____ Local Landmark _____ HABS/HAER _____	
		30. Historic Theme Primary <u>Architecture</u> [C] Secondary <u>Settlement</u> [K] Other _____ [] []	
		31. Endangered Yes _____ No <u>XX</u>	
		32. Preservation Project Status [] Actual Cost in \$1,000s [] [] [] [] [] [] [] [] [] []	
		33. ATTACH PHOTO Roll No. <u>14</u> Picture No. <u>13 - 29</u> Direction _____	
		34. Prepared by: <u>William Gus Johnson</u> Senior Historian	
		35. Organization <u>Kentucky Heritage Council</u>	
		36. Date <u>January 1983</u>	
		37. Revision Dates _____ 38. Staff Review _____	
11. Architect _____		18. Description Situated on a rise overlooking the Cloverport-Hawesville Road (U.S.60), the Oglesby-Conrad House is a one and one-half story brick structure with a single-story brick ell. The facade is five bays wide with a center entrance which originally had a transom and sidelights now enclosed. Flemish bond brickwork accentuates the facade as well as the west side, while the (Continue on Back)	
12. Builder <u>Joseph Oglesby</u>		No. Stories <u>one & one-half</u> [B]	
13. Date <u>Ca. 1825</u> A. [2] B. []		Single Pile <u>XX</u> NA _____	
14. Style A. Federal [B] B. []		Double Pile _____	
15. Original Use <u>Dwelling</u> [A]		Floor Plan <u>Central Passage</u> [I]	
16. Present use <u>Dwelling</u>		Structural Fabric Brick A. [] B. [C]	
17. Condition <u>Good</u> [B]		Decorative Fabric Flemish bond A. [G] Common bond B. [E]	
19. History Faucett Creek runs in front of the house. Built by Joseph Oglesby, an early settler in the Cloverport area.		Roof Form <u>Gable</u>	
20. Significance <u>The Oglesby-Conrad House is architecturally significant as one of two outstanding Federal style houses in the Cloverport area.</u>		21. Source of Information _____	

18. remainder is executed in common bond brickwork with a row of headers every five rows. The brickwork is unique in that the first sixteen rows of the facade and the first seventeen rows of the west side are laid in common bond, and completed in Flemish bond brickwork. Facade windows are 9/6 pane with jack arches. Three pedimented dormer windows enhance the facade. Side and rear windows also are accented by jack arches. The main block is set off by interior gable-end chimneys with two 2/2 pane gable windows on each end, and the ell also has an interior gable-end chimney. Three ground level ventilators with limestone lintels and sills and accented by jack arches above the lintels pierce the facade. The rear is accented by two pedimented dormer windows of 1/1 pane.

KENTUCKY HISTORIC RESOURCE INVENTORY SUPPLEMENT
BOUNDARY AND LOCATION INFORMATION

Historic Property Name Oglesby-Conrad House Site # BC-70

Multiple Resource/Thematic Nomination Title Historic Resources of Cloverport

U.T.M. Coordinates - List multiple UTMs if property is ten or more acres.

A. 16 530780 4187160 D. _____

B. _____ E. _____

C. _____ F. _____

Verbal Boundary Description _____ Acreage 1

Beginning at a point 100 feet northeast of the house proceed 200 feet in a southward direction; thence 200 feet in a westward direction; thence 200 feet in a northward direction; thence 200 feet in an eastward direction to the point of origin.

Sketch of Site Plan (Showing outbuildings, structures, landscape features and the site boundary as described above.)

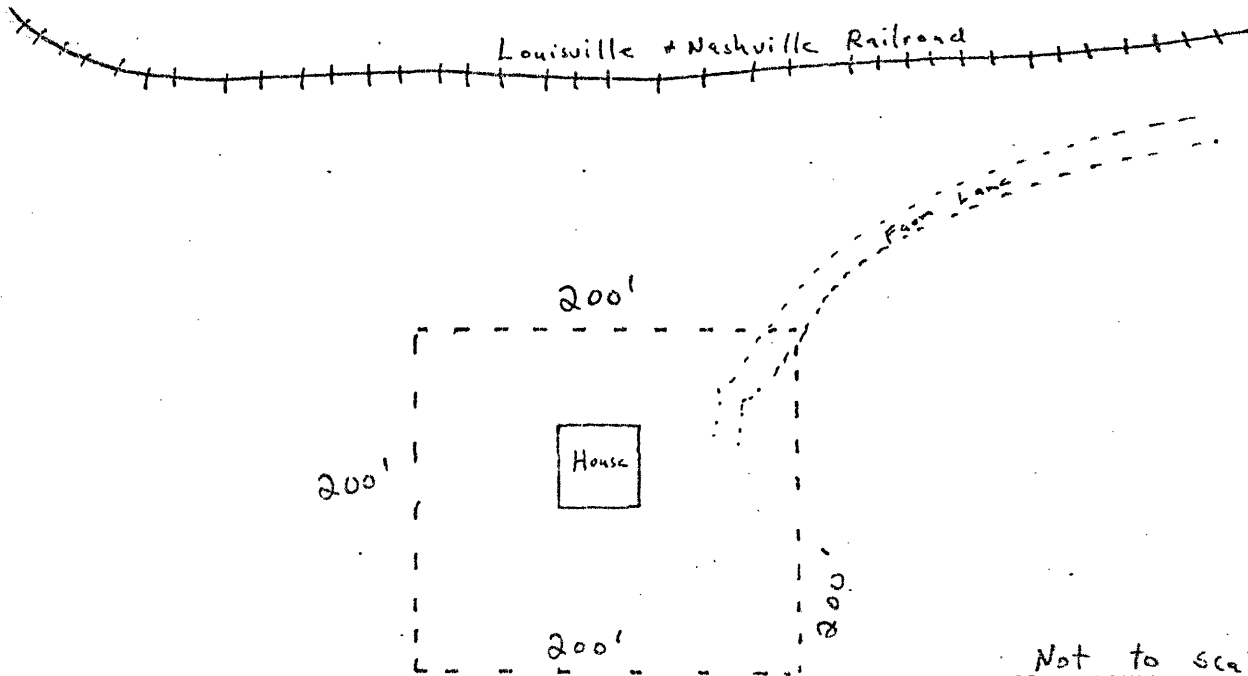

Official Courthouse Property Reference:

KENTUCKY HISTORIC RESOURCES INVENTORY

Site No. BC-70

1. Historic Name(s) <u>Oglesby-Conrad House</u> ✓ Original Owner _____		22. ADD County <u>Breckinridge</u> ✓ 014	
2. Present Name _____		23. U.S.G.S. Quadrant (15'/75') <u>Cloverport</u> ✓ G.I.S. Mod. [] [] []	
3. Location <u>Lane off U.S. 60--Outskirts of Cloverport</u>		24. UTM Reference <u>16</u> <u>530780</u> <u>4187160</u> Zone Easting Northing	
4. Owner's Name <u>Dan Burks</u>		25. Coordinate Accuracy []	
5. Owner's Address <u>Box 112, Route #2, Hardinsburg, Kentucky</u>		26. Prehistoric Site _____ Object _____ Historic Site _____ Structure _____ (Building) _____ Other _____	
6. Open to Public Yes <input checked="" type="checkbox"/> No _____	7. Visible from road Yes <input checked="" type="checkbox"/> No _____	8. Ownership [X] Private _____ [] Local _____ [] State _____ [] Federal _____ []	
9. Local Contact/Organization _____		27. National Register District Name: <u>Historic Resources of Cloverport</u> [] [] []	
10. Site Plan with North Arrow _____		28. Significance Evaluation <u>National Register</u> [H]	
		29. Status _____ Date _____ National Landmark _____ National Register _____ Landmark Certificate _____ Kentucky Survey _____ Local Landmark _____ HABS/HAER _____	
		30. Historic Theme Primary <u>Architecture</u> [C] Secondary <u>Settlement</u> [K] Other _____ [] []	
		31. Endangered Yes _____ No <u>XX</u>	
		32. Preservation Project Status _____ Actual Cost in \$1,000s [] [] [] [] [] [] [] [] [] []	
		33. ATTACH PHOTO Roll No. <u>14</u> Picture No. <u>13 - 29</u> Direction _____	
		34. Prepared by: <u>William Gus Johnson</u> Senior Historian	
		35. Organization <u>Kentucky Heritage Council</u>	
		36. Date <u>January 1983</u>	
		37. Revision Dates _____ 38. Staff Review _____	

11. Architect _____	12. Builder <u>Joseph Oglesby</u>
13. Date <u>Ca. 1825</u> A. [2] B. []	14. Style A. Federal [B] B. []
15. Original Use <u>Dwelling</u> [A]	16. Present use <u>Dwelling</u>
17. Condition <u>Good</u> [B]	18. Description Situated on a rise overlooking the Cloverport-Hawesville Road (U.S.60), the Oglesby-Conrad House is a one and one-half story brick structure with a single-story brick ell. The facade is five bays wide with a center entrance which originally had a transom and sidelights now enclosed. Flemish bond brickwork accentuates the facade as well as the west side, while the (Continue on Back)
No. Stories <u>one & one-half</u> [B]	Single Pile <u>XX</u> NA _____
Double Pile _____	Floor Plan <u>Central Passage</u> [I]
Structural Fabric <u>Brick</u> A. [] B. [C]	Decorative Fabric <u>Flemish bond</u> A. [G]
Common bond B. [E]	Roof Form <u>Gable</u>
19. History <u>Faucett Creek runs in front of the house. Built by Joseph Oglesby, an early settler in the Cloverport area.</u>	20. Significance <u>The Oglesby-Conrad House is architecturally significant as one of two outstanding Federal style houses in the Cloverport area.</u>
21. Source of Information _____	22. ADD County _____

18. remainder is executed in common bond brickwork with a row of headers every five rows. The brickwork is unique in that the first sixteen rows of the facade and the first seventeen rows of the west side are laid in common bond, and completed in Flemish bond brickwork. Facade windows are 9/6 pane with jack arches. Three pedimented dormer windows enhance the facade. Side and rear windows also are accented by jack arches. The main block is set off by interior gable-end chimneys with two 2/2 pane gable windows on each end, and the ell also has an interior gable-end chimney. Three ground level ventilators with limestone lintels and sills and accented by jack arches above the lintels pierce the facade. The rear is accented by two pedimented dormer windows of 1/1 pane.

KENTUCKY HISTORIC RESOURCE INVENTORY SUPPLEMENT
BOUNDARY AND LOCATION INFORMATION

Historic Property Name Oglesby-Conrad House Site # BC-70

Multiple Resource/Thematic Nomination Title Historic Resources of Cloverport

U.T.M. Coordinates - List multiple UTMs if property is ten or more acres.

A. 16 530780 4187160 D. _____

B. _____ E. _____

C. _____ F. _____

Verbal Boundary Description _____ Acreage 1

Beginning at a point 100 feet northeast of the house proceed 200 feet in a southward direction; thence 200 feet in a westward direction; thence 200 feet in a northward direction; thence 200 feet in an eastward direction to the point of origin.

Sketch of Site Plan (Showing outbuildings, structures, landscape features and the site boundary as described above.)

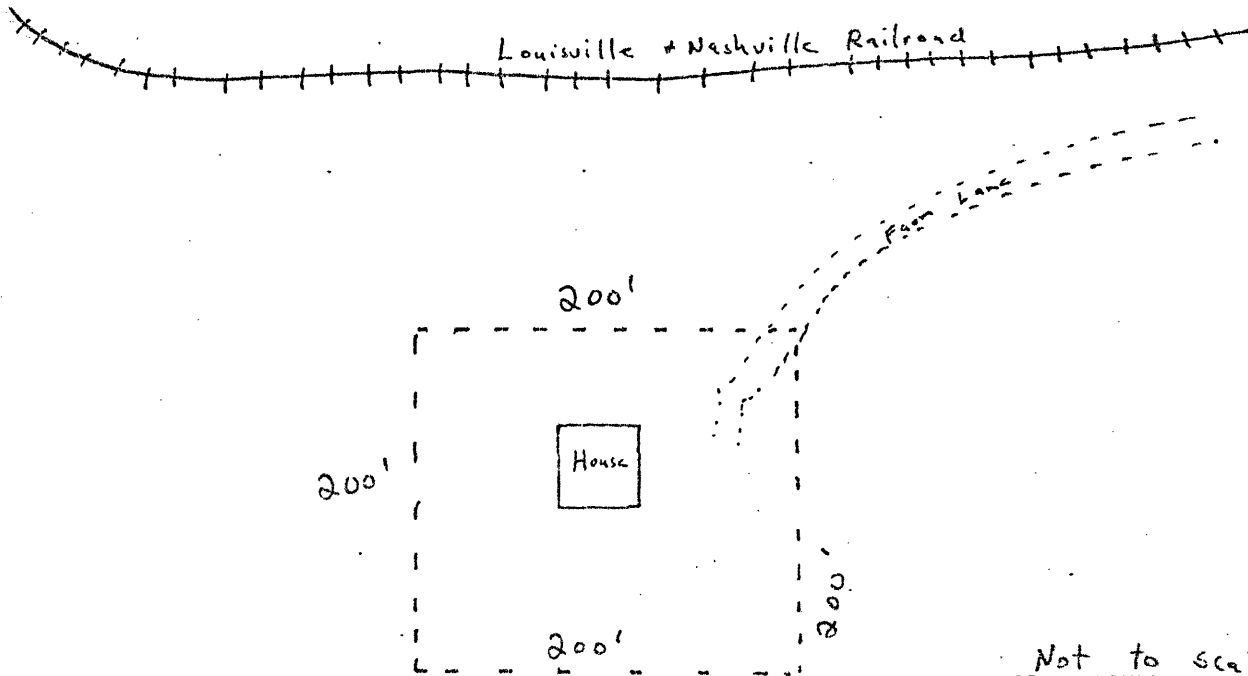

Official Courthouse Property Reference: