

UNITED STATES DEPARTMENT OF THE INTERIOR
NATIONAL PARK SERVICE

**NATIONAL REGISTER OF HISTORIC PLACES
INVENTORY -- NOMINATION FORM**

FOR FEDERAL PROPERTIES

FOR NPS USE ONLY

RECEIVED SEP 4 1981

DATE ENTERED

SEE INSTRUCTIONS IN HOW TO COMPLETE NATIONAL REGISTER FORMS
TYPE ALL ENTRIES -- COMPLETE APPLICABLE SECTIONS

1 NAME

HISTORIC
Rock Creek Guard Station, (Rock Creek Ranger Station) (24GN165)

AND/OR COMMON
Rock Creek Cabin

2 LOCATION

STREET & NUMBER Approximately 25 miles West of Philipsburg on
Highway #348 and the Rock Creek Road.

CITY, TOWN Philipsburg, Montana *vic.* VICINITY OF CONGRESSIONAL DISTRICT 27

STATE Montana CODE 30 COUNTY Granite CODE 039

3 CLASSIFICATION

CATEGORY	OWNERSHIP	STATUS	PRESENT USE
<input type="checkbox"/> DISTRICT	<input checked="" type="checkbox"/> PUBLIC	<input checked="" type="checkbox"/> OCCUPIED --seasonal	<input type="checkbox"/> AGRICULTURE <input type="checkbox"/> MUSEUM
<input checked="" type="checkbox"/> BUILDING(S)	<input type="checkbox"/> PRIVATE	<input type="checkbox"/> UNOCCUPIED	<input type="checkbox"/> COMMERCIAL <input type="checkbox"/> PARK
<input type="checkbox"/> STRUCTURE	<input type="checkbox"/> BOTH	<input type="checkbox"/> WORK IN PROGRESS	<input type="checkbox"/> EDUCATIONAL <input type="checkbox"/> PRIVATE RESIDENCE
<input type="checkbox"/> SITE	PUBLIC ACQUISITION	ACCESSIBLE	<input type="checkbox"/> ENTERTAINMENT <input type="checkbox"/> RELIGIOUS
<input type="checkbox"/> OBJECT	<input type="checkbox"/> IN PROCESS	<input type="checkbox"/> YES: RESTRICTED	<input checked="" type="checkbox"/> GOVERNMENT <input type="checkbox"/> SCIENTIFIC
	<input type="checkbox"/> BEING CONSIDERED	<input checked="" type="checkbox"/> YES: UNRESTRICTED	<input type="checkbox"/> INDUSTRIAL <input type="checkbox"/> TRANSPORTATION
	<i>N/A</i>	<input type="checkbox"/> NO	<input type="checkbox"/> MILITARY <input type="checkbox"/> OTHER:

4 AGENCY

REGIONAL HEADQUARTERS: (If applicable)
Northern Region, U. S. Forest Service

STREET & NUMBER
Federal Building

CITY, TOWN Missoula VICINITY OF STATE Montana 59807

5 LOCATION OF LEGAL DESCRIPTION T8N, R17W-Sec. 27

COURTHOUSE,
REGISTRY OF DEEDS, ETC. Lands Division, Northern Region Office

STREET & NUMBER
Federal Building

CITY, TOWN Missoula STATE Montana 59807

6 REPRESENTATION IN EXISTING SURVEYS

TITLE
NA

DATE
NA FEDERAL STATE COUNTY LOCAL

DEPOSITORY FOR
SURVEY RECORDS *NA*

CITY, TOWN *NA* STATE

7 DESCRIPTION

CONDITION		CHECK ONE	CHECK ONE
<input checked="" type="checkbox"/> EXCELLENT	<input type="checkbox"/> DETERIORATED	<input type="checkbox"/> UNALTERED	<input checked="" type="checkbox"/> ORIGINAL SITE
<input type="checkbox"/> GOOD	<input type="checkbox"/> RUINS	<input checked="" type="checkbox"/> ALTERED	<input type="checkbox"/> MOVED DATE _____
<input type="checkbox"/> FAIR	<input type="checkbox"/> UNEXPOSED		

DESCRIBE THE PRESENT AND ORIGINAL (IF KNOWN) PHYSICAL APPEARANCE

The one and one-half-story Rock Creek cabin is constructed of logs that were squared by broad axe. The logs are dovetail notched (compound angle) and daubed with cement that is chinked with quarter-split poles on the cabin's north interior. The gables have clapboard siding. The cabin measures 27 x 26', with an attached front porch extending 8' beyond the building's southwest wall. A cement foundation supports the cabin.

A brick chimney vents the original cast iron Majestic, a woodburning stove still used for cooking and heating. A propane stove and refrigerator have been added to the original furnishings. A permanent ladder extends to the sleeping and storage loft, which was built with roughcut lumber.

After its construction in 1915, the cabin's upkeep has been maintained by Forest Service employees.

The cabin received a new porch and 2" pine, tongue and groove floor in 1939; a new roof in 1943; and a rear kitchen lean-to in the forties that was removed in 1974. In 1975, YCC crews replaced the cedar shake roof and installed a new tongue and groove floor of 4" pine. They applied new cement daubing to the exterior log joints in 1976.

A corral and loading chute are 54' west of the cabin, which is surrounded by a 55 x 90' lodgepole rail fence. Eighty-two feet northeast of the cabin is a springhouse built directly over Tindall Creek.

The 13 x 11.75' structure was built of axe-cut logs that are both v-notched and saddle-notched. The cement daubing is deteriorating and many of the log joints are exposed. The building has a flagstone floor and a green shingle roof. Food is suspended from the ceiling for storage.

8 SIGNIFICANCE

PERIOD	AREAS OF SIGNIFICANCE -- CHECK AND JUSTIFY BELOW			
<input type="checkbox"/> PREHISTORIC	<input type="checkbox"/> ARCHEOLOGY-PREHISTORIC	<input type="checkbox"/> COMMUNITY PLANNING	<input type="checkbox"/> LANDSCAPE ARCHITECTURE	<input type="checkbox"/> RELIGION
<input type="checkbox"/> 1400-1499	<input type="checkbox"/> ARCHEOLOGY-HISTORIC	<input checked="" type="checkbox"/> CONSERVATION	<input type="checkbox"/> LAW	<input type="checkbox"/> SCIENCE
<input type="checkbox"/> 1500-1599	<input type="checkbox"/> AGRICULTURE	<input type="checkbox"/> ECONOMICS	<input type="checkbox"/> LITERATURE	<input type="checkbox"/> SCULPTURE
<input type="checkbox"/> 1600-1699	<input checked="" type="checkbox"/> ARCHITECTURE	<input type="checkbox"/> EDUCATION	<input type="checkbox"/> MILITARY	<input type="checkbox"/> SOCIAL/HUMANITARIAN
<input type="checkbox"/> 1700-1799	<input type="checkbox"/> ART	<input type="checkbox"/> ENGINEERING	<input type="checkbox"/> MUSIC	<input type="checkbox"/> THEATER
<input type="checkbox"/> 1800-1899	<input type="checkbox"/> COMMERCE	<input type="checkbox"/> EXPLORATION/SETTLEMENT	<input type="checkbox"/> PHILOSOPHY	<input type="checkbox"/> TRANSPORTATION
<input checked="" type="checkbox"/> 1900-	<input type="checkbox"/> COMMUNICATIONS	<input type="checkbox"/> INDUSTRY	<input type="checkbox"/> POLITICS/GOVERNMENT	<input type="checkbox"/> OTHER (SPECIFY)
		<input type="checkbox"/> INVENTION		

SPECIFIC DATES constructed 1894-1902 BUILDER/ARCHITECT A. Hutsinfiller (?)

STATEMENT OF SIGNIFICANCE

The Rock Creek Cabin's architectural design and craftsmanship are its most significant features. The cabin and adjoining spring house are excellent examples of early Forest Service stations and exhibit expert craftsmanship in log construction. They were probably built by A. Hutsinfiller (Hutsinfiller?), who began squatting on the public land in 1894. He sold the ranch buildings (1 two-roomed house, 4 out buildings, 2 barns) to D. L. Walker of Phillipsburg in October 1902. The place was known as the Walker Goat Ranch when Forest Service officials began eviction proceedings in 1907. Walker was paid \$200 for the seized ranch improvements, and the cabin was converted to an administrative site, the Rock Creek Ranger Station, by 1915. Mules and maintenance crews were stationed at the work center. Recently volunteers to the National Forest serving as campground hosts have lived in the cabin each summer. The building also still serves as a work center for occasional crews.

9 MAJOR BIBLIOGRAPHICAL REFERENCES

Lolo National Forest.
 n.d. 2760 withdrawals file, Administrative Site (Rock Creek Ranger Station),
 Supervisor's Office, Lolo National Forest, Missoula, Montana.

10 GEOGRAPHICAL DATA

ACREAGE OF NOMINATED PROPERTY 1
 UTM REFERENCES

A	<u>12</u>	<u>29, 13, 2, 5</u>	<u>5, 14, 43, 4, 0</u>	B			
	ZONE	EASTING	NORTHING		ZONE	EASTING	NORTHING
C				D			

VERBAL BOUNDARY DESCRIPTION

The Rock Creek Ranger Station lies near the junction of Rock Creek and Tindall Gulch. The boundaries are Rock Creek Road 300' southeast from the (southern end) of the Camp Siria Loop Road. Northeast to Tindall Creek (approximately 400'). The boundary then follows Tindall Creek (an intermittent stream) 500' northwest. The limits then turn southwest to the Rock Creek Road terminating 300' northwest from the (southern end) of the Camp Siria Loop Road.

LIST ALL STATES AND COUNTIES FOR PROPERTIES OVERLAPPING STATE OR COUNTY BOUNDARIES

STATE	CODE	COUNTY	CODE
<i>NA</i>			
<i>NA</i>			

11 FORM PREPARED BY

NAME / TITLE

Elaine Howard, Social Science Tech., & C. Milo McLeod, Forest Archeologist

ORGANIZATION

USFS, Lolo National Forest

DATE

April 29, 1981

STREET & NUMBER

Building 24, Fort Missoula

TELEPHONE

406-329-3222

CITY OR TOWN

Missoula

STATE

Montana 59401

12 CERTIFICATION OF NOMINATION

STATE HISTORIC PRESERVATION OFFICER RECOMMENDATION

YES NO NONE

Maxwell Deffen Deputy for
 STATE HISTORIC PRESERVATION OFFICER SIGNATURE

In compliance with Executive Order 11593, I hereby nominate this property to the National Register, certifying that the State Historic Preservation Officer has been allowed 90 days in which to present the nomination to the State Review Board and to evaluate its significance. The evaluated level of significance is National State Local.

FEDERAL REPRESENTATIVE SIGNATURE

TITLE Director, Recreation

DATE 1-10-82

FOR NPS USE ONLY

I HEREBY CERTIFY THAT THIS PROPERTY IS INCLUDED IN THE NATIONAL REGISTER

William H. Brauman

DATE 7.13.82

DIRECTOR, OFFICE OF ARCHEOLOGY AND HISTORIC PRESERVATION

ATTEST:

DATE

KEEPER OF THE NATIONAL REGISTER

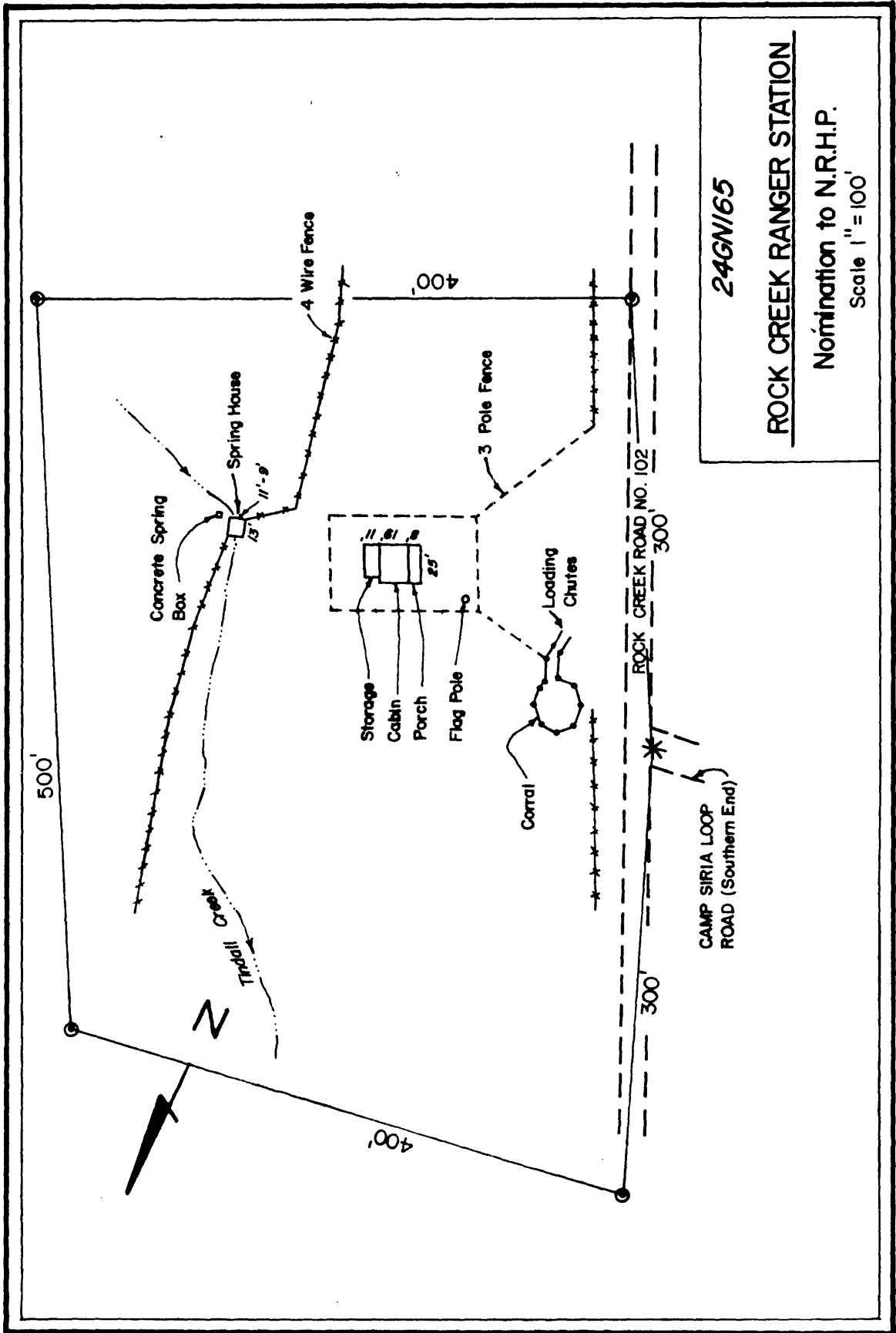

24GN/65

ROCK CREEK RANGER STATION

Nomination to N.R.H.P.

Scale 1" = 100'