

**United States Department of the Interior  
Heritage Conservation and Recreation Service**

**National Register of Historic Places  
Inventory—Nomination Form**

See instructions in *How to Complete National Register Forms*  
Type all entries—complete applicable sections

For HCRS use only

received JUN 5 1980  
date entered AUG 6 1980

## 1. Name

historic Graves Hotel

and/or common

## 2. Location

street & number 106 South Central Ave \_\_\_\_\_ not for publication

city, town Harlowton \_\_\_\_\_ vicinity of \_\_\_\_\_ congressional district 2nd

state Montana code 30 county Wheatland code 107

## 3. Classification

Category	Ownership	Status	Present Use	
<input type="checkbox"/> district	<input type="checkbox"/> public	<input checked="" type="checkbox"/> occupied	<input type="checkbox"/> agriculture	<input type="checkbox"/> museum
<input checked="" type="checkbox"/> building(s)	<input checked="" type="checkbox"/> private	<input type="checkbox"/> unoccupied	<input checked="" type="checkbox"/> commercial	<input type="checkbox"/> park
<input type="checkbox"/> structure	<input type="checkbox"/> both	<input type="checkbox"/> work in progress	<input type="checkbox"/> educational	<input type="checkbox"/> private residence
<input type="checkbox"/> site	<b>Public Acquisition</b>	<b>Accessible</b>	<input type="checkbox"/> entertainment	<input type="checkbox"/> religious
<input type="checkbox"/> object	<input type="checkbox"/> in process	<input type="checkbox"/> yes: restricted	<input type="checkbox"/> government	<input type="checkbox"/> scientific
	<input type="checkbox"/> being considered	<input checked="" type="checkbox"/> yes: unrestricted	<input type="checkbox"/> industrial	<input type="checkbox"/> transportation
		<input type="checkbox"/> no	<input type="checkbox"/> military	<input type="checkbox"/> other:

## 4. Owner of Property

name The Graves Corporation, J.D. Bain, President; D. Swanz, Sec-Treas.

street & number 106 South Central Ave

city, town Harlowton \_\_\_\_\_ vicinity of \_\_\_\_\_ state Montana

## 5. Location of Legal Description

courthouse, registry of deeds, etc. Wheatland County Courthouse

street & number Clerk and Recorder's Office

city, town Harlowton \_\_\_\_\_ state Montana

## 6. Representation in Existing Surveys

title NONE has this property been determined eligible?  yes  no

date \_\_\_\_\_ federal \_\_\_\_\_ state \_\_\_\_\_ county \_\_\_\_\_ local

depository for survey records

city, town \_\_\_\_\_ state

## 7. Description

<b>Condition</b>		<b>Check one</b>	<b>Check one</b>
<input type="checkbox"/> excellent	<input type="checkbox"/> deteriorated	<input type="checkbox"/> unaltered	<input checked="" type="checkbox"/> original site
<input checked="" type="checkbox"/> good	<input type="checkbox"/> ruins	<input checked="" type="checkbox"/> altered	<input type="checkbox"/> moved date _____
<input type="checkbox"/> fair	<input type="checkbox"/> unexposed		

### Describe the present and original (if known) physical appearance

Built in 1908, the Graves Hotel is a three story sandstone "L" shaped building standing atop "Main Street Hill" in Harlowton, Montana, overlooking the Mussellshell Valley.

The Southern and Eastern exposures of the "L" (measuring 100 feet and 80 feet respectively) are each interspaced by ten inset, double-pane windows on all three floors. The convergance of the two sides of the "L" present a 'flat' corner on the main floor and on the second and third floors introduce five-windowed projecting wooden bays which are topped by a unique metal cupola on the roof which supports a flag pole. The entire corner interest demonstrates a Gothic Revival influence in the structure. The roof is in need of general repair and the bay area and cupola need painting.

The second floor veranda is surrounded by a four foot high white banister and measures a total of 150 feet along the southern and eastern exposures of the Hotel. The veranda is supported by fourteen white Doric columns, seven on each exposure, which are set upon a cement porch following the contours of the hilltop lots, leveling off the understructure of the building.

A wooden cornice centrally located on the roof edge of the Hotel's eastern exposure bears the legend: Graves Hotel - 1908. The Hotel's flat roof is edged on the southern, eastern and northern exposures by a metal moulding, simple with dentils.

The back of the building is simple, plain and utilitarian with back entrances for tradesmen, fire exits, garbage areas, air conditioners, and loading and unloading areas. All of the trim of the Hotel needs painting.

A partial basement sits under the building and contains freezers, food storage areas, furnace and hot water heater, storage areas and a small laundry. Basement is not fully under hotel, rather it extends under two wings and ends before the lobby, or middle square of the building.

The stone for the Graves Hotel was quarried out of the cliff under the Graves Hotel and was cut and laid by a German immigrant named August Pollman. August was assisted with the handiwork, all manual labor, by a crew of Harlowton men who also helped with numerous other local buildings and private homes in the town, all sandstone.

After 70 years, these sandstone buildings still attest to the excellent workmanship of Stonemason, August Pollman.

INTERIOR: Oak is a treasured wood and it is shown in all its beauty in the Graves Hotel woodwork throughout the building. No where is it more beautifully presented than in the front staircase beginning on the Main floor Lobby and on up to the second and third floors. Even the back staircase shows workmanship and design seldom seen in modern buidings.

The Hotel still has its large, spacious lobby with large picture windows overlooking the Mussellshell Valley. The lobby, main floor public areas (Optometrist office, office, cafe, bar and dining areas), and sleeping rooms and suite have all been extensively remodeled through the years. The Hotel maintains much of its original charm particularly on the second and third floors.

**United States Department of the Interior  
Heritage Conservation and Recreation Service**

**National Register of Historic Places  
Inventory—Nomination Form**



Continuation sheet

Item number 7

Page 1

The second floor has seventeen sleeping rooms, eight baths, one public restroom, and one suite and storage areas.

A unique feature of the Graves Hotel are the four 'inside' rooms. Inside rooms are rooms which were rented cheaper to overnighters in the 'old days' because there was no outside ventilation. The light and air was furnished to the rooms by the three large windows facing the hall which were of course covered with shades for privacy. The windows have now been painted over and the rooms are used for storage only.

The high ceilings of the rooms, old light fixtures, porcelain sinks, beautiful woodwork, period dressers, tables, chairs, mirrors and so on all add to the general old-fashioned and victorian feeling of the Graves Hotel.

# 8. Significance

Period	Areas of Significance—Check and justify below			
<input type="checkbox"/> prehistoric	<input type="checkbox"/> archeology-prehistoric	<input type="checkbox"/> community planning	<input type="checkbox"/> landscape architecture	<input type="checkbox"/> religion
<input type="checkbox"/> 1400–1499	<input type="checkbox"/> archeology-historic	<input type="checkbox"/> conservation	<input type="checkbox"/> law	<input type="checkbox"/> science
<input type="checkbox"/> 1500–1599	<input type="checkbox"/> agriculture	<input type="checkbox"/> economics	<input type="checkbox"/> literature	<input type="checkbox"/> sculpture
<input type="checkbox"/> 1600–1699	<input checked="" type="checkbox"/> architecture	<input type="checkbox"/> education	<input type="checkbox"/> military	<input checked="" type="checkbox"/> social/
<input type="checkbox"/> 1700–1799	<input type="checkbox"/> art	<input type="checkbox"/> engineering	<input type="checkbox"/> music	<input type="checkbox"/> humanitarian
<input checked="" type="checkbox"/> 1800–1899	<input checked="" type="checkbox"/> commerce	<input type="checkbox"/> exploration/settlement	<input type="checkbox"/> philosophy	<input type="checkbox"/> theater
<input type="checkbox"/> 1900–	<input type="checkbox"/> communications	<input type="checkbox"/> industry	<input type="checkbox"/> politics/government	<input type="checkbox"/> transportation
		<input type="checkbox"/> invention		<input type="checkbox"/> other (specify)

**Specific dates** 6/1/08:6/19/09 **Builder/Architect** A.C. Graves/Kent & Shanley

### Statement of Significance (in one paragraph)

The Graves Hotel was the first large structure rebuilt after the Harlowton fire of 1907, a disaster that almost completely destroyed the business district of the town. The Hotel has been a center of community life since its opening in 1909 by being a business and social meeting place for all residents of Wheatland County these many years. The Graves Hotel was the first sandstone building erected in Harlowton and is a good example of the stone architecture common and peculiar to this area. The Hotel was built on top of "Main Street Hill" (Central Avenue) overlooking the Mussellshell Valley, site of the first big cattle drives in Montana, and overseeing the Milwaukee Railroad Yards.

At the time of his death in 1913 at the age of 47, A.C. "Chris" Graves was fondly called the "Father of Harlowton". His sudden and tragic death, the result of an auto accident, left the entire community bereft: Never had Harlowton seen such a demonstration of reverent admiration as this funeral called forth...<sup>1</sup>

"The many, varied and active interests of Chris Graves..., had brought him in contact with every facet of the community and business life of the town and surrounding area. He started businesses and helped others start them, bought and sold real estate, started a brick making plant, operated a meat business continuously, and in 1909 advertised "Townsite Owner of Harlowton"...<sup>2</sup>

Mr. Graves' most lasting monument was to be a hotel. Harlowton had not had a hotel since the Leland burned in 1907. On June 1, 1908 in the office of H.E. Marshall, the paper reported, the Graves Hotel Company was organized. The capital stock was \$40,000 and the life of the company would be 20 years. The work for excavating the cellar for the hotel was started on June 2 with Shueman & McNeese having the contract.

By late October, work on the hotel was progressing nicely..."Carpenters are busy putting up the framework on the second story and by Saturday night the stone masons will have the stonework finished for the first story." On January 1, 1909 readers were told, "The Harlowton Light and Water Company has commenced the electric wiring in the Graves Hotel. It will be illuminated by 150 electric lights and wired for intercommunicating telephone system."<sup>3</sup> It would be a three story structure containing 45 rooms, with modern plumbing and heating. The hotel was expected to be completed by June and it was.

The formal and grand opening of the Graves Hotel was held on Saturday, June 19, 1909. "It was a proud and happy day for the promoter, A.C. Graves, and the proprietor, J.N. Kleber the news reported in a lengthy article on the event..."At nine o'clock the guests began to gather at the hotel, which was brilliant in the most elaborate electrical display in this section of Montana. The building dazzled... The Harlowton Band played special music for the occasion..the lobby and dining room were festooned in colors of the flag.. costly bouquets of cut flowers gave a finishing touch. At 9:20 the guests formed a procession in the lobby and spacious hall on the second floor. The orchestra struck up a smart two-step...Mr. and Mrs. A.C. Graves led the Grand March, followed by Mr. and Mrs. Kleber... Dancing was resumed and "the merry making did not break up until nearly dawn."<sup>4</sup>

# 9. Major Bibliographical References

HARLOWTON TIMES, Issues of 1913, March. HARLOWTON TIMES CLARION, January 5, 1978  
 MUSSELLSHELL NES, Issues of 1907, 1908, 1909  
 "Specifications of Heating and Plumbing, Notice to Contractors", 1908  
 "Yesteryears and Pioneers" Harlowton Women's Club, cc 1976

# 10. Geographical Data

**UTM NOT VERIFIED**

Acreege of nominated property less than 1/2 acre

Quadrangle name unsurveyed area

**ACREAGE NOT VERIFIED**

Quadrangle scale \_\_\_\_\_

UMT References

A 

Zone	Easting			Northing					

B 

Zone	Easting			Northing					

C 

--	--	--	--	--	--	--	--	--	--

D 

--	--	--	--	--	--	--	--	--	--

E 

--	--	--	--	--	--	--	--	--	--

F 

--	--	--	--	--	--	--	--	--	--

G 

--	--	--	--	--	--	--	--	--	--

H 

--	--	--	--	--	--	--	--	--	--

## Verbal boundary description and justification

Lots 1, 2, 3, 4, 5, 6 of Milwaukee 2nd Addition, Block no. 27 Harlowton, Wheatland Co., Montana T8N, R15E

SE 1/4 SW 1/4 SE 1/4 section 22

## List all states and counties for properties overlapping state or county boundaries

state None code \_\_\_\_\_ county \_\_\_\_\_ code \_\_\_\_\_

state \_\_\_\_\_ code \_\_\_\_\_ county \_\_\_\_\_ code \_\_\_\_\_

# 11. Form Prepared By

name/title Nancy E. Widdicombe, Researcher

organization Graves Hotel

date March 6, 1980

street & number 106 South Central Ave

telephone 406-632-5679

city or town Harlowton

state Montana

# 12. State Historic Preservation Officer Certification

The evaluated significance of this property within the state is:

national  state  local

As the designated State Historic Preservation Officer for the National Historic Preservation Act of 1966 (Public Law 89-665), I hereby nominate this property for inclusion in the National Register and certify that it has been evaluated according to the criteria and procedures set forth by the Heritage Conservation and Recreation Service.

State Historic Preservation Officer signature

*[Handwritten Signature]*

title State Historic Preservation Officer

date 5-29-80

For NCRS use only

I hereby certify that this property is included in the National Register

*[Handwritten Signature]* W. Ray June 8/6/80

Manager of the National Register

Attest: *[Handwritten Signature]* Paula Spence 1/2/80

Chief of the National Register

**United States Department of the Interior  
Heritage Conservation and Recreation Service**

**National Register of Historic Places  
Inventory—Nomination Form**



Continuation sheet

Item number 8

Page 1

<sup>1</sup>The Harlowton Times, March 1913 "A.C. Graves Obituary" as preached by Rev. H.G. Klemme

<sup>2</sup>Times Clarion Article "The Story of A.C. Graves as told by ... Jan. 5, 1978 Grace Pound, Historian

<sup>3</sup>ibid.

<sup>4</sup>ibid.

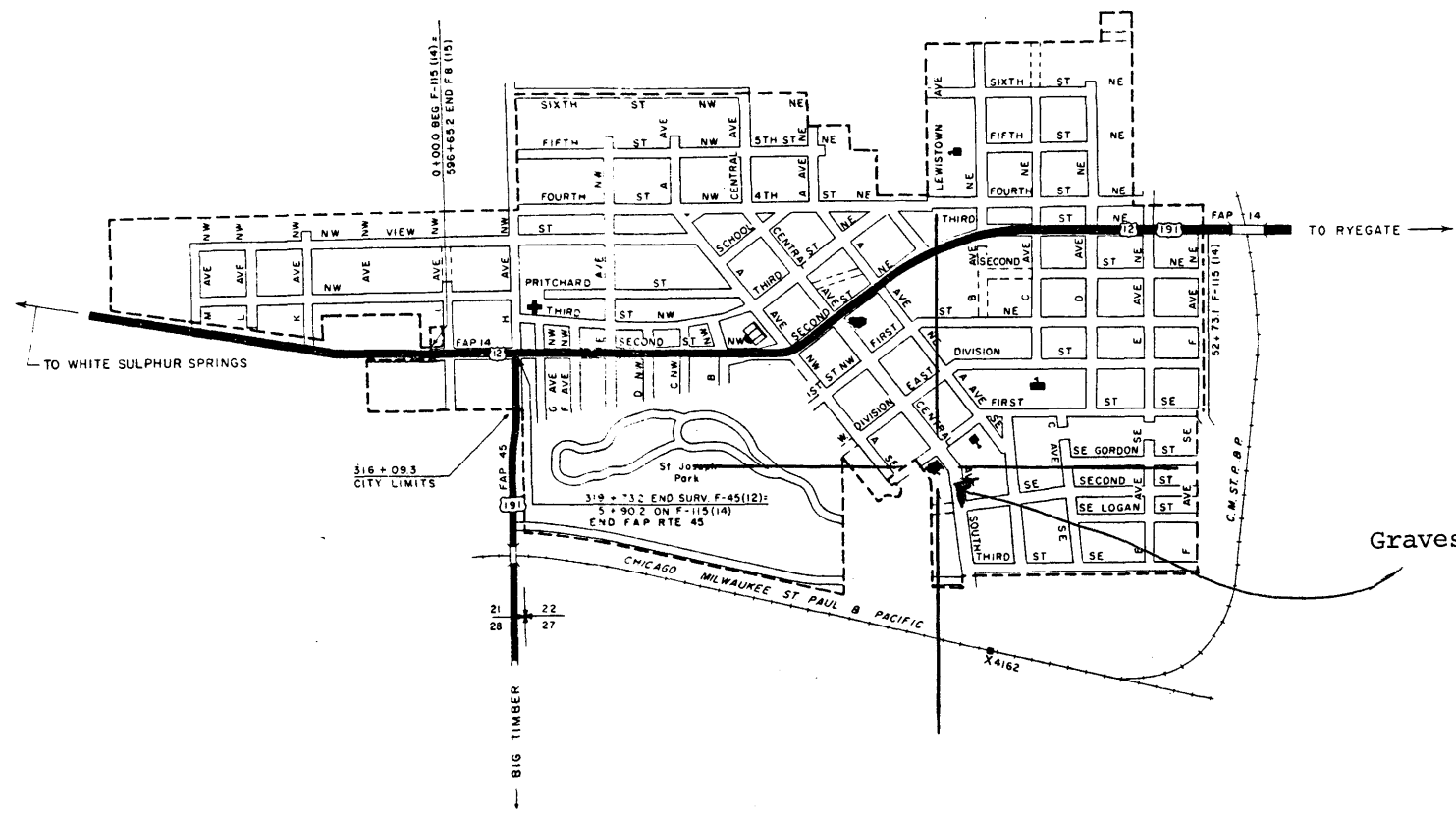

- PROPOSED ROAD
- ==== GRADED AND DRAINED ROAD
- GRAVEL OR STONE ROAD
- LOW TYPE BITUMINOUS ROAD
- PAVED ROAD
- DIVIDED ROAD - TRAFFIC FLOW
- F A I FEDERAL AID INTERSTATE SYSTEM
- F A P FEDERAL AID PRIMARY SYSTEM

- LEGEND**
- F A S FEDERAL AID SECONDARY SYSTEM
  - 90 INTERSTATE ROUTE MARKER
  - 10 US NUMBERED ROUTE MARKER
  - 13 STATE ROUTE MARKER
  - 382 OTHER ROUTE MARKER
  - CORPORATE BOUNDARY LINE
  - NON-EXISTENT DEDICATED STREET
  - CENTRAL BUSINESS DISTRICT

- URBAN EXTENSION BOUNDARY
- RAILROAD AND STATION
- POST OFFICE
- COURT HOUSE
- ELEMENTARY SCHOOL
- HIGH SCHOOL
- HOSPITAL
- X 3929 ELEVATION



CITY PLAT  
**HARLOWTON**  
WHEATLAND COUNTY  
**MONTANA**  
1970 CENSUS 1,375  
SCALE IN FEET  
600 0 600