

KENTUCKY HISTORIC RESOURCES
Individual Inventory Form

Resource # MS-27
MASON County

1. Name of Resource: Charles Pelham House

2. Original Owner: Major Charles Pelham

3. Other Names: Taylor House, Grant House

4. Prehistoric Site _____ Building Object _____
Historic Site _____ Structure _____ Other _____

5. Location: West side of Taylor Mill Road on north side of North Fork Licking, near Orangeburg

6. Owner's Name: Mr. & Mrs. David Collins [P]

7. Owner's Address: Post Office Box 285
Flemingsburg, Kentucky 41041

8. Evaluation: [G]

9. Recognition & Date:
Nat.Landmark _____ Local Landmark _____
Nat.Register _____ HABS/HAER _____
Highway Marker _____ KY Inventory
KY Landmark Certificate _____

10. N.R.Status & Date: _____

11. N.R.Group:
District Name: []
Mult.Resource Area: []
Thematic Name: Early Stone Buildings []

12. Historical Theme:
Primary: Architecture [030]
Secondary: Settlement [140]
Other: []

13. Statement of Significance:
One of two known houses in the State with plank-framed partition walls, one of two stone houses with this floor plan; unusually large for date. In excellent condition and primarily original,

[]

14. History:
Research indicates house was built by Charles Pelham, Major of the Revolutionary War, who is on the earliest extant (1789) Kentucky tax list. He is on the 1800 census of Mason County and held title to the stone house tract and mill until the 1810s when sold to the Taylor family after whom the mill and road became known. Property belonged to the Grant family in the 20th century.

15. Source of historical information and/or contact person:
Researched by owner and Carolyn M. Wooley

16. Date: Original Building late 19th Century [9]
Addition []

17. Style: Federal [21]
[]

18. Architect/Builder: Not Known

19. No. of Stories: 2 1/2 plus attic, cellar [2.5]

20. Original Floor Plan: Side Passage [SP]

21. Single Pile _____ Double Pile N.A. _____

22. Roof Form & Material: Original _____
Gable Not Original

23. Structural Material: [S]

24. Exterior Material: [S]
[]

25. Foundation Material: [S]

26. Major Alterations: None _____
Moved/Rebuilt Other _____
Additions _____

27. Special Features: Plank framed partition walls

28. Outbuildings: [0]

29. Original Function: Residence [01A]

30. Present Use: Residence [01A]

31. Condition: [E]

32. Endangered: Yes _____
No

33. Attach Photos: Roll: 22 Photo Nos: 14-24 No. of Slides: _____

34. Prepared by: Carolyn Murray-Wooley

35. Organization: Kentucky Heritage Council

36. Date: April 1984

37. New Survey _____ Resurvey

KENTUCKY HISTORIC RESOURCES INVENTORY

36. UTM Point of Primary Building: 17/261730/4272850
37. USGS Quadrant: Orangeburg
38. G.I.S. Mod. []
39. Coordinate Accuracy []
40. UTM Points of Boundary:
- A. 17/261850/4272930
- B. 17/261760/4272750
- C. 17/261700/4272860
- D. 17/261760/4272960
- E. _____
- F. _____
41. Total Acreage in Present Property: ca.4
42. Acreage Included in Nominated Boundary: ca.4
43. Site Plan and Boundary Description and Justification:

Site enclosed by A-B-C-D, as shown, which is present property boundary. A-B is along river, D-A is with road.

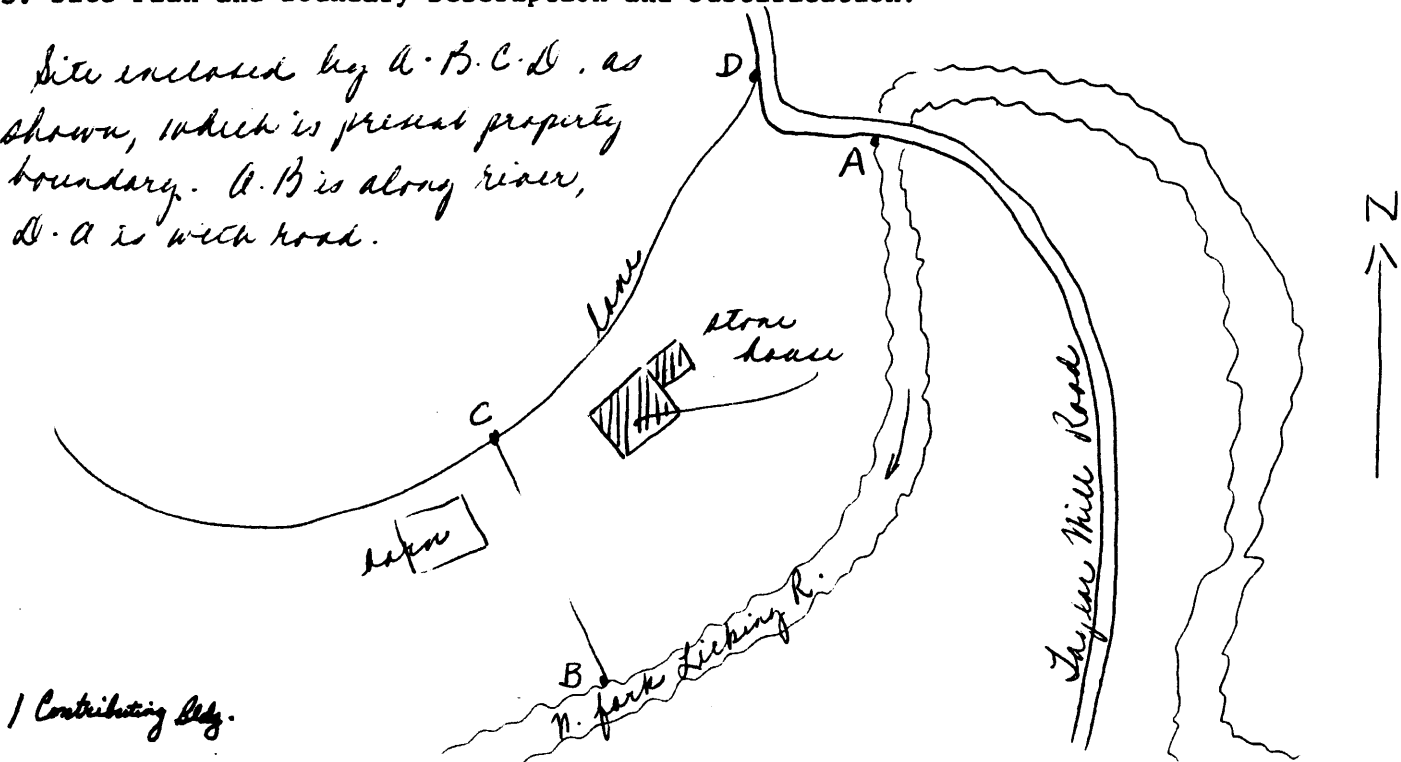

1 Contributing Bldg.

44. Description and House Plan:

2 1/2 story, 3 bay, side passage, double pile dry stone house. Built of grey colored Upper Ordovician Grant Lake limestone, tooled and coursed; voussoirs above cellar openings only. Main block has two interior chimneys on south gable end. Frames pegged, square sills. Built on side of hill facing creek, creating high basement on east front where cellar entrance is in center bay; other cellar windows have horizontal diamond bars. Depth of house creates large attic which is fully sheathed with horizontal beaded boards. There is a small stair to the floored space above the collar beams (the 4th floor, not counting the cellar). Attic (3rd floor) has full-size 6/6 windows, One on south end, two on north end. West rear doorway is extra wide, double doors of three panels each. House contains original mantels, presses built beside fireplaces, chairrail. The open U stairway has open stringer, square balusters and newell; newells also in wall along stair, connected by chairrail. Partition walls of house are staggered vertical planks which are the framing members; these have lathe and plaster applied directly. Most woodwork is pine, some ash; pine presses.

The attached kitchen wing contains a cooking fireplace with opening 5 feet high and 10 feet wide spanned by a single timber lintel. The chimney is centered behind the roof ridge. There is one square attic window forward the ridge. A shed roofed porch spans the rear of the wing and an enclosed shed room (later) is on the wing front. House built on side of hill facing valley of North Fork of Licking River, where owner's mill was located.

