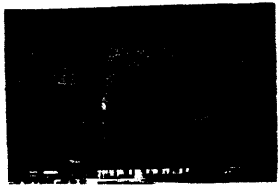

<b>1</b> City, Village or Town: WAUKESHA	County: WAUKESHA	Surveyor: HMTB	Date: 2/10/82	Wisconsin Avenue Street		
Street Address: 247 Wisconsin Avenue		Legal Description: Addendum	Acreage: Less than one acre			
Current Name & Use: First Baptist Church		Current Owner: First Baptist Church of Waukesha			247 Number	
Film Roll No. WK-4		Current Owner's Address: 247 Wisconsin Avenue				
Negative No. 29		Special Features Not Visible In Photographs: UTM: Zone 16 Easting: 399670 Northing: 4762380 USGS Waukesha Quadrangle/Scale: 1:24,000 Interior visited? <input checked="" type="radio"/> Yes <input type="radio"/> No				
Facade Orient. N						
<b>2</b> Original Name & Use: First Baptist Church		Source A	Previous Owners	Dates	Uses	Source
Dates of Construction / Alteration 1872/1922/1959	Source A/C					
Architect and/or Builder: E. T. Mix (1872)/H. C. Hengels (1922)	Source B/C					
<b>3</b> Architectural Significance <input type="radio"/> Represents work of a master <input type="radio"/> Possesses high artistic values <input checked="" type="radio"/> Represents a type, period, or method of construction <input checked="" type="radio"/> Is a visual landmark in the area <input type="radio"/> Other: _____ <input type="radio"/> None	Architectural Statement: See Continuation Sheet					Section Map Name
<b>4</b> Historical Significance <input type="radio"/> Assoc. with lives of significant persons <input type="radio"/> Assoc. with significant historical events <input type="radio"/> Assoc. with development of a locality <input type="radio"/> Other: _____ <input checked="" type="radio"/> None	Historical Statement: See Continuation Sheet					
<b>5</b> Sources of Information (Reference to Above) <b>A</b> Date Stone <b>B</b> Waukesha Plaindealer, July 30, 1872 <b>C</b> Waukesha Freeman, November 11, 1926 <b>D</b> <b>E</b> <b>F</b>	<b>6</b> Representation in Previous Surveys <input type="radio"/> HABS <input type="radio"/> NAER <input checked="" type="radio"/> WIHP <input type="radio"/> NRHP <input type="radio"/> landmark <input type="radio"/> other: _____					Waukesha City Map Map Code
<b>7</b> Condition <input checked="" type="radio"/> excellent <input type="radio"/> good <input type="radio"/> fair <input type="radio"/> poor <input type="radio"/> ruins						
<b>8</b> District: _____ <input type="radio"/> pivotal <input type="radio"/> contributing <input type="radio"/> non-contributing initials: _____ date: _____						
<b>9</b> Opinion of National Register Eligibility <input checked="" type="radio"/> eligible <input type="radio"/> not eligible <input type="radio"/> unknown <input type="radio"/> national <input type="radio"/> state <input checked="" type="radio"/> local initials: DS/CC						
4/29						

FIRST BAPTIST CHURCH (247 Wisconsin Avenue)  
Intensive Survey Form - Continuation Sheet (1)

ARCHITECTURAL STATEMENT:

Description: Designed by Milwaukee architect, Edward Townsend Mix, the First Baptist Church is a fine example of Victorian Gothic ecclesiastical architecture. The form employed for the church appears in a number of designs executed by Mix in the 1870's and is dominated by a steeple set diagonally to the body of the church. The entrance is located in the base of the tower, a position which exploits the corner site of the church. The sanctuary is located on the second story and lit by four pointed arch stained glass windows on either side, and a rose window on the north facade. Buttresses articulate the side elevations and the steeple tower. A portico is located on the center front (north face) of the church and flanked by a smaller tower capped by a fleur de lys finial. Fleur de lys and quatrefoil patterns are repeated throughout the design. The church is constructed of rock faced stone, with smooth stone forming window surrounds. An educational wing, added in 1922 on the east, repeats the Gothic theme and construction materials. Another educational wing, added in 1959 is of modern design and concrete/limestone/brick construction. Neither this later addition or the 2-story brick, 1922 parsonage contribute to the significance of the property.

Significance: First Baptist Church is significant as an example of a period of construction and is a major visual landmark in the area. The excellent quality of the stone work and the fine ornament contributes to the success of this Victorian Gothic design. The First Baptist Church is one of four churches in Waukesha eligible for the National Register. These churches are all constructed of the local limestone but vary stylistically. St. Matthias Episcopal Church (111 E. Main Street WK 5/19), is a Gothic Revival building dating from the 1850's. First Methodist Church (121 Wisconsin Avenue WK 4/35), constructed in the 1890's was greatly influenced by Richardsonian Romanesque design. St. Joseph's Catholic Church (818 N. East Avenue WK 2/21) is like First Baptist, a fine example of High Victorian Gothic design. The First Baptist Church, which predates St. Joseph's and First Methodist, was designed by the Milwaukee architect, Edward Townsend Mix. Mix was responsible for the design of many of the important commercial, public and residential buildings erected in Milwaukee from the 1850's to 1880's. In addition, he served a term as state architect (1864-1867) and designed buildings for communities throughout Wisconsin. Three buildings in Waukesha are attributed to Mix; the Chandler House (151 W. College Avenue NRHP 1974), the Frame House (507 N. Grand Avenue WK 1/15) and First Baptist Church.

HISTORICAL STATEMENT:

The first Baptist meeting in the community took place on January 11, 1836 in the Nathaniel Walton cabin. The first church was built on this site in 1844. It was moved east to the intersection of Wisconsin and Broadway in 1871 to make way for the present building. The 1844 church was used as the Town Hall in 1957. In 1959, it was moved to the present County Courthouse grounds for restoration. The old Town Hall was demolished in 1970.

ADDENDUM

Legal Descrip.: N105' Lot 8, W 37' of Lot 7, N 40' of E 20'  
& N 40' of Lot 10 Blk C Cutler & Dakin's Add.  
Pt SE $\frac{1}{4}$  Sec 3 T6N R19E

# FIRST BAPTIST CHURCH

..... Nominated Property

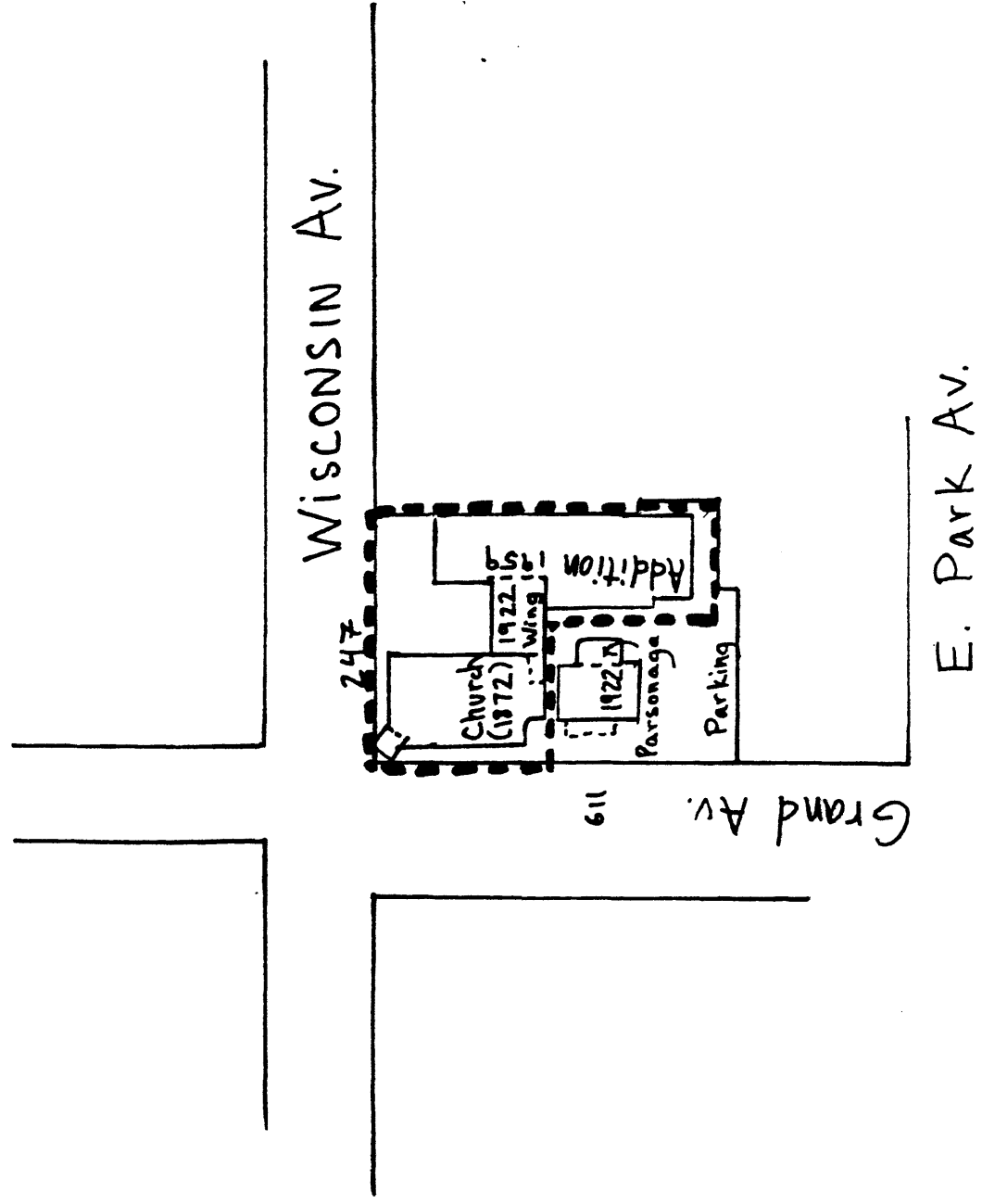

↑ N  
Scale  
1" = 100'