



United States Department of the Interior
National Park Service

National Register of Historic Places Registration Form

This form is for use in nominating or requesting determinations for individual properties and districts. See instructions in National Register Bulletin, *How to Complete the National Register of Historic Places Registration Form*. If any item does not apply to the property being documented, enter "N/A" for "not applicable." For functions, architectural classification, materials, and areas of significance, enter only categories and subcategories from the instructions. Place additional certification comments, entries, and narrative items on continuation sheets if needed (NPS Form 10-900a).

1. Name of Property

historic name Proctor, William House

other names/site number N/A

2. Location

street & number 7037 SR 64

N/A

not for publication

city or town Marengo

N/A

vicinity

state Indiana

code IN

county Crawford

code 025

zip code 47140

3. State/Federal Agency Certification

As the designated authority under the National Historic Preservation Act, as amended,

I hereby certify that this nomination request for determination of eligibility meets the documentation standards for registering properties in the National Register of Historic Places and meets the procedural and professional requirements set forth in 36 CFR Part 60.

In my opinion, the property meets does not meet the National Register Criteria. I recommend that this property be considered significant at the following level(s) of significance:

national statewide local

Signature of certifying official/Title

4/26/2013

Date

Indiana DNR-Division of Historic Preservation and Archaeology

State or Federal agency/bureau or Tribal Government

In my opinion, the property meets does not meet the National Register criteria.

Signature of commenting official

Date

Title

State or Federal agency/bureau or Tribal Government

Proctor, William House
 Name of Property

Crawford County, Indiana
 County and State

4. National Park Service Certification

I hereby certify that this property is:

- entered in the National Register determined eligible for the National Register
 determined not eligible for the National Register removed from the National Register
 other (explain): _____

Love Edson H. Beall
 Signature of the Keeper

6-25-13
 Date of Action

5. Classification

Ownership of Property
 (Check as many boxes as apply.)

Category of Property
 (Check only one box.)

Number of Resources within Property
 (Do not include previously listed resources in the count.)

- private
 public - Local
 public - State
 public - Federal

- building(s)
 district
 site
 structure
 object

Contributing	Noncontributing	
1	1	buildings
1		sites
		structures
		objects
2	1	Total

Name of related multiple property listing
 (Enter "N/A" if property is not part of a multiple property listing)

Number of contributing resources previously listed in the National Register

N/A

N/A

6. Function or Use

Historic Functions
 (Enter categories from instructions.)

DOMESTIC: single dwelling

FUNERARY: cemetery

Current Functions
 (Enter categories from instructions.)

WORK IN PROGRESS

Proctor, William House
Name of Property

Crawford County, Indiana
County and State

7. Description

Architectural Classification

(Enter categories from instructions.)

EARLY REPUBLIC:Federal

OTHER/I-house

Materials

(Enter categories from instructions.)

foundation: Stone:limestone

walls: Brick

roof: Asphalt

other:

Narrative Description

(Describe the historic and current physical appearance of the property. Explain contributing and noncontributing resources if necessary. Begin with a **summary paragraph** that briefly describes the general characteristics of the property, such as its location, setting, size, and significant features.)

Summary Paragraph

The William Proctor House is a two-story, brick I-house with both Federal-style and Italianate-style details. The house was constructed in 1832, just a few months after Proctor bought the property. The simple house was probably constructed of bricks made on site and limestone harvested on the property. The house has an unusual coved-brick cornice line and nice Federal details in the western room, including a fine Federal-style fireplace. The site on which the house stands also includes a non-contributing wooden shed, constructed outside the period of significance. There is also a contributing cemetery within the boundaries of the historic property. The pioneer cemetery includes the grave of William, his wife, Mary and all their children. The earliest marker is from 1835 for their daughter, Elizabeth Proctor. It also includes grave markers for Proctor's extended-family neighbors and fellow Crawford County homesteaders, the Woods and the Stewarts. Outside the boundary of the historic site, but on the property, are two additional non-contributing resources: an old railroad depot building moved here from its original location and a newly constructed service building containing storage, restrooms and a covered picnic area.

Narrative Description

The William Proctor house once stood on a 105-acre farm. The house is sited at an angle facing north-northwest. It is set back relatively far from the road on the south side of busy SR 64, which was once a stagecoach highway. A railroad track constructed in 1882 (outside the historic period of the house) traverses what was once the Proctor family's property a few

Proctor, William House
Name of Property

Crawford County, Indiana
County and State

yards north of the house. The boundary of the historic property includes land south of the house extending across Whiskey Run Creek to encompass the family cemetery.

The William Proctor house is a two-story I-house constructed in 1832 (Photograph 0001) The three-bay dwelling rises from an ashlar limestone foundation to brick walls. Now painted a light grey, the façade walls are laid in Flemish bond. The center bay holds the entry door. Two dry-laid stacked limestone steps reach the door. The simple door opening has limestone sill and a brick soldier-course flat-arch lintel. The original wooden door has two square recessed panels beneath a single light. A transom with a single light is above the door within the frame. Flanking the door on the first story are identical two-over-two light, double-hung windows. These windows are simply framed within the wall with wooden sills that protrude slightly and with brick soldier-course flat-arch lintels. Although the house may originally have had six-over-six light, double-hung windows, the current Italianate-style windows were replacements made within the historic period.

The second-story bays all hold identical two-over-two, double-hung windows (Photograph 0002). Just west of the second-story center window the small diamond-shaped washer, which is attached to a tie bar running through the building, is visible on the outside of the brick wall. The wooden window sills do not protrude quite as much on the second-story windows as they do on those on the first story. There are hooded moldings over the second-story windows with Italianate-style brackets supporting each molding (also probably added during the period of significance). The molding hoods are placed directly below the first row of corbelled bricks that form the cornice on the dwelling. The second row of corbelled bricks in the cornice is formed of coved bricks, creating a concave horizontal line above the first row of bricks and below the top row of standard bricks. The low-pitched gable-end roof is clad in composite shingles. Chimneys pierce the roof near the edges on the eastern and western sides of the house. Although the roof now extends past the chimneys a few inches on both sides, this roof extension may be part of the Italianate-style "makeover" that the house received in the historic period. Based on historic photos of a nearby house constructed by Proctor's brother and sister-in-law in nearly identical style and at the same time as the Proctor House, the roof may have originally cropped off at the edge of the brick wall revealing side chimneys rising from and above the side walls of the house. Both brick chimneys rise several courses high to two corbelled courses and then two additional courses above the second corbelled row.

The western side of the house has two bays (Photograph 0003). A car port addition, which had replaced a late 19th Century porch (added after the historic period), was recently removed from this side. The brick on this side is laid in a running bond pattern. An entry is in the northernmost bay. The opening is simply framed in wood with a transom with two lights above the door (Photograph 0004). The door has a recessed horizontal panel beneath a single light. The sill is wood flooring, the stoop is concrete and the lintel is formed of a header course of bricks. South of the door is a double-hung sash window with two lights over two lights in a simple wooden frame with a slightly protruding wooden sill and a lintel formed by a header course of bricks. The second story holds only one window. It is a double-hung sash with two-over-two lights. Above the second-story window the brick wall rises to a wide wooden fascia board beneath the shallow eave. Above the fascia board is a wooden boxed cornice. The fascia board and boxed cornice are probably additions made during the historic period when the house received its Italianate details. There is a decorative iron vent grille in the fascia board beneath the eave just south of where the roof peaks.

The south side of the house is currently undergoing a renovation, which will restore it to its original Federal-style appearance. The owners of the property recently removed a two-story addition that had been constructed of standard lumber and added in the first quarter of the 20th Century. The brick on this façade is laid in common bond pattern; the original unpainted brick is visible in the area where the addition was removed (Photograph 0005). The rest of this façade is painted grey to match the rest of the house. This façade has three bays. The restoration is replacing two windows in the first (westernmost bay). The center bay holds an entry. The entry is simply framed in wood that has been cut off near the bottom of the door (Photograph 0006). The current door is wooden with four vertical panels and no lights. The sill is covered in wooden flooring and the lintel is composed of a soldier course of bricks. East of the door is a double-hung sash, two-over-two light window within a wooden frame. The frame forms the sill. A soldier course of bricks forms the lintel. The second story of this façade has a frame for the window that will be replaced in the westernmost bay and identical double-hung sash, two-over-two light windows in the center and easternmost bays. The window openings are framed in wood. Above the second-story windows the walls rise one brick course to four courses of corbelled bricks and then to the roof.

The eastern façade has one bay (Photograph 0007). The brick wall of this façade is laid in a common bond and rises unbroken to the wide fascia board beneath the eave. There is an iron grate in the fascia board just south of where the gable roof peaks. The entry to the cellar is near the southern corner of the façade. It passes through the stone foundation. There is no door on the opening, which has a cast iron lintel.

Proctor, William House

Name of Property

Crawford County, Indiana

County and State

Also within the boundary of the historic property, is a board-and-batten, shed-roof outbuilding (Photograph 0008 – see building to right of house). This building, which covers the cistern, was probably added at the end of the 19th Century and is considered non-contributing. There is a pioneer cemetery included within the historic boundary of the property, as well (Photograph 0009). The cemetery has 19 graves ranging in date from 1835, marking the grave of Elizabeth Proctor, William and Mary Proctor's daughter, to 1907. There are several markers for Proctor children, illustrating the tragic losses that pioneer families experienced. All of the burials here are nuclear or extended family members of the Proctors, including William Proctor's friend and brother-in-law Absalom Wood and Wood's wife, Anna Watson Wood, who was Mary Watson Proctor's sister. The Wood children and their descendents are buried here, also. The cemetery also shows the intertwining of the Proctor's family with their neighbors, the Woods and the Stewarts. Mary Proctor, William's daughter, married David Stewart, the son of their neighbor, David Stewart. Stewart children and grandchildren are buried here along with Proctors and Woods. The largest and most elaborate marker is the one for Mary Watson Proctor and William Proctor (Photograph 0010).

Interior

The interior of the cellar reveals that the house floor joists are undressed logs (Photograph 0011). A dendrochronologist dated these logs to the spring of 1832, just a few months after William Proctor purchased the land in 1831.¹ The cellar also reveals that there is one supporting brick wall that extends through the house to the ground beneath it. West of this wall there is crawl space; east of this brick wall is the cellar (Photograph 0011 – Note: because this photograph is in the cellar, its location is not shown on the site plan or floor plans).

The interior of the first floor is laid out with a central hall with the brick masonry wall to the right (west) as one enters (Photograph 0012). A stair is within the central hall and a plaster and lath wall abuts the stair and creates the first floor room on the left (east). The western room has the finer details and was probably the public room of the house (Photograph 0013). There is a six-panel door in the opening between the hall and this room. The walls and ceiling are plaster. The floor is the original four-inch wide wood, probably poplar, laid parallel to the front of the house. The woodwork is simple and painted. There is an original fireplace surround and mantle, a nice and somewhat elaborate (for 1830s Indiana) example of Federal design with recessed panels in the surround (Photograph 0014). The rear (southern) wall of this room has new framing for a window that will be replaced into its original location. The window was removed and a door was placed in this wall when the non-historic addition was added. The eastern room has a wider plank floor, plaster walls and a wide bead board ceiling. The simple woodwork is painted. The original fireplace in this room has been enclosed behind a sheetrock wall. A flue cover is visible on the wall above the location of the fireplace. A closet created by the sheetrock addition is to the south of the location of the fireplace (Photograph 0015).

The staircase, with its applied wooden cutouts on the stringer and slender turned balusters, appears to have been remodeled or added when the house was altered with Italianate details in the historic period (Photograph 0016). The owners of the building, the Crawford County Historical and Genealogical Society, believe the original staircase was a ladder type. They believe the patched areas once cut out of the floors on the first and second story eastern rooms may indicate where an original stairway was located (Photograph 0017, second story). However, the patched square cutout area on the first floor opened into the cellar. It is cut through the floor joist and the joist is supported at that spot with a very small undressed log, much newer in appearance than the large undressed log joists. This makeshift construction is likely not original to the house, suggesting instead a different reason for the cutouts patched with wood flooring. The patched floor cutouts remain a mystery. The current staircase balustrade has been replaced on the first floor after it was stolen. The original balustrade remains on the second floor and it was used as a pattern for the first floor replacement railing. Whether the extant staircase was added in the historic period or simply refurbished when the house had its historic remodel, it was part of the historic fabric of the house.

At the top of the stairs, the landing opens into rooms on both sides and a hall extends to the south opening into secondary doors to both side rooms. The western room has its original wide wooden floor, bead board ceiling, original simple wood work, and original fireplace with surround and mantel that matches those in the eastern room (Photograph 0018). The eastern room retains its wide wooden floor, bead board ceiling, original fireplace with simple mantel and surround, original

¹ "Darrin L. Rubino Speaks at August Meeting," *The Crawford Countian*, October 2007, 5; Original deed in possession of Evelyn and Hugh Jackson.

Proctor, William House
Name of Property

Crawford County, Indiana
County and State

hall doors and has a built in pantry with four doors just north of the fireplace (Photograph 0019). There is a narrow closet just south of the fireplace. The doors to this room and on the closet are six-paneled.

The William Proctor House retains a high degree of integrity from the historic period, with both Federal and the later Italianate remodeling details remaining. Although the rear of the house was altered outside of the historic period it is a work in progress and will be restored to the look of the Federal era when the house was built.

On the property, *but outside the boundary of the historic property* are a newly constructed restroom and covered picnic area building set off from the house and a former train depot building that was moved to the property recently and placed directly east of the house.

Proctor, William House
Name of Property

Crawford County, Indiana
County and State

8. Statement of Significance

Applicable National Register Criteria

(Mark "x" in one or more boxes for the criteria qualifying the property for National Register listing.)

- A Property is associated with events that have made a significant contribution to the broad patterns of our history.
- B Property is associated with the lives of persons significant in our past.
- C Property embodies the distinctive characteristics of a type, period, or method of construction or represents the work of a master, or possesses high artistic values, or represents a significant and distinguishable entity whose components lack individual distinction.
- D Property has yielded, or is likely to yield, information important in prehistory or history.

Areas of Significance

(Enter categories from instructions.)

Exploration/Settlement

Architecture

Period of Significance

1832-1874

Significant Dates

1832 - Construction

Criteria Considerations

(Mark "x" in all the boxes that apply.)

Property is:

- A Owned by a religious institution or used for religious purposes.
- B removed from its original location.
- C a birthplace or grave.
- D a cemetery.
- E a reconstructed building, object, or structure.
- F a commemorative property.
- G less than 50 years old or achieving significance within the past 50 years.

Significant Person

(Complete only if Criterion B is marked above.)

Cultural Affiliation

Architect/Builder

Unknown

Period of Significance (justification) The Period of Significance begins in 1832, the year the house was built and just a few months after William Proctor purchased this land. A dendrochronologist has dated the undressed log floor joists to the spring of 1832. The Period of Significance ends in 1874, the year that William Proctor died. By this time it is likely that the then-modern Italianate details had been added to the house, making it a hybrid of Federal and Italianate design, which it remains today.

Proctor, William House
Name of Property

Crawford County, Indiana
County and State

Criteria Considerations (explanation, if necessary)

Statement of Significance Summary Paragraph (Provide a summary paragraph that includes level of significance and applicable criteria.)

The William Proctor House is eligible for the National Register under Criterion A for its association with the settlement of Crawford County. William Proctor began purchasing land in Crawford County in 1825, just seven years after the Indiana General Assembly established the county. By 1835 he was a postmaster for the county and the settlement around his house was known as Proctorville until the post office moved to nearby Marengo in 1852. The house is also eligible under Criterion C for its intact settlement-era architecture. An I-house originally constructed with Federal details, the dwelling was updated in the historic period when Italianate architecture became popular. Today both Federal and Italianate details remain on the house. Although a later-period addition was appended to the rear of the dwelling and a carport replaced a late 19th Century porch (both porch and carport were added after the historic period) on the western side, these additions have been removed. These alterations are not visible from the façade and the rear of the house is being restored to its original look.

Narrative Statement of Significance (Provide at least one paragraph for each area of significance.)

Settlement History

William Proctor was born in Pennsylvania in 1793. His future wife, Mary Watson, was born in 1803 and also hailed from the Keystone state.² It is not known if the two families were connected in their home state, but both William and Mary would eventually make their way to Crawford County, marry and build a home in the wilderness.

² 1850 Census.

Proctor, William House
Name of Property

Crawford County, Indiana
County and State

In 1805, about the time that Mary Watson was learning to walk and talk, William Rector was surveying the Buffalo Trace, a trail cut by migrating buffaloes through the Indiana territory, including the northern corner of what would become Crawford County.³ This land of southern Indiana had been ceded to the United States government by the Wyandot, Delaware, Shawnee, Ottawa, Chippewa, Potawatomi, Miami, Eel River, Wea, Kickapoo, Piankishaw, and Kaskaskia in 1795 at the Treaty of Greenville, Ohio.⁴ The Buffalo Trace, as much as 20-feet wide in some areas, was an important trail into the state used by travelers and the foot-soldier rangers who patrolled southern Indiana to protect settlers. Today, Highway 150 runs roughly along the former trace.⁵ Within a few years the Governor's Trace, used by Territorial Governor William Henry Harrison when traveling between Vincennes and Corydon, was cut through the county. It connected Corydon on the south to the Buffalo Trace on the north, crossing the Blue River below Milltown a few miles from the location of the Proctor House.⁶

With an east/west and a north/south road opened through the region, the area that would become Crawford County was now accessible to Euro-American settlers. The first of these to make permanent settlement in the area that would become Liberty Township was the Rice family, who arrived in 1808.⁷ The Rices and those who came after them found plentiful materials for house building in the dense forests and easily harvested limestone along the banks of the county's many rivers and creeks.⁸ In 1811 Henry Hallowell was the first settler in the area of present-day Marengo.⁹ That year Hallowell, Malachi Monk and others built a blockhouse for protection against the native peoples in the area. The block house was a two-story structure of round logs, erected about one mile east of present-day Marengo, this must have placed the block house very near or perhaps on the land that Malachi Monk would later sell to William Proctor.¹⁰

By 1818, the Indiana Legislature formed Crawford County out of portions of Harrison, Perry and Orange counties.¹¹ They designated Mount Sterling as the county seat (however, the seat of county government would move several times before finally settling in at English, its present location).¹² Also in 1818 Malachi Monk entered a land purchase through the federal government of the property that included the land on which the Proctor house would be built.¹³

³ George Wilson, "The First Public Land Surveys in Indiana," *Indiana Magazine of History*, March 1916, Vol. XII, 13. Available at http://books.google.com/books?id=YHUFaQAAMAAJ&pg=RA1-PA13&dq=buffalo+trace+indiana&hl=en&ei=1y-nTo2sJ8XegQfxzvQo&sa=X&oi=book_result&ct=result&resnum=4&ved=0CD0Q6AEwAw#v=onepage&q=buffalo%20trace%20indiana&f=false (accessed October 20, 2011); George R. Wilson, *Indiana Historical Society Publications Early Indiana Trails and Surveys*, (Indianapolis: C. E. Pauley & Co.), Vol. 6, No. 3, 1919), 375.

⁴ "Indian Land Cessions in the United States," http://memory.loc.gov/cgi-bin/query/D?hlaw:1::/temp/~ammem_BQ7I:: (accessed October 21, 2011).

⁵ Wilson, "The First Public Land Surveys in Indiana," http://books.google.com/books?id=YHUFaQAAMAAJ&pg=RA1-PA13&dq=buffalo+trace+indiana&hl=en&ei=1y-nTo2sJ8XegQfxzvQo&sa=X&oi=book_result&ct=result&resnum=4&ved=0CD0Q6AEwAw#v=onepage&q=buffalo%20trace%20indiana&f=false (accessed October 20, 2011); Wilson, *Indiana Historical Society Publications Early Indiana Trails and Surveys*, 375.

⁶ Jeffrey L. Davis & Williams D. Brockman, *Milltown a Community History* (Crawford County Historical & Genealogical Society, 2004) 18.

⁷ Indiana Department of Natural Resources, *Crawford County Interim Report* (Indianapolis: Historic Landmarks Foundation of Indiana, 2008), 45.

⁸ John H. Weathers, *A History of Crawford County*, (n.p. {1889} reprinted 1936, 1970), 11.

⁹ Indiana Department of Natural Resources, *Crawford County Interim Report*, 49.

¹⁰ Hazen Hayes Pleasant, *A History of Crawford County, Indiana*, (Greenfield, Ind.: Wm. Mitchell Printing Company, 1926), 15; Weathers, *History of Crawford County*, 15.

¹¹ Hazen Hayes Pleasant, *History of Crawford County*, 1.

¹² Weathers, *History of Crawford County*, 21.

¹³ "William Proctor House," <http://www.cchgs.info/proctor.htm> (accessed September 13, 2011).

Proctor, William House
Name of Property

Crawford County, Indiana
County and State

Two-year-old Crawford County counted 2,583 souls in the 1820 census.¹⁴ Two years after that, in 1822, the county seat moved to Fredonia after that town's proprietor, General Thom, built a courthouse and donated it for use.¹⁵ New residents were entering the county, slowing increasing the population. In 1823 Absalom Wood married Anna Watson in Clark County, Indiana.¹⁶ Then, in May 1825, Anna's sister, Mary Watson, married William Proctor, just one month after William Proctor and Absalom Wood entered a cash purchase at the land office in Jeffersonville for 80 acres of lands in Section 5, Twp 2-S, Range 2-E, in Crawford County.¹⁷ Proctor and Wood were both business partners and brothers-in-law now. Both together and separately they began buying as much land as possible in Crawford County.

William Proctor & Absalom Wood purchased 30 acres on March 21, 1826, in the northeast of Section 6 from Malachi Monk.¹⁸ The 1830 census showed William and Mary Proctor living in Milltown, Crawford County, Indiana. In their household was one man, age 30-40 (William); one woman, age 20 - 30 (Mary); and one girl, age under 5 (daughter Elizabeth). The Proctors must have been neighbors with Absalom Wood and his wife, Anna at this time because they were recorded one above the other on page 488 of the censustaker's list.¹⁹ In May 1830, William Proctor purchased a bond from Elisha Tadlock for the title to 100 acres in part of southwest and northwest quarters of Section 4 in Crawford County, adding to his county holdings.²⁰

Mary Proctor gave birth to the couple's second daughter, Isabel, in May 1831.²¹ Then in September 1831, William Proctor bought "a part of the SE ¼ of Section 6; Range 2 East; Township 2 South, beginning at the southeast corner, and running north to Whiskey Run Creek, thence up the creek to where Absalom Wood line intersects the creek, and running with the same to Monks [sic] Northeast and west line, to two white oaks, thence west with Monk's line to the Northwest corner, thence continuing west with David Stewart, east and west line, to Whiskey Run Creek, thence following down the creek, to where Monk's north and south line crosses the creek, then with same to Monk's southwest corner, thence east with Monk's line to the southeast corner, the place of beginning." On this land, Proctor would build his family's home.²²

Construction on the Proctor home began in the spring of 1832, according to a dendrochronology study of the logs used for floor joists.²³ The Proctors sited the house in line with the Leavenworth-Indianapolis Stage Coach Road which angled to

¹⁴ *Population Schedule of the Fourth Census*,

<http://www.archive.org/stream/populationsc18200014unit#page/n14/mode/1up> (accessed October 23, 2011).

¹⁵ Weathers, *History of Crawford County*, 22.

¹⁶ "Indiana Marriage Collection, 1800-1941," *Ancestry.com* http://search.ancestry.com/cgi-bin/sse.dll?rank=1&new=1&MSAV=0&msT=1&gss=angs-g&gsfn=Absalom&gsln=Wood&msypn__ftp=Crawford+County%2c+Indiana%2c+USA&msypn=760&msypn_PInfo=7-

[%7c0%7c1652393%7c0%7c2%7c3247%7c17%7c0%7c760%7c0%7c0%7c&uidh=yeo&pcat=ROOT_CATEGORY&h=3188095&recoff=6+7&db=inmarr1880&indiv=1](http://search.ancestry.com/cgi-bin/sse.dll?rank=1&new=1&MSAV=0&msT=1&gss=angs-g&gsfn=Absalom&gsln=Wood&msypn__ftp=Crawford+County%2c+Indiana%2c+USA&msypn=760&msypn_PInfo=7-%7c0%7c1652393%7c0%7c2%7c3247%7c17%7c0%7c760%7c0%7c0%7c&uidh=yeo&pcat=ROOT_CATEGORY&h=3188095&recoff=6+7&db=inmarr1880&indiv=1) (accessed October 13, 2011).

¹⁷ "Indiana Marriage Collection," *Ancestry.com* http://search.ancestry.com/cgi-bin/sse.dll?rank=1&new=1&MSAV=0&msT=1&gss=angs-c&gsfn=William&gsln=Proctor&mswpn__ftp=Crawford+County%2c+Indiana%2c+USA&mswpn=760&mswpn_PInfo=7-

[%7c0%7c1652393%7c0%7c2%7c3247%7c17%7c0%7c760%7c0%7c0%7c&msbdy=1793&uidh=yeo&pcat=34&h=2317695&recoff=6+7&db=inmarr1880&indiv=1](http://search.ancestry.com/cgi-bin/sse.dll?rank=1&new=1&MSAV=0&msT=1&gss=angs-c&gsfn=William&gsln=Proctor&mswpn__ftp=Crawford+County%2c+Indiana%2c+USA&mswpn=760&mswpn_PInfo=7-%7c0%7c1652393%7c0%7c2%7c3247%7c17%7c0%7c760%7c0%7c0%7c&msbdy=1793&uidh=yeo&pcat=34&h=2317695&recoff=6+7&db=inmarr1880&indiv=1) (accessed October 11, 2011); "U.S. General Land

Office Records," *Ancestry.com*

http://search.ancestry.com/iexec?htx=View&r=an&dbid=1246&iid=RHUSA2007B_IN0220-00072&fn=William&ln=Proctor&st=r&ssrc=&pid=658737 (accessed October 13, 2011).

¹⁸ "Book A," 217, Crawford County Archives, English, Indiana.

¹⁹ 1830 Census.

²⁰ "Crawford County Probate Book, 1830," 104 and 108.

²¹ Isabel Proctor Schoonover's cemetery marker, Proctor family cemetery, Crawford County, Indiana.

²² Original deed.

²³ "Darrin L. Rubino Speaks at August Meeting," *Crawford Countian*, 5.

²³ "Darrin L. Rubino Speaks at August Meeting," *Crawford Countian*, 5.

Proctor, William House
Name of Property

Crawford County, Indiana
County and State

the southwest in front of the property.²⁴ They chose to build or have their house built in a style almost identical to their neighbors and extended family, the Wood's home. Although no records exist to show which house was built first, the mention of Absalom Wood's name in the boundary of Proctor's deed indicates that Wood had already purchased his land when the Proctors bought the adjoining land, so it is reasonable to assume that the Wood house was the first built. Whichever family was first, the two houses were more than accidentally similar, including unusual corbelled brick courses at the eaves found at the rear on both houses [see discussion below of the house's architecture].²⁵

William Proctor became the postmaster for the area in 1835. He named the post office "Proctorville."²⁶ William Proctor was rising in prominence and in land ownership, but that year a tragedy struck his family. His and Mary's oldest daughter, Elizabeth, died on September 14. Her cemetery marker, located in the family cemetery on the Proctor property, shows that she was six years, five months and four days old. Although the family must have suffered from this loss, the birth of their son, John, the following year, may have eased their grief somewhat.²⁷

In May 1838, William Proctor received a license to keep a store, probably located at his home.²⁸ And always with an eye toward increasing his land wealth, that year he also made a land entry of 40 acres in Section 4, Crawford County.²⁹ Proctor's neighbor and eventually his daughter's father-in-law, David Stewart, platted the settlement of Marengo in 1839.³⁰

Both William Proctor's holdings and Crawford County continued to grow in the middle years of the 19th Century. Proctor purchased more land in Section 6, Range 4 South, Township 2 East from his neighbor and brother-in-law, Absalom Wood in 1841. The following year, Liberty Township was formed.³¹ This development must have pleased William Proctor, signaling an increase in the value of his land as more people moved into the county looking to buy their own farmsteads. But the Proctor family suffered tragedy again a year later in 1842. William, a son named after his father, was born and died that year. Another child's tombstone was added to the family cemetery a short walk through the woods and across Whiskey Creek from their house. Two years later Absalom Wood, Proctor's long-time partner and the husband of his wife's sister died. His marker was added near little William's in the cemetery.³²

Changes came to the Proctor family in the decade between 1850 and 1860. The census of 1850 shows William Proctor, age 57; Mary, 47; Isabelle, 18; John, 14; Mary, 12; and Jefferson Cooper, 52, living on the Proctor farm.³³ Cooper was likely a hired hand. Proctor was still both postmaster and storekeeper in 1850, but in 1852 the post office moved to the growing town of Marengo.³⁴ John Proctor, the family's only surviving son, died in 1855. Once again the family trekked across Whiskey Run to bury a child in the cemetery.³⁵ By 1860, the Proctor household had only three members: William, Mary and Isabel.³⁶ Despite their personal losses, the Proctors were becoming wealthier and may have decided around this time to update their home. Details were added to both the exterior and interior that made the house more closely resemble the modern Italianate style. The house, which had once conveyed the aspirations of a settler, now conveyed the

²⁴ Weathers, *A History of Crawford County*, 17.

²⁵ Original deed; Historic Photograph of Wood home in possession of Larry Burmeister, Crawford County, Indiana.

²⁶ "William Proctor House" <http://www.cchgs.info/proctor.htm> (accessed September 13, 2011)

²⁷ Cemetery marker, Proctor Family Cemetery, Crawford County, Indiana.

²⁸ Pleasant, *A History of Crawford County*, 154.

²⁹ "U.S. General Land Office Records," *Ancestry.com* http://search.ancestry.com/cgi-bin/sse.dll?rank=1&new=1&MSAV=0&msT=1&gss=angs-c&gsfn=William+&gsln=Proctor&mswpn__ftp=Milltown%2c+Indiana&msbdy=1793&msgpn__ftp=Clark+County%2c+Indiana%2c+USA&msgpn=624&msgpn_PInfo=7-%7c0%7c1652393%7c0%7c2%7c3247%7c17%7c0%7c624%7c0%7c0%7c&uidh=yeo&pcat=36&h=143680&recoff=6+7+8+9&db=BLMlandpatents&indiv=1 (accessed October 13, 2011).

³⁰ Indiana Department of Natural Resources, *Crawford County Interim Report*, 45.

³¹ Indiana Department of Natural Resources, *Crawford County Interim Report*, 45.

³² Cemetery markers; Land Record Books, Crawford County Archives, English, Indiana;

³³ 1850 Census.

³⁴ "William Proctor House" <http://www.cchgs.info/proctor.htm> (accessed September 13, 2011).

³⁵ Cemetery marker.

³⁶ 1860 Census.

Proctor, William House
Name of Property

Crawford County, Indiana
County and State

wealth of an established family with large landholdings and substantial importance within the community they had helped to found.

The rumbling of discontent and differences between the southern and northern states undoubtedly reached the Proctors in their brick house in Crawford County, as it did every corner of the United States in the years prior to the outbreak of the Civil War. After Abraham Lincoln's election, in 1861, the United States divided and the war began.

The town of Marengo had about 100 citizens in 1861.³⁷ Its residents and those throughout Crawford County prepared to send sons and fathers to war. Southern Indiana had been settled in large part by southerners and was notorious for Confederate sympathizers, the Knights of the Golden Circle. But Crawford County stood out in its staunch support of the northern cause. The county sent more soldiers, per capita, to fight for the Union than any other county in the North. Every family in the county was affected, according to one county history.³⁸ Although William's son-in-law, David Stewart, probably served in the northern army, all the Proctor sons had died in childhood and William was in his 60s and too old to serve. Still, they were not spared the grief experienced by their neighbors who lost family members. In 1862, Mary Watson Proctor's marker joined those of her children in the family cemetery. She had lived 59 years, 6 months, and 3 days.³⁹ William Proctor and his daughter, Isabel, were the only family members left to occupy their updated brick I-house.

Through the war years, William Proctor retained his "Retail Dealer" license. For it he paid an excise tax assessment of \$10 in 1864. The following year, his tax assessment rose to \$12.30; it included both his retail dealer assessment and tax on a carriage he now owned.⁴⁰ Proctor may have dropped his store by 1870. The census for that year shows "William, 77, farmer and Isabelle [sic], 36, housekeeper" as sole occupants of their home.⁴¹ William Proctor was now elderly, but he had not lost his desire to acquire more land. He bought an additional 200 acres in Crawford County for \$1,060.36 at a sheriff's sale in July 1871.⁴²

In 1874 William Proctor died. Like his immediate and extended family before him, he was laid to rest in the family cemetery on the land behind his home. A pioneer who had outlived his wife, his partner in landownership and three of his children, Proctor was 81 years, five months old when he died.⁴³ The estate was administered by Mary Proctor Stewart's husband, David Stewart. Isabel Proctor, who had faithfully tended to her parent's home for 45 years, inherited their brick house and the 105 acres on which it stood.⁴⁴ In 1882, just eight years after William Proctor's death, the Louisville, New Albany & St. Louis Railroad opened through Crawford County and cut its way across some of the Proctor estate with tracks only a few yards from the Proctor home.⁴⁵ Chances are good that Isabel made a pretty penny for the sale of right of way to the railroad, a move her father probably would have appreciated. Isabel Proctor married Henry Schoonover around this time. She died in 1885 and was buried in the family cemetery.⁴⁶

In 2012, the Proctor house is the oldest remaining residence in Liberty Township and dates to the settlement period. The Proctors built their home a decade before the township in which it stands was named. By the time Liberty Township was officially formed in 1842, Crawford County was emerging out of the pioneer period. In 1850, the post office moved from the Proctor residence to the nearby town of Marengo, signaling Crawford County's movement out of the pioneer years and into the town-building period. The William Proctor house is rated Outstanding in the 2008 *Crawford County Interim Report*. The Liberty Township town of Marengo has three Outstanding-rated houses (025-262-07006—c. 1915; 025-414-07020—c. 1900; and 025-414-07022—c. 1880). Only the Proctor House, constructed in 1832, and the Walker Farm (025-262-

³⁷ Department of Natural Resources, *Crawford County Interim Report*, 45.

³⁸ Weathers, *A History of Crawford County*, 29.

³⁹ Cemetery marker.

⁴⁰ "National Archives Records Administration, U.S. IRS Tax Assessment Lists, 1862-1918," (scan of original documents) *Ancestry.com*
http://search.ancestry.com/iexec?htx=View&r=an&dbid=1264&iid=RHUSA1862_101759-00468&fn=William&ln=Proctor&st=r&ssrc=&pid=5170606 (accessed October 12, 2011).

⁴¹ 1870 Census.

⁴² Land Record Books, Crawford County Archives, English, Indiana.

⁴³ Cemetery marker.

⁴⁴ Land Record Book 17; pg.489, Crawford County Courthouse, English, Indiana.

⁴⁵ Davis & Brockman, *Milltown a Community History*, 67.

⁴⁶ Cemetery marker.

Proctor, William House
Name of Property

Crawford County, Indiana
County and State

05004), constructed in 1882, are rated Outstanding among the township's scattered sites surveyed for the report. Aside from the Proctor house, the oldest Outstanding-rated dwelling was constructed circa 1880, well after the county had said goodbye to the hardships and opportunities that William Proctor and his family experienced as early Crawford County pioneers in their substantial brick home.

Architectural Significance

The William Proctor House is an interesting example of the lifespan of changes of a pioneer house. Originally a simple I-house, two rooms wide and one room deep, it was built in Federal style with little ornamentation. However from its beginnings the house displayed a certain wealth and style. Constructed in 1832, the house was probably one of few brick homes in Crawford County at this time. Many of the Proctor's neighbors were probably still living in log homes. The Proctor house also had a few elegant touches, such as the coved brick course in the façade cornice and the Federal fireplace surround in the western parlor. This was a house that conveyed its owners' standing and their aspirations. According to *Indiana Houses of the Nineteenth Century*, Federal style was popular in this state from about 1800 to about 1840, so it made sense that the Proctors would choose a style with which they were familiar and one that was popular at the time.⁴⁷

At some point in the historic period, the Proctors decided to update their home in the most modern and popular style of the day, the Italianate style. These changes included adding hooded moldings supported with small brackets to the façade windows, adding a wooden cornice board and iron grilles to the cornice on the eastern and western sides, and possibly extending the roof beyond the cornice on these sides. On the interior, the center hall staircase was either changed outright from a ladder type staircase (as speculated by the current owners) or at least altered with store-bought wooden trim applied to the stringer and new Italianate-style balusters.

Although the date of the alterations is not known, it seems reasonable to think that they happened within Mary Proctor's lifespan. Mary died in 1862. According to *A Field Guide to American Houses*, Italianate architecture became popular in the United States around 1840.⁴⁸ The style swept across the country and remained popular until the 1880s, however most Italianate buildings in Indiana seem to date to the 1860s and 1870s. It seems unlikely that William Proctor would make exterior renovations to the house after his wife's death, especially since he was almost 70 and did not remarry. It also seems unlikely that the Proctor's daughter, Isabel, a 43-year old spinster when she inherited the house at her father's death, who would not marry until she was in her 50s and at a time when Italianate style was becoming outdated, would have made these changes. Therefore the Italianate style alterations are attributed to the historic period of the house, which ends in 1874 when William Proctor died.

These are the sorts of changes that people made to their Federal-style buildings in the 1860s elsewhere in Indiana and probably across the nation. When new styles began to appear, owners then, as now, updated their homes. Madison, Indiana, has a great number of originally Federal-style buildings later updated with Italianate-style details. This renovation is a good example of how a pioneer family updated their homes as they lived in them. The stylish Italianate changes show that the Proctors continued to want their home to display their social standing and their knowledge of new national trends in architecture.

⁴⁷ Wilbur D. Peat, *Indiana Houses of the Nineteenth Century* (Indianapolis: Indiana Historical Society, 1962)
http://www.archive.org/stream/indianahousesofn00peat/indianahousesofn00peat_djvu.txt
(accessed October 11, 2011).

⁴⁸ Virginia and Lee McAlester, *A Field Guide to American Houses*, (New York: Alfred A. Knopf, 2006), 211.

Proctor, William House
Name of Property

Crawford County, Indiana
County and State

Developmental history/additional historic context information (if appropriate)

9. Major Bibliographical References

Bibliography (Cite the books, articles, and other sources used in preparing this form.)

"Book A." Crawford County Archives, English, Indiana.

Cemetery markers. Proctor Family Cemetery, Crawford County, Indiana.

Census of the United States (1830), (1850), (1860), (1870).

"Crawford County Probate Book, 1830." Crawford County Archives, English, Indiana.

"Darrin L. Rubino Speaks at August Meeting." *The Crawford Countian*. October 2007.

Davis, Jeffrey L. & Williams D. Brockman. *Milltown a Community History*. Crawford County Historical & Genealogical Society, 2004.

Historic Photograph of Wood home in possession of Larry Burmeister, Crawford County, Indiana.

"Indian Land Cessions in the United States." http://memory.loc.gov/cgi-bin/query/D?hlaw:1:./temp/~ammem_BQ7I:: (accessed October 21, 2011).

Indiana Department of Natural Resources. *Crawford County Interim Report*. Indianapolis: Historic Landmarks Foundation of Indiana, 2008.

"Indiana Marriage Collection, 1800-1941." *Ancestry.com* http://search.ancestry.com/cgi-bin/sse.dll?rank=1&new=1&MSAV=0&msT=1&gss=angs-g&gsfn=Absalom&gsln=Wood&msypn__ftp=Crawford+County%2c+Indiana%2c+USA&msypn=760&msypn_PInfo=7-%7c0%7c1652393%7c0%7c2%7c3247%7c17%7c0%7c760%7c0%7c0%7c&uidh=yeo&pcat=ROOT_CATEGORY&h

Proctor, William House
Name of Property

Crawford County, Indiana
County and State

=3188095&recoff=6+7&db=inmarr1880&indiv=1 (accessed October 13, 2011).

"Indiana Marriage Collection." *Ancestry.com* http://search.ancestry.com/cgi-bin/sse.dll?rank=1&new=1&MSAV=0&msT=1&gss=angs-c&gsfn=William&gsln=Proctor&mswpn__ftp=Crawford+County%2c+Indiana%2c+USA&mswpn=760&mswpn_PInfo=7-%7c0%7c1652393%7c0%7c2%7c3247%7c17%7c0%7c760%7c0%7c0%7c&msbdy=1793&uidh=yeo&pcat=34&h=2317695&recoff=6+7&db=inmarr1880&indiv=1 (accessed October 11, 2011).

Land Record Books. Crawford County Archives, English, Indiana.

Original deed in possession of Evelyn and Hugh Jackson, English, Indiana.

McAlester, Virginia and Lee. *A Field Guide to American Houses*. New York: Alfred A. Knopf, 2006.

National Archives Records Administration. "U.S. IRS Tax Assessment Lists, 1862-1918." (scan of original documents) *Ancestry.com* http://search.ancestry.com/iexec?htx=View&r=an&dbid=1264&iid=RHUSA1862_101759-00468&fn=William&ln=Proctor&st=r&ssrc=&pid=5170606 (accessed October 12, 2011).

Wilbur D. Peat, *Indiana Houses of the Nineteenth Century*. Indianapolis: Indiana Historical Society, 1962. http://www.archive.org/stream/indianahousesofn00peat/indianahousesofn00peat_djvu.txt (accessed October 11, 2011).

Pleasant, Hazen Hayes. *A History of Crawford County, Indiana*. Greenfield, Ind.: Wm. Mitchell Printing Company, 1926.

Population Schedule of the Fourth Census. <http://www.archive.org/stream/populationsc18200014unit#page/n14/mode/1up> (accessed October 23, 2011).

"U.S. General Land Office Records." *Ancestry.com* http://search.ancestry.com/iexec?htx=View&r=an&dbid=1246&iid=RHUSA2007B_IN0220-00072&fn=William&ln=Proctor&st=r&ssrc=&pid=658737 (accessed October 13, 2011).

Weathers, John H. *A History of Crawford County*. n.p. [1889], reprinted 1936, 1970.

"William Proctor House." <http://www.cchgs.info/proctor.htm>. (accessed September 13, 2011).

Wilson, George. "The First Public Land Surveys in Indiana." *Indiana Magazine of History*. March 1916, Vol. XII, 13. Available at http://books.google.com/books?id=YHUFQAAMAAJ&pg=RA1-PA13&dq=buffalo+trace+indiana&hl=en&ei=1y-nTo2sJ8XegQfxzvQo&sa=X&oi=book_result&ct=result&resnum=4&ved=0CD0Q6AEwAw#v=onepage&q=buffalo%20trace%20indiana&f=false (accessed October 20, 2011).

Wilson, George R. *Indiana Historical Society Publications Early Indiana Trails and Surveys*. Indianapolis: C. E. Pauley & Co., Vol. 6, No. 3, 1919.

Proctor, William House
Name of Property

Crawford County, Indiana
County and State

Previous documentation on file (NPS):

- preliminary determination of individual listing (36 CFR 67 has been requested)
- previously listed in the National Register
- previously determined eligible by the National Register
- designated a National Historic Landmark
- recorded by Historic American Buildings Survey # _____
- recorded by Historic American Engineering Record # _____
- recorded by Historic American Landscape Survey # _____

Primary location of additional data:

- State Historic Preservation Office
- Other State agency
- Federal agency
- Local government
- University
- Other
- Name of repository: _____

Historic Resources Survey Number (if assigned): 025-414-05012

10. Geographical Data

Acreage of Property Approximately 3 acres
(Do not include previously listed resource acreage.)

UTM References

(Place additional UTM references on a continuation sheet.)

1	<u>16</u>	<u>558721</u>	<u>4246712</u>	3	<u> </u>	<u> </u>	<u> </u>
	Zone	Easting	Northing		Zone	Easting	Northing
2	<u> </u>	<u> </u>	<u> </u>	4	<u> </u>	<u> </u>	<u> </u>
	Zone	Easting	Northing		Zone	Easting	Northing

Verbal Boundary Description (Describe the boundaries of the property.)

The boundary begins at the spot where the railroad track that travels in front of the house meets the right of way of Railroad View Road, the new road just west of the house. From this spot the boundary line travels in a southeasterly direction along the southern right of way of the railroad track, passing in front of the house and continuing for approximately ten feet east of the eastern edge of the house. At this point the line turns south and travels approximately 400 feet, past the eastern side of the house, past the shed behind the house, continues across the rolling land behind the house, crosses Whiskey Run Creek and continues south until it meets a wire fence at the rear of the property. Here the boundary line turns westward and continues along the fence, passing behind the grave markers in the Proctor Family Cemetery and continuing approximately 90 feet to the west. At this point the boundary turns north, continuing across the wooded area at the rear of the property, across Whiskey Run Creek, across the rolling land behind the house, past the shed and the house until it meets the right of way of Railroad View Road. Here the boundary turns to the northeast and travels along the right of way of the road until it once again meets the point of origin.

Boundary Justification (Explain why the boundaries were selected.)

Proctor, William House
Name of Property

Crawford County, Indiana
County and State

The boundary for the William Proctor House includes the house, a non-contributing outbuilding, the Proctor Family Cemetery and the land between the cemetery and the house. The boundary is drawn so that all contributing resources are included and non-contributing resources near the house, a train depot moved onto the property and a new restroom/shelter building, are excluded. The house currently sits on approximately seven acres of land. The total property within the historic boundary is approximately 3 acres.

11. Form Prepared By

name/title Connie Zeigler
organization C. Resources date 10/29/11
street & number 963 Hosbrook Street telephone 317.955.0377
city or town Indianapolis state IN zip code 46203
e-mail connie@cresourcesinc.com

Additional Documentation

Submit the following items with the completed form:

- **Maps:** A **USGS map** (7.5 or 15 minute series) indicating the property's location.
A **Sketch map** for historic districts and properties having large acreage or numerous resources. Key all photographs to this map.
- **Continuation Sheets**
- **Additional items:** (Check with the SHPO or FPO for any additional items.)

Photographs:

Submit clear and descriptive photographs. The size of each image must be 1600x1200 pixels at 300 ppi (pixels per inch) or larger. Key all photographs to the sketch map.

Name of Property: William Proctor House

City or Vicinity: Marengo

County: Crawford County State: Indiana

Photographer: Connie Zeigler

Date Photographed: September 14, 2011

Description of Photograph(s) and number: Photograph 0001. Façade, looking South-Southwest

1 of 19

Name of Property: William Proctor House

City or Vicinity: Marengo

County: Crawford County State: Indiana

Proctor, William House
Name of Property

Crawford County, Indiana
County and State

Photographer: Connie Zeigler

Date Photographed: September 14, 2011

Description of Photograph(s) and number: Photograph 0002. Window detail on façade, looking South-Southwest
2 of 19

Name of Property: William Proctor House

City or Vicinity: Marengo

County: Crawford County State: Indiana

Photographer: Connie Zeigler

Date Photographed: September 14, 2011

Description of Photograph(s) and number: Photograph 0003. West side of house, looking East
3 of 19

Name of Property: William Proctor House

City or Vicinity: Marengo

County: Crawford County State: Indiana

Photographer: Connie Zeigler

Date Photographed: September 14, 2011

Description of Photograph(s) and number: Photograph 0004. West side of house detail of door, looking East.
4 of 19

Name of Property: William Proctor House

City or Vicinity: Marengo

County: Crawford County State: Indiana

Photographer: Connie Zeigler

Date Photographed: September 14, 2011

Description of Photograph(s) and number: Photograph 0005. South side of house, looking Northeast
5 of 19

Name of Property: William Proctor House

City or Vicinity: Marengo

Proctor, William House
Name of Property

Crawford County, Indiana
County and State

County: Crawford County State: Indiana

Photographer: Connie Zeigler

Date Photographed: September 14, 2011

Description of Photograph(s) and number: Photograph 0006. South side of house door detail, looking North/Northeast
6 of 19

Name of Property: William Proctor House

City or Vicinity: Marengo

County: Crawford County State: Indiana

Photographer: Connie Zeigler

Date Photographed: September 14, 2011

Description of Photograph(s) and number: Photograph 0007. East side of house, looking West.
7 of 19

Name of Property: William Proctor House

City or Vicinity: Marengo

County: Crawford County State: Indiana

Photographer: Connie Zeigler

Date Photographed: September 14, 2011

Description of Photograph(s) and number: Photograph 0008. House from northwest corner of historic property, looking Southeast.

8 of 19

Name of Property: William Proctor House

City or Vicinity: Marengo

County: Crawford County State: Indiana

Photographer: Connie Zeigler

Date Photographed: September 14, 2011

Description of Photograph(s) and number: Photograph 0009. Cemetery looking East
9 of 19

Name of Property: William Proctor House

City or Vicinity: Marengo

Proctor, William House
Name of Property

Crawford County, Indiana
County and State

County: Crawford County State: Indiana

Photographer: Connie Zeigler

Date Photographed: September 14, 2011

Description of Photograph(s) and number: Photograph 0010. Cemetery, looking East.

10 of 19

Name of Property: William Proctor House

City or Vicinity: Marengo

County: Crawford County State: Indiana

Photographer: Connie Zeigler

Date Photographed: September 14, 2011

Description of Photograph(s) and number: Photograph 0011. In cellar, looking West from cellar into crawl space at undressed log floor joists.

11 of 19

Name of Property: William Proctor House

City or Vicinity: Marengo

County: Crawford County State: Indiana

Photographer: Connie Zeigler

Date Photographed: September 14, 2011

Description of Photograph(s) and number: Photograph 0012. Looking South in the central hall from the façade (North) door.

12 of 19

Name of Property: William Proctor House

City or Vicinity: Marengo

County: Crawford County State: Indiana

Photographer: Connie Zeigler

Date Photographed: September 14, 2011

Description of Photograph(s) and number: Photograph 0013. In western room, looking Southeast from western door.

13 of 19

Name of Property: William Proctor House

Proctor, William House
Name of Property

Crawford County, Indiana
County and State

City or Vicinity: Marengo

County: Crawford County State: Indiana

Photographer: Connie Zeigler

Date Photographed: September 14, 2011

Description of Photograph(s) and number: Photograph 0014. In western room, looking South at fireplace detail.
14 of 19

Name of Property: William Proctor House

City or Vicinity: Marengo

County: Crawford County State: Indiana

Photographer: Connie Zeigler

Date Photographed: September 14, 2011

Description of Photograph(s) and number: Photograph 0015. In east room, looking Southeast.
15 of 19

Name of Property: William Proctor House

City or Vicinity: Marengo

County: Crawford County State: Indiana

Photographer: Connie Zeigler

Date Photographed: September 14, 2011

Description of Photograph(s) and number: Photograph 0016. In central hall, looking Southeast at staircase.
16 of 19

Name of Property: William Proctor House

City or Vicinity: Marengo

County: Crawford County State: Indiana

Photographer: Connie Zeigler

Date Photographed: September 14, 2011

Description of Photograph(s) and number: Photograph 0017. Second story, central hall, looking East (and down) at the section where the floor is replaced (possibly the location of an original staircase).

17 of 19

Name of Property: William Proctor House

Proctor, William House
Name of Property

Crawford County, Indiana
County and State

City or Vicinity: Marengo

County: Crawford County State: Indiana

Photographer: Connie Zeigler

Date Photographed: September 14, 2011

Description of Photograph(s) and number: Photograph 0018. Second story, western room, looking Southeast at fireplace and cupboard.

18 of 19

Name of Property: William Proctor House

City or Vicinity: Marengo

County: Crawford County State: Indiana

Photographer: Connie Zeigler

Date Photographed: September 14, 2011

Description of Photograph(s) and number: Photograph 0019. Second story, eastern room, looking South-Southwest at fireplace and closet.

19 of 19

Proctor, William House
Name of Property

Crawford County, Indiana
County and State

Property Owner:

(Complete this item at the request of the SHPO or FPO.)

name Crawford County Historical and Genealogical Society – contact Larry Burmeister
street & number 411 South Redbud Court telephone 812-338-2725
city or town English state IN zip code 47118





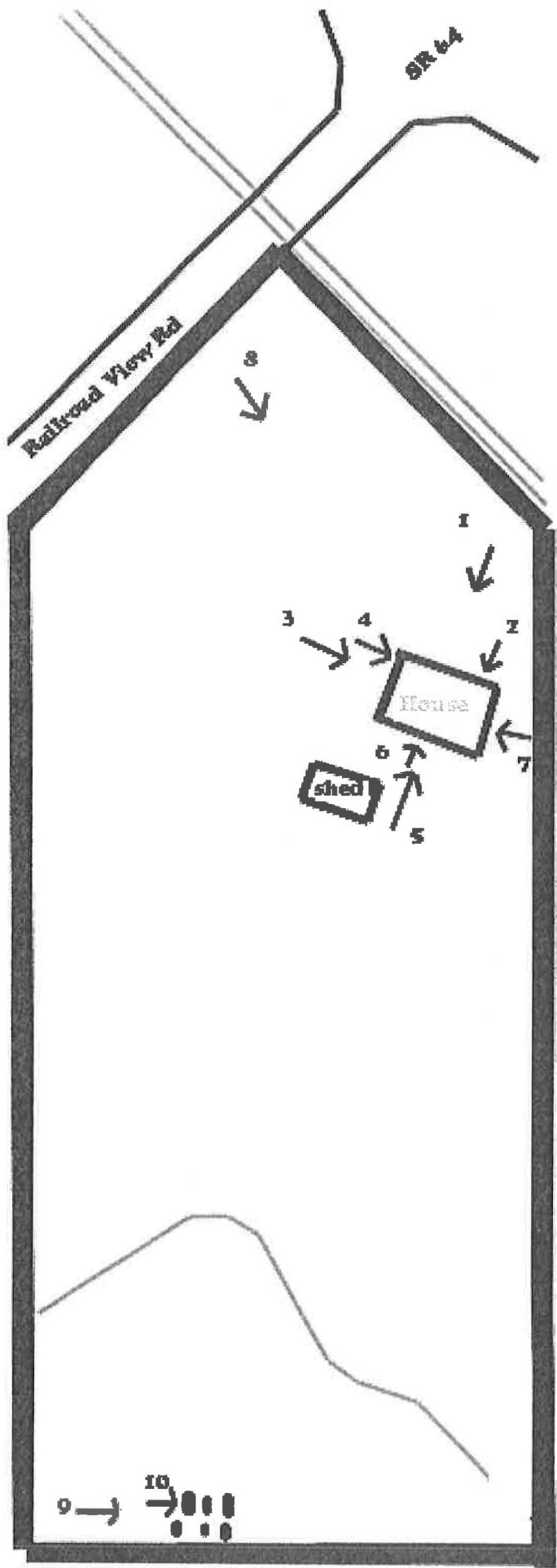

Paperwork Reduction Act Statement: This information is being collected for applications to the National Register of Historic Places to nominate properties for listing or determine eligibility for listing, to list properties, and to amend existing listings. Response to this request is required to obtain a benefit in accordance with the National Historic Preservation Act, as amended (16 U.S.C.460 et seq.).
Estimated Burden Statement: Public reporting burden for this form is estimated to average 18 hours per response including time for reviewing instructions, gathering and maintaining data, and completing and reviewing the form. Direct comments regarding this burden estimate or any aspect of this form to the Office of Planning and Performance Management, U.S. Dept. of the Interior, 1849 C. Street, NW, Washington, DC.

William Proctor House Crawford County, IN



Not to scale



-  Photograph
-  Railroad
-  Whiskey Run Creek
-  Buildings
-  Cemetery
-  Boundary

Not to scale

William Proctor House, Crawford County, Indiana



First Story

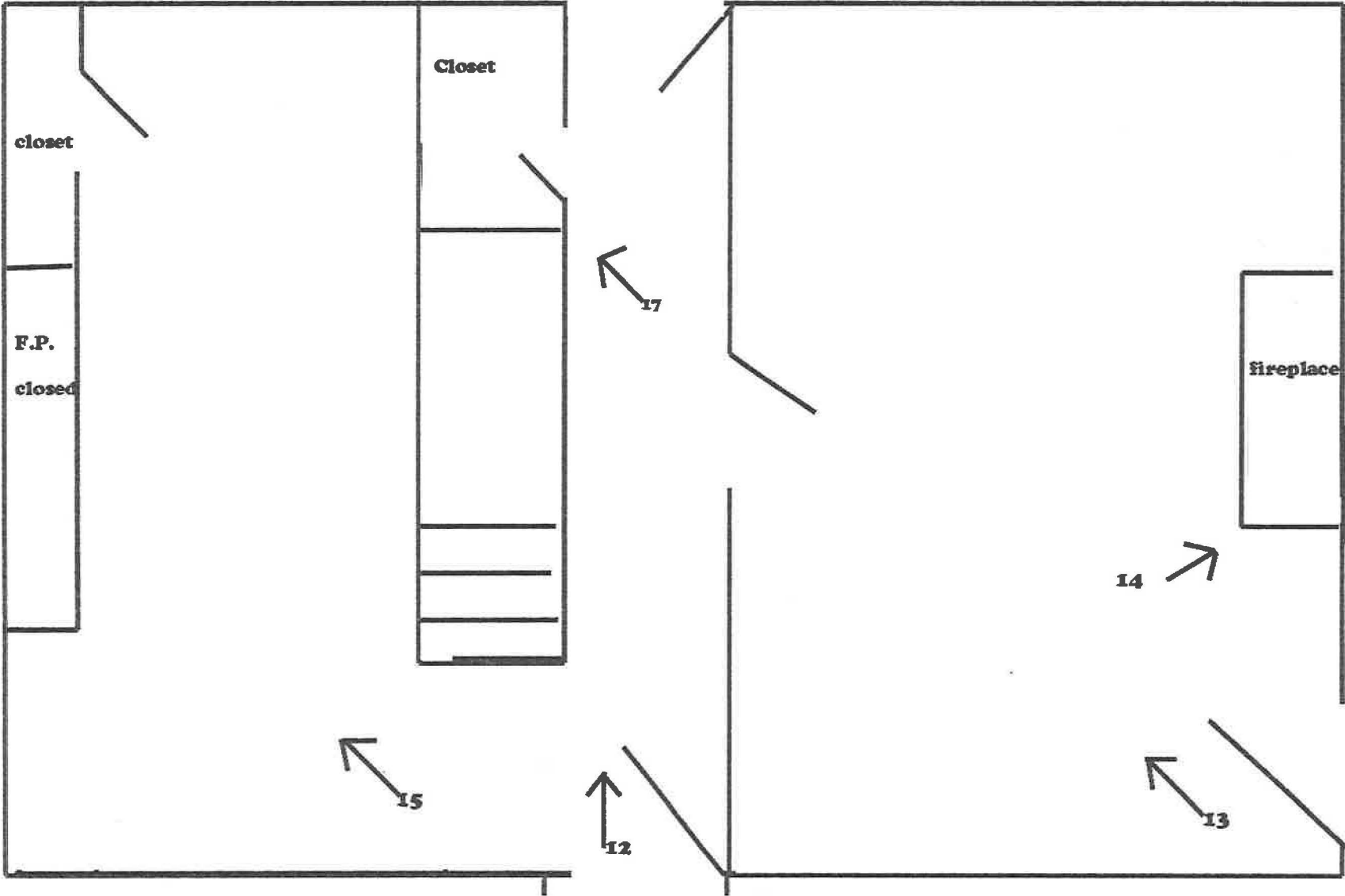

Not to scale

N



William Proctor House, Crawford County, Indiana

Second Story

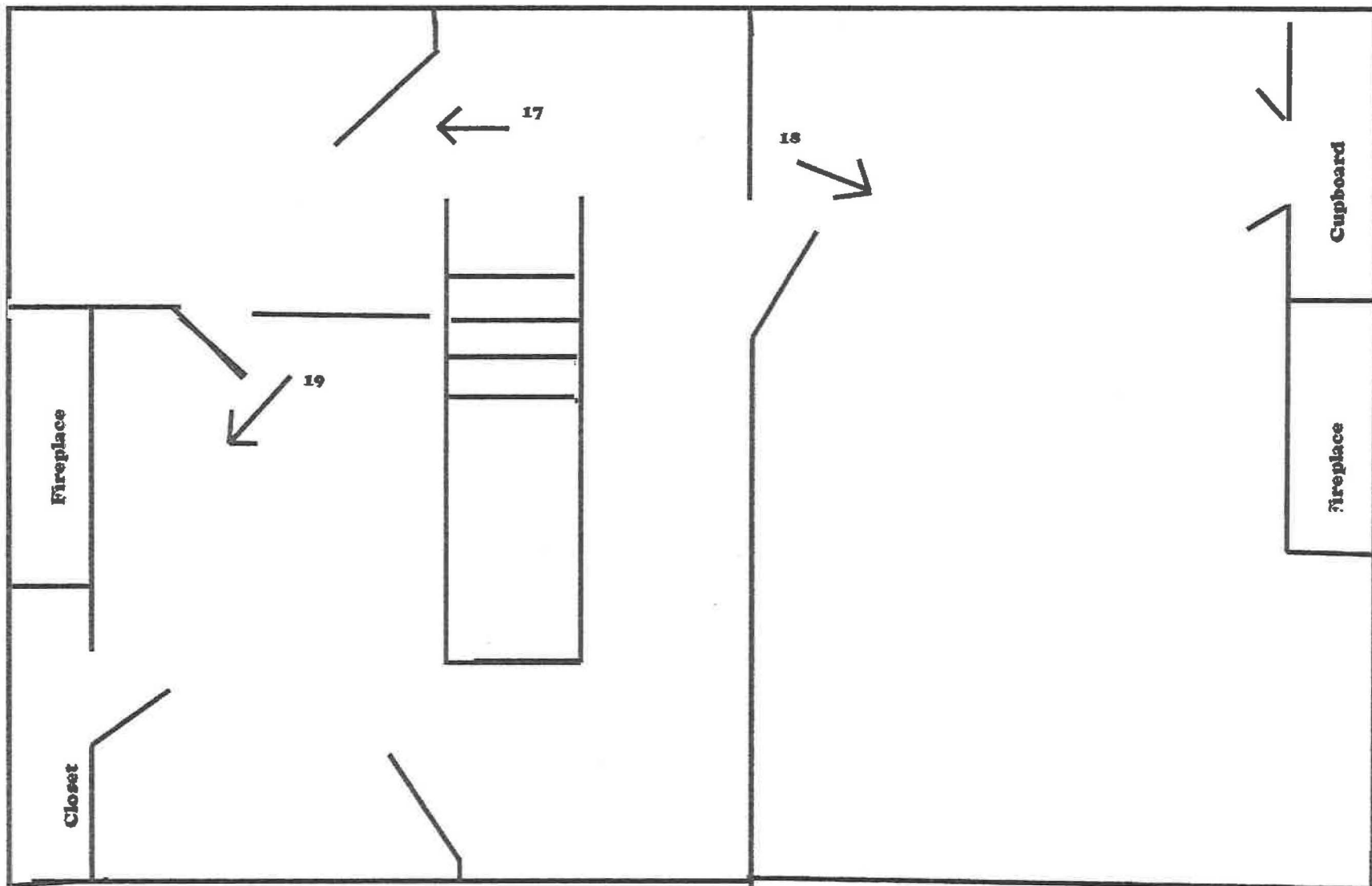

William Proctor
House
Crawford County, IN



Mapped, edited, and published by the Geological Survey
Control by USGS and USC&GS
Planimetry by photogrammetric methods from aerial photographs
Topography by planetable surveys 1945. Revised 1962
Polyconic projection
10,000-foot grids based on Indiana coordinate system,
west and east zones
1000-meter Universal Transverse Mercator grid ticks,
zone 16, shown in blue. 1927 North American Datum
To place on the predicted North American Datum 1983
move the projection lines 3 meters south and
1 meter west as shown by dashed corner ticks
Fine red dashed lines indicate selected fence and field lines where
generally visible on aerial photographs. This information is unchecked
There may be private inholdings within the boundaries
of the National or State reservations shown on this map

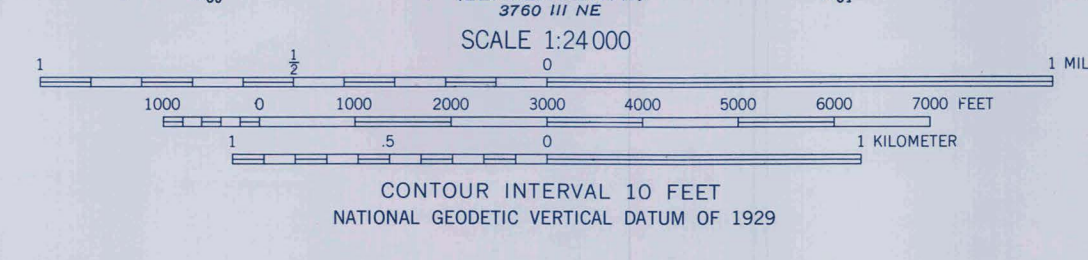
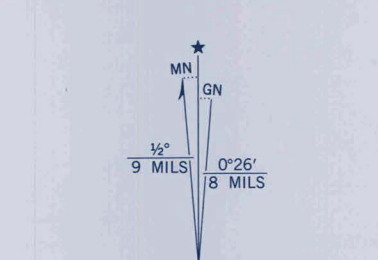

ROAD CLASSIFICATION

Primary highway, hard surface	Light-duty road, hard or improved surface
Secondary highway, hard surface	Unimproved road
Interstate Route	U.S. Route
	State Route

CONTOUR INTERVAL 10 FEET
NATIONAL GEODETIC VERTICAL DATUM OF 1929

THIS MAP COMPLIES WITH NATIONAL MAP ACCURACY STANDARDS
FOR SALE BY U.S. GEOLOGICAL SURVEY, RESTON, VIRGINIA 22092
AND INDIANA DEPARTMENT OF NATURAL RESOURCES, INDIANAPOLIS, INDIANA 46204
A FOLDER DESCRIBING TOPOGRAPHIC MAPS AND SYMBOLS IS AVAILABLE ON REQUEST

Revisions shown in purple compiled in cooperation with State of Indiana agencies from aerial photographs taken 1978 and other source data. This information not field checked. Map edited 1980

MILLTOWN, IND.
N3815-W8615/7.5
1962
PHOTOREVISED 1980
DMA 3760 IV SE—SERIES V851









7037







PROCTORVILLE
ESTABLISHED
1835
CALIFORNIA HISTORICAL
SOCIETY







WILLIAM PROCTOR
DIED
July 1, 1854
Aged
81 1/2 yrs.



WOOD
1808
1806
RICK
1826
1807



WILLIAM
1810
1810





















UNITED STATES DEPARTMENT OF THE INTERIOR
NATIONAL PARK SERVICE

NATIONAL REGISTER OF HISTORIC PLACES
EVALUATION/RETURN SHEET

REQUESTED ACTION: NOMINATION

PROPERTY NAME: Proctor, William, House

MULTIPLE NAME:

STATE & COUNTY: INDIANA, Crawford

DATE RECEIVED: 5/10/13 DATE OF PENDING LIST: 6/07/13
DATE OF 16TH DAY: 6/24/13 DATE OF 45TH DAY: 6/26/13
DATE OF WEEKLY LIST:

REFERENCE NUMBER: 13000419

REASONS FOR REVIEW:

APPEAL: N DATA PROBLEM: N LANDSCAPE: N LESS THAN 50 YEARS: N
OTHER: N PDIL: N PERIOD: N PROGRAM UNAPPROVED: N
REQUEST: N SAMPLE: N SLR DRAFT: N NATIONAL: N

COMMENT WAIVER: N

ACCEPT RETURN REJECT 6-25-13 DATE

ABSTRACT/SUMMARY COMMENTS:

**Entered in
The National Register
of
Historic Places**

RECOM./CRITERIA _____

REVIEWER _____ DISCIPLINE _____

TELEPHONE _____ DATE _____

DOCUMENTATION see attached comments Y/N see attached SLR Y/N

If a nomination is returned to the nominating authority, the nomination is no longer under consideration by the NPS.

DNR

Indiana Department of Natural Resources

Division of Historic Preservation & Archaeology • 402 W. Washington Street, W274 • Indianapolis, IN 46204-2739
Phone 317-232-1646 • Fax 317-232-0693 • dhpa@dnr.in.gov • www.in.gov/dnr/historic



April 26, 2013

Carol D. Shull
Interim Keeper of the National Register
National Park Service 2280
National Register of Historic Places
1201 "I" (Eye) Street, N.W.
Washington D.C. 20005

Re: William Proctor House, Crawford County, Indiana

Dear Ms. Shull,

Enclosed is a National Register of Historic Places nomination for the William Proctor House, Crawford County, Indiana. The Indiana Historic Preservation Review Board reviewed the application and voted to recommend its approval to the National Register of Historic Places.

Please address any questions you or your staff may have about this nomination to my National Register staff, Paul Diebold, Frank Hurdis, or Holly Tate.

Sincerely,

Robert E. Carter, Jr.
State Historic Preservation Officer

REC:PCD:pcd

enclosure: nomination package