

KENTUCKY HISTORIC RESOURCES INVENTORY

MDB-16

Site No.

1. Historic Name(s)
Original Owner

2. Present Name
Richardson House

3. Location
547 Lawrence Street

4. Owner's Name
Mrs. Lorina Richardson

5. Owner's Address
547 Lawrence Street, Brandenburg

6. Open to Public Yes No

7. Ownership Private Local State Federal

28. ADD/County
Lincoln Trail/Meade 082

29. U.S.G.S. Quadrant (15/75)
Mauckport 111

30. UTM Reference
16 15,7,2,2,4,0 4,2,0,6,4,8,0
Zone Easting Northing

31. Coordinate Accuracy

32. Prehistoric Site Object
Historic Site Structure
(Building) Other

33. National Register District Name:
Historic Resources of
Brandenburg 111

8. Site Plan with North Arrow

9. Architect/Builder

10. Date
ca. 1885 A. 5 B.

11. Style
A. T-Plan
B.

12. Original Use
Dwelling A

13. Present Use
Dwelling

14. Condition
Good B

15. Stories, No. of
1; 1 1/2 A B

34. Significance of Evaluation
National Register D

35. Status _____ Date _____

National Landmark	
National Register	
Landmark Certificate	
Kentucky Survey	
Local Landmark	
HABS/HAER	

36. Historic Theme
Primary Architecture C
Secondary _____
Other _____

37. Endangered Yes No

16. Description
One-story frame T-plan dwelling. Three bay with center entrance which has one pane transom. Bay window placement on facade and windows are 2/2 pane with denticated cornice. One-story, two bay porch enhanced by gingerbread trim with finials. Double window placement on facade consisting of long and narrow straight-headed windows of 2/2 pane with architrave trim. Facade gable pierced by double-placed rounded ventilators with hood molds. Each gable end also pierced by rounded ventilators with hoodmolds and completed by finial on cornice. Side windows 2/2 pane with architrave trim. Two bay dormers on each side
(Continue on Back)

17. Single Pile _____ NA _____
Double Pile

18. Floor Plan
T-plan W

19. Structural Fabric
Frame A. D B.

20. Decorative Fabric
Sawn Weatherboard A. J B.

21. Roof Form & Material
Gable; Asbestos shinglin

22. Foundation Material
Limestone B

23. Outbuildings 5

24. Alterations
Additions
Moved Wall Treatment

38. ATTACH PHOTO

Roll No. 6

Picture No. 20-35

Direction _____

39. Prepared by:
William Gus Johnson
Senior Historian

40. Organization
Kentucky Heritage Council

41. Date
Fall 1983

42. Revision Dates _____ 43. Staff Review _____

25. History

Significance
The dwelling is architecturally significant as an excellent example of late nineteenth century vernacular architecture in Brandenburg. It is a well-designed and well

27. Source of Information

16. on rear portion and windows are 2/2 pane. Interior chimneys. Five bay on left side with side entrance leading into enclosed rear porch. Right side is six bay. Basement. Both side cornices also accented with gingerbread trim.

26. constructed house which exhibits certain exterior architectural elements which distinguishes it from the rather basic late nineteenth century vernacular dwellings found in Brandenburg.

KENTUCKY HISTORIC RESOURCE INVENTORY SUPPLEMENT
BOUNDARY AND LOCATION INFORMATION

Historic Property Name Richardson House Site # MD-B-16

Multiple Resource/Thematic Nomination Title Historic Resources of Brandenburg, KY

U.T.M. Coordinates - List multiple UTM's if property is ten or more acres.

A. 16 572240 4206480 D. _____

B. _____ E. _____

C. _____ F. _____

Verbal Boundary Description Acreage 1.0

Beginning at a point on the south side of Lawrence Street, approximately 100 feet from the center of the house, proceed 200 feet in a southwestward direction; thence 200 feet in a northwestward direction; thence 200 feet in a northeastward direction; thence 200 feet in a southeastward direction along the south side of Lawrence Street to the point of origin.

Sketch of Site Plan (Showing outbuildings, structures, landscape features and the site boundary as described above.)

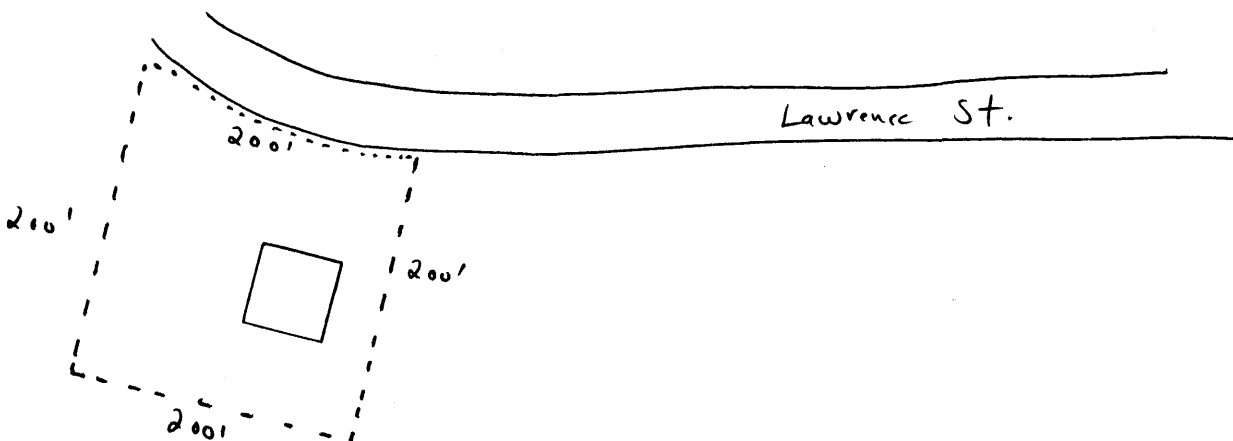

Not to scale

Official Courthouse Property Reference:

Meade County Deed Book