

United States Department of the Interior  
National Park Service

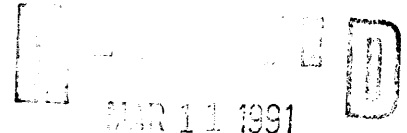

National Register of Historic Places  
Registration Form

NATIONAL REGISTER

This form is for use in nominating or requesting determinations of eligibility for individual properties or districts. See instructions in *Guidelines for Completing National Register Forms* (National Register Bulletin 16). Complete each item by marking "x" in the appropriate box or by entering the requested information. If an item does not apply to the property being documented, enter "N/A" for "not applicable." For functions, styles, materials, and areas of significance, enter only the categories and subcategories listed in the instructions. For additional space use continuation sheets (Form 10-900a). Type all entries.

1. Name of Property

historic name Hicks, Miss Emma, Bungalow  
other names/site number MM-MS-132

2. Location

street & number 10 White Avenue na not for publication  
city, town Mount Sterling na vicinity  
state Kentucky code KY county Montgomery code 173 zip code 40353

3. Classification

Ownership of Property	Category of Property	Number of Resources within Property	
		Contributing	Noncontributing
<input checked="" type="checkbox"/> private	<input checked="" type="checkbox"/> building(s)	<u>2</u>	<u>    </u> buildings
<input type="checkbox"/> public-local	<input type="checkbox"/> district	<u>    </u>	<u>    </u> sites
<input type="checkbox"/> public-State	<input type="checkbox"/> site	<u>    </u>	<u>    </u> structures
<input type="checkbox"/> public-Federal	<input type="checkbox"/> structure	<u>    </u>	<u>    </u> objects
	<input type="checkbox"/> object	<u>2</u>	<u>0</u> Total

Name of related multiple property listing: Mt. Sterling, Ky., MRA  
Number of contributing resources previously listed in the National Register 0

4. State/Federal Agency Certification

As the designated authority under the National Historic Preservation Act of 1966, as amended, I hereby certify that this  nomination  request for determination of eligibility meets the documentation standards for registering properties in the National Register of Historic Places and meets the procedural and professional requirements set forth in 36 CFR Part 60. In my opinion, the property  meets  does not meet the National Register criteria.  See continuation sheet.  
Signature of certifying official David L. Morgan Date 3-6-91  
State Historic Preservation Officer, Kentucky Heritage Council  
State or Federal agency and bureau

In my opinion, the property  meets  does not meet the National Register criteria.  See continuation sheet.  
Signature of commenting or other official \_\_\_\_\_ Date \_\_\_\_\_  
State or Federal agency and bureau \_\_\_\_\_

5. National Park Service Certification

I, hereby, certify that this property is:  
 entered in the National Register.  
 See continuation sheet.  
 determined eligible for the National Register.  See continuation sheet.  
 determined not eligible for the National Register.  
 removed from the National Register.  
 other, (explain:) \_\_\_\_\_

*Entered in the National Register*  
Shelley Byers 4/23/91  
Signature of the Keeper Date of Action

**6. Function or Use**

Historic Functions (enter categories from instructions)

DOMESTIC/ Single Dwelling  
DOMESTIC/ Secondary Structure  
\_\_\_\_\_  
\_\_\_\_\_

Current Functions (enter categories from instructions)

Domestic/ Single dwelling  
Domestic/ Secondary structure  
\_\_\_\_\_  
\_\_\_\_\_

**7. Description**

Architectural Classification  
(enter categories from instructions)

Late 19th and Early 20th Century  
American MOVement/ Bungalow  
\_\_\_\_\_

Materials (enter categories from instructions)

foundation Concrete  
walls Wood/ weatherboard  
\_\_\_\_\_  
roof Asphalt  
other \_\_\_\_\_  
\_\_\_\_\_

Describe present and historic physical appearance.

**8. Statement of Significance**

Certifying official has considered the significance of this property in relation to other properties:

nationally     statewide     locally

Applicable National Register Criteria     A     B     C     D

Criteria Considerations (Exceptions)     A     B     C     D     E     F     G

Areas of Significance (enter categories from instructions)

Architecture  
\_\_\_\_\_  
\_\_\_\_\_  
\_\_\_\_\_  
\_\_\_\_\_  
\_\_\_\_\_

Period of Significance

1922  
\_\_\_\_\_  
\_\_\_\_\_

Significant Dates

1922  
\_\_\_\_\_  
\_\_\_\_\_

Cultural Affiliation

N/A  
\_\_\_\_\_  
\_\_\_\_\_

Significant Person

N/A  
\_\_\_\_\_

Architect/Builder

N/A  
\_\_\_\_\_  
\_\_\_\_\_

State significance of property, and justify criteria, criteria considerations, and areas and periods of significance noted above.

**9. Major Bibliographical References**

Beers, D.G. and J. Lanagan. Map of Montgomery County, Kentucky.  
Philadelphia: Beers and Lanagan, 1879.

Boyd, Carl B. and Hazel M. Boyd. A History of Mt. Sterling, Ky.  
Mt. Sterling: privately printed, 1984.

Deed Books Montgomery County Courthouse.

Sanborn Insurance Maps for Mt. Sterling, Kentucky.

See continuation sheet

**Previous documentation on file (NPS):**

- preliminary determination of individual listing (36 CFR 67)  
has been requested
- previously listed in the National Register
- previously determined eligible by the National Register
- designated a National Historic Landmark
- recorded by Historic American Buildings  
Survey # \_\_\_\_\_
- recorded by Historic American Engineering  
Record # \_\_\_\_\_

**Primary location of additional data:**

- State historic preservation office
- Other State agency
- Federal agency
- Local government
- University
- Other

Specify repository:  
\_\_\_\_\_

**10. Geographical Data**

Acreeage of property .12 acre

**UTM References**

A      
Zone Easting Northing

C

B      
Zone Easting Northing

D

See continuation sheet

**Verbal Boundary Description**

See continuation sheet

**Boundary Justification**

See continuation sheet

**11. Form Prepared By**

name/title Helen Powell  
organization H. Powell & Co., Inc. date 12/1/90  
street & number 2230 Idle Hour Center telephone (606) 266-5351  
city or town Lexington state Kentucky zip code 40502

United States Department of the Interior  
National Park Service

National Register of Historic Places  
Continuation Sheet

Section number 7 Page 1

Hicks, Miss Emma, Bungalow  
Mt. Sterling, Ky. MRA

---

Miss Emma Hicks Bungalow: MM-MS-132

The Hicks Bungalow, completed in 1922, is a one and one-half story, weatherboarded, cross-gable plan bungalow. Sitting atop the point where the gables cross is a rectangular dormer with triple windows on the east and west sides and quadrupled windows on the north and south. The wide eaves are accented by brackets at the corners and apexes of the gables. On the front porch the brackets are rounded and extend beyond the roof line. Within the front gable of the porch is an oriental motif. The windows on the front or south facade are quadrupled with diamond patterned mullions in the upper halves of the windows.

Garage: MM-MS-132 A

A one car garage is located to the west of the residence. It is a rectangular, weatherboarded building with a gable roof built at approximately the same time as the dwelling.

United States Department of the Interior  
National Park Service

**National Register of Historic Places  
Continuation Sheet**

Section number   8   Page   1  

Hicks, Miss Emma, Bungalow  
Mt. Sterling, Ky. MRA

---

The Miss Emma Hicks Bungalow in Mt. Sterling, Kentucky is significant under criterion C as the best local example of the Bungalow style. The dwelling, which dates from 1922, retains its original exterior detailing and has not been altered. The building's exterior reflects more of the craftsman detailing associated nationally with the style than any other Bungalow in Mt. Sterling.

The Bungalow style as a whole is not very prevalent in Mt. Sterling. A total of twenty-two examples have been surveyed in the Northwest and East Mt. Sterling Districts. The Bungalow style became popular nationally after 1910, a period which coincided locally with a cooling of the building boom and industrial expansion in Mt. Sterling. The few dwellings built during the period were sited on lots created during the late nineteenth century expansion and typically reflect the slowdown of the local economy with a display of minimal ornamentation.

In 1920, T.C. Geary filed a plat for Bella Vista Subdivision. In 1922, lot 16 was sold to James Richards, who sold it to S.N. Williams later the same year (DB 73/252). In 1923, S.N. Williams sold the house and lot to Miss Emma Hicks. (DB 73/602).

United States Department of the Interior  
National Park Service

National Register of Historic Places  
Continuation Sheet

Section number 10 Page 1

Hicks, Miss Emma, Bungalow  
Mt. Sterling, Ky. MRA

---

Acreage in Property: .12 acre

UTM References

<u>Zone</u>	<u>Easting</u>	<u>Northing</u>
16	241000	4215840

Verbal Boundary Description

Starting at a point on the northeast corner of the lot or point A; then south approximately 80 feet along the west right of way of Reid Avenue and continuing around the corner approximately 50 feet and then northwesterly 120 feet to the northwest corner of the lot or point B; then east along the north property line of the property to the point of beginning or A.

Boundary Justification

The boundary was drawn to exclude the modern residential dwellings less than fifty years of age. Consequently the nominated area consists of the two architecturally significant resources, the dwelling and the garage.

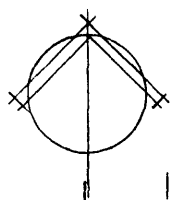

1" = 100'

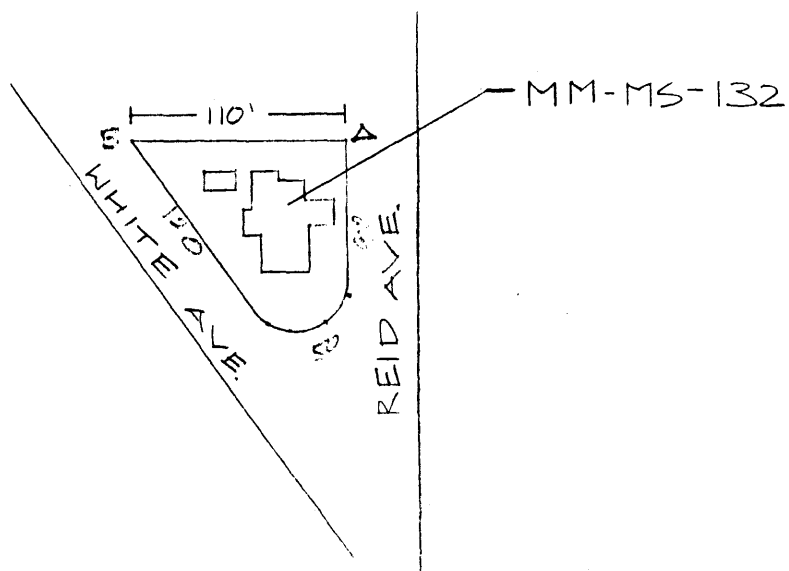

MISS EMMA HICKS BUNGALOW  
(MM-MS-132)

Mount Sterling, Kentucky, MRA

Montgomery Co.



**United States Department of the Interior  
National Park Service**

**National Register of Historic Places  
Continuation Sheet**

Section number PHOTOS Page 1 Hicks, Miss Emma, Bungalow  
Mt. Sterling, Ky., MRA

---

For All Photos:

Property Location: 10 White Avenue  
Mount Sterling, Montgomery County, Kentucky  
Photographer: Helen Powell  
Negative Location: Kentucky Heritage Council  
Frankfort, Kentucky  
Date Taken: 1990

Photo No.

- |   |                                             |
|---|---------------------------------------------|
| 1 | Main facade, view to north                  |
| 2 | Garage at left, in foreground, view to east |
| 3 | House, view to northeast                    |