

NATIONAL REGISTER OF HISTORIC PLACES
INVENTORY - NOMINATION FORM

(Type all entries - complete applicable sections)

STATE: California
COUNTY: San Francisco
FOR NPS USE ONLY
ENTRY NUMBER: _____ DATE: _____

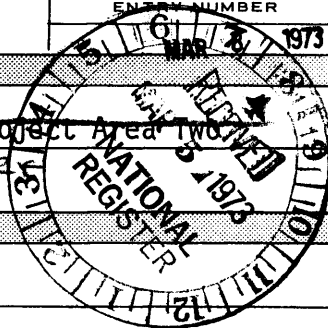

Handwritten note: House at 773 Turk Street - see attached

1. NAME
COMMON: House at 773 Turk Street ~~Western Addition Project Area Two~~
AND/OR HISTORIC: 773 Turk Street ~~1735-1737 Webster~~

2. LOCATION
STREET AND NUMBER: 773 Turk Street
CITY OR TOWN: San Francisco
STATE: California CODE: 06 COUNTY: San Francisco CODE: 075

3. CLASSIFICATION

CATEGORY (Check One)	OWNERSHIP	STATUS	ACCESSIBLE TO THE PUBLIC
<input type="checkbox"/> District <input type="checkbox"/> Site <input type="checkbox"/> Object	<input checked="" type="checkbox"/> Building <input type="checkbox"/> Structure <input type="checkbox"/> Private <input type="checkbox"/> Both	Public Acquisition: <input type="checkbox"/> In Process <input type="checkbox"/> Being Considered	Yes: <input checked="" type="checkbox"/> Restricted visual access only <input type="checkbox"/> Unrestricted <input type="checkbox"/> No
PRESENT USE (Check One or More as Appropriate)			
<input type="checkbox"/> Agricultural <input type="checkbox"/> Commercial <input type="checkbox"/> Educational <input type="checkbox"/> Entertainment	<input type="checkbox"/> Government <input type="checkbox"/> Industrial <input type="checkbox"/> Military <input type="checkbox"/> Museum	<input type="checkbox"/> Park <input checked="" type="checkbox"/> Private Residence <input type="checkbox"/> Religious <input type="checkbox"/> Scientific	<input type="checkbox"/> Transportation <input type="checkbox"/> Other (Specify) _____ Comments: _____

4. OWNER OF PROPERTY
OWNER'S NAME: ~~San Francisco Redevelopment Agency~~ George E. L. Stewart
STREET AND NUMBER: 762 Fulton Street
CITY OR TOWN: San Francisco STATE: California CODE: 06

5. LOCATION OF LEGAL DESCRIPTION
COURTHOUSE, REGISTRY OF DEEDS, ETC.: San Francisco Assessor's Office
STREET AND NUMBER: City Hall
CITY OR TOWN: San Francisco STATE: California CODE: 06

6. REPRESENTATION IN EXISTING SURVEYS
TITLE OF SURVEY: San Francisco Conservation Committee Survey *
(Under the auspices of San Francisco Redevelopment Agency)
DATE OF SURVEY: 1962 Federal State County Local
DEPOSITORY FOR SURVEY RECORDS: San Francisco Redevelopment Agency
STREET AND NUMBER: 762 Fulton Street
CITY OR TOWN: San Francisco STATE: California CODE: 06

STATE: California
COUNTY: San Francisco
ENTRY NUMBER: _____
DATE: _____
FOR NPS USE ONLY

SEE INSTRUCTIONS

*Also: Junior League of San Francisco Survey
(Both surveys were adopted by the Landmarks Preservation Advisory Board of the City and County of San Francisco).

7. DESCRIPTION

CONDITION	(Check One)					
	<input type="checkbox"/> Excellent	<input type="checkbox"/> Good	<input checked="" type="checkbox"/> Fair	<input type="checkbox"/> Deteriorated	<input type="checkbox"/> Ruins	<input type="checkbox"/> Unexposed
	(Check One)			In process (Check One)		
	<input type="checkbox"/> Altered	<input checked="" type="checkbox"/> Unaltered		<input checked="" type="checkbox"/> Moved	<input type="checkbox"/> Original Site	

DESCRIBE THE PRESENT AND ORIGINAL (if known) PHYSICAL APPEARANCE

A two-story and basement wood frame dwelling, designed originally for a single family, this tall house in the Stick Eastlake Style is of most distinctive character, with heavy and prominent ornamentation and extreme emphasis upon the vertical.

The facade is dominated by the profusion of ornament, strongly-marked vertical lines of the fenestration, doorway and the accompanying exterior decorative elements. The extreme verticality is complemented by horizontal elements, a melange of angular, straight and curvilinear applied ornament, and the intricate and involved composition is a veritable feast of the millworker's art.

The heavily ornamented facade is dominated by the square bay, which forms the eastern half of the facade, rising over two stories to a crowning gable and steeple. The bay is composed of paired vertical-emphasis windows at each story and is covered with adornment almost overpowering in its magnificence.

Beginning at the street level, the supports for the bay are single strongly marked scrolled brackets flanking a simple rectangular window and door entering the ground floor. The bay itself terminates at the point where it joins the scrolled brackets, in square boxy dependent finials, hanging down under the floor of the bay on either side. The main story windows above are connected by a prominent continuous sill with dentillations below. The individual windows are framed in heavy mouldings and flanked on either hand by slim colonnettes terminating in tiny florid Ionic capitals. Larger colonnettes also fluted in their lower halves flank the entire bay outside the smaller window colonnettes. Ionic capitals characterize the style of all columns and colonnettes of the facade. Keystones mark the apices of the windows and are applied upon horizontal panels at the ceiling level of the first story.

The elaboration of detail on the highly distinctive facade continues above this layer of ornament, a multiangular hood or pediment below the second story windows enclosing a carved floral wooden ornament centered above the midline of the lower story windows and approximately at the level of a similar multiangular hood over the porch to the west.

The straight steps of the entrance march up high into the depths and recesses of the porch, flanked by round columns, fluted on their lower thirds, smooth on the upper two thirds, crowned by Ionic capitals. The slightly rounded entrance arch echoes the slightly rounded window heads of the corresponding portion of the bay. The door is double-leaf with round arched lights flanked by colonnettes.

Above the porch is a spooled wood screen flanked by double paired spools supporting the pediment over the aforementioned doorway. This multi-angular pediment encloses a carved wood relief of bowl with floral and foliate design arranged in a sunburst pattern.

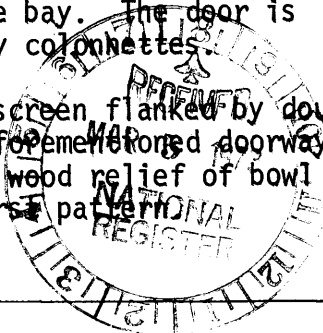

(Continued)

SEE INSTRUCTIONS

NATIONAL REGISTER OF HISTORIC PLACES
INVENTORY - NOMINATION FORM

STATE	California
COUNTY	San Francisco
FOR NPS USE ONLY	
ENTRY NUMBER	DATE

773 Turk Street

(Continuation Sheet)

(Number all entries)

7. DESCRIPTION, Continued

The windows and ornamentation of the second story, immediately above the pediments of the main story, commence with squared piers on wooden bases for the sills of the second story. Heavy projecting sills in turn support paired semifluted colonnettes flanking the single window above the doorway, the inner pair of colonnettes being smaller than the outer. Ionic caps terminate the colonnettes, the outer pair supporting a heavy flat hood moulding, with a fluted keystone coupling window head and hood moulding. Above this is another multiangular pediment enclosing modillions and a shell-like wood ornament.

Opposite this window is the window-pair of the bay at the second story, with similar round-arched windows contrasting with the flat-headed (round-cornered) ones of the first floor. The windows are trimmed with colonnettes detailed in similar manner to those at the first floor. The outer colonnettes support the heavy projecting series of flat pediments, separated by modillions, together with semicircular tympanum with sunburst pattern gable above.

The culminating ornamental and decorative elements of the facade contain the only horizontal lines of the entire facade. Composed of roof line cornice with underlying dentillations supporting scrolled brackets or consoles, modillions and smaller cornice and broken by the unusual projecting hooded gable with its ornaments, this portion of the facade serves as a crown to the work, with the spire and its terminal finial as highest element of all.

The corners of the facade are not decorated with the common quioning but have distinctive detail ornamentation: the eastmost having thin pipestem colonnettes, fluted in their lower halves, at each story. The western corner is covered with a vertical flat pilaster incised with a vertical ornament and surmounted by a curvilinear element composed of a single roulette of wood coins flowing from top to bottom crowned with a small wooden rosette and a round finial in wood. The facade is surfaced with the usual rusticated board.

The interiors and exterior of this fine Victorian structure are in original condition and will be extremely beautiful when rehabilitated by its new owner. This building is to be moved to become one in a lovely row of Victorians on Webster Street near Bush Street.

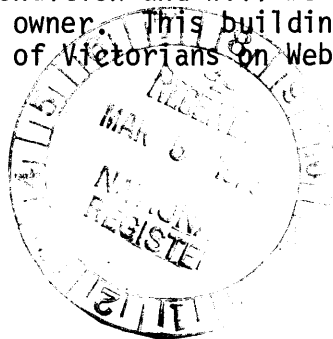

SIGNIFICANCE

PERIOD (Check One or More as Appropriate)

<input type="checkbox"/> Pre-Columbian	<input type="checkbox"/> 16th Century	<input type="checkbox"/> 18th Century	<input type="checkbox"/> 20th Century
<input type="checkbox"/> 15th Century	<input type="checkbox"/> 17th Century	<input checked="" type="checkbox"/> 19th Century	

SPECIFIC DATE(S) (If Applicable and Known) 1876

AREAS OF SIGNIFICANCE (Check One or More as Appropriate)

<input type="checkbox"/> Aboriginal	<input type="checkbox"/> Education	<input type="checkbox"/> Political	<input type="checkbox"/> Urban Planning
<input type="checkbox"/> Prehistoric	<input type="checkbox"/> Engineering	<input type="checkbox"/> Religion/Philosophy	<input type="checkbox"/> Other (Specify) _____
<input type="checkbox"/> Historic	<input type="checkbox"/> Industry	<input type="checkbox"/> Science	_____
<input type="checkbox"/> Agriculture	<input type="checkbox"/> Invention	<input type="checkbox"/> Sculpture	_____
<input checked="" type="checkbox"/> Architecture	<input type="checkbox"/> Landscape Architecture	<input type="checkbox"/> Social/Humanitarian	_____
<input type="checkbox"/> Art	<input type="checkbox"/> Literature	<input type="checkbox"/> Theater	_____
<input type="checkbox"/> Commerce	<input type="checkbox"/> Military	<input type="checkbox"/> Transportation	_____
<input type="checkbox"/> Communications	<input type="checkbox"/> Music		
<input type="checkbox"/> Conservation			

STATEMENT OF SIGNIFICANCE

The San Francisco Water Department records show that this building was connected to the water system in 1876. The Junior League of San Francisco's book Here Today puts the date at "late 1880's" and describes it as "The crowded ornate facade on this Stick-Eastlake house is crowned with an unusual tower".

Mr. F. Vollerni was the original owner. Mr. J. J. Volmer was the second owner who resided a few doors down Turk Street. Since Mr. Vollerni, there were three owners up until the San Francisco Redevelopment Agency purchased the property in 1967. All of the owners were absentee landlords and used this building as rental property.

Because of the zoning within the project area, this building has to be either demolished or moved to a more suitable location where it can be rehabilitated and preserved.

773 Turk will be moved to Block 677, Lot 2, to become one in a row of handsome Victorian buildings which are to be rehabilitated. 773 Turk is one of the six most important Victorian structures chosen by the San Francisco Landmarks Preservation Advisory Board as having exceptional merit.



SEE INSTRUCTIONS

9. MAJOR BIBLIOGRAPHICAL REFERENCES

Junior League of San Francisco, Inc. Here Today - San Francisco's Architectural Heritage (Chronicle Books, San Francisco, 1968)

10. GEOGRAPHICAL DATA

LATITUDE AND LONGITUDE COORDINATES DEFINING A RECTANGLE LOCATING THE PROPERTY				OR	LATITUDE AND LONGITUDE COORDINATES DEFINING THE CENTER POINT OF A PROPERTY OF LESS THAN TEN ACRES				
CORNER	LATITUDE		LONGITUDE		LATITUDE		LONGITUDE		
	Degrees	Minutes	Seconds	Degrees	Minutes	Seconds	Degrees	Minutes	Seconds
NW	°	'	"	°	'	"	N37°	46'	55"
NE	°	'	"	°	'	"	W122°	25'	14"
SE	°	'	"	°	'	"			
SW	°	'	"	°	'	"			

UTM
10/551040
4181540
CD

APPROXIMATE ACREAGE OF NOMINATED PROPERTY: **2,608 sq. ft.**

LIST ALL STATES AND COUNTIES FOR PROPERTIES OVERLAPPING STATE OR COUNTY BOUNDARIES

STATE:	CODE	COUNTY	CODE

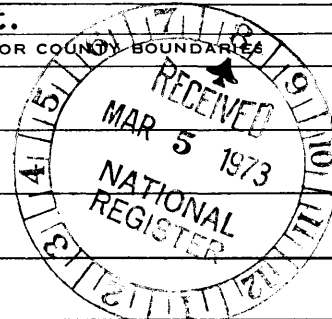

SEE INSTRUCTIONS

11. FORM PREPARED BY

NAME AND TITLE: **Enid T. Sales, Rehabilitation Supervisor; Susan Bragstad, Architect**

ORGANIZATION: **San Francisco Redevelopment Agency *** DATE: **January 9, 1973**

STREET AND NUMBER: **762 Fulton Street**

CITY OR TOWN: **San Francisco** STATE: **California** CODE: **06**

12. STATE LIAISON OFFICER CERTIFICATION

As the designated State Liaison Officer for the National Historic Preservation Act of 1966 (Public Law 89-665), I hereby nominate this property for inclusion in the National Register and certify that it has been evaluated according to the criteria and procedures set forth by the National Park Service. The recommended level of significance of this nomination is:

National State Local

Name *[Signature]*

Title State Liaison Officer

Date **FEB 12 1972**

NATIONAL REGISTER VERIFICATION

I hereby certify that this property is included in the National Register.

[Signature]
Chief, Office of Archeology and Historic Preservation

Date 3/8/73

ATTEST: *[Signature]*
Keeper of The National Register

Date 3-7-73

Also *San Francisco Landmarks Preservation Advisory Board
100 Larkin Street
San Francisco, California 06

F I L L M O R E S T.

S
U
T
T
E
R

S
T.

B
U
S
I

S
T.

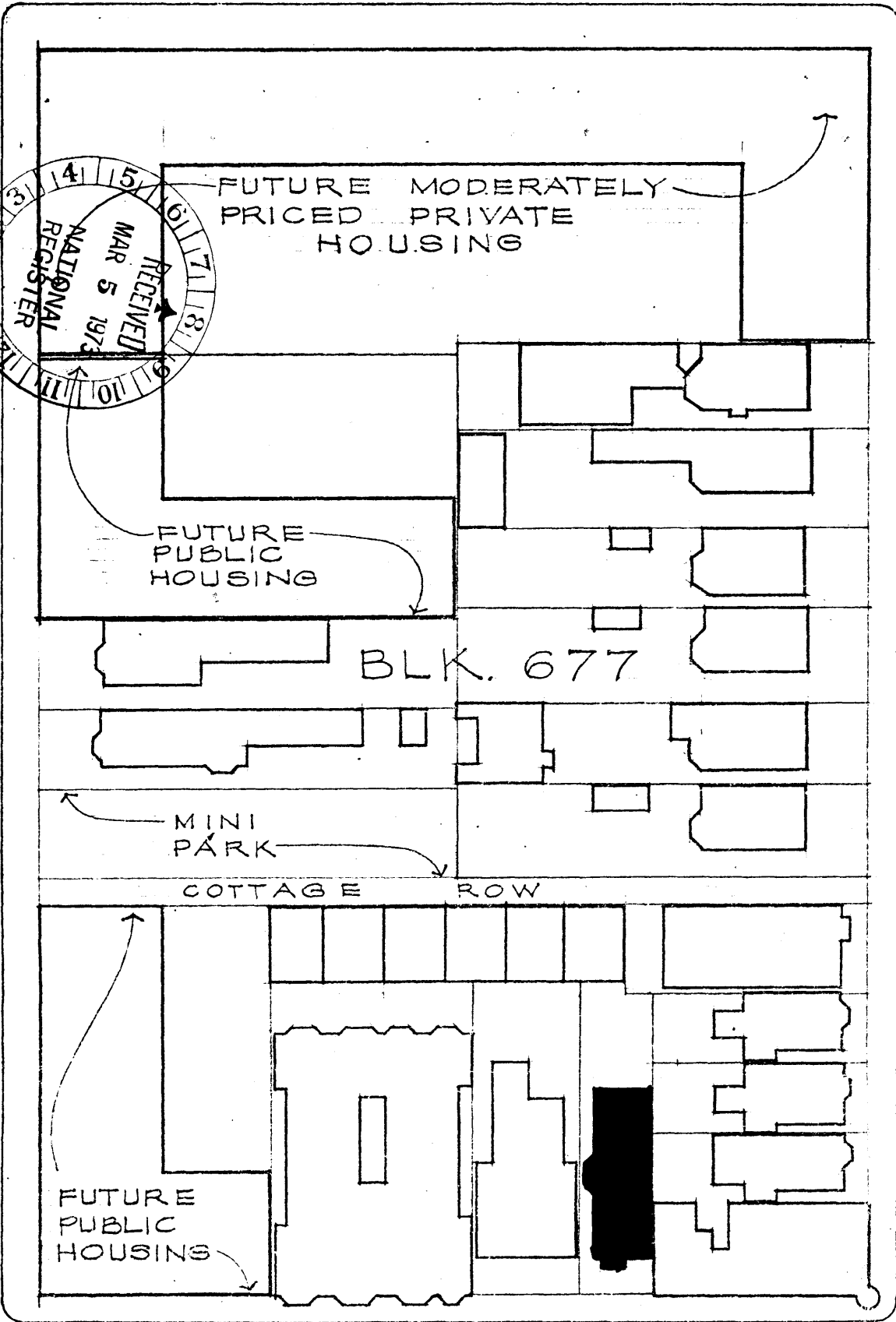
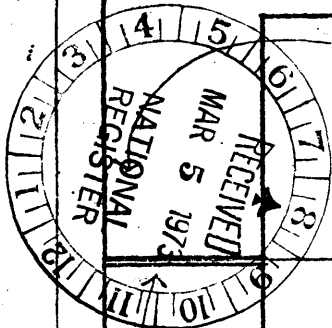

FUTURE MODERATELY PRICED PRIVATE HOUSING

FUTURE PUBLIC HOUSING

BLK. 677

MINI PARK

COTTAGE ROW

FUTURE PUBLIC HOUSING

SCALE: 1" = 50'

W E B S T E R S T.

LEGEND MAP C: DEVELOPMENT PLAN

NORTH

- NEW LOCATION OF 773 TURK
- BLDGS. TO BE REHABILITATED

JAN. 8, 1973

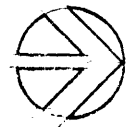

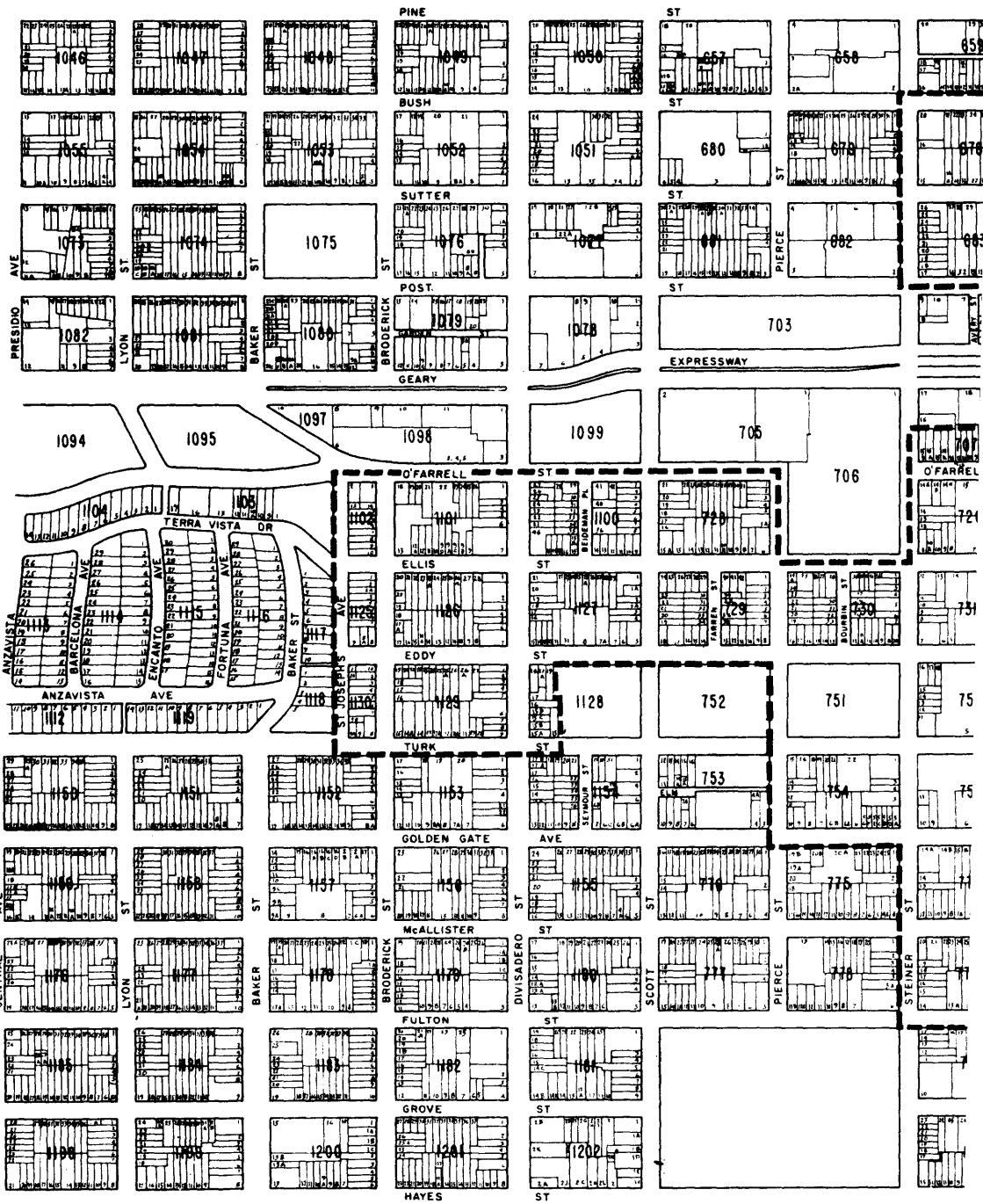

LEGEND - - - - - PROJECT BOUNDARY

WESTERN ADDI

MAP B: RELOCATION OF 773 TI

- █ EXIST. LOCATION
- █ NEW LOCATION

DEVELOPMENT PLAN

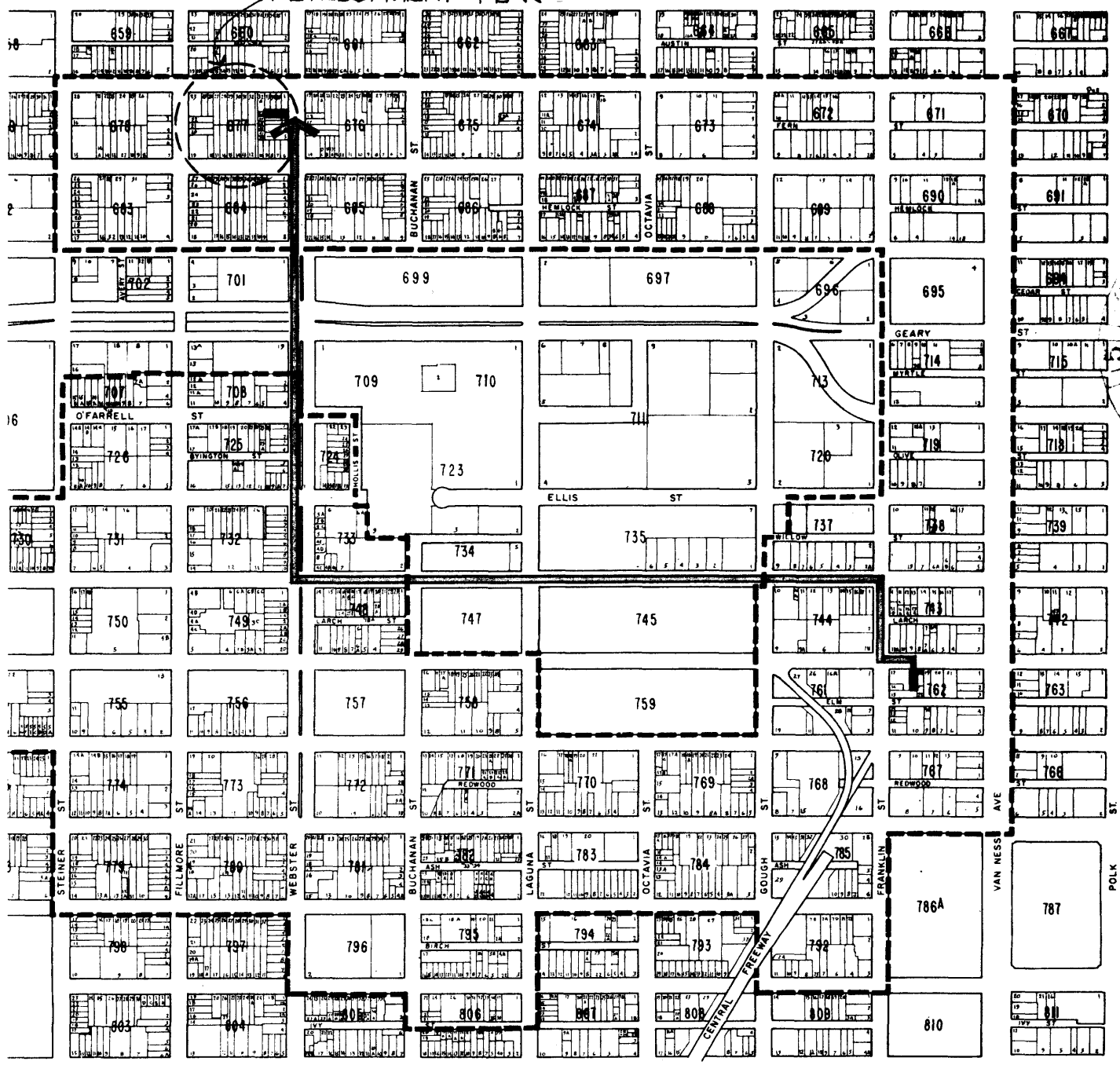

ADDITION AREA TWO

3 TURK

(REFER TO MAP "C" FOR DEVELOPMENT PLAN)

