

**NATIONAL REGISTER OF HISTORIC PLACES
INVENTORY - NOMINATION FORM**

(Type all entries - complete applicable sections)

STATE: Utah	
COUNTY: Weber	
FOR NPS USE ONLY	
ENTRY NUMBER	DATE
	APR 3 1972

1. NAME

COMMON:
Episcopal Church of The Good Shepherd

AND/OR HISTORIC:
Episcopal Church of The Good Shepherd

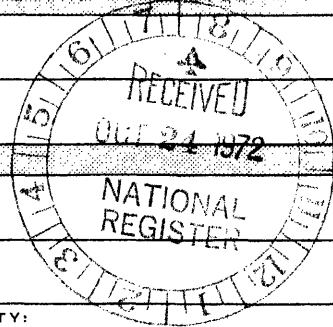

2. LOCATION

STREET AND NUMBER:
2374 Grant Avenue

CITY OR TOWN:
Ogden

STATE: **Utah** CODE: **49** COUNTY: **Weber** CODE: **057**

3. CLASSIFICATION

CATEGORY (Check One)	OWNERSHIP	STATUS	ACCESSIBLE TO THE PUBLIC
<input type="checkbox"/> District <input checked="" type="checkbox"/> Building <input type="checkbox"/> Site <input type="checkbox"/> Structure <input type="checkbox"/> Object	<input type="checkbox"/> Public <input checked="" type="checkbox"/> Private <input type="checkbox"/> Both	Public Acquisition: <input type="checkbox"/> In Process <input type="checkbox"/> Being Considered	<input checked="" type="checkbox"/> Occupied <input type="checkbox"/> Unoccupied <input type="checkbox"/> Preservation work in progress
PRESENT USE (Check One or More as Appropriate)			
<input type="checkbox"/> Agricultural <input type="checkbox"/> Commercial <input type="checkbox"/> Educational <input type="checkbox"/> Entertainment	<input type="checkbox"/> Government <input type="checkbox"/> Industrial <input type="checkbox"/> Military <input type="checkbox"/> Museum	<input type="checkbox"/> Park <input type="checkbox"/> Private Residence <input checked="" type="checkbox"/> Religious <input type="checkbox"/> Scientific	<input type="checkbox"/> Transportation <input type="checkbox"/> Other (Specify) _____ <input type="checkbox"/> Comments _____ _____ _____

4. OWNER OF PROPERTY

OWNER'S NAME:
Episcopal Church of The Good Shepherd

STREET AND NUMBER:
2374 Grant Avenue

CITY OR TOWN: **Ogden** STATE: **Utah** CODE: **49**

5. LOCATION OF LEGAL DESCRIPTION

COURTHOUSE, REGISTRY OF DEEDS, ETC.:
Recorder's Office Weber County Court House

STREET AND NUMBER:

CITY OR TOWN: **Ogden** STATE: **Utah** CODE: **49**

6. REPRESENTATION IN EXISTING SURVEYS

TITLE OF SURVEY:
Utah Historic Sites Survey

DATE OF SURVEY: **1971** Federal State County Local

DEPOSITORY FOR SURVEY RECORDS:
Utah State Historical Society

STREET AND NUMBER:
603 East South Temple

CITY OR TOWN: **Salt Lake City** STATE: **Utah** CODE: **49**

SEE INSTRUCTIONS

STATE: _____

COUNTY: _____

ENTRY NUMBER: **APR 3 1972**

DATE: _____

FOR NPS USE ONLY

7. DESCRIPTION

CONDITION

(Check One)

Excellent Good Fair Deteriorated Ruins Unexposed

(Check One)

Altered Unaltered

(Check One)

Moved Original Site

DESCRIBE THE PRESENT AND ORIGINAL (if known) PHYSICAL APPEARANCE

The Episcopal Church of The Good Shepherd is an example of "Carpenter Gothic" style of architecture. Thick cut stone walls, which were quarried from Mendon, Utah, are further braced by heavy granite buttresses.

The tudor windows contain beautiful stained glass. In 1970 the last of the stained glass windows was dedicated, making a total of 11 windows. The charm of the original building is readily apparent and seems to defy the mediocrity of its surroundings. It is one of few pioneer buildings remaining in Ogden.

The roof is steep and covered with wood shingles. Scissor shaped wood rafters are exposed on the inside. Cupula and bell tower rests atop the ridge topped by a wrought iron dove of peace which is slightly askew. The bell tower contains the first church bell to be rung in Ogden. It arrived around Christmas 1878 from New York. It weighs 515 pounds. The bell is still being rung today.

A wrought iron fence is across the front of the courtyard on Grant Avenue.

In 1942 the double wooden doors leading into the Church were painted red. Red is a symbol of welcome. Significance of the red doors indicates the Holy Spirit is within. Windows have been added above and sidelights removed from the main entrance.

The Church was expanded to the south in 1906, again to the south in 1952, and Tuttle Hall was added to the west in 1956. The additions only altered the original building in one area; part of the wall near the back south side of the Church was opened to join the new addition.

A 30 bell carrillon was added in 1968. It is the first of its kind on the Wasatch front.

Only the original part of the church is submitted as a nominee for the Register.

SEE INSTRUCTIONS

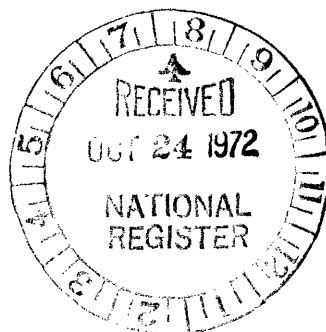

SIGNIFICANCE

PERIOD (Check One or More as Appropriate)

- | | | | |
|--|---------------------------------------|--|---------------------------------------|
| <input type="checkbox"/> Pre-Columbian | <input type="checkbox"/> 16th Century | <input type="checkbox"/> 18th Century | <input type="checkbox"/> 20th Century |
| <input type="checkbox"/> 15th Century | <input type="checkbox"/> 17th Century | <input checked="" type="checkbox"/> 19th Century | |

SPECIFIC DATE(S) (If Applicable and Known)

AREAS OF SIGNIFICANCE (Check One or More as Appropriate)

- | | | | |
|---|---|---|--|
| <input type="checkbox"/> Aboriginal | <input type="checkbox"/> Education | <input type="checkbox"/> Political | <input type="checkbox"/> Urban Planning |
| <input type="checkbox"/> Prehistoric | <input type="checkbox"/> Engineering | <input checked="" type="checkbox"/> Religion/Philosophy | <input type="checkbox"/> Other (Specify) |
| <input type="checkbox"/> Historic | <input type="checkbox"/> Industry | <input type="checkbox"/> Science | _____ |
| <input type="checkbox"/> Agriculture | <input type="checkbox"/> Invention | <input type="checkbox"/> Sculpture | _____ |
| ? <input type="checkbox"/> Architecture | <input type="checkbox"/> Landscape Architecture | <input type="checkbox"/> Social/Humanitarian | _____ |
| <input type="checkbox"/> Art | <input type="checkbox"/> Literature | <input type="checkbox"/> Theater | _____ |
| <input type="checkbox"/> Commerce | <input type="checkbox"/> Military | <input type="checkbox"/> Transportation | _____ |
| <input type="checkbox"/> Communications | <input type="checkbox"/> Music | | _____ |
| <input type="checkbox"/> Conservation | | | _____ |

STATEMENT OF SIGNIFICANCE

SEE INSTRUCTIONS

Twenty years after the arrival of the first Mormons in Utah other religious groups began to make inroads into the Mormon Zion. The first Protestant group to set up a permanent organization in Utah was the Episcopal Church. The Episcopalians did not come West with the express purpose of making converts of the Mormons but rather to find its members and offer services to them.

Brigham Young said that he did not expect any "abuse and detraction from an Episcopal bishop. They are men of education and better sense; they are gentlemen, and any gentleman is welcome here, no matter what his creed." (Daniel Sylvester Tuttle, *Reminiscences of a Missionary Bishop*, p. 59-60)

Bishop Daniel Tuttle arrived in Utah in 1867. Three years later, in 1870, Reverend James Lee Gillogly was sent to Ogden as a resident missionary. Church services were first held in the passenger room of the Ogden train station. That same year an old building which had been used as a saloon was secured for church and educational purposes.

In 1874 Bishop Tuttle obtained a \$4000 donation from John W. Hammersley of New York for the erection of a church in Ogden in memory of his daughter, Mrs. Catherine L. Livingstone. The designs for the church were provided by Gordon W. Lloyd of Detroit, Michigan.

The cornerstone was laid April 29, 1874 and on February 6, 1875 the church was consecrated. The total cost was near \$11,000 and Mr. Hammersley willingly provided the extra money.

From the time of his arrival Mr. Gillogly assumed an attitude of strong and square opposition to the Mormons. As a result antagonisms did develop between the two churches. In this sense the Church of The Good Shepherd serves as a reminder of that conflict, but even more so it stands as a monument to the pioneering work of the early Episcopalians in the West.

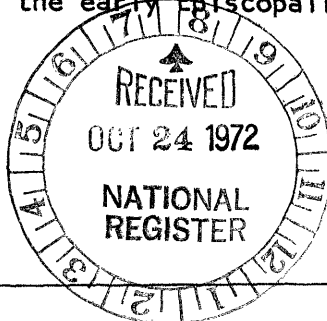

9. MAJOR BIBLIOGRAPHICAL REFERENCES

Gillogly, L. Lucelia Webster. "Early Missionary Life in Ogden, Utah." Manuscript, Utah State Historical Society, Salt Lake City, Utah.
 Lyon, T. Edgar. "Evangelical Protestant Missionary Activities in Mormon Dominated Areas, 1865-1900." Unpublished Ph.D. dissertation, University of Utah, 1962.
 Tuttle, Daniel Sylvester. Reminiscences of a Missionary Bishop. New York: Thomas Whittaker, 1906.

D. 1001. 300. 400. 500. 600. 700. 800. 900. 1000.

10. GEOGRAPHICAL DATA

LATITUDE AND LONGITUDE COORDINATES DEFINING A RECTANGLE LOCATING THE PROPERTY			O R	LATITUDE AND LONGITUDE COORDINATES DEFINING THE CENTER POINT OF A PROPERTY OF LESS THAN TEN ACRES		
CORNER	LATITUDE	LONGITUDE		LATITUDE	LONGITUDE	
	Degrees Minutes Seconds	Degrees Minutes Seconds		Degrees Minutes Seconds	Degrees Minutes Seconds	
NW	° ' "	° ' "		41 ° 13 ' 23 "	111 ° 58 ' 19 "	
NE	° ' "	° ' "				
SE	° ' "	° ' "				
SW	° ' "	° ' "				

NO
 UTM
 CD

APPROXIMATE ACREAGE OF NOMINATED PROPERTY: **less than one**

LIST ALL STATES AND COUNTIES FOR PROPERTIES OVERLAPPING STATE OR COUNTY BOUNDARIES

STATE:	CODE	COUNTY:	CODE

SEE INSTRUCTIONS

11. FORM PREPARED BY

NAME AND TITLE:
Kent Powell Preservation Historian

ORGANIZATION: **Utah State Historical Society** DATE: **August 2, 1972**

STREET AND NUMBER:
603 East South Temple

CITY OR TOWN: **Salt Lake City** STATE: **Utah** CODE: **49**

12. STATE LIAISON OFFICER CERTIFICATION

NATIONAL REGISTER VERIFICATION

As the designated State Liaison Officer for the National Historic Preservation Act of 1966 (Public Law 89-665), I hereby nominate this property for inclusion in the National Register and certify that it has been evaluated according to the criteria and procedures set forth by the National Park Service. The recommended level of significance of this nomination is:

National State Local ?

Name Milton L. Weilenmann
 Title State Liaison Officer
 Date August 2, 1972

I hereby certify that this property is included in the National Register.

Robert Tuttle
 Chief, Office of Archeology and Historic Preservation

Date 4/3/73

ATTEST:
Wm J. Smith
 Keeper of The National Register

Date 3.26.73

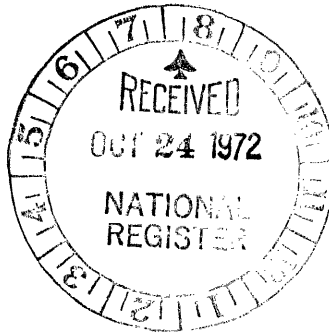

GRANT AVENUE

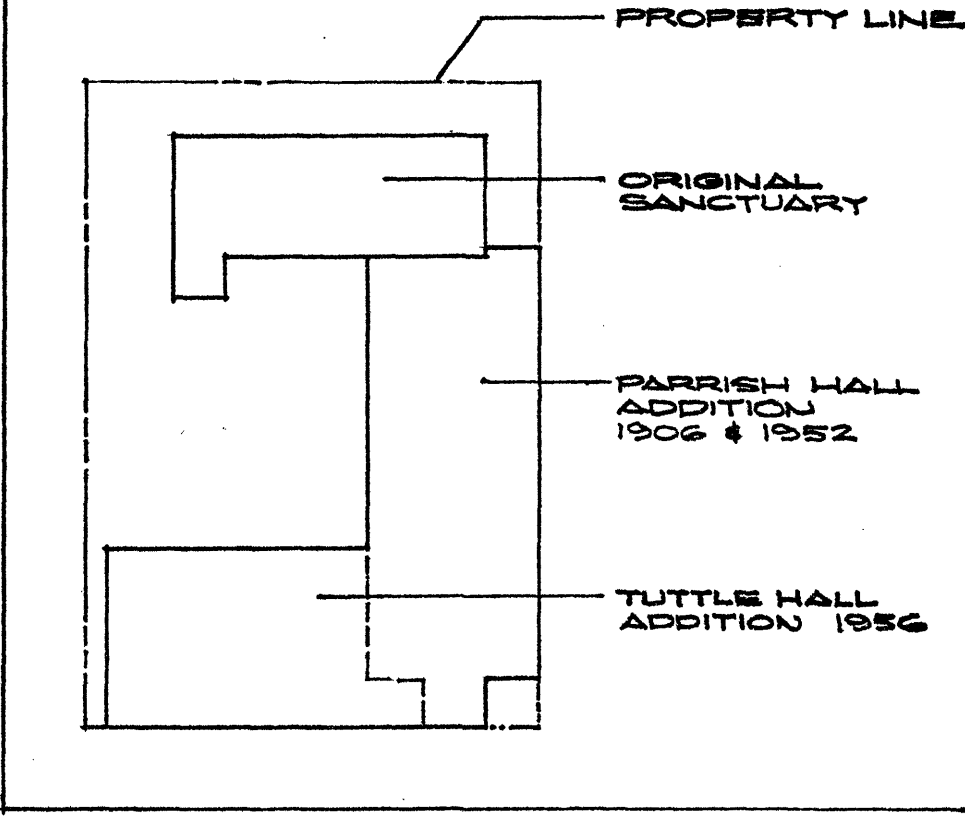

24th STREET

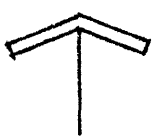

EPISCOPAL CHURCH of the GOOD SHEPHERD
2374 GRANT AVENUE
OGDEN, UTAH
LATITUDE : 41° - 13' - 23"
LONGITUDE : 111° - 58' - 19"
SCALE : 1" = 40'
DATE : JULY 1972

UNITED STATES
DEPARTMENT OF THE INTERIOR
GEOLOGICAL SURVEY

SCALE 1:24000

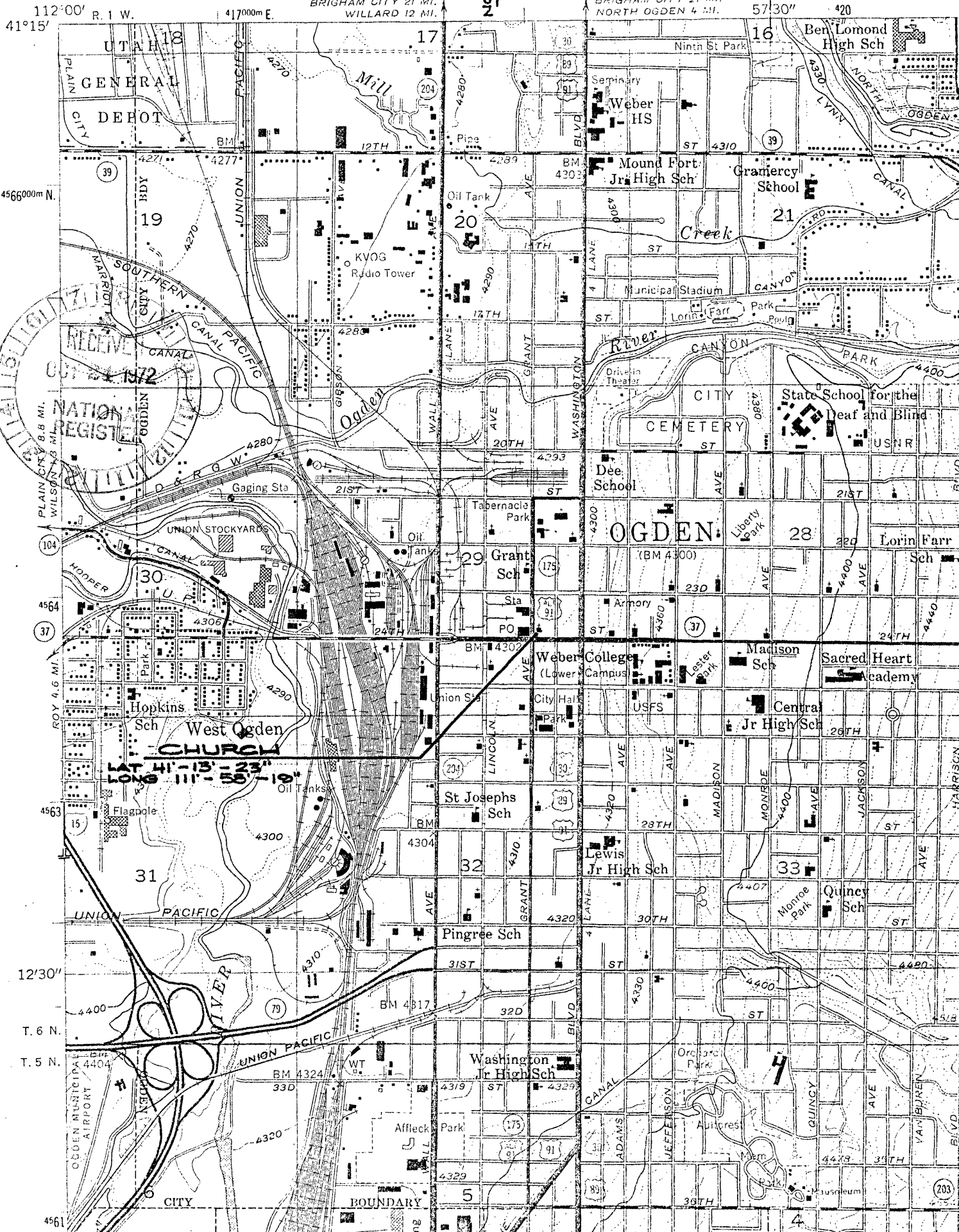

3596 (1:50,000)
(PLAIN CITY)

112°00' R. 1 W. 41°15'
4566000m N.
PLAIN CITY 8.8 MI.
WILSON 1.3 MI.
ROY 4.6 MI.
12°30'
T. 6 N.
T. 5 N.
4561

UTAH 18
GENERAL
DEHOT
17
19
20
21
29
30
31
32
33
BRIGHAM CITY 21 MI.
WILLARD 12 MI.
MILL
KVOG Radio Tower
Gaging Sta
UNION STOCKYARDS
Hopkins Sch
West Ogden
CHURCH
St Josephs Sch
Washington Jr High Sch
Affleck Park
Shopping Center
MARKING

16
17
20
21
28
29
30
31
32
33
BRIGHAM CITY 21 MI.
NORTH OGDEN 4 MI.
57°30' 420
Ninth St Park
Seminary
Weber HS
Mound Fort Jr High Sch
Gramercy School
Municipal Stadium
Lorin Farr Park
CITY CEMETERY
Dee School
OGDEN
Weber College (Lower Campus)
Madison Sch
Sacred Heart Academy
Central Jr High Sch
Lewis Jr High Sch
Quincy Sch
Museum
203