

1674

SEP 15 1989

NATIONAL REGISTER

United States Department of the Interior National Park Service

National Register of Historic Places Registration Form

This form is for use in nominating or requesting determinations of eligibility for individual properties or districts. See instructions in Guidelines for Completing National Register Forms (National Register Bulletin 16). Complete each item by marking "x" in the appropriate box or by entering the requested information. If an item does not apply to the property being documented, enter "N/A" for "not applicable." For functions, styles, materials, and areas of significance, enter only the categories and subcategories listed in the instructions. For additional space use continuation sheets (Form 10-900a). Type all entries.

1. Name of Property

historic name Lake Bemidji State Park CCC/NYA/Rustic Style Historic Resources other names/site number Lake Bemidji State Park

2. Location

street & number off County Highway 20 not for publication N/A city, town Northern Township Bemidji vicinity N/A state Minnesota code MN county Beltrami code 007 zip code 56601

3. Classification

Ownership of Property: private, public-local, public-State, public-Federal. Category of Property: building(s), district, site, structure, object. Number of Resources within Property: Contributing (2), Noncontributing (1 buildings, sites, structures, objects), Total (1).

Name of related multiple property listing: Minnesota State Park CCC/WPA/Rustic Style Historic Resources. Number of contributing resources previously listed in the National Register: 0

4. State/Federal Agency Certification

As the designated authority under the National Historic Preservation Act of 1966, as amended, I hereby certify that this nomination request for determination of eligibility meets the documentation standards for registering properties in the National Register of Historic Places and meets the procedural and professional requirements set forth in 36 CFR Part 60. In my opinion, the property meets does not meet the National Register criteria. See continuation sheet. Signature of certifying official: Nina M. Archabal, State Historic Preservation Officer, Minnesota Historical Society. Date: 9/15/89

In my opinion, the property meets does not meet the National Register criteria. See continuation sheet. Signature of commenting or other official: State or Federal agency and bureau

5. National Park Service Certification

I, hereby, certify that this property is: entered in the National Register. determined eligible for the National Register. determined not eligible for the National Register. removed from the National Register. other, (explain:)

Entered in the National Register

Signature of the Keeper

Date of Action: 10/25/89

Signature of the Keeper

Date of Action

6. Function or Use

Historic Functions (enter categories from instructions)

Recreation/Outdoor Recreation

Landscape/State Park

Current Functions (enter categories from instructions)

Recreation/Outdoor Recreation

Landscape/State Park

7. Description

Architectural Classification

(enter categories from instructions)

Other: NPS Rustic Architecture

Materials (enter categories from instructions)

foundation Stone

walls Log

roof Asphalt

other

Describe present and historic physical appearance.

See Continuation Sheets

United States Department of the Interior
National Park Service

National Register of Historic Places Continuation Sheet

Section number 7 Page 1

DESCRIPTION

Lake Bemidji State Park CCC/NYA/Rustic Style Historic Resources consist of an historic district containing two buildings, one shelter building and one sanitation building, located on the north shore of Lake Bemidji. One non-contributing building is also included. Architects for the buildings were from the Design Office of the Minnesota Division of State Parks although initial studies for the site had been conducted by the Central Design Office of the National Park Service.

The Department of Natural Resources building identification number is located after the name of each building.

Lake Bemidji State Park Historic District

1. Building: Shelter Building 1-248 Builder: NYA
Architect: H. Neilsen & Pfeifer Date: 1938-39

The Shelter Building is a T-shaped structure constructed with peeled logs with saddle-notched corners resting on a stone faced concrete foundation. The main area of the shelter is 44' x 24' with a 12' by 16' projection to the rear for the kitchen. Both sections are covered with intersecting gable roofs. The main entrance features an 8' by 16' porch with a projecting shed roof supported by log posts.

The main shelter area features a massive centrally located split rock fireplace with an 84" split log mantel. The opening is capped by a segmental arch. Bolster logs support a massive truss system also constructed with logs. The kitchen area still retains four original cast iron wood cook stoves which are placed in the rear wall of the fireplace. A 12" recess in the masonry above the stoves is supported by a series of corbels. The building retains its original plank doors and casement windows.

Except for minor changes in execution, the shelter is identical to one built at Lindbergh State Park.

United States Department of the Interior
National Park Service

National Register of Historic Places
Continuation Sheet

Section number 7 Page 2

2. Building: Sanitation Building 1-246 Builder: NYA
Architect: L. Taylor Date: 1937

The Sanitation Building is a rectangular gable roofed structure constructed with peeled logs with saddle-notched corners. The building rests on a concrete foundation faced with stone. Ten inch logs were employed in the construction of the building and the joints were packed with oakum. Window openings are six light casements.

In 1963 the interior was remodeled, skylights were added, and the exterior was painted bungalow brown. The original 6' x 7' log screens shielding the entrances were replaced with vertical boards.

3. Building: Beach House 1-233 Builder: Unknown
Architect: DNR Date: 1975

The Beach House is a rectangular frame structure which incorporates both an enclosed section covered by a series of shed roofs as well as a partially enclosed changing wing. The building replaced an 81' x 31' log constructed Bath House built by the NYA. The present Beach House is non-contributing.

8. Statement of Significance

Certifying official has considered the significance of this property in relation to other properties:

nationally statewide locally

Applicable National Register Criteria A B C D

Criteria Considerations (Exceptions) A B C D E F G

Areas of Significance (enter categories from instructions)

Architecture
Recreation
Government

Period of Significance

1937-39

Significant Dates

1937

Cultural Affiliation

N/A

Significant Person

N/A

Architect/Builder

State of Minnesota
National Youth Administration

State significance of property, and justify criteria, criteria considerations, and areas and periods of significance noted above.

See Continuation Sheets

See continuation sheet

United States Department of the Interior
National Park Service

**National Register of Historic Places
Continuation Sheet**

Section number 8 Page 1

STATEMENT OF SIGNIFICANCE

Lake Bemidji State Park CCC/NYA/Rustic Style Historic Resources are historically significant for their association with the social, political, and economic impact of the Great Depression and the subsequent development of the Federal Relief Programs which were responsible for their construction. The buildings are also historically significant as the only recreational facilities in the state park system which were constructed by the National Youth Administration.* The Shelter Building and the Sanitation Building are architecturally significant as outstanding examples of rustic style log construction typically found in northern Minnesota. The log buildings feature irreplaceable labor intensive methods and finely crafted detailing which received high praise from the National Park Service. These buildings are characterized by nonintrusive and environmentally sensitive designs based on National Park Service design philosophy and master planning.

Lake Bemidji State Park was established in 1923 when the legislature appropriated \$45,000. to purchase the site in order to preserve a remnant of a virgin pine forest and to provide public access to Lake Bemidji. One of the prime movers behind the creation of the park was a Bemidji businessman, Earl Barker. The park land was acquired from lumberman T.B. Walker over a period of time from 1923-36. Walker had originally purchased the land from the U.S. Government in 1883. The initial legislation required the county to maintain the park but this responsibility was eventually transferred to the state.

The C.C.C. camp at Itasca State Park provided limited assistance when development of recreational facilities at the park began. However, building construction was actually undertaken by the National Youth Administration.

* see Part E, page 17

9. Major Bibliographical References

Department of Natural Resources. A Management Plan for Lake Bemidji State Park. St. Paul, Minnesota. 1979.
Department of Natural Resources. Working Drawings and Specifications for Buildings at Lake Bemidji State Park. Bureau of Engineering. St. Paul, Minnesota.
Minnesota Legislative Manual. 1925.

See continuation sheet

Previous documentation on file (NPS):

- preliminary determination of individual listing (36 CFR 67) has been requested
- previously listed in the National Register
- previously determined eligible by the National Register
- designated a National Historic Landmark
- recorded by Historic American Buildings Survey # _____
- recorded by Historic American Engineering Record # _____

Primary location of additional data:

- State historic preservation office
- Other State agency
- Federal agency
- Local government
- University
- Other

Specify repository: _____

10. Geographical Data

Acreeage of property 8 acres

UTM References

A

1	5
---	---

3	6	2	4	3	0
---	---	---	---	---	---

5	2	6	6	0	0	0
---	---	---	---	---	---	---

Zone Easting Northing

C

--	--

--	--	--	--	--	--

--	--	--	--	--	--	--

B

--	--

--	--	--	--	--	--

--	--	--	--	--	--	--

Zone Easting Northing

D

--	--

--	--	--	--	--	--

--	--	--	--	--	--	--

See continuation sheet

Verbal Boundary Description

The boundary for Lake Bemidji State Park CCC/ NYA/Rustic Style Historic Resources is shown as the heavy line on the accompanying map entitled "Lake Bemidji State Park." The boundary is defined by Lake Bemidji to southwest and the park road to the north. The boundary line is crosshatched.

See continuation sheet

Boundary Justification

The boundary includes the buildings that have been historically associated with the property and that maintain historic integrity. The boundary defines the area of the park developed by the CCC and the NYA.

See continuation sheet

11. Form Prepared By

name/title Rolf T. Anderson
organization N/A date August 28, 1988
street & number 3632 Park Avenue South telephone 612-824-7807
city or town Minneapolis state Minnesota zip code 55407

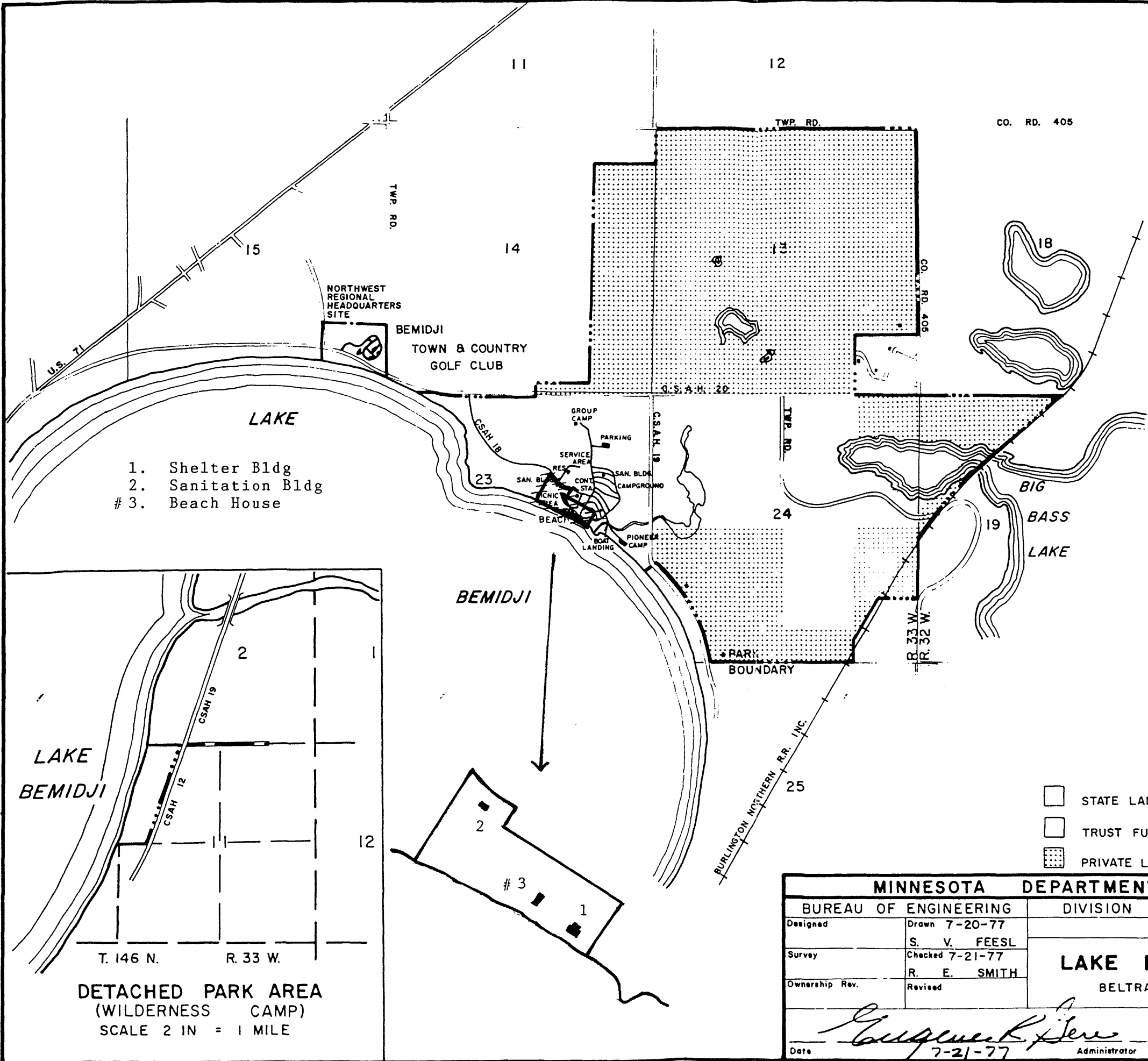
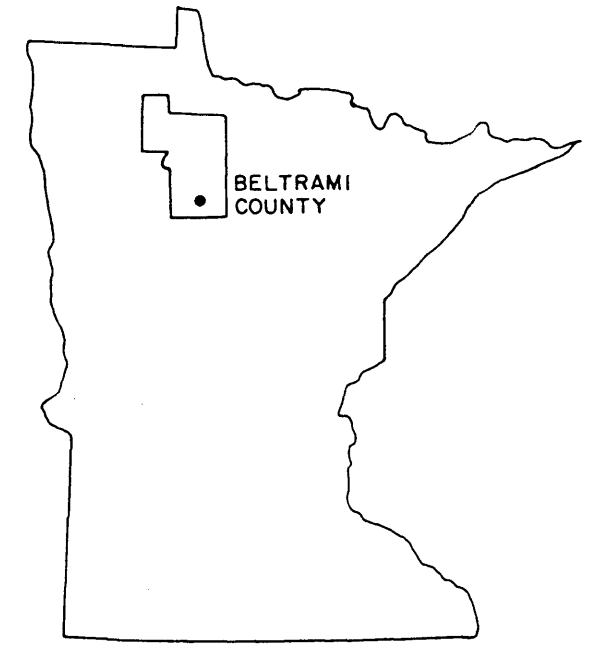

- 1. Shelter Bldg
- 2. Sanitation Bldg
- # 3. Beach House



SCALE : 1" = 2000'
 STATUTORY BOUNDARY 1598 ACRES (APPROX.)

- KEY
- STATE LAND
 - TRUST FUND LAND
 - PRIVATE LAND
 - EXISTING DEVELOPMENT
 - non-contributing

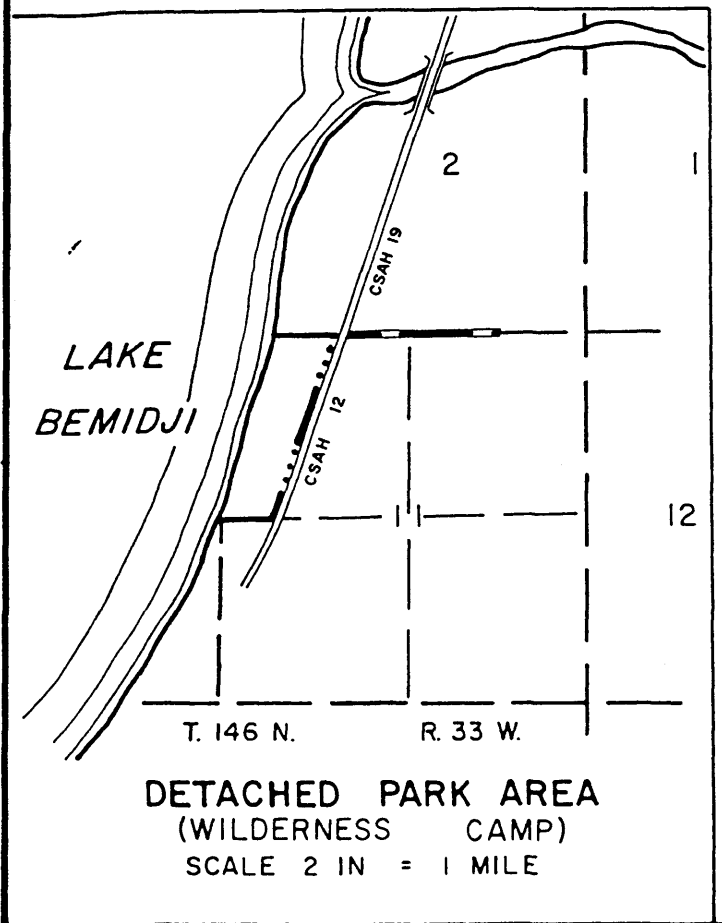

MINNESOTA DEPARTMENT OF NATURAL RESOURCES			
BUREAU OF ENGINEERING		DIVISION OF PARKS AND RECREATION	
Designed	Drawn 7-20-77	STATE PARK SITE	
	S. V. FEESL	LAKE BEMIDJI STATE PARK BELTRAMI COUNTY - NEAR BEMIDJI	
Survey	Checked 7-21-77		
Ownership Rev.	R. E. SMITH		
	Revised	Sec.	T. 146, 147 N. R. 32, 33 W.
 Date 7-21-77 Administrator		Dept. Code	Req.
		300142	77-02
		Sheet	File
		8	P.027.00.01