

RECEIVED

AUG 20 1998

947

NATIONAL REGISTER OF HISTORIC PLACES REGISTRATION FORM

This form is for use in nominating or requesting determinations of eligibility for individual properties or districts. See instructions in "Guidelines for Completing National Register Forms" (National Register Bulletin 16). Complete each item by marking "x" in the appropriate box or by entering the requested information. If an item does not apply to the property being documented, enter "N/A" for "not applicable." For functions, styles, materials, and areas of significance, enter only the categories and subcategories listed in the instructions. For additional space use continuation sheets (Form 10-900a). Type all entries.

1. Name of Property

historic name TROWELL, JOHN W. C., HOUSE
other names/site number TROWELL HOUSE

2. Location

street & number 256 East Cherry St.
city, town JESUP (N/A) vicinity of
county WAYNE code GA 305
state Georgia code GA zip code 31545

(N/A) not for publication

3. Classification

Ownership of Property:

- private
- public-local
- public-state
- public-federal

Category of Property

- building(s)
- district
- site
- structure
- object

Number of Resources within Property:

	<u>Contributing</u>	<u>Noncontributing</u>
buildings	1	0
sites	0	0
structures	0	0
objects	0	0
total	1	0

Contributing resources previously listed in the National Register: 0

Name of related multiple property listing: N/A

4. State/Federal Agency Certification

As the designated authority under the National Historic Preservation Act of 1966, as amended, I hereby certify that this nomination meets the documentation standards for registering properties in the National Register of Historic Places and meets the procedural and professional requirements set forth in 36 CFR Part 60. In my opinion, the property meets the National Register criteria. () See continuation sheet.

Elizabeth A. Lyon
Signature of certifying official

8/2/93
Date

Elizabeth A. Lyon
State Historic Preservation Officer,
Georgia Department of Natural Resources

In my opinion, the property () meets () does not meet the National Register criteria. () See continuation sheet.

Signature of commenting or other official

Date

State or Federal agency or bureau

5. National Park Service Certification

I, hereby, certify that this property is:

entered in the
National Register

entered in the National Register

Delores Byers 9/16/83

determined eligible for the National Register

determined not eligible for the National Register

removed from the National Register

other, explain:

see continuation sheet

for _____
Signature, Keeper of the National Register Date

6. Function or Use

Historic Functions:

DOMESTIC/single dwelling

Current Functions:

DOMESTIC/hotel

7. Description

Architectural Classification:

LATE VICTORIAN/Queen Anne

Materials:

foundation	brick
walls	wood
roof	asphalt shingles
other	N/A

Description of present and historic physical appearance:

The John Trowell House is located on an original residential street in Jesup, a southeast Georgia county seat town. It is located only a block from the Wayne County Courthouse and near several churches. It is a Queen Anne style house built around 1902. It is four bays wide, two stories tall with a third floor attic now a separate suite. It has a multi-gabled roof with clipped gable front, asymmetrical massing, corner octagonal tower with conical roof and a front porch. There are single and paired 2/2 sash windows and some rear additions.

On the exterior, the house has shiplap wood siding except for weatherboarding on the rear addition/west side. The exterior is painted and there is a brick pier foundation. There are three rebuilt corbelled brick chimneys, asphalt shingle roof, and concrete front steps that are flanked with bricks.

Exterior details include decorative wooden shingles at the gable ends and at the top stage of the tower. There are scalloped brackets, square colored glass lights on the edge of the windows in front of gable end/top stage of tower, turned porch posts/balusters, sawn rafter ends (porch), scalloped corner brackets with pendants and ornamented porch posts. There are louvered triangular attic vents, a paneled front door which features a large light in the top half with applied and incised classical ornamentation and elaborately decorated brass door hardware, sidelights and transom.

On the interior, the first floor plan is asymmetrical. The front entrance and hall with the main staircase is on the left as one enters, with two large rooms on the right. One of these has a bay window and was the parlor. At the end of the hall there are two more rooms, one the original dining room and the current kitchen. There is an enclosed porch on east side, a separate rear staircase, and

United States Department of the Interior
National Park Service

National Register of Historic Places
Continuation Sheet

Section 7

restrooms/kitchen at the rear. On the second floor there are four bedrooms each with private bath. The third floor, originally an unfinished attic, is being rehabilitated as a bedroom suite.

The interior includes heart pine used throughout, wood floors (some painted), plaster walls in the original section, and glazed ceramic tile hearths/fireboxes. There are stained or painted doors/windows and surrounds, baseboards, and tongue and groove ceilings.

Interior details include chamfered newel posts, molded door/window surrounds, cornerblocks, 4-paneled doors, wooden mantels (overmantels in parlor/room behind ornamented with classical motifs columns, applied swags/rosettes/bellflowers, egg and dart trim), picture molding, and some decorative hardware.

The house is features balloon frame construction. There are some historical mechanical systems surviving in the house. These include four corner fireplaces used for heat then gas stoves with copper runs, decorative copper inserts, some historic clawfoot tubs, transoms for ventilation, high ceilings (on the first floor - 12 1/2 feet, on the 2nd floor - 10 1/2 feet), old single strand wiring, and an early bathroom (possibly 1st in house) is located under the main staircase on the first floor.

The grounds include informal landscaping around and behind house including dogwoods, azaleas, and one magnolia. There is an unpaved alley to the west, and a paved sidewalk in front of the house paralleling Cherry Street.

There are no surviving outbuildings, although there were several in the past, as shown on 1920 and 1930 Sanborn Insurance maps of Jesup. A 1934 property plat indicates several small structures and a chicken yard behind the main dwelling.

The archaeological potential of the property is unknown except for the sites of former outbuildings referenced above.

The area around the house is a mixed-use residential and office neighborhood, where the majority of structures are historic with some intrusions such as a one-story brick office building to the west of the property, and a historic bungalow (office) on the east side. The house faces Cherry Street with a uniform setback.

Changes to the property include: a 2-story rear addition to southwest corner dating from 1910s-1934; 2nd floor interior conversion of rooms to apartments for boarders including the addition of closets on the first and second floors (c. 1930s/1940s); side porch on

United States Department of the Interior
National Park Service

**National Register of Historic Places
Continuation Sheet**

Section 7

northeast corner enclosed (after 1930, as late as 1950s); kitchen added to southeast corner (ca. 1940s-1960s); open area beneath main staircase/door to side porch covered with sheetrock (ca. 1930s-1950s). The house underwent rehabilitation for use as a bed and breakfast inn in 1990.

8. Statement of Significance

Certifying official has considered the significance of this property in relation to other properties:

nationally statewide locally

Applicable National Register Criteria:

A B C D

Criteria Considerations (Exceptions): N/A

A B C D E F G

Areas of Significance (enter categories from instructions):

ARCHITECTURE

Period of Significance:

1902-1939

Significant Dates:

1902

Significant Person(s):

N/A

Cultural Affiliation:

N/A

Architect(s)/Builder(s):

Unknown

**National Register of Historic Places
Continuation Sheet**

Section 8

Significance of property, justification of criteria, criteria considerations, and areas and periods of significance noted above:

Narrative statement of significance (areas of significance)

The Trowell House is significant under architecture as a good example of the Queen Anne style of architecture. The Queen Anne influence is seen in the asymmetrical layout, the decorative gable shingles, the corner tower, stained-glass patterned lights, and ornamental porch and cornice brackets. The house is a good example of a popular Victorian-era building style used in a small Georgia town during the early 20th century.

National Register Criteria

The Trowell House meets National Register Criterion C because it contains distinctive characteristics of the Queen Anne style of architecture and retains much of the original material associated with its original construction around 1902. The Queen Anne style, prevalent and popular in the late 19th and early 20th century in the U.S., was characterized by asymmetrical massing, a roof with many different levels, often a corner room or turret, and the use of various building materials, such as shingles as well as regular siding. This house embodies all of these elements as well as elaborate porch post brackets and brackets under the eaves. On the interior the house retains its original mantels, including corner mantels, doors, door surrounds, bulls' eye moldings, and original staircase. All of these features make it a good, intact example of a turn-of-the-century house in this style and with this workmanship.

Criteria Considerations (if applicable)

N/A

Period of significance (justification)

The period of significance runs from the construction date of the house (1902) until the death of the owner/builder, Mr. Trowell, in 1939. This period includes the construction of the house and its major historic rear addition.

Contributing/Noncontributing Resources (explanation, if necessary)

There is only one resource on this property, the main house.

National Register of Historic Places
Continuation Sheet

Section 8

Developmental history/historic context (if applicable)

John W. C. Trowell was born in Screven County, Georgia near Sylvania on August 17, 1862. According to census records, the Trowell family moved to Wayne County by 1870. Although nothing is known of J.W.C. Trowell's early years or his education, he married Ella Butler on December 23, 1883. Born June 30, 1864, Ella was the daughter of Reverend W. T. Elias Butler, a pioneer Baptist preacher of Liberty County, and Sara Ann Elizabeth Gibson Butler, a Wayne County native. Census records indicate that the Butler family resided in Wayne County as early as 1860.

J.W.C. Trowell was, from all who remember him, "a man who kept his eyes open and knew what was going on;" a man who could spot an opportunity and seize it; a man who was honest and above board in his dealings involving many enterprises. For example, he was proprietor of Jesup Bottling Works in 1902, believed to have been a Coca-Cola bottling company, and owned interests in a "heading mill" on South Palm Street, which made components for wooden barrels, and in the Jesup Mercantile Company. The largest store in town, Jesup Mercantile consisted of a general store on the first floor with a furniture store upstairs. Trowell is also remembered for running a meat market in a brick building on Walnut Street. At one time, he operated a gasoline powered grist mill on his Walnut Street property (Lot 14), taking a toll in grain from the farmers for grinding, and selling his share to grocers. In addition to his business pursuits, Trowell was appointed Wayne County's tax collector by Governor Allen D. Candler in 1900 and served on the Jesup City Council.

A feint, penciled notation inside the front cover of a household accounts ledger provides the only documentation yet found as to the possible construction date of the J.W.C. Trowell House, one of Jesup's rare surviving examples of Queen Anne architecture. It reads: "Trowell Home [House?] was builded [sic] 1902." Based on the style and construction of the original section of the house, the transactions involving the property, and the Trowell's economic status, this date appears reasonable.

There was considerable interest in the west half of Lot 62, the future site of the Trowell House, as early as 1895 for in the first seven months of that year the property changed hands several times. Attorney John W. Bennett sold the parcel to Mrs. C. E. Fort on February 18, 1895 for \$300, but then bought it back from her for the same amount on July 18, 1895. That same day, Bennett sold the property to M. W. Kicklighter for \$725. Four days later on July 22, 1895, J.W.C. Trowell obtained a Bond for Title from Kicklighter for the

National Register of Historic Places
Continuation Sheet

Section 8

property. According to the agreement, Trowell apparently gave Kicklighter \$500 in cash and promissory notes for \$300 and \$200 to be paid May 1, 1896 and May 1, 1897, respectively. Trowell did not receive fee simple title, however, until October 23, 1900 at which time he paid Kicklighter \$725. The subject property or town lot measured 100 feet wide by 200 feet long and was bounded on the north by Cherry Street, east by the other half of Lot 62, south by a twenty foot lane separating Plum and Cherry streets, and west by a twenty foot lane separating Brunswick and Wayne streets.

In a letter to "Mrs. J.W.C. Trowell, Statesboro, Georgia" dated December 22, 1902, Mr. Trowell wrote from Jesup that he was getting along well at "the Hotell [sic]," which may mean that the house was still under construction. In any event, this letter and another written two days later on Christmas Eve brim with affection, love, and deep solicitude for Mrs. Trowell and her health. Apparently she was in Statesboro recuperating from an illness, either in the care of relatives or in a medical facility.

Trowell addresses her as "my darling baby wife" and refers to himself as "your twiny huby [sic? hubby]" while lamenting spending Christmas apart. Fortunately, Mrs. Trowell recovered and lived for nearly fifty more years, outliving her husband by more than eleven years.

The Trowells were not only devoted to each other, but also to their church. Both were charter members of the Jesup Methodist Church (organized in 1872) and are listed ninth and tenth on the chronological church membership roll. Mr. Trowell served the church in various capacities through the years. In 1895, he was named to a committee to "inquire into the conduct of certain members of the church." He was also on the first roster of stewards in 1907, serving additionally for 1911, 1914, and 1918, and the first roster of trustees in 1911, and for 1918, 1929, and 1936.

Trowell was a delegate to the Methodist district conference in 1908, and participated beginning about 1927 on the church building committee which resulted in construction of the present building completed in 1931. A surviving letter to him from the Starr Piano Company of Birmingham, Alabama dated November 30, 1925 concerned the purchase of a piano for the Sunday School.

Although less is known of Mrs. Trowell's religious activities, she too was recognized as a "pillar of the church." Correspondence indicates, however, that Mrs. Trowell was indeed instrumental in organizing a local Jesup chapter of the Women's Christian Temperance Union in 1887 and served as the group's corresponding secretary. One of Mrs. Trowell's contemporaries is said to have observed that "Mrs.

National Register of Historic Places
Continuation Sheet

Section 8

Trowell, who lived near the church [Jesup Methodist] on the other side of Cherry Street in the many garreted two-story house, was the tallest and stateliest woman I nearly ever saw."

Rufus Roberson of Jesup remembers Mr. Trowell as a "nice old gentleman...much respected.. smart, thrifty, honest -- but not a wealthy man." A 1930 Wayne County High School graduate, Roberson worked at Wilkins' Grocery and enjoyed seeing Mr. Trowell come in because of his good sense of humor. Roberson recalls especially a trick Mr. Trowell loved to demonstrate. Although chunkily built, but not an exceptionally strong man, he could take a 20-penny nail in the palm of his hand, and protecting his hand with a handkerchief, slam the nail into a telephone pole. Mr. Trowell never revealed how this was done, and no one else could duplicate this feat. Roberson further remembers that Mr. Trowell drove a Model T coupe and kept white leghorn chickens in his backyard, selling the eggs to Wilkins' Grocery.

Another source of income for the Trowells came from renting apartments, many to newlyweds, in their home at 256 East Cherry Street. While the year in which they began renting apartments is unknown, Miss Ruby Jones, a Latin teacher for years at Wayne County High School, is believed to have rented from them as early as 1930. Other tenants included Mr. and Mrs. Bill Hendren (1936-1939), Mr. and Mrs. James Bowen (1938-1941), Mr. and Mrs. Troy Highsmith (1937), Mr. and Mrs. Willie Dent, Mr. and Mrs. Vann ("the laundry man"), and Mr. Rufus Roberson's brother and bride. The Trowells also often rented to women whose husbands worked at the WPA camp.

Mrs. Gordon Bishop, widow of the Ordinary, has fond memories of her early married life in the Trowell House. She described the Trowells as "lovely people" who dressed well, arose early, and cared for their tenants, even nursing them when they were ill. Today when she sees actor William Frawley portray "Fred Mertz" in old "I Love Lucy" reruns, she is reminded strongly of J.W.C. Trowell. The Bishops were living downstairs in the apartment with the blue-tiled fireplace and mirrored overmantle in 1937 when their daughter Carolyn was born. The Trowells, who were childless, lived in an upstairs apartment and loved baby Carolyn like their own daughter. Mrs. Bishop noted that while the Trowells had no children, they raised Mr. Trowell's niece, Lucille Bryan (O'Quinn). As an adult, O'Quinn frequently checked on her aunt and uncle, bringing them vegetables from the country. Mrs. Bishop further recalled that the Trowells' home was a pretty house located in a pleasant neighborhood with friendly neighbors, such as Mrs. J.T. Colvin across Cherry Street and Mrs. Norris next door.

Mr. and Mrs. Emory Norris leased the adjacent bungalow from the Trowells for many years, while librarian Mrs. Ada Roberts, also a

National Register of Historic Places
Continuation Sheet

Section 8

long-term tenant, rented a house nearby on Plum Street. As to the Trowell's financial status, Mrs. Bishop observed that "you never knew if they had 5 cents or \$10 million -- they never discussed money. But they wanted for nothing."

Although the Trowells kept meticulous accounts and receipts, there are no records available which document the additions made to the house through the years. The two known historic photographs of the Trowell House show views of the right front of the structure, partially obscured by a foreground tree, with a picket fence around the yard (dated 1919) and the left front showing Mr. and Mrs. Trowell on the east side porch before it was enclosed (undated photograph). Certainly interior remodeling must have taken place to convert rooms to apartments (addition of closets, kitchenettes, bathrooms) in the 1920s, 1930s, and/or 1940s. Physical evidence suggests that a two-story rear addition was made to the southwest corner of the structure, which may have required the removal of a two-story porch and possibly an exterior rear staircase, sometime before 1934. Since a 1934 survey map shows the house in roughly the same configuration as on the 1920 and 1930 Sanborn Fire Insurance maps of Jesup, the addition could actually predate 1920. The dimensions on the 1934 survey roughly correspond to that of the house today except for the addition of a kitchen to the southeast corner which dates anywhere from the 1940s to the 1960s. The side porch on the northeast corner of the structure was enclosed after the 1930 Sanborn map was prepared, possibly as late as the 1950s.

In addition to their residence at 256 East Cherry Street and several rental residential properties previously mentioned, J.W.C. Trowell had other real estate holdings in Jesup as well as Wayne County. Throughout the years, Trowell apparently encountered cash flow problems which caused him to mortgage his residence and his interest in Lot 14. But being an honest man and good provider, he left his wife clear title to both.

J.W.C. Trowell died at home at the age of 77 on November 11, 1939 following "an extended illness due to venerable age and complications." During his final illness there was a sign on the front walk reading "QUIET," but so great was the respect for Mr. Trowell that when the school bus passed his home, the bus driver demanded absolute silence on the bus. Mr. Trowell left all his real and personal property to his wife, directing that if she still owned the homeplace at 256 East Cherry Street upon her death, it should go to his niece, Lucille Bryan O'Quinn. Mrs. Trowell also received \$1,000 plus \$1.06 interest from a life insurance policy her husband had with Phoenix Mutual Insurance of Hartford, Connecticut.

**National Register of Historic Places
Continuation Sheet**

Section 8

During her last years, Mrs. Trowell continued to rent rooms and insured the house annually for \$800 and the brick store building at 151 West Walnut Street (part of Lot 14) for \$600. She sold her portion of Lot 14 to J.B. Graham on July 6, 1944 for \$1,500. Mrs. Trowell also continued to maintain her home in the manner to which she was accustomed.

Mrs. Trowell died February 8, 1951 at the home of her niece, Lucille O'Quinn, who had nursed her during a long illness. Mrs. Trowell was 86 years old. In her obituary, she was recognized for her "outstanding ...church work throughout a long and useful life." According to her late husband's wishes, and "in an effort to compensate ... Lucille Bryan O'Quinn for the many services rendered to me throughout the years and also for her many acts of kindness to me," Mrs. Trowell left her niece the house at 256 East Cherry Street along with all of her other property except several personal items. She bequeathed her silverware and table silver, sewing machine, a large picture of two horses, Mr. Trowell's watch, and her leather suitcase to other family members and possibly friends.

Lucille B. O'Quinn owned and occupied the Trowell House until her death in 1974. She left the property to her son, Waldo O'Quinn, Jr., who lived in the house until 1988. The house remained vacant until Lowell Mallard purchased the property on February 23, 1990 and began a sensitive, historic rehabilitation of the structure for use as a bed-and-breakfast inn and restaurant.

9. Major Bibliographic References

Nail, Robin Brown. "Trowell House", Historic Property Information Form, November 30, 1990. On file at the Office of Historic Preservation, Georgia Department of Natural Resources, Atlanta.

Previous documentation on file (NPS): (X) N/A

- () preliminary determination of individual listing (36 CFR 67) has been requested
- () previously listed in the National Register
- () previously determined eligible by the National Register
- () designated a National Historic Landmark
- () recorded by Historic American Buildings Survey #
- () recorded by Historic American Engineering Record #

Primary location of additional data:

- (X) State historic preservation office
- () Other State Agency
- () Federal agency
- () Local government
- () University
- () Other, Specify Repository:

Georgia Historic Resources Survey Number (if assigned):

10. Geographical Data

Acreage of Property less than one acre.

UTM References

A) Zone 17 Easting 416⁴²⁵ Northing 3496560

Verbal Boundary Description

The nominated property is marked on the enclosed tax map as parcels 8 and 104, a lot that is 200 feet by 50 feet. This is a double city lot, with the 50 foot side facing Cherry Street.

Boundary Justification

The nominated property is all that the owners own at this location and all that remains associated with this house.

11. Form Prepared By

name/title Kenneth H. Thomas, Jr., Historian
organization Office of Historic Preservation, Georgia Department of Natural Resources
street & number 205 Butler Street, S.E., Suite 1462
city or town Atlanta **state** Georgia **zip code** 30334
telephone (404) 656-2840 **date** July 21, 1993

(HPS form version 10-29-91)

United States Department of the Interior
National Park Service

**National Register of Historic Places
Continuation Sheet**

Photographs

Name of Property: Trowell, John W. C., House
City or Vicinity: Jesup
County: Wayne
State: Georgia
Photographer: James R. Lockhart
Negative Filed: Georgia Department of Natural Resources
Date Photographed: March, 1992

Description of Photograph(s):

- 1 of 9: Front facade, photographer facing west.
- 2 of 9: Front facade, photographer facing south.
- 3 of 9: Front facade, close up of front porch and door; photographer facing southwest.
- 4 of 9: Rear and side facades; photographer facing east.
- 5 of 9: Front hall and stair; photographer facing east.
- 6 of 9: Interior, first floor, dining room with corner fireplace east of front room (room with bay window/tower); photographer facing east.
- 7 of 9: Interior, second floor, stair landing in hallway; photographer facing east.
- 8 of 9: Interior, second floor, bedroom looking out at stair landing; photographer facing east.
- 9 of 9: Interior, second floor, bedroom with bay window/tower; photographer facing north.

Baptist Church Parking

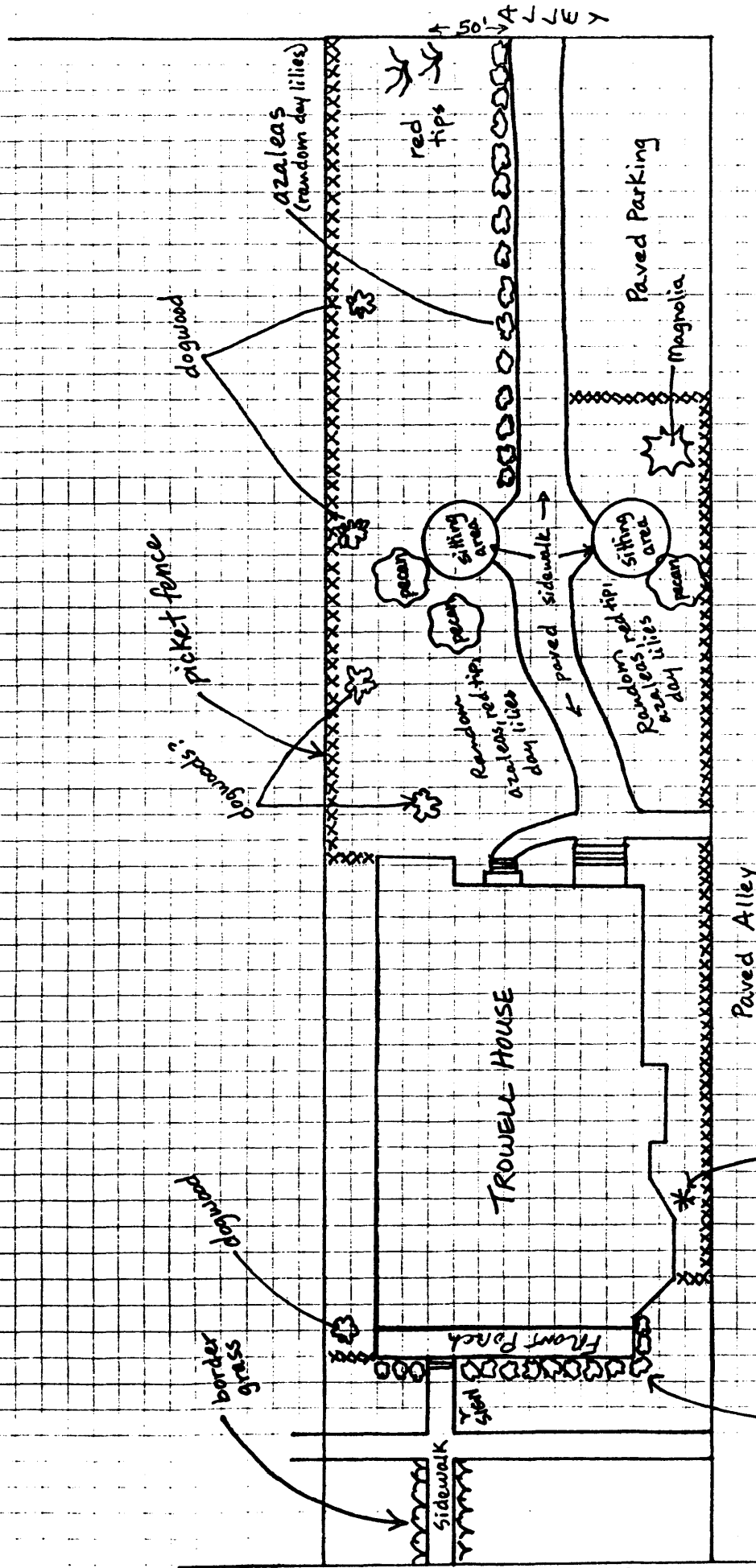

Sketch Map

Trowell, John W. C., House
Jesup, Wayne County, Georgia

Scale: not to scale

Source: drawn by Robin Nail

Date: December 1991

Key: All features are marked directly on the map.

Prepared by RBN, AGSRDC, 12/91

← 200' →

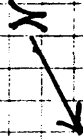

Crepe myrtle

azaleas

TROWELL HOUSE

Paved Alley

Paved Parking

Magnolia

paved sidewalk

Sidewalk

Front Porch

Back Porch

dogwood

azaleas
(random day lilies)

red tips

dogwood

pickket fence

dogwood

dogwood

50' VA

Tax Map/Plat

Trowell, John W. C., House

Jesup, Wayne County, Georgia

Scale: Measurements are drawn on the map.

Source: Wayne County Tax Assessors Office

Date: 1991

Key: The nominated property is marked by a heavy black line and consists of lots number 8 and 104.

100'

20'

STREET

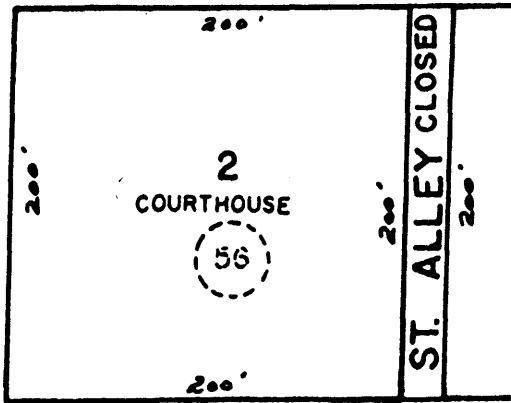

ST

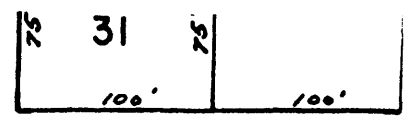

N. BRUNSWICK

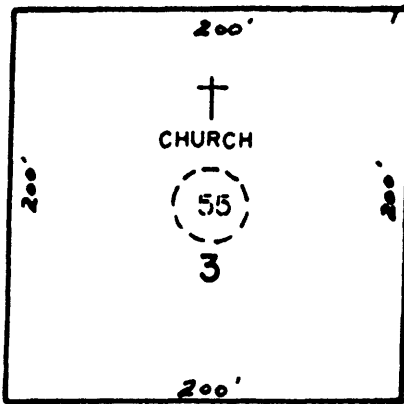

EAST

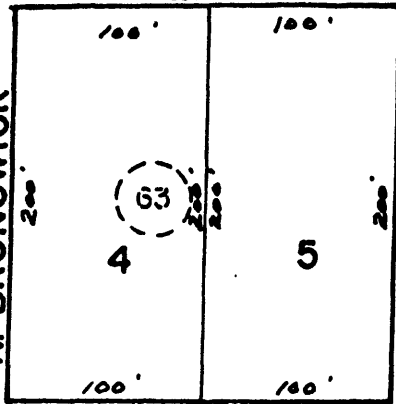

N. WAYNE

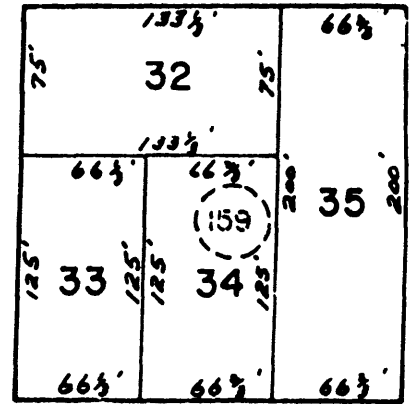

100'

20'

EAST Cherr

STREET

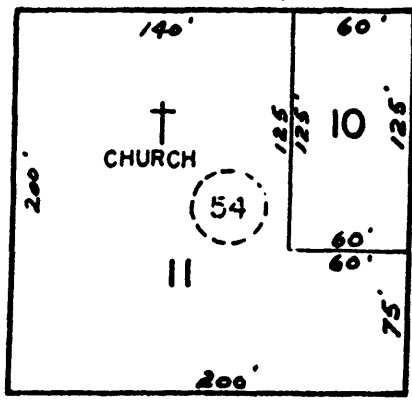

ALLEY

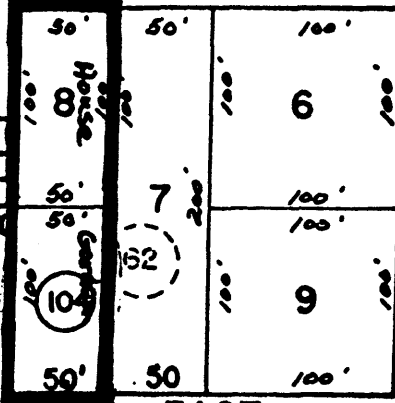

STREET

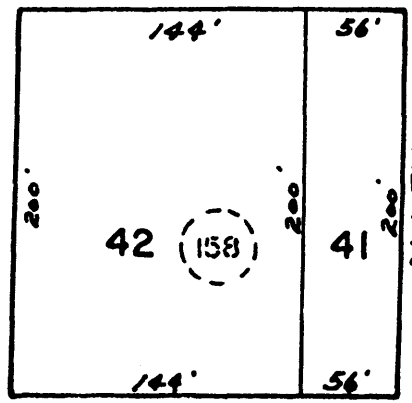

BRUNSWICK

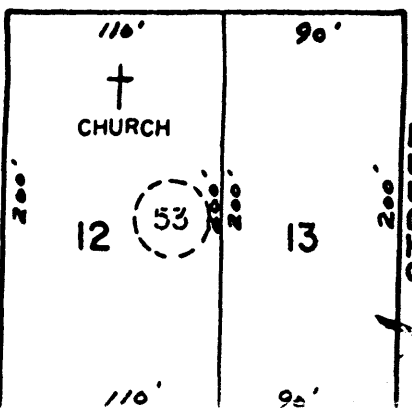

STREET

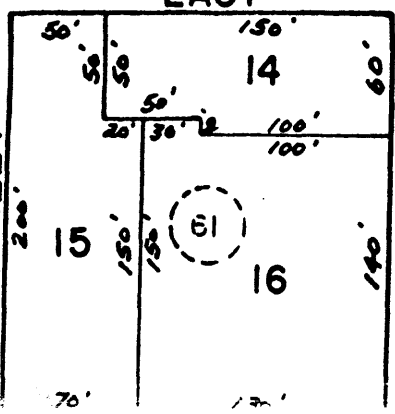

WAYNE

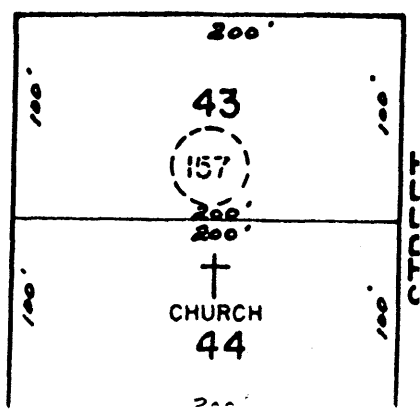

TROWELL HOUSE - 1st Floor "After Rehab"
Updated 11/91

Drawing # 4

Porch FRONT Porch

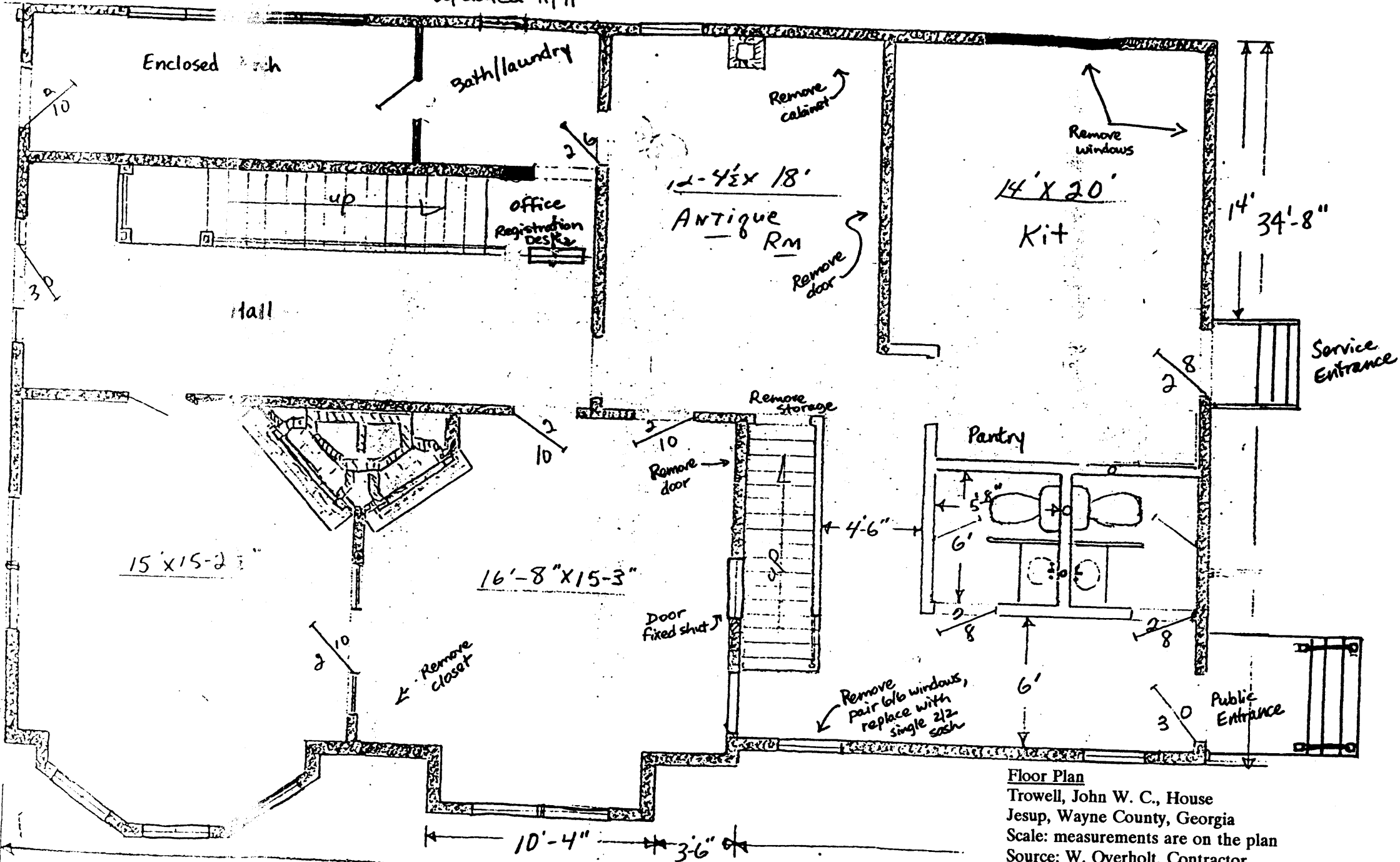

Floor Plan
Trowell, John W. C., House
Jesup, Wayne County, Georgia
Scale: measurements are on the plan
Source: W. Overholt, Contractor
Date: November 1991

Key: Key: All features are marked directly on the plan. This is the floorplan after rehabilitation.

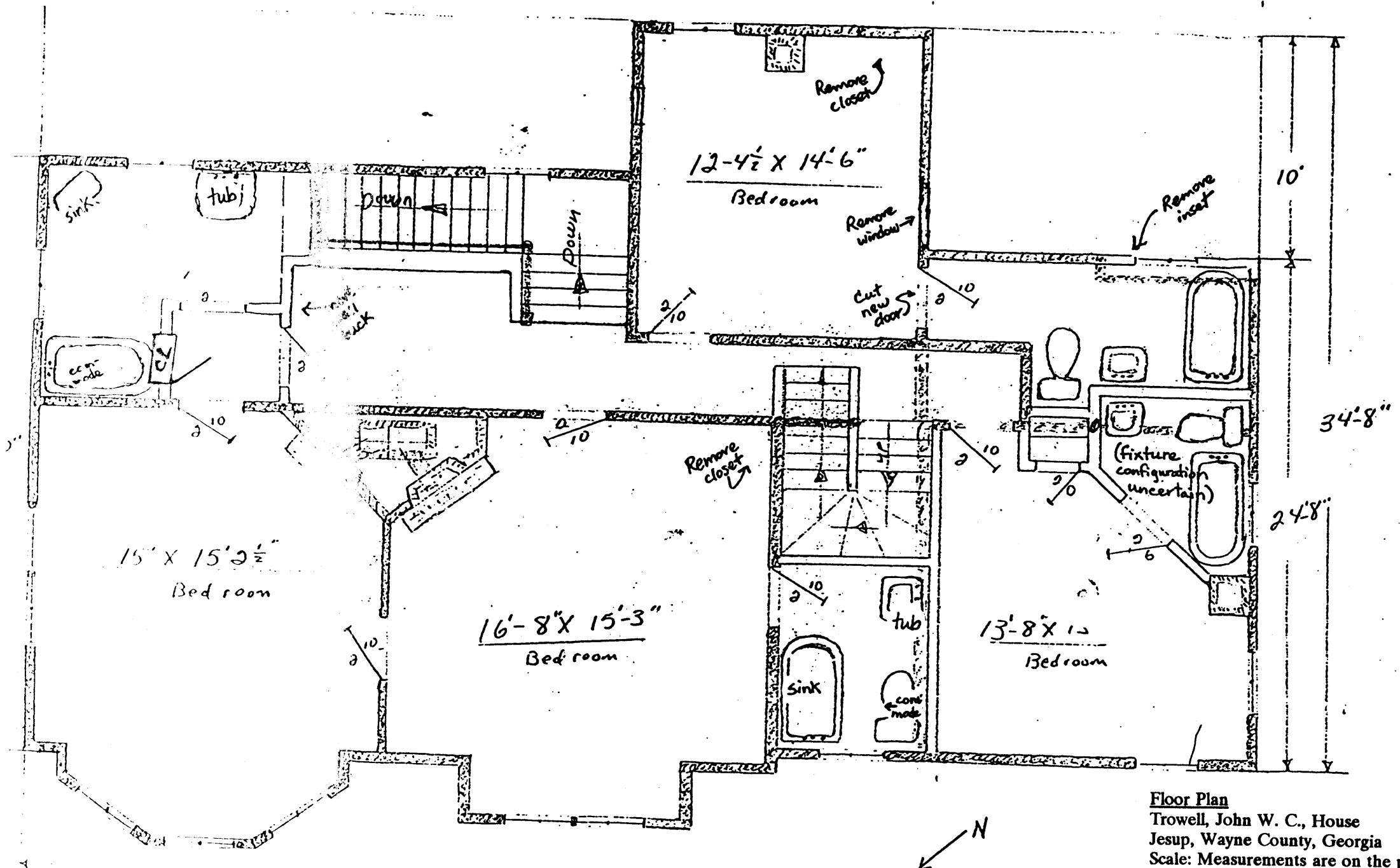

Floor Plan
 Trowell, John W. C., House
 Jesup, Wayne County, Georgia
 Scale: Measurements are on the plan.
 Source: W. Overholt, Contractor
 Date: November 1991
 Key: All features are marked directly on the plan. This is the floorplan after rehabilitation.

Key: Before rehab walls
 New walls