

1275



United States Department of Interior
National Park Service

National Register of Historic Places Registration Form

This form is for use in nominating or requesting determinations for individual properties and districts. See instructions in *How to Complete the National Register of Historic Places Registration Form* (National Register Bulletin 16A). Complete each item by marking "x" in the appropriate box or by entering the information requested. If an item does not apply to the property being documented, enter "N/A" for "not applicable." For functions, architectural classification, materials, and areas of significance, enter only categories and subcategories from the instructions. Place additional entries and narrative items on continuation sheets (NPS Form 10-900A). Use a typewriter, word processor, or computer, to complete all items.

1. Name of Property

historic name	Kimberly Point Park Lighthouse
other names/site number	Kimberly Lighthouse; Neenah Lighthouse

2. Location

street & number	290 Lake Shore Avenue	N/A	not for publication						
city or town	Neenah	N/A	vicinity						
state	Wisconsin	code	WI	county	Winnebago	code	139	zip code	54956

3. State/Federal Agency Certification

As the designated authority under the National Historic Preservation Act, as amended, I hereby certify that this nomination request for determination of eligibility meets the documentation standards for registering properties in the National Register of Historic Places and meets the procedural and professional requirements set forth in 36 CFR Part 60. In my opinion, the property meets, does not meet the National Register criteria. I recommend that this property be considered significant nationally statewide locally. (See continuation sheet for additional comments.)

12/12/12

 Signature of certifying official/Title Date

State Historic Preservation Officer - Wisconsin

State or Federal agency and bureau

In my opinion, the property meets, does not meet the National Register criteria.
(See continuation sheet for additional comments.)

 Signature of commenting official/Title Date

State or Federal agency and bureau

Kimberly Point Park Lighthouse	Winnebago County	Wisconsin
Name of Property	County and State	

4. National Park Service Certification

I hereby certify that the property is:

entered in the National Register.
 ___ See continuation sheet.
 ___ determined eligible for the National Register.
 ___ See continuation sheet.
 ___ determined not eligible for the National Register.
 ___ See continuation sheet.
 ___ removed from the National Register.
 ___ other, (explain:)

Edson H. Beall

2-5-13

[Signature]

Signature of the Keeper

Date of Action

5. Classification

Ownership of Property (check as many boxes as apply)	Category of Property (Check only one box)	Number of Resources within Property (Do not include previously listed resources in the count)	
<input type="checkbox"/> private	<input type="checkbox"/> building(s)	<input type="checkbox"/> contributing	<input type="checkbox"/> noncontributing
<input checked="" type="checkbox"/> public-local	<input type="checkbox"/> district		<input type="checkbox"/> buildings
<input type="checkbox"/> public-State	<input checked="" type="checkbox"/> structure		<input type="checkbox"/> sites
<input type="checkbox"/> public-Federal	<input type="checkbox"/> site	1	<input type="checkbox"/> structures
	<input type="checkbox"/> object		<input type="checkbox"/> objects
		1	0 total

Name of related multiple property listing:
 (Enter "N/A" if property not part of a multiple property listing.)

N/A

Number of contributing resources previously listed in the National Register

0

6. Function or Use

Historic Functions	Current Functions
(Enter categories from instructions)	(Enter categories from instructions)
TRANSPORTATION /water-related	TRANSPORTATION /water-related

7. Description

Architectural Classification	Materials
(Enter categories from instructions)	(Enter categories from instructions)
COLONIAL REVIVAL	foundation Concrete
	walls Brick
	roof Asphalt, Copper
	other Wood

Narrative Description
 (Describe the historic and current condition of the property on one or more continuation sheets.)

United States Department of the Interior
National Park Service

National Register of Historic Places
Continuation Sheet

Section 7 Page 1

Kimberly Point Park Lighthouse
Neenah, Winnebago County, Wisconsin

The Kimberly Point Park Lighthouse is situated on the northern most end of Neenah Point in Kimberly Point Park, about 1.25 mile from the city's central business district. A fully operational lighthouse, the structure abuts the shoreline of Lake Winnebago and overlooks the headwaters of the lower Fox River where it divides into two channels around Doty Island. Neenah sits near the northern tip of Lake Winnebago, the largest lake (approximately 30 by 10 miles in size) entirely within the state and one of the largest inland lakes in the country.

The lighthouse is a one-story eight-sided structure with a central eight-sided tower and two flanking porches projecting from the east and west elevations. The walls are eight feet wide at the base, the overall height is 49 feet, and the two flanking porches are roughly thirteen feet long by twelve feet wide. Constructed in 1945¹ and increased in height by ten feet in 1954², the plan configuration in the main mass is octagonal, with the first floor roof form hipped around the central tower and gabled over the flanking porches. The foundations are poured concrete, the walls are painted brick with a stretcher bond through to the fourth floor level, where the walls are sided in vertical boarding. The roofing materials are asphalt shingles at the first floor level, with the upper most portion of the 3.5-foot lantern roofed in verdigris copper.

The original fenestration was functional and included double hung six-over-six sash on the north and south elevations of the first floor. Four six-paned lights were also located on the tower's southwest and northeast elevations at what would be the second floor level, and on the southeast and northwest elevations of what would be the third floor levels. Due to vandalism in the 1970s, the first floor windows were bricked over and the tower lights replaced with wooden louvered vents. Original multi-paned bull's-eye lights are located on the north, south, east and west elevations of the wooden portion of the tower, or what would be the fourth floor. These are nine light windows placed within raised surrounds with square extensions at the ordinal points. Between them on the northwest, southwest, southeast and northeast elevations are wooden louvered vents. Above them the ten-sided lantern consists of three panes per side, the glazing of which is frosted glass on the sides opposite Lake Winnebago.

Overall, each elevation is identical except for the fenestration as described. Decorative elements are Colonial Period Revival in style. These include paired chamfered post supports located at the four corners of the two flanking east and west porches. These posts support simple gabled roof forms with flush siding on the gable ends. The blank porch frieze wraps around the entire structure, linking the two porches to the body of the lighthouse. Wrought iron railing in a cross buck design around the base of the lantern ornament the tower, as does the sailboat weathervane on top of the lantern. (The date of

¹ Neenah Daily News, Sept. 7, 1945.

² Kimberly Point Park Lighthouse Blueprints, Parks & Recreation Department Collection.

United States Department of the Interior
National Park Service

National Register of Historic Places
Continuation Sheet

Section 7 Page 2

Kimberly Point Park Lighthouse
Neenah, Winnebago County, Wisconsin

the weathervane is unknown.) Features lost with the window alterations include louvered shutters and molded brick sills located on the first floor.

The interior is divided into two public restrooms, accessed from the flanking porches; they have been updated with contemporary fixtures. Glazed block wall tiles of the original construction remain. Access to the tower is through the women's room ceiling, where wooden ladders extend up to a series of platforms to just below the lantern and contemporary lighting mechanism that operates on a timer.

Modifications to date have done little to significantly alter the fundamental architectural integrity of the structure, which over the years has evolved into an icon of the city's identity. Floodlights were attached to the northern side of the lighthouse in 2000 as part of a federally funded enhancement of recreational opportunities for disabled fishermen. Documentation of the lighthouse's appearance prior to the 1954 addition are not known to exist. The 1954 addition of ten feet to the overall height was made to increase the lantern's visibility. Anecdotal evidence indicates that the addition height was achieved through the simple addition of the wood sided portion of the tower, with the original lantern being moved to up to the new top point. No other surrounding park features or incidental landscaping are included in the nomination.

Kimberly Point Park Lighthouse	Winnebago County	Wisconsin
Name of Property	County and State	

8. Statement of Significance

Applicable National Register Criteria
 (Mark "x" in one or more boxes for the criteria qualifying the property for the National Register listing.)

- A Property is associated with events that have made a significant contribution to the broad patterns of our history.
- B Property is associated with the lives of persons significant in our past.
- C Property embodies the distinctive characteristics of a type, period, or method of construction or represents the work of a master, or possesses high artistic values, or represents a significant and distinguishable entity whose components lack individual distinction.
- D Property has yielded, or is likely to yield, information important in prehistory or history.

Criteria Considerations
 (Mark "x" in all the boxes that apply.)

Property is:

- A owned by a religious institution or used for religious purposes.
- B removed from its original location.
- C a birthplace or grave.
- D a cemetery.
- E a reconstructed building, object, or structure.
- F a commemorative property.
- G less than 50 years of age or achieved significance within the past 50 years.

Areas of Significance
 (Enter categories from instructions)

Entertainment/Recreation

Period of Significance
 1945-1964

Significant Dates
 1945

1954

Significant Person
 (Complete if Criterion B is marked)

N/A

Cultural Affiliation

N/A

Architect/Builder

Architect: N/A
 Builder: Fluor Brothers, Oshkosh, WI

United States Department of the Interior
National Park Service

**National Register of Historic Places
Continuation Sheet**

Kimberly Point Park Lighthouse
Neenah, Winnebago County, Wisconsin

Section 8 Page 1

The Kimberly Point Park Lighthouse is of local significance under criterion A for its association with Neenah's history of recreational boating. The period of significance is 1945-1964, beginning with the lighthouse construction and extending to the year that the last Inland Lake Yachting Association (ILYA) regatta took place in Neenah. The 2004 intensive survey of the city of Neenah identified the lighthouse as an individually eligible resource. The lighthouse is the last and one of only two surviving park improvements funded by the city's prominent paper manufacturers.

HISTORICAL BACKGROUND

Neenah began in 1835 as an industrial and agricultural mission for the Menomonee Indians. Its early white settlement, attracted by the waterpower of the Fox River, started a few years later. Developing in the 1850s as an important flour milling center in Wisconsin, Neenah's industrial economy evolved into a nationally prominent center for paper milling in the late 19th century, dominated by Kimberly-Clark Corp. After the turn of the century the local paper industry turned from bulk papers to consumer products, a move that resulted in continued industrial expansion during the 20th century. Kimberly-Clark led the way in this movement through the development of Cellucotton products, while other paper companies continued to provide important industrial commodities such as book and print grade papers.

The economic development of the late 19th and early 20th centuries produced a large number of substantial local fortunes, with which local industrialists built notable residences on East Wisconsin Avenue. In addition to this, several of Menasha's leading industrial figures built homes on East Forest Avenue on Doty Island, giving rise to the generalized distinction that Neenah was a city of mill owners while Menasha was a city of mill workers. While most of these early industrialists spent the majority of their adult lives hard at work, making only limited contributions to public projects, their children proved to be generous contributors to the local quality of life. At the same time, they also made a point of enjoying their leisure through various recreational pursuits, the chief of which was yacht racing on Lake Winnebago.

RECREATION

Yacht racing on Lake Winnebago began around 1859, with the Neenah Yacht Club organizing in 1864. This was followed by the Nodaway Yacht Club in 1893, which merged with the older club in 1905. Throughout this time period boat races on the lake were a notable local attraction during the summer months, drawing excursion steamers from Appleton and Oshkosh. As early as 1903, the Inland Lakes Yachting Association (ILYA), organizer of competitive races throughout the upper Midwest, picked Neenah and Lake Winnebago as a site of their rotating annual regatta, an event that grew to become one of the major Fox Valley sporting and social events of the early and mid-20th century.

United States Department of the Interior
National Park Service

National Register of Historic Places
Continuation Sheet

Section 8 Page 2

Kimberly Point Park Lighthouse
Neenah, Winnebago County, Wisconsin

Neenah's ILYA regattas grew to become particularly significant following World War I, largely through the involvement of top competitive sailors who were also leading industrialists. Chief among these was J. C. Kimberly, William Davis and S. F. Shattuck. Races held in 1923 drew 40 guest yachts and a significant number of yachtsmen from several major metropolitan areas in the Midwest, requiring that campgrounds be established in Riverside Park.³ Special events included programs, dinners and dances at Riverview Country Club in Appleton, and at the Doty Theater, the Equitable Fraternal Union, and Valley Inn hotel in Neenah. The enthusiastic local response earned Neenah a regular berth in the ILYA's rotation, and subsequent regattas were held in 1927 and 1930, and then again in 1935, 1937 and 1938.⁴

This increase in activity encouraged the Neenah-Nodaway Yacht Club to rent the John Stevens mansion in the 500 block of East Wisconsin Avenue for use as a showcase clubhouse in 1937. These and other promotional activities produced a significant increase in ILYA attendance, with numbers reaching 104 participating boats in the 1937 regatta. The following year, newspaper accounts estimated the regatta's cost at \$2,000, reporting that arrangements had been made by such community leaders as Ernst Mahler, Mowry Smith, D. C. Shepard, S. F. Shattuck, Bill Kellett and J. C. Kimberly's son, racing enthusiast and Elkhart Lake racing founder Jimmy Kimberly. Fox Valley newspapers began promoting the event as "Regatta Week," and the U.S. Coast Guard even stepped in to provide patrol boats.⁵

Concurrent with this growth and popularity of yachting was an increase in the number of Neenah parks. Beginning with three municipally acquired and undeveloped parks at the turn of the century, another five were landscaped, improved and donated by prominent industrial families to the community by the outbreak of World War II: Shattuck Park (1915) by Clara Shattuck, Doty Park (1922) by C. B. Clark Jr., Kimberly Point Park (1929) by Helen Kimberly Stuart, Washington Park (1931) by Sarah Hough Bergstrom, and Recreation Park (1940) by C. B. Clark Jr. and S. F. Shattuck.

As the gifts of wealthy patrons, these parks came with elaborate and costly facilities, frequently including those needed for newly popularized and still elite sports. Shattuck Park included a large and distinguished Arts & Crafts boathouse and lagoon. Doty Park featured ornamental bridges, a shelter, tennis courts and an amphitheater for the newly organized Winnebago Players. Recreation Park was outfitted with an Olympic size pool, while Washington Park had a full roster of tennis, ice skating, football, field hockey, and baseball facilities.

³ James C. Kimberly, History of the Neenah-Nodaway Yacht Club (Neenah: Printed privately, 1957), p. 94.

⁴ *Ibid.*, p. 119.

⁵ Appleton Post-Crescent, Sep. 16, 1938.

United States Department of the Interior
National Park Service

**National Register of Historic Places
Continuation Sheet**

Section 8 Page 3

Kimberly Point Park Lighthouse
Neenah, Winnebago County, Wisconsin

Although far more passive recreationally, the development of what became Kimberly Point Park revealed the hostility and divisiveness that existed among Neenah's industrial elite. Beginning as two lots acquired by the city in 1925 for park purposes, additional land was purchased and donated by Helen Kimberly Stuart to prevent a move by Kimberly-Clark president F. J. Sensenbrenner who wanted to acquire the point for a private estate.⁶ Stuart also donated funds towards the park's upkeep, making additional contributions in 1932 to plant and identify specimen trees, and later to widen the driveway, increase parking, and provide picnic tables, stone fireplaces and playground equipment - and even the possibility of including a recreational beach - all under the direction of landscapers Wyman & Uihlein of Milwaukee.⁷ Initially conceived of as "Point Park," it was after Stuart's involvement that it officially became known as Kimberly Point Park.

The enhancement of public parks by the city's industrial leadership, in conjunction with the increased involvement of these leaders in competitive sailing, ultimately led to proposals aimed at addressing the needs of that sport. In spite of a deepening national depression in 1939, the Park and Recreation commission was presented with two new park improvements: meeting rooms for the yacht club on the shoreline of Riverside Park, and a similarly situated navigational lighthouse in Kimberly Point Park, the only one to be ultimately implemented.⁸ In the summer of that year, parks commissioner Charles Madsen informed other commissioners and the city that Stuart and members of the Kimberly family were planning to contribute an estimated \$15,000 towards the construction of a functioning 40-foot tall lighthouse to serve as both an aid to recreational navigation and as a reference point for the ILYA race courses. Preliminary drawings rendered by Madsen (owner of the Twin Cities Monument Works) were of an octagonal lighthouse with a stone first floor and shingled tower. In response the commission expressed its hope that the structure's base could be made large enough to house rest room facilities.⁹

From the outset, development of the lighthouse came under the close scrutiny and approvals of the Department of Commerce, the War Department and the Coast Guard, as a privately owned aid to navigation.¹⁰ Deferred by the outbreak of World War II and a national ban on new construction, the lighthouse remained a personal objective of Stuart's brother, J. C. Kimberly, who for decades had promoted and participated in ILYA regattas. In 1944 he enabled the plans to proceed by donating a sufficient number of shares in Kimberly-Clark to fund the structure, with the city being responsible for providing the electricity and plumbing for the public restrooms. Circumvention of the construction ban was accomplished as part of the U.S. Coast Guard's navigational system, most likely expedited through Kimberly's son Jimmy, who during the war was serving in Washington, D.C. as Lieutenant

⁶ William E. Dunwiddie, *The Parks of Neenah* (Amherst, WI: Palmer Publications Inc., 1993), p. 12.

⁷ Kimberly Point Park Landscaping Blueprints, Park & Recreation Department Collection.

⁸ Neenah Park & Recreation Commission Minutes Book, July 8, 1939, Park & Recreation Department Collection.

⁹ *Oshkosh Daily Northwestern*, Dec. 8, 1939.

¹⁰ Correspondence with the U.S. Department of Commerce dated July 27, 1939, the U.S. War Department dated July 14, 1939, and the U.S. Coast Guard dated Sept. 23, 1954, Park & Recreation Department Collection.

United States Department of the Interior
National Park Service

National Register of Historic Places
Continuation Sheet

Section 8 Page 4

Kimberly Point Park Lighthouse
Neenah, Winnebago County, Wisconsin

Commander of the Coast Guard Auxiliary.¹¹ The following year, within days of the war's official end, construction of the lighthouse was announced and begun by Fluor brothers of Oshkosh. Completed at a cost of \$7,000, an additional 10 feet was added to the structure 1954 to increase the visibility of the lantern.¹²

With the completion of the lighthouse, ILYA regattas returned to Neenah but attendance did not surpass or even match the prewar years. In the years that followed, ILYA regattas continued to decline, with the last one in Neenah taking place in 1964. The lighthouse was operated as an official part of the Coast Guard navigational system, maintaining an official signal pattern and filing periodic reports to meet transportation standards, until the 1990s.¹³ Park features associated with the original gift of Helen Kimberly Stuart, including the park drive, specimen trees and picnic grills, are no longer extant.

In addition to marking the end of the regional yachting competitions in Neenah, the Kimberly Point Park lighthouse marks the end of private industrial wealth enriching the quality of Neenah's public park system. Subsequently created parks were either municipally purchased and developed or the product of a corporate donation. The lighthouse is also distinguished as one of two surviving private gifts to the city parks. At Shattuck Park the 1915 boathouse, lagoon and formal gardens were demolished in 2007. Similarly, the 1940 Olympic-size pool in Recreation Park has also been razed. In Doty Park, the gates, shelter and amphitheater have all been removed and only the distinctive 1922 bridges remain.

A rare survivor of an era of great industrial wealth, the Kimberly Point Park Lighthouse is of local historical significance for its association with Neenah's history of recreational boating, a popular sport in the community. The lighthouse served as an aid to recreational navigation and as a reference point for the ILYA race courses, guiding boats to the entrance to the Fox River where it joins Lake Winnebago.

¹¹ Sarasota Herald-Tribune, April 17, 1944.

¹² Kimberly Point Park Lighthouse Blueprints, Park & Recreation Department Collection.

¹³ Interview with Eileen McCoy, director of parks and recreation, City of Neenah, Oct. 22, 2011.

United States Department of the Interior
National Park Service

National Register of Historic Places

Continuation Sheet

Section 9 Page 1

Kimberly Point Park Lighthouse
Neenah, Winnebago County, Wisconsin

TEXTS

Adams, Peter J. Neenah Historical and Architectural Survey and Nomination Project. Neenah, WI: City of Neenah, 1982.

Crompton, Samuel Willard. The Lighthouse Book. New York: Barnes & Noble Books, 1999.

Dunwiddie, William E. The Parks of Neenah. Amherst, WI: Palmer Publications Inc., 1993.

Glaab, Charles N. and Larsen, Lawrence H. Factories in the Valley. Madison: State Historical Society of Wisconsin, 1969.

Heritage Research, Ltd. Historical/Architectural Resources Survey: 2004 addendum, City of Neenah, Winnebago County. Menomonee Falls, WI: Heritage Research, 2004.

Kimberly, James C. History of the Neenah-Nodaway Yacht Club. Neenah: Printed privately, 1957.

Lawson, P. V. History of Winnebago County. Chicago: Cooper & Co., 1908.

Roberts, Bruce and Jones, Ray. American Lighthouses. Old Saybrook, CT: The Globe Pequot Press, 1998.

Shattuck, S. F. (ed). History of Neenah. Menasha, WI: Printed privately, 1958.

Wardius, Ken and Barb. Wisconsin Lighthouses. Madison: Prairie Oak Press, 2000.

Wyatt, Barbara, ed. Cultural Resource Management in Wisconsin. Madison: State Historical Society of Wisconsin, 1986.

OTHER RESOURCES

Appleton Post Crescent: 12/31/1937, 7/8/1938, 8/20/1938, 9/16/1938, 12/6/1940

Blueprints, Correspondence and Minute Books, Parks & Recreation Department Collection.

Neenah Daily News, 9/7/1945

Oshkosh Daily Northwestern: 7/20/1937, 6/4/1938, 12/8/1939

Sarasota Herald-Tribune, April 17, 1945.

Interview with Eileen McCoy, Director of Parks and Recreation, City of Neenah Oct. 22, 2011.

United States Department of the Interior
National Park Service

National Register of Historic Places
Continuation Sheet

Kimberly Point Park Lighthouse
Neenah, Winnebago County, Wisconsin

Section 10 Page 1

Verbal Boundary Description:

Beginning at a point 20 feet southeast of the southeast corner of the lighthouse, continue northwest to a point 20 feet from the southwest corner, then proceed northeast to a point 20 feet from the northwest corner of the building, continue southeast to a point 20 feet from the northeast corner of the lighthouse, and from there southwest 20 feet to the point of beginning.

Boundary Justification:

The boundary encompasses the building and land that were historically associated with the Kimberly Point Park Lighthouse, and that are in what is part of the platted shoreline public right of way of Lake Shore Avenue, Block C of the Lakeview Addition. It excludes all other features related to the park.

Kimberly Point Park Lighthouse	Winnebago County	Wisconsin
Name of Property	County and State	

Additional Documentation

Submit the following items with the completed form:

Continuation Sheets

Maps A USGS map (7.5 or 15 minute series) indicating the property's location.
 A sketch map for historic districts and properties having large acreage or numerous resources.

Photographs Representative black and white photographs of the property.

Additional Items (Check with the SHPO or FPO for any additional items)

Property Owner

Complete this item at the request of SHPO or FPO.)

name/title		date
organization		telephone
street & number		zip code
city or town	state	

Paperwork Reduction Act Statement: This information is being collected for applications to the National Register of Historic Places to nominate properties for listing or determine eligibility for listing, to list properties, and to amend existing listings. Response to this request is required to obtain a benefit in accordance with the National Historic Preservation Act, as amended (16 U.S.C. 470 *et seq.*).

Estimated Burden Statement: Public reporting burden for this form is estimated to average 18.1 hours per response including time for reviewing instructions, gathering and maintaining data, and completing and reviewing the form. Direct comments regarding this burden estimate or any aspect of this form to the Chief, Administrative Services Division, National Park Service, P.O. Box 37127, Washington, DC 20013-7127; and the Office of Management and Budget, Paperwork Reductions Projects, (1024-0018), Washington, DC 20503.

United States Department of the Interior
National Park Service

National Register of Historic Places
Continuation Sheet

Section Photos Page 1

Kimberly Point Park Lighthouse
Neenah, Winnebago County, Wisconsin

Name of property: Kimberly Point Park Lighthouse

City: Neenah

County: Winnebago County

State: Wisconsin

Photographer: Peter Adams

Date: October 2011

Location of original digital files: 537 E Wisconsin Ave, Neenah, WI 54956

Number of photographs: 6

Photograph 1 of 6:

View from the south of the southern elevations.

Photograph 2 of 6:

View from east of the eastern elevations.

Photograph 3 of 6:

View from the northwest of the western elevations.

Photograph 4 of 6

Detail, lantern and weathervane.

Photograph 5 of 6

Interior, women's restroom

Photograph 6 of 6

Interior, looking up into the lighthouse tower

UNITED STATES DEPARTMENT OF THE INTERIOR
NATIONAL PARK SERVICE

NATIONAL REGISTER OF HISTORIC PLACES
EVALUATION/RETURN SHEET

REQUESTED ACTION: NOMINATION

PROPERTY NAME: Kimberly Point Park Lighthouse

MULTIPLE NAME:

STATE & COUNTY: WISCONSIN, Winnebago

DATE RECEIVED: 12/21/12 DATE OF PENDING LIST:
DATE OF 16TH DAY: DATE OF 45TH DAY: 2/06/13
DATE OF WEEKLY LIST:

REFERENCE NUMBER: 12001275

REASONS FOR REVIEW:

APPEAL: N DATA PROBLEM: N LANDSCAPE: N LESS THAN 50 YEARS: N
OTHER: N PDIL: N PERIOD: N PROGRAM UNAPPROVED: N
REQUEST: N SAMPLE: N SLR DRAFT: N NATIONAL: N

COMMENT WAIVER: N

ACCEPT RETURN REJECT 2-5-13 DATE

ABSTRACT/SUMMARY COMMENTS:

Entered in
The National Register
of
Historic Places

RECOM./CRITERIA _____

REVIEWER _____ DISCIPLINE _____

TELEPHONE _____ DATE _____

DOCUMENTATION see attached comments Y/N see attached SLR Y/N

If a nomination is returned to the nominating authority, the nomination is no longer under consideration by the NPS.



Kimberly Point Park Lighthouse
Neenah, Winnebago Co., WI
Photo 1/6

Walsreens 03392 <> 11/14/11

990400370 ime-5445-0013.jpg 2/12



Kimberly Point Park Lighthouse
Neenah, Winnebago Co., WI
Photo 2/6

W11 screens 03392 <> 11/14/11

990400370 1img_5446_0012.jpg 3/12



Kimberly Point Park Lighthouse
Neenah, Winnebago County, WI
Photo 3/6

Walsreens 03392 < 11/14/11

990400370 1ms_5464_0001.jp9 7/12



Kimberly Point Park Lighthouse
Neenah, Winnebago Co, WI
Photo 4/6

Waterrens 03392 < 11/14/11

990400370 img_5448_0010.jpg 5/12



Kimberly Point Park Lighthouse
Newark, Winnebago Co, WI
Photo 5/6

Walarens 03392 < 11/14/11

990400370 :img_5462_0003.jpg 12/12



Kimberly Point Park Lighthouse
Neenah, Winnebago Co., WI
Photo 6/6

Walgreens 03392 (> 11/14/11

990400370 1ms_5460_0005.jp9 10/12

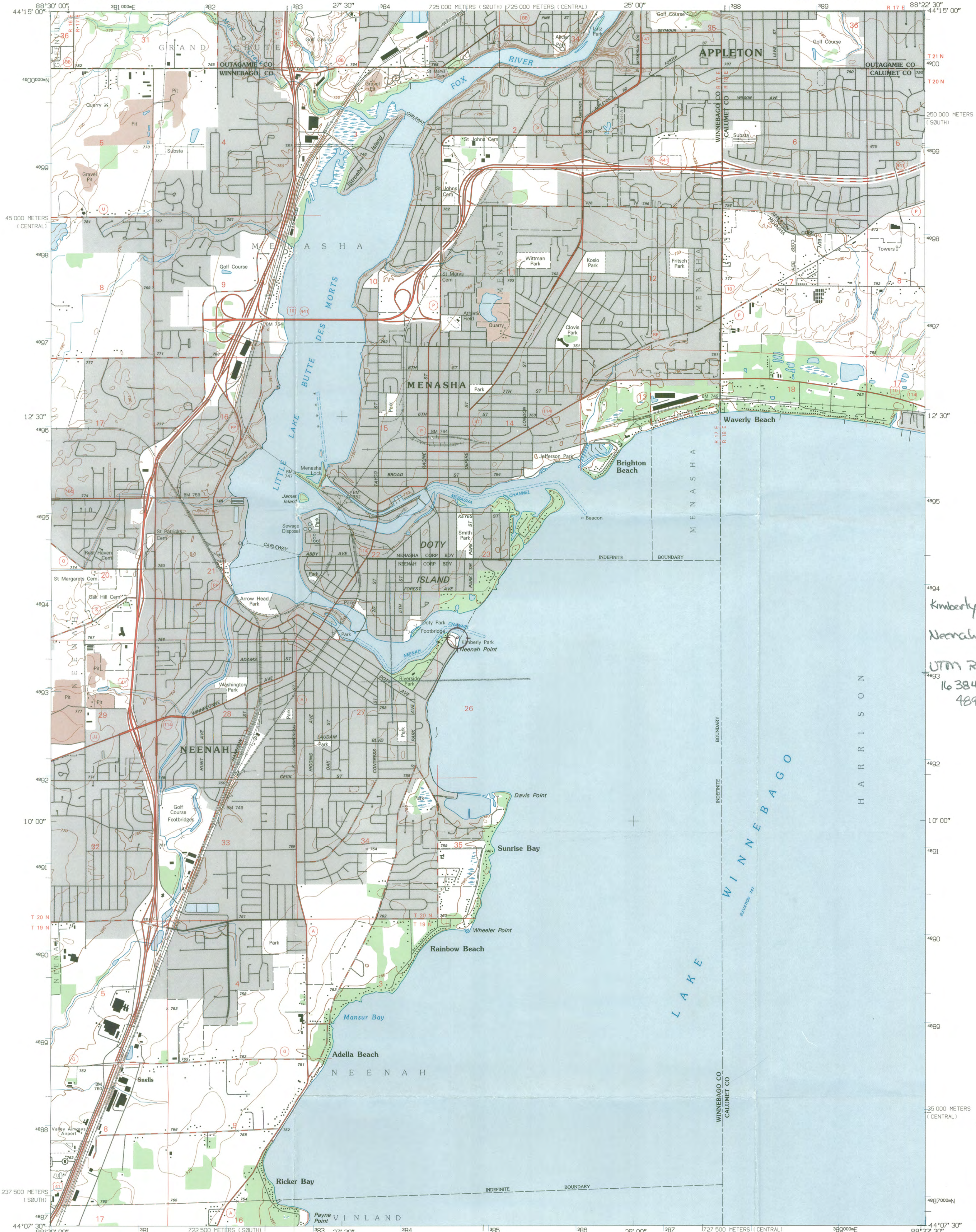

Kimberly Point Park
Lighthouse
Neenah, Winnebago Co.
Wisconsin
UTM References:
16 384773 E
4893490 N

Produced by the United States Geological Survey
Compiled from imagery dated 1953. Revised from imagery dated 1992. PLS and survey control current as of 1995. Contours and elevations current as of 1953. Map edited 1995. North American Datum of 1983 (NAD 83). Projection and blue 1000-meter ticks: Universal Transverse Mercator, zone 16. 2500-meter ticks: Wisconsin Coordinate System of 1983 (south and central zones).
North American Datum of 1927 (NAD 27) is shown by dashed corner ticks. The values of the shift between NAD 83 and NAD 27 for 7.5-minute intersections are obtainable from National Geodetic Survey NADCON software.
There may be private inholdings within the boundaries of the National or State reservations shown on this map.

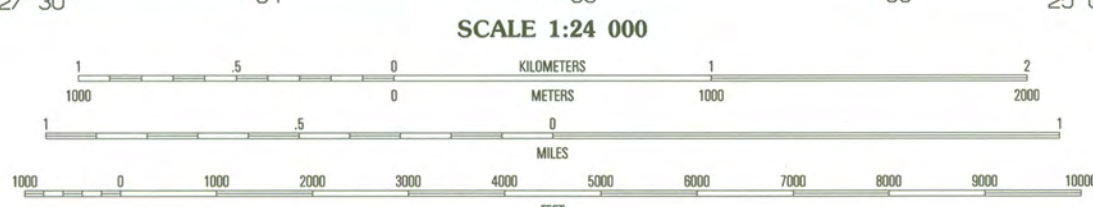
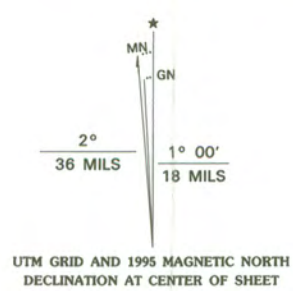

QUADRANGLE LOCATION

1	2	3	1 Greenville
2	3	4	2 Appleton
3	4	5	3 Kaukauna
4	5	6	4 Oshkosh NE
5	6	7	5 Sherwood
6	7	8	6 Oakshosh
			7 Indian Point
			8 Stockbridge

ROAD CLASSIFICATION

Primary highway hard surface	Light-duty road, hard or improved surface
Secondary highway hard surface	Unimproved road
Interstate Route	U.S. Route
	State Route

CONTOUR INTERVAL 10 FEET
NATIONAL GEODETIC VERTICAL DATUM OF 1929
THIS MAP COMPLIES WITH NATIONAL MAP ACCURACY STANDARDS
FOR SALE BY U.S. GEOLOGICAL SURVEY
DENVER, COLORADO 80025, OR RESTON, VIRGINIA 22092
AND WISCONSIN GEOLOGICAL AND NATURAL HISTORY SURVEY, MADISON, WISCONSIN 53706
A FOLDER DESCRIBING TOPOGRAPHIC MAPS AND SYMBOLS IS AVAILABLE ON REQUEST

NEENAH, WI
44088-B4-TF-024
1992

DMA 3372 III NW-SERIES V861



CLARKSON MAP CO.
1233 DELAWARE ST.
PO BOX 218
KAUKAUNA, WI 54130
920-766-3000
WWW.CLARKSONMAP.COM





Department of Community Development
211 Walnut St., P.O. Box 426, Neenah, WI 54957-0426
Phone: 920-886-6125 Fax: 920-886-6129
website/e-mail: www.ci.neenah.wi.us

RECEIVED
FEB 16 2012
DIV HIST PRES

February 14, 2012

Daina Penkiunas
National Register Coordinator
Wisconsin Historical Society
816 State Street
Madison, WI 53706-1482

Dear Ms. Penkiunas:

The City of Neenah is pleased to support the listing of the Kimberly Point Park Lighthouse in the National Register of Historic Places.

The Neenah Landmarks Commission has reviewed the nomination for this property and recommends it as eligible for listing in the National Register.

Please contact me at 886-6128 if there are any questions about this matter.

Sincerely,

Carol M. Kasimor
Assistant Planner



WISCONSIN
HISTORICAL
SOCIETY



TO: Keeper
National Register of Historic Places

FROM: Daina Penkiunas

SUBJECT: National Register Nomination

The following materials are submitted on this 13th day of December 2012,
for nomination of the Kimberly Point Park Lighthouse to the National Register of
Historic Places:

1 Original National Register of Historic Places nomination form

_____ Multiple Property Documentation Form

6 Photograph(s)

1 CD with electronic images

1 Original USGS map(s)

_____ Sketch map(s)/figure(s)/exhibit(s)

1 Piece(s) of correspondence

_____ Other: _____

COMMENTS:

_____ Please insure that this nomination is reviewed

_____ This property has been certified under 36 CFR 67

_____ The enclosed owner objection(s) do _____ do not _____
constitute a majority of property owners.

_____ Other: _____