

United States Department of the Interior
Heritage Conservation and Recreation Service

National Register of Historic Places Inventory—Nomination Form

See instructions in *How to Complete National Register Forms*
Type all entries—complete applicable sections

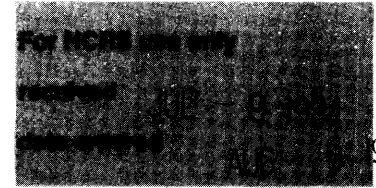

1. Name

historic Linthicum Walks

and/or common Linthicum Walks

2. Location

street & number 2295 Davidsonville Road, n/a not for publication

city, town Crofton, X vicinity of congressional district Fourth

state Maryland code 24 county Anne Arundel code 003

3. Classification

Category	Ownership	Status	Present Use
<input type="checkbox"/> district	<input checked="" type="checkbox"/> public	<input checked="" type="checkbox"/> occupied	<input type="checkbox"/> agriculture
<input checked="" type="checkbox"/> building(s)	<input type="checkbox"/> private	<input type="checkbox"/> unoccupied	<input type="checkbox"/> commercial
<input type="checkbox"/> structure	<input type="checkbox"/> both	<input type="checkbox"/> work in progress	<input type="checkbox"/> educational
<input type="checkbox"/> site	Public Acquisition	Accessible	<input type="checkbox"/> entertainment
<input type="checkbox"/> object	<input type="checkbox"/> in process	<input checked="" type="checkbox"/> yes: restricted	<input type="checkbox"/> government
	<input type="checkbox"/> being considered	<input type="checkbox"/> yes: unrestricted	<input type="checkbox"/> industrial
	<input checked="" type="checkbox"/> not applicable	<input type="checkbox"/> no	<input type="checkbox"/> military
			<input type="checkbox"/> museum
			<input type="checkbox"/> park
			<input checked="" type="checkbox"/> private residence
			<input type="checkbox"/> religious
			<input type="checkbox"/> scientific
			<input type="checkbox"/> transportation
			<input type="checkbox"/> other:

4. Owner of Property

name Anne Arundel County

street & number Arundel Center (P.O. Box 1831)

city, town Annapolis n/a vicinity of state Maryland 21404

5. Location of Legal Description

courthouse, registry of deeds, etc. Anne Arundel County Courthouse

street & number Church Circle

city, town Annapolis state Maryland 21401

6. Representation in Existing Surveys

title Maryland Historical Trust
Historic Sites Inventory

has this property been determined eligible? yes no

date 1980 and 1983 federal state county local

depository for survey records Maryland Historical Trust, 21 State Circle

city, town Annapolis state Maryland 21401

7. Description

AA-188

Condition		Check one	Check one	
<input type="checkbox"/> excellent	<input type="checkbox"/> deteriorated	<input type="checkbox"/> unaltered	<input checked="" type="checkbox"/> original site	Only the tobacco house was moved date <u>c. 1925.</u>
<input checked="" type="checkbox"/> good	<input type="checkbox"/> ruins	<input checked="" type="checkbox"/> altered	<input checked="" type="checkbox"/> moved	
<input type="checkbox"/> fair	<input type="checkbox"/> unexposed			

Describe the present and original (if known) physical appearance

Number of Resources

Contributing	Noncontributing
<u>3</u>	<u>1</u> buildings
<u>1</u>	<u>0</u> sites
<u>0</u>	<u>0</u> structures
<u>0</u>	<u>0</u> objects
<u>4</u>	<u>1</u> Total

Number of previously listed
National Register properties
included in this nomination: 0

Original and historic functions
and uses: agricultural, residential

DESCRIPTION SUMMARY:

Linthicum Walks is situated in western Anne Arundel County, Maryland, near Crofton on the east side of Maryland Route 424 (Davidsonville Road). A frame 19th century dwelling (part of which may be 18th century), a mid-19th century meathouse, a frame pre-1815 tobacco house, and a family cemetery dating to the mid-19th century are located on the 5.19 acre property. The dwelling was constructed in two sections. The original section is frame 1½ stories high, 3 bays wide, and one room deep, with a large exterior stone and brick chimney centered on the north gable wall. A large, c. 1840, frame addition to the south gable consists of a 2½ story, 3 bay house that is two rooms deep, with a pair of exterior brick chimneys on the south gable wall. A 20th century, two-story frame shed addition covers the rear of the c. 1840 section. The house rests on a stone foundation. The walls are covered with early 20th century wooden shingles, and the gable roofs, over both sections, with asphalt shingles. The facade faces west. There are two principal entrances on the facade - one in the south bay of the original section and the other in the north bay of the c. 1840 addition. Windows in the original section are 9/6 sash and 6/6 sash in the addition. The original section has a pair of 6/6 sash pitched roof dormers on the facade and the rear, east elevation. Both sections of the house retain considerable early decorative detail. Interior trim in the original section, including chair rail and architraves, is typical of the Federal period but generally more common circa 1820-1830; the mantels and architraves in the later section are consistent with the period 1830-1850. To the east of the house is a small frame meathouse with a gable roof. A large tobacco house, constructed with hand-hewn and pit-sawn timber, stands northeast of the dwelling and the family cemetery is located to the south. Also on the property is a 20th century concrete block garage which does not contribute to the significance of the resource.

For General Description, see Continuation Sheet No. 1

AA-188

**United States Department of the Interior
National Park Service**

**National Register of Historic Places
Inventory—Nomination Form**

For NPS use only

received

date entered AUG 9 1984

Continuation sheet Linthicum Walks Item number 7 Page 1
Anne Arundel County

GENERAL DESCRIPTION

The dwelling located on Linthicum Walks was constructed in two sections. The original section is 1½ stories and measures 3 bays by 1 bay. The front facade is oriented to the west, toward Davidsonville Road. The door is in the south bay, with two 9/6 windows to the north. The door is constructed with six beaded flush panels. Similar three-panel exterior shutters are fitted on the windows, with modern hinges and Victorian shell-pattern dogs. There is a four-light transom over the door; the architrave trim on the door and both windows is modern. A pair of 6/6 shed roof dormers on the second floor probably date to the c. 1840 addition.

The original cornice is hidden by a modern one-story porch that stretches across the entire facade. The walls are covered with wooden shingles, added c.1925. The rakeboards appear to date from this period as well. The gable roof is covered with asphalt shingles.

The chimney is centered on the north gable wall. The lower shaft is constructed of local iron stone; the upper shaft is brick and is corbeled in two places. The only opening on this wall is a modern trap door to the left of the chimney that is used for wood storage. A modern brick furnace flue has been added at the west end of this wall.

The south bay of the rear, east wall, has been covered by a modern lean-to addition. Original 9/6 windows survive in the center and north bays. There are two 6/6 pitched roof dormers on the second floor, a bulkhead cellar entrance in the center bay of the foundation, and a four-light cellar window in the north bay.

The south gable wall has been completely covered by the c. 1840 addition.

The interior of the original house has been opened up into one large rectangular room on the first floor. Seams in the walls and chair rail indicate that an original board partition formed a stair hall across the south gable wall, leaving a large parlor to the south. The existing stair in the southeast corner of the house appears to be reconstructed in the original stair location. A stone fireplace is centered on the north gable wall with no mantel or other decoration. A simple two-piece chair rail survives throughout most of the first floor. The door and window architrave trim consists of a beaded fascia with a steep ogee/astragal backband, a profile typical of the Federal period, but generally more common circa 1820-1830.

The second floor is divided into two rooms. The fireplace in the north room has been blocked; no early trim survives. The original random width flooring remains intact. There is no access to the roof or eaves.

See Continuation Sheet No. 2

**United States Department of the Interior
National Park Service**

**National Register of Historic Places
Inventory—Nomination Form**

AA-188

For NPS use only

received

date entered

AUG 9 1982

Continuation sheet Linthicum Walks Anne Arundel County, Maryland Item number 7 Page 2

GENERAL DESCRIPTION (continued)

Dating evidence is limited for the original house. The overall form and plan and the presence of wrought iron nails suggests a late 18th or early 19th century date. The interior trim on the first floor is consistent with that period or may have been added circa 1820-1830.

The large-2½ story frame wing was added circa 1840s to the south gable wall of the original house. The front facade projects out about six feet in front of the earlier house, flush with the later one-story porch.

The door is located in the north bay on the first floor, with two 6/6 windows to the south, three 6/6 windows on the second floor, and no dormers on the roof. The front door is a 6-panel door with flattened ogee panel molds typical of circa 1830s to 1850s. There is a three-light transom over the door. All of the architrave trim is 20th century. The siding is modern wood shingle (consistent with the earlier 1½ story section), and the gable roof is covered with asphalt shingles. The box cornice and rakeboards have been rebuilt in this century.

The south gable wall is dominated by a pair of large brick exterior chimneys that shoulder in on the second floor. A single 6/6 window in the center of the upper gable is the only original opening on this wall. An early 20th century door has been cut in to the east of the rear chimney.

A two-story frame addition dating to the early 20th century has completely covered the rear facade.

The majority of the north gable wall is covered by the earlier house. A pair of 6/6 windows in the upper gable are the only openings.

The interior consists of a sidehall across the north gable with two parlors to the south. An open string stair rises against the north wall of the hall to a landing at the rear. A door to the west of the foot of the stair opens into the original house. A door behind the stair, on the north wall, opens into an added bath which has another door into the original house on the east wall at the south end. Original trim includes both parlor mantels and virtually all of the interior architrave trim. This trim is typical of circa 1830-1850.

The second floor plan is similar to the first floor, but with a small chamber partitioned off at the west end of the hall. This room now serves as a bath. An enclosed stair in the bath rises to the third floor. The majority of the original trim remains on the second floor as well.

AA-188

**United States Department of the Interior
National Park Service**

**National Register of Historic Places
Inventory—Nomination Form**

For NPS use only

received

date entered

AUG 9 1984

Continuation sheet Linthicum Walks
Anne Arundel County, MD

Item number 7

Page 3

GENERAL DESCRIPTION (continued)

The third floor has been finished off as one large, plain room, with no early detailing visible. Two trap doors in the ceiling allow access to a narrow crawl space above the collar beams.

In form and plan, this section of the house is typical of the Federal period. The side hall, double parlor plan continued in use in this region well into the mid-19th century, however. The consistent use of fully mature machine-made nails, combined with machine sawn lathing suggests a date of after circa 1840. The trim throughout this section is typical of circa 1830-1850, suggesting a construction date of circa 1840s or early 1850s.

The cellar is reached through a door on the first floor of the c. 1840s addition under the stair. It extends under the early section of the house only. It is not divided by a partition. A pair of seams in the chimney base at the north end suggests a blocked fireplace location; other seams at the south end of the west wall may identify an original bulkhead cellar entrance. Framing evidence in the southeast corner suggests a possible interior cellar stair. Rough boards are nailed to the bottoms of the joists with wrought nails under the first floor hearth at the north end of the cellar.

Outbuildings

To the rear of the house is a small frame meathouse, 12 feet square with a pitched gable roof oriented on a north-south axis. This building appears to date to the mid-19th century and is probably contemporary with the large addition to the original house.

North of the meathouse is a 20th century, concrete-block garage which does not contribute to the significance of the resource.

To the northeast of the house is a large 24 X 40 foot tobacco house with an early addition. The barn is constructed with hand-hewn and pit-sawn timber and secured with wrought nails. The framing, including a tilted false plate, and the use of wrought nails indicate that the tobacco house was constructed before 1815. It was moved from a point further to the northeast in c. 1925. A chain-link fence was recently erected around the tobacco house as a safety measure.

8. Significance

Period	Areas of Significance—Check and justify below			
<input type="checkbox"/> prehistoric	<input type="checkbox"/> archeology-prehistoric	<input type="checkbox"/> community planning	<input type="checkbox"/> landscape architecture	<input type="checkbox"/> religion
<input type="checkbox"/> 1400-1499	<input type="checkbox"/> archeology-historic	<input type="checkbox"/> conservation	<input type="checkbox"/> law	<input type="checkbox"/> science
<input type="checkbox"/> 1500-1599	<input type="checkbox"/> agriculture	<input type="checkbox"/> economics	<input type="checkbox"/> literature	<input type="checkbox"/> sculpture
<input type="checkbox"/> 1600-1699	<input checked="" type="checkbox"/> architecture	<input type="checkbox"/> education	<input type="checkbox"/> military	<input type="checkbox"/> social/ humanitarian
<input checked="" type="checkbox"/> 1700-1799	<input type="checkbox"/> art	<input type="checkbox"/> engineering	<input type="checkbox"/> music	<input type="checkbox"/> theater
<input checked="" type="checkbox"/> 1800-1899	<input type="checkbox"/> commerce	<input type="checkbox"/> exploration/settlement	<input type="checkbox"/> philosophy	<input type="checkbox"/> transportation
<input type="checkbox"/> 1900-	<input type="checkbox"/> communications	<input type="checkbox"/> industry	<input type="checkbox"/> politics/government	<input type="checkbox"/> other (specify)
		<input type="checkbox"/> invention		

Specific dates	Late 18th to mid-19th century	Builder/Architect	unknown
-----------------------	-------------------------------	--------------------------	---------

Statement of Significance (in one paragraph)

Applicable Criteria: C
 Applicable Exceptions: none
 Level of Significance for Evaluation: local

SIGNIFICANCE SUMMARY:

The dwelling and farm buildings at Linthicum Walks are significant for their architecture, embodying the distinctive characteristics of the vernacular architecture of rural Tidewater Maryland of the late 18th through mid 19th centuries. The house, constructed in two periods, comprises a small 1½ story frame building probably constructed in the late 18th or early 19th century, to which a 2½ story, 3-bay, side-passage double-parlor house was added circa 1840. Both phases represent house forms typical of Tidewater Maryland architecture of their respective periods, and retain integrity of design, materials, and workmanship. The outbuildings, including a mid 19th century frame meathouse and a frame tobacco house constructed before 1815, are also significant; few examples of 19th century agricultural buildings survive in Tidewater Maryland (and fewer still in western Anne Arundel County, an area which is rapidly losing its historic rural character to high-density housing development). The tobacco house is especially noteworthy, as one of only three pre-1815 tobacco houses surviving in the county; its construction, incorporating tilted-false-plate roof framing and employing hewn and pitted timbers and wrought nails, exemplifies 18th-century practice, and the building reflects the importance of tobacco culture in the early economy of Anne Arundel County.

9. Major Bibliographical References

AA-188

See Footnotes, Continuation Sheet No. 7

10. Geographical Data

Acreege of nominated property 5.19 acres

Quadrangle name Bowie, Maryland

Quadrangle scale 1:24,000

UMT References

A	<u>1</u> <u>1</u> <u>8</u>	<u>3</u> <u>5</u> <u>5</u> <u>3</u> <u>2</u> <u>0</u>	<u>4</u> <u>3</u> <u>1</u> <u>7</u> <u>7</u> <u>6</u> <u>0</u>
	Zone	Easting	Northing

B			
	Zone	Easting	Northing

C			
	Zone	Easting	Northing

D			
	Zone	Easting	Northing

E			
	Zone	Easting	Northing

F			
	Zone	Easting	Northing

G			
	Zone	Easting	Northing

H			
	Zone	Easting	Northing

Verbal boundary description and justification

For Boundary Description, see Continuation Sheet No. 7

For Boundary Justification, see Continuation Sheet No. 8

List all states and counties for properties overlapping state or county boundaries

state	code	county	code
<u>n/a</u>			

state	code	county	code

11. Form Prepared By

name/title Orlando Ridout V and Joseph and Lynne Brown

Edited by Donna Ware, Contributions made by Kim Kimlin

organization Maryland Historical Trust/

Anne Arundel Co. Planning & Zoning

date February 1984

street & number Arundel Center

telephone (301) 224-1210

city or town Annapolis

state Maryland 21404

12. State Historic Preservation Officer Certification

The evaluated significance of this property within the state is:

national state local

As the designated State Historic Preservation Officer for the National Historic Preservation Act of 1966 (Public Law 89-665), I hereby nominate this property for inclusion in the National Register and certify that it has been evaluated according to the criteria and procedures set forth by the Heritage Conservation and Recreation Service.

State Historic Preservation Officer signature

Mi. A. 7-5-84

title STATE HISTORIC PRESERVATION OFFICER

date

For HCPS use only

I hereby certify that this property is included in the National Register

Entered in the National Register

date

9/1/84

Keeper of the National Register

Attest:

date

Chief of Registration

AA-188

**United States Department of the Interior
National Park Service**

**National Register of Historic Places
Inventory—Nomination Form**

For NPS use only

received

date entered AUG 9 1981

Continuation sheet Linthicum Walks
Anne Arundel County, Maryland Item number 8 Page 4

HISTORY AND SUPPORT

The dwelling at Linthicum Walks was constructed in two separate periods. The original house is a small 1½ story frame structure on a stone foundation. It is typical of a house form widely used in Tidewater Maryland in the latter part of the 18th century and throughout the first half of the 19th century. This particular house exhibits a side passage plan that has been modified by the removal of the first floor partition. Architectural evidence indicates that it was built in the late 18th or early 19th century. However, family tradition places the date of construction earlier, possibly c. 1740 or 1750.²

The earliest documentation of a dwelling on this site appears in the 1786 probate inventory of Edward Edwards' estate. A house is described as having one large room and one small room downstairs, one large bedroom upstairs, and a cellar below. The 1798 Federal Direct Tax recorded that a wooden, one-story dwelling measuring 18 X 24 feet, a meathouse measuring 12 X 12 feet, and a kitchen measuring 12 X 16 feet stood on the property belonging to Cadwallader Edwards. The dimensions of the dwelling do not match the present dimensions of the early section (16½ X 30 feet), giving credence to the later construction date. Neither is the tobacco house mentioned in the 1798 Direct Tax, indicating that it, too, was built later.

The larger section to the south of the original house was probably added circa 1840-1855 by John Linthicum III. It is typical of the 2½ story, side passage double pile house form popular from the last decades of the 18th century until the Civil War. The interior remains almost completely intact.

Also of interest is the small meathouse to the rear of the house, probably constructed circa 1840-1855, and the large pre-1815 tobacco house to the east of the house. The survival rate of 19th century or earlier outbuildings in Tidewater Maryland is low, making the existence of these two structures highly significant. The tobacco house is particularly noteworthy, and was duly recorded in 1981 as part of the Agricultural Buildings Project of the Colonial Williamsburg Foundation.

Of special note is the Linthicum family cemetery spanning 1840-1880, located south of the dwelling. It is believed that other earlier stones may be located close by.

Another interesting aspect of the property is that the driveway leading to the house, which originally extended from Davidsonville Road (Route 424), was once part of the first direct route between Annapolis and Washington, D.C., surveyed in 1805. By 1844, the road was rerouted around Linthicum Walks along what is now Underwood Road.³

**United States Department of the Interior
National Park Service**

**National Register of Historic Places
Inventory—Nomination Form**

For NPS use only

received

date entered

Linthicum Walks

Continuation sheet Anne Arundel County, Maryland Item number

8

Page

5

HISTORY AND SUPPORT (continued)

The original land grants for the property date back to 1672 to Evan Davis, who patented 200 acres of land which he called "Davis His Rest," generally shortened thereafter to Davis' Rest. Davis died three years later. The occupancy of the land is in question until 1699 when Thomas Linthicum, a Welshman who emigrated to Maryland prior to 1658, willed Davis' Rest and an adjoining property, Grey's Addition, to his son Thomas II. In 1701, Thomas II resurveyed these properties and others amounting to 631 acres and renamed the entire tract Linthicum Walks.

In 1724, Thomas II gave 200 acres of this land to his son, Thomas III, probably as a wedding present. Thomas III lived on the land for a quarter of a century, but in 1747 he was ejected from Linthicum Walks because of a legal loophole arising from an unclear title, probably dating back to the 1701 resurvey. Thomas had to mortgage Linthicum Walks in order to pay off the claimant, and when he failed to meet the payments on the mortgage four years later, his creditors sold the property to recover their losses. Thomas signed away the rights to his land to Edward Edwards, a neighboring farmer, and then moved west with his wife and youngest children in 1752.

The 200 acre tract remained in the Edwards family for over half a century. Ironically, the Linthicums regained the property in 1816, after Edward Edwards' son, Cadwallader, defaulted on his debts. Thomas' two brothers, also on Linthicum Walks, were unaffected by Thomas' losses. Edmund and Hezekiah had 429 acres between them, and probably lived comfortably on the lands adjoining Thomas (and later Edward Edwards). Hezekiah's son, John, and his descendants became the dominant family figures associated with Linthicum Walks.

John married Anne Edwards, daughter of Edward Edwards, and lived in an earlier Linthicum house (no longer extant) at the end of Russell Road (between Underwood Road and Route 450). John had an active and interesting life, but most important, in 1816 he managed to reacquire, through purchase, nearly all of the original acreage of Linthicum Walks surveyed for his grandfather over 100 years earlier.

When John died a few years later, his son, John II, probably inherited all of his father's property. Evidently John II had rented the Edwards' property as early as 1810, even before his father purchased it. John II married Elizabeth White and probably sometime thereafter they enlarged the house to its present dimensions to accommodate seven children.

In 1844, John's five children all owned land on or adjacent to Linthicum Walks. They were the last generation of Linthicums to live out their lives at Linthicum Walks. The eldest son, John III, was deeded the house on Linthicum Walks in that year, and his parents died a few years later. In 1860, John III died at the age of 45, leaving his wife Anne and seven children all under the age of 10. Anne died not too long thereafter and the children sold their

**United States Department of the Interior
National Park Service**

**National Register of Historic Places
Inventory—Nomination Form**

For NPS use only	
received	
date entered	AUG 9 1983

Continuation sheet Linthicum Walks Anne Arundel County, Maryland Item number 8 and 10 Page 6

HISTORY AND SUPPORT (continued)

property in 1885, with the house and its family cemetery passing out of the Linthicum family forever.

The condition of the house on Linthicum Walks deteriorated rapidly until 1924, when Mr. and Mrs. Benjamin King purchased it. In 1972, however, the Board of Education condemned the property for use as three school sites. Through the efforts of Anne Arundel Heritage, the Board agreed on August 1, 1979, to preserve the house and cemetery.⁴

Footnotes

- ¹Fieldwork conducted by Orlando Ridout V in 1980.
- ²Interview with Sweetser Linthicum of Linthicum Heights, February 1984.
- ³Letter from Joe Browne to Mary McHenry, October 18, 1983.
- ⁴Most of the preceding text was taken from a manuscript prepared by Joseph L and Lynn M. Browne in 1980.

GEOGRAPHICAL DATA

Verbal Boundary Description

Boundaries are depicted on the attached plat, and described as follows:
 BEGINNING for the same at a point being distant North 21°35'38" East, 1283.66 feet from the beginning of the eighth or North 15°33'18" West, 651.52 foot line of Exhibit "A", of the aforesaid conveyance, and running thence within the lands of the Board of Education of Anne Arundel County, the following nine (9) courses:

1. North 73°21'15" West, 270.00 feet to a point;
2. North 43°26'48" West, 200.60 feet to a point;
3. North 44°07'47" East, 395.67 feet to a point;
4. North 05°34'20" East, 19.31 feet to a point;
5. North 44°07'47" East, 100.00 feet to a point;
6. South 45°12'39" East, 340.92 feet to a point;
7. South 08°00'00" East, 280.00 feet to a point;
8. South 67°00'00" West, 170.00 feet to a point; and
9. South 79°19'39" West, 76.12 feet to the place of beginning, containing 226.174 square feet or 5.1922 acres of land.

AA-188

**United States Department of the Interior
National Park Service**

**National Register of Historic Places
Inventory—Nomination Form**

For NPS use only

received

date entered

AUG 9 1984

Linthicum Walks

Continuation sheet Anne Arundel County, Maryland Item number 10

Page 7

Boundary Justification

The nominated property, 5.19 acres, comprises the house and outbuildings within their immediate setting, and represents the maximum acreage associated with the resource which retains its rural agricultural character. The property surrounding the nominated acreage is currently under development as the site of major new educational facilities and athletic fields. The nominated property represents the maximum acreage which retains its rural agricultural character.

athletic field
 ← APPROXIMATE N.R. BOUNDARY
 (NOT DRAWN TO SCALE)

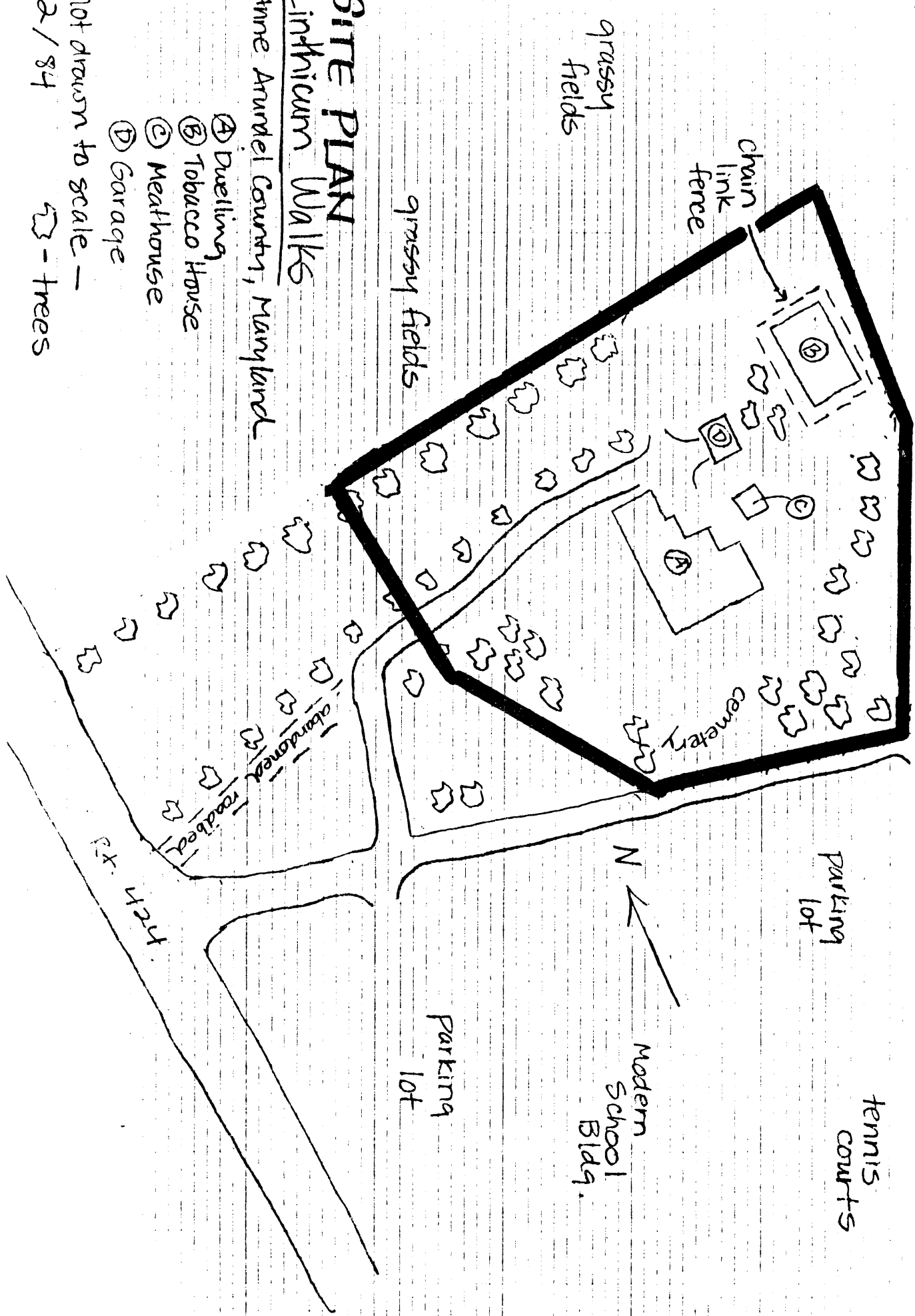

SITE PLAN
Linthicum Walks

Anne Arundel County, Maryland

- Ⓐ Dwelling
- Ⓑ Tobacco House
- Ⓒ Meathouse
- Ⓓ Garage

- Not drawn to scale -
 2/84 ☁ - trees

LINTHICUM WALKS NATIONAL REGISTER
 ANNE ARUNDEL CO., MD. BOUNDARY
 2/84

(a)	N424,742.82	(1)	S80°-0'-0"E	280.00'
(b)	E893,934.95	(2)	S67°-0'-0"W	170.00'
(c)	N424,465.55	(3)	S79°-19'-36"W	72.12'
(d)	E893,973.92	(4)	N73°-21'-15"W	270.00'
(e)	N424,399.13	(5)	N43°-26'-48"W	200.59'
(f)	E893,817.43	(6)	N44°-7'-47"E	395.67'
(g)	N424,395.03	(7)	N50°-33'-38"E	19.31'
(h)	E893,742.63	(8)	N44°-7'-47"E	100.00'
(a)	N424,462.37	(9)	N45°-12'-37"W	340.92'
(f)	E893,483.94	Total Tract... 5.29 Acres		
(g)	N424,608.00			
(h)	E893,346.00			
(a)	N424,892.00			
(b)	E893,621.50			
(c)	N424,911.22			
(d)	E893,623.37			
(e)	N424,893.			
(f)	E893,693.			

