



The William McCredie House
2606 Old Stage Road
Medford, Jackson County, Oregon
Photographer: Kenn Knackstedt
Negative: U.S. Forest Service
Date of Photo: March, 1978
View: North and front elevation

Photograph #1/10

SEP 17 1980

JUL 17 1980



Photograph #2

10

William McCredie House
2606 Old Stage Road
Medford, Jackson County, Oregon
Photographer: Kenn Knackstedt
Negative : U. S. Forest Service
Date of Photo: March, 1978
View: North east view.

JUL 17 1980

SEP 17 1980



Photograph #3/10

The William McCredie House

2606 Old Stage Road

Medford, Jackson County, Oregon

Photographer: Kenn Knackstedt

Negative: U.S. Forest Service

Date of Photo: March, 1978

View: East elevation (and South, rear).

JUL 17 1980

SEP 17 1980



Photograph #4/10

William McCredie House
2606 Old Stage Road
Medford, Jackson County, Oregon
Photographer: Kenn Knackstedt
Negative: U.S. Forest Service
Date of Photo: March, 1978
View: North-west elevations

JUL 17 1980

SEP 17 1980



Photograph #5 / 10

William McCredie House

2606 Old Stage Road

Medford, Jackson County, Oregon

Photographer: Kenn Knackstedt

Negative: U.S. Forest Service

Date of Photo: March, 1978

View: North-elevation (eaves detail)

JUL 17 1980

SEP 17 1980



Photograph #6/10

William McCredie House
2606 Old Stage Road
Medford, Jackson County, Oregon
Photographer: Kenn Knackstedt
Negative: U.S. Forest Service
Date of Photo: March, 1978
View: Detail of Front Door

0861 2 1 700

SEP 17 1980



Photograph #7/10

William McCredie House

2606 South Stage Road

Medford, Jackson County, Oregon

Photographer: Kenn Knackstedt

Negative: U.S. Forest Service

Date of Photo: March, 1978

View: Interior: Newell Post and baluster

JUL 1 1980

SEP 17 1980



Photograph #8 / 10

William McCredie House

2606 South Stage Road

Medford, Jackson County, Oregon

Photographer: Kenn Knackstedt

Negative: U.S. Forest Service

Date of Photo: March, 1978

View: Interior: Doorways Downstairs

086t 2 1 70r
JUL 1 1980

SEP 17 1980



Photograph #9 / 16

William McCredie House

2606 Old Stage Road

Medford, Jackson County, Oregon

Photographer: Kenn Knackstedt

Negative: U.S. Forest Service

Date of Photo: March, 1978

View: Interior: Detail of Window trim and wainscot

0866 2 I 700

SEP 17 1980

SITE PLAN for WILLIAM McCREDIE HOUSE
PRIOR to DEVELOPMENT of
MEDFORD FOREST NURSERY
T37S, R2W, Sec. 16 W.M. JACKSON Co., Ore.

PEAR
ORCHARD

VIEW
TO
MT. McLOUGHLIN
→

FAMILY
GARDEN

CHICKEN
COOP
C. 1980

FUEL
STORAGE
BUILDING
C. 1910

BARN
C. 1910

ROGUE RIVER NATIONAL FOREST, MEDFORD, OREGON
PREPARED by DON ALLEN MARCH 9, 1978, from AIRPHOTO DATED 1976

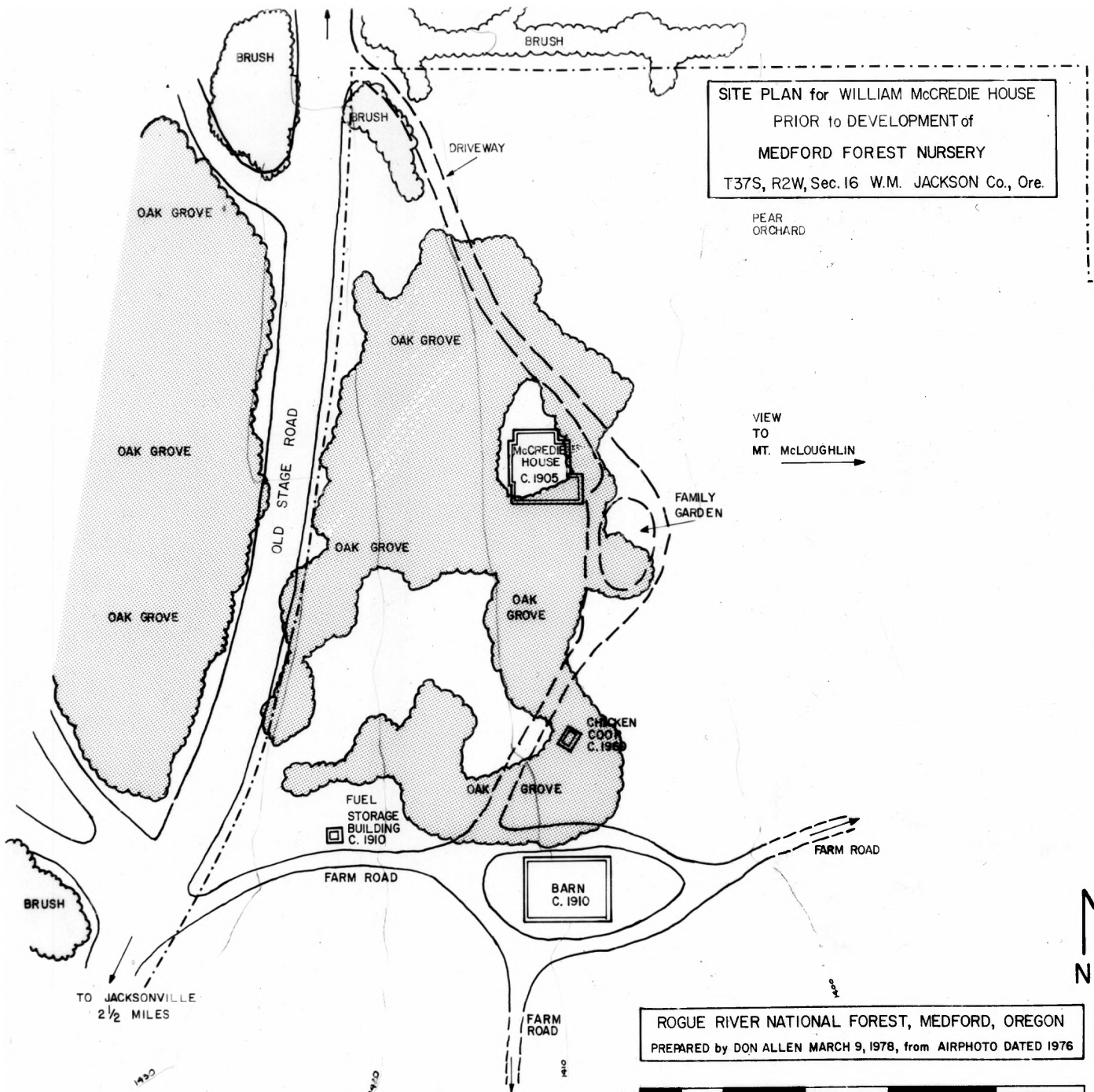
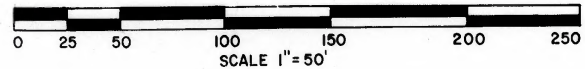

TO JACKSONVILLE
2 1/2 MILES

1930

1940

1950

N

Photograph #10/10

William McCredie House

2606 Old Stage Road

Medford, Jackson County, Oregon

Photographer: Kenn Knackstedt

Negative: U.S. Forest Service

Date of Photo: March, 1978 (from 1976 photo)

View: aerial view of Site Plan for William
McCredie House prior to development of Forest Service
Nursery.

JUL 17 1980

SEP 17 1980



McCredie, William, House
2685 Old Stage Road
Central Point, Jackson County, Oregon

Mark Adams Photo, 1986
2685 Old Stage Road
Central Point OR 97502

1 of 10

Northeast elevation (principal)
facade, showing native oaks which
are common to original and present
sites.

LA/11



McCredie, William, House
2685 Old Stage Road
Central Point, Jackson County, Oregon

Mark Adams Photo, 1986
2685 Old Stage Road
Central Point OR 97502

L 41111

2 of 10

Northeast elevation (principal facade). Brick stove chimney is to be reconstructed around exposed flue.



McCredie, William, House
2685 Old Stage Road
Central Point, Jackson County, Oregon

Mark Adams Photo, 1986
2685 Old Stage Road
Central Point OR 97502

3 of 10
Southeast elevation.

1/21/87



McCredie, William, House
2685 Old Stage Road
Central Point, Jackson County, Oregon

Mark Adams Photo, 1986
2685 Old Stage Road
Central Point OR 97502

4 of 10
Southwest and southeast elevations.

1/2/87



McCredie, William, House
2685 Old Stage Road
Central Point, Jackson County, Oregon

Mark Adams Photo, 1986
2685 Old Stage Road
Central Point OR 97502

5 of 10
Southwest (rear) elevation.

117167



McCredie, William, House
2685 Old Stage Road
Central Point, Jackson County, Oregon

Mark Adams Photo, 1986
2685 Old Stage Road
Central Point OR 97502

6 of 10

Northwest and southwest elevations.

1/21/87



McCredie, William, House
2685 Old Stage Road
Central Point, Jackson County, Oregon

Mark Adams Photo, 1986
2685 Old Stage Road
Central Point OR 97502

7 of 10

Northwest elevation, showing concrete
block foundation, which is to be
finished with stucco to resemble

1767

original concrete perimeter foundation.



FOR NEVER WAS
MORE ONE QUALITY
IN HIS MINDSET
AND SOON
AND HIS MINDSET

McCredie, William, House
2685 Old Stage Road
Central Point, Jackson County, Oregon

Mark Adams Photo, 1986
2685 Old Stage Road
Central Point OR 97502

8 of 10
Staircase viewed from front parlor.

1/21/87



McCredie, William, House
2685 Old Stage Road
Central Point, Jackson County, Oregon

Mark Adams Photo, 1986
2685 Old Stage Road
Central Point OR 97502

9 of 10

Detail of newell post, staircase
between front parlor and kitchen.

11/187



McCredie, William, House
2685 Old Stage Road
Central Point, Jackson County, Oregon

Mark Adams Photo, 1986
2685 Old Stage Road
Central Point OR 97502

10 of 10

Parlor doorway, showing typical door
trim and baseboard molding.