

UNITED STATES DEPARTMENT OF THE INTERIOR
NATIONAL PARK SERVICE

NATIONAL REGISTER OF HISTORIC PLACES
INVENTORY -- NOMINATION FORM

FOR NPS USE ONLY

RECEIVED OCT 14 1975

DATE ENTERED DEC 6 1975

SEE INSTRUCTIONS IN HOW TO COMPLETE NATIONAL REGISTER FORMS
TYPE ALL ENTRIES -- COMPLETE APPLICABLE SECTIONS

1 NAME

HISTORIC Watson-Sawyer House

AND/OR COMMON

2 LOCATION

STREET & NUMBER

502 East Parker

CITY, TOWN

Hamburg

STATE

Arkansas

VICINITY OF

CODE
05

NOT FOR PUBLICATION

CONGRESSIONAL DISTRICT

Fourth

COUNTY

Ashley

CODE

003

3 CLASSIFICATION

CATEGORY

- ☐ DISTRICT
- ☒ BUILDING(S)
- ☐ STRUCTURE
- ☐ SITE
- ☐ OBJECT

OWNERSHIP

- ☐ PUBLIC
- ☒ PRIVATE
- ☐ BOTH

PUBLIC ACQUISITION

- ☐ IN PROCESS
- ☐ BEING CONSIDERED

STATUS

- ☒ OCCUPIED
- ☐ UNOCCUPIED
- ☐ WORK IN PROGRESS

ACCESSIBLE

- ☒ YES: RESTRICTED
- ☐ YES: UNRESTRICTED
- ☐ NO

PRESENT USE

- ☐ AGRICULTURE
- ☐ COMMERICAL
- ☐ EDUCATIONAL
- ☐ ENTERTAINMENT
- ☐ GOVERNMENT
- ☐ INDUSTRIAL
- ☐ MILITARY
- ☐ MUSEUM
- ☐ PARK
- ☒ PRIVATE RESIDENCE
- ☐ RELIGIOUS
- ☐ SCIENTIFIC
- ☐ TRANSPORTATION
- ☐ OTHER:

4 OWNER OF PROPERTY

NAME Mrs. Floie Watson Sawyer

STREET & NUMBER

502 East Parker

CITY, TOWN

Hamburg

VICINITY OF

STATE

Arkansas

5 LOCATION OF LEGAL DESCRIPTION

COURTHOUSE,
REGISTRY OF DEEDS, ETC.

Circuit Clerk's Office

STREET & NUMBER

Ashley County Courthouse

CITY, TOWN

Hamburg

STATE

Arkansas

6 REPRESENTATION IN EXISTING SURVEYS

TITLE

DATE

FEDERAL STATE COUNTY LOCAL

DEPOSITORY FOR
SURVEY RECORDS

CITY, TOWN

STATE

7 DESCRIPTION

CONDITION

☒ EXCELLENT
☐ GOOD
☐ FAIR

☐ DETERIORATED
☐ RUINS
☐ UNEXPOSED

CHECK ONE

☐ UNALTERED
☒ ALTERED

CHECK ONE

☒ ORIGINAL SITE
☐ MOVED DATE _____

DESCRIBE THE PRESENT AND ORIGINAL (IF KNOWN) PHYSICAL APPEARANCE

The Watson-Sawyer House, built in 1870, is a two-storey wooden structure. It is of rectilinear shape and has a gable roof. As to architecture, the house is best described as an eclectic "provincial" style.

The Watson-Sawyer House is symmetrical and well-balanced. The facade features a centered two-storey portico supported by fluted Doric-capital columns. The pediment of the portico features ribbon-like woodwork, which terminates at the drop point of the pediment. Similar ribbon-like wood trim decorates the pediments of the gable ends. Pairs of windows with original shutters flank the portico on both the first and second-storey levels. Simple molding surrounds these windows. In keeping with the balance of the house, exterior-end chimneys project from each gable end. The front entry features double-paneled doors on both first and second-storey levels. These doors are surrounded by sidelights and a multi-light transom.

A wide frieze surrounding the house is marked by paired brackets. These brackets feature drop pendants and give the house a distinctive aura.

The interior plan of the Watson-Sawyer House is organized as a large central hallway with one room on either side. A single flight, one-run stairway of walnut extends from the downstairs hallway to the second-storey. The stairway features turned balusters. Mantles in the two downstairs ~~in the two downstairs~~ parlors are elaborate in design, while those on the second storey are plain. On the first floor the rooms feature paneled wainscot and decorative cornice. The original oak floors remain.

In 1949 a one-storey addition was built onto the rear elevation. In 1961 the original square porch columns were replaced with fluted columns taken from an older house in Hamburg - - an older house which was being razed.

The Watson-Sawyer House radiates an air of southern elegance as it rests on a large piece of land, carefully landscaped. This significant Ashley County structure remains in excellent condition.

8 SIGNIFICANCE

PERIOD		AREAS OF SIGNIFICANCE -- CHECK AND JUSTIFY BELOW			
<input type="checkbox"/> PREHISTORIC	<input type="checkbox"/> ARCHEOLOGY-PREHISTORIC	<input type="checkbox"/> COMMUNITY PLANNING	<input type="checkbox"/> LANDSCAPE ARCHITECTURE	<input type="checkbox"/> RELIGION	
<input type="checkbox"/> 1400-1499	<input type="checkbox"/> ARCHEOLOGY-HISTORIC	<input type="checkbox"/> CONSERVATION	<input type="checkbox"/> LAW	<input type="checkbox"/> SCIENCE	
<input type="checkbox"/> 1500-1599	<input type="checkbox"/> AGRICULTURE	<input type="checkbox"/> ECONOMICS	<input type="checkbox"/> LITERATURE	<input type="checkbox"/> SCULPTURE	
<input type="checkbox"/> 1600-1699	<input checked="" type="checkbox"/> ARCHITECTURE	<input type="checkbox"/> EDUCATION	<input type="checkbox"/> MILITARY	<input type="checkbox"/> SOCIAL/HUMANITARIAN	
<input type="checkbox"/> 1700-1799	<input type="checkbox"/> ART	<input type="checkbox"/> ENGINEERING	<input type="checkbox"/> MUSIC	<input type="checkbox"/> THEATER	
<input checked="" type="checkbox"/> 1800-1899	<input type="checkbox"/> COMMERCE	<input checked="" type="checkbox"/> EXPLORATION/SETTLEMENT	<input type="checkbox"/> PHILOSOPHY	<input type="checkbox"/> TRANSPORTATION	
<input type="checkbox"/> 1900-	<input type="checkbox"/> COMMUNICATIONS	<input type="checkbox"/> INDUSTRY	<input type="checkbox"/> POLITICS/GOVERNMENT	<input type="checkbox"/> OTHER (SPECIFY)	
		<input type="checkbox"/> INVENTION			

SPECIFIC DATES 1870 BUILDER/ARCHITECT E. D. Watson

STATEMENT OF SIGNIFICANCE

Located in the southeastern Arkansas town of Hamburg, the Watson-Sawyer House rests on a tree-shaded lot near the downtown area. Built in 1870, the house is constructed entirely of oak. The primary significance of the Watson-Sawyer House lies in its architecture, which is best characterized as "provincial" style. The two-storey structure is symmetrical and well-balanced, with its center portico flanked by pairs of windows on either side and paired decorative brackets on the cornice. The role the Watson family has played in the area also lends significance to the house. As one of the early settlers in Hamburg, E. D. Watson played an important role in the development of the community.

E. D. Watson and his wife, Sarah, started west from South Carolina in the early 1860's in a covered wagon. They stopped in Tennessee for the birth of their first child, then moved on to Ashley County, Arkansas. The Watsons decided that the southern Arkansas area was where they would settle. Watson opened a hardware store and in 1865 bought 160 acres from J. C. Waddell. Close to the town of Hamburg where his business was located, the newly acquired land afforded Watson a sense of establishment. He built a three-room house on the land shortly after its purchase. By 1870, the Watson family had grown to seventeen and the Watson Hardware business had prospered. In that year Watson built for his large family an impressive two-storey structure; it was very near the three-room house which Watson's family had outgrown. The new addition became known as one of the finest structures in Ashley County.

The Watson-Sawyer House has never been out of the Watson family. It is now owned and occupied by a granddaughter of E. D. Watson. Undoubtedly this background of ownership and occupancy has contributed to the house being in such an excellent state of preservation today.

9 MAJOR BIBLIOGRAPHICAL REFERENCES

Arkansas Gazette. August 2, 1954.

Crossett News Observer. October 2, 1969.

Sawyer, Floie Watson. Personal interview at Watson-Sawyer House, Hamburg, Arkansas, August 18, 1975.

Veazey, Ann Etheridge, Family Bible Records of Ashley County, Arkansas. Hamburg, Arkansas, March 24, 1967, Vol.2.

10 GEOGRAPHICAL DATA

ACREAGE OF NOMINATED PROPERTY less than one acre

UTM REFERENCES

UTM 08-WNW
12-22-75

A	1,5	6,1,2,4,4,0	3,6,7,6,5,3,0	B					
	ZONE	EASTING	NORTHING		ZONE	EASTING	NORTHING		
C				D					

VERBAL BOUNDARY DESCRIPTION

LIST ALL STATES AND COUNTIES FOR PROPERTIES OVERLAPPING STATE OR COUNTY BOUNDARIES

STATE	CODE	COUNTY	CODE
STATE	CODE	COUNTY	CODE

11 FORM PREPARED BY

NAME / TITLE

Sandra Taylor, Historian

ORGANIZATION

Arkansas Historic Preservation Program

DATE

September 9, 1975

STREET & NUMBER

300 West Markham

TELEPHONE

501-371-1639

CITY OR TOWN

Little Rock

STATE

Arkansas

12 STATE HISTORIC PRESERVATION OFFICER CERTIFICATION

THE EVALUATED SIGNIFICANCE OF THIS PROPERTY WITHIN THE STATE IS:

NATIONAL ☐

STATE ☒

LOCAL ☐

As the designated State Historic Preservation Officer for the National Historic Preservation Act of 1966 (Public Law 89-665), I hereby nominate this property for inclusion in the National Register and certify that it has been evaluated according to the criteria and procedures set forth by the National Park Service.

STATE HISTORIC PRESERVATION OFFICER SIGNATURE *Gene Richardson*

TITLE State Historic Preservation Officer

DATE September 9, 1975

FOR NPS USE ONLY

I HEREBY CERTIFY THAT THIS PROPERTY IS INCLUDED IN THE NATIONAL REGISTER

Acting

DIRECTOR, OFFICE OF ARCHEOLOGY AND HISTORIC PRESERVATION

ATTEST:

KEEPER OF THE NATIONAL REGISTER

DATE

12/6/91

DATE

11. 28.75

Property Watson - Sawyer House

75000375
Ashley Co.

State Arkansas

Working Number 10.14.75.1812

TECHNICAL

Photos 3
Maps 1

CONTROL

OK 10.20.75

HISTORIAN

Accept
E. Smith
11-18-75

ARCHITECTURAL HISTORIAN

Accept
L.W. Moll 11/24/75
ARCHEOLOGIST

OTHER

HAER

Inventory _____
Review _____

REVIEW UNIT CHIEF

Accept
Colz
11-26-75

BRANCH CHIEF

KEEPER

Accept
H. M. ...
11-26-75

National Register Write-up _____
Federal Register Entry 3-2-76

Send-back _____
Re-submit _____

Entered DEC 6 1975

INT:2106-74



1. WATSON-SAWYER HOUSE
ASHLEY COUNTY, ARKANSAS
FACADE AND EAST ELEVATION, VIEWED FROM THE NORTHEAST

7

Form No. 10-301a
(Rev. 10-74)

UNITED STATES DEPARTMENT OF THE INTERIOR
NATIONAL PARK SERVICE

NATIONAL REGISTER OF HISTORIC PLACES
PROPERTY PHOTOGRAPH FORM

FOR NPS USE ONLY

RECEIVED OCT 14 1975

DATE ENTERED DEC 6 1975

SEE INSTRUCTIONS IN *HOW TO COMPLETE NATIONAL REGISTER FORMS*
TYPE ALL ENTRIES -- ENCLOSE WITH PHOTOGRAPH

1 NAME

HISTORIC WATSON-SAWYER HOUSE

AND/OR COMMON

2 LOCATION

CITY, TOWN HAMBURG

VICINITY OF

STATE
ARKANSAS

COUNTY
ASHLEY

3 PHOTO REFERENCE

PHOTO CREDIT SANDRA TAYLOR

DATE OF PHOTO 1975

NEGATIVE FILED AT ARKANSAS HISTORIC PRESERVATION PROGRAM

4 IDENTIFICATION

DESCRIBE VIEW, DIRECTION, ETC. IF DISTRICT, GIVE BUILDING NAME & STREET

FACADE AND EAST ELEVATION, VIEWED FROM THE NORTHEAST

PHOTO NO.

1 of 3

AS 5

GPO 892-454

1073



A. WATSON-SAWYER HOUSE
ASHLEY COUNTY, ARKANSAS
PORTICO ON FACADE, VIEWED FROM THE NORTH

Form No. 10-301a
(Rev. 10-74)

UNITED STATES DEPARTMENT OF THE INTERIOR
NATIONAL PARK SERVICE

NATIONAL REGISTER OF HISTORIC PLACES
PROPERTY PHOTOGRAPH FORM

FOR NPS USE ONLY

RECEIVED OCT 14 1975

DATE ENTERED DEC 6 1975

SEE INSTRUCTIONS IN HOW TO COMPLETE NATIONAL REGISTER FORMS
TYPE ALL ENTRIES -- ENCLOSE WITH PHOTOGRAPH

1 NAME

HISTORIC

WATSON - SAWYER HOUSE

AND/OR COMMON

2 LOCATION

CITY, TOWN

HAMBURG

____ VICINITY OF

STATE
ARKANSAS

COUNTY
ASHLEY

3 PHOTO REFERENCE

PHOTO CREDIT

SANDRA TAYLOR

DATE OF PHOTO

1975

NEGATIVE FILED AT

ARKANSAS HISTORIC PRESERVATION PROGRAM

4 IDENTIFICATION

DESCRIBE VIEW, DIRECTION, ETC. IF DISTRICT. GIVE BUILDING NAME & STREET

PORTICO ON FACADE, VIEWED FROM THE NORTH

PHOTO NO.

2 43

GPO 892-454



3. WATSON-SAWYER HOUSE
ASHLEY COUNTY, ARKANSAS
WEST ELEVATION, VIEWED FROM THE WEST

Form No. 10-301a
(Rev. 10-74)

UNITED STATES DEPARTMENT OF THE INTERIOR
NATIONAL PARK SERVICE

NATIONAL REGISTER OF HISTORIC PLACES
PROPERTY PHOTOGRAPH FORM

FOR NPS USE ONLY

RECEIVED

OGT 14 1975

DATE ENTERED

DEC 6 1975

SEE INSTRUCTIONS IN *HOW TO COMPLETE NATIONAL REGISTER FORMS*
TYPE ALL ENTRIES -- ENCLOSE WITH PHOTOGRAPH

1 NAME

HISTORIC WATSON - SAWYER HOUSE

AND/OR COMMON

2 LOCATION

CITY, TOWN HAMBURG

____ VICINITY OF

STATE
ARKANSAS

COUNTY
ASHLEY

3 PHOTO REFERENCE

PHOTO CREDIT SANDRA TAYLOR

DATE OF PHOTO 1975

NEGATIVE FILED AT ARKANSAS HISTORIC PRESERVATION PROGRAM

4 IDENTIFICATION

DESCRIBE VIEW, DIRECTION, ETC. IF DISTRICT, GIVE BUILDING NAME & STREET
WEST ELEVATION, VIEWED FROM THE WEST

PHOTO NO.

343

from the west

UNITED STATES DEPARTMENT OF THE INTERIOR
NATIONAL PARK SERVICE

**NATIONAL REGISTER OF HISTORIC PLACES
PROPERTY MAP FORM**

FOR NPS USE ONLY

RECEIVED OCT 14 1975

DATE ENTERED DEC 6 1975

SEE INSTRUCTIONS IN *HOW TO COMPLETE NATIONAL REGISTER FORMS*
TYPE ALL ENTRIES -- ENCLOSE WITH MAP

1 NAME

HISTORIC

WATSON - SAWYER HOUSE

AND/OR COMMON

2 LOCATION

CITY, TOWN

HAMBURG

____ VICINITY OF

COUNTY

ASHLEY

STATE

ARKANSAS

3 MAP REFERENCE

SOURCE

U. S. GEOLOGICAL SURVEY

SCALE

1:2400

DATE

1973

4 REQUIREMENTS

TO BE INCLUDED ON ALL MAPS

1. PROPERTY BOUNDARIES
2. NORTH ARROW
3. UTM REFERENCES

UNITED STATES
DEPARTMENT OF THE INTERIOR
GEOLOGICAL SURVEY

ADVANCE PROOF
SUBJECT TO CORRECTION
SCALE 1:24,000

HAMBURG QUADRANGLE
ARKANSAS-ASHLEY CO.
7.5 MINUTE SERIES (TOPOGRAPHIC)

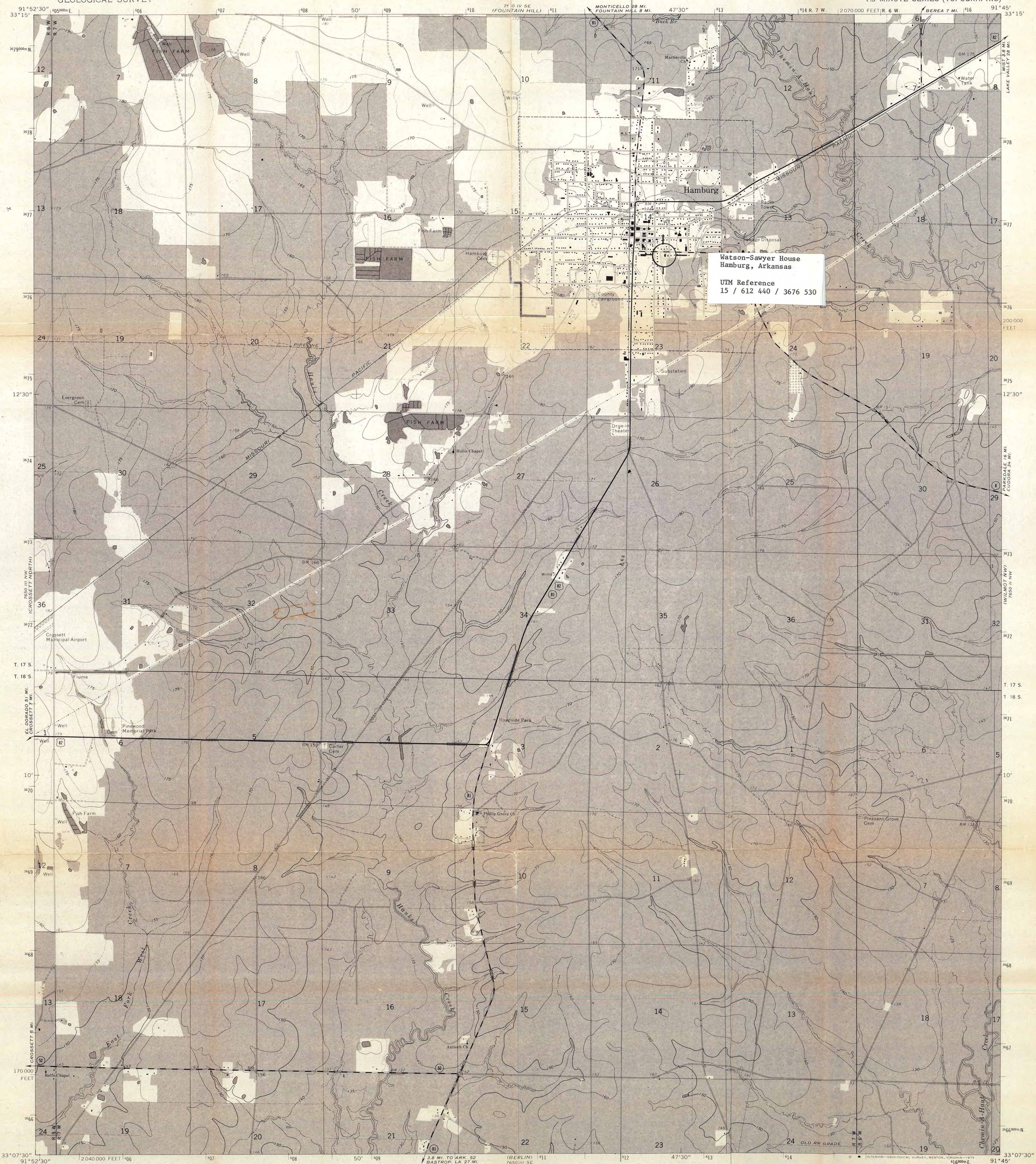

Mapped, edited, and published by the Geological Survey
Control by USGS and USC&GS
Topography by photogrammetric methods from aerial
photographs taken 1972. Field checked 1973
Projection and 10,000-foot grid ticks: Arkansas coordinate
system, south zone (Lambert conformal conic)
1000-metre Universal Transverse Mercator grid ticks,
zone 15, shown in blue. 1927 North American datum
Fine red dashed lines indicate selected fence and field lines where
generally visible on aerial photographs. This information is unchecked

UTM GRID AND 1973 MAGNETIC NORTH
DECLINATION AT CENTER OF SHEET

SCALE 1:24,000
CONTOUR INTERVAL 10 FEET
DOTTED LINES REPRESENT 5-FOOT CONTOURS
NATIONAL GEODETIC VERTICAL DATUM OF 1929

QUADRANGLE LOCATION

ROAD CLASSIFICATION
Primary highway, hard surface
Secondary highway, hard surface
Unimproved road
Interstate Route
U. S. Route
State Route

HAMBURG, ARK.
N3307.5-W9145/7.5
1973
AMS 7650 III NE-SERIES V884
HAMBURG NE, ARK.
HAMBURG PROJ. UNIT B-LEK REW
LL



Hamburg
OC

ENTRIES IN THE NATIONAL REGISTER

STATE ARKANSAS

Date Entered DEC 6 1975

<u>Name</u>	<u>Location</u>
Main Hall, Central College	Conway Faulkner County
Marisgate (William P. Dortch House)	Scott Lonoke County
Watson-Sawyer House	Hamburg Ashley County
Helena Library and Museum	Helena Phillips County
Ferguson House	Augusta Woodruff County

Also Notified

Hon. John L. McClellan
Hon. Dale Bumpers
Hon. Wilbur D. Mills
Hon. Ray Thornton
Hon. Bill Alexander
Regional Director, Southwest
Region

State Historic Preservation Officer
Mr. Gene Richardson
Acting Director, Department of Natural
and Cultural Heritage
The Old State House
300 West Markham
Little Rock, Arkansas 72201

PR MMott/row 12/12/75

INT: 2950-75

NATIONAL REGISTER DATA SHEET

57

1 NAME as it appears on federal register:
Watson-Sawyer House

2 OTHER NAMES:

3 date of entry: 12-6-75

4 county code: 003

5 LOCATION street & number: 502 E. Parker St.

city / town: Hamburg

vicinity of:

state: AR

county: Ashley

6 NPS REGION: Southwest

7 OWNER: ☒ PRIVATE ☐ STATE ☐ MUNICIPAL ☐ COUNTY ☐ MULTIPLE ☐ FEDERAL (agency name)

8 ADMINISTRATOR:

9 EXISTING SURVEYS: ☐ NABS ☐ HAER ☐ NHL

10 FUNDED? ☐ YES ☒ NO

11 CONGRESS. DISTRICT: 4

12 SOURCE of NOMINATION: ☒ STATE ☐ FEDERAL

13 WITHIN NATIONAL REGISTER HISTORIC DISTRICT? ☒ YES, NAME: ☐ NO

14 WITHIN NATIONAL HISTORIC LANDMARK? ☒ YES, NAME: ☐ NO

15 ACRES: < 1

16 CONDITION: ☒ excellent ☐ good ☐ fair ☐ deteriorated ☐ ruins ☐ unexposed ☐ unexcavated ☒ altered ☐ unaltered ☐ reconstructed ☐ excavated ☒ original site ☐ moved ☐ unknown

17 features: ☒ SUBSTANTIALLY INTACT-1 ☐ NOT INTACT-0 ☐ UNKNOWN-4 ☐ NOT APPLICABLE-7

18 SUBSTANTIALLY INTACT-2 ☐ NOT INTACT-0 ☐ UNKNOWN-5 ☐ NOT APPLICABLE-8

19 SUBSTANTIALLY INTACT-3 ☒ NOT INTACT-0 ☐ UNKNOWN-6 ☐ NOT APPLICABLE-9

20 ACCESS: ☒ YES-Restricted ☐ YES-Unrestricted ☐ No Access ☐ Unknown

21 ADAPTIVE USE: ☐ YES ☒ NO

22 SAVED? ☐ YES ☒ NO

23 IS PROPERTY A HISTORIC DISTRICT? ☐ yes ☒ no

24 AREAS OF SIGNIFICANCE:

25 CLAIMS: explain 'first' ☐ 'oldest' ☐ 'only' ☐

26 functions: WHEN HISTORICALLY SIGNIFICANT: PRIVATE RESIDENCE CURRENTLY: PRIVATE RESIDENCE

27 dates of initial construction: 1870

28 ETHNIC GROUP ASSOCIATION:

29 architectural style(s): GREEK REVIVAL WITH PICTURESQUE ITALIANATE ELEMENTS

30 architect:

31 master builder:

32 engineer:

33 landscape architect / garden designer:

34 interior decorator:

35 artist:

36 artisan:

37 builder/contractor:

38 NAMES give role & date

PERSONAL:

EVENTS:

INSTITUTIONAL:

39 NATIONAL REGISTER WRITE-UP

Frame, cladding; 1-2 stories, gabled roof sections with bargeboards and paired brackets, exterior end chimneys; 1st and 2nd story entrances each with paneled double doors, transom, sidelights, and engaged colonnettes; small 2nd-story balcony, 2-story distyle pedimented front entrance portico; original interior woodwork; 1949, 1-story rear addition; 1961, original square columns replaced with fluted columns from older Hamburg house being razed. Unique SE Arkansas vernacular juxtaposition of Greek Revival and Picturesque Italianate elements.

modified rectangles

unusual