

UNITED STATES DEPARTMENT OF THE INTERIOR  
NATIONAL PARK SERVICE

FOR NPS USE ONLY  
RECEIVED NOV 17 1976  
DATE ENTERED AUG 29 1977

**NATIONAL REGISTER OF HISTORIC PLACES  
INVENTORY -- NOMINATION FORM**

SEE INSTRUCTIONS IN HOW TO COMPLETE NATIONAL REGISTER FORMS  
TYPE ALL ENTRIES -- COMPLETE APPLICABLE SECTIONS

**1 NAME**

HISTORIC *\*\**  
Aaron-Miller-House, James Dixon Farm  
AND/OR COMMON  
Dixon Property

**2 LOCATION**

STREET & NUMBER *W of Boonton on*  
Rockaway Valley Road  
CITY, TOWN Township of Boonton VICINITY OF 13th  
STATE New Jersey CODE 034 COUNTY Morris CODE 027

**3 CLASSIFICATION**

CATEGORY	OWNERSHIP	STATUS	PRESENT USE
<input type="checkbox"/> DISTRICT	<input type="checkbox"/> PUBLIC	<input checked="" type="checkbox"/> OCCUPIED	<input checked="" type="checkbox"/> AGRICULTURE <input type="checkbox"/> MUSEUM
<input checked="" type="checkbox"/> BUILDING(S)	<input checked="" type="checkbox"/> PRIVATE	<input type="checkbox"/> UNOCCUPIED	<input type="checkbox"/> COMMERCIAL <input type="checkbox"/> PARK
<input type="checkbox"/> STRUCTURE	<input type="checkbox"/> BOTH	<input type="checkbox"/> WORK IN PROGRESS	<input type="checkbox"/> EDUCATIONAL <input checked="" type="checkbox"/> PRIVATE RESIDENCE
<input type="checkbox"/> SITE	<b>PUBLIC ACQUISITION</b>	<b>ACCESSIBLE</b>	<input type="checkbox"/> ENTERTAINMENT <input type="checkbox"/> RELIGIOUS
<input type="checkbox"/> OBJECT	<input type="checkbox"/> IN PROCESS	<input type="checkbox"/> YES: RESTRICTED	<input type="checkbox"/> GOVERNMENT <input type="checkbox"/> SCIENTIFIC
	<input type="checkbox"/> BEING CONSIDERED	<input type="checkbox"/> YES: UNRESTRICTED	<input type="checkbox"/> INDUSTRIAL <input type="checkbox"/> TRANSPORTATION
		<input checked="" type="checkbox"/> NO	<input type="checkbox"/> MILITARY <input type="checkbox"/> OTHER:

**4 OWNER OF PROPERTY**

NAME Dixon Association, B. M. Dixon & B. H. Dixon  
STREET & NUMBER Rockaway Valley Road  
CITY, TOWN Township of Boonton VICINITY OF STATE New Jersey

**5 LOCATION OF LEGAL DESCRIPTION**

COURTHOUSE, REGISTRY OF DEEDS, ETC. Hall of Records  
STREET & NUMBER Court Street  
CITY, TOWN Morristown STATE New Jersey

**6 REPRESENTATION IN EXISTING SURVEYS**

TITLE New Jersey Historic Sites Inventory  
DATE 1975  FEDERAL  STATE  COUNTY  LOCAL

DEPOSITORY FOR SURVEY RECORDS Department of Environmental Protection P.O. Box 1420  
CITY, TOWN Trenton STATE New Jersey

# 7 DESCRIPTION

CONDITION		CHECK ONE	CHECK ONE
<input type="checkbox"/> EXCELLENT	<input type="checkbox"/> DETERIORATED	<input type="checkbox"/> UNALTERED	<input checked="" type="checkbox"/> ORIGINAL SITE
<input checked="" type="checkbox"/> GOOD	<input type="checkbox"/> RUINS	<input checked="" type="checkbox"/> ALTERED	<input type="checkbox"/> MOVED      DATE _____
<input type="checkbox"/> FAIR	<input type="checkbox"/> UNEXPOSED		

---

DESCRIBE THE PRESENT AND ORIGINAL (IF KNOWN) PHYSICAL APPEARANCE

The Dixon Property consists basically of three houses, a mill and several barns. The main buildings will be considered individually.

### The Aaron Miller House

This is the oldest building on the Dixon Farm. The original builder and owner Frederick Miller, built the house in 1760. The walls are native sandstone and over 12" thick. The stones were quarred at Great Notch.

With this house, a tradition was started that all Miller houses were built into the side of a bank. This one was built into the north side.

The original house had a keeping room with fireplace and dutch oven (on the outside), the original room, and one room finished over the original room. There was also an open loft in the front part of the house.

An addition was added sometime later and the house now has two front doors. Another finished room was added over the new section. The upstairs rooms were reached by straight up ladders. Both front rooms have the original fireplaces and one room has an original and very crude corner cabinet. The dining room was added about 1820.

In 1898, the house was remodeled. The original floors, doors, hardware and windows were removed. Front and rear dormers were added to the roof. The corner cabinet and the second fireplace were the only things left untouched. The first fireplace was restoned to its original size in 1960.

The present house is 42' x 33' with five rooms on the 1st floor and six on the second floor.

A wagon or carriage house once stood behind this house.

### Forge Keeper's House

This house was built and owned by James Dixon. It is built next to a pond with a waterfall. Dixon built the pond in 1830 and the house in 1840.

The original house, built for the forge keeper, had two rooms, one upstairs and one down. The house is white clapboard with green shutters. There was a shed-type lean-to in the back of the downstairs room. The house still has the original wide floor boards. The main room has a very shallow fireplace. The shed area was enlarged and walled in about 1860. The original well is still in the cellar.

# 8 SIGNIFICANCE

PERIOD	AREAS OF SIGNIFICANCE -- CHECK AND JUSTIFY BELOW			
<input type="checkbox"/> PREHISTORIC	<input type="checkbox"/> ARCHEOLOGY-PREHISTORIC	<input type="checkbox"/> COMMUNITY PLANNING	<input type="checkbox"/> LANDSCAPE ARCHITECTURE	<input type="checkbox"/> RELIGION
<input type="checkbox"/> 1400-1499	<input type="checkbox"/> ARCHEOLOGY-HISTORIC	<input type="checkbox"/> CONSERVATION	<input type="checkbox"/> LAW	<input type="checkbox"/> SCIENCE
<input type="checkbox"/> 1500-1599	<input checked="" type="checkbox"/> AGRICULTURE	<input type="checkbox"/> ECONOMICS	<input type="checkbox"/> LITERATURE	<input type="checkbox"/> SCULPTURE
<input type="checkbox"/> 1600-1699	<input type="checkbox"/> ARCHITECTURE	<input type="checkbox"/> EDUCATION	<input type="checkbox"/> MILITARY	<input type="checkbox"/> SOCIAL/HUMANITARIAN
<input checked="" type="checkbox"/> 1700-1799	<input type="checkbox"/> ART	<input type="checkbox"/> ENGINEERING	<input type="checkbox"/> MUSIC	<input type="checkbox"/> THEATER
<input checked="" type="checkbox"/> 1800-1899	<input type="checkbox"/> COMMERCE	<input type="checkbox"/> EXPLORATION/SETTLEMENT	<input type="checkbox"/> PHILOSOPHY	<input type="checkbox"/> TRANSPORTATION
<input type="checkbox"/> 1900-	<input type="checkbox"/> COMMUNICATIONS	<input type="checkbox"/> INDUSTRY	<input type="checkbox"/> POLITICS/GOVERNMENT	<input type="checkbox"/> OTHER (SPECIFY)
		<input type="checkbox"/> INVENTION		

SPECIFIC DATES

BUILDER/ARCHITECT

## STATEMENT OF SIGNIFICANCE

The Miller family was one of the first to settle in what is now Boonton Township. The Dixon Family married into the Miller family and came to own the present property.

The Dixon Farm significance lies primarily in its development as a farm complex. The Dixon Farm has been the home of the Dixon family for over seven generations. The site is the largest and one of the most significant in Boonton Township.

The Dixon property shows the way in which a farm complex can develop. The Dixons inherited the property from the Miller family who began to develop the site in 1760. Originally planned for farming, when it was found to be profitable a forge was set up; another addition was a mill. Thus what was essentially an agrarian lifestyle was able to be expanded on by the innovative owners.

All through the 18th century the Morris County countryside was developing into rolling farmlands and small villages and farm complexes. The Dixon property is representative of this. By the second quarter of the 19th century the Dixon's had established a working community. This was typical of the times. The descendents of the early settlers were joined by others who brought with them a needed trade or profession that helped to make the farm self-sufficient.

From the late 19th century until the present there has been negligible development occurring in the farm. Consequently, this provides the county and the State with an excellent presentation of a second and third quarter 19th century farm complex with intermittent examples of late 18th and early 19th century construction methods.

The Dixon Farm is rich in the history and development of what is now known as Boonton Township. Originally purchased by the Miller family it only began to prosper when the Dixons acquired it. The property is an very good living example of farm complexes which are slowly becoming non-existent due to urban population growth eliminating the space needed for adequate farming.

# 9 MAJOR BIBLIOGRAPHICAL REFERENCES

**Books**

Munsell, W. W. & Co., History of Morris County, (Reprinted by Morris County Historical Society 1967). pp. 7-25, 66-71, 177-188, 217-228, 265-289, 331-363.

**Pamphlets**

Rockaway Valley Methodist Church, Centennial of Worship in the Present Building, September 20, 1942. (Cont'd)

# 10 GEOGRAPHICAL DATA

ACREAGE OF NOMINATED PROPERTY 12 acres

UTM REFERENCES

DA	1,8	5,4,7,1,6,0	4,5,3,1,4,0,0	AB	1,8	5,4,7,3,6,0	4,5,3,1,2,6,0
	ZONE	EASTING	NORTHING		ZONE	EASTING	NORTHING
BC	1,8	5,4,7,2,0,0	4,5,3,1,0,6,0	CA	1,8	5,4,7,0,2,0	4,5,3,1,2,0,0

VERBAL BOUNDARY DESCRIPTION

Beginning at a point on Rockaway Valley Road 2400 feet SW of its intersection with Split Rock Road; proceed 900 feet SW along Rockaway Valley Road; thence proceed 900 feet NW; thence proceed 900 feet NE; thence proceed 900 feet SE to the point of origin

LIST ALL STATES AND COUNTIES FOR PROPERTIES OVERLAPPING STATE OR COUNTY BOUNDARIES

STATE	CODE	COUNTY	CODE
STATE	CODE	COUNTY	CODE

# 11 FORM PREPARED BY

NAME / TITLE

Nancy Kostrub - Research Assistant

ORGANIZATION

Historic Sites Section, Department of Environmental Protection

STREET & NUMBER

P. O. Box 1420

CITY OR TOWN

Trenton

DATE

TELEPHONE

(609) 292-2023

STATE

New Jersey

# 12 STATE HISTORIC PRESERVATION OFFICER CERTIFICATION

THE EVALUATED SIGNIFICANCE OF THIS PROPERTY WITHIN THE STATE IS:

NATIONAL

STATE

LOCAL

As the designated State Historic Preservation Officer for the National Historic Preservation Act of 1966 (Public Law 89-665), I hereby nominate this property for inclusion in the National Register and certify that it has been evaluated according to the criteria and procedures set forth by the National Park Service.

STATE HISTORIC PRESERVATION OFFICER SIGNATURE

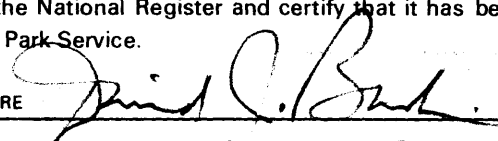

TITLE Commissioner, Department of Environmental Protection

DATE JUL - 6 1976

FOR NPS USE ONLY

I HEREBY CERTIFY THAT THIS PROPERTY IS INCLUDED IN THE NATIONAL REGISTER

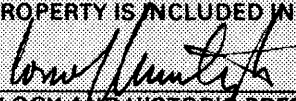

DIRECTOR, DEPARTMENT OF ARCHAEOLOGY AND HISTORIC PRESERVATION

DATE

8/29/77

ATTEST:



KEEPER OF THE NATIONAL REGISTER

DATE

8-23-77

KEEPER OF THE NATIONAL REGISTER

UNITED STATES DEPARTMENT OF THE INTERIOR  
NATIONAL PARK SERVICE

**NATIONAL REGISTER OF HISTORIC PLACES  
INVENTORY -- NOMINATION FORM**

Dixon Farm  
Boonton Township  
Morris County

CONTINUATION SHEET

034

ITEM NUMBER 7

PAGE 2

FOR NPS USE ONLY

RECEIVED NOV 17 1976

DATE ENTERED AUG 29 1977

7. DESCRIPTION (cont.)

The house was remodeled in 1940. A front porch and dormer windows were added.

The forge, no longer standing, was to the rear of the house. The remains of the forge spillway can still be seen.

A blacksmith shop, no longer extant, stood at the entrance to the property.

Dixon's Mill

The original Grist Mill once stood by the small pond to the left of the Stone House. The mill was built about 1800 by Aaron Miller. It had an undershot wheel.

The original mill was replaced by the present one in 1830. The present mill was placed on the hillside beyond the site of the original. James Dixon had this mill moved to the property from Tony's Brook in Montclair, New Jersey. Also in 1830 James Dixon constructed the pond which is behind the property to accommodate the mill which had an overshot wheel.

This mill is a two stone mill, with all of the workings intact. In 1890, the water wheel was removed and replaced by a turbine.

Cyrus Dixon House

This house was built c. 1856 on the hill overlooking Rockaway Valley.

The original kitchen was a rough, unfinished room on the left side of the house. A Dutch Oven was built on the outside of this kitchen. Other first floor rooms include a living room, dining room, pantry, hall, sitting room and new kitchen. An addition was added in 1936 which added 3 rooms to the first floor.

The second floor included 4 rooms. The 1936 addition added 2 rooms and several closets.

The exterior of the house remains the same today as it did in 1891.

A map of the district delineating boundaries and historic properties is attached.

UNITED STATES DEPARTMENT OF THE INTERIOR  
NATIONAL PARK SERVICE

FOR NPS USE ONLY	
RECEIVED	NOV 17 1976
DATE ENTERED	AUG 29 1977

**NATIONAL REGISTER OF HISTORIC PLACES  
INVENTORY -- NOMINATION FORM**

Dixon Property  
Boonton Township  
Morris County New Jersey 034

CONTINUATION SHEET

ITEM NUMBER 7 PAGE 3

Inventory of Historic Structures Located Within the Dixon Property

1. Aaron Miller House, 2 stories, sandstone.
2. Forge Keeper's House, 2 stories, clapboard, 20th c. porch.
3. Cyrus Dixon House, c. 1865, 2 stories, clapboard, Victorian Gingerbread Porch.
4. Dixon's Mill, 2 1/2 stories, clapboard.
5. Barn, 1898 2 stories, vertical board, siding, cupola, bankbarn.
6. Barn, 1864, 1 1/2 stories, vertical board, siding, stone foundation, Bankbarn.

UNITED STATES DEPARTMENT OF THE INTERIOR  
NATIONAL PARK SERVICE

FOR NPS USE ONLY

RECEIVED NOV 17 1976

DATE ENTERED AUG 29 1977

**NATIONAL REGISTER OF HISTORIC PLACES  
INVENTORY -- NOMINATION FORM**

Dixon Farm  
Boonton Township  
Morris County New Jersey 034

CONTINUATION SHEET

ITEM NUMBER 9 PAGE 1

BIBLIOGRAPHICAL REFERENCES CONTINUED

Pamphlets

Rockaway Valley Methodist Church, 125th Anniversary, October 1, 1967

Newspaper

Boonton Times-Bulletin, Vol. 98, #9, Monday, November 25, 1968.

Notes and Conversations

Alex Fowler, 445 Vreeland Ave., Boonton, NJ  
H.W. Schroeder, Split Rock Road, R.D. #2, Boonton NJ

Various members of the Dixon family  
Rockaway Valley Road, R.D. #3, Boonton Twp., NJ  
Jane Dixon, Bruce Dixon, Bryant Dixon, Harriet Dixon, Homer Dixon,  
Cyrus Byram Dixon II.

DIXON PROPERTY  
BOONTON TOWNSHIP  
MORRIS COUNTY

STOCKTON

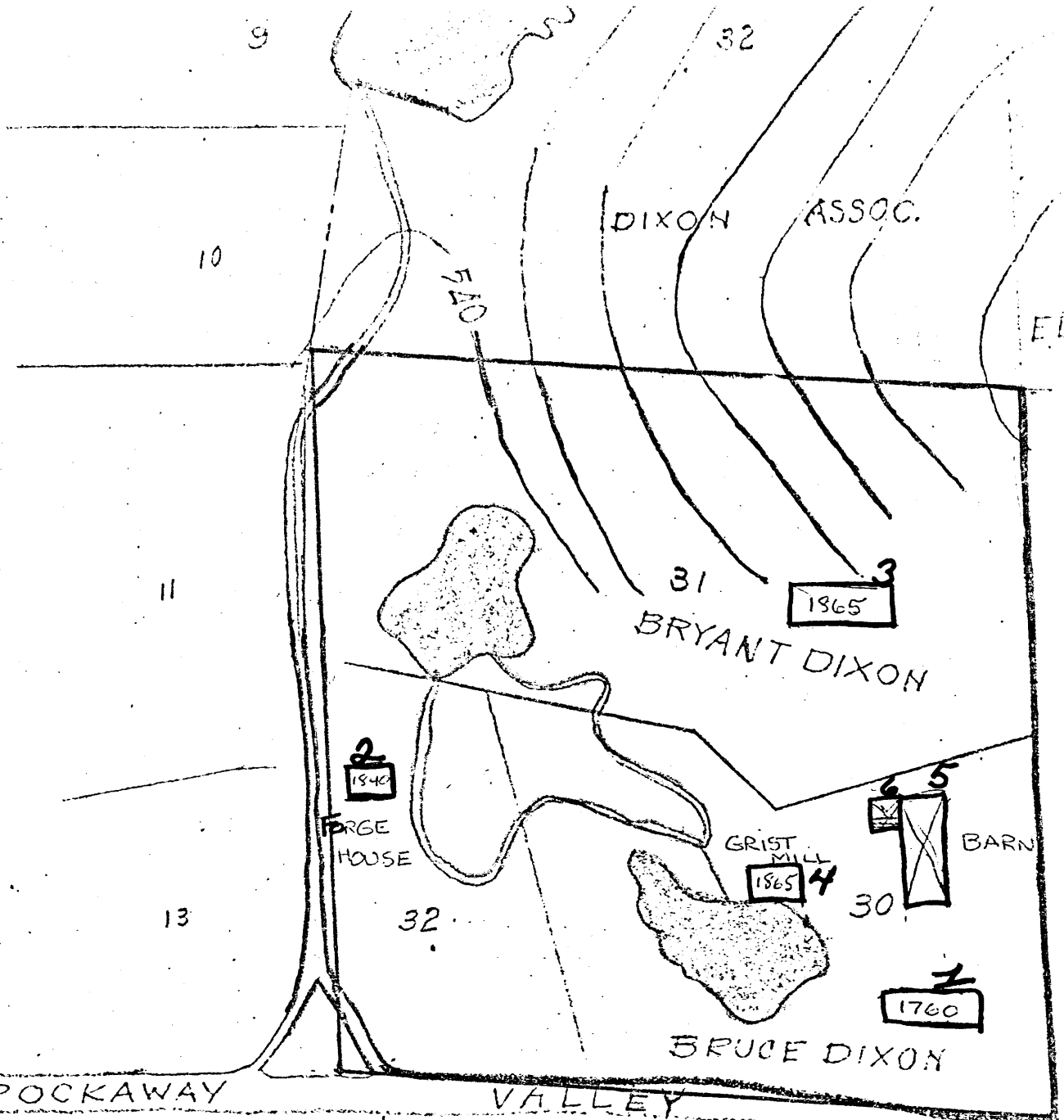

VALLEY ROAD

SCALE 1" = 200'

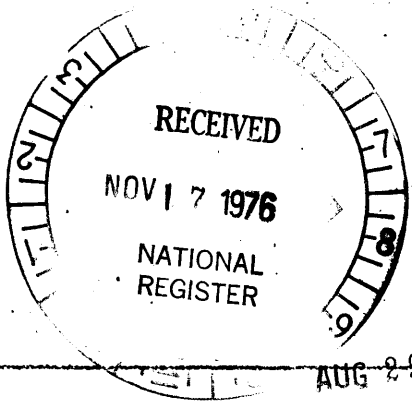
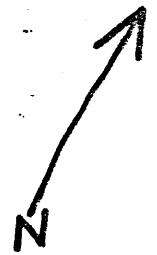

AUG 29 1977