

A. HISTORIC NAME H. G. NEWMAN BUILDING B. COUNTY Vanderburgh C. NUMBER 163-176-00287
 D. ADDRESS 211-213 SE Fourth Street E. TWP./CITY Pigeon/Evansville F. QUAD NAME Evansville IN-47
 SR _____ NR _____ NHL _____ HABS _____ MAER _____ UTM REFERENCES 16 414919.0 426213.0

STATE OF INDIANA DEPARTMENT OF NATURAL RESOURCES INDIANA HISTORIC SITES AND STRUCTURES INVENTORY REVISED 1977



1. COMMON NAME _____ 4. PROPERTY'S MAILING ADDRESS H. G. Newman Plumbing Co., Inc. 5. LOCATION NOTES SE 1/4 NE 1/4 SE 1/4 S 20 T6S R10E
 2. OWNERSHIP _____ Public Private _____ 5. TAX CODE: 20-20-3
 3. VISIBLE _____ Yes _____ No _____ Evansville IN 47713 6. SE 35' of Donation End lot 190

6. USE	PRESENT	PAST	PRESENT	PAST	7. ENDANGERED	8. CATEGORY	9. LOCAL LEGAL PROTECTION
Residence	<input type="checkbox"/>	<input type="checkbox"/>	Military	<input type="checkbox"/>	<input type="checkbox"/>	<input type="checkbox"/>	<input type="checkbox"/>
Govt./Pol.	<input type="checkbox"/>	<input type="checkbox"/>	Entertainment	<input type="checkbox"/>	<input type="checkbox"/>	<input checked="" type="checkbox"/> Building(s)	<input type="checkbox"/> Historic District
Commerce	<input checked="" type="checkbox"/>	<input checked="" type="checkbox"/>	Scientific	<input type="checkbox"/>	<input type="checkbox"/>	<input type="checkbox"/> Structure	<input type="checkbox"/> Landmark
Industrial	<input type="checkbox"/>	<input type="checkbox"/>	Religious	<input type="checkbox"/>	<input type="checkbox"/>	<input type="checkbox"/> Site	<input type="checkbox"/> Deed Restriction
Agriculture	<input type="checkbox"/>	<input type="checkbox"/>	Park	<input type="checkbox"/>	<input type="checkbox"/>	<input type="checkbox"/> Object	<input type="checkbox"/> Other
Transportation	<input type="checkbox"/>	<input type="checkbox"/>	Museum	<input type="checkbox"/>	<input type="checkbox"/>		
Organization	<input type="checkbox"/>	<input type="checkbox"/>	Educational	<input type="checkbox"/>	<input type="checkbox"/>		
Other							

10. CONDITION
 Excellent
 Good
 Fair
 Deteriorated
 Ruins

11. BUILDING INTEGRITY
 Unaltered
 Altered
 Moved
 Date _____

11a. Specify Alterations
 Removals _____
 Structural _____
 Replacement _____
 Additions _____

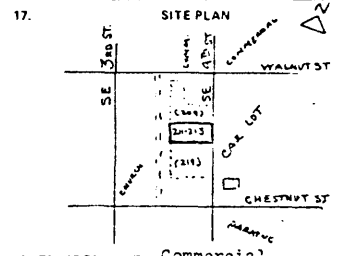

12. DATE c. 1900 13. STYLE _____ 14. ARCHITECT/BUILDER Unknown
 15. DESCRIPTION Two story brick; approx. 37' wide x 120' long; 1st story facade contains vehicle bay and display windows with central recessed entrance; 2nd sty two sets (3 each) round-arched windows surmounted by ornamental brickwork & a parapet.
 Inscriptions _____ Facade Material Brick

18. ENVIRONMENT Commercial

19. AREAS OF SIGNIFICANCE
- | | | | |
|--|---|---|--|
| <input type="checkbox"/> Aboriginal | <input type="checkbox"/> Community Planning | <input type="checkbox"/> Humanities | <input type="checkbox"/> Religion |
| <input type="checkbox"/> Arts | <input type="checkbox"/> Education | <input type="checkbox"/> Indian | <input type="checkbox"/> Science/Technology |
| <input checked="" type="checkbox"/> Architecture | <input type="checkbox"/> Engineering | <input type="checkbox"/> Landscape Architecture | <input type="checkbox"/> Social/Ethnicity |
| <input type="checkbox"/> Commerce | <input type="checkbox"/> Environs/Neighborhoods | <input type="checkbox"/> Military | <input type="checkbox"/> Transportation |
| <input type="checkbox"/> Communications | <input type="checkbox"/> Exploration/Settlement | <input type="checkbox"/> Politics/Government | <input type="checkbox"/> Vernacular/Construction |
| <input type="checkbox"/> Other _____ | | | |

Specify the significance for each area checked. While the H(arry) G. Newman Plumbing Company has been quartered in this building for seventy years (since 1909), research data indicates that the construction date is closer to 1900 and that the original occupant (1901) was a wholesale grocer, followed an implement and farmers' supply concern. The unusual placement of the vehicle bay on the facade may date from this latter occupancy.

The Newman building over the course of its existence has been spared modernization unlike the majority of other commercial buildings in downtown Evansville. The rhythmical fenestration and ornamental brickwork of its upper story are particularly noteworthy and, as a whole, the building remains one of the best surviving examples of late Victorian commercial architecture in the city.

20. INFORMATION SOURCES Deed records; city directories.