

United States Department of the Interior
National Park Service

National Register of Historic Places
Inventory—Nomination Form

For NPS use only
received
date entered

Continuation sheet

Item number 1,2,4,7,8,10

Page 36

1. Name: Mimbres School, survey number 67
2. Location: 200' east of Highway 61 and 150' south of junction of 61 with Forest Route 73.
4. Owner: Dan Antonio and Mariano Grijalva et al, San Lorenzo, N.M. 88057
7. Description: Photo 35; map 7; foundation unknown; stuccoed adobe; corrugated metal gabled roofs, wood shingles in gables; 6/1,6/6 double hung windows singly and in tandem; double doors with transom. New French double doors in original opening, adobe room added to north rear in 1985. Enclosed in an ornamental fence of wire, pipe and cast iron, likely erected near the construction of the school in the 1890s. Two small wood frame sheds sided with corrugated metal stand behind the school and within the fence.
8. Significance: This is one of four unaltered historic buildings remaining in Mimbres. (See Sibole Store, # 71, above for discussion of history of Mimbres.) Built in the 1890s, this along with the San Juan school, is one of the first two schools built in the valley and therefore meets Criterion A as a good reminder of the early settlement of Grant County. It uses typical materials of the local New Mexico Vernacular--adobe and corrugated roofing--but adapted to a new purpose, and a scale just slightly larger than the normal residence. It meets Register Criterion C as a good, well-preserved example of the New Mexico Vernacular type.
10. Geographical Data: Approximate Acreage: less than one.
Quadrangle Name: San Lorenzo, N.M. Scale: 1: 62,500
UTM References: 13 221000 3638950
Verbal boundary: A rectangle, roughly 120' by 190', as shown on map 7, formed by lines parallel to and ten feet from the ornamental fence enclosing the building. Since this is an unplatted area, this boundary has been created to include only the school, two small sheds and the historic fence.

7. Mimbres School (67)
Historic Resources of the
Mimbres Valley, 1987

N ↑ Photo □ →
Not to scale

Boundary - - - -
Ornamental fence ······

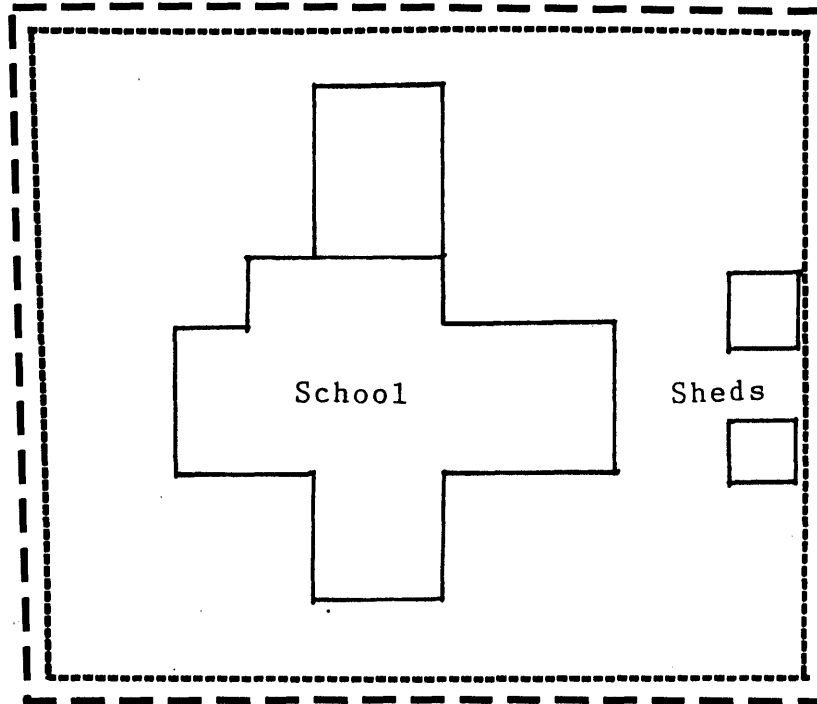

United States Department of the Interior
National Park Service

**National Register of Historic Places
Continuation Sheet**

Section number 4 Page 5

PROPERTY NAME

OWNER

George Sibole Store

Henry Stewart
610 Conestoga Road
Villanova, Pa. 19085

William Redding House

Brenda Zimmerman
329 East Lawrence
Royal Oakes, Michigan 48073

Kim Hamilton
1050 Triviz Rd. #29
Las Cruces, NM 88001

Hooks-Moore Store

Gilbert Moore
269 E. 3050 N.
Ogden, Utah

Mimbres School

Dan Antonio & Mariano Grijalva
San Lorenzo, NM 88057

Ysabel Valencia House

Ronnie Montoya
Rt. 16, Box 4625
Mimbres, NM 88049

Otto Huechling House

Mimbres Foundation
c/o Melvin Nefsky
521 N. La Cienega B Suite 202
Los Angeles, Ca. 90048

Dr. Granville Wood House

Mimbres Foundation
c/o Melvin Nefsky
521 N. La Cienega B Suite 202
Los Angeles, Ca. 90048

Elizabeth and Alex McGregor House

Geralda Kelley
1313 Lafayette
Baytown, Texas

United States Department of the Interior
National Park Service

APR 1 1988

National Register of Historic Places Continuation Sheet

Section number _____ Page _____

Multiple Resource Area
Thematic Group

Name Mimbres Valley MRA
State Grant County, NEW MEXICO

Nomination/Type of Review	Date/Signature
Cover	Keeper <u>Beth Boland 5/16/88</u>
Substantive Review	
1. San Lorenzo Historic District	Keeper <u>Beth Boland 5/16/88</u>
Substantive Review	Attest _____
2. San Juan Historic District	Keeper <u>Helena Byers 5/16/88</u>
Entered in the National Register	Attest _____
3. Sibole, George, Store	Keeper <u>Helena Byers 5/16/88</u>
Entered in the National Register	Attest _____
4. Redding, William, House	Keeper <u>Helena Byers 5/16/88</u>
Entered in the National Register	Attest _____
5. Hooks--Moore Store	Keeper <u>Beth Boland 5/16/88</u>
Substantive Review	Attest _____
6. Mimbres School	Keeper <u>Beth Boland 5/16/88</u>
Substantive Review	Attest _____
7. Valencia, Ysabel, House	Keeper <u>Helena Byers 5/16/88</u>
Entered in the National Register	Attest _____
8. Huechling, Otto, House	Keeper <u>Helena Byers 5/16/88</u>
Entered in the National Register	Attest _____
9. Wood, Dr. Granville, House	Keeper <u>Helena Byers 5-16-88</u>
Entered in the National Register	Attest _____
10. McGregor, Elizabeth and Alex, House	Keeper <u>Caree Shue 8-5-88</u>
Substantive Review	Attest _____
DOE/OWNER OBJECTION	