

United States Department of the Interior
National Park Service

For NPS use only

National Register of Historic Places
Inventory—Nomination Form

received JUL 2 1985
date entered SEP 11 1985

See instructions in *How to Complete National Register Forms*
Type all entries—complete applicable sections

1. Name

historic Alfred W. Roberts House

and or common Same

2. Location

street & number Ga. 372 - A.W. Roberts Drive N/A not for publication

city, town Ball Ground N/A vicinity of

state Georgia code 013 county Cherokee code 057

3. Classification

Category	Ownership	Status	Present Use
<input type="checkbox"/> district	<input type="checkbox"/> public	<input checked="" type="checkbox"/> occupied	<input type="checkbox"/> agriculture
<input checked="" type="checkbox"/> building(s)	<input checked="" type="checkbox"/> private	<input type="checkbox"/> unoccupied	<input type="checkbox"/> commercial
<input type="checkbox"/> structure	<input type="checkbox"/> both	<input type="checkbox"/> work in progress	<input type="checkbox"/> educational
<input type="checkbox"/> site	Public Acquisition	Accessible	<input checked="" type="checkbox"/> private residence
<input type="checkbox"/> object	<input checked="" type="checkbox"/> N/A in process	<input checked="" type="checkbox"/> yes: restricted	<input type="checkbox"/> entertainment
	<input type="checkbox"/> being considered	<input type="checkbox"/> yes: unrestricted	<input type="checkbox"/> government
		<input type="checkbox"/> no	<input type="checkbox"/> industrial
			<input type="checkbox"/> military
			<input type="checkbox"/> museum
			<input type="checkbox"/> park
			<input type="checkbox"/> religious
			<input type="checkbox"/> scientific
			<input type="checkbox"/> transportation
			<input type="checkbox"/> other:

4. Owner of Property

name A.W. Roberts Estate, c/o A.R. Roberts

street & number P.O. Box 3

city, town Ball Ground N/A vicinity of state Georgia

5. Location of Legal Description

courthouse, registry of deeds, etc. Superior Court

street & number Cherokee County Courthouse

city, town Canton state Georgia

6. Representation in Existing Surveys

Historic Structural Field Survey
title Cherokee County

has this property been determined eligible? yes no

date 1976 federal state county local

depository for survey records Georgia Department of Natural Resources

city, town Atlanta state Georgia

7. Description

Condition

excellent
 good
 fair

deteriorated
 ruins
 unexposed

Check one

unaltered
 altered

Check one

original site
 moved date _____

Describe the present and original (if known) physical appearance

The Alfred W. Roberts House is a large, two-story, wood-framed, Victorian eclectic style structure with classical detailing. It is situated on the top of a hill near the center of the small town of Ball Ground.

Exterior architectural features include a single-story balustraded porch with Doric columns across the east and part of the south facades, marble front steps, bracketed cornices, and brick chimneys. The house has a complex roof line with multiple gables, several of which have a decorative feather-cut shingle pattern, windows, and louvered windows. Most windows are two over two and several have louvered shutters.

Interior features include French doors, chair rail, vertical panel tongue-and-groove wainscoting, picture rail, walls with horizontal boards, and original door knobs and locks. The plan consists of an asymmetrical arrangement of rooms around a plantation plain type core.

It is believed that the oldest part of the house dates from the mid-1850s, and is comprised of the central part that originally consisted of two rooms over two with central hall and stairway, and two chimneys on the west wall. The kitchen and dining room building was detached and located just west of the main house. The house was enlarged in the late 1880s with the addition of rooms on both levels, and sides, to the west and to the east, and Victorian decorative elements on the exterior and interior. Between 1910 and 1920 other modifications included the addition of electrical wiring, the construction of the log pump house and the two-story barn, and the addition of Doric columns and balustrade on the front porch.

The property is landscaped with red maple, Norway spruce, magnolia, and hemlock trees. A marble sidewalk is located in front of the house and extends diagonally to the street. To the southeast of the house are an overgrown rock garden and former fish pond covered in ivy and periwinkle. The yard also contains marble birdbaths, urns, benches, and a pet cemetery with marble monuments. Outbuildings include a two-story barn, garage, lob pump-house, and a well house.

8. Significance

Period	Areas of Significance—Check and justify below			
<input type="checkbox"/> prehistoric	<input type="checkbox"/> archeology-prehistoric	<input type="checkbox"/> community planning	<input checked="" type="checkbox"/> landscape architecture	<input type="checkbox"/> religion
<input type="checkbox"/> 1400-1499	<input type="checkbox"/> archeology-historic	<input type="checkbox"/> conservation	<input type="checkbox"/> law	<input type="checkbox"/> science
<input type="checkbox"/> 1500-1599	<input type="checkbox"/> agriculture	<input type="checkbox"/> economics	<input type="checkbox"/> literature	<input type="checkbox"/> sculpture
<input type="checkbox"/> 1600-1699	<input checked="" type="checkbox"/> architecture	<input type="checkbox"/> education	<input type="checkbox"/> military	<input type="checkbox"/> social/ humanitarian
<input type="checkbox"/> 1700-1799	<input type="checkbox"/> art	<input type="checkbox"/> engineering	<input type="checkbox"/> music	<input type="checkbox"/> theater
<input checked="" type="checkbox"/> 1800-1899	<input type="checkbox"/> commerce	<input type="checkbox"/> exploration/settlement	<input type="checkbox"/> philosophy	<input type="checkbox"/> transportation
<input checked="" type="checkbox"/> 1900-	<input type="checkbox"/> communications	<input type="checkbox"/> industry	<input type="checkbox"/> politics/government	<input checked="" type="checkbox"/> other (specify) Local History
<input type="checkbox"/> invention				

Specific dates 1855 - 1932 Builder/Architect unknown

Statement of Significance (in one paragraph)

The Alfred W. Roberts House is significant in the areas of architecture, landscape architecture, and local history.

The house is significant architecturally as one of Ball Ground's largest houses that was originally constructed in the mid-19th century and enlarged at the turn of the century. It is a good example of an evolved house that reflects changing architectural tastes, a practice that was common in small towns in Georgia and the southeast in the late 19th and early 20th centuries. It is important for its unusual eclectic style which encompasses plantation plain, Victorian, and Classical elements, reflecting the historical development of the property between 1855 and 1932. Important exterior architectural details include the balustraded porch with Doric columns, marble front steps, bracketed cornices, brick chimneys, and multiple gables with decorative feather-cut shingle pattern. Significant interior features associated with the late 19th century period include French doors, chair rail, baseboards, vertical panel tongue-and-groove wainscoting, picture rail, walls with horizontal boards, and original knobs and door locks.

The significant interior features associated with the mid-19th-century plantation plain style two-over-two room house imbedded in the present house include: hand-hewn sills in the basement that are mortised and tenoned together; wide boards on stairway wall to basement; wide baseboards and floor boards, and a slightly crude two panel door in a first floor bedroom; and wide ceiling boards, old mantel, wide baseboards, two panel door, and low ceiling in a second story bedroom. The property has several notable out-buildings which consist of a barn, garage, log pump-house, and a well house.

In terms of landscape architecture, the Alfred W. Roberts House is important for its rock garden, marble sidewalks, benches, steps, birdbaths, urns, and pet cemetery. The property is landscaped with large old red maple, Norway spruce, magnolia, oak, hemlock, Yuka, cypress, cedar, and dogwood trees. In addition, the property has informally planted shrubbery, including boxwood, acuba, and ivy.

The property is significant in the area of local history for its association with the family of Alfred W. Roberts (1844-1918), a prominent merchant and charter citizen of the town of Ball Ground. Alfred W. Roberts purchased the property around 1890 and enlarged and remodeled the original plantation plain style structure to include Victorian detailing around 1898. In the late 1910s the style of the exterior of the house was altered again with the addition of a Classical front porch. A.W. Roberts served in the Confederate Army, and in 1879, he married Althea Georgia Ann Coggins (1861-1932), and they had seven children. His marriage into the Coggins family, who were associated with early business concerns in the Canton area, enabled him to broaden his business contacts in the granite, banking, and retailing businesses. Ball Ground was incorporated in 1883, and A.W. Roberts was involved in most phases of the town's early development as a banker, real estate developer, cotton broker, and creator of the Roberts Marble Company. He was one of the founders of the Bank of Ball Ground in 1906, and founded the Roberts Store which served the town for about 80 years. In addition, his sons Judson, Clyde, and Paul owned and operated the family marble monument business. In an effort to provide electricity for the marble manufacturing company as well as local residents in Ball Ground, the Roberts brothers built a log dam on Long Swamp Creek creating a 65 acre lake. This facility brought the first electricity to Ball Ground and was later purchased by the Georgia Power Company.

Descendants of Alfred W. Roberts maintain and live on the property today.

9. Major Bibliographical References

Roberts, A.R.III. "Historic Property Information Form-Alfred W. Roberts House", August, 1983. (On file at the Historic Preservation Section, Georgia Department of Natural Resources).

10. Geographical Data

Acreeage of nominated property 26 acres, approximately

Quadrangle name Ball Ground West, Georgia

Quadrangle scale 1:24000

UTM References

A

7	16	7	4	1	0	10	0	3	8	0	2	6	1	0	0
Zone	Easting			Northing											

B

7	16	7	4	1	3	8	1	0	3	8	0	1	2	8	1	1	0
Zone	Easting			Northing													

C

7	16	7	4	10	8	8	10	3	8	0	2	6	1	0	0
Zone	Easting			Northing											

D

Zone	Easting			Northing													

E

Zone	Easting			Northing													

F

Zone	Easting			Northing													

G

Zone	Easting			Northing													

H

Zone	Easting			Northing													

Verbal boundary description and justification

The nominated property coincides with the current legal description of the property. It includes the house, outbuildings, and landscaping associated with the house.

List all states and counties for properties overlapping state or county boundaries

state	code	county	code
N/A			

state	code	county	code
-------	------	--------	------

11. Form Prepared By

name/title Andrea Niles, Survey and Research Specialist

Historic Preservation Section

organization Georgia Department of Natural Resources date 5-31-85

street & number 270 Washington St. SW telephone (404) 656-2840

city or town Atlanta state Georgia

12. State Historic Preservation Officer Certification

The evaluated significance of this property within the state is:

national state local

As the designated State Historic Preservation Officer for the National Historic Preservation Act of 1966 (Public Law 89-665), I hereby nominate this property for inclusion in the National Register and certify that it has been evaluated according to the criteria and procedures set forth by the National Park Service.

State Historic Preservation Officer signature Elizabeth A. Lyon

Elizabeth A. Lyon

title Deputy State Historic Preservation Office date 6/13/85

For NPS use only

I hereby certify that this property is included in the National Register

James Byers
Keeper of the National Register

Entered in the National Register date 7/11/85

Attest: _____ date _____

Chief of Registration

MAP 4-2B

Alfred W. Roberts House
Ball Ground, Cherokee County, Georgia

Property Map:
Scale: 1 inch = 444.44 feet
Boundary of nominated property: ———
North: ↑

MAP 4-2

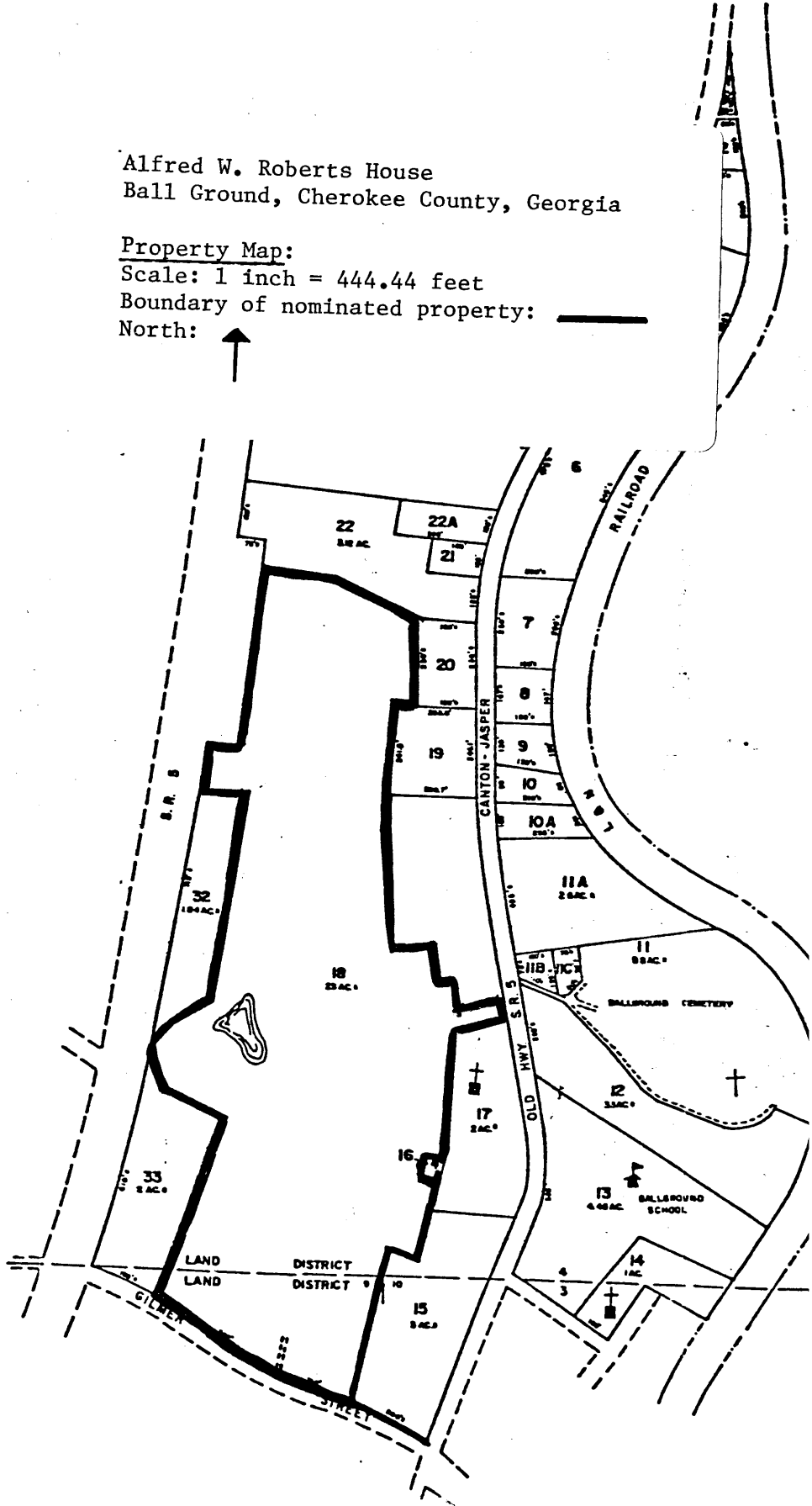

LEGEND

---	---
---	---
---	---
---	---