

United States Department of the Interior
National Park Service

For NPS use only

National Register of Historic Places
Inventory—Nomination Form

received DEC 20 1984
date entered JAN 18 1985

See instructions in *How to Complete National Register Forms*
Type all entries—complete applicable sections

1. Name

historic McGehee Hall, Southeastern Louisiana State University

and or common Same

2. Location

street & number Southeastern Louisiana University N/A not for publication

city, town Hammond N/A vicinity of

state LA code 22 parish Tangipahoa code 105

3. Classification

Category	Ownership	Status	Present Use
<input type="checkbox"/> district	<input checked="" type="checkbox"/> public	<input checked="" type="checkbox"/> occupied	<input type="checkbox"/> agriculture
<input checked="" type="checkbox"/> building(s)	<input type="checkbox"/> private	<input type="checkbox"/> unoccupied	<input type="checkbox"/> commercial
<input type="checkbox"/> structure	<input type="checkbox"/> both	<input type="checkbox"/> work in progress	<input checked="" type="checkbox"/> educational
<input type="checkbox"/> site	Public Acquisition	Accessible	<input type="checkbox"/> entertainment
<input type="checkbox"/> object	<input type="checkbox"/> in process	<input checked="" type="checkbox"/> yes: restricted	<input type="checkbox"/> government
	<input type="checkbox"/> N/A being considered	<input type="checkbox"/> yes: unrestricted	<input type="checkbox"/> industrial
		<input type="checkbox"/> no	<input type="checkbox"/> military
			<input type="checkbox"/> museum
			<input type="checkbox"/> park
			<input type="checkbox"/> private residence
			<input type="checkbox"/> religious
			<input type="checkbox"/> scientific
			<input type="checkbox"/> transportation
			<input type="checkbox"/> other:

4. Owner of Property

name Southeastern Louisiana State University (504) 549-2280

street & number Office of the President, P. O. Drawer 784, University Station

city, town Hammond N/A vicinity of state LA 70402

5. Location of Legal Description

courthouse, registry of deeds, etc. Tangipahoa Parish Courthouse

street & number Mulberry and Bay Streets (no specific address) P. O. Box 667

city, town Amite state LA 70422

6. Representation in Existing Surveys

title LA Historic Sites Survey has this property been determined eligible? yes no

date 1984 federal state county local

depository for survey records LA State Historic Preservation Office

city, town Baton Rouge state LA

7. Description

Condition

excellent
 good
 fair

deteriorated
 ruins
 unexposed

Check one

unaltered
 altered

Check one

original site
 moved date N/A

Describe the present and original (if known) physical appearance

McGehee Hall (1934) is a two-story brick neo-Georgian institutional building which is the centerpiece of the Southeastern Louisiana University campus. Despite a few alterations, the hall retains its National Register eligibility.

McGehee Hall is set impressively at the head of an axial avenue which leads from the university's main entrance. At one time the hall served as the administration building, but it has since been put to various uses, and consequently the interior has been somewhat modified. However, it should be noted that for the most part the interior was always functional and architecturally unpretentious. The plan is fairly straightforward with a central entrance, a corridor running to each side, and a staircase located at each end of the building.

The long brick building has bands of metal factory type windows. But despite this, it has considerable grace and dignity due to its neo-Georgian styling. It is articulated with a central colossal Doric pilastered pedimented pavilion and a pair of hip roofed end pavilions. The central pavilion subtly dominates the facade because it is set slightly forward from the building plane and slightly above the cornice line. The end pavilions feature shallow niches which at one time contained fountains. The rear of the hall is less elaborate, but it does feature two aedicule style entrances surmounted by ear molded windows.

Assessment of Integrity:

The following changes have been made in the building since construction:

1. The aforementioned fountains have been taken out. (Only the fountain mechanisms were actually removed.)
2. The front and rear doors have been replaced.
3. Handicapped access ramps have been installed.
4. There have been several interior alterations, the most noteworthy being the lowering of the ceilings.

Despite these changes, the hall still retains the architectural features for which it is considered significant. (See Item 8.)

8. Significance

Period	Areas of Significance—Check and justify below			
<input type="checkbox"/> prehistoric	<input type="checkbox"/> archeology-prehistoric	<input type="checkbox"/> community planning	<input type="checkbox"/> landscape architecture	<input type="checkbox"/> religion
<input type="checkbox"/> 1400-1499	<input type="checkbox"/> archeology-historic	<input type="checkbox"/> conservation	<input type="checkbox"/> law	<input type="checkbox"/> science
<input type="checkbox"/> 1500-1599	<input type="checkbox"/> agriculture	<input type="checkbox"/> economics	<input type="checkbox"/> literature	<input type="checkbox"/> sculpture
<input type="checkbox"/> 1600-1699	<input checked="" type="checkbox"/> architecture	<input type="checkbox"/> education	<input type="checkbox"/> military	<input type="checkbox"/> social/
<input type="checkbox"/> 1700-1799	<input type="checkbox"/> art	<input type="checkbox"/> engineering	<input type="checkbox"/> music	<input type="checkbox"/> humanitarian
<input type="checkbox"/> 1800-1899	<input type="checkbox"/> commerce	<input type="checkbox"/> exploration/settlement	<input type="checkbox"/> philosophy	<input type="checkbox"/> theater
<input checked="" type="checkbox"/> 1900-	<input type="checkbox"/> communications	<input type="checkbox"/> industry	<input type="checkbox"/> politics/government	<input type="checkbox"/> transportation
		<input type="checkbox"/> invention		<input type="checkbox"/> other (specify)

Specific dates 1934 **Builder/Architect** Architects: Weiss, Dreyfous, and Seiferth

Statement of Significance (in one paragraph) Criterion C

McGehee Hall is locally significant in the area of architecture within the context of the city of Hammond. It represents the work of Weiss, Dreyfous and Seiferth, one of Louisiana's most prominent early twentieth century architectural firms. The firm is best known for its tremendous output (about 400 commissions) and the fact that it received some of the state's most prestigious commissions, including the Louisiana State Capitol, the Old Governor's Mansion, much of the LSU campus, and Charity Hospital in New Orleans. Of the 200 or so early twentieth century structures in the Hammond vicinity, McGehee Hall is the only example of the firm's work. It is also the city's only example of the work of a high style regionally recognized practitioner. All the other period buildings reflect the builder tradition. In addition, McGehee Hall is one of Hammond's grandest early twentieth century structures. It is the only one to feature three pavilions with a colossal pedimented entrance.

Historical Note:

Southeastern Louisiana University was founded in 1925 as Hammond Junior College. In 1928 it was brought into the state system of higher education and renamed Southeastern Louisiana College. The present campus site was purchased in 1927. McGehee Hall was named for Dr. Lucius McGehee, one of the school's founders.

9. Major Bibliographical References

History of Southeastern Louisiana University found in 50th anniversary booklet,
Copy in National Register file, LA State Historic Preservation Office,

10. Geographical Data

Acreeage of nominated property @2/3rds of an acre

Quadrangle name Hammond, LA

Quadrangle scale 1:62500

UTM References

A

1	5	7	4	3	0	5	0	3	3	7	8	0	0	0
Zone			Easting					Northing						

B

Zone			Easting					Northing						

C

Zone			Easting					Northing						

D

Zone			Easting					Northing						

E

Zone			Easting					Northing						

F

Zone			Easting					Northing						

G

Zone			Easting					Northing						

H

Zone			Easting					Northing						

Verbal boundary description and justification Please refer to enclosed sketch map. Boundaries were drawn to discretely encompass the significant resource. To have nominated the entire plot of land under single ownership would have required listing the whole campus, most of which is less than 50 years old. Hence a rectangle of land was selected to encompass McGehee

List all states and counties for properties overlapping state or county boundaries

Hall.

state N/A code county code

state code county code

11. Form Prepared By

name/title National Register Staff
Division of Historic Preservation

ASSISTED BY DR. J. LARRY CRAIN,
President, Southeastern
Louisiana University

organization State of Louisiana

date October, 1984

street & number P. O. Box 44247

telephone (504) 922-0358

city or town Baton Rouge

state LA 70804

12. State Historic Preservation Officer Certification

The evaluated significance of this property within the state is:

national state local

As the designated State Historic Preservation Officer for the National Historic Preservation Act of 1966 (Public Law 89-665), I hereby nominate this property for inclusion in the National Register and certify that it has been evaluated according to the criteria and procedures set forth by the National Park Service.

State Historic Preservation Officer signature

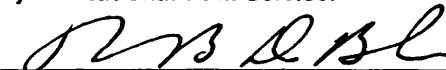

Robert B. DeBlieux

title State Historic Preservation Officer

date December 10, 1984

For NPS use only

I hereby certify that this property is included in the National Register

Entered in the
National Register

date

1/18/85

Keeper of the National Register

Attest:

date

Chief of Registration

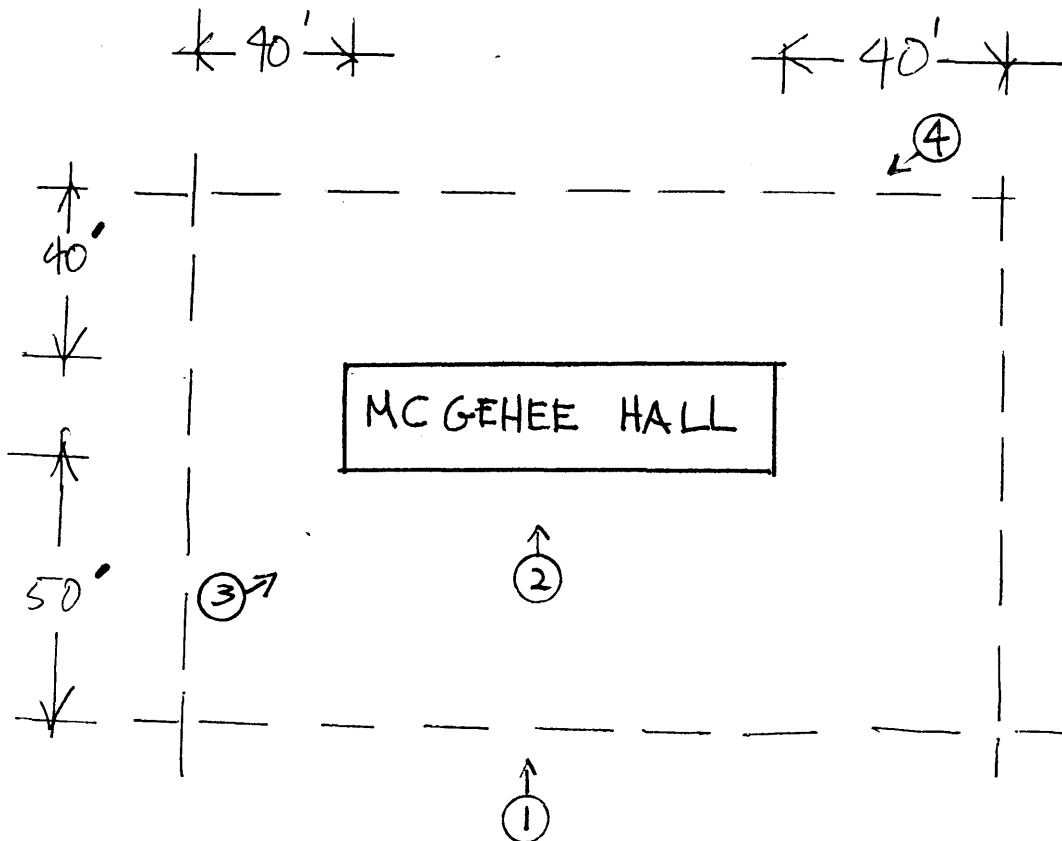

BOUNDARY LINES PARALLEL BUILDING
FACADES AT DISTANCES SHOWN

APPROX. 2/3 ACRE

(NOT TO SCALE)

BOUNDARY



McGehee Hall, Southeastern Louisiana University
Hammond, Tangipahoa Parish