

ARIZONA STATE HISTORIC PROPERTY INVENTORY

IDENTIFICATION

SURVEY AREA NAME: Kingman Historic Resources Survey
 HISTORIC NAME: Desert Power & Water Co., Electric Power Plant
 ADDRESS/LOCATION: See Additional Description
 CITY/TOWN: Kingman
 TAX PARCEL NUMBER: 303-06-16
 OWNER: Citizens Utilities
 OWNER ADDRESS: P.O. Box 3099
Kingman, AZ 86402
 HISTORIC USE: power plant
 PRESENT USE: vacant
 BUILDING TYPE: industrial
 STYLE: NA
 CONSTRUCTION DATE: 1907-08; additions, 1909, 1910, 1911
 ARCHITECT/BUILDER: Tracy Engineering Co., McCafe Contracting Co., (Los Angeles)
 INTEGRITY: original site/unaltered
 CONDITION: good/maintained

COUNTY: Mohave SURVEY SITE: 6-1
 USGS QUAD: Kingman Quadrangle (171)
 T 21 N R 17 W S 23 / SE 1/4 OF THE 1/4
 UTM Zone 11, E-767870, N-3897770

Description (contd.)

ROOF TYPE: gable - steep pitch-iron truss
 ROOF SHEATHING: corrugated metal
 EAVES TREATMENT: open- gable ends metal covered
 WINDOWS: double hung 1/1, 4/4 double hung, segmental arches, both long and short
 ENTRY: double entry at south, original
 PORCHES: NA
 STOREFRONTS: NA

DESCRIPTION

STORIES: 1 DIMENSIONS: (l) 155 (w) 110
 STRUCTURAL MATERIAL: cast-in-place concrete
 FOUNDATION MATERIAL: concrete
 WALL SHEATHING: none
 APPLIED ORNAMENT: concrete stepped back pilasters

NOTABLE INTERIOR: _____
 OUTBUILDINGS: some original buildings extant power grid extant
 ALTERATIONS: no

PHOTOGRAPH

PHOTOGRAPHER: J. Garrison
 DATE: 4/84 VIEW: Southwest

SKETCH MAP:

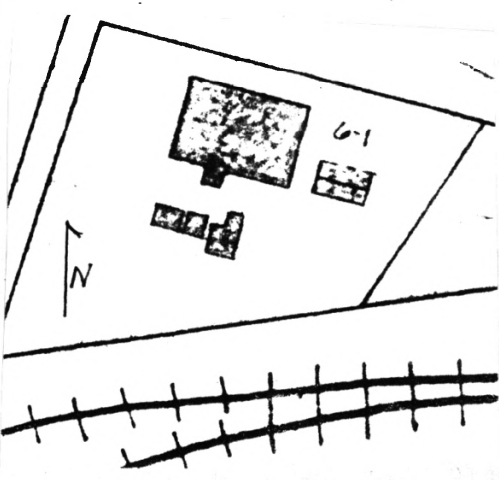

ADDITIONAL DESCRIPTION/ANALYSIS (annotated form):

Gable - roofed ventilator extends length of ridge of roof.

Walls are 14" thick.

Location: Bowers Addition: bounded by AT&SF Railroad tracks, Spillway Lane, Park Street, 1st Street.

SIGNIFICANCE:

AREAS OF SIGNIFICANCE: COMMERCE___ COMMUNITY PLANNING___ ECONOMICS___ X
EXPLORATION/SETTLEMENT___ GOVERNMENTAL___ MILITARY___ RELIGION___ SCIENCE___
THEATRE___ TRANSPORTATION___ TOURISM___ OTHER(specify) Mining - Power

HISTORIC ASSOCIATIONS (be concise):

PROMINENT OCCUPANT/HISTORIC ASSOCIATION(S) At the time of construction, the power plant was considered one of the largest steam generating plants on the Pacific Coast.

RELATIONSHIP TO LOCAL DEVELOPMENT Expresses importance of mining to community. (see b

CULTURAL AFFILIATIONS

ARCHITECTURAL STYLE

MAJOR ARCH. FORM/MATERIAL Very early use of cast-in-place concrete.

ENGINEERING/STRUCTURAL

DISTRICT/STREETScape CONTRIBUTION

DISCUSSION AS REQUIRED:

Three major buildings were built between 1907 and 1911: a power house, a transformer house and an office.

Built to transmit power to nearby mines and to provide electricity for Kingman. The greater supply of power to these mines allowed them to expand, thereby providing more commerce and freighting business to Kingman. The provision of power to Kingman was of secondary importance at the time.

CONTEXT: ISOLATED/RURAL X RESIDENTIAL STREET___ COMMERCIAL___ CENTRAL SQUARE___
CBD: X OTHER:___

BIBLIOGRAPHY/SOURCES:

Mohave County Miner: 1907-1911

LISTING IN OTHER SURVEYS:___

NATIONAL REGISTER STATUS:

LISTED___ DETERMINED ELIGIBLE___ DETERMINED NOT ELIGIBLE___ NOT EVALUATED___

COMMENTS/DEVELOPMENT PLANS/THREATS:

Ref: Kingman MRA
Item 8, p. 26

SURVEYOR Garrison/Myers SURVEY DATE April 1984 DATE FORM COMPLETED July 25, 1984