

HISTORIC PRESERVATION UNIT  
DEPARTMENT OF CULTURE & HISTORY  
SCIENCE & CULTURE CENTER  
CHARLESTON, WEST VIRGINIA 25305

File No.:  
Theme(s):  
Neg No(a):  
USGS Quad:  
UTM Ref: 17/451970/4346440

DISTRICT..SITE..BUILDING..STRUCTURE..OBJECT

1. NAME(S), historic/common: First Baptist Church  
*(Downtown Parkersburg, W.V.A.)*

2. LOCATION, street/road: 813 Market St.  
TAX MAP - LOT # (W corner of Market & 9th Sts.)  
80-72 city/town: Parkersburg, WV 26101  
(incorporated/unincorporated)

3. USE/FUNCTION, present: church (public/private, restricted)  
original: church

4. OWNER/ADDRESS, present: First Baptist Church (public/private)  
address above  
original: same as above

5. PHOTO/SKETCH OF: 8112-R2-F29-31  
8201-R2-F10-11

7. PLAN (include approx. dimensions):



6. LOCALE/ENVIRONMENT (map):

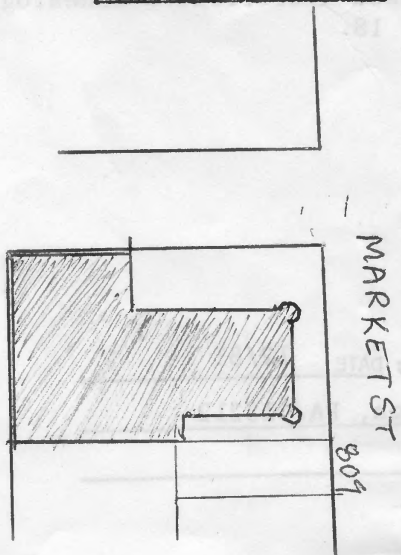

8. ACREAGE (approx): 150' x 100'  
City Lot No. 80-72  
(See No. 2)

MASONIC TEMPLE  
NINTH ST

COUNTY: Wood  
Survey Region: \_\_\_\_\_  
Planning District: \_\_\_\_\_

9. DESCRIPTION (clarify as appropriate): See attached

a. Exterior Fabric

stone \_\_\_\_\_  
brick red \_\_\_\_\_  
concrete \_\_\_\_\_  
stucco \_\_\_\_\_  
weatherboard \_\_\_\_\_  
clapboard \_\_\_\_\_  
board & batten \_\_\_\_\_  
shingle \_\_\_\_\_  
other \_\_\_\_\_

b. Structural System

masonry X \_\_\_\_\_  
frame \_\_\_\_\_  
log \_\_\_\_\_  
metal \_\_\_\_\_  
other \_\_\_\_\_  
foundation stone \_\_\_\_\_

c. Roofing Material

wood \_\_\_\_\_  
metal \_\_\_\_\_  
slate \_\_\_\_\_  
tile \_\_\_\_\_  
asphalt \_\_\_\_\_  
composition \_\_\_\_\_  
other metal steeple \_\_\_\_\_

d. Associated Structures (use/type):

outbuildings \_\_\_\_\_  
dependencies \_\_\_\_\_  
other \_\_\_\_\_

e. Integrity (include dates):

original site/relocated \_\_\_\_\_  
alterations steeple is replacement \_\_\_\_\_  
additions \_\_\_\_\_

f. Condition:

excellent \_\_\_\_\_  
good X \_\_\_\_\_  
fair \_\_\_\_\_  
deteriorated \_\_\_\_\_  
abandoned \_\_\_\_\_

g. Threats:

10. SIGNIFICANCE (use additional sheet if necessary):

- a. Architect/Builder/Engineer:  
Lysander Dudley
- b. Style/Period: Italianate
- c. Date(s): 1871 (sign on bldg.)

Organized by 24 people on October 11, 1817, this congregation built its first church structure in 1839. "Deacon Lysander Dudley presented plans of a church in his home town of Wallingford, Conn. and was appointed to superintend building a similar structure at the Ninth and Market location. The 1st meeting was held in the basement of the new church on January 2, 1872, and an Educational Building was added in 1959." Built at the height of the Italianate period, this church displays with excellent integrity the characteristic elements of the style.

11. BIBLIOGRAPHY:

The History of Wood County, WV. The West Augusta Historical & Genealogical Society, Taylor Publishing Co!, 1980, p. 18.

12. FORM PREPARED BY Eliza Smith, Christina Mann ; DATE 12/81
- a. Address Allegheny Square West, Pittsburgh, PA 15212
- b. Organization Landmarks Planning, Inc.

First Baptist Church

813 Market St. (W corner of Market & 9th Sts.)

80-72

Sited on a corner lot in the central business district, this is a 2 story, 3 by 6 bay gable roofed church with a central steeple on the facade (SE) and several additions to the rear (NW). Its gable roof is trimmed by an arched corbel table, corner turrets, and the polygonal steeple rising above an octagonal drum with arched ornament and large wooden corbels. The 2nd story windows, t/s, are round arched with hood molds; on the facade (SE), they contain round arched tracery. The 1st story windows are straight-topped on the side elevations. Three doorways open into the front (SE): a central one, framed by a large transom, tympanum, and compound arches, is flanked by smaller doorways with arched tympanums and hood molds. Rear additions include a large cement block section on the W which runs half the length of the nave and connects to the Oeldorf Building to the S; a 2nd wing at the N corner has a flat roof, corbeled cornice, tall arched windows on the NE side, and an arcaded porch across the SE.



First Baptist Church  
811 Market St. (W. corner of Market & 9th Sts.)

80-77

Sited on a corner lot in the central business district, this is a 2 story,  
1 by 2 bay gable roofed church with a central steeple in the facade (SE).  
and several additions to the rear (NW). The gable roof is trimmed by an  
arched metal fascia, corner finials, and the polygonal steeple rising above  
an octagonal drum with arched ornament and large wooden belfry. The end  
gable windows, 1/2, are round arched with hood moldings on the facade (SE). They  
contain round arched tracery. The flat story windows are straight-topped on  
the side elevations. Three doorways open into the front (SE): a central one,  
flanked by a pair of Kansas, Lymanus, and compound arches, is flanked by  
earlier doorway  
a large cement  
and connects to  
a flat roof, to  
arched porch

