

**United States Department of the Interior  
Heritage Conservation and Recreation Service**

**National Register of Historic Places  
Inventory—Nomination Form**

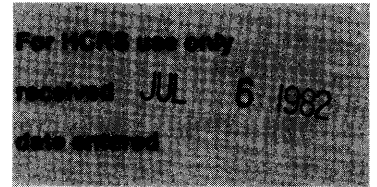

See instructions in *How to Complete National Register Forms*  
Type all entries—complete applicable sections

**1. Name**

historic Arlington Plantation House

and/or common Same

**2. Location**

street & number 2 miles west of Washington on Bayou Courtableau <sup>N</sup> <sup>off LA 103</sup> N/A not for publication

city, town Washington <sup>Me.</sup>  vicinity of congressional district 8th - Gillis Long

state LA code 22 <sup>parish</sup> St. Landry code 097

**3. Classification**

Category	Ownership	Status	Present Use
<input type="checkbox"/> district	<input type="checkbox"/> public	<input checked="" type="checkbox"/> occupied	<input type="checkbox"/> agriculture
<input checked="" type="checkbox"/> building(s)	<input checked="" type="checkbox"/> private	<input type="checkbox"/> unoccupied	<input type="checkbox"/> commercial
<input type="checkbox"/> structure	<input type="checkbox"/> both	<input type="checkbox"/> work in progress	<input type="checkbox"/> educational
<input type="checkbox"/> site	<b>Public Acquisition</b>	<b>Accessible</b>	<input type="checkbox"/> entertainment
<input type="checkbox"/> object	<u>N/A</u> in process	<input checked="" type="checkbox"/> yes: restricted	<input type="checkbox"/> government
	<u>N/A</u> being considered	<input type="checkbox"/> yes: unrestricted	<input type="checkbox"/> industrial
		<input type="checkbox"/> no	<input type="checkbox"/> military
			<input type="checkbox"/> museum
			<input type="checkbox"/> park
			<input checked="" type="checkbox"/> private residence
			<input type="checkbox"/> religious
			<input type="checkbox"/> scientific
			<input type="checkbox"/> transportation
			<input type="checkbox"/> other:

**4. Owner of Property**

name Mr. and Mrs. Robert Louis Olivier

street & number P. O. Box 85

city, town Washington N/A vicinity of state LA 70589

**5. Location of Legal Description**

courthouse, registry of deeds, etc. St. Landry Parish Courthouse

street & number P. O. Box 750 Corner of Court and Landry Streets (no specific no.)

city, town Opelousas state LA 70570

**6. Representation in Existing Surveys**

title LA Historic Sites Survey has this property been determined eligible?  yes  no

date 1980  federal  state  county  local

depository for survey records Louisiana State Historic Preservation Office

city, town Baton Rouge state LA

---

## 7. Description

---

**Condition**

excellent  
 good  
 fair

deteriorated  
 ruins  
 unexposed

**Check one**

unaltered  
 altered

**Check one**

original site  
 moved date N/A

---

**Describe the present and original (if known) physical appearance**

Arlington (1829) is a large brick and frame plantation house with an unusual design. It is set on gently rolling farmland approximately two miles west of the town of Washington. There have been some changes since construction; however, none of them have substantially diminished the features which make Arlington architecturally significant.

The 2-1/2 story house has solid common bond brick walls on the first story and brick sides with frame front and back walls on the second. The first and second stories have central halls with two rooms on each side. All fireplaces are set against the exterior side walls of the house. One of the downstairs fireplaces is twice as wide as any of the others. The room in which it is located was the original plantation kitchen, which is highly unusual inasmuch as most plantation kitchens were separate buildings. Originally the kitchen had a dirt floor, which is now bricked over. Another unusual feature of the house is its cellar which is set opposite the kitchen. The original cellar stairs descend between the front and rear rooms on the north side of the house. The second floor is reached by means of an original rear gallery staircase. Most of the mantels are simple massive aedicule motifs with heavy cyma recta moldings or plain beveled molding. Most of the windows and doors have shoulder molded frames. The only exception is in the parlor on the second story where the windows and doors have full entablatures with drip cornices. Windows are six over six and doors have four panels.

The five bay facade has an unusual, perhaps unique, one bay, three story porch composed of brick columns which terminates in a single massive pedimented dormer. The rear porch is a more conventional gallery with brick columns below and wooden Doric pillars above. The only unusual feature is a pair of three foot deep closets at either end of the upper gallery. These are much smaller than a normal cabinet.

In the late nineteenth century the following changes were made:

- (1) The present staircase with its heavy turned newel post was installed in the hall.
- (2) The second floor parlor received plate glass windows and a marble mantel.

Twentieth century changes include:

- (1) The bricking over of the dirt floor in the kitchen.
- (2) The installation of salvaged cast-iron balustrades on the second story of the aforementioned single bay porch.
- (3) The installation of a set of French doors complete with transom and side lights on the facade of the massive dormer atop the main facade.
- (4) The installation of latticework on a small portion of the second story rear gallery.

Continued. . .

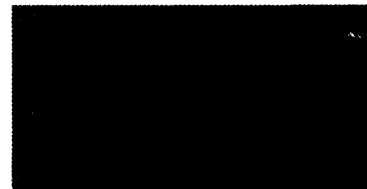
**United States Department of the Interior  
Heritage Conservation and Recreation Service****National Register of Historic Places  
Inventory—Nomination Form**

Continuation sheet    Arlington

Item number    7

Page    2

## 7. Description (cont'd)

## Assessment of Integrity

None of these changes have substantially diminished the five features which give Arlington its architectural significance. These features include the cellar, kitchen, portico, cabinets and rear gallery stairs.

Although the floor was bricked over, the kitchen is still easily recognizable as such. Despite the changes, the portico retains its stature as a unique feature. Its uniqueness did not depend upon the windows of the dormer or the design of the balustrade. The cabinets, stairs and cellar have been unaffected by the changes.

# 8. Significance

Period	Areas of Significance—Check and justify below			
<input type="checkbox"/> prehistoric	<input type="checkbox"/> archeology-prehistoric	<input type="checkbox"/> community planning	<input type="checkbox"/> landscape architecture	<input type="checkbox"/> religion
<input type="checkbox"/> 1400–1499	<input type="checkbox"/> archeology-historic	<input type="checkbox"/> conservation	<input type="checkbox"/> law	<input type="checkbox"/> science
<input type="checkbox"/> 1500–1599	<input type="checkbox"/> agriculture	<input type="checkbox"/> economics	<input type="checkbox"/> literature	<input type="checkbox"/> sculpture
<input type="checkbox"/> 1600–1699	<input checked="" type="checkbox"/> architecture	<input type="checkbox"/> education	<input type="checkbox"/> military	<input type="checkbox"/> social/ humanitarian
<input checked="" type="checkbox"/> 1700–1799	<input type="checkbox"/> art	<input type="checkbox"/> engineering	<input type="checkbox"/> music	<input type="checkbox"/> theater
<input type="checkbox"/> 1800–1899	<input type="checkbox"/> commerce	<input type="checkbox"/> exploration/settlement	<input type="checkbox"/> philosophy	<input type="checkbox"/> transportation
<input type="checkbox"/> 1900–	<input type="checkbox"/> communications	<input type="checkbox"/> industry	<input type="checkbox"/> politics/government	<input type="checkbox"/> other (specify)
	<input type="checkbox"/> invention			

**Specific dates** 1829 **Builder/Architect** Builder - Major Amos Webb

**Statement of Significance (in one paragraph)** Criterion C

Arlington is architecturally significant on the state level for two reasons:

- (1) It is a landmark in the assimilation of the Greek Revival taste into native Louisiana plantation house architecture. This process is an important aspect of Louisiana's architectural heritage.
- (2) It is extremely unusual to find an interior kitchen and cellar in an antebellum plantation house in Louisiana.

When the Anglo-American Greek Revival influence came to Louisiana in the 1820's, it was not totally absorbed. During the next thirty years a number of Greek Revival "deviations" were created in which Greek Revival and native Louisiana characteristics were mixed. This body of architecture is a major part of Louisiana's material cultural identity.

Arlington is a landmark within the context of this architectural heritage because it is an important example of the grafting of French Creole and local features onto a basic two-story Greek Revival central hall plan plantation house. These features include the small cabinets, the rear gallery stairs, and the use of brick construction on the first story and wood frame construction on part of the second story.

Another local characteristic (though not necessarily Creole) is the large central dormer. At Arlington it is exaggerated into a unique fully developed two-story portico.

This set of features, particularly the unusual closet size cabinets and the unique dormer-portico, produces a design which deviates from the Greek Revival norm more than most other examples of Greek Revival adaptation in Louisiana. Hence Arlington is an important part of the state's distinctive architectural heritage.

Arlington is additionally significant because it has an interior kitchen and cellar. These two features are virtually unheard of in pre-1870 Louisiana plantation houses.

# 9. Major Bibliographical References

Chain of Title, St. Landry Parish Courthouse

# 10. Geographical Data

Acreeage of nominated property approx. 1.16 acres

Quadrangle name Opelousas, LA

Quadrangle scale 1:62,500

### UMT References

A 

1	5	5	8	8	9	2	5	3	3	9	0	6	2	5
Zone	Easting				Northing									

B 

Zone	Easting				Northing									

C 

Zone	Easting				Northing									

D 

Zone	Easting				Northing									

E 

Zone	Easting				Northing									

F 

Zone	Easting				Northing									

G 

Zone	Easting				Northing									

H 

Zone	Easting				Northing									

### Verbal boundary description and justification

See attached sketch map.

### List all states and counties for properties overlapping state or county boundaries

state N/A code county code

state code county code

# 11. Form Prepared By

name/title Mr. and Mrs. Robert Louis Olivier

organization N/A date December 1980

street & number P. O. Box 85 telephone (318) 826-3298

city or town Washington state LA 70589

# 12. State Historic Preservation Officer Certification

The evaluated significance of this property within the state is:

national  state  local

As the designated State Historic Preservation Officer for the National Historic Preservation Act of 1966 (Public Law 89-665), I hereby nominate this property for inclusion in the National Register and certify that it has been evaluated according to the criteria and procedures set forth by the Heritage Conservation and Recreation Service.

State Historic Preservation Officer signature 

title State Historic Preservation Officer date June 25, 1982

For HCRS use only

I hereby certify that this property is included in the National Register



Keeper of the National Register

date 8/16/82

Attest: \_\_\_\_\_ date \_\_\_\_\_

Chief of \_\_\_\_\_

# Arlington House

TO BAYOU LOURTABLEAU

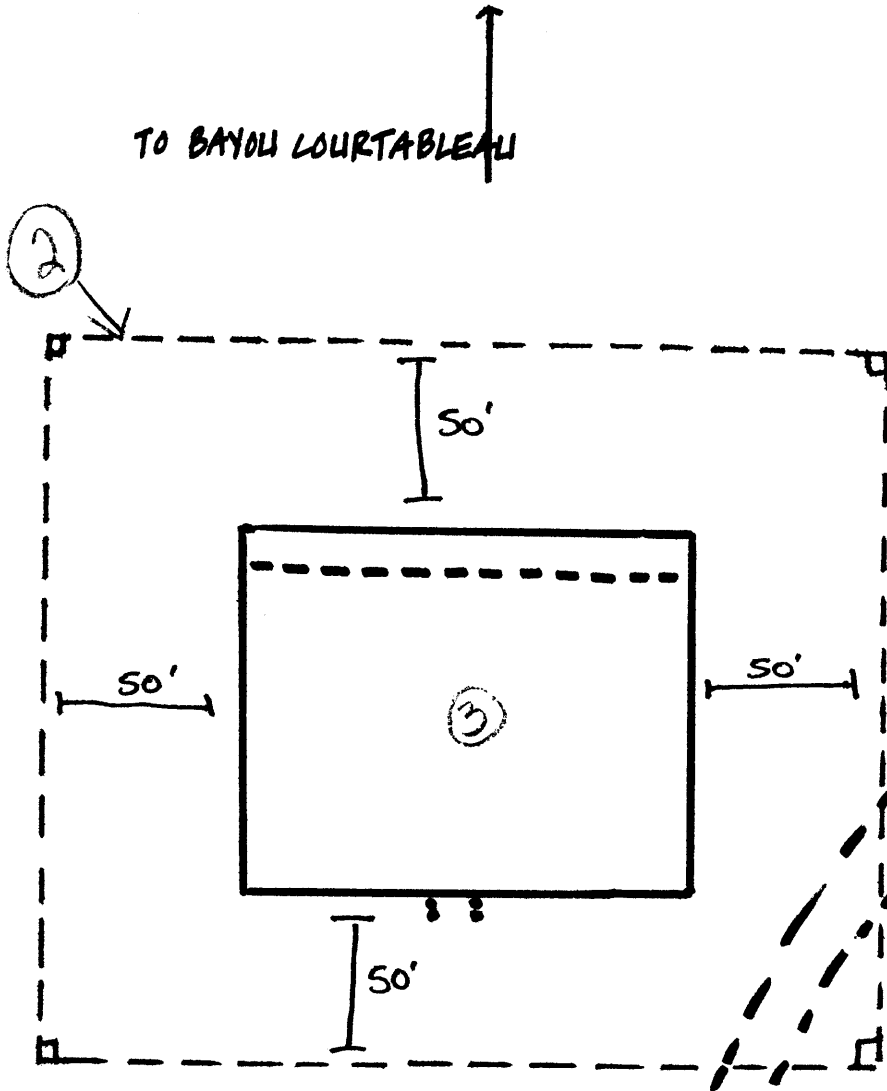

NB: USGS map does not show the correct location of the gravel approach road. As can be seen in Photo 1, the sketch map is correct.

NOTE: SITE BOUNDARIES PARALLEL BLDG. FALADES AT DISTANCES SHOWN.

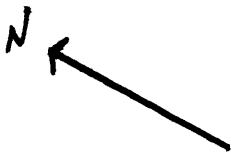

SCALE 1" = 50' APPROX.

TO WASHINGTON