

United States Department of the Interior
National Park Service

National Register of Historic Places
Inventory—Nomination Form

See instructions in *How to Complete National Register Forms*
Type all entries—complete applicable sections

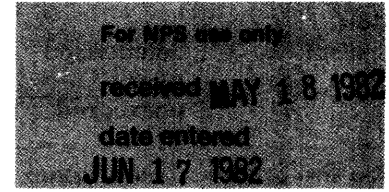

1. Name

historic Burwell O. Hill House

and/or common

2. Location

street & number La Grange Street

N/A not for publication

city, town Greenville

N/A vicinity of

~~Congressional district~~

state Georgia

code 013

county Meriwether

code 199

3. Classification

Category	Ownership	Status	Present Use	
<input type="checkbox"/> district	<input type="checkbox"/> public	<input checked="" type="checkbox"/> occupied	<input type="checkbox"/> agriculture	<input type="checkbox"/> museum
<input checked="" type="checkbox"/> building(s)	<input checked="" type="checkbox"/> private	<input type="checkbox"/> unoccupied	<input type="checkbox"/> commercial	<input type="checkbox"/> park
<input type="checkbox"/> structure	<input type="checkbox"/> both	<input type="checkbox"/> work in progress	<input type="checkbox"/> educational	<input checked="" type="checkbox"/> private residence
<input type="checkbox"/> site	Public Acquisition	Accessible	<input type="checkbox"/> entertainment	<input type="checkbox"/> religious
<input type="checkbox"/> object	<u>N/A</u> in process	<input checked="" type="checkbox"/> yes: restricted	<input type="checkbox"/> government	<input type="checkbox"/> scientific
	<input type="checkbox"/> being considered	<input type="checkbox"/> yes: unrestricted	<input type="checkbox"/> industrial	<input type="checkbox"/> transportation
		<input type="checkbox"/> no	<input type="checkbox"/> military	<input type="checkbox"/> other:

4. Owner of Property

name Mary Ellen Hill and J. Render Hill

street & number Box 246

city, town Greenville

N/A vicinity of

state Georgia 30222

5. Location of Legal Description

courthouse, registry of deeds, etc. Superior Court

street & number Meriwether County Courthouse

city, town Greenville

state Georgia

6. Representation in Existing Surveys

title None

has this property been determined eligible? yes no

date N/A federal state county local

depository for survey records None

city, town

state

7. Description

Condition		Check one	Check one	
<input type="checkbox"/> excellent	<input type="checkbox"/> deteriorated	<input type="checkbox"/> unaltered	<input checked="" type="checkbox"/> original site	
<input checked="" type="checkbox"/> good	<input type="checkbox"/> ruins	<input checked="" type="checkbox"/> altered	<input type="checkbox"/> moved	date _____
<input type="checkbox"/> fair	<input type="checkbox"/> unexposed			

Describe the present and original (if known) physical appearance

The Burwell O. Hill House, built in 1893, is a late-Victorian style house with typical Victorian decoration. In 1909, the original two-story Victorian porch on the front facade was replaced by a massive two-story Neo-Classical portico, which gives the house, at first glance, a Neo-Classical appearance. The house sits on fifteen acres located on Highway 109 (La Grange Street) at the western edge of Greenville, Meriwether County, Georgia.

The Hill House is weatherboarded, sits on a brick and stone foundation, and has a gable roof covered with metal shingles. The house is asymmetrically massed with the exception of the 1909 pedimented portico which is centered on the front facade. This portico features a Palladian style window in the pediment and four massive two-story Corinthian columns. Dentils highlight the frieze and the pediment. A full-width second story balcony with a simple balustrade extends out to meet the columns. A one-story side porch supported by three smaller Corinthian columns juts out from the west side of the portico and protects an entrance that leads directly into the dining room. In 1909, at the time of the remodeling, the front wing from which the portico projects was expanded to the east side to make it symmetrical with the main body of the house. Little attempt was made to alter the rest of the house, and, consequently, numerous features of the original 1893 Victorian-style house are still in evidence. Gable ends feature decorative shingle work and a series of diamond-shaped decorations on the underside of the projecting eaves. Two bands of decorative woodwork run around most of the house, a frieze with a dentil-like pattern in very low relief, and, between the water table and the first floor windows, panels of diagonal tongue and groove boards. The house has five brick exterior end chimneys; the three main ones, located on the gable ends and the westside of the front wing, have decorative terra cotta tiles inlaid in the brick. The majority of windows have two-over-two double hung sash. Four windows in the front wing have small squares of stained glass around the exterior of the upper sash. The first floor front window to the west of the front door is still flanked by sawn woodwork decoration from the Victorian facade treatment.

The interior of the Hill House is completely Victorian in plan and detailing. The front door leads directly into a living room created from the original stair-hall when the front wing was extended to the east during the 1909 remodeling. To its west is a formal parlor. An open two-run stair leads from a now-closed, approximately central, stairhall (once open to the living room) to the second floor. To the west of the stairhall is the dining room; to the east are two bedrooms. The house has had two kitchens. The present, and perhaps older kitchen, is attached to the main part of the house behind the dining room and breakfast room. A second, reportedly newer yet now unused kitchen, was added at the rear and is attached to the house by an ell-shaped porch which covers the well. The east end of this porch has been enclosed to form a storage room and bathroom. The second floor of the house consists of four bedrooms separated by a central hall and three small rooms to the north, probably added in 1909, which serve as a bathroom, dressing room and large closet. The original plaster walls are nearly all covered with wallpaper. The west front parlor has a plaster cove ceiling; upstairs ceilings are of tongue and groove boards. Modest Victorian mantels are located in nearly every room. The east back bedroom has a fine antebellum mantel not original to the house. Window and

(Continued)

**United States Department of the Interior
Heritage Conservation and Recreation Service**

**National Register of Historic Places
Inventory—Nomination Form**

For HCERS use only

received

date entered

Continuation sheet Description Item number 7 Page 2

door surrounds have molded trim meeting at corner blocks. Between the parlor and dining room are large hinged double doors. The dining room and stairhalls on both floors have tongue and groove wainscoting. Original lighting fixtures remain, as well as evidence of the original knob and tube wiring located in a fuse box in the upstairs stairhall.

The Hill House property is located on Georgia Highway 109 (La Grange Street) at the entrance to Greenville from La Grange. It is the first of a series of historic homes which line the street as it approaches the courthouse square. Originally the Hill House property was a farm, located outside the city limits, and the remaining acreage still retains some characteristics of a country property. A grove of oak trees is located to the west of the house. To the rear of the house is a large pasture which once abutted a peach orchard. Between it and the house are two historic wood frame outbuildings. Closest to the house is a smokehouse, now adapted to serve as a garage. Further to the northeast is a storage building which probably served originally as a carriage house. To the west of the house is the site of an early twentieth century tenant house, and to the north, near the pasture, is the site of a two-story dairy barn, demolished in the 1950's, which dated from about 1915. A semi-circular driveway encircles the house and a gravel parking area is located just off the road in front of the house. The area immediately around the house is landscaped with a lawn, large oak trees, the remains of a formal garden to the east, and shrub and boxwood foundation plantings. A brick walk leads to the front entrance. Originally, La Grange Street was located much closer to the house, and the property was separated from the street by a picket fence. Today, oak and pecan trees in the area of the old road shelter the house from the present street.

BOUNDARY

The boundary of the nominated property constitutes the remaining intact acreage associated with the Hill House and owned by the current owners. The property is outlined with a heavy black line on the enclosed plat.

PHOTOGRAPHS

The Historic Preservation Section has determined that the photographs taken in May, 1981 still represent the character and appearance of the property. No significant changes have been made since that date.

8. Significance

Period	Areas of Significance—Check and justify below			
<input type="checkbox"/> prehistoric	<input type="checkbox"/> archeology-prehistoric	<input type="checkbox"/> community planning	<input type="checkbox"/> landscape architecture	<input type="checkbox"/> religion
<input type="checkbox"/> 1400–1499	<input type="checkbox"/> archeology-historic	<input type="checkbox"/> conservation	<input type="checkbox"/> law	<input type="checkbox"/> science
<input type="checkbox"/> 1500–1599	<input type="checkbox"/> agriculture	<input type="checkbox"/> economics	<input type="checkbox"/> literature	<input type="checkbox"/> sculpture
<input type="checkbox"/> 1600–1699	<input checked="" type="checkbox"/> architecture	<input type="checkbox"/> education	<input type="checkbox"/> military	<input type="checkbox"/> social/ humanitarian
<input type="checkbox"/> 1700–1799	<input type="checkbox"/> art	<input type="checkbox"/> engineering	<input type="checkbox"/> music	<input type="checkbox"/> theater
<input checked="" type="checkbox"/> 1800–1899	<input type="checkbox"/> commerce	<input type="checkbox"/> exploration/settlement	<input type="checkbox"/> philosophy	<input type="checkbox"/> transportation
<input checked="" type="checkbox"/> 1900–	<input type="checkbox"/> communications	<input type="checkbox"/> industry	<input type="checkbox"/> politics/government	<input checked="" type="checkbox"/> other (specify) local history
<input type="checkbox"/> invention				
Specific dates	1893, 1909	Builder/Architect	W. A. Steed	

Statement of Significance (in one paragraph)

The Burwell O. Hill House is significant in the areas of architecture, local history and historic archaeology. Architecturally, it is significant as a structure that evolved from a late-Victorian style house to one in the Neo-Classical style in just over fifteen years. It documents how very quickly the Victorian style went out of fashion in at least one part of Georgia. In terms of local history the house is significant as the home of the Burwell O. Hill family which included a prominent Meriwether County farmer and two Georgia State Senators. Historic archaeological significance is based on inferred potential for information which might be gathered from excavating the known sites of two outbuildings. The above areas of significance support property eligibility under National Register Criteria B, C and D.

The Hill House was built in 1893 in a late-Victorian style with much wood ornamentation and a two-story veranda with typical gingerbread detailing. Most of this fine woodwork remains on both the exterior and interior, including cut shingles in the gable ends, a decorative frieze and paneled water table which wrap around the house, inlaid terra cotta panels in the chimneys and incised wood mantels. The original Victorian style house was designed by W. A. Steed, an architect/builder from nearby Newnan, Georgia who was the brother-in-law of Mrs. Hill. In 1909, in order to keep up with the latest fashion in residential architecture, the two-tier Victorian veranda was removed and replaced by a more imposing Neo-Classical portico, complete with denticulated pediment, Palladian style window and Corinthian columns. Little was done to the interior of the house at this time.

The Neo-Classical style achieved widespread popularity in this country following its introduction at the Chicago Columbian Exposition 1893. In Georgia, it quickly became the accepted style for residences built by men of means and prestige. The Hill family may have been prompted to do their remodeling by the appearance of a splendid Neo-Classical house further along La Grange Street. The short span of time, only sixteen years, between the house's original construction date and the Neo-Classical remodeling documents the rapid demise of Victorian styles at the turn of the century.

The Hill House was built by Burwell O. Hill (1856–1918), a prominent Meriwether County farmer. His son, Obadiah W. Hill (1888–1956), who lived there after 1918, was a merchant and farmer who served in the Georgia House and Senate during the 1940's and 1950's. He was succeeded by his son, J. Render Hill, who is presently a State Senator and a current owner of the house. It is significant that the house has remained in the same family since its construction in 1893.

No formal archaeology has been done on the property. Archaeological significance is based on inferred potential for information which might be gathered from the identified sites of an early twentieth century tenant house and a ca. 1914 two story dairy barn. This information could contribute to an understanding of Burwell Hill's agricultural activities and practices.

ITEM NOT VERIFIED
ACREAGE NOT VERIFIED

9. Major Bibliographical References

See attached sheet

10. Geographical Data

Acreeage of nominated property 15 acres

Quadrangle name Greenville, GA

Quadrangle scale 1:24000

UMT References

A

116	7112	51810	316	516	41010
Zone	Easting				

B

116	7112	71910	316	516	41010
Zone	Easting				

C

116	7112	71710	316	516	11710

D

116	7112	51710	316	516	01610

E

F

G

H

Verbal boundary description and justification

See verbal boundary description and justification in Section 7.

List all states and counties for properties overlapping state or county boundaries

state N/A code county code

state code county code

11. Form Prepared By

name/title Carolyn Brooks, National Register Researcher

organization Historic Preservation Section

Georgia Department of Natural Resources date March 25, 1982

street & number 270 Washington Street., SW

telephone 404/656-2840

city or town Atlanta

state Georgia

12. State Historic Preservation Officer Certification

The evaluated significance of this property within the state is:

national state local

As the designated State Historic Preservation Officer for the National Historic Preservation Act of 1966 (Public Law 89-665), I hereby nominate this property for inclusion in the National Register and certify that it has been evaluated according to the criteria and procedures set forth by the National Park Service.

State Historic Preservation Officer signature

Elizabeth A. Lyon
Elizabeth A. Lyon

title State Historic Preservation Officer

date 4/30/82

For NPS use only

I hereby certify that this property is included in the National Register

Entered in the
National Register

date 6/17/82

Albion Byers
Keeper of the National Register

Attest:

date

Chief of Registration

**United States Department of the Interior
Heritage Conservation and Recreation Service**

**National Register of Historic Places
Inventory—Nomination Form**

For HCRS use only
received
date entered

Continuation sheet

Bibliography

Item number

9

Page

2

Davidson, William H. Brooks of Honey and Butter. Alexander City, Ala: Outlook Publishing Co., 1971.

Golson, Maurie. Draft National Register Nomination. On file Historic Preservation Section, Georgia Department of Natural Resources.

Jeff Davis County Ledger, Hazelhurst, Georgia. November 18, 1971.

La Grange Daily News, La Grange, Georgia. December 9, 1970.

Manchester Star, Manchester, Georgia. September 30, 1971.

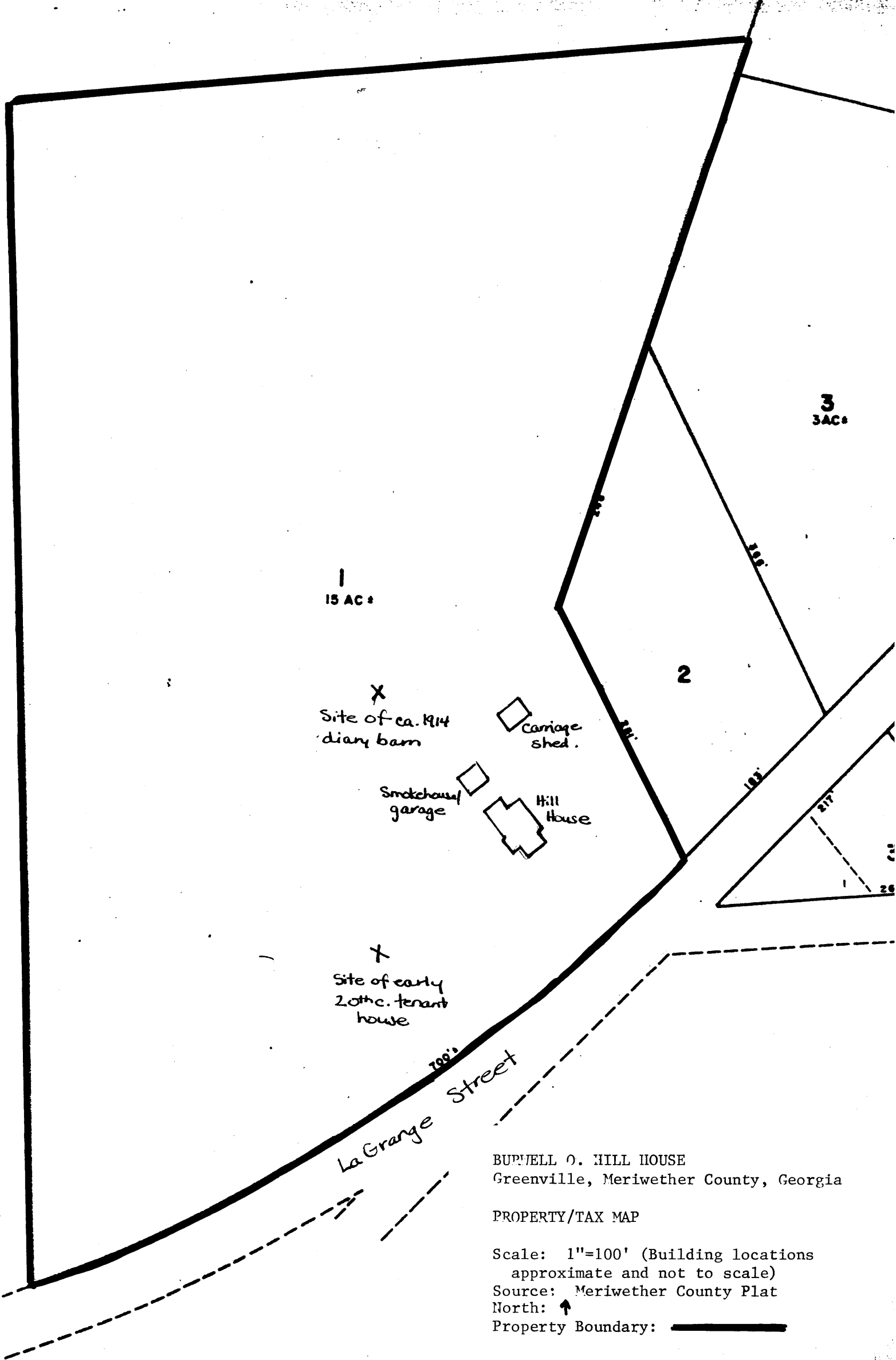

1
15 AC ±

3
3 AC ±

2

X
Site of ca. 1914
dairy barn

Carriage
shed.

Smokehouse/
garage

Hill
House

X
Site of early
20thc. tenant
house

La Grange Street

BUPWELL O. HILL HOUSE
Greenville, Meriwether County, Georgia

PROPERTY/TAX MAP

Scale: 1"=100' (Building locations
approximate and not to scale)

Source: Meriwether County Plat

North: ↑

Property Boundary: **—————**