

Planting Plan for Estate of

M. R. P. WOODS

Lincoln Nebraska

Scale 1 inch = 10 feet

APRIL 1916



Note 1. - Rows to be Caroline Island, Kollanoyah and pink, Grass as light American Beauty, Mrs. John Deery, Mexican Royal Victoria, Dutch Broomer.

Note 2. - Ground level plant with grass, ferns, iris, spike rubies, great lobelia, and arrowhead.

Note 3. - Hedges to be planted in walls of house.

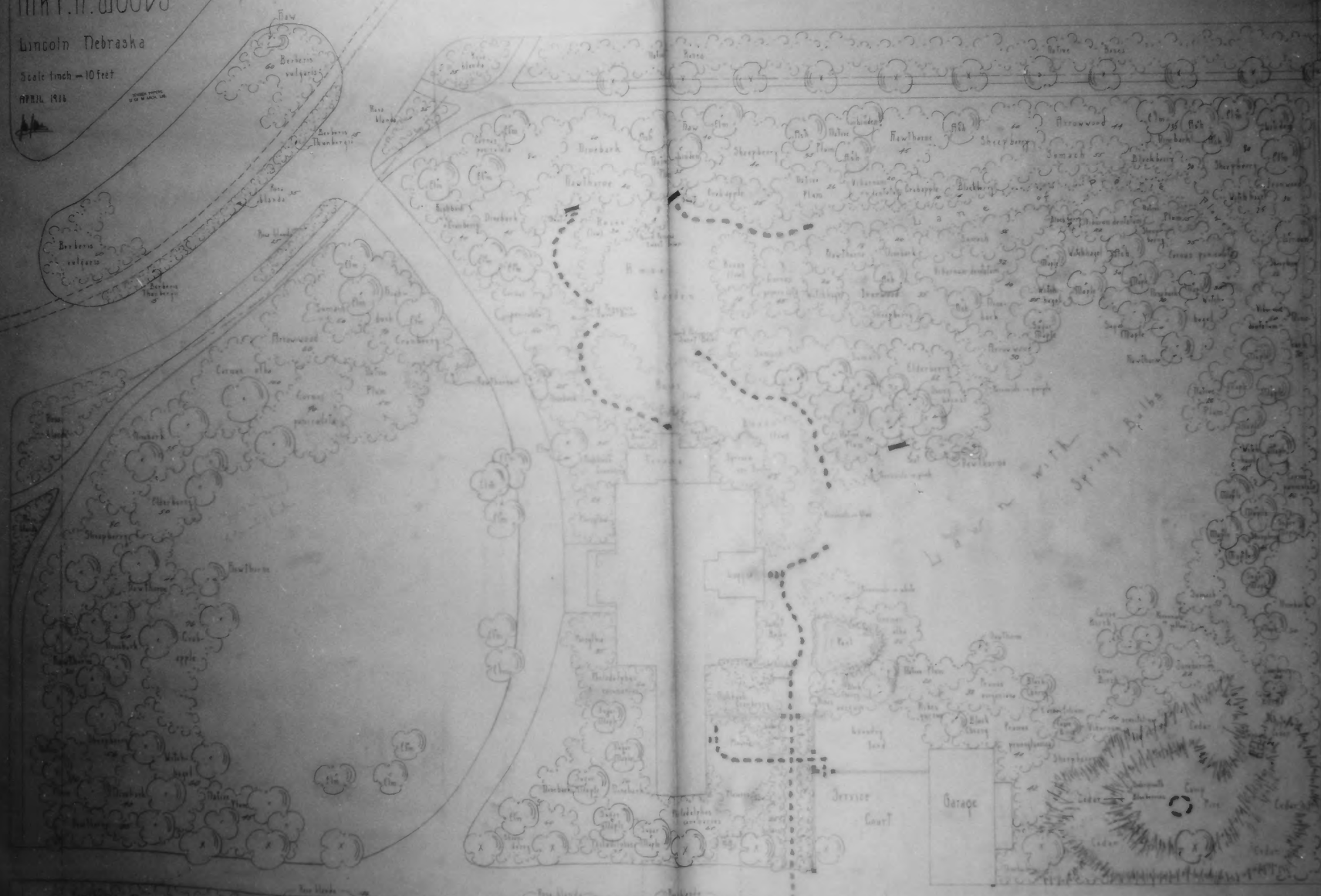

Photo 1 of 14

Woods House LC13:DS-470

Lancaster County, NE



Photo 2 of 14

Woods House LC13:D5-470

Lancaster Co. NE



Photo 3 of 14

Woods House LC13:DS-470

Lancaster County, NE



Photo 4 of 14

Woods House LC13:DS-470

Lancaster County NE





Photo 5 of 14.

Woods House LC13:05-470

Lancaster County NE



Photo 6 of 14

Woods Howse LC13: D5-470

Lancaster County NE



Photo 7 of 14

Woods House LC13: D5-470

Lancaster County NE



Photo 8 of 14

Woods House LC 13: D5-470

Lancaster County NE





Photo 9 of 14

Woods House LC13: D5-470

Lancaster County NE



Photo 10 of 14

Woods House LC13:05-470

Lancaster County NE



Photo 11 of 14

Woods House LC13: D5-470

Lanaster County NE



Photo 12 of 14

Woods House LC13: D5-470

Lancaster County NE





Photo 13 of 14

Woods House LC13: D5-470

Lancaster County NE



Photo 14 of 14

Woods House LC 13: D5-470

Lancaster County NE