

**United States Department of the Interior  
National Park Service**

For NPS use only

**National Register of Historic Places  
Inventory—Nomination Form**

received **MAY 31 1984**

date entered **JUN 28 1984**

See instructions in *How to Complete National Register Forms*  
Type all entries—complete applicable sections

**1. Name**

historic Champion-McGarrah Plantation

and/or common Merritt Farm

**2. Location**

street & number County Road 122, two miles northwest of Friendship,  
Georgia, off Georgia Highway 30 N/A not for publication

city, town Friendship  vicinity of

state Georgia code 013 county Marion code 197

**3. Classification**

Category	Ownership	Status	Present Use
<input type="checkbox"/> district	<input type="checkbox"/> public	<input checked="" type="checkbox"/> occupied	<input checked="" type="checkbox"/> agriculture
<input checked="" type="checkbox"/> building(s)	<input checked="" type="checkbox"/> private	<input type="checkbox"/> unoccupied	<input type="checkbox"/> commercial
<input checked="" type="checkbox"/> structure	<input type="checkbox"/> both	<input type="checkbox"/> work in progress	<input type="checkbox"/> educational
<input type="checkbox"/> site	<b>Public Acquisition</b>	<b>Accessible</b>	<input type="checkbox"/> entertainment
<input type="checkbox"/> object	N/A in process	<input checked="" type="checkbox"/> yes: restricted	<input type="checkbox"/> government
	<input type="checkbox"/> being considered	<input type="checkbox"/> yes: unrestricted	<input type="checkbox"/> industrial
		<input type="checkbox"/> no	<input type="checkbox"/> military
			<input type="checkbox"/> museum
			<input type="checkbox"/> park
			<input checked="" type="checkbox"/> private residence
			<input type="checkbox"/> religious
			<input type="checkbox"/> scientific
			<input type="checkbox"/> transportation
			<input type="checkbox"/> other:

**4. Owner of Property**

name William and Faye Merritt

street & number Route 1, Box 180

city, town Buena Vista N/A vicinity of state Georgia 31803

**5. Location of Legal Description**

courthouse, registry of deeds, etc. Superior Court

street & number Marion County Courthouse

city, town Buena Vista state Georgia

**6. Representation in Existing Surveys**

Historic Structures Field Survey:  
title Marion County, Georgia has this property been determined eligible?  yes  no

date 1982  federal  state  county  local

depository for survey records Historic Preservation Section, Georgia Dept. of Natural Resources

city, town Atlanta state Georgia

---

## 7. Description

---

<b>Condition</b>		<b>Check one</b>	<b>Check one</b>
<input type="checkbox"/> excellent	<input type="checkbox"/> deteriorated	<input type="checkbox"/> unaltered	<input checked="" type="checkbox"/> original site
<input checked="" type="checkbox"/> good	<input type="checkbox"/> ruins	<input checked="" type="checkbox"/> altered	<input type="checkbox"/> moved      date _____
<input type="checkbox"/> fair	<input type="checkbox"/> unexposed		

---

### Describe the present and original (if known) physical appearance

The Champion-McGarrah Plantation consists of the original core of an antebellum plantation that, besides farmland, includes a historic, one-story frame main house, seven historic frame tenant houses, and associated historic farm structures including a barn, smokehouses, and several sheds and cribs.

The main house, built in the Greek Revival style around 1840, is square in plan with a central hall and a rear ell. It is wood-framed, weatherboarded, and rests on brick piers. It has a recessed front porch with a main door surrounded by sidelights and transom. The porch is supported by simple, wooden columns. Two small front bedrooms are accessible only from the porch and were known as "travellers rooms." There are two main rooms off the central hall, one of which was formerly a parlor. Behind these rooms are two bedrooms. The hall leads to a side porch off of which is the rear ell. The ell contains the dining room and kitchen. The rear ell was originally separate but was later connected.

The two rooms and the hall in the central portion of the house are the only ones with interior plastered walls. The two front rooms also have wainscoting. The remaining rooms contain unplastered boarded walls. Simple, straight-forward mantels exist. The frame of the main house is pegged together.

The house sits on a level tract of land at the top of a low rise of ground. The yard contains several pecan and oak trees and boxwood hedges. The seven historic frame tenant houses are lined up across the road from the main house. They were built from 1870 to 1920. The other outbuildings consist of smokehouses, barns, cribs, and sheds. They are frame and vary in dates from antebellum times to the early twentieth century.

Archaeological potential may exist in that the acreage covers the suggested locations of earlier outbuildings. The farm is located in a rural setting. The main house, tenant houses and outbuildings are separated from the farming areas by fences and natural tree growth.

No major changes have been made to the property. Within the main house, changes include the enclosure of the breezeway between the dining room/kitchen ell and the main house. Fireplaces also have been closed and a rear bedroom has been converted to a bathroom.

# 8. Significance

Period	Areas of Significance—Check and justify below			
<input type="checkbox"/> prehistoric	<input type="checkbox"/> archeology-prehistoric	<input type="checkbox"/> community planning	<input type="checkbox"/> landscape architecture	<input type="checkbox"/> religion
<input type="checkbox"/> 1400-1499	<input type="checkbox"/> archeology-historic	<input type="checkbox"/> conservation	<input type="checkbox"/> law	<input type="checkbox"/> science
<input type="checkbox"/> 1500-1599	<input checked="" type="checkbox"/> agriculture	<input type="checkbox"/> economics	<input type="checkbox"/> literature	<input type="checkbox"/> sculpture
<input type="checkbox"/> 1600-1699	<input checked="" type="checkbox"/> architecture	<input type="checkbox"/> education	<input type="checkbox"/> military	<input type="checkbox"/> social/ humanitarian
<input type="checkbox"/> 1700-1799	<input type="checkbox"/> art	<input type="checkbox"/> engineering	<input type="checkbox"/> music	<input type="checkbox"/> theater
<input checked="" type="checkbox"/> 1800-1899	<input type="checkbox"/> commerce	<input type="checkbox"/> exploration/settlement	<input type="checkbox"/> philosophy	<input type="checkbox"/> transportation
<input checked="" type="checkbox"/> 1900-	<input type="checkbox"/> communications	<input type="checkbox"/> industry	<input type="checkbox"/> politics/government	<input checked="" type="checkbox"/> other (specify) Local History
<input type="checkbox"/>	<input type="checkbox"/>	<input type="checkbox"/> invention		

**Specific dates** ca. 1840-1920      **Builder/Architect** Unknown

**Statement of Significance (in one paragraph)**

Architecturally, the Champion-McGarrah Plantation is significant for containing a good example of a simple antebellum plantation home in rural Georgia that reflects the transition from the two-room, open-breezeway, dogtrot house to a square, central-hall design. It reflects the Greek Revival style, which reached its height in America just as this house was built, in its symmetry and compact massing, the simple columns on the porch, its front door with sidelights and transom, and interior detailing. It also illustrates traditional antebellum craftsmanship and materials. The plantation is also significant for its relatively rare collection of outbuildings and tenant houses which documents types of buildings and their construction materials and techniques associated with nineteenth-century Georgia plantations. The plantation is significant in agriculture and local history as a good example of a historic Georgia plantation and one of the oldest plantations in an area which opened for settlement in 1827. It was a cotton and corn plantation which at its peak contained 1,300 acres. The original builder/owner, George M. Champion (1790-1871), was also a public servant who was instrumental in having the Marion County county seat moved to Buena Vista. During the 1850s, he served there as one of the Justices of the Inferior Court, the highest local antebellum county office. He was also an elder in the Mount Tabor Presbyterian Church, which originally was adjacent to this plantation. When Champion died in 1871, the farm passed to his grandson, Moses H. McGarrah, whose father's family had moved to the area from South Carolina around 1831. He ran the farm in the tenant era until his death in 1899, and his widow until 1913, when it was sold to the T.M. Merritt family, whose descendants still own it.

These areas of significance support property eligibility under National Register criteria A, C and D.

# 9. Major Bibliographical References

See Continuation Sheet.

# 10. Geographical Data

Acreage of nominated property 202½ acres

Quadrangle name Draneville, Georgia

Quadrangle scale 1:24,000

### UTM References

A 

1	6	7	3	9	6	8	0	3	5	6	1	5	5	0
Zone			Easting				Northing							

B 

1	6	7	4	0	6	0	0	3	5	6	1	5	5	0
Zone			Easting				Northing							

C 

1	6	7	3	9	7	1	0	3	5	6	0	6	3	0
Zone			Easting				Northing							

D 

1	6	7	4	0	6	3	0	3	5	6	0	6	3	0
Zone			Easting				Northing							

E 

Zone			Easting				Northing							

F 

Zone			Easting				Northing							

G 

Zone			Easting				Northing							

H 

Zone			Easting				Northing							

### Verbal boundary description and justification

The nominated property consists of Land Lot 3, which contains the historic structures and acreage associated with the plantation. It was the historic core of the plantation.

### List all states and counties for properties overlapping state or county boundaries

state N/A code county code

state code county code

# 11. Form Prepared By

name/title Kenneth H. Thomas, Jr., Historian  
Historic Preservation Section

organization Georgia Dept. of Natural Resources

date May 7, 1984

street & number 270 Washington Street, S.W.

telephone (404) 656-2840

city or town Atlanta

state Georgia 30334

# 12. State Historic Preservation Officer Certification

The evaluated significance of this property within the state is:

national  state  local

As the designated State Historic Preservation Officer for the National Historic Preservation Act of 1966 (Public Law 89-665), I hereby nominate this property for inclusion in the National Register and certify that it has been evaluated according to the criteria and procedures set forth by the National Park Service.

State Historic Preservation Officer signature

*Elizabeth A. Lyon*

Elizabeth A. Lyon

title State Historic Preservation Officer

date 5/22/84

For NPS use only

I hereby certify that this property is included in the National Register

Entered in the  
National Register

date 6/28/84

*for [Signature]*  
Keeper of the National Register

Attest:

date

Chief of Registration

**United States Department of the Interior  
National Park Service**

**National Register of Historic Places  
Inventory—Nomination Form**

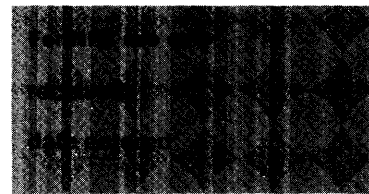

Continuation sheet    Bibliography

Item number 9

Page 2

9. Major Bibliographical References

Campbell, Susan, and John Sledge. "Champion-McGarrah Farm;" Historic Property Information Form, September 1, 1982. On file at the Historic Preservation Section, Georgia Department of Natural Resources, Atlanta, Georgia. (Based on county histories, deed research, interviews and census records.)

Dixon, Mrs. Harry M. Papers, Georgia Department of Archives and History; folder on "Churches" and "Church Hill." (Located in Manuscripts Division)

Upton, T.M. "Mt. Tabor Presbyterian Church - Sumter County" and additional, signed "Brief History of Mount Tabor Church." Vertical file, Historical Foundation of the Presbyterian and Reformed Churches, Inc., Montreat, N.C.

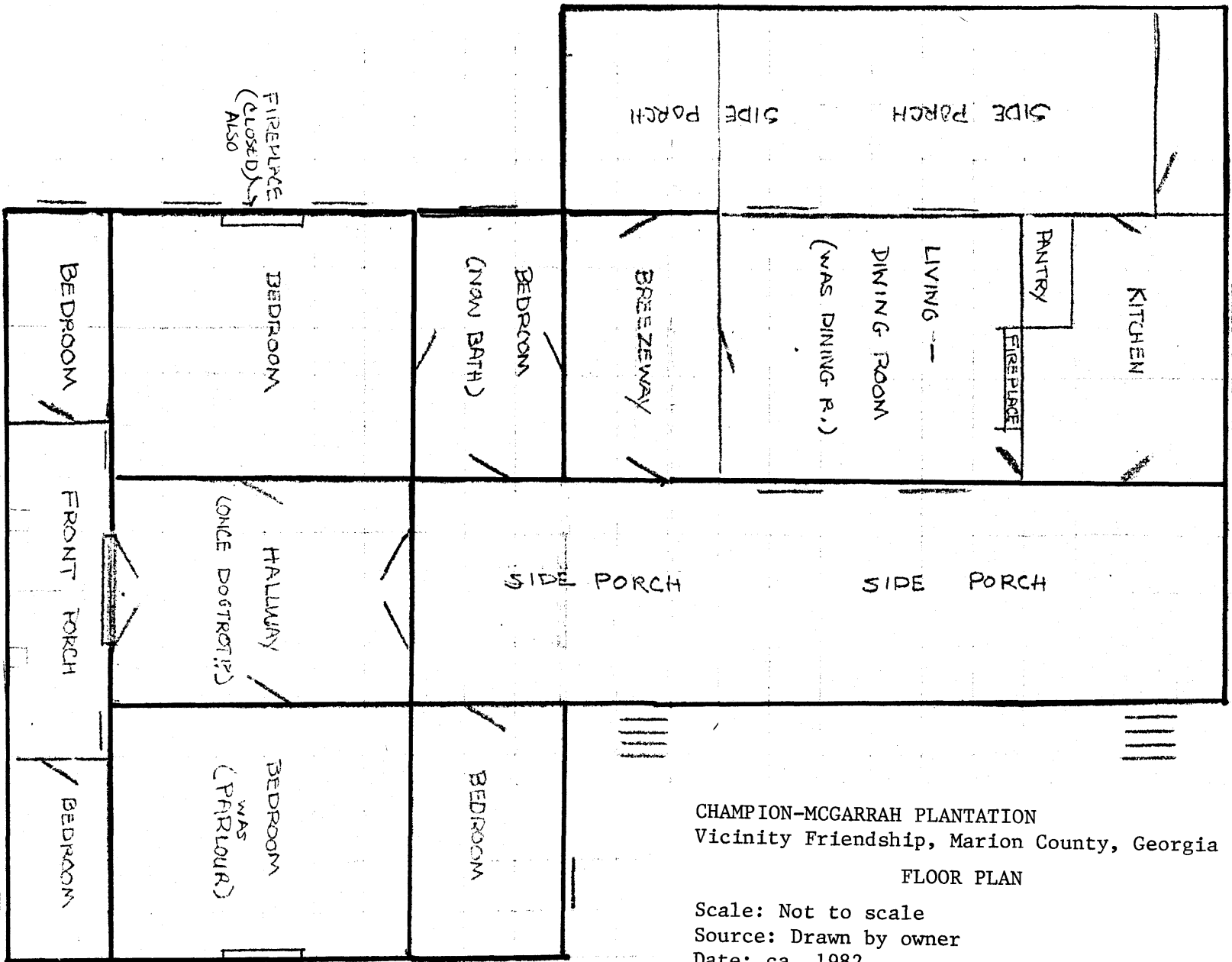

CHAMPION-MCGARRAH PLANTATION  
 Vicinity Friendship, Marion County, Georgia  
 FLOOR PLAN

Scale: Not to scale  
 Source: Drawn by owner  
 Date: ca. 1982  
 Key: All rooms are labeled on the floor plan.

MEM  
 NOT A SCALED DRAWING

WILLIAM B. MERRITT'S HOUSE

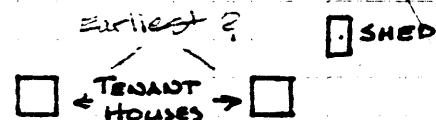
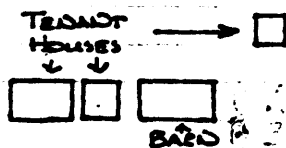
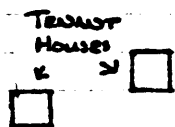

ROAD

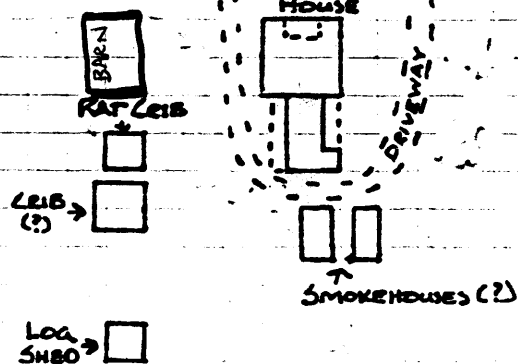

ROUGH SKETCH MAP  
OF THE HISTORICAL  
BUILDINGS ON THE  
CHAMPION FARM  
MARION CO., GA

NOT TO SCALE

CHAMPION-MCGARRAH PLANTATION  
Vicinity Friendship, Marion County, Georgia

SKETCH MAP

Scale: Not to scale

Source: Drawn by John Sledge

Date: 1983

Key: All plantation buildings are marked on  
the map. This is just a portion of the  
property showing the structures.