

KENTUCKY HISTORIC RESOURCES
Individual Inventory Form

Resource # MS-57
Mason County

1. Name of Resource: Springhouse on Flat Fork

2. Original Owner: Not Known

3. Other Names:

4. Prehistoric Site Building Object
Historic Site Structure Other

5. Location: west side of Kentucky 161, 1 2/10 miles south of Kentucky 324, near Mays Lick

6. Owner's Name: Cecil McCarthy [P]

7. Owner's Address: Flat Fork Pike
Mays Lick, Kentucky 41055

8. Evaluation: [G]

9. Recognition & Date:
Nat. Landmark _____ Local Landmark _____
Nat. Register _____ HABS/HAER _____
Highway Marker _____ KY Inventory
KY Landmark Certificate _____

10. N.R. Status & Date:

11. N.R. Group:
District Name: []
Mult. Resource Area: []
Thematic Name: Early Stone Buildings []

12. Historical Theme:
Primary: Architecture [030]
Secondary: []
Other: []

13. Statement of Significance:

Excellent example stone springhouse; type unique to Mason County.

[]

14. History:

Not Researched.

16. Date: Original Building early 19th C. [8]
Addition []

17. Style: Settlement Vernacular [2V]
[]

18. Architect/Builder: Not Known

19. No. of Stories: Two [2.0]

20. Original Floor Plan: Rec. Single Cell [1R]

21. Single Pile Double Pile N.A.

22. Roof Form & Material: Original _____
Gable Not Original _____

23. Structural Material: Stone [S]

24. Exterior Material: Stone [S]
[]

25. Foundation Material: Stone [S]

26. Major Alterations: None
Moved/Rebuilt Other _____
Additions _____

27. Special Features: Spring arises outside Springhouse

28. Outbuildings: House, Quarters, Three Barns [5]

29. Original Function: Springhouse [01C]

30. Present Use: Springhouse [01C]

31. Condition: Excellent [E]

32. Endangered: Yes _____
No

33. Attach Photos: Roll: 24 Photo Nos 23-36 No. of Slides: X

Sl. 1 1987

15. Source of historical information and/or contact person:

34. Prepared by: Carolyn Murray-Wooley

35. Organization: Kentucky Heritage Council

36. Date: April 1984

37. New Survey Reserve _____

KENTUCKY HISTORIC RESOURCES INVENTORY

36. UTM Point of Primary Building: 17 253 320 4264 520
 37. USGS Quadrant: Elizaville
 38. G.I.S. Mod. []
 39. Coordinate Accuracy []
 40. UTM Points of Boundary:
 A. 17 253 480 4264 760 C. 17 253 925 4264 180 E. 17 253 100 4264 760
 B. 17 253 600 4264 250 D. 17 253 060 4264 590 F. []
 41. Total Acreage in Present Property: . 42. Acreage Included in Nominated Boundary: 60

43. Site Plan and Boundary Description and Justification:

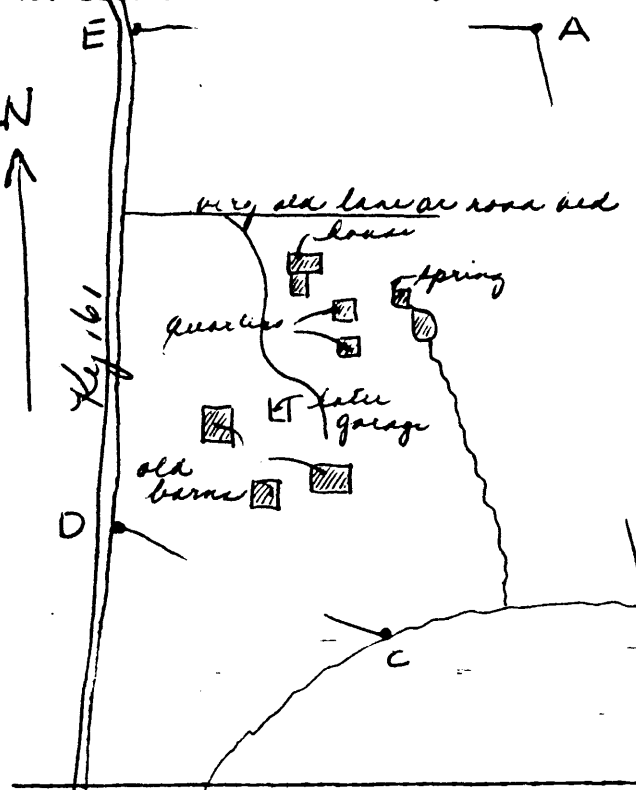

Site enclosed by A-B-C-D-E as shown.
 B-C is on Flat Fork, D-E is at Ky 161.
 Boundary includes spring house, pond,
 house, quarters and 3 barns.

- 7 contributing buildings.
- 1 contributing structure (pond)
- 1 non contributing building (garage)

Boundary includes a portion
 of the original farm which can
 be seen from house.

45. Description and House Plan

One-room, dry-stone springhouse, ca. 14 x 16 feet; two stories tall, doorway to each story in north end of house; north gable end of roof extended to roof over entrance. Spring flows through rock lining into circular basin outside northwest corner of house; basin ca. four feet tall, covered by stone slab. Pool overflows and goes under entrance walk and under stone door threshold into springhouse. Steps descend from west hillside to walkway between spring and springhouse. Springs flows out southeast corner of springhouse into stone lined pond.

The spring is located downhill, east of the house.

There are several other original buildings on this farm complex. The main house is a two-story, three-bay weatherboarded house with a two-story ell. Two two-story weatherboarded servants' quarters are in the yard, southeast of the house. There are three barns around the barn yard south of the house. All of these are in good condition.

Addendum: The entire complex was an early pioneer farmstead, the house dating to the early 19th century, the quarters and barns to mid-19th century. The garage is non-contributing. The complex is a good illustration of the relationship of various domestic and agricultural buildings on a pioneer farm. The springhouse is an extremely significant example.

SPRINGHOUSE ON FLAT FORK

MS 1
1973
Spring
house

MS 57

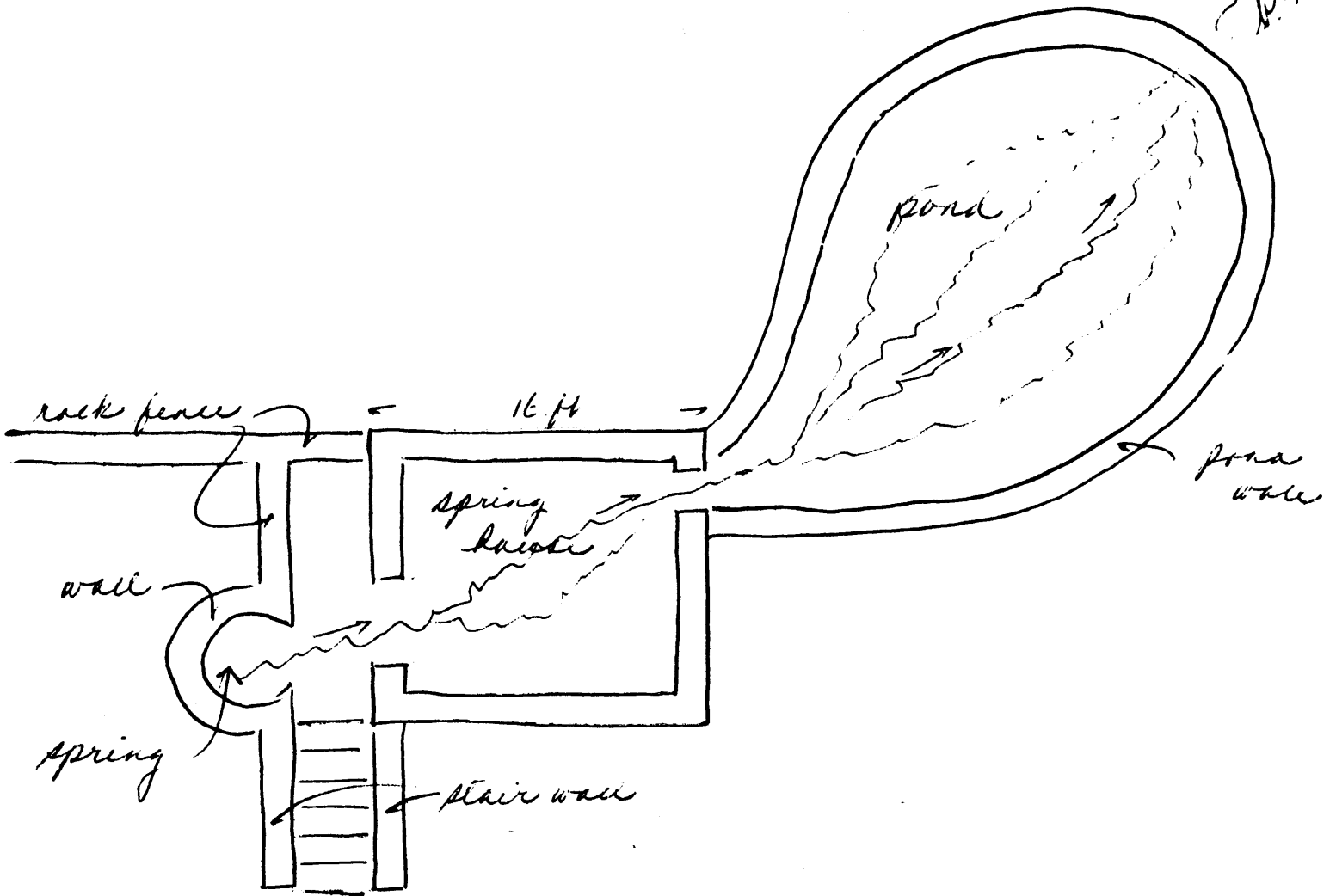

Stone slab threshold to spring house,
spring flows under it.

Area via door way also covered by
stone slabs spanning spring run.