

**United States Department of the Interior  
National Park Service**

**National Register of Historic Places  
Inventory—Nomination Form**

For NPS use only
received <i>8/1/84</i>
date entered

East Shelbyville District

Continuation sheet Mult. Res. of Shelbyville, KY Item number 7 & 8

Page 1

OVERVIEW OF THE EAST SHELBYVILLE DISTRICT

*Roughly  
E. Side of  
from Washington to  
Bradshaw St.*

The East Shelbyville District is composed of some of the earliest buildings from Shelbyville's history. On Main Street, the one and two story brick Federal buildings occupy lots from the original town plat of 1794. An adjacent neighborhood on Third Street was an early subdivision of these original lots. The buildings have been preserved as an intact neighborhood.

ARCHITECTURAL DESCRIPTION: EAST SHELBYVILLE DISTRICT

The earliest surviving structures are the five one and two story, three bay, gable roofed buildings on East Main Street. (Photo #15, 16). They are sited on lots from the original town plat and were built in the first quarter of the nineteenth century. Built on the hall-parlor plan, their detailing includes Flemish bond brick and jack arches. Some modification of the first stories has taken place in the commercial structures. Dormers have been added to one of the one story buildings.

There are also three later Federal brick buildings in the district. The Scarce Academy Building built by Dr. Nuckols is a central passage plan, one room deep with an original ell. The Flemish bond and the jack arches are still visible in the five bay facade despite an overlay of nineteenth century Italianate detailing. (Photo #8). The three bay Krieger House exemplifies the side passage plan as does the four bay Scofield House which is also a two-family residence. The Scofield House has Italianate modifications around the doorway and hood moldings.

The Gothic Revival style of the mid-nineteenth century is exemplified by the St. James Episcopal Church on the corner of Third and Main. It was built in 1868 as portions of Third St. were being subdivided. (Photo #17). South on Third between Clay and Bradshaw, the original half acre lots were divided into five lots facing Third. The west side of the street was developed first and vestiges of the Gothic Revival style can be seen in the wall gables and the drip moldings around the windows and doors. Early Italianate houses with arcaded porches can also be found in this area. (Photos #19, 20). The east side of the street has more of an Eastlake aspect with the turned porch posts and profusion of bargeboards. (Photos # 23, 25).

Later Italianate detailing can be found on Washington St. (Photo #7). In a one story, five bay residence, the brickwork is attributed to Deiss, a local mason and brickyard owner. The brick segmental arches over the windows and door surrounds are elegant

**United States Department of the Interior  
National Park Service**

**National Register of Historic Places  
Inventory—Nomination Form**

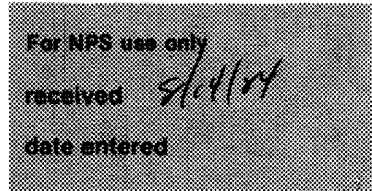

East Shelbyville District  
Continuation sheet Multi-Res. of Shelbyville, KY Item number 7 & 8 Page 2

expressions of the style.

Expression of the late nineteenth century Queen Anne style can be found in the detailing of a duplex at the corner of Bradshaw and Third. The asymmetrical roofline, mixture of materials, and use of colored glass exemplify the style. (Photo #26).

The twentieth century represented the classical revival reaction to the asymmetry of the Victorian styles. One and two story American Four Squares with hipped roofs, overhanging eaves, and classical elements on the porch such as dentils can be found in the district. (Photo #5,9) At the same time, bungalos with gable roofs which overhang the porch were being built. Brackets were used to support the overhanging eaves and sometimes found a fuller expression as "craftsman" supports to the porch. (Photo #9).

EAST SHELBYVILLE DISTRICT: SIGNIFICANCE

The East Shelbyville District contains the remnants of three early neighborhoods in Shelbyville. The cluster of brick buildings on East Main Street is the oldest surviving neighborhood of Federal structures in Shelbyville. Despite some alterations to the first floor commercial space, the three bay facades with Flemish bond and jack arches are still visible. The proportions of the gable roofed structures stand out in contrast to the later buildings found in either directions on Main. These buildings provide a glimpse of the architectural fabric of the town during the first quarter of the nineteenth century. The demolition of other nineteenth century buildings in the immediate vicinity since the 1979 survey makes recognition of these buildings through the National Register especially important.

Two of the four remaining log-core structures in the City Limits of Shelbyville are found on Washington Street. They conform to the specifications set up by the early Trustees who sold the lots in the original plan and the Eastern Addition. The rarity of remaining buildings of this type in Shelbyville makes them an important part of the nomination.

Third Street had one of the early bridges across Clear Creek and also served as the Mt. Eden Pike, one of the entrances into Shelbyville. The ten houses on Third between Clay and Bradshaw demonstrate the styles popular in the mid-nineteenth century. The continuity of setbacks, materials, porches, and floor plans contribute to a sense of place.

The East Shelbyville District is composed of outstanding individual structures such as the Scarse Academy, the Scofield House, the Krieger building, and St. James Episcopal Church. The neighborhood clusters on Washington, Main, and south Third Street are irreplaceable in terms of site preservation. The present transition of this area from residential to commercial threatens all of these structures and makes

**United States Department of the Interior  
National Park Service**

**National Register of Historic Places  
Inventory—Nomination Form**

For NPS use only

received *8/14/84*

date entered

East Shelbyville District

Continuation sheet Multi-Res. of Shelbyville, KY Item number 7 & 8

Page 3

the National Register Nomination very timely.

BOUNDARY: EAST SHELBYVILLE DISTRICT

Beginning at a point in the north right of way of Washington Street 100 feet east of the northeast corner of the intersection of Washington and Third Street;  
North 100 feet to a point;  
Turning west 200 feet to a point in the west property line of 301 Washington;  
Then south 100 feet with the west property line of 301 Washington Street to a point in the north right of way of Washington;  
Then east 40 feet along the north right of way of Washington Street to a point;  
Then south 200 feet crossing Washington Street and proceeding along the west property line of 408 Third Street to a point;  
Then west 25 feet to a point in the west line of 301-303 Main Street;  
Then south 130 feet along the west property line of 301-303 Main Street to a point in the south right of way of Main Street;  
Then west 210 feet along the south right of way of Main Street to a point;  
Then south 90 feet along the west property line of 320 Main Street to a point;  
Then east 230 feet to a point in the west property line of 516 Third Street;  
Then south 170 feet to a point in the south right of way of Clay Street;  
Then west 30 feet with the south right of way of Clay Street to a point;  
Then south 50 feet with the west property line of 600 Third Street to a point in the north property line of 608 Third;  
Then west 20 feet along the north property line of 608 Third Street to a point;  
Then south 170 feet to a point in the north right of way of Bradshaw Street;  
Then east 190 feet along the north right of way of Bradshaw to a point;  
Then north 910 feet to the point of beginning.

BOUNDARY JUSTIFICATION

North of the district are vacant lots and Clear Creek which forms the boundary of the present City Limits. West of the district are more modern commercial buildings and vacant areas where buildings have been removed. The houses left in this area are gradually being converted to commercial buildings and have lost much of their architectural integrity. South of the district are the railroad tracks with an overpass at Third Street. The area bordering the railroad tracks is devoted to light industry. East of the district is the same pattern of transitional buildings found west of the district. No groupings of houses like those found on Washington, Main and Third can be found in these adjacent areas.

**United States Department of the Interior  
National Park Service**

**National Register of Historic Places  
Inventory—Nomination Form**

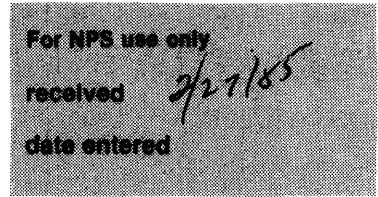

East Shelbyville Historic District

Continuation sheet Shelbyville M.R.A., Shelby Co., KY Item number 10

Page 1

GEOGRAPHICAL DATA

Acreage of Nominated Property: 5.1 acres

Quadrangle Name: Shelbyville

UTM References:

A.	16/656520/4230600
B.	16/656500/4230340
C.	16/656440/4230330
D.	16/656460/4230460
E.	16/656400/4230480
F.	16/656400/4230500
G.	16/656460/4230500
H.	16/656480/4230620

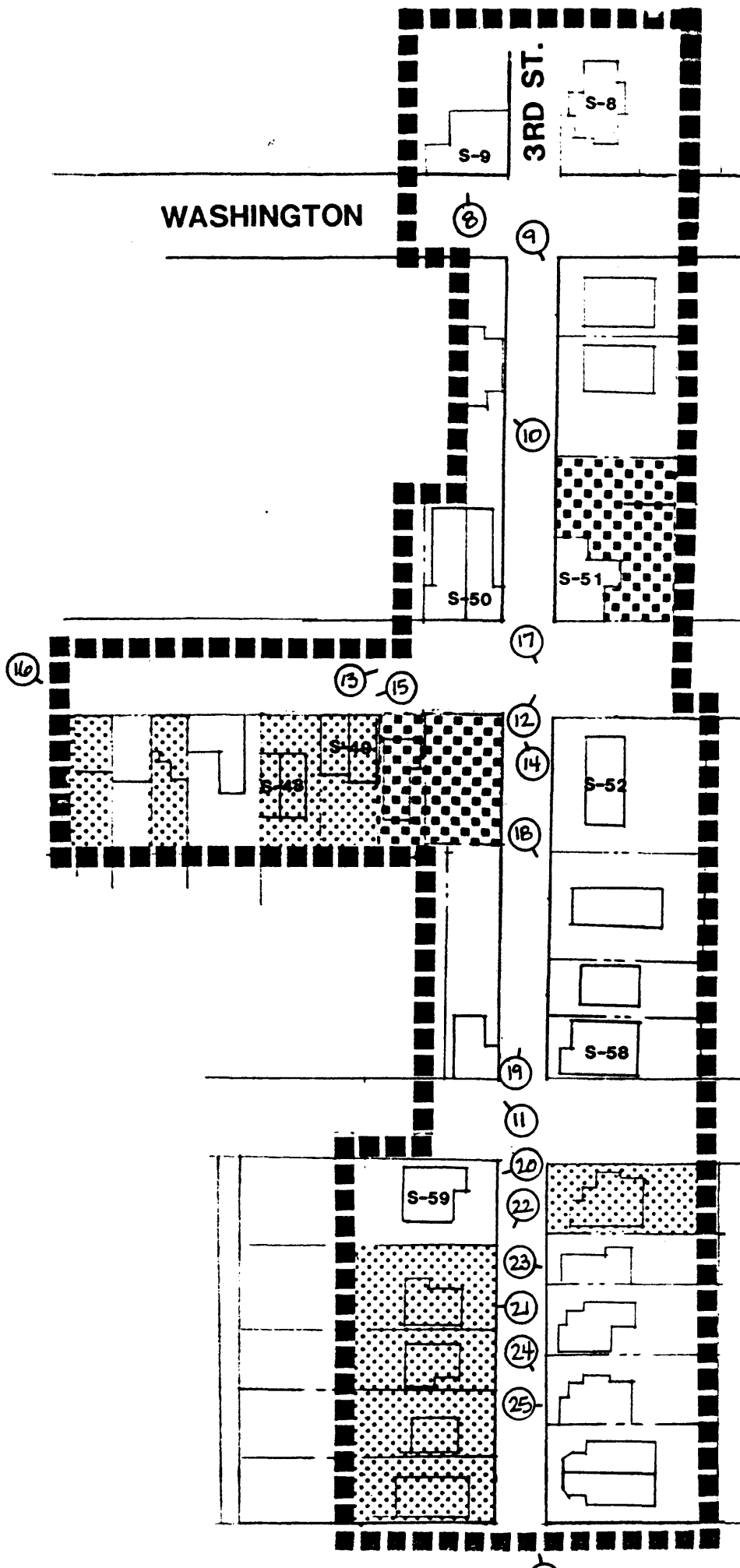

MAIN

# EAST SHELBYVILLE DISTRICT PHOTOGRAPHS

CLAY

white contributing  
 small dot  
 contributing  
 but altered  
 (covered)  
 big dot non-  
 contributing

SCALE: 1"=100'

# MULTIPLE RESOURCES OF SHELBYVILLE

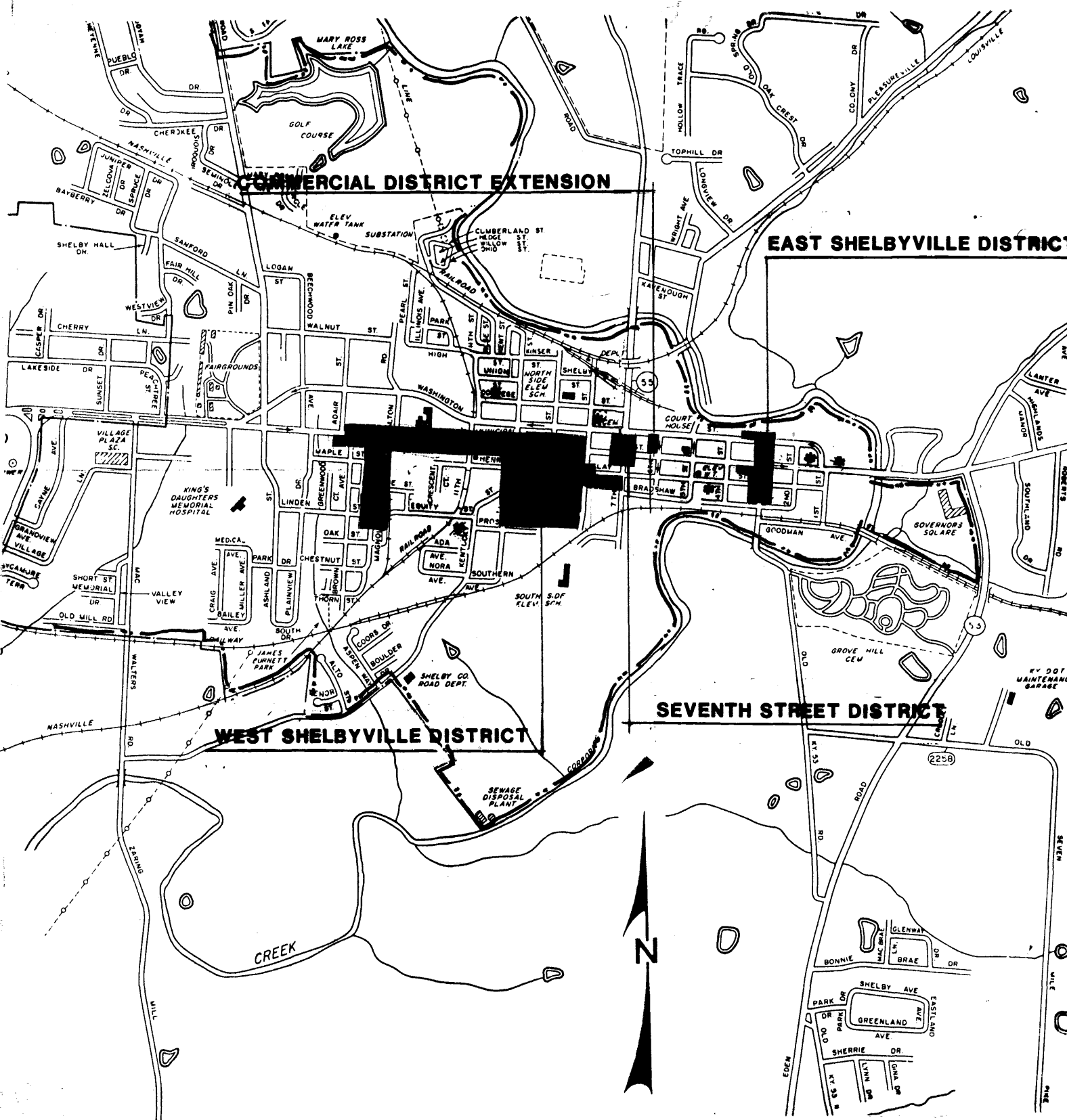

# KENTUCKY HISTORIC RESOURCES INVENTORY

Site No. Sh - S 9

<b>1. Historic Name(s)</b> Governor A.O. Stanley Birthplace Original Owner Scearce Academy Dr. George Nuckols		<b>22. ADO/County</b> KIPDA / <b>SHELBY</b> <span style="float: right; border: 1px solid black; padding: 2px;">106</span>									
<b>2. Present Name</b> _____		<b>23. U.S.G.S. Quadrant (15'/75')</b> <b>SHELBYVILLE</b> <span style="float: right; border: 1px solid black; padding: 2px;">G.I.S. Mod.</span>									
<b>3. Location</b> 301 Washington St. Shelbyville, Ky.		<b>24. UTM Reference</b> <table style="width: 100%; border-collapse: collapse;"> <tr> <td style="border: 1px solid black; width: 25px; height: 25px;"></td> <td style="border: 1px solid black; width: 25px; height: 25px;"></td> <td style="border: 1px solid black; width: 25px; height: 25px;"></td> <td style="border: 1px solid black; width: 25px; height: 25px;"></td> </tr> <tr> <td style="text-align: center;">Zone</td> <td style="text-align: center;">Easting</td> <td colspan="2" style="text-align: center;">Northing</td> </tr> </table>						Zone	Easting	Northing	
Zone	Easting	Northing									
<b>4. Owner's Name</b> Joseph O. Casey		<b>25. Coordinate Accuracy</b> <input type="checkbox"/>									
<b>5. Owner's Address</b> 301 Washington St. Shelbyville, Ky.		<b>26. Prehistoric Site</b> <span style="float: right;">Object</span> Historic Site <span style="float: right;">Structure</span> <input checked="" type="checkbox"/> Building <span style="float: right;">Other</span>									
<b>6. Open to Public</b> Yes _____ No _____	<b>7. Visible from road</b> Yes <input checked="" type="checkbox"/> No _____	<b>8. Ownership</b> Private <input checked="" type="checkbox"/> Local _____ State _____ Federal _____									
<b>9. Local Contact/Organization</b> <b>SHELBY COUNTY HISTORICAL SOCIETY</b>		<b>27. National Register District Name:</b> <b>MULTIPLE RESOURCES OF SHELBYVILLE</b> EAST SHELBYVILLE DISTRICT									
<b>10. Site Plan with North Arrow</b> <div style="border: 1px solid black; padding: 10px; width: 300px; height: 200px; position: relative;"> <div style="position: absolute; top: 10px; left: 10px; width: 40px; height: 40px; border: 1px solid black;"></div> <div style="position: absolute; top: 50px; left: 100px; font-size: 24px; font-weight: bold;">WASHINGTON</div> <div style="position: absolute; top: 100px; left: 10px; font-size: 24px; font-weight: bold; transform: rotate(-90deg);">3RD ST.</div> <div style="position: absolute; top: 450px; left: 250px;"> </div> </div>		<b>28. Significance Evaluation</b> <b>National Register</b> <input type="checkbox"/>									
		<b>11. Architect</b> _____	<b>29. Status</b> <span style="float: right;">Date</span> National Landmark _____ National Register _____ Landmark Certificate <input checked="" type="checkbox"/> <span style="float: right;">3/11/71</span> Kentucky Survey <input checked="" type="checkbox"/> <span style="float: right;">8/15/80</span> Local Landmark _____ HABS/HAER _____								
		<b>12. Builder</b> _____	<b>30. Historic Theme</b> Primary <b>Education</b> <span style="float: right; border: 1px solid black; padding: 2px;">I I</span> Secondary <b>Architecture</b> <span style="float: right; border: 1px solid black; padding: 2px;">  </span> Other <b>Govt. Politics</b> <span style="float: right; border: 1px solid black; padding: 2px;">  </span>								
		<b>13. Date</b> 1830 A. <input checked="" type="checkbox"/> B. <input type="checkbox"/>	<b>31. Endangered</b> Yes _____ No _____								
		<b>14. Style</b> A. Federal <input type="checkbox"/> B. Italianate <input type="checkbox"/>	<b>32. Preservation Project Status</b> <input type="checkbox"/>								
		<b>15. Original Use</b> <b>S.F. Residence</b> <input checked="" type="checkbox"/>	Actual Cost in \$1,000s _____								
		<b>16. Present use</b> Same	<b>33. ATTACH PHOTO</b> <div style="text-align: right; margin-bottom: 5px;">Roll No. <u>5:21</u></div> Picture No. _____ Direction _____ <b>34. Prepared by:</b> Helen Powell <span style="float: right;">KTG/KHC</span> <span style="float: right;">1979</span>								
		<b>17. Condition</b> Good <input checked="" type="checkbox"/>									
<b>18. Description</b> Two story, five bay brick residence; central passage plan; projecting central bay; Flemish bond with jack arches; 2 story, 2 bay kitchen block with Flemish bond with header flat arches; dual leaf door in frame connector between house and kitchen; narrow cornice w/ returns; facade remodeled Italianate (Continue on Back)		No. Stories <input checked="" type="checkbox"/> 2									
		Single Pile <input checked="" type="checkbox"/> NA _____ Double Pile _____ Floor Plan Gen. Hall S.P. <input checked="" type="checkbox"/>									
		Structural Fabric Brick A. <input checked="" type="checkbox"/> B. <input type="checkbox"/>									
		Decorative Fabric Flemish Bond A. <input checked="" type="checkbox"/> B. <input type="checkbox"/>									
		Roof Form Gable	<b>35. Organization</b> <b>CARMAN AND POWELL, INC.</b>								
<b>19. History</b> First owner of lot was Issac Watkins 1795 (DB A, 357) Watkins sold the lot to Dr. George Nuckols, a physician. Nuckols was the owner until 1857 and built the house. Gov. A.O. Stanley was born here in 1867 son of Rev. William and Amanda Owsley Stanley.		<b>36. Date</b> <b>1983</b>									
<b>20. Significance</b> Birthplace of Gov. A.O. Stanley (1915-1919); site of Prof. Scearce's Academy 1885-1901		<b>37. Revision Dates</b> <span style="float: right;">38 Staff Review</span>									
<b>21. Source of Information</b> Bennett Roach/ 1970 Inventory Form Lot 16 Original Town Plat; Lake Map 1882											

KENTUCKY HISTORIC RESOURCES INVENTORY

Site No. Sh - S 47

1. Historic Name(s) Original Owner		22. ADD/County <b>KIPDA / SHELBY</b>	
2. Present Name 312- 320 Main St.		23. U.S.G.S. Quadrant (15'/75') <b>SHELBYVILLE</b>	
3. Location 312-320 Main St. Shelbyville, Ky. 40065		24. UTM Reference Zone Easting Northing	
4. Owner's Name 312-318: Bill Lynam 316 Main St.		25. Coordinate Accuracy	
5. Owner's Address 320: Carl Graybeal 205 Magnolia		26. Prehistoric Site Object Historic Site Structure <input checked="" type="checkbox"/> Building <input type="checkbox"/> Other	
6. Open to Public Yes <input type="checkbox"/> No <input type="checkbox"/>		27. National Register District Name: <b>MULTIPLE RESOURCES OF SHELBYVILLE</b>	
7. Visible from road Yes <input checked="" type="checkbox"/> No <input type="checkbox"/>		28. Significance Evaluation <b>National Register</b>	
8. Ownership Private <input type="checkbox"/> Local <input type="checkbox"/> State <input type="checkbox"/> Federal <input type="checkbox"/>		29. Status National Landmark <input type="checkbox"/> National Register <input type="checkbox"/> Landmark Certificate <input type="checkbox"/> Kentucky Survey <input type="checkbox"/> Local Landmark <input type="checkbox"/> HABS/HAER <input type="checkbox"/>	
9. Local Contact/Organization <b>SHELBY COUNTY HISTORICAL SOCIETY</b>		30. Historic Theme Primary <input type="checkbox"/> Secondary <input type="checkbox"/> Other <input type="checkbox"/>	
10. Site Plan with North Arrow 		11. Architect 12. Builder 13. Date 1810-1825 A. <input checked="" type="checkbox"/> B. <input type="checkbox"/> 14. Style A. Federal <input checked="" type="checkbox"/> B. <input type="checkbox"/> 15. Original Use S.F. Residence <input checked="" type="checkbox"/> 16. Present use Same and Commercial 17. Condition Fair <input checked="" type="checkbox"/>	
18. Description One and two story, 3 bay Federal brick residences now commercial and apartments; Flemish Bond with jack arches (Continue on Back)		31. Endangered Yes <input type="checkbox"/> No <input checked="" type="checkbox"/>	
19. History Part of original lot # 46 on 1794 plat		32. Preservation Project Status <input type="checkbox"/>	
20. Significance Part of cluster of brick Federal buildings on Main St.; some of the earliest surviving structures from Shelbyville's development		33. Photographs 	
21. Source of Information Sandborn Insurance Map 1886 D.J. Lake Map 1882		34. Prepared by: Helen Powell KTG/KHC 1979	
		35. Organization <b>CARMAN AND POWELL, INC.</b>	
		36. Date <b>1983</b>	
		37. Revision Dates 38. Staff Review	



KENTUCKY HISTORIC RESOURCES INVENTORY

8/14/84

Site No. Sh - S 49

1. Historic Name(s) Original Owner _____		22. ADD/County <b>KIPDA / SHELBY</b> <span style="float:right; border: 1px solid black; padding: 2px;">106</span>	
2. Present Name 306-308 Main St.		23. U.S.G.S. Quadrant (15'/75') <b>SHELBYVILLE</b> <span style="float:right; border: 1px solid black; padding: 2px;">G.I.S. Mod. [ ] [ ] [ ]</span>	
3. Location 306-308 Main St. Shelbyville, Ky.		24. UTM Reference [ ] Zone Easting Northing	
4. Owner's Name Chester Ethington		25. Coordinate Accuracy <span style="float:right; border: 1px solid black; padding: 2px;">[ ]</span>	
5. Owner's Address 905 Ashland Ave. Shelbyville, Ky. 40065		26. Prehistoric Site _____ Object _____ Historic Site _____ Structure _____ <input checked="" type="checkbox"/> Building _____ Other _____	
6. Open to Public Yes _____ No _____		27. National Register District Name: <b>MULTIPLE RESOURCES OF SHELBYVILLE</b> <span style="float:right; border: 1px solid black; padding: 2px;">[ ] [ ] [ ]</span> EAST SHELBYVILLE DISTRICT	
7. Visible from road Yes <input checked="" type="checkbox"/> No _____		28. Significance Evaluation <b>National Register</b> <span style="float:right; border: 1px solid black; padding: 2px;">[ ]</span>	
8. Ownership Private _____ Local _____ State _____ Federal _____		29. Status _____ Date _____ National Landmark _____ National Register _____ Landmark Certificate _____ Kentucky Survey _____ Local Landmark _____ HABS-HAER _____	
9. Local Contact Organization <b>SHELBY COUNTY HISTORICAL SOCIETY</b>		30. Historic Theme Primary _____ Secondary _____ Other _____ <span style="float:right; border: 1px solid black; padding: 2px;">[ ] [ ] [ ] [ ] [ ] [ ]</span>	
10. Site Plan with North Arrow <div style="border: 1px solid black; padding: 10px; width: 100%;"> <p style="text-align: center;">MAN</p> <div style="display: flex; justify-content: space-around; align-items: center;"> <div style="border: 1px solid black; width: 20px; height: 20px; margin: 10px;"></div> <div style="writing-mode: vertical-rl; transform: rotate(180deg); font-weight: bold; font-size: 2em;">THIRD</div> </div> </div>		11. Architect _____ 12. Builder _____ 13. Date 1825 A. <input checked="" type="checkbox"/> B. <input type="checkbox"/> 14. Style A. Federal <input checked="" type="checkbox"/> B. <input type="checkbox"/> 15. Original Use S-F. Residence <input checked="" type="checkbox"/> A. <input type="checkbox"/> 16. Present use Same	
17. Condition Fair <input checked="" type="checkbox"/> C. <input type="checkbox"/>		31. Endangered Yes _____ No _____	
18. Description 1 1/2 story brick residence; 5 bay; Flemish Bond; segmental openings; interior end chimney; hall parlor plan		32. Preservation Project Status <span style="float:right; border: 1px solid black; padding: 2px;">[ ]</span> Actual Cost in \$1,000s <span style="float:right; border: 1px solid black; padding: 2px;">[ ] [ ] [ ] [ ] [ ] [ ]</span>	
(Continue on Back)		33. Roll No. <u>5:31</u> Picture No. _____ Direction _____	
19. History Lot # 46 on original town plat		34. Prepared by: Helen Powell <span style="float:right;">KTG/KHC 1979</span>	
20. Significance One of cluster of brick Federal buildings on Main St. Group contains some of earliest surviving buildings in Shelbyville		35. Organization <b>CARMAN AND POWELL, INC.</b>	
21. Source of Information Sandborn Insurance Map 1886 D.J. Lake Map 1882		36. Date <b>1983</b>	
		37. Revision Dates _____ 38. Staff Review _____	



1. Historic Name(s) <b>Krieger Building</b> Original Owner		22. ADD/County <b>KIPDA / SHELBY</b> <span style="float:right; border:1px solid black; padding:2px;">106</span>	
2. Present Name <b>231 Main</b>		23. U.S.G.S. Quadrant (15'/75') <b>SHELBYVILLE</b> <span style="float:right; border:1px solid black; padding:2px;">  </span> G.I.S. Mod.	
3. Location <b>231 Main St. Shelbyville, Ky. 40065</b>		24. UTM Reference Zone Easting Northing	
4. Owner's Name <b>State Farm Insurance</b>		25. Coordinate Accuracy <span style="float:right;"><input type="checkbox"/></span>	
5. Owner's Address <b>231 Main St. Shelbyville, Ky. 40065</b>		26. Prehistoric Site Object Historic Site Structure <input checked="" type="checkbox"/> Building Other	
6. Open to Public Yes <input type="checkbox"/> No <input type="checkbox"/>	7. Visible from road Yes <input checked="" type="checkbox"/> No <input type="checkbox"/>	8. Ownership Private <input type="checkbox"/> Local <input type="checkbox"/> State <input type="checkbox"/> Federal <input type="checkbox"/>	
9. Local Contact/Organization <b>SHELBY COUNTY HISTORICAL SOCIETY</b>		27. National Register District Name: <b>MULTIPLE RESOURCES OF SHELBYVILLE</b> EAST SHELBYVILLE DISTRICT <span style="float:right; border:1px solid black; padding:2px;">  </span>	
10. Site Plan with North Arrow <div style="text-align:center;"> </div>		28. Significance Evaluation <b>National Register</b> <span style="float:right;"><input type="checkbox"/></span>	
		29. Status <span style="float:right;">Date</span> National Landmark <input type="checkbox"/> National Register <input type="checkbox"/> Landmark Certificate <input type="checkbox"/> Kentucky Survey <input type="checkbox"/> Local Landmark <input type="checkbox"/> HABS/HAER <input type="checkbox"/>	
		30. Historic Theme Primary <input type="checkbox"/> Secondary <input type="checkbox"/> Other <input type="checkbox"/>	
		31. Endangered <span style="float:right;">Yes <input type="checkbox"/> No <input type="checkbox"/></span>	
		32. Preservation Project Status <span style="float:right;"><input type="checkbox"/></span> Actual Cost in \$1,000s <span style="float:right; border:1px solid black; padding:2px;">  </span>	
4. Description <b>Two story, 3 bay brick structure; side passage plan; Flemish bond; one story original cell with second story added; jack arches; interior end chimney; Italiante hood added to entry</b> (Continue on Back)		33. ATTACH PHOTO <div style="text-align:center;"> </div>	
		Roll No. <u>5:29</u> Picture No. _____ Direction _____	
19. History <b>Lot 162, Eastern Addition; on D.J. Lake Map 1882</b>		34. Prepared by: <b>Helen Powell</b> <span style="float:right;">KTG/KHC 1979</span>	
20. Significance <b>One of a group of brick Federal structures in the East Shelbyville District</b>		35. Organization <b>CARMAN AND POWELL, INC.</b>	
21. Source of Information		36. Date <b>1983</b>	
		37. Revision Dates <span style="float:right;">38. Staff Review</span>	