

United States Department of the Interior
Heritage Conservation and Recreation Service

National Register of Historic Places
Inventory—Nomination Form

See instructions in *How to Complete National Register Forms*
Type all entries—complete applicable sections

1. Name Haese Memorial Village Historic District

historic F. G. Haese General Merchandise Store

and/or common Haese Memorial Village Historic District (preferred)

2. Location

street & number SE corner of Milwaukee and Randolph ^{Sts.} Streets not for publication

city, town Forest Junction vicinity of _____ congressional district 6th

state Wisconsin code 055 county Calumet code 015

3. Classification

Category	Ownership	Status	Present Use	
<input checked="" type="checkbox"/> district	<input type="checkbox"/> public	<input checked="" type="checkbox"/> occupied	<input type="checkbox"/> agriculture	<input checked="" type="checkbox"/> museum
<input type="checkbox"/> building(s)	<input checked="" type="checkbox"/> private	<input type="checkbox"/> unoccupied	<input type="checkbox"/> commercial	<input type="checkbox"/> park
<input type="checkbox"/> structure	<input type="checkbox"/> both	<input type="checkbox"/> work in progress	<input type="checkbox"/> educational	<input type="checkbox"/> private residence
<input type="checkbox"/> site	Public Acquisition	Accessible	<input type="checkbox"/> entertainment	<input type="checkbox"/> religious
<input type="checkbox"/> object	<input type="checkbox"/> in process	<input type="checkbox"/> yes: restricted	<input type="checkbox"/> government	<input type="checkbox"/> scientific
	<input type="checkbox"/> being considered	<input checked="" type="checkbox"/> yes: unrestricted	<input type="checkbox"/> industrial	<input type="checkbox"/> transportation
		<input type="checkbox"/> no	<input type="checkbox"/> military	<input type="checkbox"/> other:

4. Owner of Property

name Haese Memorial Village Historical Society

street & number SE corner of Milwaukee and Randolph Streets

city, town Forest Junction vicinity of _____ state Wisconsin 54123

5. Location of Legal Description

courthouse, registry of deeds, etc. Calumet County Courthouse

street & number 206 Court Street

city, town Chilton vicinity of _____ state Wisconsin 53014

6. Representation in Existing Surveys

title Wisconsin Inventory of Historic Places has this property been determined eligible? yes no

date 1978 federal state county local

depository for survey records State Historical Society of Wisconsin

city, town Madison vicinity of _____ state Wisconsin 53706

7. Description

Condition		Check one	Check one
<input type="checkbox"/> excellent	<input type="checkbox"/> deteriorated	<input type="checkbox"/> unaltered	<input checked="" type="checkbox"/> original site
<input checked="" type="checkbox"/> good	<input type="checkbox"/> ruins	<input checked="" type="checkbox"/> altered	<input type="checkbox"/> moved date _____
<input type="checkbox"/> fair	<input type="checkbox"/> unexposed		

Describe the present and original (if known) physical appearance

Forest Junction lies in an area of poorly-drained marshland and sandy cropland. The village derives its name from the criss-crossing of two railroads in the lowland forests of northeastern Calumet County in the early 1870's. Originally, village life focused on the railroads as storefronts faced the tracks; houses were built behind the rows of commercial buildings that lined both the north-south and east-west rails. The coming of major highways in 1931 shifted the center of the village away from its former lifeline. By the late 1960s rail traffic was practically nonexistent and most of the old shops and taverns were forced to close due to the competition from nearby Appleton that the automobile had opened up. Since then, the old commercial center of Forest Junction, with the exception of the Haese Memorial Village Historic District, has badly deteriorated.

The Haese Memorial Village Historic District is a group of vernacular, turn-of-the-century commercial buildings located on the northwestern limits of Forest Junction. The site fronts the railroad tracks of the Milwaukee Road and includes the main store and living quarters, a large lumber warehouse that enclosed the hardware store (former Jeremiah Hunt establishment), a machine warehouse, the first gasoline station in Forest Junction, a cement shed, two-story barn, carriage house with upstairs granary, milkhouse/summer kitchen, smokehouse, chicken coop, and large outhouse.

Boundaries

The Haese Memorial Village Historic District is a compact unit bounded on the east by a row of early twentieth century residential buildings and by open farmland. To the west are the ramshackle remains of main street while a residential area composed of late-nineteenth to mid-twentieth century vernacular style lies beyond that. The southern edge of the district is bordered by a few farm machinery warehouses and grain elevators that quickly give way to farmland. To the north across the railroad tracks and the highway, the land is devoted to agriculture as well.

The exact boundaries of the district are as follows: the western boundary is formed by Milwaukee Street, at the north end by the tracks of the Chicago & Northwestern Railroad. The eastern boundary is formed by an unnamed road and extends 400 feet to the property line. From this point the southern boundary extends westward (to the right) 180 feet along the property line to Milwaukee Street.

Archeological Potential

There are no known archeological sites within the district, but the area as yet has not been thoroughly evaluated. It should be noted that several sites have been found outside of the district boundaries.

Inventory of Properties

All structures in the district are owned and maintained by the Haese Memorial Village Historical Society. Those structures inventoried below that are pivotal or contributing are designed as "P" and "C" respectively.

**United States Department of the Interior
Heritage Conservation and Recreation Service**

**National Register of Historic Places
Inventory—Nomination Form**

Haese Memorial Village District

Continuation sheet

Item number 7

Page 1

7. Description

Main general store and living quarters - P.

The main general store was built in 1884 by a local carpenter. Rectangular in plan, it is constructed of a heavy timber in combination with a later balloon frame, covered with locally milled clapboard. The original roof was made of wood shingles but was later replaced with tin. In 1914 the store underwent some remodeling as a second story was added to an earlier "stone-wall" addition on the north side. A window was also placed in the attic. The present two-story elevation is crowned by a shouldered segmental arch defined by a heavy, bracketed wood cornice carried above the attic story in "boom-town" fashion. The original storefront, with six-paned display windows and center double doors and transom, is still in place on the front facade. The floors in the main store are in original condition, having been constructed of wide pine boards. Hardware, lighting, and plumbing fixtures date from 1914. Most of the original furnishings, as well as a variety of merchandise, remain in both the store and the living quarters.

Hardware store/warehouse - P.

In 1889, a neighboring store, owned by Jeremiah Hunt and built by the S.S. Roby and Company of Menasha in 1874, was acquired by Haese. This structure was later incorporated into a large lumber warehouse in 1934, leaving the Hunt store intact. The interior of Hunt's hardware store looks much as it did in the 1870s with its exposed hewn beams and rough pine woodwork. The rough pine floor boards and service counters are the originals and are in good condition. An array of goods is housed in the building, including a cream separator, hay hooks, millstone and other hardware items, most of which have never been used. The warehouse measures 40 by 90 feet and is constructed of clapboard over a balloon frame with a gable roof, covered with tin.

Machine shed - C.

A vertical board and batten frame building that measures 20 feet by 100 feet. It has a tin-covered gable roof. The building dates from about 1914.

Gasoline "station" - C.

The first gasoline "station" in the village, it is a four by four foot frame shed with shingled gabled roof and clapboard exterior, built in 1908.

Milkhouse/summer kitchen - C.

A single-story ell-shaped frame building with clapboard exterior and an asphalt shingle gable roof.

**United States Department of the Interior
Heritage Conservation and Recreation Service**

**National Register of Historic Places
Inventory—Nomination Form**

HAESE MEMORIAL VILLAGE DISTRICT

Continuation sheet

Item number 7

Page 2

Carriage house/granary - C.

Two-story frame building with clapboard exterior and medium gable roof with asphalt shingles. The granary occupies the second floor with the carriage "house" on the first.

Barn - C.

A two-story frame structure with shiplap siding and an asphalt shingle gable roof.

Smokehouse - C.

A single-story, approximately four by six foot, frame building with board and batten siding and asphalt-shingled gable roof.

Outhouse - C.

A single-story, four by four foot, frame building with clapboard exterior and an asphalt-shingled gable roof.

8. Significance

Period	Areas of Significance—Check and justify below			
<input type="checkbox"/> prehistoric	<input type="checkbox"/> archeology-prehistoric	<input type="checkbox"/> community planning	<input type="checkbox"/> landscape architecture	<input type="checkbox"/> religion
<input type="checkbox"/> 1400–1499	<input type="checkbox"/> archeology-historic	<input type="checkbox"/> conservation	<input type="checkbox"/> law	<input type="checkbox"/> science
<input type="checkbox"/> 1500–1599	<input type="checkbox"/> agriculture	<input type="checkbox"/> economics	<input type="checkbox"/> literature	<input type="checkbox"/> sculpture
<input type="checkbox"/> 1600–1699	<input checked="" type="checkbox"/> architecture	<input type="checkbox"/> education	<input type="checkbox"/> military	<input type="checkbox"/> social/ humanitarian
<input type="checkbox"/> 1700–1799	<input type="checkbox"/> art	<input type="checkbox"/> engineering	<input type="checkbox"/> music	<input type="checkbox"/> theater
<input checked="" type="checkbox"/> 1800–1899	<input checked="" type="checkbox"/> commerce	<input type="checkbox"/> exploration/settlement	<input type="checkbox"/> philosophy	<input type="checkbox"/> transportation
<input checked="" type="checkbox"/> 1900–	<input type="checkbox"/> communications	<input type="checkbox"/> industry	<input type="checkbox"/> politics/government	<input type="checkbox"/> other (specify)
Specific dates	1874, ¹ 1884 ²	Builder/Architect		

Statement of Significance (in one paragraph)

The Haese Memorial Village District is significant as one of the few well-preserved turn-of-the-century commercial groups that exist in small-town Wisconsin. It is representative of the role and ultimate success of the small-town entrepreneur who was later to fall to the rise of the chain store. Architecturally, the Haese Memorial Village District is a rare survivor of turn-of-the-century commercial and residential building forms.

Commerce

Forest Junction, in northeastern Calumet County, derives its names from the fact that it was here in 1873 that two railroads crossed in the then "virgin forest."³ Very little of either of these distinguishing features remains today; the forest has all but been cut down and the trains run through once or twice a week rather than daily. What does remain to remind us of this village's history are a few scattered structures, the most significant of them being the former F. G. Haese General Merchandise Store, now referred to as the Haese Memorial Village. As Forest Junction was created by the railroads, it was only natural that one of its early and most successful businessmen should come into town, "not on foot, not on horseback, nor in a horse-drawn carriage, but riding in an early Milwaukee, LakeShore & Western railroad locomotive."⁴

The year was 1885 and the village of Forest Junction was only twelve years old. Three stores, a saloon, the charcoal kilns, the sawmill, the railroad depot, the hotel (none of which is still standing), and a few scattered residences were all that comprised this pioneer community.⁵ Shortly after his arrival on August 18, 1885, Haese entered into a partnership with his brother-in-law, John F. Otto, who had built a store in the village in 1884 with the aid of another early entrepreneur of Forest Junction, Leopold Graetz. On June 27, 1887, Haese bought out his partners and acquired full interest in the 24 x 60 foot store.⁶

Within a few short years Haese was expanding his interests. In 1893, as the country slid into one of its gravest depressions, Haese added lumber and other building materials to his line of merchandise. This arose from his practice of trading in goods as well as cash, a common activity of frontier merchants. During this first great industrial depression, Haese took farm produce from area residents in exchange for manufactured items. He then shipped this produce to the lumber camps of northern Wisconsin. When the camps were faced with an era of tight money, they paid Haese, and merchants like him, in lumber.⁷

9. Major Bibliographical References

Articles of Dissolution, June 27, 1887 (regarding the partnership of John F. Otto and F. G. Haese). Copies available at the Haese Memorial Village Complex and at the Register of Deeds Office, Calumet County Courthouse, Chilton.
 The Brillion News, (October 15, 1943-January 1, 1944).

10. Geographical Data

ACREAGE NOT VERIFIED
 UTM NOT VERIFIED

Acreege of nominated property 1.65

Quadrangle name Hilbert, Wis.

Quadrangle scale 1:24000

UTM References

A

1	6	4	0	8	7	5	10	4	8	9	5	3	6	10
Zone		Easting						Northing						

B

Zone		Easting						Northing					

C

Zone		Easting						Northing					

D

Zone		Easting						Northing					

E

Zone		Easting						Northing					

F

Zone		Easting						Northing					

G

Zone		Easting						Northing					

H

Zone		Easting						Northing					

Verbal boundary description and justification

Lots 2 through 10 of Block 10, of the original plat of Forest Junction, Wisconsin (also known as the Baldwin Plat).

List all states and counties for properties overlapping state or county boundaries

state	code	county	code

11. Form Prepared By

name/title Michael R. Matucheski, Researcher, Historic Preservation Division

organization State Historical Society of Wisconsin date June 10, 1980

street & number 816 State Street telephone 608/262-8904

city or town Madison state Wisconsin 53706

12. State Historic Preservation Officer Certification

The evaluated significance of this property within the state is:

national state local

As the designated State Historic Preservation Officer for the National Historic Preservation Act of 1966 (Public Law 89-665), I hereby nominate this property for inclusion in the National Register and certify that it has been evaluated according to the criteria and procedures set forth by the Heritage Conservation and Recreation Service.

State Historic Preservation Officer signature *Richard Murray*

title Director, State Historical Society of Wisconsin date 11/17/80

For HCRS use only	
I hereby certify that this property is included in the National Register	
<u><i>David M. ...</i></u>	date <u>3/2/82</u>
Keeper of the National Register	
Attest:	date
Chief of Registration	

**United States Department of the Interior
Heritage Conservation and Recreation Service**

**National Register of Historic Places
Inventory—Nomination Form**



Haese Memorial Village District

Continuation sheet

Item number 8

Page 1

8. Significance

The motto of the F. G. Haese General Merchandise Store was: "We have it, we'll get it, or it isn't made!"⁸ Haese grew to meet the needs of his clients, needs that were ever changing. In 1889, Haese acquired the neighboring hardware store of Jeremiah Hunt.⁹ Later, to meet the demands of the expanding agricultural sector, a farm implement line was added, again through the buying out of a potential competitor. With the dawn of the automobile age, new needs manifested themselves and Haese did his utmost to satisfy them. A small four by four foot building, housing a one hundred gallon tank, was constructed in September of 1908 and it was here that the village's first automobiles came in 1910 and 1911 to fill their tanks.¹⁰

Although Haese answered the initial challenge presented by the automobile, it was this single device that was to have much to do with the demise of his own general store and others like it. The automobile brought increased mobility and provided people with the opportunity to take their business to the big city. Haese died in 1936 and was succeeded by his son, Robert. Business declined following World War II as the community had access to better roads and shopping centers in nearby Appleton. Since then, the store had been operated as something of a living museum, a place where one could linger awhile in the days of yesteryear. Robert Haese died in 1966 and shortly afterward the Haese properties were acquired by the local historical society. Immediate plans call for the preservation of this commercial landmark of Forest Junction.

Architecture

Rarely found in largely original condition on the original site, the Haese Memorial Village is a valuable remnant of turn-of-the-century village form. Taken both collectively and individually, all are good examples of vernacular commercial structures typically built in small towns in the nineteenth century. In particular, the retention of interior features, furnishings, and merchandise, as well as the exterior form of the general store, makes this an exceptional historical document. The well-preserved state of the Haese Memorial Village is in stark contrast with the few existing residential and commercial structures that date from the same period. Unlike the Haese properties, most of these buildings are dilapidated or have been compromised by additions.

**United States Department of the Interior
Heritage Conservation and Recreation Service**

**National Register of Historic Places
Inventory—Nomination Form**

Haese Memorial Village District
Continuation sheet

Item number 8

Page 2



Integrity of the District

Currently, the Haese properties are owned by the Haese Memorial Village Society which maintains the buildings as a museum. This effort preserves the turn-of-the-century atmosphere of the district. The inclusion of the farm outbuildings and other structures rounds-out the depiction of the dominating role played by Haese in the commercial life of the village of Forest Junction. The Haese Memorial Village District is virtually unlike any other in a similar area in the state as it has undergone very few changes since the early decades of this century.

Boundary Justification

The boundaries for the district were chosen on the basis of the property held by F. G. Haese, with the exception of the agricultural lands, now controlled by the local historical society.

**United States Department of the Interior
Heritage Conservation and Recreation Service**

**National Register of Historic Places
Inventory—Nomination Form**



Haese Memorial Village District
Continuation sheet

Item number 8

Page 3

FOOTNOTES

¹Construction date of the Jeremiah Hunt store which was acquired by Haese in 1889. Robert Haese, At Seventy: A History of Forest Junction, Calumet County, Wisconsin, 1873-1943 (Brillion, Wisconsin: Brillion News, 1944), p. 15.

²Ibid., p. 16.

³Ibid., p. 3.

⁴Robert Haese, As Time Rolls On! (Forest Junction: Robert Haese, 1950), p. 8.

⁵Haese, At Seventy, p. 15.

⁶Articles of Dissolution, June 27, 1887. Copies available at Haese Memorial Village Complex and at Register of Deeds Office, Calumet County Courthouse, Chilton.

⁷Haese, As Time Rolls On!, p. 10.

⁸From letterhead available at the Haese Memorial Village Complex.

⁹Warranty Deed, September 26, 1889. Copies available at the Haese Memorial Village Complex and at the Register of Deeds Office, Calumet County Courthouse, Chilton.

¹⁰Haese, As Time Rolls On!, p. 11.

**United States Department of the Interior
Heritage Conservation and Recreation Service**

**National Register of Historic Places
Inventory—Nomination Form**



Haese Memorial Village District

Continuation sheet

Item number 9, 11

Page 1

9. Major Bibliographical References

Haese, Robert. As Time Rolls On! Forest Junction: Robert Haese, 1950.

Haese, Robert. At Seventy: A History of Forest Junction, Wisconsin, Calumet County, Wisconsin, 1873-1943. Brillion, Wisconsin: Brillion News, 1944.

Warranty Deeds for F. G. Haese properties: September 26, 1889; January 25, 1897; January 20, 1899, July 25, 1900.

Wisconsin State Gazetteer and Business Directory, 1879-1924.

11. Form Prepared by

Diane H. Filipowicz, Architectural Historian
Historic Preservation Division
State Historical Society of Wisconsin
816 State Street
Madison, Wisconsin 53706

June 1980
608/262-2970

HAESE MEMORIAL VILLAGE SITE PLAN

SCALE: 1 INCH = 40 FT.

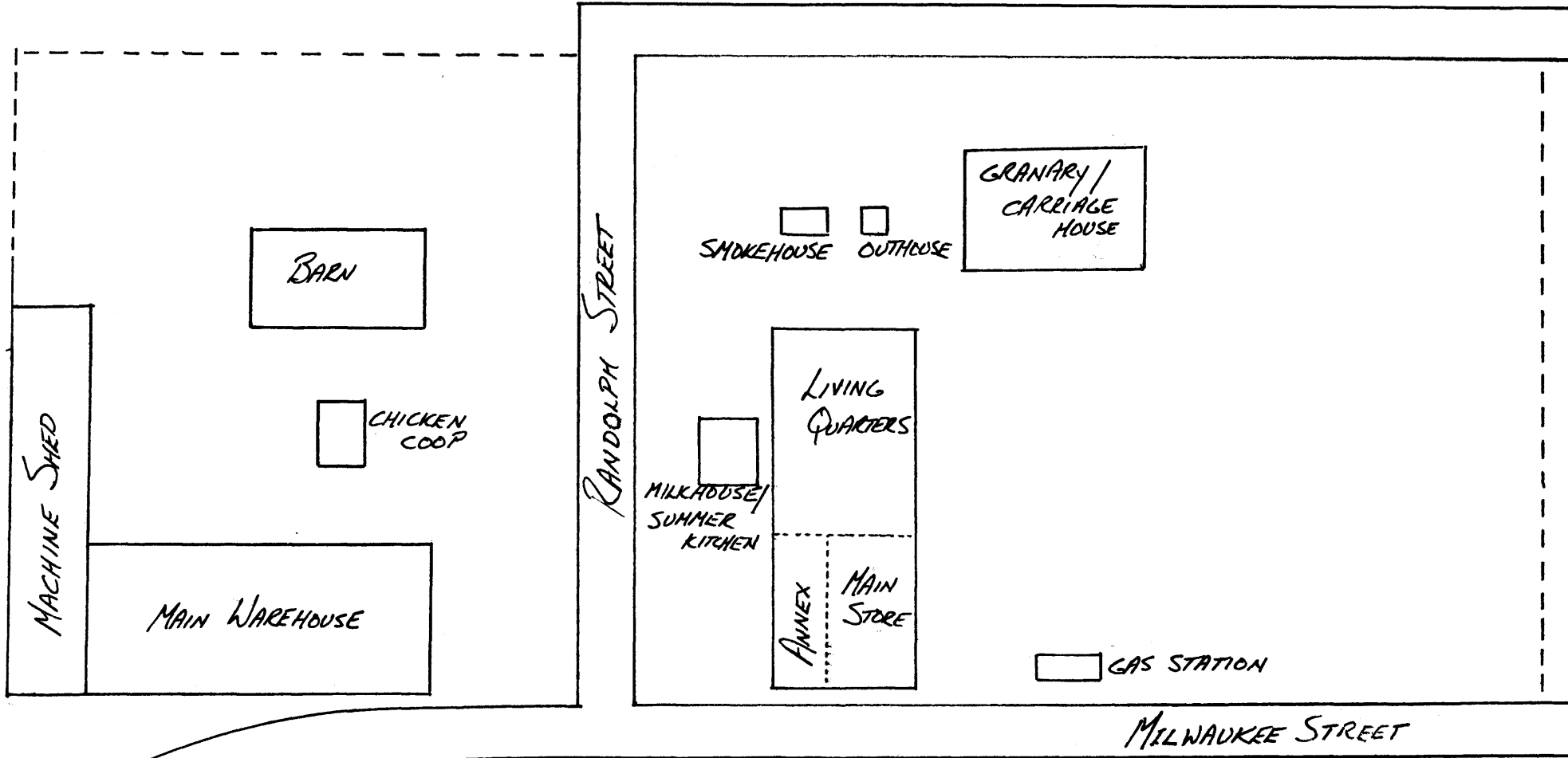

DEC 3 1980

CHICAGO, MILWAUKEE, ST. PAUL AND PACIFIC RAILROAD