

A. HISTORIC NAME Commercial Building B. COUNTY Vanderburgh C. NUMBER 82-196-00012
 D. ADDRESS 611-613 Main Street E. TWP/CITY Pigeon F. QUAD NAME Evansville-South
 RATING Outstanding Significant/Notable Contributing/Reference Non-Contributing UTM REFERENCES 18 45,006,0 4,20,27,6,0

STATE OF INDIANA DEPARTMENT OF NATURAL RESOURCES INDIANA HISTORIC SITES AND STRUCTURES INVENTORY REVISED 1981

MOUNT CONTACT PRINTS HERE

1. COMMON NAME Dallas Music / Conner's Bookstore
 2. OWNERSHIP Public Private
 3. VISIBLE Yes No
 4. PROPERTY'S MAILING ADDRESS
Dallas Hughes
401 W. Buena Vista
Evansville, Indiana 47710
 5. LOCATION NOTES
Sub lots 2-3 of Eastern Enlargement,
Block 37, lot 2.

6. USE		PRESENT	PAST	PRESENT	PAST	7. ENDANGERED	8. CATEGORY	9a. LOCAL LEGAL PROTECTIONS
Residence	<input type="checkbox"/>	<input type="checkbox"/>	Military	<input type="checkbox"/>	<input type="checkbox"/>	<input type="checkbox"/> Vacant	<input type="checkbox"/> District	<input type="checkbox"/> Historic District
Govt./Pol.	<input type="checkbox"/>	<input type="checkbox"/>	Entertainment	<input type="checkbox"/>	<input type="checkbox"/>	<input type="checkbox"/> Neglected	<input checked="" type="checkbox"/> Building(s)	<input type="checkbox"/> Landmark
Commerce	<input checked="" type="checkbox"/>	<input checked="" type="checkbox"/>	Scientific	<input type="checkbox"/>	<input type="checkbox"/>	<input type="checkbox"/> Encroachment	<input type="checkbox"/> Structure	<input type="checkbox"/> Deed Restriction
Industrial	<input type="checkbox"/>	<input type="checkbox"/>	Religious	<input type="checkbox"/>	<input type="checkbox"/>	<input type="checkbox"/> Other	<input type="checkbox"/> Site	<input type="checkbox"/> Other
Agriculture	<input type="checkbox"/>	<input type="checkbox"/>	Park	<input type="checkbox"/>	<input type="checkbox"/>		<input type="checkbox"/> Object	
Transportation	<input type="checkbox"/>	<input type="checkbox"/>	Museum	<input type="checkbox"/>	<input type="checkbox"/>			
Organization	<input type="checkbox"/>	<input type="checkbox"/>	Educational	<input type="checkbox"/>	<input type="checkbox"/>			
Other								

9b. SURVEYS
 SR NR NHL HABS HAER

10. CONDITION
 Excellent
 Good
 Fair
 Deteriorated
 Ruins

11. BUILDING INTEGRITY
 Unaltered
 Altered
 Moved
 Date _____

11a. Specify Alterations
 Removals _____
 Structural _____
 Replacement ground floor modernized
 Additions _____

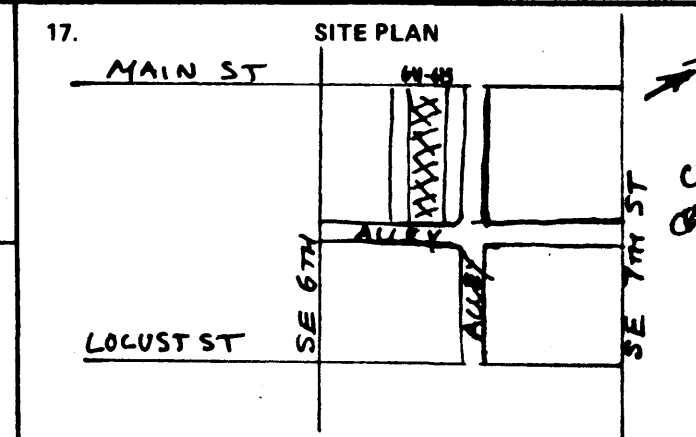

12. DATE c. 1865 13. STYLE Commercial Vernacular 14. ARCHITECT/BUILDER Not known.
 15. DESCRIPTION See below.
 Inscriptions none Facade Material brick
 16. OUTBUILDINGS none

18. ENVIRONMENT commercial, retail

19. AREAS OF SIGNIFICANCE: Specify the significance for each area checked 15.

<input type="checkbox"/> Aboriginal	<input checked="" type="checkbox"/> Arts	<input checked="" type="checkbox"/> Architecture	<input type="checkbox"/> Commerce	<input type="checkbox"/> Communications	<input type="checkbox"/> Community Planning	<input type="checkbox"/> Education	<input type="checkbox"/> Engineering	<input type="checkbox"/> Environs/Neighborhoods	<input type="checkbox"/> Exploration/Settlement	<input type="checkbox"/> Humanities	<input type="checkbox"/> Indian	<input type="checkbox"/> Landscape Architecture	<input type="checkbox"/> Military	<input type="checkbox"/> Politics/Government	<input type="checkbox"/> Religion	<input type="checkbox"/> Science/Technology	<input type="checkbox"/> Social/Ethnicity	<input checked="" type="checkbox"/> Transportation	<input type="checkbox"/> Vernacular/Construction	<input type="checkbox"/> Other
-------------------------------------	--	--	-----------------------------------	---	---	------------------------------------	--------------------------------------	---	---	-------------------------------------	---------------------------------	---	-----------------------------------	--	-----------------------------------	---	---	--	--	--------------------------------

Number 611-13 Main is a two story painted brick commercial building enclosed by a pitched roof forming end gables. Having a frontage of 37 feet, it was built to house two storerooms with second floor living quarters. The ground elevation has been modernized relatively recently with large display windows and the interior is now one large storeroom. There are three central, single-leaf entry doors, two opening into each side of the storeroom and a middle one leading to an interior stairway for second story access. Above the modernized ground floor the original plan remains and is characterized by 6 double hung sash containing 1/1 lights. Stone serves for lintels and sills. The rear of the building has been extended by a one-story concrete block addition. The acreage of the site is approximately .2 acre.

ATTACH NEGATIVE ENVELOPE HERE

19: See Additional Architectural Information form.

20. INFORMATION SOURCES Deed Records; City Directories; Assessment Records.

21. SURVEYOR Douglas L Stern 22. DATE 07 December 1982 (Amended)

**STATE OF INDIANA
DEPARTMENT OF NATURAL RESOURCES
INDIANA HISTORIC SITES AND STRUCTURES INVENTORY**

Additional Architectural Information

A. NAME Cornis Bookstore C. NUMBER 82-196-00012
B. ADDRESS 611-613 Main Street
D. UTM References

1	6	4	5	0	0	6	0	4	2	0	2	7	6	0
---	---	---	---	---	---	---	---	---	---	---	---	---	---	---

E. 19.

There is not any other building in the entire Downtown Multiple Resources Area which matches the significance of 611-13 Main Street. Erected in about 1865, the small, brick structure is the oldest commercial building remaining in the MRA and the only one left from the immediate post-bellum period.

Evansville profited from the Civil War. Like other border cities (North and South alike), Evansville was free of the physical ruin and devastation of commercial cities in the Deep South. Not only was its trade with its traditional southern markets not interrupted during and after the war, it actually increased. While its sons marched off, its merchants and manufacturers were realizing practically windfall profits.

Precious few of the buildings which housed those war time and Reconstruction era commission merchants or manufacturers remain today. In fact, because of the extensive rebuilding at the turn of the century and afterwards, only a mere handful of pre-1865 buildings of any sort exist in the MRA.

The building at 611-13 Main Street represents more, however, than just the history of commerce in post-Civil War Evansville. The physical characteristics of the building are not seen anywhere else. Its gable roof and free-standing side walls, for example, are solitary reminders of early construction methods supplanted by later, more urban party walls and flat roofs.

F. INFORMATION SOURCES _____

G. PREPARED BY Douglas L Stern

H. DATE 07 December 1982 (Amended)

FEB 23 1984