

NATIONAL REGISTER OF HISTORIC PLACES
INVENTORY - NOMINATION FORM

(Type all entries - complete applicable sections)

STATE: Minnesota	
COUNTY: Crow Wing Cass	
FOR NPS USE ONLY	
ENTRY NUMBER 70-7-22-0068	DATE 7/28/70

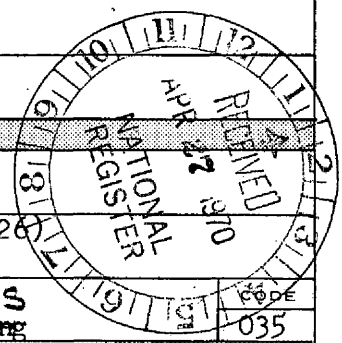

1. NAME

COMMON:
Crow Wing State Park

AND/OR HISTORIC:
Crow Wing

2. LOCATION

STREET AND NUMBER: Morrison County--T132N, R29W (sec. 4, 5, 8)
Cass County--T133N, R29W (sec. 33, 34)

CITY OR TOWN: Crow Wing County--T132N, R32W (sec. 23, 24, 26)
Barrows vicinity, - c. 6 m SW T133N, R32W (sec. 13)

STATE: Minnesota CODE: 22 COUNTY: Cass Crow Wing CODE: 035

3. CLASSIFICATION

CATEGORY (Check One)	OWNERSHIP	STATUS	ACCESSIBLE TO THE PUBLIC
<input type="checkbox"/> District <input type="checkbox"/> Site <input type="checkbox"/> Object <input checked="" type="checkbox"/> Building <input type="checkbox"/> Structure	<input type="checkbox"/> Public <input type="checkbox"/> Private <input type="checkbox"/> Both <input checked="" type="checkbox"/> Public Acquisition: <input type="checkbox"/> In Process <input type="checkbox"/> Being Considered	<input type="checkbox"/> Occupied <input checked="" type="checkbox"/> Unoccupied <input type="checkbox"/> Preservation work in progress	Yes: <input checked="" type="checkbox"/> Restricted <input type="checkbox"/> Unrestricted <input type="checkbox"/> No
PRESENT USE (Check One or More as Appropriate)			
<input type="checkbox"/> Agricultural <input type="checkbox"/> Commercial <input type="checkbox"/> Educational <input checked="" type="checkbox"/> Entertainment	<input type="checkbox"/> Government <input type="checkbox"/> Industrial <input type="checkbox"/> Military <input type="checkbox"/> Museum	<input type="checkbox"/> Park <input type="checkbox"/> Private Residence <input type="checkbox"/> Religious <input type="checkbox"/> Scientific	<input checked="" type="checkbox"/> Transportation <input type="checkbox"/> Other (Specify) _____ _____

4. OWNER OF PROPERTY

OWNER'S NAME:
State of Minnesota, Division of State Parks

STREET AND NUMBER:
Centennial Building

CITY OR TOWN: St. Paul STATE: Minnesota CODE: 22

5. LOCATION OF LEGAL DESCRIPTION

COURTHOUSE, REGISTRY OF DEEDS, ETC:

STREET AND NUMBER:

CITY OR TOWN: Brainerd: Approximate acreage of Nominated Property: 1879 STATE: Minnesota CODE: 22

6. REPRESENTATION IN EXISTING SURVEYS

TITLE OF SURVEY:
Minnesota State Register of Historic Sites

DATE OF SURVEY: 1969 Federal State County Local

DEPOSITORY FOR SURVEY RECORDS:
Minnesota Historical Society

STREET AND NUMBER:
690 Cedar Street

CITY OR TOWN: St. Paul STATE: Minnesota CODE: 22

SEE INSTRUCTIONS

STATE: Minnesota
COUNTY: Crow Wing
FOR NPS USE ONLY
ENTRY NUMBER
DATE

7. DESCRIPTION

CONDITION	(Check One)					
	<input type="checkbox"/> Excellent	<input type="checkbox"/> Good	<input type="checkbox"/> Fair	<input type="checkbox"/> Deteriorated	<input checked="" type="checkbox"/> Ruins	<input type="checkbox"/> Unexposed
	(Check One)			(Check One)		
	<input checked="" type="checkbox"/> Altered	<input type="checkbox"/> Unaltered		<input type="checkbox"/> Moved	<input checked="" type="checkbox"/> Original Site	

DESCRIBE THE PRESENT AND ORIGINAL (if known) PHYSICAL APPEARANCE

The site of Crow Wing is located eight miles south of Brainerd, Minnesota on the east bank of the Mississippi River opposite the mouth of the Crow Wing River. The town was spread out on about 430 acres of land, most of which is now in Crow Wing State Park. Crow Wing is situated on a bluff among rolling hills and is surrounded by six marshes.

The area was originally occupied by the Dakota Indians, but during the eighteenth century they were pushed out by the Chippewa. The firing pits which the Chippewa dug before the battle can still be seen, located on the east bank of the Mississippi River about 300 yards south of the mouth of the Crow Wing River. (See Significance)

The first white trappers entered the Crow Wing area in 1767, and the town reached its population peak (600) in the 1860's. Most of the village from the 1840's through the '60's was built directly opposite the Crow Wing mouth on the east side of the Mississippi. The identification of the following sites is presumed on the basis of the limited documentation available. The Fairbank Store, the Beaulieu trading post, Brown's Hotel, an old mansion, and a Catholic Church and cemetery were located opposite the north mouth of the Crow Wing River between the branch of the Red River Trail which ran along within 100 yards of the Mississippi and the branch of the trail which ran southeast to Sandy Lake. About 400 yards north of this area on the Red River Trail were the town well, government warehouses, and a ferry landing. About 350 yards to the northwest of the fork there was a trading post, and 300 yards to the northeast of the Red River Trail fork the William Aitkin trading post, the school, the schoolmaster's home, and an Episcopal Cemetery were located. Chief Hole-in-the-Day's campground was about 600 yards northwest of the fork, but there is no visible evidence of it now. There was a house along the Trail about 300 yards south of the fork, and about 300 yards south of this was the Allan Morrison home.

None of the structures at Crow Wing are still standing. All that remains are 15 to 20 cellar depressions. One of these has been excavated to determine if it was the Beaulieu trading post, which it was not, but the rest of the ruins are undisturbed. If Crow Wing could be excavated further, it would add to our knowledge of Minnesota history, particularly the life of the prehistoric and historic Dakota and Chippewa Indians, the fur traders, loggers and the territorial settlers.

The boundary of the historic district is the same as that of the Crow Wing State Park as shown by the enclosed map.

SEE INSTRUCTIONS

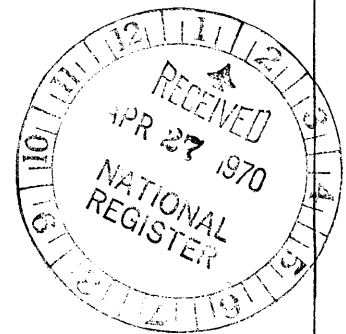

SIGNIFICANCE

PERIOD (Check One or More as Appropriate)

- | | | | |
|--|---------------------------------------|--|---------------------------------------|
| <input type="checkbox"/> Pre-Columbian | <input type="checkbox"/> 16th Century | <input checked="" type="checkbox"/> 18th Century | <input type="checkbox"/> 20th Century |
| <input type="checkbox"/> 15th Century | <input type="checkbox"/> 17th Century | <input checked="" type="checkbox"/> 19th Century | |

SPECIFIC DATE(S) (If Applicable and Known)

AREAS OF SIGNIFICANCE (Check One or More as Appropriate)

- | | | |
|---|--|---|
| <input type="checkbox"/> Aboriginal | <input type="checkbox"/> Education | <input type="checkbox"/> Political |
| <input checked="" type="checkbox"/> Prehistoric | <input type="checkbox"/> Engineering | <input checked="" type="checkbox"/> Religion/Philosophy |
| <input checked="" type="checkbox"/> Historic | <input checked="" type="checkbox"/> Industry | <input type="checkbox"/> Science |
| <input type="checkbox"/> Agriculture | <input type="checkbox"/> Invention | <input type="checkbox"/> Sculpture |
| <input type="checkbox"/> Architecture | <input type="checkbox"/> Landscape | <input type="checkbox"/> Social/Humanitarian |
| <input type="checkbox"/> Art | <input type="checkbox"/> Literature | <input type="checkbox"/> Theater |
| <input checked="" type="checkbox"/> Commerce | <input type="checkbox"/> Military | <input type="checkbox"/> Transportation |
| <input type="checkbox"/> Communications | <input type="checkbox"/> Music | |
| <input type="checkbox"/> Conservation | | |

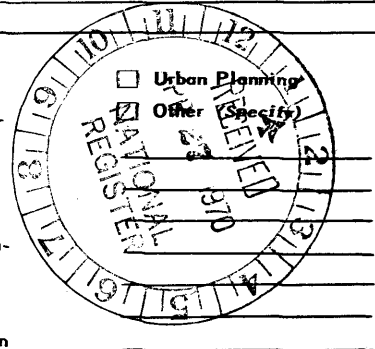

STATEMENT OF SIGNIFICANCE

Old Crow Wing is located on the eastern side of the Mississippi River opposite the mouth of the Crow Wing River at the junction of prehistoric and pre-railroad land and water transportation routes.

This site proved to be an excellent one because the fur traders could send their furs down the Mississippi to St. Louis. Old Crow Wing is a unique site in Minnesota history; it spans a period which includes prehistoric, fur trade, and lumber eras in Minnesota.

This area was inhabited by the Dakota Indians before the arrival of Europeans. In the 18th century the Chippewa Indians migrated west and south from the Great Lakes and drove the Dakota from the lakes of northern Minnesota to the plains and valleys of southern Minnesota. One of the decisive battles for the area of central Minnesota was fought at the mouth of the Crow Wing in the 1750's. The Chippewa dug pits for concealment and protection on the east side of the Mississippi, where the current of the Crow Wing River carried the main current beneath a high bluff. When the Dakota came down the river, the Chippewa, armed with muskets, decisively defeated them, killing many in the water and on the cliff sides.

Where the Chippewa settled, the French fur traders soon followed, and the first trader, Berti, established himself at the mouth of the Crow Wing in 1767. The trade increased and was transferred from French to English to American management. During the next 60 years Crow Wing grew with the fur trade, and in 1823 Allan Morrison built the Crow Wing American Fur Post, which included a post, house, a barn, and an office. When Morrison retired, Clement Beaulieu replaced him. The first true settlement was established in Crow Wing in 1847, and it soon became a center of trade in the upper Mississippi region.

Because of its central location on the transportation routes, Crow Wing was a favored location for new industrial developments. The logging industry arrived in 1848 and soon replaced the fur trade as the primary economy. Throughout most of the 1850's Crow Wing was a prosperous village. The town grew in size and became the county seat in 1857. In the following year, however, a decline began with the Panic of 1858. A number of railroads planning to build through Crow Wing changed their plans and bypassed the village. In 1860 the county government failed and was disbanded.

(more)

SEE INSTRUCTIONS

9. MAJOR BIBLIOGRAPHICAL REFERENCES

Folwell, William W., A History of Minnesota, Minnesota Historical Society Press, 1969, vol. 1,2,3,4

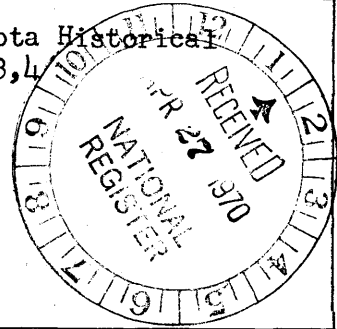

10. GEOGRAPHICAL DATA

LATITUDE AND LONGITUDE COORDINATES DEFINING A RECTANGLE LOCATING THE PROPERTY			O R	LATITUDE AND LONGITUDE COORDINATES DEFINING THE CENTER POINT OF A PROPERTY OF LESS THAN TEN ACRES		
CORNER	LATITUDE	LONGITUDE		LATITUDE	LONGITUDE	
NW	Degrees Minutes Seconds 46° 17' 49"	Degrees Minutes Seconds 94° 22' 12"		Degrees Minutes Seconds ° ' "	Degrees Minutes Seconds ° ' "	
NE	46° 17' 49"	94° 19' 08"				
SE	46° 15' 30"	94° 19' 08"				
SW	46° 15' 30"	94° 22' 12"				

APPROXIMATE ACREAGE OF NOMINATED PROPERTY: 1879 acres

LIST ALL STATES AND COUNTIES FOR PROPERTIES OVERLAPPING STATE OR COUNTY BOUNDARIES

STATE:	CODE	COUNTY	CODE
		Crow Wing	035
		Cass	021
		Morrison	097

11. FORM PREPARED BY

NAME AND TITLE: **John Grossman, Survey and Planning**

ORGANIZATION: **Minnesota Historical Society** DATE: **March 6, 1970**

STREET AND NUMBER: **Fort Snelling (Building 25)**

CITY OR TOWN: **St. Paul** STATE: **Minnesota** CODE: **22**

12. STATE LIAISON OFFICER CERTIFICATION

As the designated State Liaison Officer for the National Historic Preservation Act of 1966 (Public Law 89-665), I hereby nominate this property for inclusion in the National Register and certify that it has been evaluated according to the criteria and procedures set forth by the National Park Service. The recommended level of significance of this nomination is:

National State Local

Name Russell W. Fridley

Title Director, Minn. Historical Society

Date April 6, 1970

NATIONAL REGISTER VERIFICATION

I hereby certify that this property is included in the National Register.

Ernest Allen Gurnally
Chief, Office of Archeology and Historic Preservation

JUL 28 1970

Date _____

ATTEST:

William J. Swartz
Keeper of The National Register

Date JUL 8 1970

NO
VHM
SEE INSTRUCTIONS

NATIONAL REGISTER OF HISTORIC PLACES
INVENTORY - NOMINATION FORM

(Continuation Sheet)

STATE Minnesota	
COUNTY Crow Wing	
FOR NPS USE ONLY	
ENTRY NUMBER 70.7.22.008	DATE 7/28/70

(Number all entries)

8. Significance (continued)

The town still had a population of about 600 in 1866 although only seven families were permanent residents. Shortly after this time, most people began to move away because of the violence among the large Indian population near the village. The Reverend J. O. Gilfillan writes in his History of Indian Missions in Minnesota, that for a period of 75 days, there was an average of one murder a day in Crow Wing. When the Northern Pacific found that there were only a few families left, it moved its right-of-way to near-by Brainerd. When this railroad was built in 1874, most of the remaining people moved with the line, thus leaving the village almost deserted by 1880.

Old Crow Wing is a unique district in Minnesota because it is one of the surviving areas where successive themes can be researched through a century of recorded history and time-out-of-mind before that. This archaeological potential is unusually well preserved, both because it was deserted in the 1880's and because it is now state owned. Here, in one area, a crossroads for centuries, the interpretation can include the story of prehistoric Indian culture which failed to survive the coming of the white man, and the story of a 19th century white settlement which failed to survive the coming of the railroad.

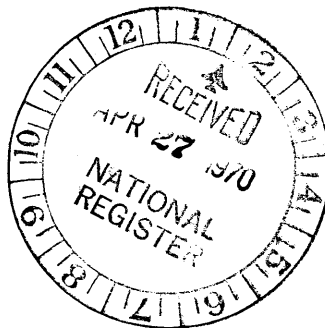

U.S.G.S. 7.5' Quadrangle

Dexter, Minn. 1954

Old Crow Wing

Scale: 1"=24000"

	Long.	Lat.
NW	94° 22' 12"	46° 17' 49"
NE	94° 19' 08"	46° 17' 49"
SE	94° 19' 08"	46° 15' 30"
SW	94° 22' 12"	46° 15' 30"

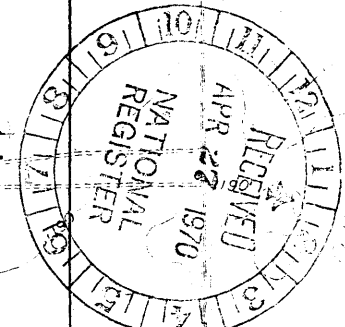
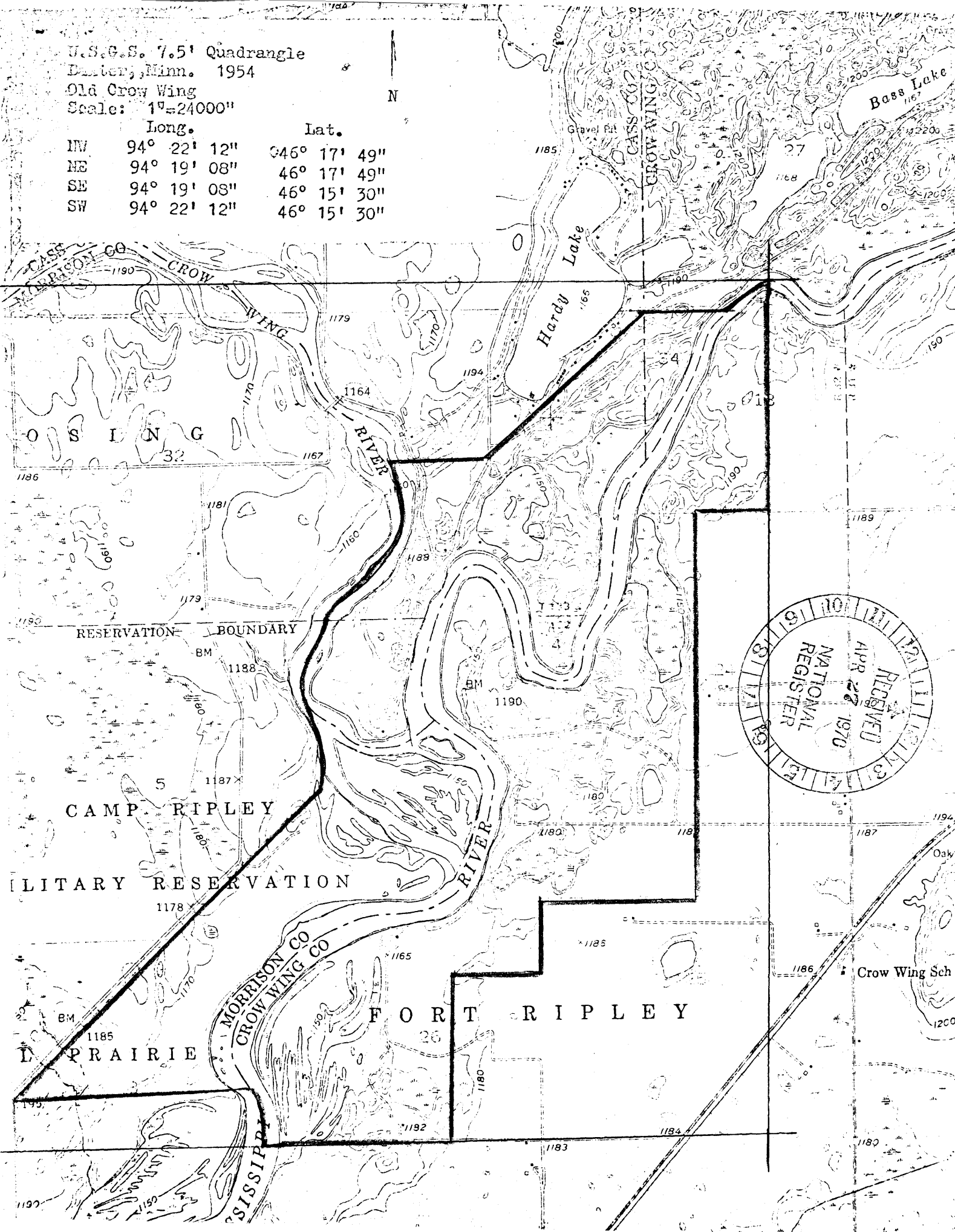

Form 10-301
(July 1969)

UNITED STATES DEPARTMENT OF THE INTERIOR
NATIONAL PARK SERVICE

**NATIONAL REGISTER OF HISTORIC PLACES
PROPERTY MAP FORM**

(Type all entries - attach to or enclose with map)

STATE Minnesota	
COUNTY Crow Wing	
FOR NPS USE ONLY	
ENTRY NUMBER 70-7-22-0008	DATE 7/28/70

SEE INSTRUCTIONS

1. NAME			
COMMON: Old Crow Wing			
AND/OR HISTORIC: Crow Wing			
2. LOCATION			
STREET AND NUMBER:			
CITY OR TOWN:			
STATE: Minnesota	CODE 22	COUNTY: Crow Wing	CODE 035
3. MAP REFERENCE			
SOURCE: U.S.G.S. 7.5' Quadrangle			
SCALE: 1" = 25000'			
DATE: 1954			
4. REQUIREMENTS			
TO BE INCLUDED ON ALL MAPS			
1. Property boundaries where required.			
2. North arrow.			
3. Latitude and longitude reference.			

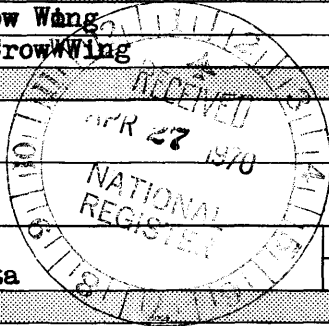

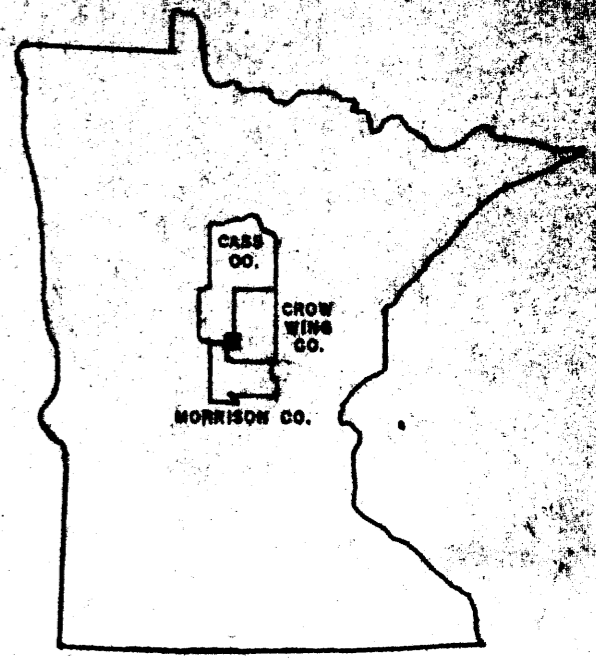
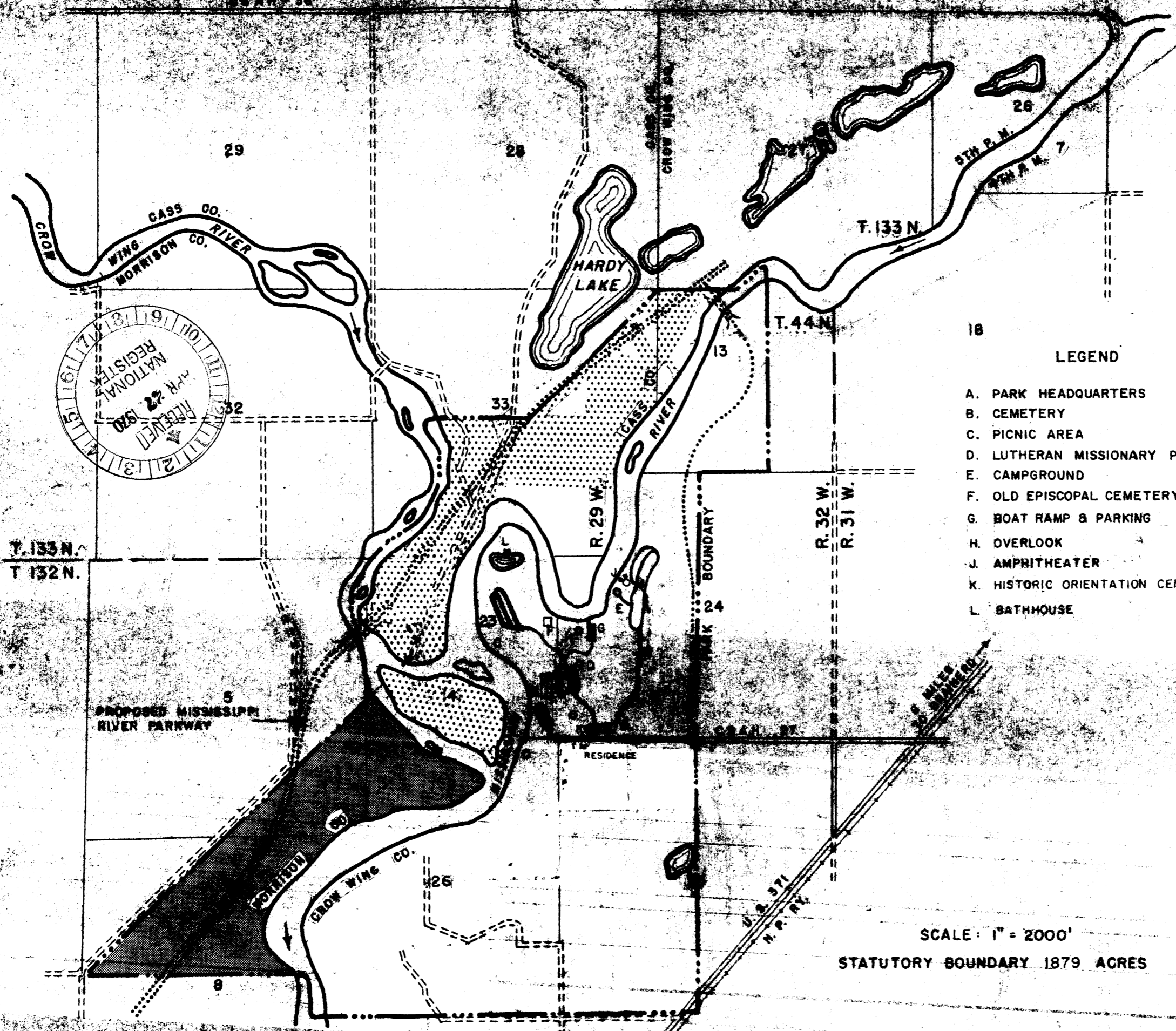

LEGEND

- A. PARK HEADQUARTERS
- B. CEMETERY
- C. PICNIC AREA
- D. LUTHERAN MISSIONARY PLAQUE
- E. CAMPGROUND
- F. OLD EPISCOPAL CEMETERY
- G. BOAT RAMP & PARKING
- H. OVERLOOK
- J. AMPHITHEATER
- K. HISTORIC ORIENTATION CENTER
- L. BATHHOUSE

- KEY
- STATE LAND
 - PRIVATE LAND
 - MILITARY RESERVATION
 - EXISTING DEVELOPMENT
 - PROPOSED DEVELOPMENT

LATITUDE AND LONGITUDE COORDINATES DEFINING A RECTANGLE LOCATING THE PROPERTY

CORNER	LATITUDE			LONGITUDE		
	Degrees	Minutes	Seconds	Degrees	Minutes	Seconds
NW	46	17	49	94	22	12
NE	46	17	49	94	19	08
SE	46	15	30	94	19	03
SW	46	15	30	94	22	12

JAN 9 1976

MINNESOTA CONSERVATION DEPARTMENT
DIVISION OF STATE PARKS

STATE PARK SITE

CROW WING STATE PARK
CROW WING, CASS & MORRISON CO. - NEAR BRAINERD

SCALE: 1" = 2000'
STATUTORY BOUNDARY 1879 ACRES

DRAWN DAD 11-29-62	BUREAU OF ENGINEERING	SURVEY
CHECKED MWR 12-5-62		DATUM
REVISED RES 8-6-69	<i>[Signature]</i> CHIEF ENGINEER	
OWNERSHIP - REV. REQ.	SHEET	FILE
62-22	5	P.0650

Form 10-301
(Dec. 1968)

UNITED STATES DEPARTMENT OF THE INTERIOR
NATIONAL PARK SERVICE

**NATIONAL REGISTER OF HISTORIC PLACES
PROPERTY MAP FORM**

(Type all entries - attach to or enclose with map)

STATE Minnesota	
COUNTY Crow Wing	
FOR NPS USE ONLY	
ENTRY NUMBER	DATE
76.7.22.0088	7/25/70

SEE INSTRUCTIONS

1. NAME			
COMMON: Old Crow Wing			
AND/OR HISTORIC: Crow Wing			
2. LOCATION			
STREET AND NUMBER:			
CITY OR TOWN:			
STATE:	Minnesota	CODE:	22
COUNTY:	Crow Wing	CODE:	035
3. MAP REFERENCE			
SOURCE: Minnesota Conservation Dept., Division of State Parks			
SCALE: 1" = 2000'			
DATE: 8/6/69			
4. REQUIREMENTS			
TO BE INCLUDED ON ALL MAPS			
1. Property boundaries where required.			
2. North arrow.			
3. Latitude and longitude reference.			