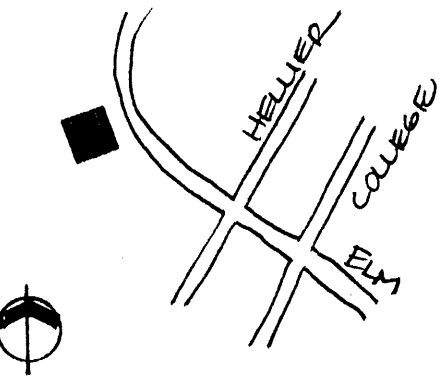
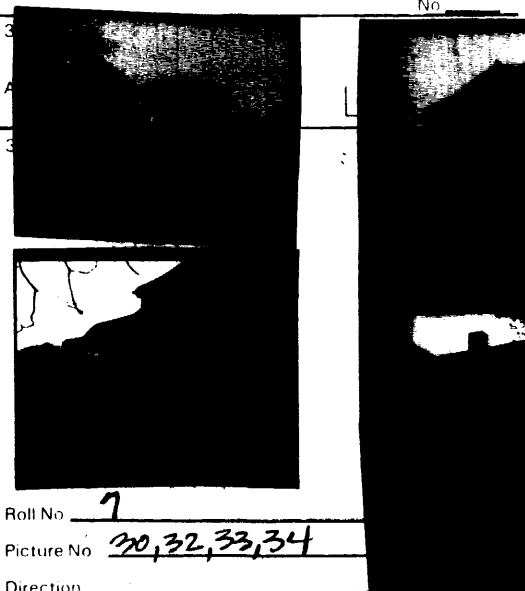

KENTUCKY HISTORIC RESOURCES INVENTORY

Site No. PIP 11

1. Historic Name(s) York Mansion Original Owner Judge J.M. York		22 ADD/County BIG SANDY / PIKE 098	
2. Present Name Creekmore Mansion		23. U.S.G.S. Quadrant (15'/75') Pikeville 	
3. Location 209 Elm Pikeville, Ky. 41501		24. UTM Reference 17 365330 4148740 Zone Easting Northing	
4. Owner's Name Imogene Johnson		25. Coordinate Accuracy 	
5. Owner's Address 209 Elm Pikeville, Ky. 41501		26. Prehistoric Site Object Historic Site Structure X Building Other	
6. Open to Public Yes <input type="checkbox"/> No <input checked="" type="checkbox"/>	7. Visible from road Yes <input checked="" type="checkbox"/> No <input type="checkbox"/>	8. Ownership X Private <input type="checkbox"/> Local <input type="checkbox"/> State <input type="checkbox"/> Federal <input type="checkbox"/>	
9. Local Contact/Organization PRESERVATION COUNCIL OF PIKE COUNTY, INC.		27. National Register District Name: Multiple Resources of Pikeville	
10. Site Plan with North Arrow 		28. Significance Evaluation 	
18. Description Creekmore is 2 stories plus raised basement and high attic; cream brick w/ dark mortar; stone foundation; wrap around porch; black clay tile roof; finials and cresting; Art deco detailing Setting overlooking Pikeville from hill makes it one of Pikeville's landmarks. (Continue on Back)		11. Architect Mrs. Augusta York	
		12. Builder	
		13. Date 1918 A. <input checked="" type="checkbox"/> B. <input type="checkbox"/>	
		14. Style A. Classical <input checked="" type="checkbox"/> M B. Revival <input type="checkbox"/>	
		15. Original Use S.F. Residence <input checked="" type="checkbox"/> A	
		16. Present use "	
		17. Condition Good <input checked="" type="checkbox"/> B	
		No. Stories Two <input checked="" type="checkbox"/> C	
		Single Pile <input type="checkbox"/> NA <input type="checkbox"/> Double Pile <input checked="" type="checkbox"/>	
		Floor Plan Gen. Pas. D.P. <input checked="" type="checkbox"/> K	
Structural Fabric Brick A. <input checked="" type="checkbox"/> B. <input type="checkbox"/>			
Decorative Fabric Marble A. <input checked="" type="checkbox"/> H Tile B. <input checked="" type="checkbox"/> Q			
Roof Form Mansard			
19. History It is thought that Mrs. Augusta York designed this house from a similar one that she had seen in Cincinnati. Judge and Mrs. York never lived in the mansion		29. Status Date National Landmark <input type="checkbox"/> National Register <input type="checkbox"/> Landmark Certificate <input type="checkbox"/> Kentucky Survey <input type="checkbox"/> Local Landmark <input type="checkbox"/> HABS/HAER <input type="checkbox"/>	
20. Significance Retains much of original setting and architectural detailing; very prominent on the Pikeville skyline		30. Historic Theme Primary Architecture C Secondary Appalachian Hist. I I Other <input type="checkbox"/>	
21. Source of Information Kathy Burke 1974 Sandborn 1932		31. Endangered Yes <input type="checkbox"/> No <input type="checkbox"/> 	
34. Prepared by: HELEN POWELL		Roll No. <u>7</u> Picture No. <u>30, 32, 33, 34</u> Direction _____	
35. Organization CARMAN AND POWELL, INC.		36. Date	
37. Revision Dates		38. Staff Review	

KENTUCKY HISTORIC RESOURCE INVENTORY SUPPLEMENT
BOUNDARY AND LOCATION INFORMATION

Historic Property Name York Mansion Site # PIP 11

Multiple Resource/Thematic Nomination Title Multiple Resources of Pikeville

U.T.M. Coordinates - List multiple UTMs if property is ten or more acres.

A. 17 365330 4148740 D. _____

B. _____ E. _____

C. _____ F. _____

Verbal Boundary Description _____ Acreage .32

From the southeast corner of the intersection of Hellier and Elm, 230 feet along the east right of way of Elm to the point of beginning; then 190 feet east to a point; then 70 feet north to a point; then 190 feet west to a point; then 70 feet south to the point of beginning and containing the house, landscaped front yard, and the stone retaining wall.

Sketch of Site Plan (Showing outbuildings, structures, landscape features and the site boundary as described above.)

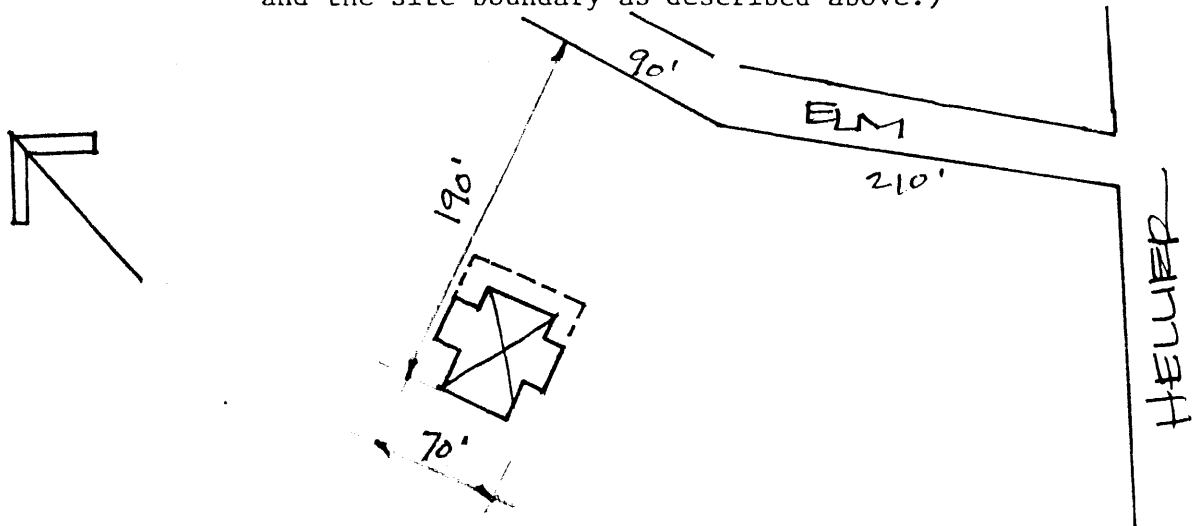

Official Courthouse Property Reference: